

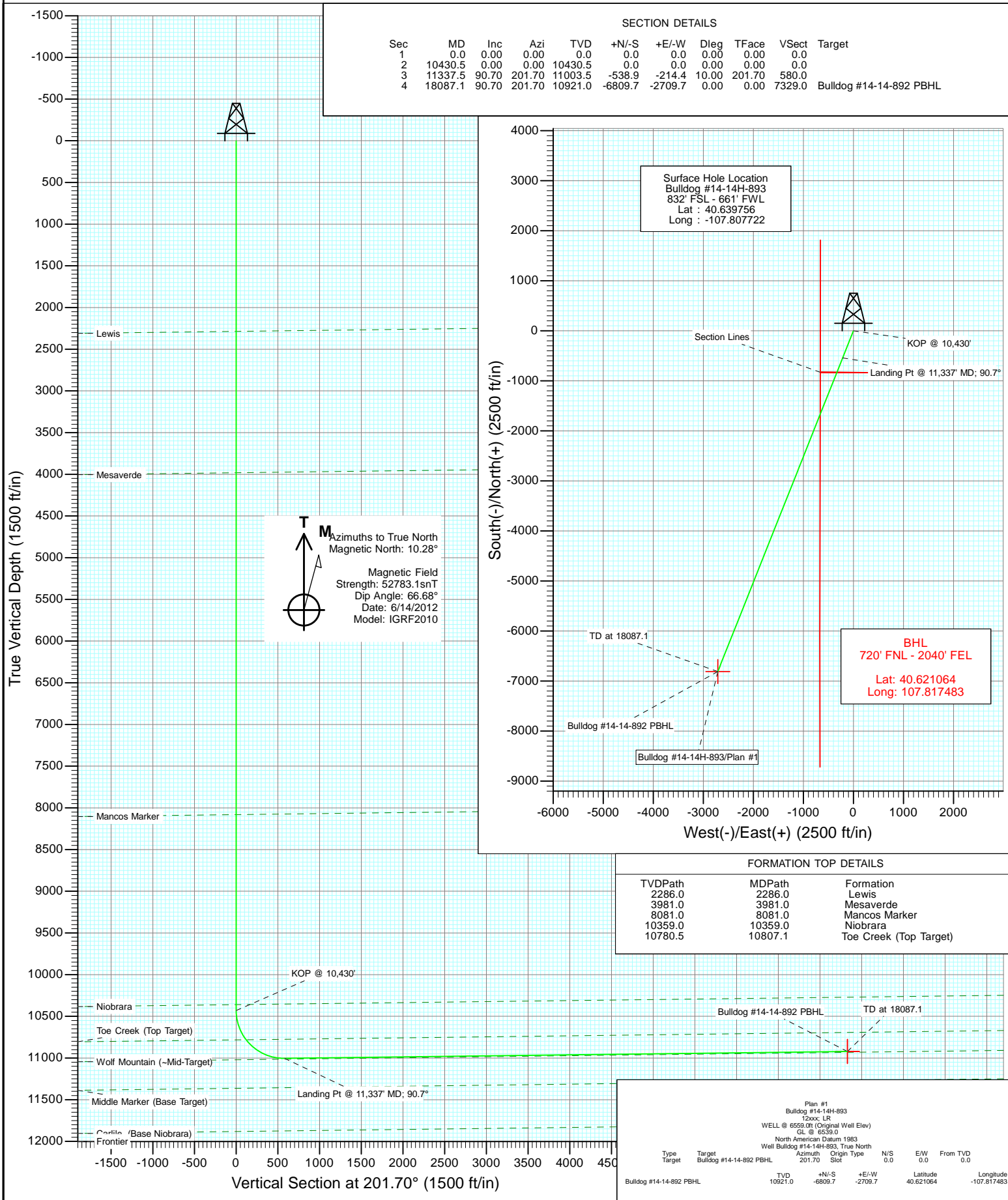

Project: Moffat County, CO  
Site: SEC 14-T8N-R93W  
Well: Bulldog #14-14H-893  
Wellbore: Hz  
Design: Plan #1



## Planning Report

<b>Database:</b>	USA EDM 5000 Multi Users DB	<b>Local Co-ordinate Reference:</b>	Well Bulldog #14-14H-893
<b>Company:</b>	Axia Energy	<b>TVD Reference:</b>	WELL @ 6559.0ft (Original Well Elev)
<b>Project:</b>	Moffat County, CO	<b>MD Reference:</b>	WELL @ 6559.0ft (Original Well Elev)
<b>Site:</b>	SEC 14-T8N-R93W	<b>North Reference:</b>	True
<b>Well:</b>	Bulldog #14-14H-893	<b>Survey Calculation Method:</b>	Minimum Curvature
<b>Wellbore:</b>	Hz		
<b>Design:</b>	Plan #1		

<b>Project</b>	Moffat County, CO		
<b>Map System:</b>	US State Plane 1983	<b>System Datum:</b>	Mean Sea Level
<b>Geo Datum:</b>	North American Datum 1983		
<b>Map Zone:</b>	Colorado Northern Zone		

Site		SEC 14-T8N-R93W			
Site Position:		Northing:	1,484,241.53 ft	Latitude:	40.639756
From:	Lat/Long	Easting:	2,359,625.65 ft	Longitude:	-107.807722
Position Uncertainty:	0.0 ft	Slot Radius:	13.200 in	Grid Convergence:	-1.49 °

Well	Bulldog #14-14H-893					
Well Position	+N/-S	0.0 ft	Northing:	1,484,241.52 ft	Latitude:	40.639756
	+E/-W	0.0 ft	Easting:	2,359,625.65 ft	Longitude:	-107.807722
Position Uncertainty		0.0 ft	Wellhead Elevation:	ft	Ground Level:	6,539.0 ft

<b>Wellbore</b>	Hz				
<b>Magnetics</b>	<b>Model Name</b>	<b>Sample Date</b>	<b>Declination (°)</b>	<b>Dip Angle (°)</b>	<b>Field Strength (nT)</b>
	IGRF2010	6/14/2012	10.28	66.68	52,783

<b>Design</b>	Plan #1				
<b>Audit Notes:</b>					
<b>Version:</b>	<b>Phase:</b>	PLAN		<b>Tie On Depth:</b>	0.0
<b>Vertical Section:</b>	<b>Depth From (TVD) (ft)</b>	<b>+N/-S (ft)</b>	<b>+E/-W (ft)</b>	<b>Direction (°)</b>	
	0.0	0.0	0.0	201.70	

<b>Plan Sections</b>										
Measured Depth (ft)	Inclination (°)	Azimuth (°)	Vertical Depth (ft)	+N/-S (ft)	+E/-W (ft)	Dogleg Rate (°/100ft)	Build Rate (°/100ft)	Turn Rate (°/100ft)	TFO (°)	Target
0.0	0.00	0.00	0.0	0.0	0.0	0.00	0.00	0.00	0.00	
10,430.5	0.00	0.00	10,430.5	0.0	0.0	0.00	0.00	0.00	0.00	
11,337.5	90.70	201.70	11,003.5	-538.9	-214.4	10.00	10.00	0.00	201.70	
18,087.1	90.70	201.70	10,921.0	-6,809.7	-2,709.7	0.00	0.00	0.00	0.00	Bulldog #14-14-892 P

# Planning Report

<b>Database:</b>	USA EDM 5000 Multi Users DB	<b>Local Co-ordinate Reference:</b>	Well Bulldog #14-14H-893
<b>Company:</b>	Axia Energy	<b>TVD Reference:</b>	WELL @ 6559.0ft (Original Well Elev)
<b>Project:</b>	Moffat County, CO	<b>MD Reference:</b>	WELL @ 6559.0ft (Original Well Elev)
<b>Site:</b>	SEC 14-T8N-R93W	<b>North Reference:</b>	True
<b>Well:</b>	Bulldog #14-14H-893	<b>Survey Calculation Method:</b>	Minimum Curvature
<b>Wellbore:</b>	Hz		
<b>Design:</b>	Plan #1		

Planned Survey									
Measured Depth (ft)	Inclination (°)	Azimuth (°)	Vertical Depth (ft)	+N/-S (ft)	+E/-W (ft)	Vertical Section (ft)	Dogleg Rate (°/100ft)	Build Rate (°/100ft)	Comments / Formations
0.0	0.00	0.00	0.0	0.0	0.0	0.0	0.00	0.00	
100.0	0.00	0.00	100.0	0.0	0.0	0.0	0.00	0.00	
200.0	0.00	0.00	200.0	0.0	0.0	0.0	0.00	0.00	
300.0	0.00	0.00	300.0	0.0	0.0	0.0	0.00	0.00	
400.0	0.00	0.00	400.0	0.0	0.0	0.0	0.00	0.00	
500.0	0.00	0.00	500.0	0.0	0.0	0.0	0.00	0.00	
600.0	0.00	0.00	600.0	0.0	0.0	0.0	0.00	0.00	
700.0	0.00	0.00	700.0	0.0	0.0	0.0	0.00	0.00	
800.0	0.00	0.00	800.0	0.0	0.0	0.0	0.00	0.00	
900.0	0.00	0.00	900.0	0.0	0.0	0.0	0.00	0.00	
1,000.0	0.00	0.00	1,000.0	0.0	0.0	0.0	0.00	0.00	
1,100.0	0.00	0.00	1,100.0	0.0	0.0	0.0	0.00	0.00	
1,200.0	0.00	0.00	1,200.0	0.0	0.0	0.0	0.00	0.00	
1,300.0	0.00	0.00	1,300.0	0.0	0.0	0.0	0.00	0.00	
1,400.0	0.00	0.00	1,400.0	0.0	0.0	0.0	0.00	0.00	
1,500.0	0.00	0.00	1,500.0	0.0	0.0	0.0	0.00	0.00	
1,600.0	0.00	0.00	1,600.0	0.0	0.0	0.0	0.00	0.00	
1,700.0	0.00	0.00	1,700.0	0.0	0.0	0.0	0.00	0.00	
1,800.0	0.00	0.00	1,800.0	0.0	0.0	0.0	0.00	0.00	
1,900.0	0.00	0.00	1,900.0	0.0	0.0	0.0	0.00	0.00	
2,000.0	0.00	0.00	2,000.0	0.0	0.0	0.0	0.00	0.00	
2,100.0	0.00	0.00	2,100.0	0.0	0.0	0.0	0.00	0.00	
2,200.0	0.00	0.00	2,200.0	0.0	0.0	0.0	0.00	0.00	
2,286.0	0.00	0.00	2,286.0	0.0	0.0	0.0	0.00	0.00	Lewis
2,300.0	0.00	0.00	2,300.0	0.0	0.0	0.0	0.00	0.00	
2,400.0	0.00	0.00	2,400.0	0.0	0.0	0.0	0.00	0.00	
2,500.0	0.00	0.00	2,500.0	0.0	0.0	0.0	0.00	0.00	
2,600.0	0.00	0.00	2,600.0	0.0	0.0	0.0	0.00	0.00	
2,700.0	0.00	0.00	2,700.0	0.0	0.0	0.0	0.00	0.00	
2,800.0	0.00	0.00	2,800.0	0.0	0.0	0.0	0.00	0.00	
2,900.0	0.00	0.00	2,900.0	0.0	0.0	0.0	0.00	0.00	
3,000.0	0.00	0.00	3,000.0	0.0	0.0	0.0	0.00	0.00	
3,100.0	0.00	0.00	3,100.0	0.0	0.0	0.0	0.00	0.00	
3,200.0	0.00	0.00	3,200.0	0.0	0.0	0.0	0.00	0.00	
3,300.0	0.00	0.00	3,300.0	0.0	0.0	0.0	0.00	0.00	
3,400.0	0.00	0.00	3,400.0	0.0	0.0	0.0	0.00	0.00	
3,500.0	0.00	0.00	3,500.0	0.0	0.0	0.0	0.00	0.00	
3,600.0	0.00	0.00	3,600.0	0.0	0.0	0.0	0.00	0.00	
3,700.0	0.00	0.00	3,700.0	0.0	0.0	0.0	0.00	0.00	
3,800.0	0.00	0.00	3,800.0	0.0	0.0	0.0	0.00	0.00	
3,900.0	0.00	0.00	3,900.0	0.0	0.0	0.0	0.00	0.00	
3,981.0	0.00	0.00	3,981.0	0.0	0.0	0.0	0.00	0.00	Mesaverde
4,000.0	0.00	0.00	4,000.0	0.0	0.0	0.0	0.00	0.00	
4,100.0	0.00	0.00	4,100.0	0.0	0.0	0.0	0.00	0.00	
4,200.0	0.00	0.00	4,200.0	0.0	0.0	0.0	0.00	0.00	
4,300.0	0.00	0.00	4,300.0	0.0	0.0	0.0	0.00	0.00	
4,400.0	0.00	0.00	4,400.0	0.0	0.0	0.0	0.00	0.00	
4,500.0	0.00	0.00	4,500.0	0.0	0.0	0.0	0.00	0.00	
4,600.0	0.00	0.00	4,600.0	0.0	0.0	0.0	0.00	0.00	
4,700.0	0.00	0.00	4,700.0	0.0	0.0	0.0	0.00	0.00	
4,800.0	0.00	0.00	4,800.0	0.0	0.0	0.0	0.00	0.00	
4,900.0	0.00	0.00	4,900.0	0.0	0.0	0.0	0.00	0.00	

# Planning Report

<b>Database:</b>	USA EDM 5000 Multi Users DB	<b>Local Co-ordinate Reference:</b>	Well Bulldog #14-14H-893
<b>Company:</b>	Axia Energy	<b>TVD Reference:</b>	WELL @ 6559.0ft (Original Well Elev)
<b>Project:</b>	Moffat County, CO	<b>MD Reference:</b>	WELL @ 6559.0ft (Original Well Elev)
<b>Site:</b>	SEC 14-T8N-R93W	<b>North Reference:</b>	True
<b>Well:</b>	Bulldog #14-14H-893	<b>Survey Calculation Method:</b>	Minimum Curvature
<b>Wellbore:</b>	Hz		
<b>Design:</b>	Plan #1		

Planned Survey									
Measured Depth (ft)	Inclination (°)	Azimuth (°)	Vertical Depth (ft)	+N/-S (ft)	+E/-W (ft)	Vertical Section (ft)	Dogleg Rate (°/100ft)	Build Rate (°/100ft)	Comments / Formations
5,000.0	0.00	0.00	5,000.0	0.0	0.0	0.0	0.00	0.00	
5,100.0	0.00	0.00	5,100.0	0.0	0.0	0.0	0.00	0.00	
5,200.0	0.00	0.00	5,200.0	0.0	0.0	0.0	0.00	0.00	
5,300.0	0.00	0.00	5,300.0	0.0	0.0	0.0	0.00	0.00	
5,400.0	0.00	0.00	5,400.0	0.0	0.0	0.0	0.00	0.00	
5,500.0	0.00	0.00	5,500.0	0.0	0.0	0.0	0.00	0.00	
5,600.0	0.00	0.00	5,600.0	0.0	0.0	0.0	0.00	0.00	
5,700.0	0.00	0.00	5,700.0	0.0	0.0	0.0	0.00	0.00	
5,800.0	0.00	0.00	5,800.0	0.0	0.0	0.0	0.00	0.00	
5,900.0	0.00	0.00	5,900.0	0.0	0.0	0.0	0.00	0.00	
6,000.0	0.00	0.00	6,000.0	0.0	0.0	0.0	0.00	0.00	
6,100.0	0.00	0.00	6,100.0	0.0	0.0	0.0	0.00	0.00	
6,200.0	0.00	0.00	6,200.0	0.0	0.0	0.0	0.00	0.00	
6,300.0	0.00	0.00	6,300.0	0.0	0.0	0.0	0.00	0.00	
6,400.0	0.00	0.00	6,400.0	0.0	0.0	0.0	0.00	0.00	
6,500.0	0.00	0.00	6,500.0	0.0	0.0	0.0	0.00	0.00	
6,600.0	0.00	0.00	6,600.0	0.0	0.0	0.0	0.00	0.00	
6,700.0	0.00	0.00	6,700.0	0.0	0.0	0.0	0.00	0.00	
6,800.0	0.00	0.00	6,800.0	0.0	0.0	0.0	0.00	0.00	
6,900.0	0.00	0.00	6,900.0	0.0	0.0	0.0	0.00	0.00	
7,000.0	0.00	0.00	7,000.0	0.0	0.0	0.0	0.00	0.00	
7,100.0	0.00	0.00	7,100.0	0.0	0.0	0.0	0.00	0.00	
7,200.0	0.00	0.00	7,200.0	0.0	0.0	0.0	0.00	0.00	
7,300.0	0.00	0.00	7,300.0	0.0	0.0	0.0	0.00	0.00	
7,400.0	0.00	0.00	7,400.0	0.0	0.0	0.0	0.00	0.00	
7,500.0	0.00	0.00	7,500.0	0.0	0.0	0.0	0.00	0.00	
7,600.0	0.00	0.00	7,600.0	0.0	0.0	0.0	0.00	0.00	
7,700.0	0.00	0.00	7,700.0	0.0	0.0	0.0	0.00	0.00	
7,800.0	0.00	0.00	7,800.0	0.0	0.0	0.0	0.00	0.00	
7,900.0	0.00	0.00	7,900.0	0.0	0.0	0.0	0.00	0.00	
8,000.0	0.00	0.00	8,000.0	0.0	0.0	0.0	0.00	0.00	
8,081.0	0.00	0.00	8,081.0	0.0	0.0	0.0	0.00	0.00	Mancos Marker
8,100.0	0.00	0.00	8,100.0	0.0	0.0	0.0	0.00	0.00	
8,200.0	0.00	0.00	8,200.0	0.0	0.0	0.0	0.00	0.00	
8,300.0	0.00	0.00	8,300.0	0.0	0.0	0.0	0.00	0.00	
8,400.0	0.00	0.00	8,400.0	0.0	0.0	0.0	0.00	0.00	
8,500.0	0.00	0.00	8,500.0	0.0	0.0	0.0	0.00	0.00	
8,600.0	0.00	0.00	8,600.0	0.0	0.0	0.0	0.00	0.00	
8,700.0	0.00	0.00	8,700.0	0.0	0.0	0.0	0.00	0.00	
8,800.0	0.00	0.00	8,800.0	0.0	0.0	0.0	0.00	0.00	
8,900.0	0.00	0.00	8,900.0	0.0	0.0	0.0	0.00	0.00	
9,000.0	0.00	0.00	9,000.0	0.0	0.0	0.0	0.00	0.00	
9,100.0	0.00	0.00	9,100.0	0.0	0.0	0.0	0.00	0.00	
9,200.0	0.00	0.00	9,200.0	0.0	0.0	0.0	0.00	0.00	
9,300.0	0.00	0.00	9,300.0	0.0	0.0	0.0	0.00	0.00	
9,400.0	0.00	0.00	9,400.0	0.0	0.0	0.0	0.00	0.00	
9,500.0	0.00	0.00	9,500.0	0.0	0.0	0.0	0.00	0.00	
9,600.0	0.00	0.00	9,600.0	0.0	0.0	0.0	0.00	0.00	
9,700.0	0.00	0.00	9,700.0	0.0	0.0	0.0	0.00	0.00	
9,800.0	0.00	0.00	9,800.0	0.0	0.0	0.0	0.00	0.00	
9,900.0	0.00	0.00	9,900.0	0.0	0.0	0.0	0.00	0.00	
10,000.0	0.00	0.00	10,000.0	0.0	0.0	0.0	0.00	0.00	

# Planning Report

<b>Database:</b>	USA EDM 5000 Multi Users DB	<b>Local Co-ordinate Reference:</b>	Well Bulldog #14-14H-893
<b>Company:</b>	Axia Energy	<b>TVD Reference:</b>	WELL @ 6559.0ft (Original Well Elev)
<b>Project:</b>	Moffat County, CO	<b>MD Reference:</b>	WELL @ 6559.0ft (Original Well Elev)
<b>Site:</b>	SEC 14-T8N-R93W	<b>North Reference:</b>	True
<b>Well:</b>	Bulldog #14-14H-893	<b>Survey Calculation Method:</b>	Minimum Curvature
<b>Wellbore:</b>	Hz		
<b>Design:</b>	Plan #1		

Planned Survey									
Measured Depth (ft)	Inclination (°)	Azimuth (°)	Vertical Depth (ft)	+N/-S (ft)	+E/-W (ft)	Vertical Section (ft)	Dogleg Rate (°/100ft)	Build Rate (°/100ft)	Comments / Formations
10,100.0	0.00	0.00	10,100.0	0.0	0.0	0.0	0.00	0.00	
10,200.0	0.00	0.00	10,200.0	0.0	0.0	0.0	0.00	0.00	
10,300.0	0.00	0.00	10,300.0	0.0	0.0	0.0	0.00	0.00	
10,359.0	0.00	0.00	10,359.0	0.0	0.0	0.0	0.00	0.00	Niobrara
10,400.0	0.00	0.00	10,400.0	0.0	0.0	0.0	0.00	0.00	
10,430.5	0.00	0.00	10,430.5	0.0	0.0	0.0	0.00	0.00	KOP @ 10,430'
10,500.0	6.95	201.70	10,499.8	-3.9	-1.6	4.2	10.00	10.00	
10,600.0	16.95	201.70	10,597.5	-23.1	-9.2	24.9	10.00	10.00	
10,700.0	26.95	201.70	10,690.2	-57.8	-23.0	62.2	10.00	10.00	
10,800.0	36.95	201.70	10,774.9	-106.9	-42.5	115.0	10.00	10.00	
10,807.1	37.65	201.70	10,780.5	-110.9	-44.1	119.3	10.00	10.00	Toe Creek (Top Target)
10,900.0	46.95	201.70	10,849.2	-168.9	-67.2	181.8	10.00	10.00	
11,000.0	56.95	201.70	10,910.8	-242.0	-96.3	260.4	10.00	10.00	
11,100.0	66.95	201.70	10,957.7	-323.9	-128.9	348.6	10.00	10.00	
11,200.0	76.95	201.70	10,988.7	-412.1	-164.0	443.5	10.00	10.00	
11,300.0	86.95	201.70	11,002.7	-504.0	-200.5	542.4	10.00	10.00	
11,337.5	90.70	201.70	11,003.5	-538.9	-214.4	580.0	10.00	10.00	Landing Pt @ 11,337' MD; 90.7°
11,400.0	90.70	201.70	11,002.7	-596.9	-237.5	642.4	0.00	0.00	
11,500.0	90.70	201.70	11,001.5	-689.8	-274.5	742.4	0.00	0.00	
11,600.0	90.70	201.70	11,000.3	-782.7	-311.4	842.4	0.00	0.00	
11,700.0	90.70	201.70	10,999.0	-875.6	-348.4	942.4	0.00	0.00	
11,800.0	90.70	201.70	10,997.8	-968.5	-385.4	1,042.4	0.00	0.00	
11,900.0	90.70	201.70	10,996.6	-1,061.4	-422.4	1,142.4	0.00	0.00	
12,000.0	90.70	201.70	10,995.4	-1,154.3	-459.3	1,242.4	0.00	0.00	
12,100.0	90.70	201.70	10,994.1	-1,247.2	-496.3	1,342.4	0.00	0.00	
12,200.0	90.70	201.70	10,992.9	-1,340.1	-533.3	1,442.3	0.00	0.00	
12,300.0	90.70	201.70	10,991.7	-1,433.1	-570.2	1,542.3	0.00	0.00	
12,400.0	90.70	201.70	10,990.5	-1,526.0	-607.2	1,642.3	0.00	0.00	
12,500.0	90.70	201.70	10,989.3	-1,618.9	-644.2	1,742.3	0.00	0.00	
12,600.0	90.70	201.70	10,988.0	-1,711.8	-681.1	1,842.3	0.00	0.00	
12,700.0	90.70	201.70	10,986.8	-1,804.7	-718.1	1,942.3	0.00	0.00	
12,800.0	90.70	201.70	10,985.6	-1,897.6	-755.1	2,042.3	0.00	0.00	
12,900.0	90.70	201.70	10,984.4	-1,990.5	-792.0	2,142.3	0.00	0.00	
13,000.0	90.70	201.70	10,983.1	-2,083.4	-829.0	2,242.3	0.00	0.00	
13,100.0	90.70	201.70	10,981.9	-2,176.3	-866.0	2,342.3	0.00	0.00	
13,200.0	90.70	201.70	10,980.7	-2,269.2	-903.0	2,442.3	0.00	0.00	
13,300.0	90.70	201.70	10,979.5	-2,362.1	-939.9	2,542.3	0.00	0.00	
13,400.0	90.70	201.70	10,978.3	-2,455.0	-976.9	2,642.3	0.00	0.00	
13,500.0	90.70	201.70	10,977.0	-2,547.9	-1,013.9	2,742.3	0.00	0.00	
13,600.0	90.70	201.70	10,975.8	-2,640.9	-1,050.8	2,842.2	0.00	0.00	
13,700.0	90.70	201.70	10,974.6	-2,733.8	-1,087.8	2,942.2	0.00	0.00	
13,800.0	90.70	201.70	10,973.4	-2,826.7	-1,124.8	3,042.2	0.00	0.00	
13,900.0	90.70	201.70	10,972.2	-2,919.6	-1,161.7	3,142.2	0.00	0.00	
14,000.0	90.70	201.70	10,970.9	-3,012.5	-1,198.7	3,242.2	0.00	0.00	
14,100.0	90.70	201.70	10,969.7	-3,105.4	-1,235.7	3,342.2	0.00	0.00	
14,200.0	90.70	201.70	10,968.5	-3,198.3	-1,272.7	3,442.2	0.00	0.00	
14,300.0	90.70	201.70	10,967.3	-3,291.2	-1,309.6	3,542.2	0.00	0.00	
14,400.0	90.70	201.70	10,966.0	-3,384.1	-1,346.6	3,642.2	0.00	0.00	
14,500.0	90.70	201.70	10,964.8	-3,477.0	-1,383.6	3,742.2	0.00	0.00	
14,600.0	90.70	201.70	10,963.6	-3,569.9	-1,420.5	3,842.2	0.00	0.00	
14,700.0	90.70	201.70	10,962.4	-3,662.8	-1,457.5	3,942.2	0.00	0.00	
14,800.0	90.70	201.70	10,961.2	-3,755.7	-1,494.5	4,042.2	0.00	0.00	

## Planning Report

<b>Database:</b>	USA EDM 5000 Multi Users DB	<b>Local Co-ordinate Reference:</b>	Well Bulldog #14-14H-893
<b>Company:</b>	Axia Energy	<b>TVD Reference:</b>	WELL @ 6559.0ft (Original Well Elev)
<b>Project:</b>	Moffat County, CO	<b>MD Reference:</b>	WELL @ 6559.0ft (Original Well Elev)
<b>Site:</b>	SEC 14-T8N-R93W	<b>North Reference:</b>	True
<b>Well:</b>	Bulldog #14-14H-893	<b>Survey Calculation Method:</b>	Minimum Curvature
<b>Wellbore:</b>	Hz		
<b>Design:</b>	Plan #1		

Planned Survey									
Measured Depth (ft)	Inclination (°)	Azimuth (°)	Vertical Depth (ft)	+N/-S (ft)	+E/-W (ft)	Vertical Section (ft)	Dogleg Rate (°/100ft)	Build Rate (°/100ft)	Comments / Formations
14,900.0	90.70	201.70	10,959.9	-3,848.6	-1,531.4	4,142.1	0.00	0.00	
15,000.0	90.70	201.70	10,958.7	-3,941.6	-1,568.4	4,242.1	0.00	0.00	
15,100.0	90.70	201.70	10,957.5	-4,034.5	-1,605.4	4,342.1	0.00	0.00	
15,200.0	90.70	201.70	10,956.3	-4,127.4	-1,642.3	4,442.1	0.00	0.00	
15,300.0	90.70	201.70	10,955.0	-4,220.3	-1,679.3	4,542.1	0.00	0.00	
15,400.0	90.70	201.70	10,953.8	-4,313.2	-1,716.3	4,642.1	0.00	0.00	
15,500.0	90.70	201.70	10,952.6	-4,406.1	-1,753.3	4,742.1	0.00	0.00	
15,600.0	90.70	201.70	10,951.4	-4,499.0	-1,790.2	4,842.1	0.00	0.00	
15,700.0	90.70	201.70	10,950.2	-4,591.9	-1,827.2	4,942.1	0.00	0.00	
15,800.0	90.70	201.70	10,948.9	-4,684.8	-1,864.2	5,042.1	0.00	0.00	
15,900.0	90.70	201.70	10,947.7	-4,777.7	-1,901.1	5,142.1	0.00	0.00	
16,000.0	90.70	201.70	10,946.5	-4,870.6	-1,938.1	5,242.1	0.00	0.00	
16,100.0	90.70	201.70	10,945.3	-4,963.5	-1,975.1	5,342.1	0.00	0.00	
16,200.0	90.70	201.70	10,944.1	-5,056.4	-2,012.0	5,442.1	0.00	0.00	
16,300.0	90.70	201.70	10,942.8	-5,149.4	-2,049.0	5,542.0	0.00	0.00	
16,400.0	90.70	201.70	10,941.6	-5,242.3	-2,086.0	5,642.0	0.00	0.00	
16,500.0	90.70	201.70	10,940.4	-5,335.2	-2,122.9	5,742.0	0.00	0.00	
16,600.0	90.70	201.70	10,939.2	-5,428.1	-2,159.9	5,842.0	0.00	0.00	
16,700.0	90.70	201.70	10,937.9	-5,521.0	-2,196.9	5,942.0	0.00	0.00	
16,800.0	90.70	201.70	10,936.7	-5,613.9	-2,233.9	6,042.0	0.00	0.00	
16,900.0	90.70	201.70	10,935.5	-5,706.8	-2,270.8	6,142.0	0.00	0.00	
17,000.0	90.70	201.70	10,934.3	-5,799.7	-2,307.8	6,242.0	0.00	0.00	
17,100.0	90.70	201.70	10,933.1	-5,892.6	-2,344.8	6,342.0	0.00	0.00	
17,200.0	90.70	201.70	10,931.8	-5,985.5	-2,381.7	6,442.0	0.00	0.00	
17,300.0	90.70	201.70	10,930.6	-6,078.4	-2,418.7	6,542.0	0.00	0.00	
17,400.0	90.70	201.70	10,929.4	-6,171.3	-2,455.7	6,642.0	0.00	0.00	
17,500.0	90.70	201.70	10,928.2	-6,264.2	-2,492.6	6,742.0	0.00	0.00	
17,600.0	90.70	201.70	10,927.0	-6,357.1	-2,529.6	6,841.9	0.00	0.00	
17,700.0	90.70	201.70	10,925.7	-6,450.1	-2,566.6	6,941.9	0.00	0.00	
17,800.0	90.70	201.70	10,924.5	-6,543.0	-2,603.5	7,041.9	0.00	0.00	
17,900.0	90.70	201.70	10,923.3	-6,635.9	-2,640.5	7,141.9	0.00	0.00	
18,000.0	90.70	201.70	10,922.1	-6,728.8	-2,677.5	7,241.9	0.00	0.00	
18,087.1	90.70	201.70	10,921.0	-6,809.7	-2,709.7	7,329.0	0.00	0.00	TD at 18087.1 - Bulldog #14-14-892 PBHL

Targets									
Target Name									
- hit/miss target	Dip Angle (°)	Dip Dir. (°)	TVD (ft)	+N/-S (ft)	+E/-W (ft)	Northing (ft)	Easting (ft)	Latitude	Longitude
- Shape									
Bulldog #14-14-892 PBH	0.00	0.00	10,921.0	-6,809.7	-2,709.7	1,477,504.64	2,356,739.69	40.621064	-107.817483
- plan hits target center									
- Point									

## Planning Report

<b>Database:</b>	USA EDM 5000 Multi Users DB	<b>Local Co-ordinate Reference:</b>	Well Bulldog #14-14H-893
<b>Company:</b>	Axia Energy	<b>TVD Reference:</b>	WELL @ 6559.0ft (Original Well Elev)
<b>Project:</b>	Moffat County, CO	<b>MD Reference:</b>	WELL @ 6559.0ft (Original Well Elev)
<b>Site:</b>	SEC 14-T8N-R93W	<b>North Reference:</b>	True
<b>Well:</b>	Bulldog #14-14H-893	<b>Survey Calculation Method:</b>	Minimum Curvature
<b>Wellbore:</b>	Hz		
<b>Design:</b>	Plan #1		

Formations					
Measured Depth (ft)	Vertical Depth (ft)	Name	Lithology	Dip (°)	Dip Direction (°)
2,286.0	2,286.0	Lewis		-0.70	201.70
3,981.0	3,981.0	Mesaverde		-0.70	201.70
8,081.0	8,081.0	Mancos Marker		-0.70	201.70
10,359.0	10,359.0	Niobrara		-0.70	201.70
10,807.1	10,782.0	Toe Creek (Top Target)		-0.70	201.70

Plan Annotations				
Measured Depth (ft)	Vertical Depth (ft)	Local Coordinates		Comment
		+N/-S (ft)	+E/-W (ft)	
10,430.5	10,430.5	0.0	0.0	KOP @ 10,430'
11,337.5	11,003.5	-538.9	-214.4	Landing Pt @ 11,337' MD; 90.7°
18,087.1	10,921.0	-6,809.7	-2,709.7	TD at 18087.1