

2011 ANNUAL PROJECT SUMMARY TABLE

Incident Date	Remediation No.	Well Name	API	Status	NFA Proposed	NFA Approved Date	2011 Site Summary (monitoring/remediation/ wells installed or destroyed)	Wells Sampled (Last Quarter) 2011	Wells Exceeding 5 ug/L Benzene (Last Quarter Sampled 2011)	Benzene Range (Last Quarter Sampled 2011)	POC Reached	2012 Recommendations	Well Reduction Request
2/22/2011	5847	Gelb 17-26, Votling 1-26	05-123-23457	Monitoring	NO	N/A	Quarterly groundwater monitoring since April-2011. MW01-MW04 installed April-2011. MW05 and MW06 installed June-2011.	MW01-MW06	MW01	ND - 370	YES	Quarterly groundwater monitoring will continue.	N/A

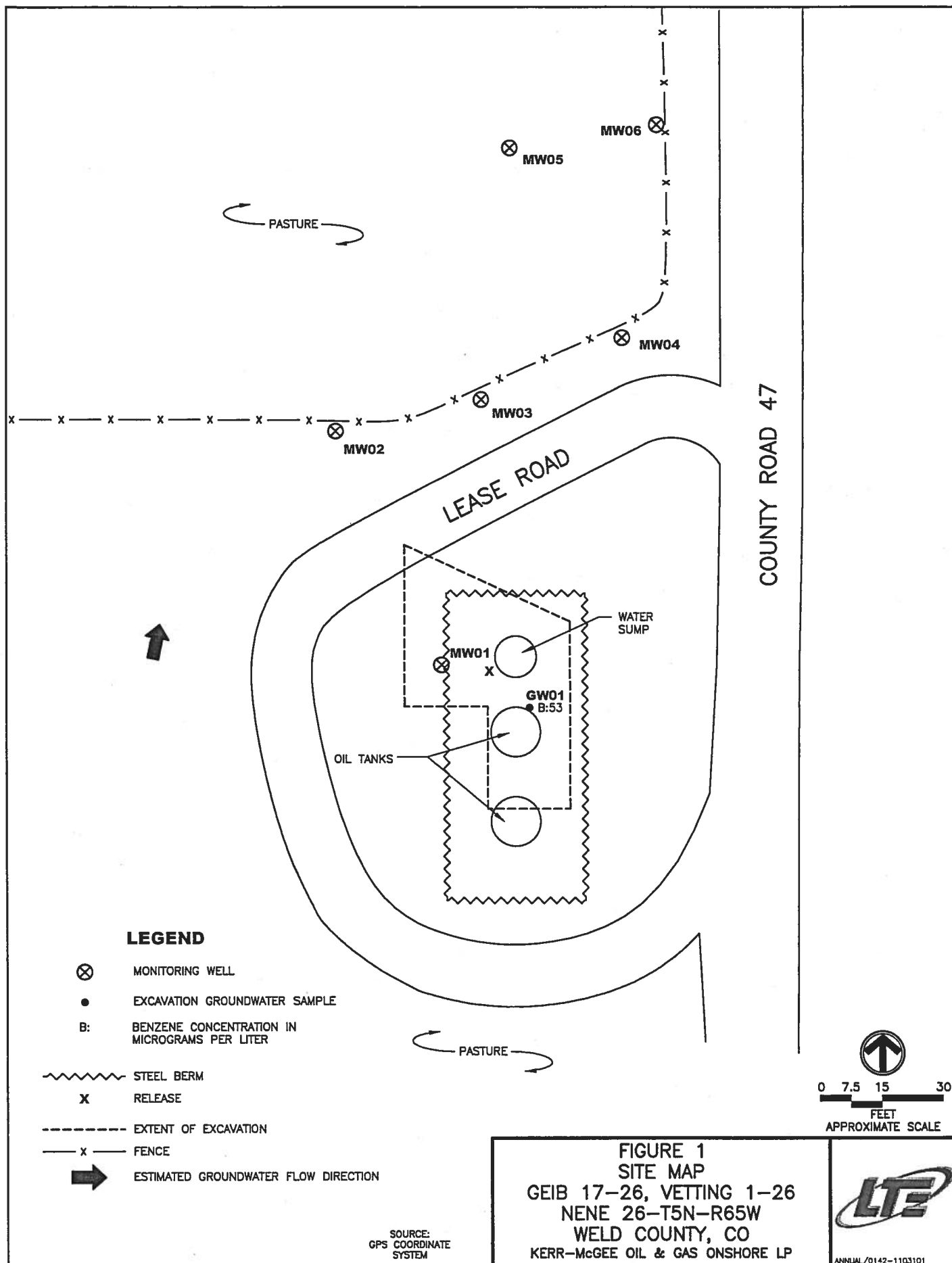

TABLE 1
GROUNDWATER ANALYTICAL AND FIELD RESULTS
GEIB 17-26, VETTING 1-26
WELD COUNTY, COLORADO
KERR-McGEE OIL & GAS ONSHORE LP

Well Name	Date	Benzene (ug/L)	Toluene (ug/L)	Ethylbenzene (ug/L)	Xylenes (ug/L)	Depth Water/ (Depth Product) (ft bgs)
GW01	02/18/2011	53	<1.0	54	3700	NM
MW01	04/26/2011	280	<1.0	270	5100	7.90
	07/11/2011	67	<1.0	79	410	6.07
	10/04/2011	370	<1.0	190	1100	2.30
MW02	04/26/2011	<1.0	<1.0	<1.0	<1.0	7.95
	07/11/2011	<1.0	<1.0	<1.0	<1.0	6.08
	10/04/2011	<1.0	<1.0	<1.0	<1.0	2.58
MW03	04/26/2011	3.8	<1.0	<1.0	<1.0	7.66
	07/11/2011	<1.0	<1.0	<1.0	<1.0	5.75
	10/04/2011	<1.0	<1.0	<1.0	<1.0	2.29
MW04	04/26/2011	76	<1.0	<1.0	<1.0	7.29
	07/11/2011	<1.0	<1.0	<1.0	<1.0	5.41
	10/04/2011	<1.0	<1.0	<1.0	<1.0	1.89
MW05	07/11/2011	<1.0	<1.0	<1.0	<1.0	5.48
	10/04/2011	<1.0	<1.0	<1.0	<1.0	2.34
MW06	07/11/2011	<1.0	<1.0	<1.0	<1.0	5.32
	10/04/2011	<1.0	<1.0	<1.0	<1.0	2.20
Colo GW Quality Standards		5	1000	700	1400	

Notes: NM - Not Measured
ug/L - micrograms per Liter
NA - Not Analyzed/Not Available

GW - Groundwater ft bgs - feet below ground surface
< - less than laboratory reporting limit
Bold numbers indicate result equaled or exceeded standard.

