

BMP Plan

Wiepking-Fullerton Energy, L.L.C.
4600 S. Downing St.
Englewood, CO 80113
303-789-1798
303-761-9067 (fax)

Certification to Discharge
Under
CDPS General Permit COR-03000
Stormwater Discharges Associated with Construction

Certification Number COR 39788

Mahalo # 10 well
T10S, R55W
Sec. 29: SW1/4NW1/4
Lincoln County, Colorado

Description of Well Site and Construction Area

1-3 acre site with access road for drilling of oil and gas well. Terrain is flat with native grass and sagebrush. No receiving waters will be affected by well pad. Surface Roughening will be used on low side of drill site to reduce speed of runoff, increase infiltration, reduce erosion, trap sediment and prepare soil for reseeding. Mud and Water Pits will be reclaimed within 6 months weather permitting. Topsoil will be separated and spread on drill site as final operation before reseeding operations. To prevent soil erosion site will be disked and straw crimped in or manure spread.

Stormwater Management Plan (SWMP) is on file in Wiepking-Fullerton Energy, L.L.C. office.

Spill Prevention, Control and Countermeasure Plan is on file in Wiepking-Fullerton Energy, L.L.C. office.

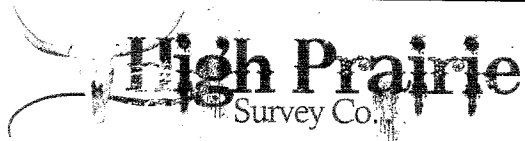

Physical Address: 401 Arapahoe St.
Mail to: Box 384 Kiowa, CO 80117
Ph. 303-621-8672 - Fax 303-621-2717
www.highprairiesurvey.com

Job: 10178 Mahalo #10

Inv # 1958

High Prairie Surveying of Kiowa, Colorado has in accordance with a request from **Jack Fincham, Wiepking Fullerton Energy** has determined the location of **Mahalo #10** to be **1980 feet FNL**, and **660 feet FWL**, (90° off Section lines) of **SECTION 29**, Township **10s**, Range **55w** of the 6th Principal Meridian, **Lincoln County**, Colorado.

Date: Staked on 5-29-12 drawn on 5-30-12.

Re: Staked by Keith Westfall
Drawn: Drawn by Elijah Frane

Topo Exhibit

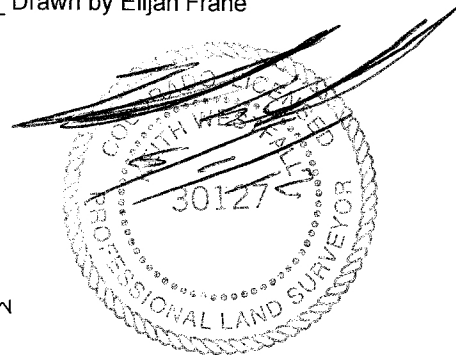

Wiepking Fullerton
NW ¼ SEC. 29-10s-55w
Mahalo #10
Lincoln, Co. Colorado

