

**SWEPI LP**  
**DRY SAGE UNIT #1-23**  
LOCATED IN MOFFAT COUNTY, COLORADO  
SECTION 23, T12N, R90W, 6th P.M.

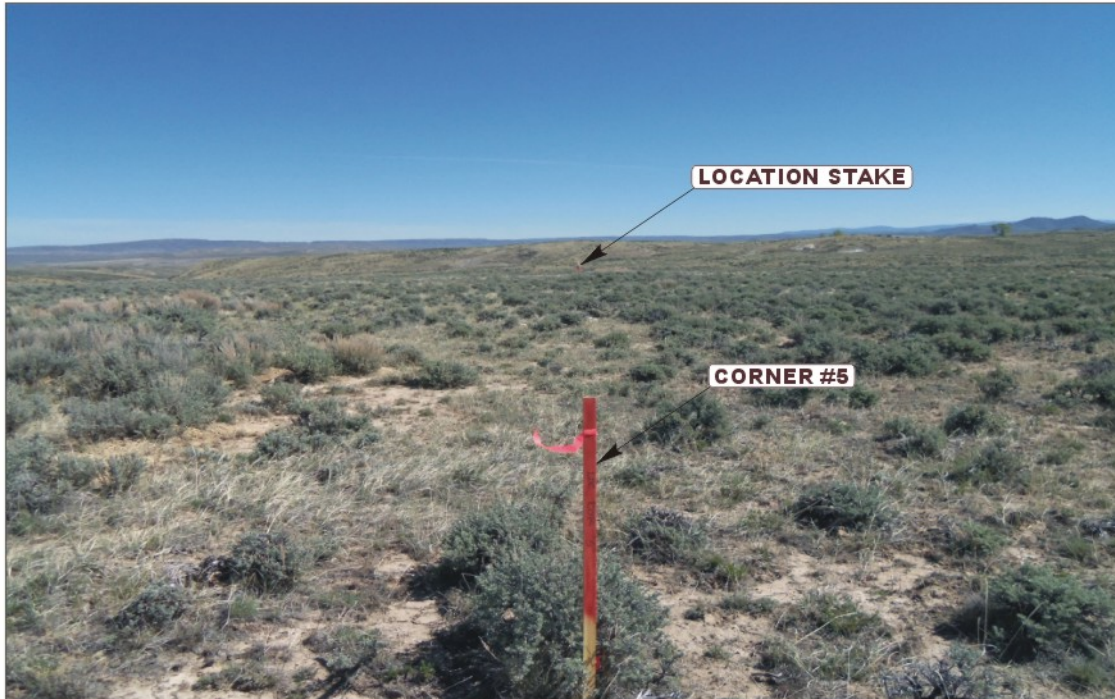

PHOTO: VIEW FROM CORNER #5 TO LOCATION STAKE

CAMERA ANGLE: NORTHEASTERLY



PHOTO: VIEW OF PROPOSED ACCESS

CAMERA ANGLE: SOUTHWESTERLY



**UELS** Uintah Engineering & Land Surveying  
85 South 200 East Vernal, Utah 84078  
(435) 789-1017 \* FAX (435) 789-1813

**LOCATION PHOTOS**

**07** **19** **11**  
MONTH DAY YEAR

TAKEN BY: B.H.

DRAWN BY: B.D.H.

REVISED: 05-16-12

PHOTO  
**P1**



**SWEPI LP**  
**DRY SAGE UNIT #1-23**  
LOCATED IN MOFFAT COUNTY, COLORADO  
SECTION 23, T12N, R90W, 6th P.M.



PHOTO: VIEW OF LOCATION STAKE

CAMERA ANGLE: NORTHERLY



PHOTO: VIEW OF LOCATION STAKE

CAMERA ANGLE: EASTERLY



- Since 1964 -

**U  
E  
L  
S**

Uintah Engineering & Land Surveying  
85 South 200 East Vernal, Utah 84078  
(435) 789-1017 \* FAX (435) 789-1813

**LOCATION PHOTOS**

**07**  
MONTH

**19**  
DAY

**11**  
YEAR

TAKEN BY: B.H.

DRAWN BY: B.D.H.

REVISED: 05-16-12

PHOTO  
**P2**



**SWEPI LP**  
**DRY SAGE UNIT #1-23**  
LOCATED IN MOFFAT COUNTY, COLORADO  
SECTION 23, T12N, R90W, 6th P.M.



PHOTO: VIEW OF LOCATION STAKE

CAMERA ANGLE: SOUTHERLY



PHOTO: VIEW OF LOCATION STAKE

CAMERA ANGLE: WESTERLY



**UELS** Uintah Engineering & Land Surveying  
85 South 200 East Vernal, Utah 84078  
(435) 789-1017 \* FAX (435) 789-1813

**LOCATION PHOTOS**

**07** **19** **11**  
MONTH DAY YEAR

PHOTO  
**P3**

TAKEN BY: B.H.

DRAWN BY: B.D.H.

REVISED: 05-16-12