

# **LEGEND:**

 PROPOSED LOCATION



## **GREAT WESTERN OIL & GAS COMPANY**

De TIENNE FD #10-18 & #10-25D  
SECTION 10, T6N, R67W, 6th P.M.  
NW 1/4 SW 1/4

**U&LS**  
 Uintah Engineering & Land Surveying  
 85 South 200 East Vernal, Utah 84078  
 (435) 789-1017 \* FAX (435) 789-1813

**ACCESS ROAD  
MAP**

**03 22 12**  
 MONTH DAY YEAR

**A  
TOPO**

SCALE: 1:100,000 DRAWN BY: A.T. REVISED: 00-00-00



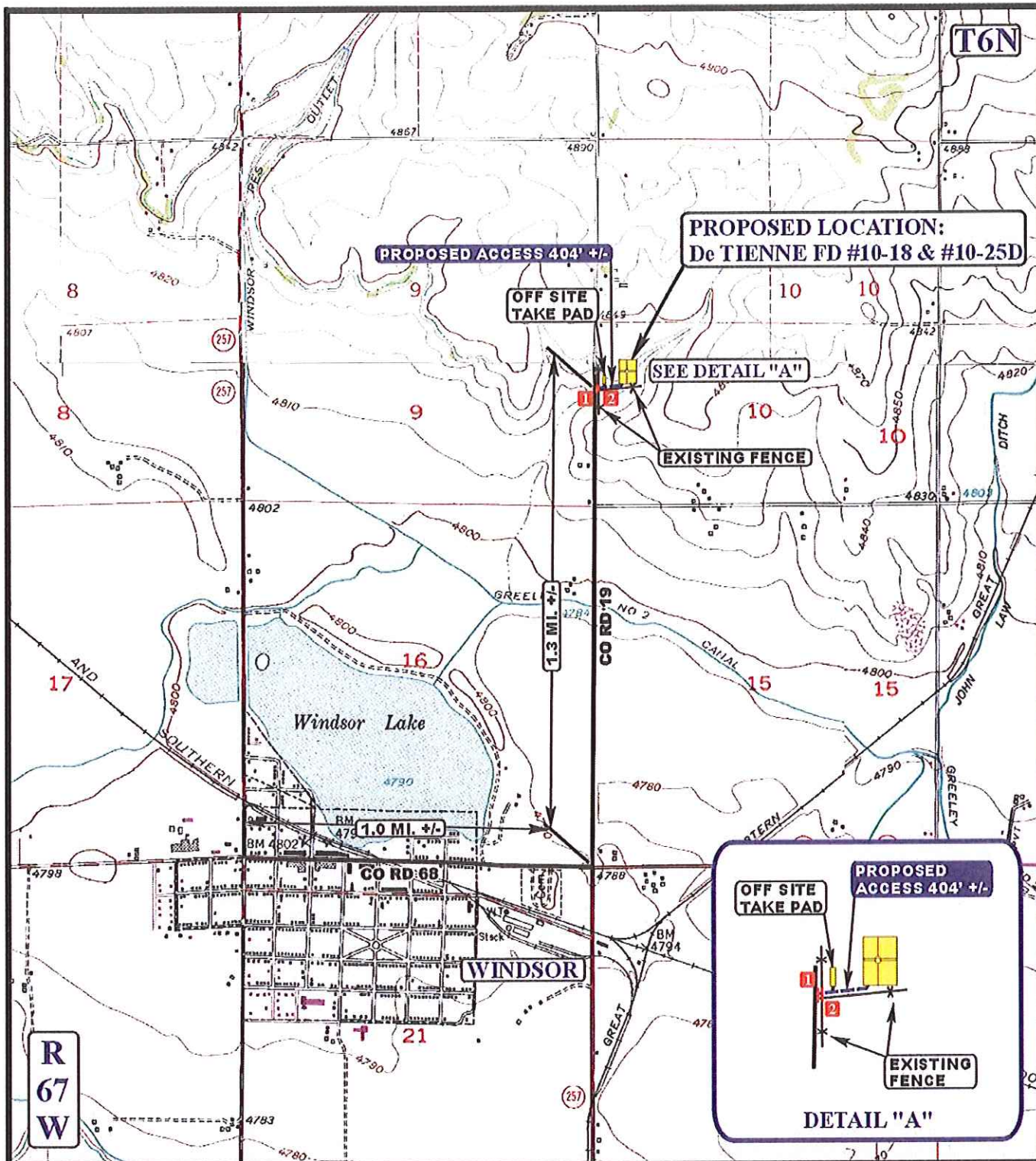

# **LEGEND:**

- EXISTING ROAD
- PROPOSED ACCESS ROAD
- EXISTING FENCE
- 18" CMP REQUIRED
- INSTALL CATTLE GUARD

**U  
E  
L  
S**

**Uintah Engineering & Land Surveying**  
85 South 200 East Vernal, Utah 84078  
(435) 789-1017 \* FAX (435) 789-1813



## **GREAT WESTERN OIL & GAS COMPANY**

**De TIENNE FD #10-18 & #10-25D**  
**SECTION 10, T6N, R67W, 6th P.M.**  
**NW 1/4 SW 1/4**

**ACCESS ROAD**  
**MAP**

**03 22 12**  
MONTH DAY YEAR

**B**  
**TOPO**

SCALE: 1" = 2000' DRAWN BY: A.T. REVISED: 00-00-00

# GREAT WESTERN OIL & GAS COMPANY

De TIENNE FD #10-18 & #10-25D

SECTION 10, T6N, R67W, 6<sup>th</sup> P.M.

PROCEED IN AN EASTERLY DIRECTION FROM WINDSOR, COLORADO ALONG COUNTY ROAD 68 APPROXIMATELY 1.0 MILES TO THE JUNCTION OF THIS ROAD AND COUNTY ROAD 19 TO THE NORTH; TURN LEFT AND PROCEED IN A NORTHERLY DIRECTION APPROXIMATELY 1.3 MILES TO THE BEGINNING OF THE PROPOSED ACCESS ROAD TO THE EAST; FOLLOW ROAD FLAGS IN AN EASTERLY DIRECTION APPROXIMATELY 404' TO THE PROPOSED LOCATION.

TOTAL DISTANCE FROM WINDSOR, COLORADO TO THE PROPOSED LOCATION IS APPROXIMATELY 2.4 MILES.