

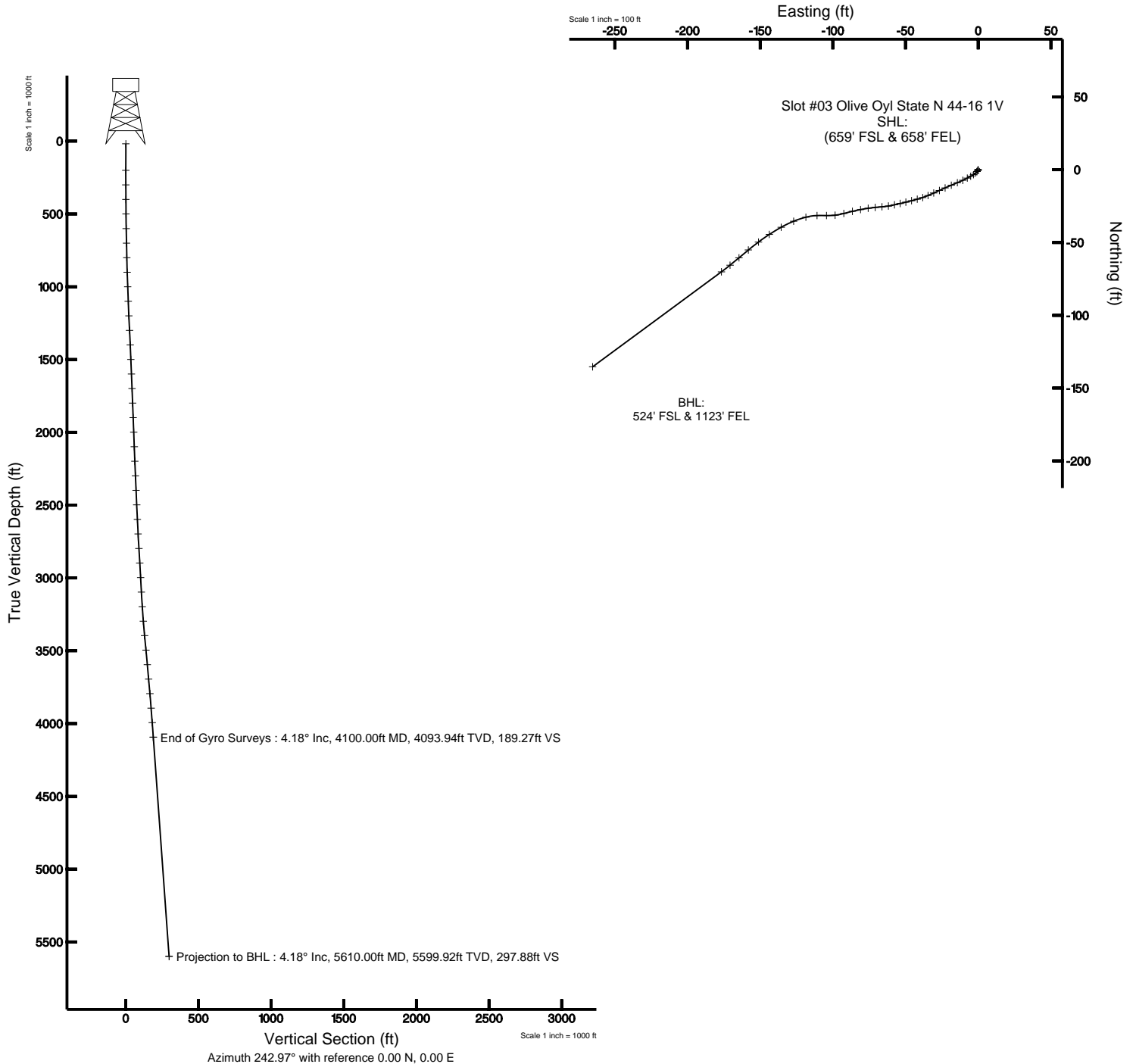

# ULTRA RESOURCES, INC

Location: PA Slot: Slot #03 Olive Oyl State N 44-16 1V (659' FSL & 658' FEL)  
Field: EL Paso Country (Nad 83) Well: Olive Oyl State N 44-16 1V  
Facility: Sec.16-T15S-R64W Wellbore: Olive Oyl State N 44-16 1V AWB





## Actual Wellpath Report

Olive Oyl State N 44-16 1V Original AWP

Page 1 of 3



REFERENCE WELLPATH IDENTIFICATION			
Operator	ULTRA RESOURCES, INC	Slot	Slot #03 Olive Oyl State N 44-16 1V (659' FSL & 658' FEL)
Area	PA	Well	Olive Oyl State N 44-16 1V
Field	EL Paso Country (Nad 83)	Wellbore	Olive Oyl State N 44-16 1V AWB
Facility	Sec.16-T15S-R64W		

REPORT SETUP INFORMATION			
Projection System	NAD83 / Lambert Colorado State Planes, Central Zone (502), US feet	Software System	WellArchitect® 2.0
North Reference	True	User	Ewilliams
Scale	0.999956	Report Generated	4/19/2012 at 4:36:51 PM
Convergence at slot	0.60° East	Database/Source file	UltraWellArchitect/Olive_Oyl_State_N_44-16_1V_AWB.xml

WELLPATH LOCATION						
	Local coordinates		Grid coordinates		Geographic coordinates	
	North[ft]	East[ft]	Easting[USft]	Northing[USft]	Latitude	Longitude
Slot Location	301.20	-78.16	3269759.09	1331237.88	38°44'20.339"N	104°33'15.268"W
Facility Reference Pt			3269840.37	1330937.52	38°44'17.362"N	104°33'14.281"W
Field Reference Pt			3270660.16	1360754.62	38°49'12.000"N	104°33'00.000"W

WELLPATH DATUM			
Calculation method	Minimum curvature	Rig on Slot #01 Olive Oyl State N 44-16 1V (660' FSL & 660' FEL) (RT) to Facility Vertical Datum	6023.00ft
Horizontal Reference Pt	Slot	Rig on Slot #01 Olive Oyl State N 44-16 1V (660' FSL & 660' FEL) (RT) to Mean Sea Level	6023.00ft
Vertical Reference Pt	Rig on Slot #01 Olive Oyl State N 44-16 1V (660' FSL & 660' FEL) (RT)	Facility Vertical Datum to Mud Line (Facility)	0.00ft
MD Reference Pt	Rig on Slot #01 Olive Oyl State N 44-16 1V (660' FSL & 660' FEL) (RT)	Section Origin	N 0.00, E 0.00 ft
Field Vertical Reference	Mean Sea Level	Section Azimuth	242.97°



## Actual Wellpath Report

Olive Oyl State N 44-16 1V Original AWP

Page 2 of 3



REFERENCE WELLPATH IDENTIFICATION			
Operator	ULTRA RESOURCES, INC	Slot	Slot #03 Olive Oyl State N 44-16 1V (659' FSL & 658' FEL)
Area	PA	Well	Olive Oyl State N 44-16 1V
Field	EL Paso Country (Nad 83)	Wellbore	Olive Oyl State N 44-16 1V AWB
Facility	Sec.16-T15S-R64W		

WELLPATH DATA (43 stations) † = interpolated/extrapolated station										
MD [ft]	Inclination [°]	Azimuth [°]	TVD [ft]	Vert Sect [ft]	North [ft]	East [ft]	Latitude	Longitude	DLS [°/100ft]	Comments
0.00†	0.000	339.300	0.00	0.00	0.00	0.00	38°44'20.339"N	104°33'15.268"W	0.00	
18.00	0.000	339.300	18.00	0.00	0.00	0.00	38°44'20.339"N	104°33'15.268"W	0.00	
200.00	0.030	339.300	200.00	-0.01	0.04	-0.02	38°44'20.339"N	104°33'15.268"W	0.02	
300.00	0.190	181.940	300.00	0.07	-0.10	-0.03	38°44'20.338"N	104°33'15.268"W	0.22	
400.00	0.400	209.150	400.00	0.44	-0.57	-0.21	38°44'20.333"N	104°33'15.270"W	0.25	
500.00	0.600	222.240	499.99	1.22	-1.26	-0.73	38°44'20.326"N	104°33'15.277"W	0.23	
600.00	0.960	225.800	599.99	2.51	-2.23	-1.68	38°44'20.317"N	104°33'15.289"W	0.36	
700.00	1.200	237.160	699.97	4.35	-3.38	-3.16	38°44'20.305"N	104°33'15.308"W	0.32	
800.00	1.320	242.750	799.94	6.55	-4.48	-5.07	38°44'20.295"N	104°33'15.332"W	0.17	
900.00	1.740	241.500	899.91	9.22	-5.73	-7.42	38°44'20.282"N	104°33'15.361"W	0.42	
1000.00	2.260	246.120	999.85	12.70	-7.25	-10.56	38°44'20.267"N	104°33'15.401"W	0.54	
1100.00	2.420	247.080	1099.76	16.78	-8.87	-14.31	38°44'20.251"N	104°33'15.448"W	0.16	
1200.00	2.740	247.020	1199.66	21.27	-10.63	-18.45	38°44'20.234"N	104°33'15.500"W	0.32	
1300.00	2.570	245.410	1299.55	25.89	-12.49	-22.69	38°44'20.215"N	104°33'15.554"W	0.19	
1400.00	2.400	246.950	1399.46	30.22	-14.25	-26.66	38°44'20.198"N	104°33'15.604"W	0.18	
1500.00	2.500	245.950	1499.37	34.49	-15.96	-30.58	38°44'20.181"N	104°33'15.653"W	0.11	
1600.00	2.380	245.260	1599.28	38.74	-17.71	-34.45	38°44'20.164"N	104°33'15.702"W	0.12	
1700.00	2.180	253.370	1699.20	42.69	-19.13	-38.16	38°44'20.150"N	104°33'15.749"W	0.38	
1800.00	2.270	253.700	1799.12	46.50	-20.23	-41.89	38°44'20.139"N	104°33'15.796"W	0.09	
1900.00	2.340	256.770	1899.04	50.43	-21.25	-45.77	38°44'20.129"N	104°33'15.845"W	0.14	
2000.00	2.380	254.860	1998.96	54.45	-22.26	-49.77	38°44'20.119"N	104°33'15.896"W	0.09	
2100.00	2.190	258.880	2098.88	58.31	-23.17	-53.64	38°44'20.110"N	104°33'15.945"W	0.25	
2200.00	2.420	255.540	2198.80	62.21	-24.07	-57.56	38°44'20.101"N	104°33'15.994"W	0.27	
2300.00	2.460	261.300	2298.71	66.31	-24.92	-61.73	38°44'20.092"N	104°33'16.047"W	0.25	
2400.00	2.690	264.490	2398.61	70.53	-25.47	-66.19	38°44'20.087"N	104°33'16.103"W	0.27	
2500.00	2.650	264.720	2498.50	74.86	-25.91	-70.82	38°44'20.083"N	104°33'16.161"W	0.04	
2600.00	2.960	262.460	2598.38	79.44	-26.46	-75.69	38°44'20.077"N	104°33'16.223"W	0.33	
2700.00	3.130	258.430	2698.24	84.51	-27.34	-80.92	38°44'20.069"N	104°33'16.289"W	0.27	
2800.00	3.410	257.000	2798.07	90.02	-28.56	-86.49	38°44'20.056"N	104°33'16.359"W	0.29	
2900.00	3.630	255.190	2897.88	96.00	-30.04	-92.45	38°44'20.042"N	104°33'16.434"W	0.25	



## Actual Wellpath Report

Olive Oyl State N 44-16 1V Original AWP

Page 3 of 3



REFERENCE WELLPATH IDENTIFICATION			
Operator	ULTRA RESOURCES, INC	Slot	Slot #03 Olive Oyl State N 44-16 1V (659' FSL & 658' FEL)
Area	PA	Well	Olive Oyl State N 44-16 1V
Field	EL Paso Country (Nad 83)	Wellbore	Olive Oyl State N 44-16 1V AWB
Facility	Sec.16-T15S-R64W		

WELLPATH DATA (43 stations)										
MD [ft]	Inclination [°]	Azimuth [°]	TVD [ft]	Vert Sect [ft]	North [ft]	East [ft]	Latitude	Longitude	DLS [°/100ft]	Comments
3000.00	3.390	262.780	2997.70	101.88	-31.22	-98.44	38°44'20.030"N	104°33'16.510"W	0.52	
3100.00	3.390	272.510	3097.52	107.23	-31.46	-104.33	38°44'20.028"N	104°33'16.584"W	0.57	
3200.00	4.110	268.060	3197.31	113.05	-31.45	-110.87	38°44'20.028"N	104°33'16.667"W	0.78	
3300.00	4.850	256.000	3297.00	120.41	-32.60	-118.55	38°44'20.017"N	104°33'16.764"W	1.19	
3400.00	5.320	247.990	3396.61	129.15	-35.36	-126.95	38°44'19.989"N	104°33'16.870"W	0.85	
3500.00	5.630	240.650	3496.16	138.67	-39.50	-135.52	38°44'19.948"N	104°33'16.978"W	0.77	
3600.00	5.360	237.130	3595.70	148.22	-44.44	-143.72	38°44'19.900"N	104°33'17.081"W	0.43	
3700.00	5.130	232.550	3695.28	157.26	-49.69	-151.19	38°44'19.848"N	104°33'17.176"W	0.48	
3800.00	4.990	231.550	3794.89	165.92	-55.12	-158.15	38°44'19.794"N	104°33'17.264"W	0.17	
3900.00	4.680	228.870	3894.53	174.14	-60.50	-164.63	38°44'19.741"N	104°33'17.345"W	0.38	
4000.00	4.430	231.690	3994.22	181.89	-65.58	-170.73	38°44'19.691"N	104°33'17.422"W	0.34	
4100.00	4.180	233.640	4093.94	189.27	-70.14	-176.70	38°44'19.646"N	104°33'17.498"W	0.29	End of Gyro Surveys
5610.00	4.180	233.640	5599.92	297.88	-135.39	-265.33	38°44'19.001"N	104°33'18.616"W	0.00	Projection to Bit

WELLPATH COMPOSITION Ref Wellbore: Olive Oyl State N 44-16 1V AWB Ref Wellpath: Olive Oyl State N 44-16 1V Original AWP				
Start MD [ft]	End MD [ft]	Positional Uncertainty Model	Log Name/Comment	Wellbore
18.00	4100.00	Gyrodata standard - Continuous gyro	Gyro	Olive Oyl State N 44-16 1V AWB
4100.00	5610.00	Blind Drilling (std)	Projection to bit	Olive Oyl State N 44-16 1V AWB