

Axia Energy

Project: Moffat County, CO
Site: SEC 7-T7N-R89W
Well: Bulldog #7-14H-789
Wellbore: Hz
Design: Plan #1

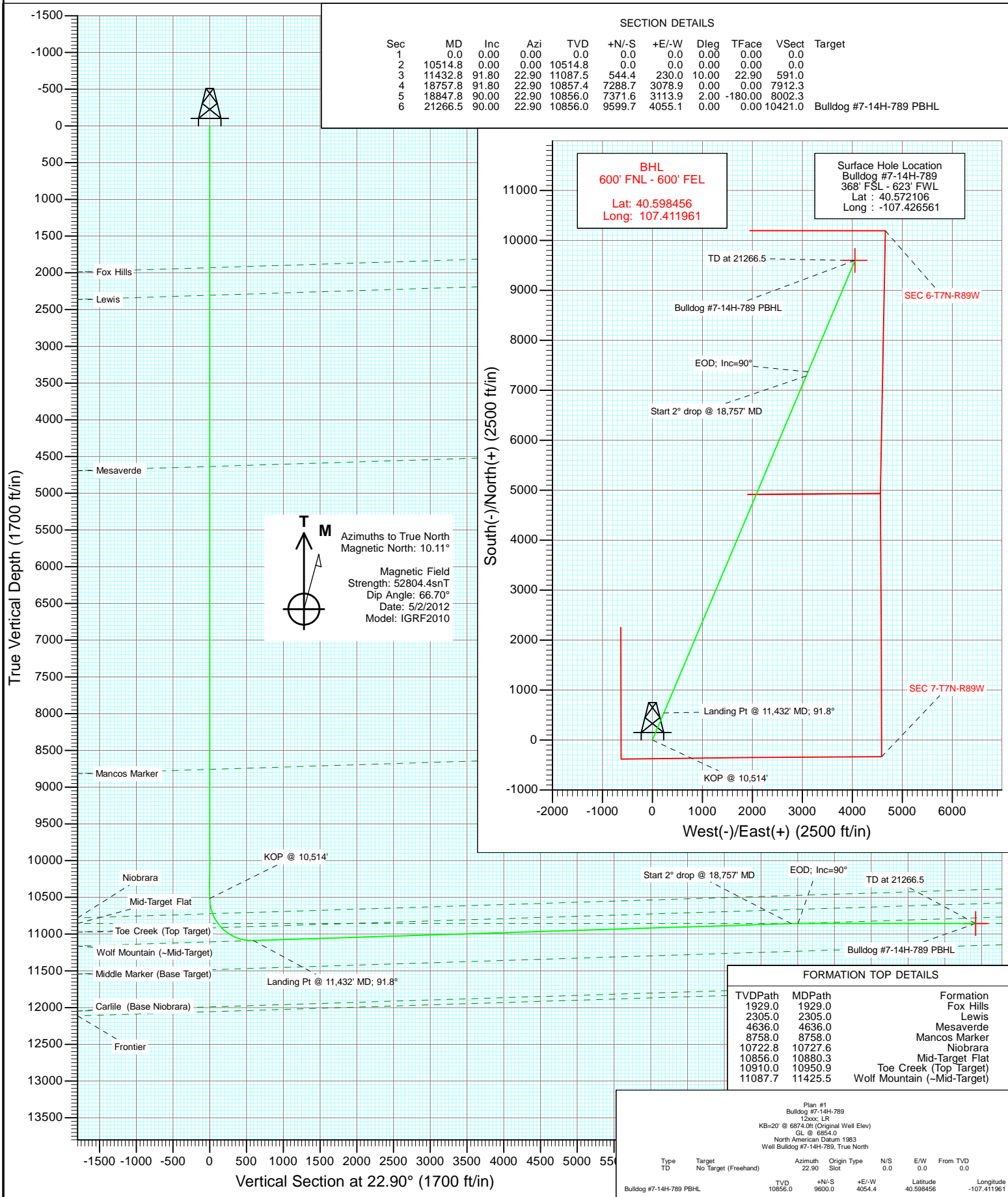

Planning Report

Database:	USA EDM 5000 Multi Users DB	Local Co-ordinate Reference:	Well Bulldog #7-14H-789
Company:	Axia Energy	TVD Reference:	KB=20' @ 6874.0ft (Original Well Elev)
Project:	Moffat County, CO	MD Reference:	KB=20' @ 6874.0ft (Original Well Elev)
Site:	SEC 7-T7N-R89W	North Reference:	True
Well:	Bulldog #7-14H-789	Survey Calculation Method:	Minimum Curvature
Wellbore:	Hz		
Design:	Plan #1		

Project	Moffat County, CO		
Map System:	US State Plane 1983	System Datum:	Mean Sea Level
Geo Datum:	North American Datum 1983		
Map Zone:	Colorado Northern Zone		

Site		SEC 7-T7N-R89W			
Site Position:		Northing:	1,457,076.00 ft	Latitude:	40.572106
From:	Lat/Long	Easting:	2,464,842.05 ft	Longitude:	-107.426561
Position Uncertainty:	0.0 ft	Slot Radius:	13.200 in	Grid Convergence:	-1.24 °

Well	Bulldog #7-14H-789					
Well Position	+N/-S	0.0 ft	Northing:	1,457,075.99 ft	Latitude:	40.572106
	+E/-W	0.0 ft	Easting:	2,464,842.05 ft	Longitude:	-107.426561
Position Uncertainty		0.0 ft	Wellhead Elevation:	ft	Ground Level:	6,854.0 ft

Wellbore	Hz				
Magnetics	Model Name	Sample Date	Declination (°)	Dip Angle (°)	Field Strength (nT)
	IGRF2010	5/2/2012	10.11	66.70	52,804

Design	Plan #1				
Audit Notes:					
Version:	Phase:	PLAN		Tie On Depth:	0.0
Vertical Section:	Depth From (TVD) (ft)	+N/-S (ft)	+E/-W (ft)	Direction (°)	
	0.0	0.0	0.0	22.90	

Plan Sections										
Measured Depth (ft)	Inclination (°)	Azimuth (°)	Vertical Depth (ft)	+N/-S (ft)	+E/-W (ft)	Dogleg Rate (°/100ft)	Build Rate (°/100ft)	Turn Rate (°/100ft)	TFO (°)	Target
0.0	0.00	0.00	0.0	0.0	0.0	0.00	0.00	0.00	0.00	
10,514.8	0.00	0.00	10,514.8	0.0	0.0	0.00	0.00	0.00	0.00	
11,432.8	91.80	22.90	11,087.5	544.4	230.0	10.00	10.00	0.00	22.90	
18,757.8	91.80	22.90	10,857.4	7,288.7	3,078.9	0.00	0.00	0.00	0.00	
18,847.8	90.00	22.90	10,856.0	7,371.6	3,113.9	2.00	-2.00	0.00	-180.00	
21,266.5	90.00	22.90	10,856.0	9,599.7	4,055.1	0.00	0.00	0.00	0.00	Bulldog #7-14H-789 F

Planning Report

Database:	USA EDM 5000 Multi Users DB	Local Co-ordinate Reference:	Well Bulldog #7-14H-789
Company:	Axia Energy	TVD Reference:	KB=20' @ 6874.0ft (Original Well Elev)
Project:	Moffat County, CO	MD Reference:	KB=20' @ 6874.0ft (Original Well Elev)
Site:	SEC 7-T7N-R89W	North Reference:	True
Well:	Bulldog #7-14H-789	Survey Calculation Method:	Minimum Curvature
Wellbore:	Hz		
Design:	Plan #1		

Planned Survey									
Measured Depth (ft)	Inclination (°)	Azimuth (°)	Vertical Depth (ft)	+N/-S (ft)	+E/-W (ft)	Vertical Section (ft)	Dogleg Rate (°/100ft)	Build Rate (°/100ft)	Comments / Formations
0.0	0.00	0.00	0.0	0.0	0.0	0.0	0.00	0.00	
100.0	0.00	0.00	100.0	0.0	0.0	0.0	0.00	0.00	
200.0	0.00	0.00	200.0	0.0	0.0	0.0	0.00	0.00	
300.0	0.00	0.00	300.0	0.0	0.0	0.0	0.00	0.00	
400.0	0.00	0.00	400.0	0.0	0.0	0.0	0.00	0.00	
500.0	0.00	0.00	500.0	0.0	0.0	0.0	0.00	0.00	
600.0	0.00	0.00	600.0	0.0	0.0	0.0	0.00	0.00	
700.0	0.00	0.00	700.0	0.0	0.0	0.0	0.00	0.00	
800.0	0.00	0.00	800.0	0.0	0.0	0.0	0.00	0.00	
900.0	0.00	0.00	900.0	0.0	0.0	0.0	0.00	0.00	
1,000.0	0.00	0.00	1,000.0	0.0	0.0	0.0	0.00	0.00	
1,100.0	0.00	0.00	1,100.0	0.0	0.0	0.0	0.00	0.00	
1,200.0	0.00	0.00	1,200.0	0.0	0.0	0.0	0.00	0.00	
1,300.0	0.00	0.00	1,300.0	0.0	0.0	0.0	0.00	0.00	
1,400.0	0.00	0.00	1,400.0	0.0	0.0	0.0	0.00	0.00	
1,500.0	0.00	0.00	1,500.0	0.0	0.0	0.0	0.00	0.00	
1,600.0	0.00	0.00	1,600.0	0.0	0.0	0.0	0.00	0.00	
1,700.0	0.00	0.00	1,700.0	0.0	0.0	0.0	0.00	0.00	
1,800.0	0.00	0.00	1,800.0	0.0	0.0	0.0	0.00	0.00	
1,900.0	0.00	0.00	1,900.0	0.0	0.0	0.0	0.00	0.00	
1,929.0	0.00	0.00	1,929.0	0.0	0.0	0.0	0.00	0.00	Fox Hills
2,000.0	0.00	0.00	2,000.0	0.0	0.0	0.0	0.00	0.00	
2,100.0	0.00	0.00	2,100.0	0.0	0.0	0.0	0.00	0.00	
2,200.0	0.00	0.00	2,200.0	0.0	0.0	0.0	0.00	0.00	
2,300.0	0.00	0.00	2,300.0	0.0	0.0	0.0	0.00	0.00	
2,305.0	0.00	0.00	2,305.0	0.0	0.0	0.0	0.00	0.00	Lewis
2,400.0	0.00	0.00	2,400.0	0.0	0.0	0.0	0.00	0.00	
2,500.0	0.00	0.00	2,500.0	0.0	0.0	0.0	0.00	0.00	
2,600.0	0.00	0.00	2,600.0	0.0	0.0	0.0	0.00	0.00	
2,700.0	0.00	0.00	2,700.0	0.0	0.0	0.0	0.00	0.00	
2,800.0	0.00	0.00	2,800.0	0.0	0.0	0.0	0.00	0.00	
2,900.0	0.00	0.00	2,900.0	0.0	0.0	0.0	0.00	0.00	
3,000.0	0.00	0.00	3,000.0	0.0	0.0	0.0	0.00	0.00	
3,100.0	0.00	0.00	3,100.0	0.0	0.0	0.0	0.00	0.00	
3,200.0	0.00	0.00	3,200.0	0.0	0.0	0.0	0.00	0.00	
3,300.0	0.00	0.00	3,300.0	0.0	0.0	0.0	0.00	0.00	
3,400.0	0.00	0.00	3,400.0	0.0	0.0	0.0	0.00	0.00	
3,500.0	0.00	0.00	3,500.0	0.0	0.0	0.0	0.00	0.00	
3,600.0	0.00	0.00	3,600.0	0.0	0.0	0.0	0.00	0.00	
3,700.0	0.00	0.00	3,700.0	0.0	0.0	0.0	0.00	0.00	
3,800.0	0.00	0.00	3,800.0	0.0	0.0	0.0	0.00	0.00	
3,900.0	0.00	0.00	3,900.0	0.0	0.0	0.0	0.00	0.00	
4,000.0	0.00	0.00	4,000.0	0.0	0.0	0.0	0.00	0.00	
4,100.0	0.00	0.00	4,100.0	0.0	0.0	0.0	0.00	0.00	
4,200.0	0.00	0.00	4,200.0	0.0	0.0	0.0	0.00	0.00	
4,300.0	0.00	0.00	4,300.0	0.0	0.0	0.0	0.00	0.00	
4,400.0	0.00	0.00	4,400.0	0.0	0.0	0.0	0.00	0.00	
4,500.0	0.00	0.00	4,500.0	0.0	0.0	0.0	0.00	0.00	
4,600.0	0.00	0.00	4,600.0	0.0	0.0	0.0	0.00	0.00	
4,636.0	0.00	0.00	4,636.0	0.0	0.0	0.0	0.00	0.00	Mesaverde
4,700.0	0.00	0.00	4,700.0	0.0	0.0	0.0	0.00	0.00	
4,800.0	0.00	0.00	4,800.0	0.0	0.0	0.0	0.00	0.00	

Planning Report

Database:	USA EDM 5000 Multi Users DB	Local Co-ordinate Reference:	Well Bulldog #7-14H-789
Company:	Axia Energy	TVD Reference:	KB=20' @ 6874.0ft (Original Well Elev)
Project:	Moffat County, CO	MD Reference:	KB=20' @ 6874.0ft (Original Well Elev)
Site:	SEC 7-T7N-R89W	North Reference:	True
Well:	Bulldog #7-14H-789	Survey Calculation Method:	Minimum Curvature
Wellbore:	Hz		
Design:	Plan #1		

Planned Survey									
Measured Depth (ft)	Inclination (°)	Azimuth (°)	Vertical Depth (ft)	+N/-S (ft)	+E/-W (ft)	Vertical Section (ft)	Dogleg Rate (°/100ft)	Build Rate (°/100ft)	Comments / Formations
4,900.0	0.00	0.00	4,900.0	0.0	0.0	0.0	0.00	0.00	
5,000.0	0.00	0.00	5,000.0	0.0	0.0	0.0	0.00	0.00	
5,100.0	0.00	0.00	5,100.0	0.0	0.0	0.0	0.00	0.00	
5,200.0	0.00	0.00	5,200.0	0.0	0.0	0.0	0.00	0.00	
5,300.0	0.00	0.00	5,300.0	0.0	0.0	0.0	0.00	0.00	
5,400.0	0.00	0.00	5,400.0	0.0	0.0	0.0	0.00	0.00	
5,500.0	0.00	0.00	5,500.0	0.0	0.0	0.0	0.00	0.00	
5,600.0	0.00	0.00	5,600.0	0.0	0.0	0.0	0.00	0.00	
5,700.0	0.00	0.00	5,700.0	0.0	0.0	0.0	0.00	0.00	
5,800.0	0.00	0.00	5,800.0	0.0	0.0	0.0	0.00	0.00	
5,900.0	0.00	0.00	5,900.0	0.0	0.0	0.0	0.00	0.00	
6,000.0	0.00	0.00	6,000.0	0.0	0.0	0.0	0.00	0.00	
6,100.0	0.00	0.00	6,100.0	0.0	0.0	0.0	0.00	0.00	
6,200.0	0.00	0.00	6,200.0	0.0	0.0	0.0	0.00	0.00	
6,300.0	0.00	0.00	6,300.0	0.0	0.0	0.0	0.00	0.00	
6,400.0	0.00	0.00	6,400.0	0.0	0.0	0.0	0.00	0.00	
6,500.0	0.00	0.00	6,500.0	0.0	0.0	0.0	0.00	0.00	
6,600.0	0.00	0.00	6,600.0	0.0	0.0	0.0	0.00	0.00	
6,700.0	0.00	0.00	6,700.0	0.0	0.0	0.0	0.00	0.00	
6,800.0	0.00	0.00	6,800.0	0.0	0.0	0.0	0.00	0.00	
6,900.0	0.00	0.00	6,900.0	0.0	0.0	0.0	0.00	0.00	
7,000.0	0.00	0.00	7,000.0	0.0	0.0	0.0	0.00	0.00	
7,100.0	0.00	0.00	7,100.0	0.0	0.0	0.0	0.00	0.00	
7,200.0	0.00	0.00	7,200.0	0.0	0.0	0.0	0.00	0.00	
7,300.0	0.00	0.00	7,300.0	0.0	0.0	0.0	0.00	0.00	
7,400.0	0.00	0.00	7,400.0	0.0	0.0	0.0	0.00	0.00	
7,500.0	0.00	0.00	7,500.0	0.0	0.0	0.0	0.00	0.00	
7,600.0	0.00	0.00	7,600.0	0.0	0.0	0.0	0.00	0.00	
7,700.0	0.00	0.00	7,700.0	0.0	0.0	0.0	0.00	0.00	
7,800.0	0.00	0.00	7,800.0	0.0	0.0	0.0	0.00	0.00	
7,900.0	0.00	0.00	7,900.0	0.0	0.0	0.0	0.00	0.00	
8,000.0	0.00	0.00	8,000.0	0.0	0.0	0.0	0.00	0.00	
8,100.0	0.00	0.00	8,100.0	0.0	0.0	0.0	0.00	0.00	
8,200.0	0.00	0.00	8,200.0	0.0	0.0	0.0	0.00	0.00	
8,300.0	0.00	0.00	8,300.0	0.0	0.0	0.0	0.00	0.00	
8,400.0	0.00	0.00	8,400.0	0.0	0.0	0.0	0.00	0.00	
8,500.0	0.00	0.00	8,500.0	0.0	0.0	0.0	0.00	0.00	
8,600.0	0.00	0.00	8,600.0	0.0	0.0	0.0	0.00	0.00	
8,700.0	0.00	0.00	8,700.0	0.0	0.0	0.0	0.00	0.00	
8,758.0	0.00	0.00	8,758.0	0.0	0.0	0.0	0.00	0.00	Mancos Marker
8,800.0	0.00	0.00	8,800.0	0.0	0.0	0.0	0.00	0.00	
8,900.0	0.00	0.00	8,900.0	0.0	0.0	0.0	0.00	0.00	
9,000.0	0.00	0.00	9,000.0	0.0	0.0	0.0	0.00	0.00	
9,100.0	0.00	0.00	9,100.0	0.0	0.0	0.0	0.00	0.00	
9,200.0	0.00	0.00	9,200.0	0.0	0.0	0.0	0.00	0.00	
9,300.0	0.00	0.00	9,300.0	0.0	0.0	0.0	0.00	0.00	
9,400.0	0.00	0.00	9,400.0	0.0	0.0	0.0	0.00	0.00	
9,500.0	0.00	0.00	9,500.0	0.0	0.0	0.0	0.00	0.00	
9,600.0	0.00	0.00	9,600.0	0.0	0.0	0.0	0.00	0.00	
9,700.0	0.00	0.00	9,700.0	0.0	0.0	0.0	0.00	0.00	
9,800.0	0.00	0.00	9,800.0	0.0	0.0	0.0	0.00	0.00	
9,900.0	0.00	0.00	9,900.0	0.0	0.0	0.0	0.00	0.00	

Planning Report

Database:	USA EDM 5000 Multi Users DB	Local Co-ordinate Reference:	Well Bulldog #7-14H-789
Company:	Axia Energy	TVD Reference:	KB=20' @ 6874.0ft (Original Well Elev)
Project:	Moffat County, CO	MD Reference:	KB=20' @ 6874.0ft (Original Well Elev)
Site:	SEC 7-T7N-R89W	North Reference:	True
Well:	Bulldog #7-14H-789	Survey Calculation Method:	Minimum Curvature
Wellbore:	Hz		
Design:	Plan #1		

Planned Survey

Measured Depth (ft)	Inclination (°)	Azimuth (°)	Vertical Depth (ft)	+N/-S (ft)	+E/-W (ft)	Vertical Section (ft)	Dogleg Rate (°/100ft)	Build Rate (°/100ft)	Comments / Formations
10,000.0	0.00	0.00	10,000.0	0.0	0.0	0.0	0.00	0.00	
10,100.0	0.00	0.00	10,100.0	0.0	0.0	0.0	0.00	0.00	
10,200.0	0.00	0.00	10,200.0	0.0	0.0	0.0	0.00	0.00	
10,300.0	0.00	0.00	10,300.0	0.0	0.0	0.0	0.00	0.00	
10,400.0	0.00	0.00	10,400.0	0.0	0.0	0.0	0.00	0.00	
10,500.0	0.00	0.00	10,500.0	0.0	0.0	0.0	0.00	0.00	
10,514.8	0.00	0.00	10,514.8	0.0	0.0	0.0	0.00	0.00	KOP @ 10,514'
10,600.0	8.52	22.90	10,599.7	5.8	2.5	6.3	10.00	10.00	
10,700.0	18.52	22.90	10,696.8	27.3	11.5	29.7	10.00	10.00	
10,727.6	21.28	22.90	10,722.8	36.0	15.2	39.1	10.00	10.00	Niobrara
10,800.0	28.52	22.90	10,788.4	64.0	27.1	69.5	10.00	10.00	
10,880.3	36.55	22.90	10,856.0	103.8	43.8	112.7	10.00	10.00	Mid-Target Flat
10,900.0	38.52	22.90	10,871.6	114.9	48.5	124.7	10.00	10.00	
10,950.9	43.61	22.90	10,910.0	145.7	61.5	158.1	10.00	10.00	Toe Creek (Top Target)
11,000.0	48.52	22.90	10,944.1	178.2	75.3	193.5	10.00	10.00	
11,100.0	58.52	22.90	11,003.4	252.2	106.5	273.8	10.00	10.00	
11,200.0	68.52	22.90	11,048.0	334.5	141.3	363.2	10.00	10.00	
11,300.0	78.52	22.90	11,076.3	422.8	178.6	458.9	10.00	10.00	
11,400.0	88.52	22.90	11,087.6	514.2	217.2	558.2	10.00	10.00	
11,425.5	91.07	22.90	11,087.7	537.7	227.1	583.7	10.00	10.00	Wolf Mountain (~Mid-Target)
11,432.8	91.80	22.90	11,087.5	544.4	230.0	591.0	10.00	10.00	Landing Pt @ 11,432' MD; 91.8°
11,500.0	91.80	22.90	11,085.4	606.3	256.1	658.1	0.00	0.00	
11,600.0	91.80	22.90	11,082.2	698.3	295.0	758.1	0.00	0.00	
11,700.0	91.80	22.90	11,079.1	790.4	333.9	858.0	0.00	0.00	
11,800.0	91.80	22.90	11,075.9	882.5	372.8	958.0	0.00	0.00	
11,900.0	91.80	22.90	11,072.8	974.5	411.7	1,057.9	0.00	0.00	
12,000.0	91.80	22.90	11,069.7	1,066.6	450.6	1,157.9	0.00	0.00	
12,100.0	91.80	22.90	11,066.5	1,158.7	489.5	1,257.8	0.00	0.00	
12,200.0	91.80	22.90	11,063.4	1,250.8	528.3	1,357.8	0.00	0.00	
12,300.0	91.80	22.90	11,060.2	1,342.8	567.2	1,457.7	0.00	0.00	
12,400.0	91.80	22.90	11,057.1	1,434.9	606.1	1,557.7	0.00	0.00	
12,500.0	91.80	22.90	11,054.0	1,527.0	645.0	1,657.6	0.00	0.00	
12,600.0	91.80	22.90	11,050.8	1,619.1	683.9	1,757.6	0.00	0.00	
12,700.0	91.80	22.90	11,047.7	1,711.1	722.8	1,857.5	0.00	0.00	
12,800.0	91.80	22.90	11,044.5	1,803.2	761.7	1,957.5	0.00	0.00	
12,900.0	91.80	22.90	11,041.4	1,895.3	800.6	2,057.4	0.00	0.00	
13,000.0	91.80	22.90	11,038.2	1,987.3	839.5	2,157.4	0.00	0.00	
13,100.0	91.80	22.90	11,035.1	2,079.4	878.4	2,257.3	0.00	0.00	
13,200.0	91.80	22.90	11,032.0	2,171.5	917.3	2,357.3	0.00	0.00	
13,300.0	91.80	22.90	11,028.8	2,263.6	956.2	2,457.2	0.00	0.00	
13,400.0	91.80	22.90	11,025.7	2,355.6	995.1	2,557.2	0.00	0.00	
13,500.0	91.80	22.90	11,022.5	2,447.7	1,034.0	2,657.1	0.00	0.00	
13,600.0	91.80	22.90	11,019.4	2,539.8	1,072.8	2,757.1	0.00	0.00	
13,700.0	91.80	22.90	11,016.3	2,631.9	1,111.7	2,857.0	0.00	0.00	
13,800.0	91.80	22.90	11,013.1	2,723.9	1,150.6	2,957.0	0.00	0.00	
13,900.0	91.80	22.90	11,010.0	2,816.0	1,189.5	3,056.9	0.00	0.00	
14,000.0	91.80	22.90	11,006.8	2,908.1	1,228.4	3,156.9	0.00	0.00	
14,100.0	91.80	22.90	11,003.7	3,000.2	1,267.3	3,256.8	0.00	0.00	
14,200.0	91.80	22.90	11,000.6	3,092.2	1,306.2	3,356.8	0.00	0.00	
14,300.0	91.80	22.90	10,997.4	3,184.3	1,345.1	3,456.7	0.00	0.00	
14,400.0	91.80	22.90	10,994.3	3,276.4	1,384.0	3,556.7	0.00	0.00	
14,500.0	91.80	22.90	10,991.1	3,368.4	1,422.9	3,656.6	0.00	0.00	

Planning Report

Database:	USA EDM 5000 Multi Users DB	Local Co-ordinate Reference:	Well Bulldog #7-14H-789
Company:	Axia Energy	TVD Reference:	KB=20' @ 6874.0ft (Original Well Elev)
Project:	Moffat County, CO	MD Reference:	KB=20' @ 6874.0ft (Original Well Elev)
Site:	SEC 7-T7N-R89W	North Reference:	True
Well:	Bulldog #7-14H-789	Survey Calculation Method:	Minimum Curvature
Wellbore:	Hz		
Design:	Plan #1		

Planned Survey									
Measured Depth (ft)	Inclination (°)	Azimuth (°)	Vertical Depth (ft)	+N/-S (ft)	+E/-W (ft)	Vertical Section (ft)	Dogleg Rate (°/100ft)	Build Rate (°/100ft)	Comments / Formations
14,600.0	91.80	22.90	10,988.0	3,460.5	1,461.8	3,756.6	0.00	0.00	
14,700.0	91.80	22.90	10,984.8	3,552.6	1,500.7	3,856.5	0.00	0.00	
14,800.0	91.80	22.90	10,981.7	3,644.7	1,539.6	3,956.5	0.00	0.00	
14,900.0	91.80	22.90	10,978.6	3,736.7	1,578.5	4,056.4	0.00	0.00	
15,000.0	91.80	22.90	10,975.4	3,828.8	1,617.4	4,156.4	0.00	0.00	
15,100.0	91.80	22.90	10,972.3	3,920.9	1,656.2	4,256.3	0.00	0.00	
15,200.0	91.80	22.90	10,969.1	4,013.0	1,695.1	4,356.3	0.00	0.00	
15,300.0	91.80	22.90	10,966.0	4,105.0	1,734.0	4,456.2	0.00	0.00	
15,400.0	91.80	22.90	10,962.9	4,197.1	1,772.9	4,556.2	0.00	0.00	
15,500.0	91.80	22.90	10,959.7	4,289.2	1,811.8	4,656.1	0.00	0.00	
15,600.0	91.80	22.90	10,956.6	4,381.2	1,850.7	4,756.1	0.00	0.00	
15,700.0	91.80	22.90	10,953.4	4,473.3	1,889.6	4,856.0	0.00	0.00	
15,800.0	91.80	22.90	10,950.3	4,565.4	1,928.5	4,956.0	0.00	0.00	
15,900.0	91.80	22.90	10,947.2	4,657.5	1,967.4	5,056.0	0.00	0.00	
16,000.0	91.80	22.90	10,944.0	4,749.5	2,006.3	5,155.9	0.00	0.00	
16,100.0	91.80	22.90	10,940.9	4,841.6	2,045.2	5,255.9	0.00	0.00	
16,200.0	91.80	22.90	10,937.7	4,933.7	2,084.1	5,355.8	0.00	0.00	
16,300.0	91.80	22.90	10,934.6	5,025.8	2,123.0	5,455.8	0.00	0.00	
16,400.0	91.80	22.90	10,931.5	5,117.8	2,161.9	5,555.7	0.00	0.00	
16,500.0	91.80	22.90	10,928.3	5,209.9	2,200.8	5,655.7	0.00	0.00	
16,600.0	91.80	22.90	10,925.2	5,302.0	2,239.6	5,755.6	0.00	0.00	
16,700.0	91.80	22.90	10,922.0	5,394.1	2,278.5	5,855.6	0.00	0.00	
16,800.0	91.80	22.90	10,918.9	5,486.1	2,317.4	5,955.5	0.00	0.00	
16,900.0	91.80	22.90	10,915.7	5,578.2	2,356.3	6,055.5	0.00	0.00	
17,000.0	91.80	22.90	10,912.6	5,670.3	2,395.2	6,155.4	0.00	0.00	
17,100.0	91.80	22.90	10,909.5	5,762.3	2,434.1	6,255.4	0.00	0.00	
17,200.0	91.80	22.90	10,906.3	5,854.4	2,473.0	6,355.3	0.00	0.00	
17,300.0	91.80	22.90	10,903.2	5,946.5	2,511.9	6,455.3	0.00	0.00	
17,400.0	91.80	22.90	10,900.0	6,038.6	2,550.8	6,555.2	0.00	0.00	
17,500.0	91.80	22.90	10,896.9	6,130.6	2,589.7	6,655.2	0.00	0.00	
17,600.0	91.80	22.90	10,893.8	6,222.7	2,628.6	6,755.1	0.00	0.00	
17,700.0	91.80	22.90	10,890.6	6,314.8	2,667.5	6,855.1	0.00	0.00	
17,800.0	91.80	22.90	10,887.5	6,406.9	2,706.4	6,955.0	0.00	0.00	
17,900.0	91.80	22.90	10,884.3	6,498.9	2,745.3	7,055.0	0.00	0.00	
18,000.0	91.80	22.90	10,881.2	6,591.0	2,784.1	7,154.9	0.00	0.00	
18,100.0	91.80	22.90	10,878.1	6,683.1	2,823.0	7,254.9	0.00	0.00	
18,200.0	91.80	22.90	10,874.9	6,775.1	2,861.9	7,354.8	0.00	0.00	
18,300.0	91.80	22.90	10,871.8	6,867.2	2,900.8	7,454.8	0.00	0.00	
18,400.0	91.80	22.90	10,868.6	6,959.3	2,939.7	7,554.7	0.00	0.00	
18,500.0	91.80	22.90	10,865.5	7,051.4	2,978.6	7,654.7	0.00	0.00	
18,600.0	91.80	22.90	10,862.3	7,143.4	3,017.5	7,754.6	0.00	0.00	
18,700.0	91.80	22.90	10,859.2	7,235.5	3,056.4	7,854.6	0.00	0.00	
18,757.8	91.80	22.90	10,857.4	7,288.7	3,078.9	7,912.3	0.00	0.00	Start 2° drop @ 18,757' MD
18,800.0	90.96	22.90	10,856.4	7,327.6	3,095.3	7,954.5	2.00	-2.00	
18,847.8	90.00	22.90	10,856.0	7,371.6	3,113.9	8,002.3	2.00	-2.00	EOD; Inc=90°
18,900.0	90.00	22.90	10,856.0	7,419.7	3,134.2	8,054.5	0.00	0.00	
19,000.0	90.00	22.90	10,856.0	7,511.8	3,173.1	8,154.5	0.00	0.00	
19,100.0	90.00	22.90	10,856.0	7,603.9	3,212.0	8,254.5	0.00	0.00	
19,200.0	90.00	22.90	10,856.0	7,696.1	3,250.9	8,354.5	0.00	0.00	
19,300.0	90.00	22.90	10,856.0	7,788.2	3,289.9	8,454.5	0.00	0.00	
19,400.0	90.00	22.90	10,856.0	7,880.3	3,328.8	8,554.5	0.00	0.00	
19,500.0	90.00	22.90	10,856.0	7,972.4	3,367.7	8,654.5	0.00	0.00	

Planning Report

Database:	USA EDM 5000 Multi Users DB	Local Co-ordinate Reference:	Well Bulldog #7-14H-789
Company:	Axia Energy	TVD Reference:	KB=20' @ 6874.0ft (Original Well Elev)
Project:	Moffat County, CO	MD Reference:	KB=20' @ 6874.0ft (Original Well Elev)
Site:	SEC 7-T7N-R89W	North Reference:	True
Well:	Bulldog #7-14H-789	Survey Calculation Method:	Minimum Curvature
Wellbore:	Hz		
Design:	Plan #1		

Planned Survey									
Measured Depth (ft)	Inclination (°)	Azimuth (°)	Vertical Depth (ft)	+N/-S (ft)	+E/-W (ft)	Vertical Section (ft)	Dogleg Rate (°/100ft)	Build Rate (°/100ft)	Comments / Formations
19,600.0	90.00	22.90	10,856.0	8,064.5	3,406.6	8,754.5	0.00	0.00	
19,700.0	90.00	22.90	10,856.0	8,156.7	3,445.5	8,854.5	0.00	0.00	
19,800.0	90.00	22.90	10,856.0	8,248.8	3,484.4	8,954.5	0.00	0.00	
19,900.0	90.00	22.90	10,856.0	8,340.9	3,523.3	9,054.5	0.00	0.00	
20,000.0	90.00	22.90	10,856.0	8,433.0	3,562.2	9,154.5	0.00	0.00	
20,100.0	90.00	22.90	10,856.0	8,525.1	3,601.2	9,254.5	0.00	0.00	
20,200.0	90.00	22.90	10,856.0	8,617.3	3,640.1	9,354.5	0.00	0.00	
20,300.0	90.00	22.90	10,856.0	8,709.4	3,679.0	9,454.5	0.00	0.00	
20,400.0	90.00	22.90	10,856.0	8,801.5	3,717.9	9,554.5	0.00	0.00	
20,500.0	90.00	22.90	10,856.0	8,893.6	3,756.8	9,654.5	0.00	0.00	
20,600.0	90.00	22.90	10,856.0	8,985.7	3,795.7	9,754.5	0.00	0.00	
20,700.0	90.00	22.90	10,856.0	9,077.8	3,834.6	9,854.5	0.00	0.00	
20,800.0	90.00	22.90	10,856.0	9,170.0	3,873.5	9,954.5	0.00	0.00	
20,900.0	90.00	22.90	10,856.0	9,262.1	3,912.5	10,054.5	0.00	0.00	
21,000.0	90.00	22.90	10,856.0	9,354.2	3,951.4	10,154.5	0.00	0.00	
21,100.0	90.00	22.90	10,856.0	9,446.3	3,990.3	10,254.5	0.00	0.00	
21,200.0	90.00	22.90	10,856.0	9,538.4	4,029.2	10,354.5	0.00	0.00	
21,266.5	90.00	22.90	10,856.0	9,599.7	4,055.1	10,421.0	0.00	0.00	TD at 21266.5 - Bulldog #7-14H-789 PBHL

Targets									
Target Name	Dip Angle (°)	Dip Dir. (°)	TVD (ft)	+N/-S (ft)	+E/-W (ft)	Northing (ft)	Easting (ft)	Latitude	Longitude
Bulldog #7-14H-789 PBI - hit/miss target - Shape - Point	0.00	0.00	10,856.0	9,600.0	4,054.4	1,466,585.67	2,469,104.00	40.598456	-107.411961
- plan misses target center by 0.8ft at 21266.5ft MD (10856.0 TVD, 9599.7 N, 4055.1 E)									

Formations					
Measured Depth (ft)	Vertical Depth (ft)	Name	Lithology	Dip (°)	Dip Direction (°)
1,929.0	1,929.0	Fox Hills		-1.80	22.90
2,305.0	2,305.0	Lewis		-1.80	22.90
4,636.0	4,636.0	Mesaverde		-1.80	22.90
8,758.0	8,758.0	Mancos Marker		-1.80	22.90
10,727.6	10,724.0	Niobrara		-1.80	22.90
10,880.3	10,856.0	Mid-Target Flat		0.00	22.90
10,950.9	10,915.0	Toe Creek (Top Target)		-1.80	22.90
11,425.5	11,106.0	Wolf Mountain (~Mid-Target)		-1.80	22.90

Planning Report

Database:	USA EDM 5000 Multi Users DB	Local Co-ordinate Reference:	Well Bulldog #7-14H-789
Company:	Axia Energy	TVD Reference:	KB=20' @ 6874.0ft (Original Well Elev)
Project:	Moffat County, CO	MD Reference:	KB=20' @ 6874.0ft (Original Well Elev)
Site:	SEC 7-T7N-R89W	North Reference:	True
Well:	Bulldog #7-14H-789	Survey Calculation Method:	Minimum Curvature
Wellbore:	Hz		
Design:	Plan #1		

Plan Annotations

Measured Depth (ft)	Vertical Depth (ft)	Local Coordinates		Comment
		+N/-S (ft)	+E/-W (ft)	
10,514.8	10,514.8	0.0	0.0	KOP @ 10,514'
11,432.8	11,087.5	544.4	230.0	Landing Pt @ 11,432' MD; 91.8°
18,757.8	10,857.4	7,288.7	3,078.9	Start 2° drop @ 18,757' MD
18,847.8	10,856.0	7,371.6	3,113.9	EOD; Inc=90°
21,266.5	10,856.0	9,599.7	4,055.1	TD at 21266.5