

MARATHON OIL COMPANY

Location: COLORADO

Field: WELD COUNTY (NAD 83, GRID NORTH)

Facility: SEC.35-T7N-R62W

Slot: SLOT#01 CROW VALLEY 7-62-35-2H (366'FNL & 1837FWL, SEC.35)

Well: CROW VALLEY 7-62-35-2H

Wellbore: CROW VALLEY 7-62-35-2H pwb



Plot reference wellpath is CROW VALLEY 7-62-35-2H (REV.F.0) PWP	
True vertical depths are referenced to Rig on SLOT#01 CROW VALLEY 7-62-35-2H (366FNL & 1837FWL, SEC.35) (RKB)	Grid System: NAD83 / Lambert Colorado SP, Northern Zone (501), US feet
Measured depths are referenced to Rig on SLOT#01 CROW VALLEY 7-62-35-2H (366FNL & 1837FWL, SEC.35) (RKB)	North Reference: Grid north
Rig on SLOT#01 CROW VALLEY 7-62-35-2H (366FNL & 1837FWL, SEC.35) (RKB) to Mean Sea Level: 4837 feet	Scale: True distance
Mean Sea Level to Mud line (At Slot: SLOT#01 CROW VALLEY 7-62-35-2H (366FNL & 1837FWL, SEC.35): 0 feet	Depths are in feet
Coordinates are in feet referenced to Slot	Created by: cookdamm on 4/18/2012

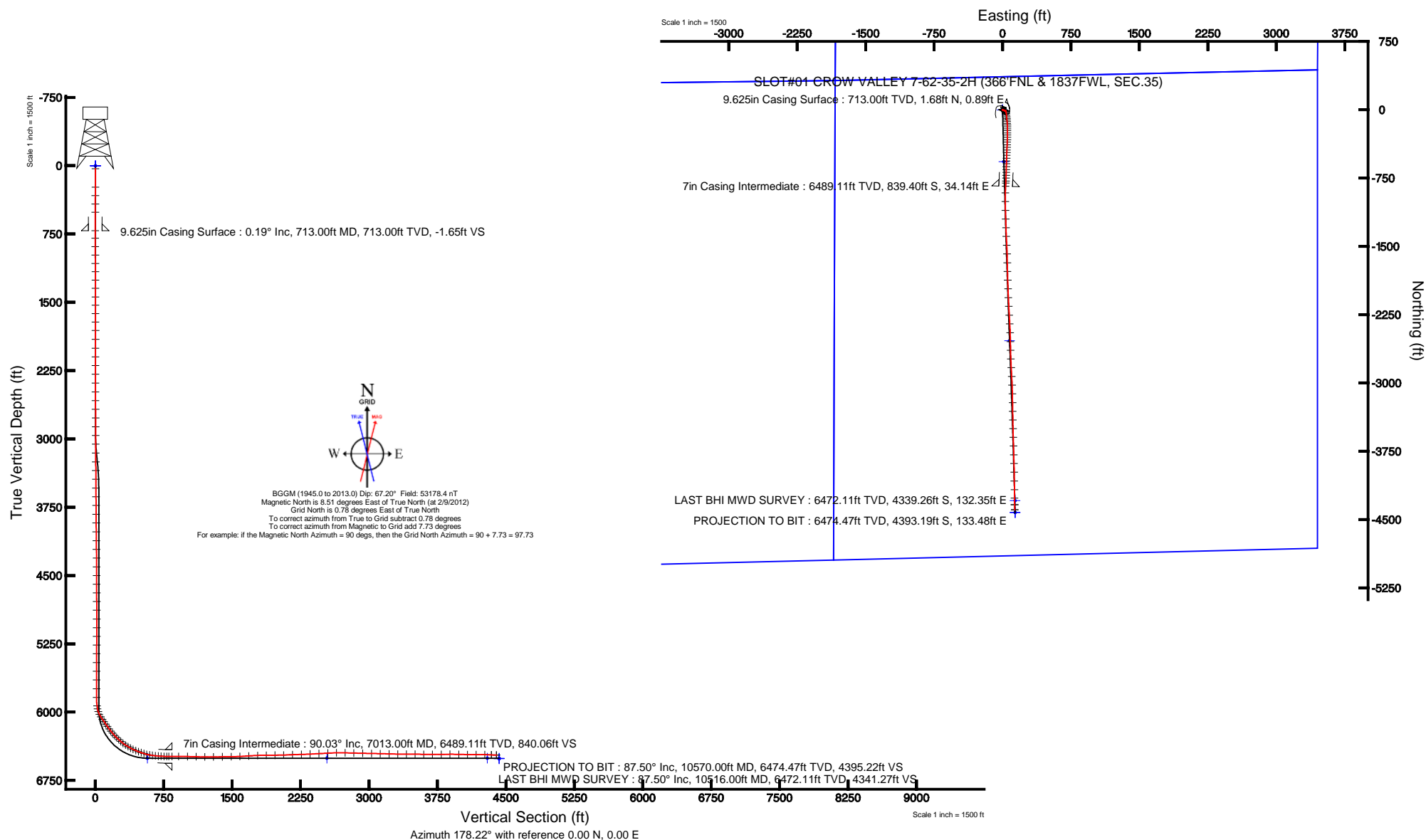



Actual Wellpath Report

CROW VALLEY 7-62-35-2H AWP

Page 1 of 7



REFERENCE WELLPATH IDENTIFICATION

Operator	MARATHON OIL COMPANY	Slot	SLOT#01 CROW VALLEY 7-62-35-2H (366'FNL & 1837FWL, SEC.35)
Area	COLORADO	Well	CROW VALLEY 7-62-35-2H
Field	WELD COUNTY (NAD 83, GRID NORTH)	Wellbore	CROW VALLEY 7-62-35-2H AWB
Facility	SEC.35-T7N-R62W		

REPORT SETUP INFORMATION

Projection System	NAD83 / Lambert Colorado SP, Northern Zone (501), US feet	Software System	WellArchitect® 4.0.0
North Reference	Grid	User	Cookdanm
Scale	0.999969	Report Generated	4/18/2012 at 5:22:49 PM
Convergence at slot	0.78° East	Database/Source file	WA_Denver/CROW_VALLEY_7-62-35-2H_AWB.xml

WELLPATH LOCATION

	Local coordinates		Grid coordinates		Geographic coordinates	
	North[ft]	East[ft]	Easting[US ft]	Northing[US ft]	Latitude	Longitude
Slot Location	0.00	0.00	3335727.27	1440771.01	40°32'13.343"N	104°17'31.495"W
Facility Reference Pt			3335727.27	1440771.01	40°32'13.343"N	104°17'31.495"W
Field Reference Pt			3476081.76	1512960.14	40°43'43.704"N	103°46'55.829"W

WELLPATH DATUM

Calculation method	Minimum curvature	Rig on SLOT#01 CROW VALLEY 7-62-35-2H (366'FNL & 1837FWL, SEC.35) (RKB) to Facility Vertical Datum
Horizontal Reference Pt	Slot	Rig on SLOT#01 CROW VALLEY 7-62-35-2H (366'FNL & 1837FWL, SEC.35) (RKB) to Mean Sea Level
Vertical Reference Pt	Rig on SLOT#01 CROW VALLEY 7-62-35-2H (366'FNL & 1837FWL, SEC.35) (RKB)	Rig on SLOT#01 CROW VALLEY 7-62-35-2H (366'FNL & 1837FWL, SEC.35) (RKB) to Mud Line at Slot (SLOT#0)
MD Reference Pt	Rig on SLOT#01 CROW VALLEY 7-62-35-2H (366'FNL & 1837FWL, SEC.35) (RKB)	Section Origin
Field Vertical Reference	Mean Sea Level	Section Azimuth



Actual Wellpath Report

CROW VALLEY 7-62-35-2H AWP

Page 2 of 7



REFERENCE WELLPATH IDENTIFICATION

Operator	MARATHON OIL COMPANY	Slot	SLOT#01 CROW VALLEY 7-62-35-2H (366°FNL & 1837FWL, SEC.35)
Area	COLORADO	Well	CROW VALLEY 7-62-35-2H
Field	WELD COUNTY (NAD 83, GRID NORTH)	Wellbore	CROW VALLEY 7-62-35-2H AWB
Facility	SEC.35-T7N-R62W		

WELLPATH DATA (132 stations) † = interpolated/extrapolated station

MD [ft]	Inclination [°]	Azimuth [°]	TVD [ft]	Vert Sect [ft]	North [ft]	East [ft]	Grid East [US ft]	Grid North [US ft]	Latitude	Longitude	DLS [°/100ft]	Comments
0.00†	0.000	29.610	0.00	0.00	0.00	0.00	3335727.27	1440771.01	40°32'13.343"N	104°17'31.495"W	0.00	
31.00	0.000	29.610	31.00	0.00	0.00	0.00	3335727.27	1440771.01	40°32'13.343"N	104°17'31.495"W	0.00	
234.00	0.410	29.610	234.00	-0.62	0.63	0.36	3335727.63	1440771.64	40°32'13.349"N	104°17'31.490"W	0.20	
327.00	0.200	42.190	327.00	-1.02	1.04	0.63	3335727.90	1440772.05	40°32'13.353"N	104°17'31.486"W	0.24	
419.00	0.170	56.530	419.00	-1.21	1.24	0.85	3335728.12	1440772.25	40°32'13.355"N	104°17'31.483"W	0.06	
509.00	0.140	44.330	509.00	-1.35	1.39	1.04	3335728.31	1440772.40	40°32'13.357"N	104°17'31.481"W	0.05	
796.00	0.300	279.300	795.99	-1.74	1.76	0.55	3335727.82	1440772.77	40°32'13.361"N	104°17'31.487"W	0.14	
888.00	0.300	213.100	887.99	-1.59	1.60	0.18	3335727.45	1440772.61	40°32'13.359"N	104°17'31.492"W	0.36	
980.00	0.500	244.800	979.99	-1.23	1.22	-0.32	3335726.95	1440772.23	40°32'13.355"N	104°17'31.499"W	0.32	
1072.00	0.400	208.000	1071.99	-0.80	0.77	-0.83	3335726.44	1440771.78	40°32'13.351"N	104°17'31.505"W	0.33	
1163.00	0.200	248.900	1162.99	-0.47	0.43	-1.13	3335726.14	1440771.44	40°32'13.348"N	104°17'31.509"W	0.31	
1256.00	0.200	268.500	1255.99	-0.41	0.37	-1.44	3335725.83	1440771.38	40°32'13.347"N	104°17'31.513"W	0.07	
1347.00	0.400	220.800	1346.99	-0.18	0.12	-1.81	3335725.46	1440771.13	40°32'13.345"N	104°17'31.518"W	0.33	
1440.00	0.300	240.900	1439.98	0.17	-0.24	-2.23	3335725.04	1440770.77	40°32'13.341"N	104°17'31.524"W	0.17	
1532.00	0.600	246.500	1531.98	0.46	-0.55	-2.89	3335724.38	1440770.46	40°32'13.338"N	104°17'31.532"W	0.33	
1623.00	0.100	245.200	1622.98	0.67	-0.77	-3.40	3335723.87	1440770.24	40°32'13.336"N	104°17'31.539"W	0.55	
1716.00	0.200	185.600	1715.98	0.86	-0.97	-3.49	3335723.78	1440770.04	40°32'13.334"N	104°17'31.540"W	0.19	
1808.00	0.200	143.800	1807.98	1.15	-1.26	-3.41	3335723.86	1440769.75	40°32'13.331"N	104°17'31.539"W	0.16	
1906.00	0.200	279.600	1905.98	1.26	-1.37	-3.47	3335723.80	1440769.64	40°32'13.330"N	104°17'31.540"W	0.38	
2003.00	0.200	319.700	2002.98	1.09	-1.21	-3.75	3335723.52	1440769.80	40°32'13.332"N	104°17'31.543"W	0.14	
2099.00	0.100	263.600	2098.98	0.97	-1.09	-3.94	3335723.33	1440769.92	40°32'13.333"N	104°17'31.546"W	0.17	
2194.00	0.500	72.500	2193.98	0.86	-0.98	-3.63	3335723.64	1440770.03	40°32'13.334"N	104°17'31.542"W	0.63	
2290.00	0.600	73.900	2289.97	0.62	-0.71	-2.75	3335724.52	1440770.30	40°32'13.337"N	104°17'31.530"W	0.11	
2387.00	0.600	86.600	2386.97	0.48	-0.54	-1.75	3335725.52	1440770.47	40°32'13.338"N	104°17'31.517"W	0.14	
2484.00	0.800	90.600	2483.96	0.50	-0.52	-0.57	3335726.70	1440770.49	40°32'13.338"N	104°17'31.502"W	0.21	
2579.00	1.100	112.800	2578.95	0.90	-0.88	0.94	3335728.21	1440770.13	40°32'13.334"N	104°17'31.483"W	0.49	
2676.00	1.000	101.000	2675.93	1.48	-1.40	2.63	3335729.90	1440769.61	40°32'13.329"N	104°17'31.461"W	0.25	
2771.00	1.300	108.300	2770.91	2.03	-1.89	4.46	3335731.73	1440769.12	40°32'13.324"N	104°17'31.437"W	0.35	
2867.00	1.000	94.000	2866.89	2.49	-2.30	6.33	3335733.60	1440768.71	40°32'13.320"N	104°17'31.413"W	0.43	
2963.00	0.900	97.300	2962.88	2.69	-2.45	7.92	3335735.19	1440768.56	40°32'13.318"N	104°17'31.393"W	0.12	
3059.00	1.000	105.000	3058.87	3.06	-2.76	9.47	3335736.74	1440768.25	40°32'13.315"N	104°17'31.373"W	0.17	
3155.00	0.600	101.100	3154.86	3.41	-3.08	10.78	3335738.04	1440767.93	40°32'13.311"N	104°17'31.356"W	0.42	
3252.00	0.800	105.700	3251.85	3.73	-3.36	11.93	3335739.20	1440767.65	40°32'13.308"N	104°17'31.341"W	0.21	
3347.00	0.400	132.200	3346.84	4.16	-3.76	12.81	3335740.08	1440767.25	40°32'13.304"N	104°17'31.329"W	0.50	
3443.00	1.000	109.300	3442.84	4.69	-4.26	13.85	3335741.12	1440766.75	40°32'13.299"N	104°17'31.316"W	0.68	
3540.00	1.100	115.100	3539.82	5.41	-4.94	15.49	3335742.76	1440766.07	40°32'13.292"N	104°17'31.295"W	0.15	
3636.00	0.900	120.900	3635.81	6.24	-5.71	16.97	3335744.24	1440765.30	40°32'13.285"N	104°17'31.276"W	0.23	
3732.00	1.600	117.600	3731.78	7.30	-6.72	18.81	3335746.08	1440764.29	40°32'13.274"N	104°17'31.252"W	0.73	
3828.00	1.400	97.700	3827.75	8.15	-7.50	21.16	3335748.43	1440763.51	40°32'13.266"N	104°17'31.222"W	0.58	
3925.00	1.000	107.200	3924.73	8.62	-7.91	23.14	3335750.41	1440763.10	40°32'13.262"N	104°17'31.196"W	0.46	
4021.00	0.900	115.100	4020.71	9.24	-8.48	24.62	3335751.89	1440762.53	40°32'13.256"N	104°17'31.177"W	0.17	
4118.00	0.900	137.500	4117.70	10.16	-9.36	25.83	3335753.10	1440761.65	40°32'13.247"N	104°17'31.162"W	0.36	
4213.00	1.500	119.800	4212.68	11.38	-10.53	27.41	3335754.68	1440760.48	40°32'13.236"N	104°17'31.142"W	0.74	
4309.00	1.600	107.500	4308.65	12.48	-11.56	29.78	3335757.05	1440759.45	40°32'13.225"N	104°17'31.111"W	0.36	
4406.00	1.400	96.400	4405.61	13.09	-12.10	32.25	3335759.52	1440758.91	40°32'13.219"N	104°17'31.079"W	0.36	



Actual Wellpath Report

CROW VALLEY 7-62-35-2H AWP

Page 3 of 7



REFERENCE WELLPATH IDENTIFICATION

Operator	MARATHON OIL COMPANY	Slot	SLOT#01 CROW VALLEY 7-62-35-2H (366°FNL & 1837FWL, SEC.35)
Area	COLORADO	Well	CROW VALLEY 7-62-35-2H
Field	WELD COUNTY (NAD 83, GRID NORTH)	Wellbore	CROW VALLEY 7-62-35-2H AWB
Facility	SEC.35-T7N-R62W		

WELLPATH DATA (132 stations)

MD [ft]	Inclination [°]	Azimuth [°]	TVD [ft]	Vert Sect [ft]	North [ft]	East [ft]	Grid East [US ft]	Grid North [US ft]	Latitude	Longitude	DLS [°/100ft]	Comments
4501.00	0.800	88.000	4500.60	13.26	-12.20	34.06	3335761.33	1440758.81	40°32'13.218"N	104°17'31.056"W	0.65	
4597.00	0.200	157.300	4596.59	13.41	-12.33	34.80	3335762.07	1440758.68	40°32'13.217"N	104°17'31.046"W	0.78	
4692.00	0.400	116.500	4691.59	13.72	-12.63	35.16	3335762.43	1440758.38	40°32'13.214"N	104°17'31.042"W	0.30	
4788.00	0.200	224.500	4787.59	14.00	-12.90	35.34	3335762.61	1440758.11	40°32'13.211"N	104°17'31.039"W	0.52	
4883.00	0.200	228.600	4882.59	14.22	-13.13	35.10	3335762.37	1440757.88	40°32'13.209"N	104°17'31.042"W	0.02	
4979.00	0.300	282.400	4978.59	14.26	-13.19	34.73	3335762.00	1440757.82	40°32'13.208"N	104°17'31.047"W	0.25	
5076.00	0.200	334.600	5075.59	14.04	-12.98	34.41	3335761.68	1440758.03	40°32'13.210"N	104°17'31.051"W	0.24	
5171.00	0.300	231.200	5170.59	14.04	-12.99	34.14	3335761.41	1440758.02	40°32'13.210"N	104°17'31.055"W	0.42	
5266.00	0.300	2.000	5265.59	13.94	-12.89	33.96	3335761.23	1440758.12	40°32'13.211"N	104°17'31.057"W	0.57	
5361.00	0.200	332.200	5360.59	13.55	-12.50	33.89	3335761.16	1440758.51	40°32'13.215"N	104°17'31.058"W	0.17	
5457.00	0.500	21.800	5456.58	13.01	-11.96	33.97	3335761.24	1440759.05	40°32'13.220"N	104°17'31.057"W	0.42	
5553.00	0.300	91.500	5552.58	12.64	-11.58	34.37	3335761.64	1440759.43	40°32'13.224"N	104°17'31.052"W	0.51	
5649.00	0.100	65.400	5648.58	12.62	-11.55	34.70	3335761.97	1440759.46	40°32'13.224"N	104°17'31.047"W	0.22	
5745.00	0.500	67.100	5744.58	12.44	-11.35	35.16	3335762.43	1440759.66	40°32'13.226"N	104°17'31.041"W	0.42	
5841.00	0.300	56.700	5840.58	12.16	-11.05	35.76	3335763.03	1440759.96	40°32'13.229"N	104°17'31.034"W	0.22	
5935.00	6.500	173.000	5934.38	17.33	-16.20	36.61	3335763.88	1440754.81	40°32'13.178"N	104°17'31.023"W	7.06	
5967.00	13.000	170.000	5965.90	22.71	-21.55	37.46	3335764.73	1440749.46	40°32'13.125"N	104°17'31.013"W	20.37	
5999.00	18.700	170.100	5996.67	31.35	-30.16	38.97	3335766.24	1440740.85	40°32'13.040"N	104°17'30.995"W	17.81	
6031.00	25.900	171.400	6026.26	43.39	-42.14	40.90	3335768.17	1440728.87	40°32'12.921"N	104°17'30.972"W	22.55	
6063.00	32.700	172.600	6054.15	58.95	-57.64	43.06	3335770.33	1440713.37	40°32'12.768"N	104°17'30.947"W	21.33	
6095.00	34.800	174.200	6080.76	76.66	-75.30	45.10	3335772.37	1440695.72	40°32'12.593"N	104°17'30.924"W	7.13	
6127.00	35.000	174.900	6107.00	94.93	-93.52	46.84	3335774.10	1440677.49	40°32'12.413"N	104°17'30.905"W	1.40	
6158.00	35.100	175.300	6132.38	112.71	-111.26	48.36	3335775.62	1440659.75	40°32'12.237"N	104°17'30.888"W	0.81	
6190.00	35.000	175.300	6158.58	131.06	-129.57	49.86	3335777.13	1440641.44	40°32'12.056"N	104°17'30.872"W	0.31	
6222.00	35.500	176.200	6184.71	149.51	-147.99	51.23	3335778.50	1440623.02	40°32'11.874"N	104°17'30.857"W	2.25	
6254.00	37.900	177.600	6210.36	168.63	-167.09	52.26	3335779.53	1440603.93	40°32'11.685"N	104°17'30.847"W	7.94	
6285.00	40.100	178.400	6234.45	188.14	-186.58	52.93	3335780.20	1440584.43	40°32'11.493"N	104°17'30.842"W	7.28	
6317.00	42.200	178.200	6258.55	209.19	-207.63	53.56	3335780.83	1440563.39	40°32'11.285"N	104°17'30.838"W	6.58	
6349.00	45.300	179.600	6281.66	231.32	-229.75	53.98	3335781.25	1440541.27	40°32'11.066"N	104°17'30.836"W	10.15	
6381.00	47.600	180.800	6303.71	254.49	-252.94	53.89	3335781.16	1440518.08	40°32'10.837"N	104°17'30.841"W	7.68	
6413.00	50.000	181.700	6324.79	278.53	-277.01	53.36	3335780.63	1440494.01	40°32'10.599"N	104°17'30.853"W	7.79	
6445.00	53.100	181.100	6344.68	303.55	-302.06	52.75	3335780.02	1440468.96	40°32'10.352"N	104°17'30.865"W	9.80	
6477.00	55.700	181.400	6363.31	329.53	-328.07	52.18	3335779.45	1440442.95	40°32'10.095"N	104°17'30.877"W	8.16	
6509.00	58.500	181.600	6380.69	356.35	-354.93	51.48	3335778.75	1440416.10	40°32'09.829"N	104°17'30.891"W	8.77	
6542.00	61.500	182.500	6397.19	384.87	-383.48	50.46	3335777.72	1440387.54	40°32'09.547"N	104°17'30.909"W	9.39	
6573.00	64.900	182.200	6411.16	412.46	-411.12	49.32	3335776.59	1440359.90	40°32'09.274"N	104°17'30.928"W	11.00	
6605.00	67.200	182.100	6424.15	441.63	-440.35	48.23	3335775.49	1440330.68	40°32'08.986"N	104°17'30.948"W	7.19	
6637.00	69.000	182.400	6436.09	471.25	-470.01	47.06	3335774.33	1440301.01	40°32'08.693"N	104°17'30.968"W	5.69	
6669.00	71.200	182.200	6446.98	501.26	-500.08	45.85	3335773.12	1440270.95	40°32'08.396"N	104°17'30.989"W	6.90	
6701.00	72.900	182.400	6456.84	531.62	-530.49	44.63	3335771.90	1440240.53	40°32'08.096"N	104°17'31.010"W	5.35	
6733.00	75.700	181.800	6465.50	562.36	-561.28	43.50	3335770.77	1440209.75	40°32'07.792"N	104°17'31.030"W	8.93	
6765.00	79.100	181.300	6472.48	593.53	-592.49	42.66	3335769.93	1440178.54	40°32'07.483"N	104°17'31.047"W	10.73	
6797.00	81.900	181.300	6477.76	625.04	-624.04	41.94	3335769.21	1440146.99	40°32'07.172"N	104°17'31.062"W	8.75	
6829.00	83.700	181.500	6481.77	656.74	-655.78	41.17	3335768.44	1440115.26	40°32'06.858"N	104°17'31.077"W	5.66	
6861.00	86.000	181.500	6484.64	688.56	-687.63	40.33	3335767.60	1440083.40	40°32'06.544"N	104°17'31.094"W	7.19	



Actual Wellpath Report

CROW VALLEY 7-62-35-2H AWP

Page 4 of 7



REFERENCE WELLPATH IDENTIFICATION

Operator	MARATHON OIL COMPANY	Slot	SLOT#01 CROW VALLEY 7-62-35-2H (366°FNL & 1837FWL, SEC.35)
Area	COLORADO	Well	CROW VALLEY 7-62-35-2H
Field	WELD COUNTY (NAD 83, GRID NORTH)	Wellbore	CROW VALLEY 7-62-35-2H AWB
Facility	SEC.35-T7N-R62W		

WELLPATH DATA (132 stations)

MD [ft]	Inclination [°]	Azimuth [°]	TVD [ft]	Vert Sect [ft]	North [ft]	East [ft]	Grid East [US ft]	Grid North [US ft]	Latitude	Longitude	DLS [°/100ft]	Comments
6892.00	87.100	182.100	6486.51	719.44	-718.56	39.36	3335766.63	1440052.47	40°32'06.238"N	104°17'31.112"W	4.04	
6924.00	87.900	182.200	6487.90	751.33	-750.51	38.16	3335765.43	1440020.53	40°32'05.923"N	104°17'31.133"W	2.52	
6955.00	88.700	182.600	6488.82	782.24	-781.47	36.86	3335764.13	1439989.57	40°32'05.617"N	104°17'31.155"W	2.88	
6977.00	89.900	182.900	6489.09	804.16	-803.44	35.81	3335763.08	1439967.60	40°32'05.400"N	104°17'31.173"W	5.62	
7086.00	90.300	181.400	6488.90	912.90	-912.36	31.72	3335758.99	1439858.68	40°32'04.324"N	104°17'31.245"W	1.42	
7182.00	88.800	179.700	6489.65	1008.82	-1008.35	30.80	3335758.07	1439762.70	40°32'03.376"N	104°17'31.274"W	2.36	
7278.00	88.600	178.700	6491.83	1104.78	-1104.31	32.14	3335759.41	1439666.74	40°32'02.428"N	104°17'31.273"W	1.06	
7373.00	89.200	178.200	6493.66	1199.76	-1199.26	34.71	3335761.98	1439571.79	40°32'01.489"N	104°17'31.257"W	0.82	
7468.00	90.900	178.100	6493.57	1294.75	-1294.20	37.77	3335765.04	1439476.85	40°32'00.551"N	104°17'31.234"W	1.79	
7564.00	90.500	177.200	6492.40	1390.74	-1390.12	41.71	3335768.98	1439380.94	40°31'59.603"N	104°17'31.200"W	1.03	
7661.00	90.700	177.500	6491.38	1487.72	-1487.01	46.19	3335773.46	1439284.05	40°31'58.645"N	104°17'31.159"W	0.37	
7757.00	92.800	178.200	6488.45	1583.67	-1582.89	49.79	3335777.06	1439188.17	40°31'57.697"N	104°17'31.129"W	2.31	
7854.00	93.600	179.100	6483.04	1680.51	-1679.71	52.08	3335779.34	1439091.36	40°31'56.740"N	104°17'31.117"W	1.24	
7951.00	92.300	178.500	6478.05	1777.38	-1776.56	54.10	3335781.37	1438994.51	40°31'55.783"N	104°17'31.107"W	1.48	
8046.00	90.200	178.100	6475.97	1872.35	-1871.49	56.92	3335784.19	1438899.59	40°31'54.844"N	104°17'31.088"W	2.25	
8141.00	90.700	178.200	6475.23	1967.35	-1966.43	59.99	3335787.26	1438804.64	40°31'53.906"N	104°17'31.065"W	0.54	
8237.00	91.700	177.100	6473.22	2063.32	-2062.33	63.92	3335791.19	1438708.75	40°31'52.958"N	104°17'31.031"W	1.55	
8334.00	92.200	177.300	6469.92	2160.25	-2159.16	68.66	3335795.93	1438611.92	40°31'52.000"N	104°17'30.986"W	0.56	
8431.00	91.600	176.600	6466.70	2257.17	-2255.96	73.82	3335801.09	1438515.12	40°31'51.043"N	104°17'30.937"W	0.95	
8527.00	93.100	176.900	6462.76	2353.05	-2351.73	79.26	3335806.52	1438419.36	40°31'50.096"N	104°17'30.883"W	1.59	
8625.00	93.000	178.000	6457.55	2450.90	-2449.49	83.61	3335810.88	1438321.60	40°31'49.130"N	104°17'30.844"W	1.13	
8721.00	92.900	178.800	6452.61	2546.78	-2545.32	86.29	3335813.55	1438225.77	40°31'48.183"N	104°17'30.826"W	0.84	
8817.00	91.000	178.900	6449.34	2642.71	-2641.24	88.21	3335815.48	1438129.85	40°31'47.235"N	104°17'30.818"W	1.98	
8913.00	88.900	177.700	6449.43	2738.70	-2737.20	91.06	3335818.33	1438033.90	40°31'46.286"N	104°17'30.798"W	2.52	
9008.00	88.400	177.300	6451.66	2833.67	-2832.08	95.20	3335822.47	1437939.02	40°31'45.348"N	104°17'30.761"W	0.67	
9105.00	88.700	176.900	6454.12	2930.62	-2928.92	100.11	3335827.38	1437842.18	40°31'44.391"N	104°17'30.715"W	0.52	
9201.00	88.700	177.700	6456.30	3026.58	-3024.79	104.63	3335831.90	1437746.32	40°31'43.443"N	104°17'30.673"W	0.83	
9297.00	88.800	178.500	6458.39	3122.56	-3120.71	107.81	3335835.08	1437650.40	40°31'42.495"N	104°17'30.649"W	0.84	
9393.00	88.500	179.000	6460.65	3218.53	-3216.66	109.91	3335837.17	1437554.45	40°31'41.546"N	104°17'30.639"W	0.61	
9489.00	88.700	179.100	6463.00	3314.49	-3312.62	111.50	3335838.76	1437458.50	40°31'40.598"N	104°17'30.635"W	0.23	
9584.00	89.900	179.100	6464.16	3409.47	-3407.60	112.99	3335840.26	1437363.52	40°31'39.659"N	104°17'30.633"W	1.26	
9679.00	89.700	178.600	6464.49	3504.46	-3502.58	114.90	3335842.16	1437268.54	40°31'38.721"N	104°17'30.625"W	0.57	
9775.00	89.200	178.300	6465.41	3600.45	-3598.54	117.49	3335844.76	1437172.59	40°31'37.772"N	104°17'30.608"W	0.61	
9870.00	89.900	178.200	6466.16	3695.45	-3693.49	120.39	3335847.66	1437077.64	40°31'36.833"N	104°17'30.587"W	0.74	
9966.00	90.600	178.800	6465.74	3791.45	-3789.46	122.91	3335850.17	1436981.67	40°31'35.885"N	104°17'30.572"W	0.96	
10062.00	90.400	177.900	6464.90	3887.44	-3885.41	125.67	3335852.94	1436885.72	40°31'34.937"N	104°17'30.553"W	0.96	
10158.00	88.200	179.300	6466.07	3983.43	-3981.37	128.02	3335855.28	1436789.77	40°31'33.988"N	104°17'30.539"W	2.72	
10254.00	89.600	179.300	6467.92	4079.39	-4077.34	129.19	3335856.45	1436693.80	40°31'33.040"N	104°17'30.541"W	1.46	
10349.00	90.200	179.600	6468.08	4174.37	-4172.34	130.10	3335857.37	1436598.81	40°31'32.101"N	104°17'30.546"W	0.71	
10444.00	88.200	179.200	6469.41	4269.33	-4267.32	131.09	3335858.36	1436503.83	40°31'31.162"N	104°17'30.550"W	2.15	
10516.00	87.500	178.800	6472.11	4341.27	-4339.26	132.35	3335859.62	1436431.90	40°31'30.451"N	104°17'30.546"W	1.12	LAST BHI MWD SURVEY
10570.00	87.500	178.800	6474.47	4395.22	-4393.19	133.48	3335860.75	1436377.96	40°31'29.918"N	104°17'30.541"W	0.00	PROJECTION TO BIT



Actual Wellpath Report

CROW VALLEY 7-62-35-2H AWP

Page 5 of 7



REFERENCE WELLPATH IDENTIFICATION

Operator	MARATHON OIL COMPANY	Slot	SLOT#01 CROW VALLEY 7-62-35-2H (366'FNL & 1837FWL, SEC.35)
Area	COLORADO	Well	CROW VALLEY 7-62-35-2H
Field	WELD COUNTY (NAD 83, GRID NORTH)	Wellbore	CROW VALLEY 7-62-35-2H AWB
Facility	SEC.35-T7N-R62W		

HOLE & CASING SECTIONS - Ref Wellbore: CROW VALLEY 7-62-35-2H AWB Ref Wellpath: CROW VALLEY 7-62-35-2H AWP

String/Diameter	Start MD [ft]	End MD [ft]	Interval [ft]	Start TVD [ft]	End TVD [ft]	Start N/S [ft]	Start E/W [ft]	End N/S [ft]	End E/W [ft]
9.625in Casing Surface	31.00	713.00	682.00	31.00	713.00	0.00	0.00	1.68	0.89
8.75in Open Hole	713.00	7033.00	6320.00	713.00	6489.09	1.68	0.89	-859.39	33.35
7in Casing Intermediate	31.00	7013.00	6982.00	31.00	6489.11	0.00	0.00	-839.40	34.14
6in Open Hole	7033.00	10570.00	3537.00	6489.09	6474.47	-859.39	33.35	-4393.19	133.48

TARGETS

Name	MD [ft]	TVD [ft]	North [ft]	East [ft]	Grid East [US ft]	Grid North [US ft]	Latitude	Longitude	Shape
CROW VALLEY SECTION 13		0.00	0.00	0.00	3335727.27	1440771.01	40°32'13.343"N	104°17'31.495"W	polygon
CROW VALLEY SECTION 24		0.00	0.00	0.00	3335727.27	1440771.01	40°32'13.343"N	104°17'31.495"W	polygon
CROW VALLEY SECTION 26		0.00	0.00	0.00	3335727.27	1440771.01	40°32'13.343"N	104°17'31.495"W	polygon
CROW VALLEY SECTION 27		0.00	0.00	0.00	3335727.27	1440771.01	40°32'13.343"N	104°17'31.495"W	polygon
CROW VALLEY SECTION 34		0.00	0.00	0.00	3335727.27	1440771.01	40°32'13.343"N	104°17'31.495"W	polygon
CROW VALLEY SECTION 35		0.00	0.00	0.00	3335727.27	1440771.01	40°32'13.343"N	104°17'31.495"W	polygon
CROW VALLEY 7-62-35-2H BHL ON PLAT (470'FSL & 1989'FWL, REV-4)		6508.00	-4423.77	137.63	3335864.90	1436347.38	40°31'29.616"N	104°17'30.493"W	point
CROW VALLEY 7-62-35-2H BHL ON PLAT (600'FSL & 1989'FWL, REV-3)		6508.00	-4293.84	137.97	3335865.24	1436477.31	40°31'30.899"N	104°17'30.466"W	point
CROW VALLEY 7-62-35-2H FAULT (REV-1)		6508.00	-2536.69	76.64	3335803.91	1438234.40	40°31'48.269"N	104°17'30.950"W	point
CROW VALLEY 7-62-35-2H LANDING (REV-1)		6508.00	-568.27	14.64	3335741.91	1440202.76	40°32'07.727"N	104°17'31.405"W	point
CROW VALLEY 7-62-35-2H BHL ON PLAT (470'FSL & 1989'FWL, REV-1)		6512.00	-4423.77	137.63	3335864.90	1436347.38	40°31'29.616"N	104°17'30.493"W	point
CROW VALLEY 7-62-35-2H BHL ON PLAT (470'FSL & 1989'FWL, REV-2)		6515.00	-4423.77	137.63	3335864.90	1436347.38	40°31'29.616"N	104°17'30.493"W	point

**Actual Wellpath Report**

CROW VALLEY 7-62-35-2H AWP

Page 6 of 7

**REFERENCE WELLPATH IDENTIFICATION**

Operator	MARATHON OIL COMPANY	Slot	SLOT#01 CROW VALLEY 7-62-35-2H (366'FNL & 1837FWL, SEC.35)
Area	COLORADO	Well	CROW VALLEY 7-62-35-2H
Field	WELD COUNTY (NAD 83, GRID NORTH)	Wellbore	CROW VALLEY 7-62-35-2H AWB
Facility	SEC.35-T7N-R62W		

WELLPATH COMPOSITION - Ref Wellbore: CROW VALLEY 7-62-35-2H AWB Ref Wellpath: CROW VALLEY 7-62-35-2H AWP

Start MD [ft]	End MD [ft]	Positional Uncertainty Model	Log Name/Comment	Wellbore
31.00	6977.00	NaviTrak (Standard)	BHI/NAVITRAK MWD 8.75"- <234-6977>	CROW VALLEY 7-62-35-2H AWB
6977.00	10516.00	NaviTrak (Standard)	BHI/NAVITRAK MWD 6"- <7086-10516>	CROW VALLEY 7-62-35-2H AWB
10516.00	10570.00	Blind Drilling (std)	Projection to bit	CROW VALLEY 7-62-35-2H AWB

**Actual Wellpath Report**

CROW VALLEY 7-62-35-2H AWP

Page 7 of 7

**REFERENCE WELLPATH IDENTIFICATION**

Operator	MARATHON OIL COMPANY	Slot	SLOT#01 CROW VALLEY 7-62-35-2H (366'FNL & 1837FWL, SEC.35)
Area	COLORADO	Well	CROW VALLEY 7-62-35-2H
Field	WELD COUNTY (NAD 83, GRID NORTH)	Wellbore	CROW VALLEY 7-62-35-2H AWB
Facility	SEC.35-T7N-R62W		

WELLPATH COMMENTS

MD [ft]	Inclination [°]	Azimuth [°]	TVD [ft]	Comment
10516.00	87.500	178.800	6472.11	LAST BHI MWD SURVEY
10570.00	87.500	178.800	6474.47	PROJECTION TO BIT