

# LOCATION DRAWING

ADAMS D30-29D + ADAMS D30-30D + ADAMS D30-31D + DECHANT D30-17D

SECTION 30  
TOWNSHIP 3 NORTH  
RANGE 64 WEST

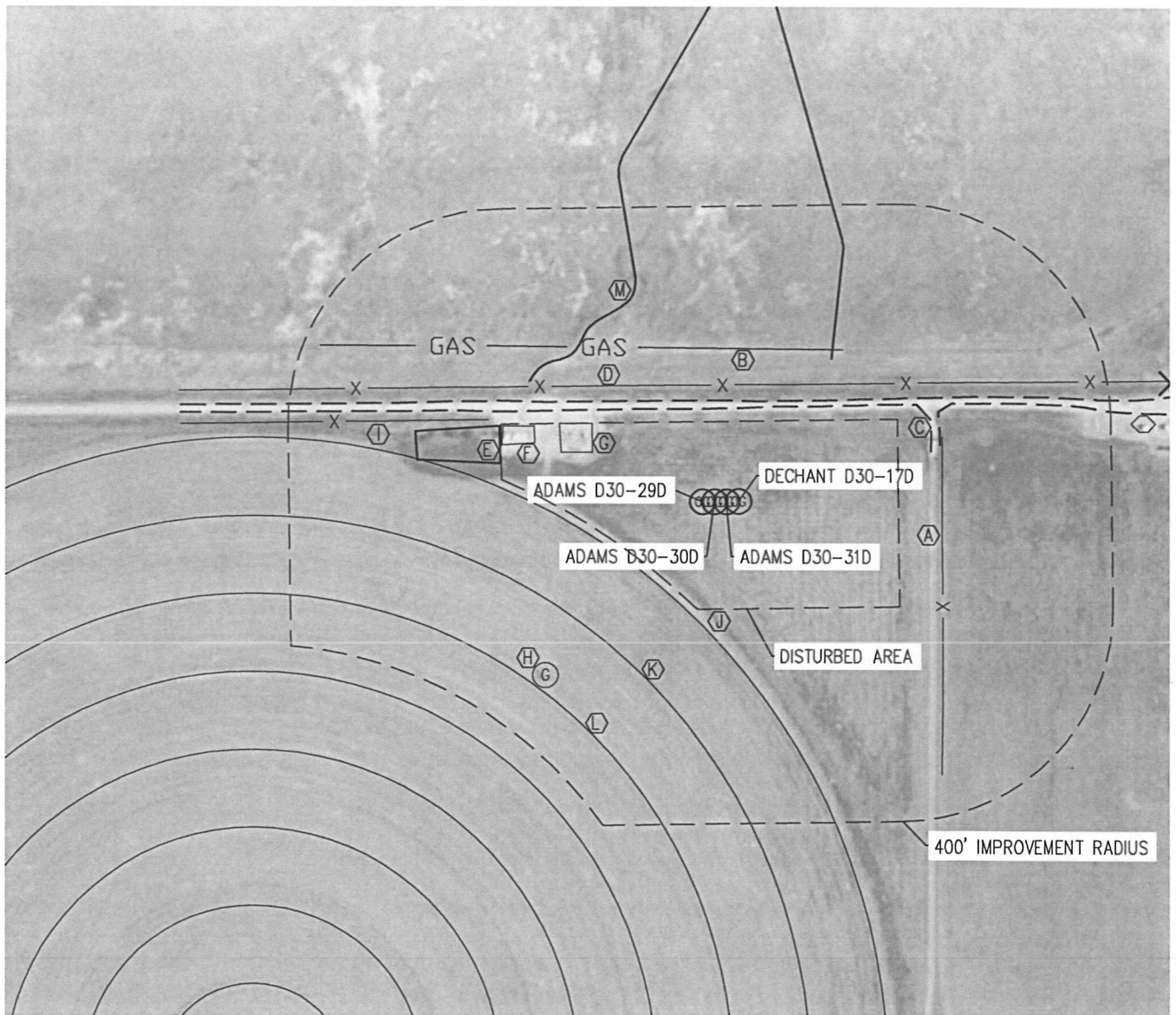

NEAREST: BUILDING 2,191' S, PUBLIC ROAD 2,074' W, ABOVE GROUND UTILITY 1,989' W,  
RAILROAD 5,280'+, PROPERTY LINE 154' N

(MEASURED FROM ADAMS D30-29D LOCATION)

## IMPROVEMENTS:

- |                                                |                                                |
|------------------------------------------------|------------------------------------------------|
| (A) FENCE: 450' EAST                           | (K) IRRIGATION SPRINKLER TRACK: 318' SOUTHWEST |
| (B) GAS PIPELINE: 284' NORTH                   | (L) IRRIGATION SPRINKLER TRACK: 463' SOUTHWEST |
| (C) GRAVEL ROAD: 173' NORTH                    | (M) NATURAL DRAINAGE: 360' NORTHEAST           |
| (D) FENCE: 217' NORTH                          |                                                |
| (E) POND: 387' NORTHWEST                       |                                                |
| (F) TANKS: 334' NORTHWEST                      |                                                |
| (G) SEPARATOR: 227' NORTHWEST                  |                                                |
| (H) OIL & GAS WELL 438' SOUTHWEST              |                                                |
| (I) FENCE: 432' NORTHWEST                      |                                                |
| (J) IRRIGATION SPRINKLER TRACK: 172' SOUTHWEST |                                                |

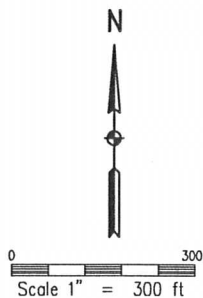

## NOTE

The size, type and location of underground utilities shown hereon are approximate, and are based on markings made by utility locate companies. It is not guaranteed that all utilities have been located. It shall be the responsibility of the contractor to verify the existence of all underground utilities in the area of the work before commencing new construction.