

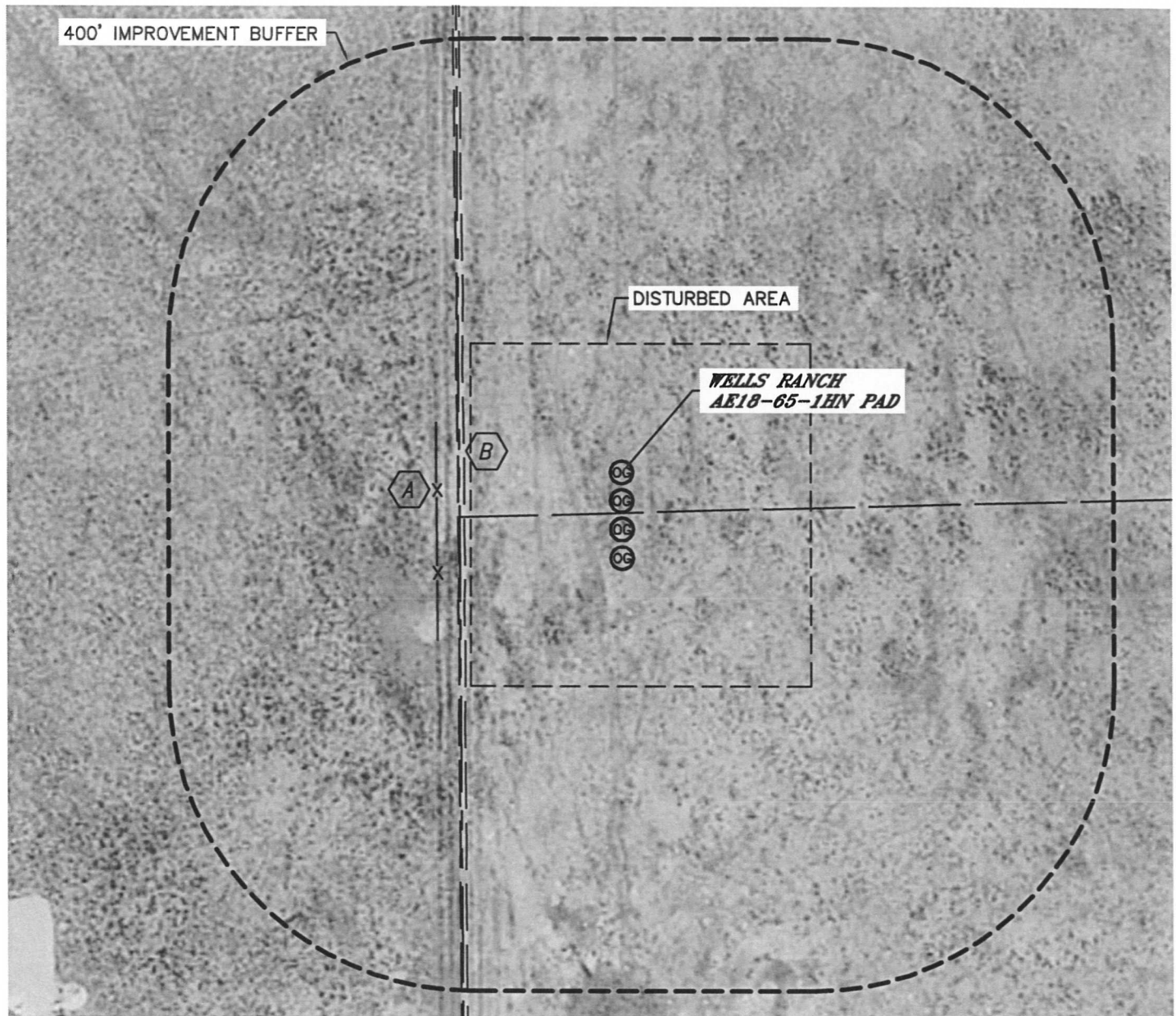

LOCATION DRAWING

WELLS RANCH AE18-65-1HN PAD

SECTION: 18
TOWNSHIP: 6N
RANGE: 62W



IMPROVEMENTS:
(MEASURED FROM PROPOSED WELLS RANCH AE18-65-1HN WELL LOCATION)

-  FENCE 246' W
-  FIELD ROAD 213' W



1"=200'

NEAREST: BUILDING 5280'+, PUBLIC ROAD 1366' S (CR 68),
ABOVE GROUND UTILITY 5280'+, RAILROAD 5280'+, PROPERTY LINE 215' W

DATE: 2/22/2012
PROJECT#: 2011024