

April 17, 2012

City of Rifle  
Dick Duessen, Utility Director  
202 Railroad Avenue  
Rifle, CO 81650



Antero Resources  
1625 17th Street  
Denver, Colorado 80202  
Office 303.357.7310  
Fax 303.357.7315

VIA CERTIFIED MAIL

RE: River Ranch C (Pad Expansion)  
NESW, Section 8, T6S, R92W, 6<sup>th</sup> P.M., Garfield County, Colorado  
Notification to Public Water Supply System, Per Rule 317B

Mr. Duessen:

In compliance with Colorado Oil and Gas Conservation Commission Rule 317B, Antero Resources Piceance Corporation would like to notify you that the subject oil and gas location, River Ranch C, is proposed to be located in a COGCC Rule 317B external buffer zone (501'-2,640') from surface water supply area), as shown in the attached Hydrology Map. Specifically, the proposed oil and gas location will be approximately 340' from an intermittent stream and the City of Rifle's public water supply system is within fifteen (15) stream miles of our proposed location. Per COGCC Rule 317B.d., operators are required to send notification to "potentially impacted Public Water System(s) within fifteen (15) stream miles downstream of the DCPS Operation prior to commencement of new surface disturbing activities at this site." Please note, this is an existing, built pad that we are slightly expanding in size.

Please be advised that, as required by COGCC Rule 317B, Antero has an emergency response plan in place and if a spill or release that threatens to impact the City of Rifle's Public Water System is discovered, we will notify you immediately following discovery of the release.

Please contact me at (303) 357-6820 or Jerry Alberts, Environmental and Regulatory Manager, at (303) 357-7341 if you have any questions.

Sincerely,



Shauna Redican  
Permit Representative

Enclosures

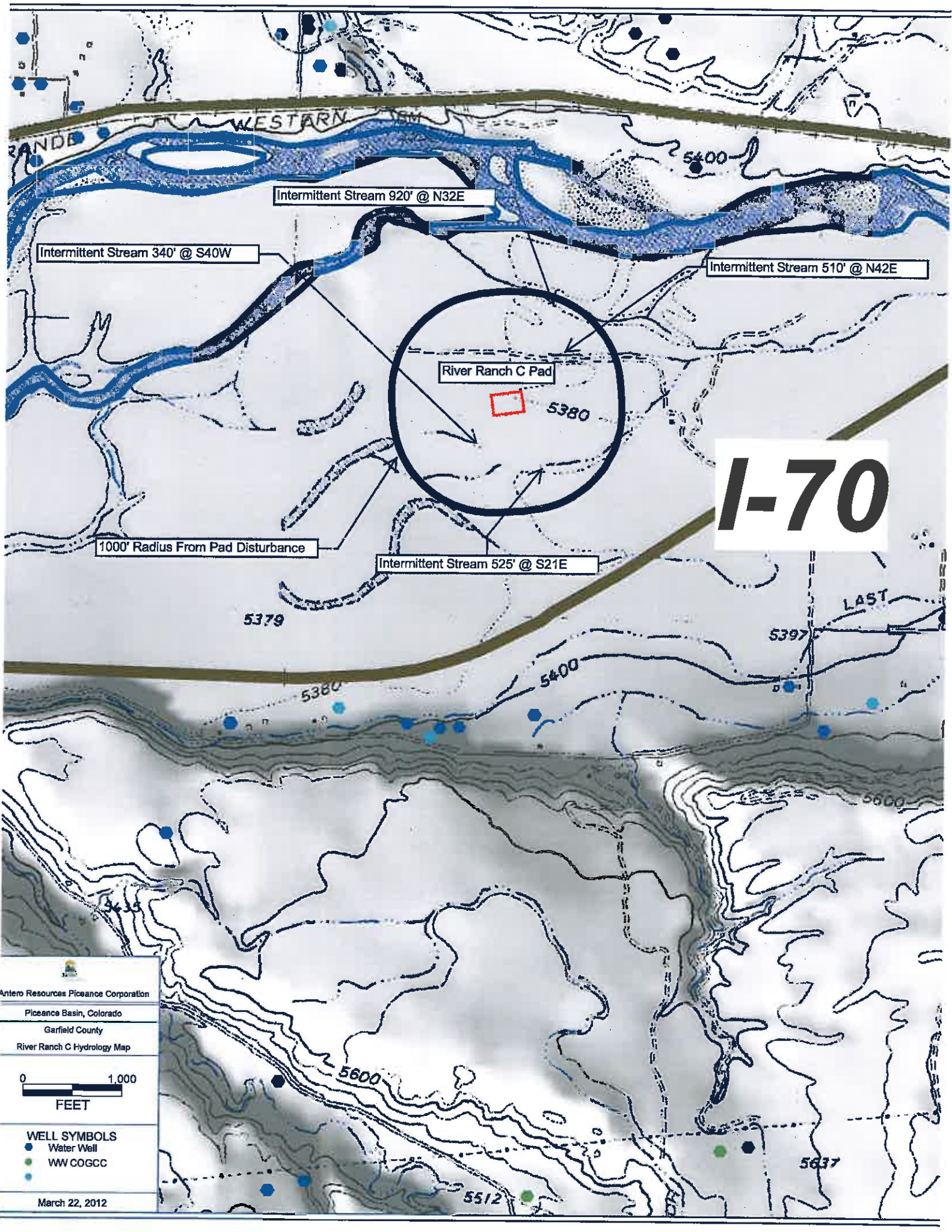

  
Antero Resources Piceance Corporation  
Piceance Basin, Colorado  
Garfield County  
River Ranch C Hydrology Map

0 1,000  
FEET

**WELL SYMBOLS**  
● Water Well  
● WW COGCC

March 22, 2012

## Instructions

1. Each Click-N-Ship® label is unique. Labels are to be used as printed and used only once. DO NOT PHOTO COPY OR ALTER LABEL.
2. Place your label so it does not wrap around the edge of the package.
3. Adhere your label to the package. A self-adhesive label is recommended. If tape or glue is used, DO NOT TAPE OVER BARCODE. Be sure all edges are secure.
4. To mail your package with PC Postage®, you may schedule a Carrier Pickup online, hand to your letter carrier, take to a Post Office™, or drop in a USPS collection box.
5. Mail your package on the "Ship Date" you selected when creating this label.

## Online Label Record (Label 1 of 1)

**Signature Confirmation™ Number:**  
**9410 8036 9930 0030 5363 80**

**Paid Online**

Transaction #:	230101972	Priority Mail® Postage:	<b>\$4.97</b>
Print Date:	04/17/2012	Signature Confirmation:	<b>\$2.10</b>
Ship Date:	04/17/2012	(Electronic Rate)	
Weight:	0 lb 6 oz	Total:	<b>\$7.07</b>

**From:** SHAUNA REDICAN  
ANTERO RESOURCES  
1625 17TH ST STE 300  
DENVER CO 80202-5986

**To:** CITY OF RIFLE  
DICK DUESSEN, UTILITY DIRECTOR  
202 RAILROAD AVE  
RIFLE CO 81650-2218

\* Commercial Base Pricing Priority Mail rates apply. Signature Confirmation service electronic fee required. Delivery information is not available by phone for the electronic rate. Refunds for unused postage paid labels can be requested online 10 days from the print date. A copy of the recipient's signature will be faxed or mailed upon request by visiting the web site listed below or calling 1-800-222-1811.



*Thank you for shipping with the United States Postal Service!  
Check the status of your shipment on the Track & Confirm page at [usps.com](http://usps.com)*