



Physical Address: 401 Arapahoe St.
Mail to: Box 384 Kiowa, CO 80117
Ph. 303-621-8672 - Fax 303-621-2717
www.highprairiesurvey.com

Job: 10177 Napali #9

Inv # 1805

High Prairie Surveying of Kiowa, Colorado has in accordance with a request from **Jack Fincham, Wiepking Fullerton Energy** has determined the location of **Napali #9** to be **1879 feet FNL**, and **1820 feet FEL**, (90° off Section lines) of **SECTION 17**, Township **10s**, Range **55w** of the 6th Principal Meridian, **Lincoln County**, Colorado.

Date: Staked on 2-28-12 drawn on 3-2-12.

Re: Staked by Keith Westfall

Drawn: Drawn by Elijah Frane

Location Drawing

There are no apparent improvements within 400 feet of the proposed well pad.

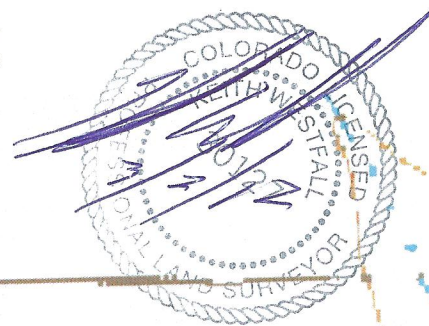

Wiepking Fullerton
NE 1/4 SEC. 17-10s-55w
Napali #9
Lincoln, Co. Colorado

