

SCALE: 1"= 100'  
CONTOUR  
INTERVAL 1'

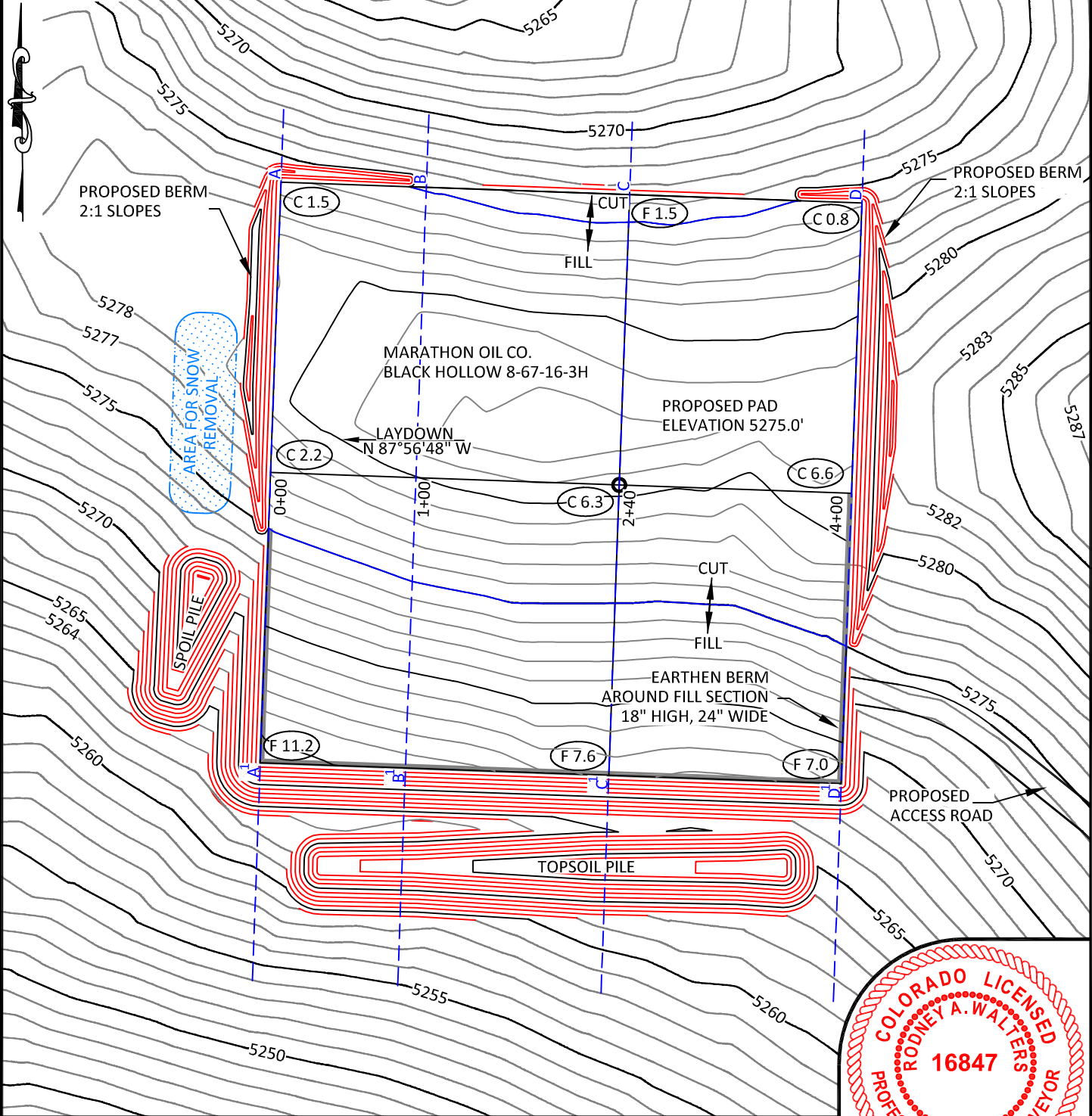

**NOTES:**

- Elevation of pad shown on plans are to constructed pad without final gravel padding placement. Depth, volume, and padding material to be determined by operator.
- The information contained in this plat is legally privileged and confidential information intended only for the use of the recipients. If you are not the intended recipients, you are hereby notified that any use, dissemination, distribution or copying of this information is strictly prohibited.

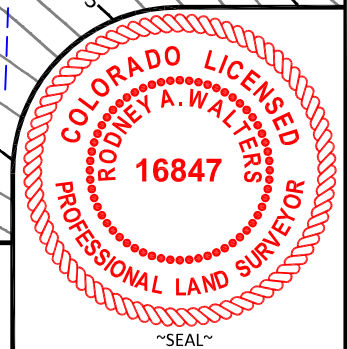

**WILLIAM H. SMITH  
& ASSOCIATES P.C.**  
SURVEYING CONSULTANTS  
550 EAST SECOND NORTH PHONE: 307-875-3638  
GREEN RIVER, WY 307-875-3639  
www.whsmithpc.com

**CONSTRUCTION DATA**

CUT SLOPE:	3:1
FILL SLOPE:	3:1
TOTAL CUT:	18,477 CU. YDS.
TOTAL FILL:	14,004 CU. YDS.
TOP SOIL AT 6"	3,444 CU. YDS.
SPOIL	1,029 CU. YDS.
DISTURBED AREA	185,986 SQ. FT.
DISTURBED AREA	4.27 ACRES

**LOCATION:**

BLACK HOLLOW  
8-67-16-3H  
WITHIN NW/4  
NE/4 SECTION 16,  
T 8 N, R 67 W,  
6TH PM.  
WELD COUNTY,  
COLORADO

**MARATHON OIL COMPANY**  
PO BOX 3128, HOUSTON TX, 77253  
5555 SAN FELIPE, HOUSTON TX, 77056

**CONSTRUCTION LAYOUT**

453 FNL	1955 FWL
SCALE: 1"=100'	EXHIBIT "I"
DATE: 3/5/2012	SHEET 8 OF 14



SCALE: 1"= 100'  
CONTOUR  
INTERVAL 1'

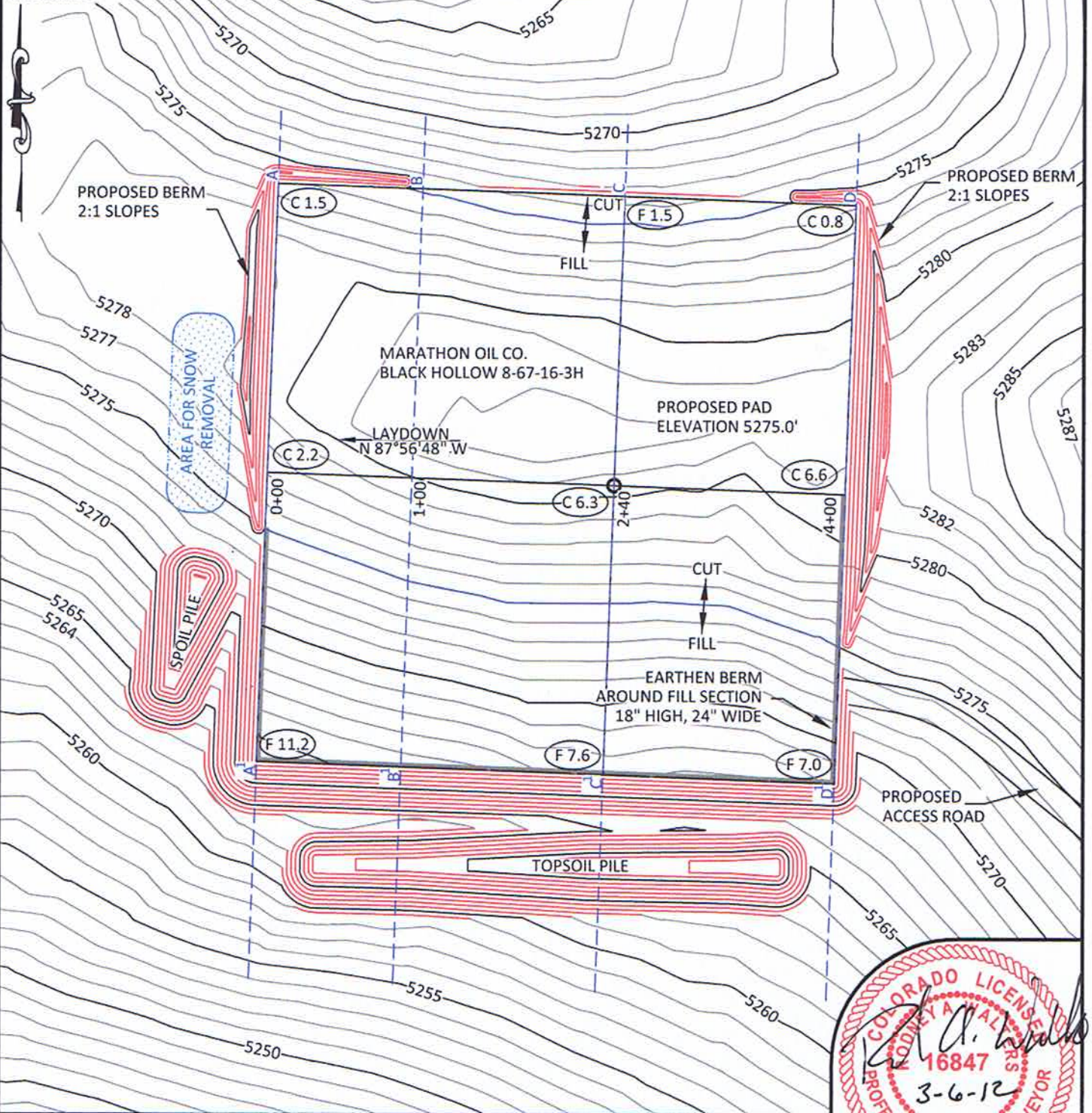

- NOTES:**
- Elevation of pad shown on plans are to constructed pad without final gravel padding placement. Depth, volume, and padding material to be determined by operator.
  - The information contained in this plat is legally privileged and confidential information intended only for the use of the recipients. If you are not the intended recipients, you are hereby notified that any use, dissemination, distribution or copying of this information is strictly prohibited.



**WILLIAM H. SMITH  
& ASSOCIATES P.C.**  
SURVEYING CONSULTANTS  
550 EAST SECOND NORTH PHONE: 307-875-3638  
GREEN RIVER, WY 307-875-3639  
www.wsmithpc.com

CONSTRUCTION DATA	
CUT SLOPE:	3:1
FILL SLOPE:	3:1
TOTAL CUT:	18,477 CU. YDS.
TOTAL FILL:	14,004 CU. YDS.
TOP SOIL AT 6"	3,444 CU. YDS.
SPOIL:	1,029 CU. YDS.
DISTURBED AREA	185,986 SQ. FT.
DISTURBED AREA	4.27 ACRES

**LOCATION:**  
BLACK HOLLOW  
8-67-16-3H  
WITHIN NW/4  
NE/4 SECTION 16,  
T 8 N, R 67 W,  
6TH PM.  
WELD COUNTY,  
COLORADO

**MARATHON OIL COMPANY**  
PO BOX 3128, HOUSTON TX, 77253  
5555 SAN FELIPE, HOUSTON TX, 77056

**CONSTRUCTION LAYOUT**

453 FNL	1955 FWL
SCALE: 1"=100'	EXHIBIT "I"
DATE: 3/5/2012	SHEET 8 OF 14

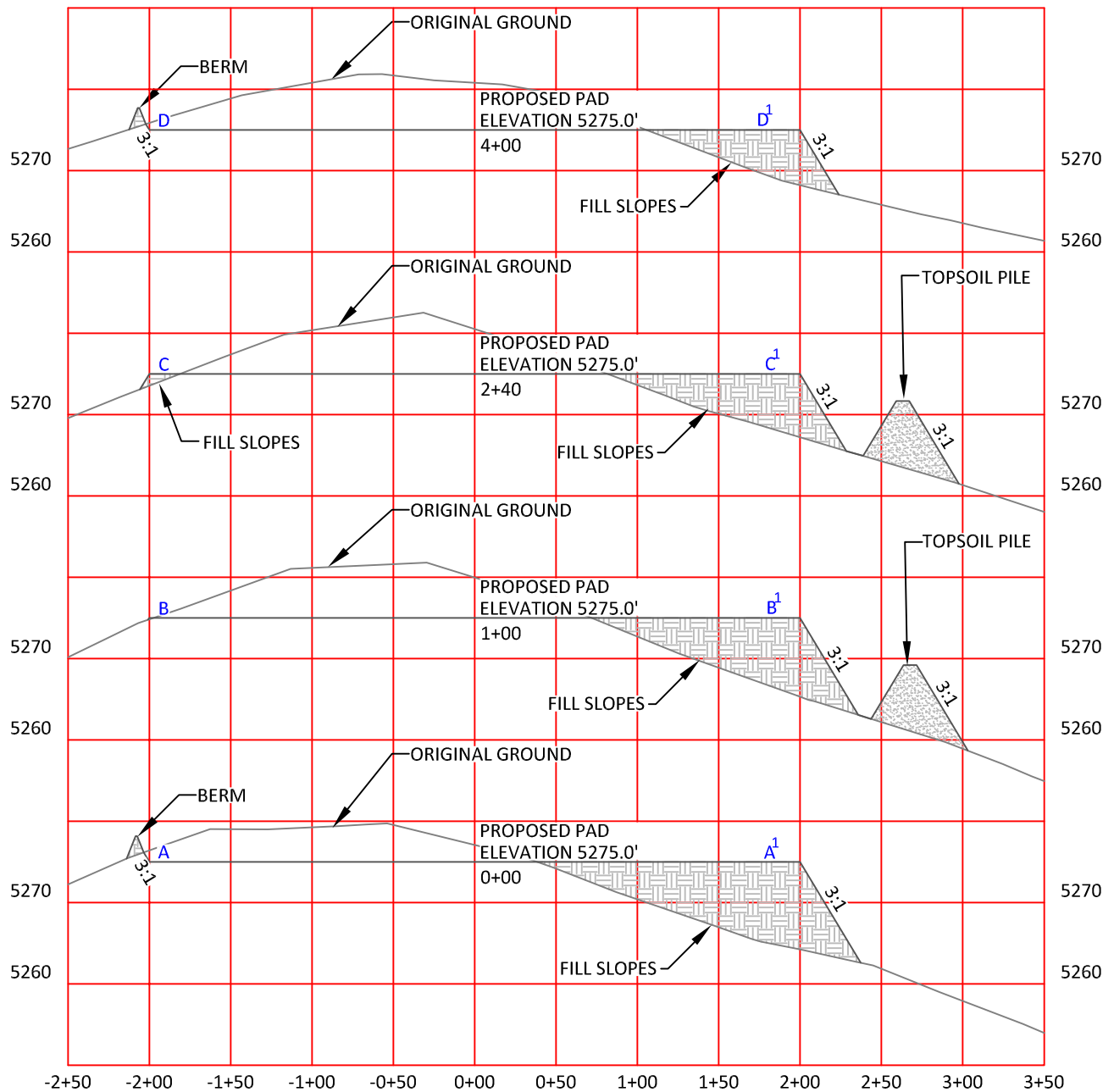

HORIZONTAL SCALE: 1"=100' - VERTICAL SCALE: 1"=20'

**NOTES:**

- Elevation of pad shown on plans are to constructed pad without final gravel padding placement. Depth, volume, and padding material to be determined by operator.
- The information contained in this plat is legally privileged and confidential information intended only for the use of the recipients. If you are not the intended recipients, you are hereby notified that any use, dissemination, distribution or copying of this information is strictly prohibited.



**WILLIAM H. SMITH  
& ASSOCIATES P.C.**

SURVEYING CONSULTANTS  
650 EAST SECOND NORTH PHONE: 307-875-3638  
GREEN RIVER, WY 307-875-3639  
www.whsmithpc.com

DRAWN BY: IBB CHECKED BY: RAW  
PROJECT NO: 867163H JOB NO: 2011001  
REVISIONS:

**CONSTRUCTION DATA**

CUT SLOPE:	3:1
FILL SLOPE:	3:1
TOTAL CUT:	18,477 CU. YDS.
TOTAL FILL:	14,004 CU. YDS.
TOP SOIL AT 6"	3,444 CU. YDS.
SPOIL	1,029 CU. YDS.
DISTURBED AREA	185,986 SQ. FT.
DISTURBED AREA	4.27 ACRES

**LOCATION:**

BLACK HOLLOW  
8-67-16-3H  
WITHIN NW/4  
NE/4 SECTION 16,  
T 8 N, R 67 W,  
6TH PM.  
WELD COUNTY,  
COLORADO

**MARATHON OIL COMPANY**  
PO BOX 3128, HOUSTON TX, 77253  
5555 SAN FELIPE, HOUSTON TX, 77056

**CONSTRUCTION LAYOUT  
CROSS SECTIONS**

SCALE: AS NOTED EXHIBIT "J"  
DATE: 3/5/2012 SHEET 9 OF 14



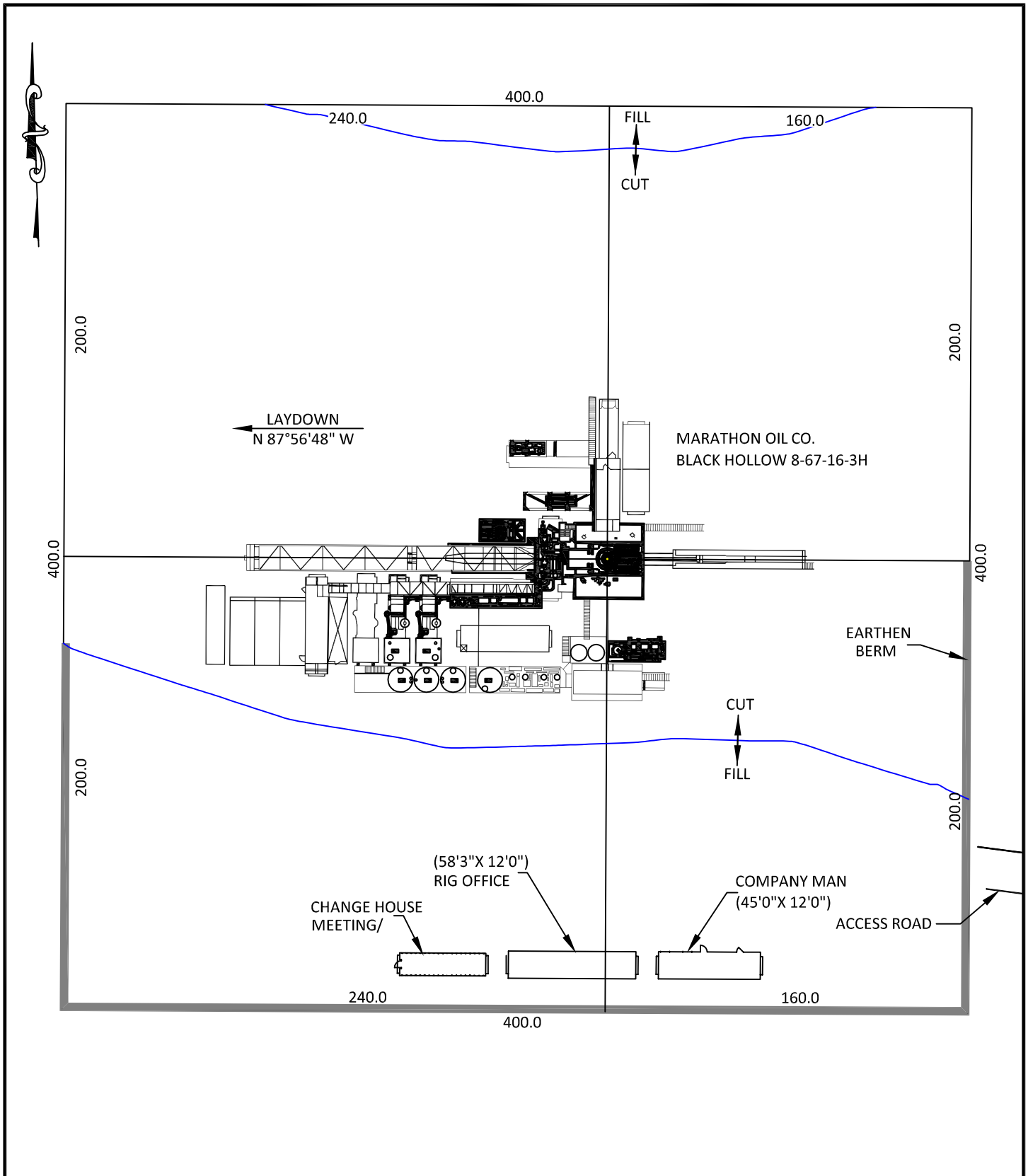

**WILLIAM H. SMITH  
& ASSOCIATES P.C.**

**SURVEYING CONSULTANTS**  
550 EAST SECOND NORTH PHONE: 307-875-3638  
GREEN RIVER, WY 307-875-3639  
www.whsmithpc.com

DRAWN BY: IBB	CHECKED BY: RAW
PROJECT NO: 867163H	JOB NO: 2011001
REVISIONS:	

**CONFIDENTIALITY NOTES:**

The information contained in this plat is legally privileged and confidential information intended only for the use of the recipients. If you are not the intended recipients, you are hereby notified that any use, dissemination, distribution or copying of this information is strictly prohibited.

**LOCATION:**

BLACK HOLLOW  
8-67-16-3H  
WITHIN NW/4  
NE/4 SECTION 16,  
T 8 N, R 67 W,  
6TH PM.  
WELD COUNTY,  
COLORADO

**MARATHON OIL COMPANY**  
PO BOX 3128, HOUSTON TX, 77253  
5555 SAN FELIPE, HOUSTON TX, 77056

**DRILLING FACILITIES**

SCALE: 1"=60'	EXHIBIT "K"
DATE: 3/5/2012	SHEET 10 OF 14

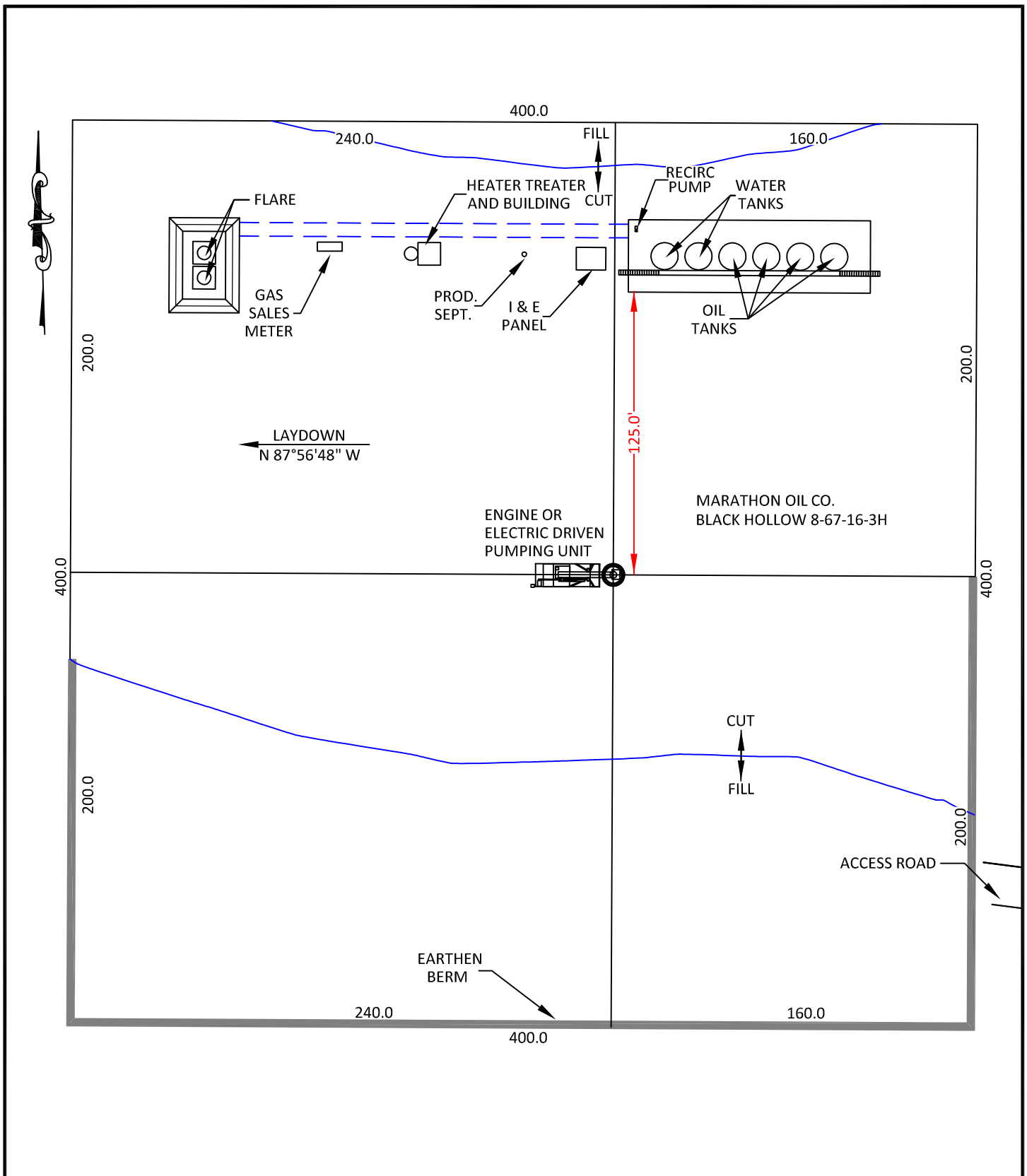

**WILLIAM H. SMITH  
& ASSOCIATES P.C.**

**SURVEYING CONSULTANTS**  
550 EAST SECOND NORTH PHONE: 307-875-3638  
GREEN RIVER, WY 307-875-3639  
www.whsmithpc.com

DRAWN BY: IBB CHECKED BY: RAW

PROJECT NO: 867163H JOB NO: 2011001

REVISIONS:

**CONFIDENTIALITY NOTES:**

The information contained in this plat is legally privileged and confidential information intended only for the use of the recipients. If you are not the intended recipients, you are hereby notified that any use, dissemination, distribution or copying of this information is strictly prohibited.

**LOCATION:**

BLACK HOLLOW  
8-67-16-3H  
WITHIN NW/4  
NE/4 SECTION 16,  
T 8 N, R 67 W,  
6TH PM.  
WELD COUNTY,  
COLORADO

**MARATHON OIL COMPANY**  
PO BOX 3128, HOUSTON TX, 77253  
5555 SAN FELIPE, HOUSTON TX, 77056

**PRODUCTION FACILITIES**

SCALE: 1"=60'

DATE: 3/5/2012

EXHIBIT "L"

SHEET 11 OF 14

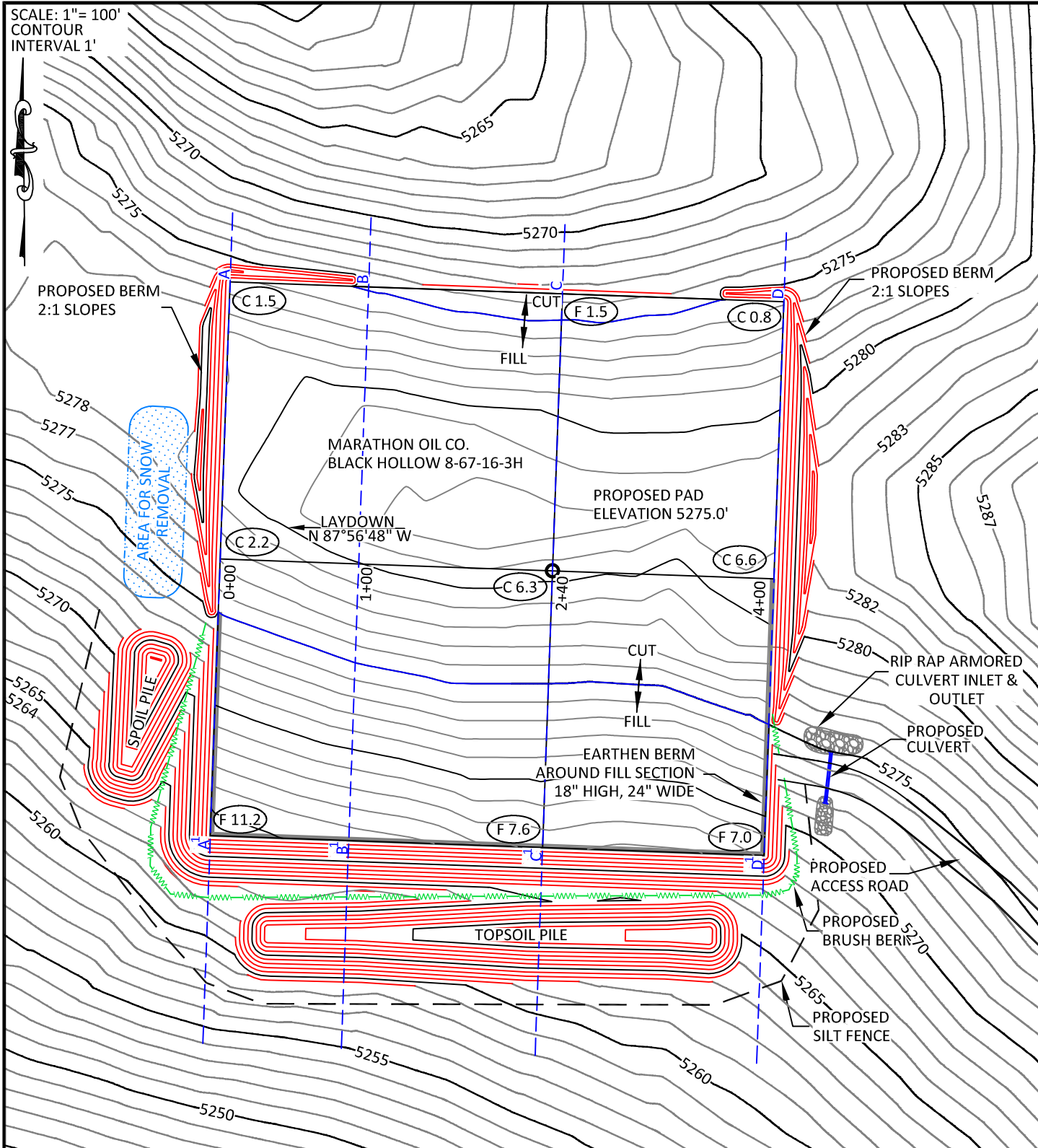

**CONFIDENTIALITY NOTES:**

The information contained in this plat is legally privileged and confidential information intended only for the use of the recipients. If you are not the intended recipients, you are hereby notified that any use, dissemination, distribution or copying of this information is strictly prohibited.



**WILLIAM H. SMITH  
& ASSOCIATES P.C.**  
SURVEYING CONSULTANTS

550 EAST SECOND NORTH PHONE: 307-875-3638  
GREEN RIVER, WY 307-875-3639  
www.whsmithpc.com

DRAWN BY: IBB

CHECKED BY: RAW

PROJECT NO: 867163H

JOB NO: 2011001

REVISIONS:

**LEGEND**

SILT FENCE

BRUSH BERM

EXISTING FENCE

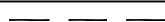

**LOCATION:**

BLACK HOLLOW  
8-67-16-3H  
WITHIN NW/4  
NE/4 SECTION 16,  
T 8 N, R 67 W,  
6TH PM.  
WELD COUNTY,  
COLORADO

**MARATHON OIL COMPANY**

PO BOX 3128, HOUSTON TX, 77253  
5555 SAN FELIPE, HOUSTON TX, 77056

**STORM WATER  
PREVENTION PLAN**

SCALE: 1" = 100'

DATE: 3/5/2012

EXHIBIT "M"

SHEET 12 of 14

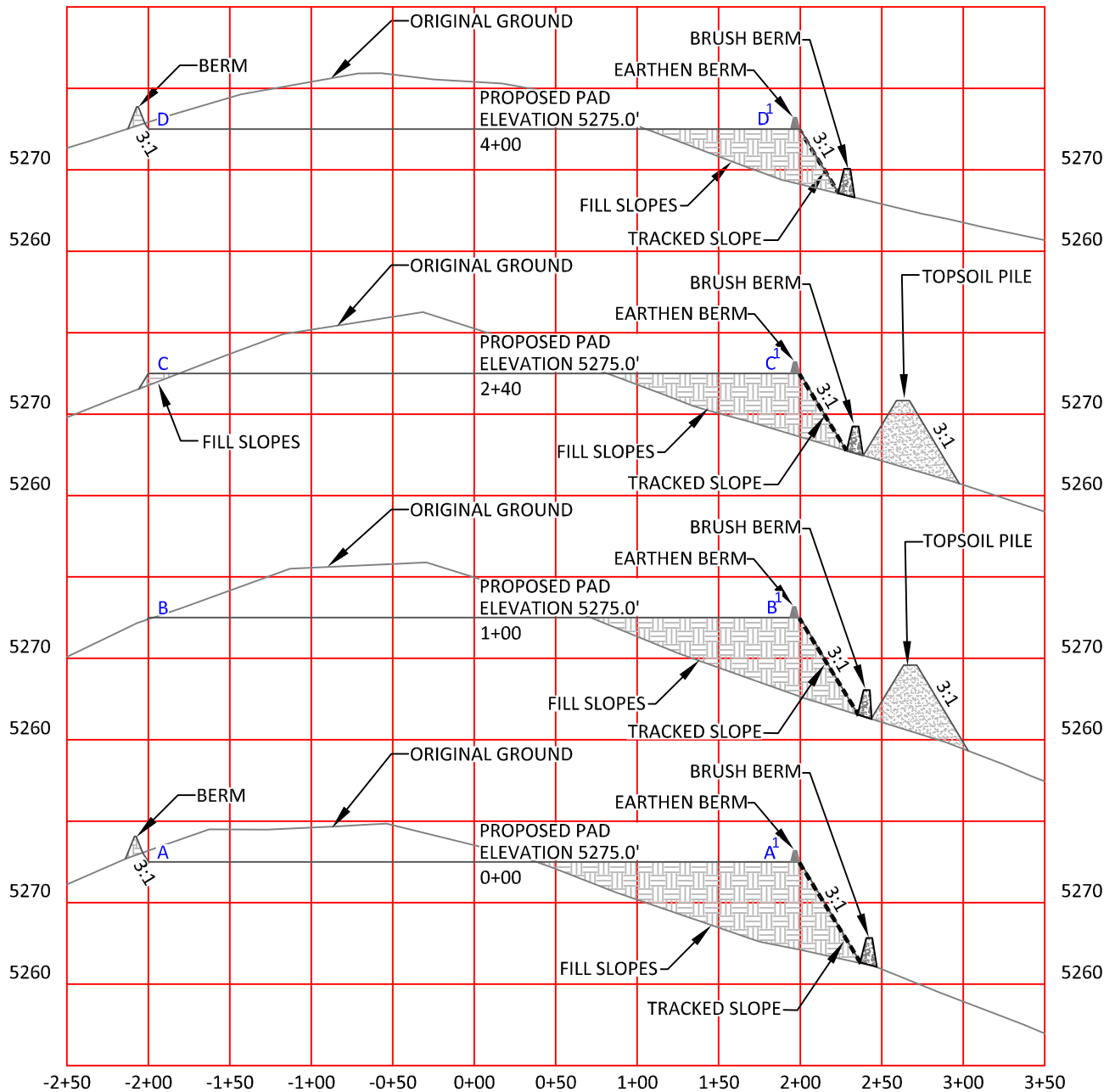

HORIZONTAL SCALE: 1"=100'  
VERTICAL SCALE: 1"=20'



**WILLIAM H. SMITH  
& ASSOCIATES P.C.**  
SURVEYING CONSULTANTS

650 EAST SECOND NORTH PHONE: 307-875-3638  
GREEN RIVER, WY 307-875-3639  
www.whsmithpc.com

DRAWN BY: IBB CHECKED BY: RAW  
PROJECT NO: 867163H JOB NO: 2011001  
REVISIONS:

**CONFIDENTIALITY NOTES:**

The information contained in this plat is legally privileged and confidential information intended only for the use of the recipients. If you are not the intended recipients, you are hereby notified that any use, dissemination, distribution or copying of this information is strictly prohibited.

**LOCATION:**

BLACK HOLLOW  
8-67-16-3H  
WITHIN NW/4  
NE/4 SECTION 16,  
T 8 N, R 67 W,  
6TH PM.  
WELD COUNTY,  
COLORADO

**MARATHON OIL COMPANY**  
PO BOX 3128, HOUSTON TX, 77253  
5555 SAN FELIPE, HOUSTON TX, 77056

**STORM WATER PREVENTION  
CROSS SECTIONS**

SCALE: AS NOTED EXHIBIT "N"  
DATE: 3/5/2012 SHEET 13 of 14

### A. FILL SLOPE TRACKING DETAILS

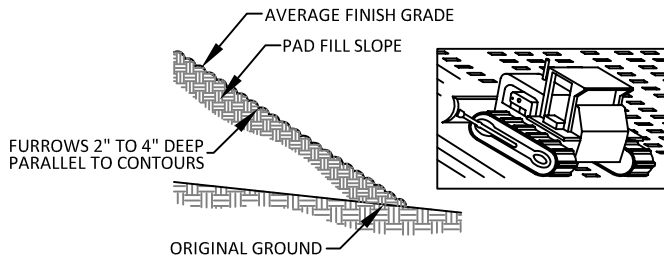

#### INSTALLATION NOTES:

1. DISTURBED SURFACES SHALL BE ROUGHENED USING RIPPING OR TILLING EQUIPMENT ON THE CONTOURS OR TRACKING UP AND DOWN THE SLOPE USING EQUIPMENT TREADS

### B. EARTHEN BERM DETAIL

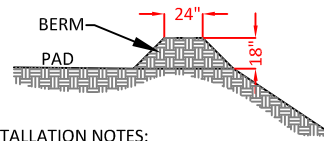

#### INSTALLATION NOTES:

1. BERM SHALL BE CONSTRUCTED OF WELL COMPACTED GRANULAR MATERIAL.
2. BERM SHALL BE CONSTRUCTED ON THE PERIMETER OF THE PAD IN ALL AREAS THAT COULD RECEIVE STORMWATER RUNOFF.
3. DIMENSIONS ARE APPROXIMATE. FIELD CONDITIONS WILL DETERMINE ACTUAL DIMENSIONS OF STRUCTURE.

### C. BRUSH BERM DETAIL

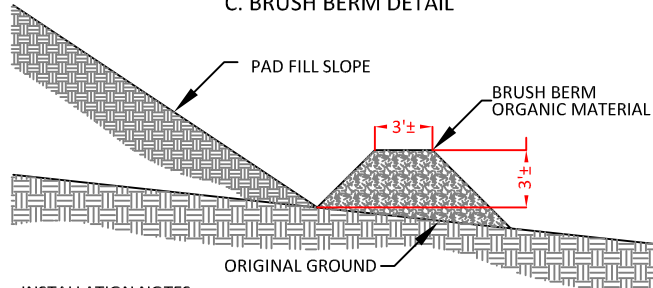

#### INSTALLATION NOTES:

1. BERM TO BE CONSTRUCTED AFTER SITE HAS BEEN GRUBBED PRIOR TO PAD CONSTRUCTION.
2. ONSITE ORGANIC MATERIAL TO BE PUSHED INTO BERM ON EDGE PERIMETER OF FILL SLOPE IN A MANNER NOT TO CREATE ADDITIONAL DISTURBANCE BEYOND THE CATCH LINE.
3. BERM TO BE COMPACTED WITH FRONT END LOADER BUCKET OR SIMILAR METHOD TO ACHIEVE ADEQUATE COMPACTION.

### D. SILT FENCE DETAILS

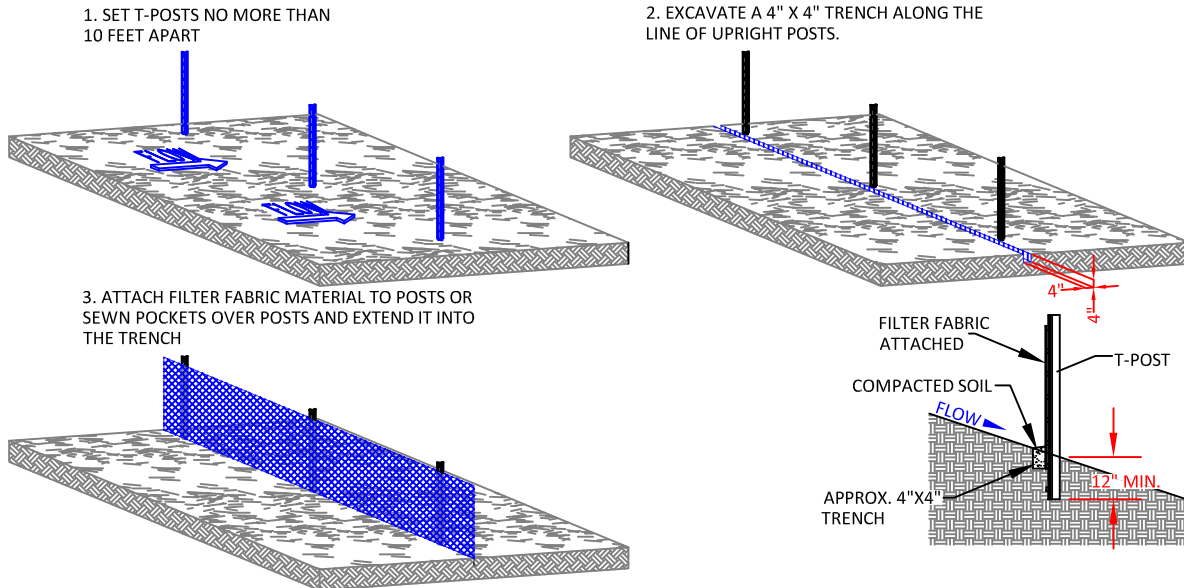

#### CONFIDENTIALITY NOTES:

The information contained in this plat is legally privileged and confidential information intended only for the use of the recipients. If you are not the intended recipients, you are hereby notified that any use, dissemination, distribution or copying of this information is strictly prohibited.



**WILLIAM H. SMITH  
& ASSOCIATES P.C.**  
SURVEYING CONSULTANTS

550 EAST SECOND NORTH PHONE: 307-875-3638  
GREEN RIVER, WY 307-875-3639  
www.whsmithpc.com

DRAWN BY: IBB CHECKED BY: RAW  
PROJECT NO: 867163H JOB NO: 2011001  
REVISIONS:

#### USED ON THIS SITE

- A: EARTHEN BERM AT TOP OF SLOPE  
AROUND FILL SECTIONS
- B: BRUSH BERM AT TOE OF SLOPE  
AROUND FILL SECTIONS
- C: SILT FENCE
- D: FILL SLOPE TRACKING

#### LOCATION:

BLACK HOLLOW  
8-67-16-3H  
WITHIN NW/4  
NE/4 SECTION 16,  
T 8 N, R 67 W,  
6TH PM.  
WELD COUNTY,  
COLORADO

**MARATHON OIL COMPANY**  
PO BOX 3128, HOUSTON TX, 77253  
5555 SAN FELIPE, HOUSTON TX, 77056

#### STORM WATER PREVENTION DETAILS

SCALE: NOT TO SCALE  
DATE: 3/5/2012

EXHIBIT "O"  
SHEET 14 of 14