

**LEASE MAP**  
**FRAZIER PC G33-67HN**

PROPOSED WELLBORE SPACING UNIT

**N/2 of Sec 33, T4N-R65W\***

Weld County, CO

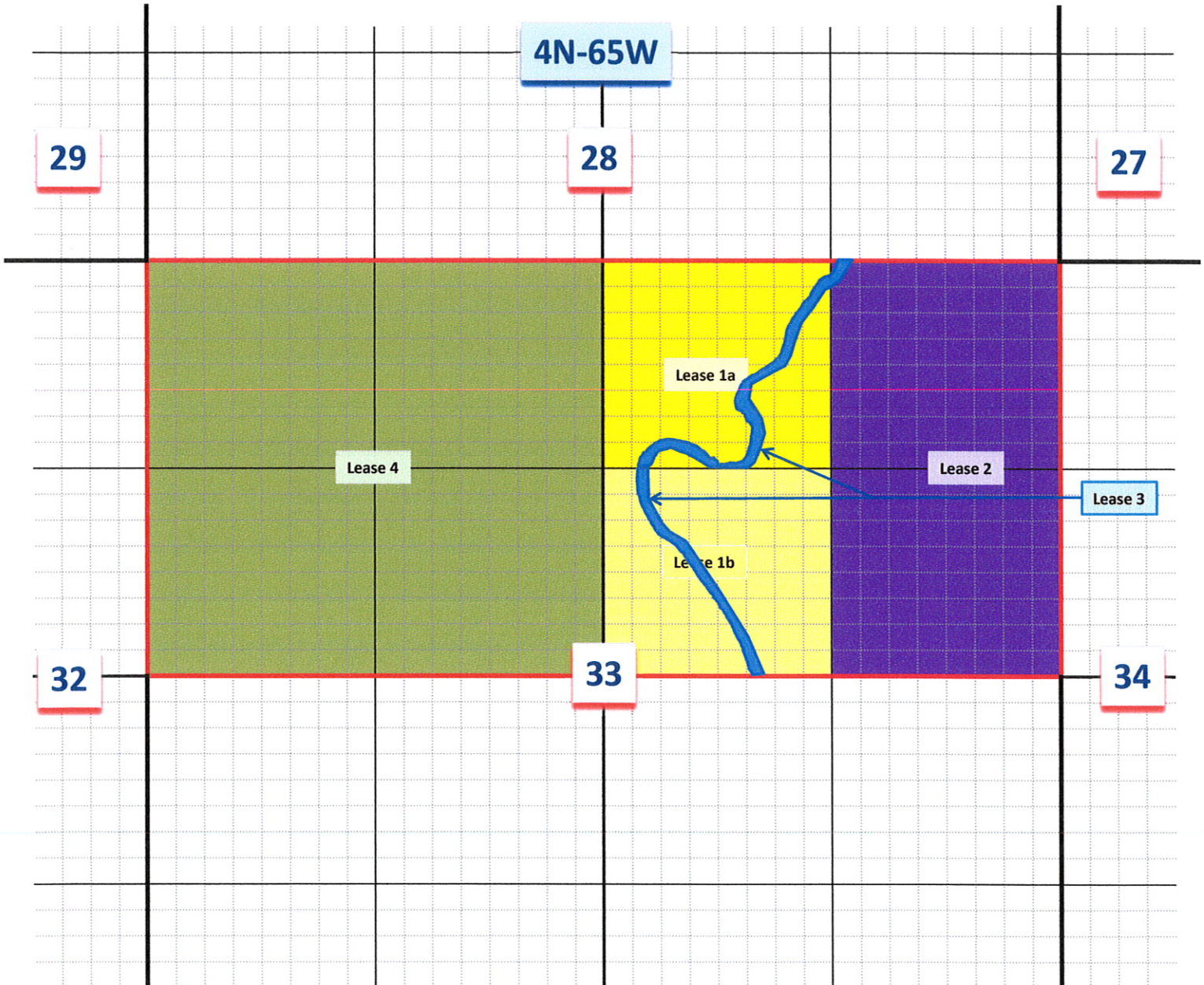

\*of the 6th P.M., Weld Co., CO



**LEASE MAP**  
**FRAZIER PC G33-67HN**  
**N/2 of Sec 33, T4N-R65W\***  
Weld County, CO

LEASE NO	TSH-RNG	SEC	TRACT	GR AC
1a	4N-65W	33	NW/4NE/4	40.0000
1b	4N-65W	33	SW/4NE/4	40.0000
2	4N-65W	33	E/2NE/4 less 5.04 ac tract deeded to The Platte Valley Irrigation Company	74.9600
3	4N-65W	33	7.08 ac tract deeded The Platte Valley Irrigation Company	7.0800
4	4N-64W	7	Lots 1 & 2 (W/2W/2), E/2W/2, SE/4	450.84
		17	NW/4, S/2	480.00
		19	Lots 1 & 2 (W/2W/2), E/2W/2, SE/4	452.32
		29	NW/4, S/2	480.00
		31	Lots 1 & 2 (W/2W/2), E/2W/2, SE/4	456.72
	5N-64W	7	Lot 1 (W/2NW/4)	72.10
		9	SE/4SW/4	40.00
		15	SW/4NE/4, S/2NW/4	120.00
		23	NW/4, S/2 except R/W	468.14
		29	NW/4, S/2	480.00
		31	NW/4, S/2	480.00
		35	W/2SW/4, SE/4SW/4	120.00
	3N-65W	3	Lot 2 (NW/4NE/4), S/2NE	120.26
	4N-65W	25	NW/4, S/2	480.00
		33	NW/4, S/2	480.00
		35	NW/4, S/2	480.00
TOTAL GROSS ACRES				5,822.4200

\*of the 6th P.M., Weld Co., CO