

PROPOSED ACCESS ROAD LOCATION

BEGIN ROAD: END ROAD:
 LAT 40.337485N LAT 40.334162N
 LONG 104.440597W LONG 104.438809W

OWNERSHIP TABULATION

WELL LOCATION SURFACE OWNER:
 PARK

PROPOSED ACCESS ROAD SURFACE OWNER:
 PARK (1180')

ROAD TABULATION*

LEGEND	TYPE	LENGTH
	PROPOSED ACCESS	130'
	EXISTING 2-TRACK	0'
	EXISTING ACCESS	1,050'

*NOTES:

1. WELL INFORMATION SHOWN ON THIS MAP OBTAINED FROM THE COGCC. WELLS SHOWN MAY BE PERMITTED BUT NOT EXIST IN THE FIELD.

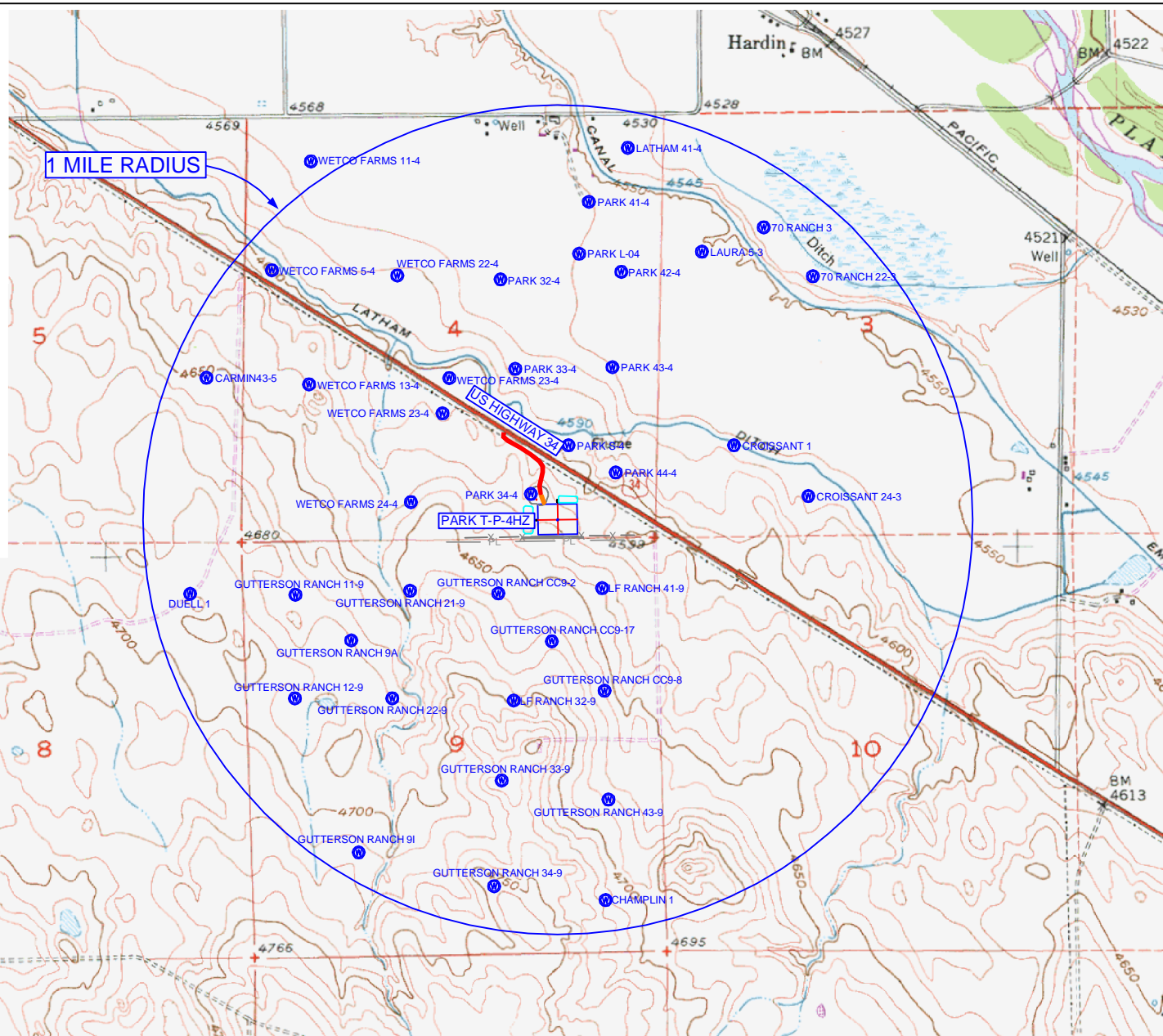

LOWHAM WALSH LLC
 Engineering & Environmental Services

205 S. THIRD ST.
 LANDER, WY 82520
 (307) 335-8466 (O)
 (307) 335-7343 (F)

Drawn By: DAF

Checked By: ATS

Date: 3/1/2012

Revision:

Date:

Sheet: 6 of 7

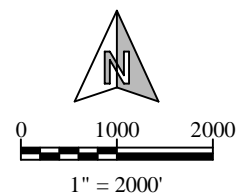

BONANZA CREEK ENERGY
PARK T-P-4HZ
PROPOSED ACCESS MAP
 220' FSL, 1200' FEL,
 SE¼SE¼, SECTION 4
 T4N, R63W, 6th PM
WELD COUNTY, COLORADO