

Azimuths to True North
Magnetic North: 8.74°

Magnetic Field
Strength: 53204.5nT
Dip Angle: 67.19°
Date: 8/30/2011
Model: IGRF2010

DD Bayswater Robel 14-28 115495/116855					
WELL @ 4862.0ft (Original Well Elev) North American Datum 1983 Well Bayswater Robel 14-28, True North					
Target	Bayswater Robel 14-28	Azimuth	Origin Type	N/S	E/W From TVD
		621.53	Slot	0.0	0.0
Name	TVD	+N/-S	+E/-W	Latitude	Longitude
Bayswater Robel 14-28 TGT	5000.0	-621.2	937.6	40.538505	-104.557675
Bayswater Robel 14-28 BHL	7320.0	-621.2	937.6	40.538505	-104.557675

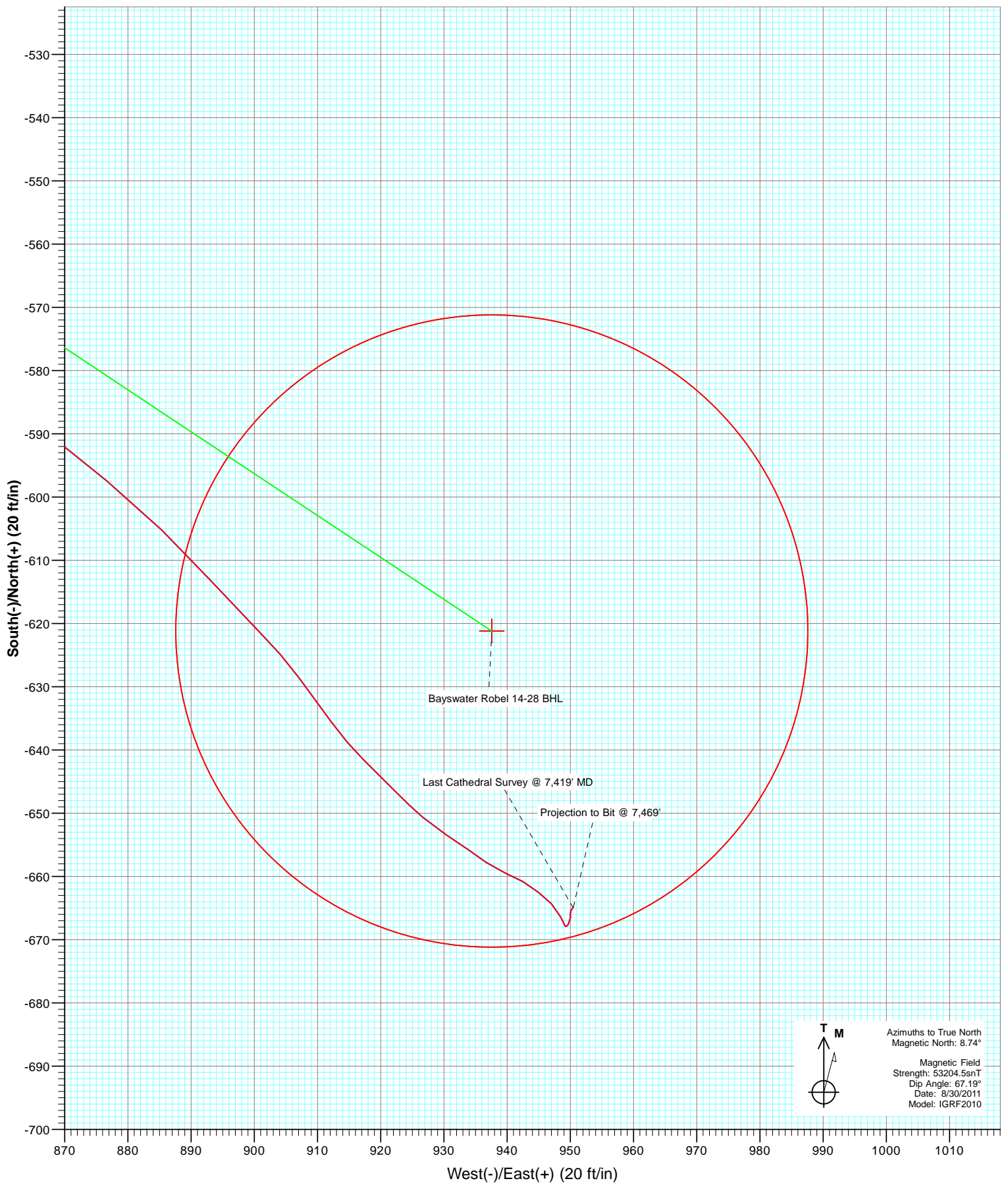

Cathedral Energy Services

Survey Report

Company:	Bayswater Exploration & Production, LLC	Local Co-ordinate Reference:	Well Bayswater Robel 14-28
Project:	Weld County, CO	TVD Reference:	WELL @ 4862.0ft (Original Well Elev)
Site:	SEC 28 T7N R64W	MD Reference:	WELL @ 4862.0ft (Original Well Elev)
Well:	Bayswater Robel 14-28	North Reference:	True
Wellbore:	DD	Survey Calculation Method:	Minimum Curvature
Design:	DD	Database:	USA EDM 5000 Multi Users DB

Project	Weld County, CO		
Map System:	US State Plane 1983	System Datum:	Mean Sea Level
Geo Datum:	North American Datum 1983		
Map Zone:	Colorado Northern Zone		

Site		SEC 28 T7N R64W			
Site Position:		Northing:	1,441,053.76 ft	Latitude:	40.540292
From:	Lat/Long	Easting:	3,260,958.23 ft	Longitude:	-104.561084
Position Uncertainty:	0.0 ft	Slot Radius:	13.200 in	Grid Convergence:	0.61 °

Well	Bayswater Robel 14-28					
Well Position	+N/-S	0.0 ft	Northing:	1,441,023.86 ft	Latitude:	40.540210
	+E/-W	0.0 ft	Easting:	3,260,968.55 ft	Longitude:	-104.561048
Position Uncertainty		0.0 ft	Wellhead Elevation:	ft	Ground Level:	4,852.0 ft

Wellbore	DD				
Magnetics	Model Name	Sample Date	Declination (°)	Dip Angle (°)	Field Strength (nT)
	IGRF2010	8/30/2011	8.74	67.19	53,204

Design	DD			
Audit Notes:				
Version:	1.0	Phase:	ACTUAL	Tie On Depth: 0.0
Vertical Section:	Depth From (TVD) (ft)	+N/-S (ft)	+E/-W (ft)	Direction (°)
	0.0	0.0	0.0	123.53

Survey Program	Date	11/4/2011			
From	To	Survey (Wellbore)	Tool Name	Description	
(ft)	(ft)				
789.0	7,469.0	Survey #1 (DD)	MWD	Geolink MWD	

Survey									
Measured	Inclination	Azimuth	Vertical	+N/-S	+E/-W	Vertical	Dogleg	Build	Formations /
Depth	(°)	(°)	Depth	(ft)	(ft)	Section	Rate	Rate	Comments
(ft)			(ft)			(ft)	(°/100ft)	(°/100ft)	
0.0	0.00	0.00	0.0	0.0	0.0	0.0	0.00	0.00	
789.0	0.40	138.60	789.0	-2.1	1.8	2.7	0.05	0.05	
884.0	1.80	132.30	884.0	-3.3	3.1	4.5	1.48	1.47	
980.0	4.40	132.10	979.8	-6.8	7.0	9.6	2.71	2.71	
1,076.0	6.10	131.90	1,075.4	-12.7	13.5	18.3	1.77	1.77	
1,172.0	8.60	125.50	1,170.6	-20.3	23.2	30.5	2.74	2.60	
1,267.0	10.50	128.60	1,264.3	-29.8	35.7	46.2	2.07	2.00	
1,363.0	12.60	127.50	1,358.4	-41.6	50.9	65.4	2.20	2.19	
1,457.0	13.90	122.30	1,449.9	-53.9	68.5	86.9	1.87	1.38	
1,551.0	15.80	128.20	1,540.7	-67.8	88.1	110.9	2.58	2.02	
1,645.0	17.50	123.10	1,630.8	-83.5	110.0	137.8	2.38	1.81	
1,741.0	19.10	124.00	1,721.9	-100.1	135.2	168.0	1.69	1.67	
1,835.0	20.40	120.40	1,810.4	-117.0	162.0	199.7	1.89	1.38	

Cathedral Energy Services

Survey Report

Company:	Bayswater Exploration & Production, LLC	Local Co-ordinate Reference:	Well Bayswater Robel 14-28
Project:	Weld County, CO	TVD Reference:	WELL @ 4862.0ft (Original Well Elev)
Site:	SEC 28 T7N R64W	MD Reference:	WELL @ 4862.0ft (Original Well Elev)
Well:	Bayswater Robel 14-28	North Reference:	True
Wellbore:	DD	Survey Calculation Method:	Minimum Curvature
Design:	DD	Database:	USA EDM 5000 Multi Users DB

Survey									
Measured Depth (ft)	Inclination (°)	Azimuth (°)	Vertical Depth (ft)	+N/-S (ft)	+E/-W (ft)	Vertical Section (ft)	Dogleg Rate (°/100ft)	Build Rate (°/100ft)	Formations / Comments
1,931.0	20.50	123.80	1,900.3	-134.8	190.4	233.2	1.24	0.10	
2,024.0	19.10	124.50	1,987.8	-152.5	216.5	264.7	1.53	-1.51	
2,118.0	20.30	123.80	2,076.3	-170.3	242.7	296.4	1.30	1.28	
2,212.0	19.00	120.70	2,164.9	-187.2	269.4	328.0	1.77	-1.38	
2,307.0	19.30	123.20	2,254.6	-203.7	295.9	359.2	0.92	0.32	
2,402.0	19.80	123.30	2,344.1	-221.1	322.5	390.9	0.53	0.53	
2,498.0	20.30	124.90	2,434.3	-239.6	349.7	423.9	0.77	0.52	
2,593.0	18.20	125.50	2,524.0	-257.6	375.3	455.2	2.22	-2.21	
2,687.0	18.50	125.00	2,613.2	-274.7	399.5	484.7	0.36	0.32	
2,783.0	19.40	127.00	2,704.0	-293.0	424.7	515.9	1.16	0.94	
2,878.0	20.30	127.90	2,793.4	-312.6	450.3	548.1	1.00	0.95	
2,973.0	20.90	127.70	2,882.3	-333.1	476.7	581.4	0.64	0.63	
3,066.0	19.70	127.10	2,969.5	-352.7	502.3	613.6	1.31	-1.29	
3,159.0	19.20	128.70	3,057.2	-371.7	526.8	644.5	0.79	-0.54	
3,254.0	20.50	127.00	3,146.6	-391.5	552.2	676.6	1.50	1.37	
3,348.0	20.00	124.20	3,234.8	-410.5	578.7	709.1	1.16	-0.53	
3,444.0	19.90	119.70	3,325.0	-427.8	606.5	741.8	1.60	-0.10	
3,539.0	18.00	120.80	3,414.8	-443.3	633.1	772.6	2.03	-2.00	
3,634.0	15.60	120.70	3,505.8	-457.4	656.7	800.1	2.53	-2.53	
3,728.0	13.80	121.20	3,596.7	-469.6	677.2	823.9	1.92	-1.91	
3,822.0	11.70	119.00	3,688.4	-480.1	695.1	844.6	2.29	-2.23	
3,917.0	10.30	122.80	3,781.6	-489.3	710.7	862.7	1.66	-1.47	
4,012.0	10.00	121.10	3,875.2	-498.2	724.9	879.4	0.45	-0.32	
4,107.0	11.80	122.40	3,968.4	-507.7	740.1	897.4	1.91	1.89	
4,201.0	12.60	121.20	4,060.3	-518.1	757.0	917.2	0.89	0.85	
4,296.0	12.60	122.60	4,153.0	-529.1	774.6	937.9	0.32	0.00	
4,391.0	11.80	121.20	4,245.9	-539.7	791.6	958.0	0.90	-0.84	
4,486.0	11.20	121.80	4,339.0	-549.6	807.8	976.9	0.64	-0.63	
4,582.0	9.60	125.80	4,433.4	-559.2	822.2	994.3	1.83	-1.67	
4,677.0	8.50	124.00	4,527.2	-567.7	834.5	1,009.2	1.20	-1.16	
4,772.0	7.20	123.60	4,621.3	-574.9	845.2	1,022.2	1.37	-1.37	
4,867.0	8.70	122.80	4,715.4	-582.1	856.2	1,035.3	1.58	1.58	
4,960.0	7.90	127.60	4,807.4	-589.8	867.2	1,048.7	1.14	-0.86	
5,053.0	7.20	130.00	4,899.6	-597.5	876.7	1,060.9	0.83	-0.75	
5,149.0	6.70	133.80	4,994.9	-605.2	885.4	1,072.4	0.71	-0.52	
5,244.0	6.90	137.90	5,089.2	-613.3	893.2	1,083.4	0.55	0.21	
5,340.0	6.20	135.00	5,184.6	-621.2	900.7	1,094.0	0.81	-0.73	
5,435.0	5.50	143.80	5,279.1	-628.6	907.1	1,103.3	1.20	-0.74	
5,530.0	5.10	143.80	5,373.7	-635.6	912.2	1,111.5	0.42	-0.42	
5,624.0	4.30	134.60	5,467.4	-641.5	917.2	1,118.9	1.17	-0.85	
5,717.0	4.30	135.20	5,560.1	-646.4	922.2	1,125.8	0.05	0.00	
5,813.0	3.00	130.50	5,655.9	-650.6	926.6	1,131.8	1.39	-1.35	
5,904.0	2.90	123.30	5,746.8	-653.4	930.3	1,136.4	0.42	-0.11	
5,998.0	2.20	124.50	5,840.7	-655.7	933.8	1,140.6	0.75	-0.74	
6,092.0	2.10	126.10	5,934.7	-657.8	936.7	1,144.2	0.12	-0.11	
6,187.0	2.10	112.30	6,029.6	-659.4	939.7	1,147.6	0.53	0.00	
6,283.0	1.60	120.50	6,125.6	-660.8	942.5	1,150.7	0.59	-0.52	
6,377.0	2.00	128.10	6,219.5	-662.5	944.9	1,153.6	0.49	0.43	
6,472.0	1.40	135.90	6,314.5	-664.3	947.0	1,156.4	0.68	-0.63	
6,566.0	1.70	152.50	6,408.4	-666.4	948.5	1,158.7	0.57	0.32	
6,662.0	0.10	189.30	6,504.4	-667.7	949.1	1,160.0	1.69	-1.67	
6,756.0	0.20	116.60	6,598.4	-667.9	949.2	1,160.2	0.21	0.11	
6,852.0	0.30	39.20	6,694.4	-667.8	949.6	1,160.4	0.34	0.10	

Cathedral Energy Services

Survey Report

Company:	Bayswater Exploration & Production, LLC	Local Co-ordinate Reference:	Well Bayswater Robel 14-28
Project:	Weld County, CO	TVD Reference:	WELL @ 4862.0ft (Original Well Elev)
Site:	SEC 28 T7N R64W	MD Reference:	WELL @ 4862.0ft (Original Well Elev)
Well:	Bayswater Robel 14-28	North Reference:	True
Wellbore:	DD	Survey Calculation Method:	Minimum Curvature
Design:	DD	Database:	USA EDM 5000 Multi Users DB

Survey									
Measured Depth (ft)	Inclination (°)	Azimuth (°)	Vertical Depth (ft)	+N/-S (ft)	+E/-W (ft)	Vertical Section (ft)	Dogleg Rate (°/100ft)	Build Rate (°/100ft)	Formations / Comments
6,946.0	0.10	351.70	6,788.4	-667.5	949.7	1,160.4	0.26	-0.21	
7,043.0	0.40	24.80	6,885.4	-667.1	949.8	1,160.3	0.33	0.31	
7,135.0	0.40	12.30	6,977.4	-666.5	950.0	1,160.1	0.09	0.00	
7,231.0	0.40	343.00	7,073.4	-665.9	950.0	1,159.7	0.21	0.00	
7,327.0	0.40	46.00	7,169.4	-665.3	950.2	1,159.5	0.44	0.00	
7,419.0	0.20	22.20	7,261.4	-664.9	950.4	1,159.6	0.25	-0.22	Last Cathedral Survey @ 7,419' MD Projection to Bit @ 7,469'
7,469.0	0.20	22.20	7,311.4	-664.8	950.5	1,159.5	0.00	0.00	

Targets									
Target Name	Dip Angle (°)	Dip Dir. (°)	TVD (ft)	+N/-S (ft)	+E/-W (ft)	Northing (ft)	Easting (ft)	Latitude	Longitude
Bayswater Robel 14-28 - hit/miss target - Shape	0.00	0.00	7,320.0	-621.2	937.6	1,440,412.64	3,261,912.66	40.538505	-104.557675
- survey misses target center by 46.3ft at 7469.0ft MD (7311.4 TVD, -664.8 N, 950.5 E) - Circle (radius 50.0)									
Bayswater Robel 14-28 - survey misses target center by 53.8ft at 5159.7ft MD (5005.5 TVD, -606.1 N, 886.3 E) - Point	0.00	0.00	5,000.0	-621.2	937.6	1,440,412.64	3,261,912.66	40.538505	-104.557675

Survey Annotations				
Measured Depth (ft)	Vertical Depth (ft)	Local Coordinates		Comment
		+N/-S (ft)	+E/-W (ft)	
7,419.0	7,261.4	-664.9	950.4	Last Cathedral Survey @ 7,419' MD
7,469.0	7,311.4	-664.8	950.5	Projection to Bit @ 7,469'

Checked By: _____ Approved By: _____ Date: _____