

Well Name: **Schell 42-6**

Surface Location: Schell 41-6 Pad Sec.6-T3N-R67W
North American Datum 1983 US State Plane 1983 Colorado Northern Zone

Ground Elevation: 4916.0

+N/-S	+E/-W	Northing	Easting	Latitude	Longitude
0.0	0.0	1338847.50	3159756.40	40.262120	-104.927550

Original Well Elev WELL @ 4929.0ft (Original Well Elev)

Slot

Sundance Energy, Weld County, CO

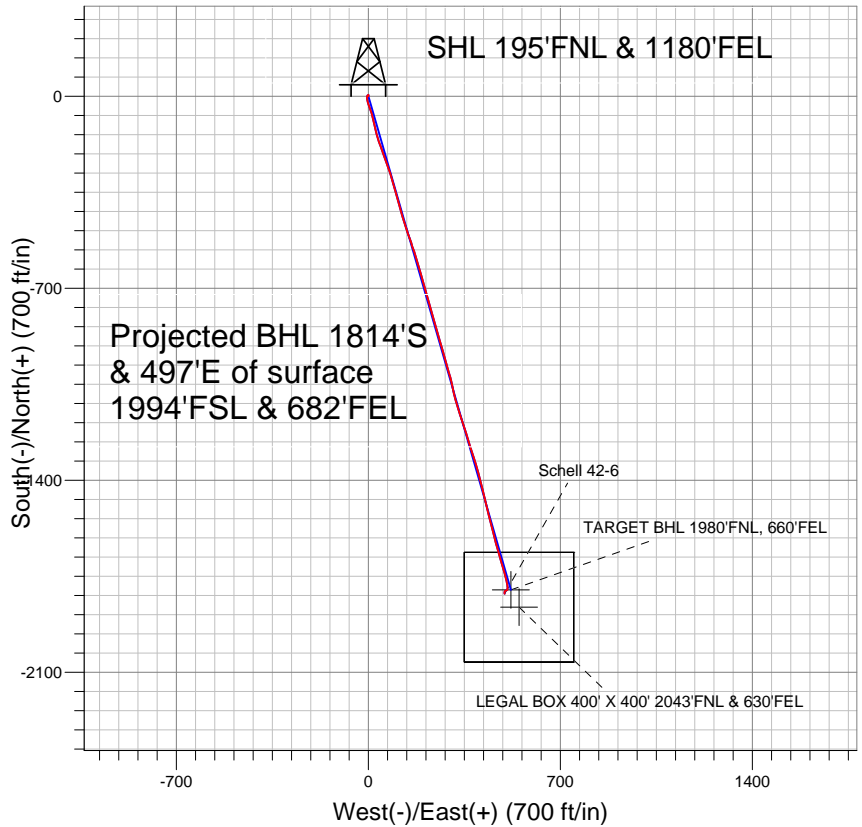

LEGEND

- ✕ Schell 42-6, Wellbore #1, Plan #3 (4-19-11) V0
- Wellbore #1
- Survey #1

Final Survey Plot

Projected Final Survey -
7779'MD & 7403'TVD @ 1880'VS
0.3 deg Inc 125.9 deg AZ

Project: SEC.6-T3N-R67W
Site: Schell 41-6 Pad Sec.6-T3N-R67W
Well: Schell 42-6
Plan: Wellbore #1

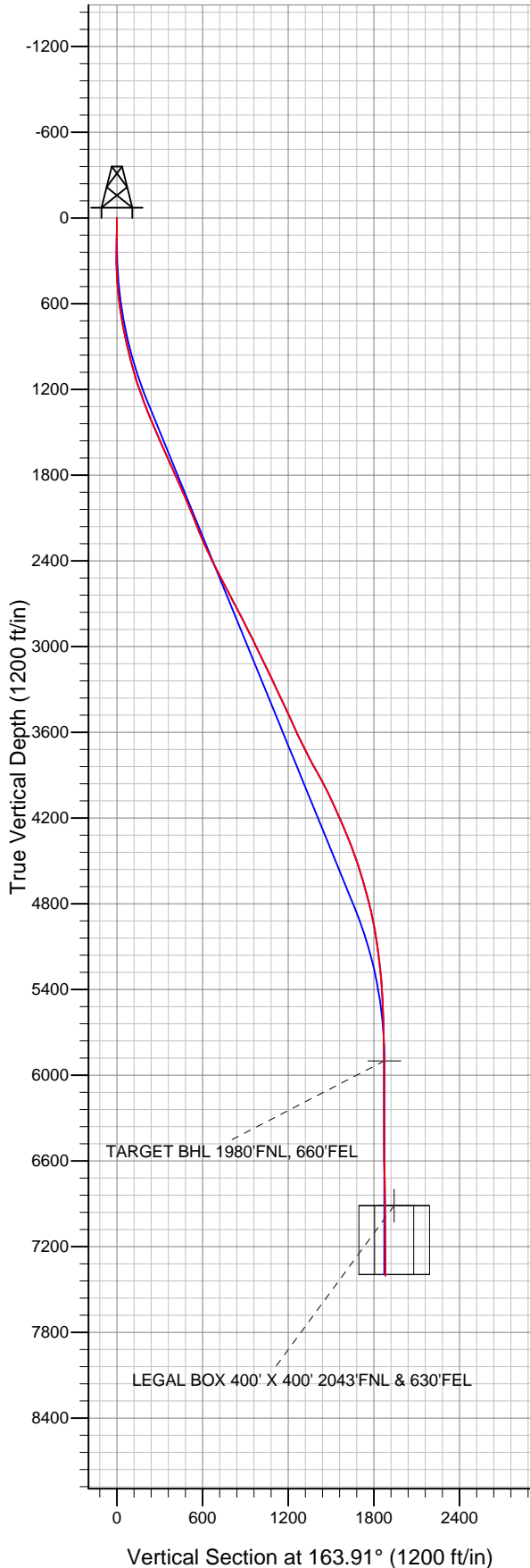



Directional

Sundance Energy, Weld County, CO

SEC.6-T3N-R67W

Schell 41-6 Pad Sec.6-T3N-R67W

Schell 42-6

Wellbore #1

Survey: Survey #1

Standard Survey Report

22 July, 2011

Survey	Survey Data									
	Measured Depth (ft)	Inclination (°)	Azimuth (°)	Vertical Depth (ft)	+N/-S (ft)	+E/-W (ft)	Vertical Section (ft)	Dogleg Rate (°/100ft)	Build Rate (°/100ft)	Turn Rate (°/100ft)
	0.0	0.00	0.00	0.0	0.0	0.0	0.0	0.00	0.00	0.00
	152.0	2.00	14.00	152.0	2.6	0.6	-2.3	1.32	1.32	0.00
	244.0	1.10	300.20	243.9	4.6	0.3	-4.3	2.17	-0.98	-80.22
	336.0	2.60	234.40	335.9	3.8	-2.2	-4.3	2.58	1.63	-71.52
	432.0	4.70	194.10	431.7	-1.3	-4.9	-0.1	3.33	2.19	-41.98
	525.0	6.60	169.90	524.3	-10.2	-4.9	8.5	3.23	2.04	-26.02
	620.0	8.40	165.10	618.5	-22.3	-2.2	20.8	2.00	1.89	-5.05
	663.0	8.90	160.70	661.0	-28.5	-0.3	27.3	1.93	1.16	-10.23
	835.0	11.20	160.70	830.3	-56.8	9.7	57.3	1.34	1.34	0.00
	929.0	13.10	166.40	922.2	-75.8	15.2	77.0	2.39	2.02	6.06
	1,023.0	14.60	168.00	1,013.5	-97.7	20.1	99.5	1.65	1.60	1.70
	1,116.0	17.20	167.60	1,102.9	-122.6	25.5	124.9	2.80	2.80	-0.43
	1,210.0	19.30	162.20	1,192.2	-151.0	33.3	154.3	2.87	2.23	-5.74

Company:	Sundance Energy, Weld County, CO	Local Co-ordinate Reference:	Well Schell 42-6
Project:	SEC.6-T3N-R67W	TVD Reference:	WELL @ 4929.0ft (Original Well Elev)
Site:	Schell 41-6 Pad Sec.6-T3N-R67W	MD Reference:	WELL @ 4929.0ft (Original Well Elev)
Well:	Schell 42-6	North Reference:	True
Wellbore:	Wellbore #1	Survey Calculation Method:	Minimum Curvature
Design:	Wellbore #1	Database:	Landmark

Survey

Measured Depth (ft)	Inclination (°)	Azimuth (°)	Vertical Depth (ft)	+N/-S (ft)	+E/-W (ft)	Vertical Section (ft)	Dogleg Rate (°/100ft)	Build Rate (°/100ft)	Turn Rate (°/100ft)
1,304.0	20.40	159.90	1,280.6	-181.2	43.7	186.2	1.43	1.17	-2.45
1,398.0	21.10	159.80	1,368.5	-212.4	55.1	219.4	0.75	0.74	-0.11
1,491.0	23.60	159.80	1,454.5	-245.6	67.3	254.7	2.69	2.69	0.00
1,585.0	24.90	163.40	1,540.2	-282.3	79.5	293.2	2.09	1.38	3.83
1,679.0	23.90	163.30	1,625.8	-319.5	90.6	332.1	1.06	-1.06	-0.11
1,772.0	23.60	165.70	1,710.9	-355.5	100.6	369.5	1.09	-0.32	2.58
1,867.0	23.70	164.00	1,798.0	-392.3	110.6	407.6	0.73	0.11	-1.79
1,961.0	23.90	164.40	1,884.0	-428.8	120.9	445.5	0.27	0.21	0.43
2,055.0	23.00	160.70	1,970.2	-464.5	132.1	482.9	1.84	-0.96	-3.94
2,148.0	22.80	161.00	2,055.9	-498.7	144.0	519.1	0.25	-0.22	0.32
2,242.0	21.30	162.30	2,143.0	-532.2	155.1	554.3	1.68	-1.60	1.38
2,336.0	22.90	161.30	2,230.1	-565.8	166.1	589.7	1.75	1.70	-1.06
2,429.0	24.70	162.70	2,315.2	-601.5	177.7	627.2	2.03	1.94	1.51
2,523.0	25.60	165.10	2,400.3	-639.8	188.8	667.1	1.45	0.96	2.55
2,617.0	27.50	164.30	2,484.4	-680.4	199.9	709.1	2.06	2.02	-0.85
2,710.0	28.10	164.20	2,566.6	-722.1	211.7	752.5	0.65	0.65	-0.11
2,804.0	27.90	163.60	2,649.6	-764.5	223.9	796.6	0.37	-0.21	-0.64
2,898.0	27.20	164.00	2,733.0	-806.3	236.0	840.1	0.77	-0.74	0.43
2,992.0	27.30	163.60	2,816.5	-847.6	248.0	883.1	0.22	0.11	-0.43
3,085.0	26.90	164.20	2,899.3	-888.3	259.8	925.5	0.52	-0.43	0.65
3,179.0	25.70	164.60	2,983.6	-928.4	271.0	967.1	1.29	-1.28	0.43
3,273.0	25.80	164.90	3,068.3	-967.8	281.7	1,008.0	0.17	0.11	0.32
3,367.0	25.60	163.20	3,153.0	-1,007.0	292.9	1,048.7	0.81	-0.21	-1.81
3,461.0	25.20	167.10	3,237.9	-1,045.9	303.3	1,089.0	1.83	-0.43	4.15
3,554.0	25.70	167.40	3,321.8	-1,084.9	312.1	1,128.9	0.56	0.54	0.32
3,648.0	25.40	163.90	3,406.7	-1,124.2	322.1	1,169.4	1.64	-0.32	-3.72
3,742.0	24.40	160.10	3,491.9	-1,161.8	334.3	1,209.0	2.01	-1.06	-4.04
3,835.0	24.70	163.50	3,576.5	-1,198.5	346.4	1,247.6	1.55	0.32	3.66
3,929.0	26.00	162.00	3,661.5	-1,236.9	358.3	1,287.8	1.54	1.38	-1.60
4,023.0	26.80	162.50	3,745.7	-1,276.7	371.1	1,329.6	0.88	0.85	0.53
4,116.0	28.70	161.90	3,828.0	-1,318.0	384.3	1,372.9	2.06	2.04	-0.65
4,210.0	29.50	164.60	3,910.1	-1,361.7	397.5	1,418.6	1.64	0.85	2.87
4,304.0	27.00	166.10	3,992.9	-1,404.8	408.7	1,463.0	2.76	-2.66	1.60
4,397.0	24.10	166.00	4,076.8	-1,443.7	418.4	1,503.1	3.12	-3.12	-0.11
4,491.0	24.60	167.30	4,162.4	-1,481.4	427.4	1,541.8	0.78	0.53	1.38
4,585.0	23.70	165.80	4,248.2	-1,518.8	436.3	1,580.2	1.16	-0.96	-1.60
4,679.0	22.20	165.30	4,334.8	-1,554.3	445.4	1,616.9	1.61	-1.60	-0.53
4,773.0	20.50	165.60	4,422.3	-1,587.4	454.0	1,651.1	1.81	-1.81	0.32
4,867.0	18.30	165.80	4,511.0	-1,617.7	461.7	1,682.3	2.34	-2.34	0.21
4,961.0	16.80	163.30	4,600.6	-1,645.0	469.3	1,710.6	1.79	-1.60	-2.66
5,054.0	15.80	163.90	4,689.9	-1,670.0	476.6	1,736.7	1.09	-1.08	0.65
5,148.0	14.60	164.70	4,780.6	-1,693.8	483.3	1,761.4	1.30	-1.28	0.85
5,242.0	12.70	164.30	4,871.9	-1,715.1	489.2	1,783.5	2.02	-2.02	-0.43
5,336.0	10.40	163.40	4,964.0	-1,733.2	494.5	1,802.4	2.45	-2.45	-0.96
5,429.0	8.80	164.80	5,055.7	-1,748.1	498.7	1,817.9	1.74	-1.72	1.51
5,523.0	7.50	167.00	5,148.7	-1,761.0	502.0	1,831.2	1.42	-1.38	2.34
5,617.0	6.00	166.80	5,242.1	-1,771.8	504.5	1,842.2	1.60	-1.60	-0.21
5,711.0	4.90	172.50	5,335.7	-1,780.6	506.1	1,851.1	1.30	-1.17	6.06
5,805.0	3.70	175.20	5,429.4	-1,787.6	506.9	1,858.0	1.29	-1.28	2.87
5,899.0	2.70	184.10	5,523.2	-1,792.8	507.0	1,863.1	1.18	-1.06	9.47
5,993.0	1.50	183.70	5,617.2	-1,796.2	506.8	1,866.3	1.28	-1.28	-0.43
6,087.0	1.50	195.10	5,711.2	-1,798.7	506.4	1,868.5	0.32	0.00	12.13
6,180.0	1.40	250.30	5,804.1	-1,800.2	505.0	1,869.6	1.45	-0.11	59.35
6,275.6	1.09	249.25	5,899.7	-1,800.9	503.0	1,869.8	0.32	-0.32	-1.10

Company:	Sundance Energy, Weld County, CO	Local Co-ordinate Reference:	Well Schell 42-6
Project:	SEC.6-T3N-R67W	TVD Reference:	WELL @ 4929.0ft (Original Well Elev)
Site:	Schell 41-6 Pad Sec.6-T3N-R67W	MD Reference:	WELL @ 4929.0ft (Original Well Elev)
Well:	Schell 42-6	North Reference:	True
Wellbore:	Wellbore #1	Survey Calculation Method:	Minimum Curvature
Design:	Wellbore #1	Database:	Landmark

Survey									
Measured Depth (ft)	Inclination (°)	Azimuth (°)	Vertical Depth (ft)	+N/-S (ft)	+E/-W (ft)	Vertical Section (ft)	Dogleg Rate (°/100ft)	Build Rate (°/100ft)	Turn Rate (°/100ft)
TARGET BHL 1980'FNL, 660'FEL									
6,367.0	0.80	247.50	5,991.1	-1,801.5	501.6	1,869.9	0.32	-0.32	-1.92
6,554.0	0.80	236.50	6,178.1	-1,802.7	499.3	1,870.5	0.08	0.00	-5.88
6,742.0	0.70	215.60	6,366.1	-1,804.4	497.6	1,871.6	0.15	-0.05	-11.12
6,930.0	0.60	194.40	6,554.0	-1,806.2	496.7	1,873.1	0.14	-0.05	-11.28
7,117.0	0.70	189.90	6,741.0	-1,808.3	496.2	1,875.0	0.06	0.05	-2.41
7,289.7	0.88	177.55	6,913.7	-1,810.7	496.1	1,877.2	0.14	0.11	-7.15
LEGAL BOX 400' X 400' 2043'FNL & 630'FEL									
7,305.0	0.90	176.70	6,929.0	-1,810.9	496.1	1,877.5	0.14	0.12	-5.52
7,491.0	0.20	165.20	7,115.0	-1,812.7	496.3	1,879.2	0.38	-0.38	-6.18
7,735.0	0.30	125.90	7,359.0	-1,813.5	496.9	1,880.2	0.08	0.04	-16.11
7,779.0	0.30	125.90	7,403.0	-1,813.6	497.1	1,880.3	0.00	0.00	0.00

Checked By: _____	Approved By: _____	Date: _____
-------------------	--------------------	-------------