

Synergy Resources

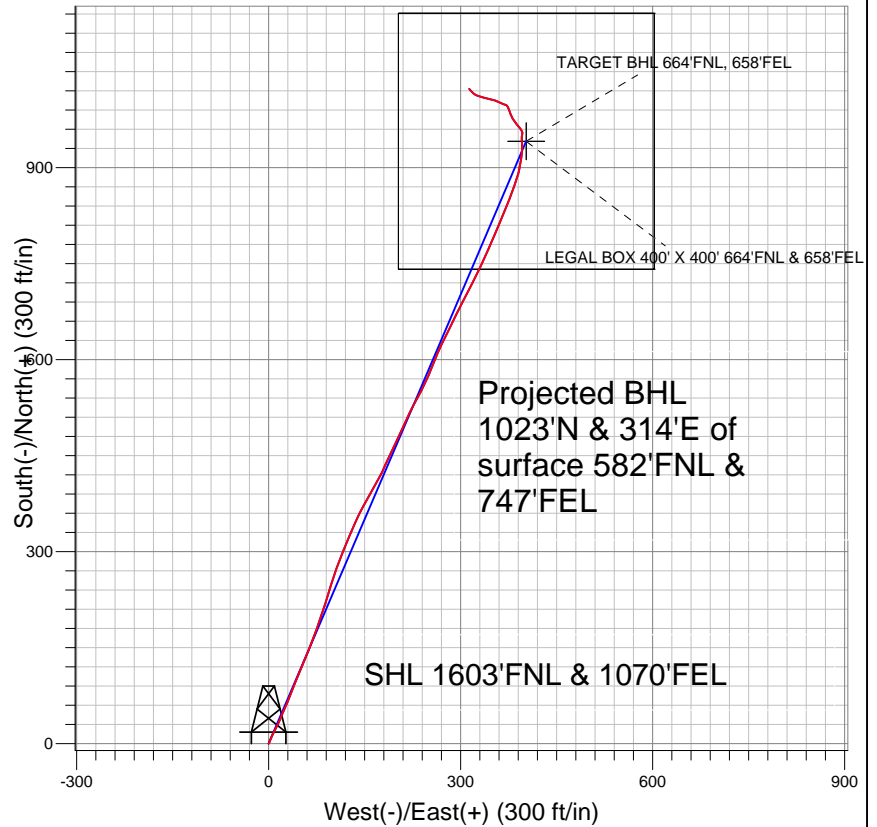

LEGEND

- ◆ SRC Pratt 41-29D, Wellbore #1, Plan #3 (4-4-11) V0
- Wellbore #1
- Survey #1

Final Survey Plot

Projected Final Survey -
8733'MD & 8599'TVD @ 1064'VS
1.1 deg Inc 322.0 deg AZ

Project: SEC.29-T1N-R68W
Site: SRC Pratt 41-29D Pad Sec.29-T1N-R68W
Well: SRC Pratt 41-29D
Plan: Wellbore #1



Directional

Synergy Resources

SEC.29-T1N-R68W

SRC Pratt 41-29D Pad Sec.29-T1N-R68W

SRC Pratt 41-29D

Wellbore #1

Survey: Survey #1

Standard Survey Report

15 April, 2011

Company:	Synergy Resources	Local Co-ordinate Reference:	Well SRC Pratt 41-29D
Project:	SEC.29-T1N-R68W	TVD Reference:	WELL @ 5229.0ft (Original Well Elev)
Site:	SRC Pratt 41-29D Pad Sec.29-T1N-R68W	MD Reference:	WELL @ 5229.0ft (Original Well Elev)
Well:	SRC Pratt 41-29D	North Reference:	True
Wellbore:	Wellbore #1	Survey Calculation Method:	Minimum Curvature
Design:	Wellbore #1	Database:	Landmark

Project	SEC.29-T1N-R68W, Weld County, Colorado		
Map System:	US State Plane 1983	System Datum:	Mean Sea Level
Geo Datum:	North American Datum 1983		
Map Zone:	Colorado Northern Zone		Using geodetic scale factor

Site		SRC Pratt 41-29D Pad Sec.29-T1N-R68W			
Site Position:		Northing:		1,252,299.88 ft	
From:	Lat/Long	Easting:		Longitude:	
		3,133,856.76 ft		-105.022025	
Position Uncertainty:		Slot Radius:		Grid Convergence:	
0.0 ft		"		0.31 °	

Well	SRC Pratt 41-29D					
Well Position	+N/-S	0.0 ft	Northing:	1,252,282.33 ft	Latitude:	40.024912
	+E/-W	0.0 ft	Easting:	3,133,847.33 ft	Longitude:	-105.022059
Position Uncertainty		0.0 ft	Wellhead Elevation:	ft	Ground Level:	5,216.0 ft

Wellbore	Wellbore #1				
Magnetics	Model Name	Sample Date	Declination (°)	Dip Angle (°)	Field Strength (nT)
	IGRF2010	3/21/2011	9.00	66.71	52,927

Design		Wellbore #1				
Audit Notes:						
Version:		1.0	Phase:	ACTUAL	Tie On Depth:	0.0
Vertical Section:		Depth From (TVD) (ft)	+N/-S (ft)	+E/-W (ft)	Direction (°)	
		0.0	0.0	0.0	19.05	

Survey Program		Date	4/15/2011		
From (ft)	To (ft)	Survey (Wellbore)	Tool Name	Description	
248.0	8,733.0	Survey #1 (Wellbore #1)	MWD	MWD - Standard	

Survey	Survey Data									
	Measured Depth (ft)	Inclination (°)	Azimuth (°)	Vertical Depth (ft)	+N/-S (ft)	+E/-W (ft)	Vertical Section (ft)	Dogleg Rate (°/100ft)	Build Rate (°/100ft)	Turn Rate (°/100ft)
	0.0	0.00	0.00	0.0	0.0	0.0	0.0	0.00	0.00	0.00
	248.0	0.80	33.80	248.0	1.4	1.0	1.7	0.32	0.32	0.00
	340.0	2.90	20.60	339.9	4.2	2.1	4.6	2.31	2.28	-14.35
	435.0	4.70	22.20	434.7	10.0	4.5	10.9	1.90	1.89	1.68
	529.0	7.30	28.20	528.2	18.8	8.7	20.7	2.84	2.77	6.38
	623.0	9.30	24.60	621.2	31.0	14.7	34.1	2.20	2.13	-3.83
	717.0	11.10	23.30	713.7	46.2	21.5	50.7	1.93	1.91	-1.38
	811.0	12.40	23.00	805.8	63.8	29.0	69.8	1.38	1.38	-0.32
	904.0	12.50	22.40	896.6	82.3	36.7	89.8	0.18	0.11	-0.65
	1,027.0	12.20	20.50	1,016.7	106.8	46.3	116.1	0.41	-0.24	-1.54
	1,121.0	14.40	24.80	1,108.2	126.7	54.7	137.6	2.56	2.34	4.57
	1,215.0	14.60	19.20	1,199.2	148.5	63.5	161.1	1.51	0.21	-5.96
	1,309.0	15.50	20.70	1,290.0	171.5	71.9	185.5	1.04	0.96	1.60

Company:	Synergy Resources	Local Co-ordinate Reference:	Well SRC Pratt 41-29D
Project:	SEC.29-T1N-R68W	TVD Reference:	WELL @ 5229.0ft (Original Well Elev)
Site:	SRC Pratt 41-29D Pad Sec.29-T1N-R68W	MD Reference:	WELL @ 5229.0ft (Original Well Elev)
Well:	SRC Pratt 41-29D	North Reference:	True
Wellbore:	Wellbore #1	Survey Calculation Method:	Minimum Curvature
Design:	Wellbore #1	Database:	Landmark

Survey

Measured Depth (ft)	Inclination (°)	Azimuth (°)	Vertical Depth (ft)	+N/-S (ft)	+E/-W (ft)	Vertical Section (ft)	Dogleg Rate (°/100ft)	Build Rate (°/100ft)	Turn Rate (°/100ft)
1,402.0	16.20	19.80	1,379.4	195.3	80.6	210.9	0.80	0.75	-0.97
1,496.0	16.40	17.40	1,469.7	220.3	89.1	237.3	0.75	0.21	-2.55
1,590.0	17.80	17.10	1,559.5	246.7	97.3	264.9	1.49	1.49	-0.32
1,683.0	17.10	19.40	1,648.2	273.2	106.0	292.8	1.06	-0.75	2.47
1,777.0	17.20	22.20	1,738.1	299.1	115.8	320.5	0.88	0.11	2.98
1,872.0	16.60	23.10	1,829.0	324.6	126.4	348.1	0.69	-0.63	0.95
1,965.0	15.40	23.70	1,918.3	348.1	136.6	373.6	1.30	-1.29	0.65
2,059.0	15.10	29.00	2,009.0	370.2	147.6	398.1	1.52	-0.32	5.64
2,153.0	15.40	29.00	2,099.7	391.8	159.6	422.5	0.32	0.32	0.00
2,247.0	14.60	29.10	2,190.5	413.1	171.4	446.4	0.85	-0.85	0.11
2,340.0	15.90	23.70	2,280.3	435.0	182.2	470.7	2.07	1.40	-5.81
2,434.0	15.10	26.20	2,370.8	457.8	192.8	495.7	1.11	-0.85	2.66
2,528.0	16.20	25.20	2,461.4	480.7	203.8	520.8	1.20	1.17	-1.06
2,621.0	16.40	23.70	2,550.6	504.4	214.6	546.8	0.50	0.22	-1.61
2,715.0	16.50	28.60	2,640.8	528.3	226.3	573.2	1.48	0.11	5.21
2,809.0	15.90	27.10	2,731.0	551.5	238.5	599.1	0.78	-0.64	-1.60
2,902.0	16.20	23.80	2,820.4	574.7	249.6	624.7	1.03	0.32	-3.55
2,996.0	16.40	20.60	2,910.6	599.1	259.5	651.0	0.98	0.21	-3.40
3,090.0	16.90	26.90	3,000.7	623.7	270.4	677.8	1.99	0.53	6.70
3,183.0	16.80	25.00	3,089.7	647.9	282.2	704.6	0.60	-0.11	-2.04
3,277.0	16.80	26.30	3,179.7	672.4	294.0	731.6	0.40	0.00	1.38
3,371.0	17.30	28.10	3,269.6	696.9	306.6	758.8	0.77	0.53	1.91
3,465.0	15.60	26.50	3,359.7	720.6	318.8	785.2	1.87	-1.81	-1.70
3,559.0	17.30	25.70	3,449.9	744.5	330.5	811.6	1.82	1.81	-0.85
3,652.0	17.10	23.50	3,538.7	769.5	341.9	839.0	0.73	-0.22	-2.37
3,746.0	17.00	23.70	3,628.6	794.7	353.0	866.4	0.12	-0.11	0.21
3,840.0	15.50	22.40	3,718.8	818.9	363.3	892.7	1.64	-1.60	-1.38
3,934.0	13.50	22.20	3,809.8	840.7	372.2	916.2	2.13	-2.13	-0.21
4,027.0	11.80	20.60	3,900.6	859.7	379.7	936.5	1.87	-1.83	-1.72
4,121.0	9.80	18.60	3,992.9	876.2	385.6	954.1	2.16	-2.13	-2.13
4,215.0	8.40	14.60	4,085.7	890.5	389.9	969.0	1.63	-1.49	-4.26
4,308.0	7.10	11.30	4,177.9	902.7	392.7	981.4	1.48	-1.40	-3.55
4,402.0	5.90	8.40	4,271.3	913.2	394.6	991.9	1.32	-1.28	-3.09
4,495.0	5.10	4.40	4,363.8	922.0	395.6	1,000.6	0.95	-0.86	-4.30
4,590.0	4.60	0.90	4,458.5	930.0	396.0	1,008.3	0.61	-0.53	-3.68
4,684.0	4.00	359.00	4,552.2	937.1	396.0	1,015.0	0.66	-0.64	-2.02
4,778.0	3.40	356.60	4,646.0	943.1	395.7	1,020.7	0.66	-0.64	-2.55
4,871.0	3.20	4.20	4,738.9	948.5	395.8	1,025.7	0.52	-0.22	8.17
4,965.0	1.70	13.10	4,832.8	952.5	396.3	1,029.6	1.64	-1.60	9.47
5,059.0	1.40	358.50	4,926.7	955.0	396.6	1,032.1	0.53	-0.32	-15.53
5,246.0	2.50	317.90	5,113.6	960.3	393.8	1,036.2	0.91	0.59	-21.71
5,331.5	2.22	320.93	5,199.1	962.9	391.5	1,038.0	0.36	-0.32	3.54
TARGET BHL 664'FNL, 658'FEL									
5,434.0	1.90	325.70	5,301.5	965.9	389.3	1,040.0	0.36	-0.31	4.66
5,622.0	0.60	319.30	5,489.5	969.2	386.9	1,042.4	0.69	-0.69	-3.40
5,810.0	1.00	321.90	5,677.4	971.2	385.2	1,043.8	0.21	0.21	1.38
5,997.0	1.10	319.30	5,864.4	973.9	383.0	1,045.6	0.06	0.05	-1.39
6,185.0	1.10	332.30	6,052.4	976.9	381.0	1,047.7	0.13	0.00	6.91
6,373.0	1.20	341.00	6,240.3	980.3	379.5	1,050.5	0.11	0.05	4.63
6,559.0	1.50	339.60	6,426.3	984.4	378.0	1,053.9	0.16	0.16	-0.75
6,747.0	1.70	341.40	6,614.2	989.4	376.3	1,058.0	0.11	0.11	0.96
6,831.0	1.83	335.82	6,698.2	991.8	375.4	1,060.0	0.25	0.15	-6.64
LEGAL BOX 400' X 400' 664'FNL & 658'FEL									
6,934.0	2.00	330.00	6,801.1	994.8	373.8	1,062.4	0.25	0.17	-5.65

Company:	Synergy Resources	Local Co-ordinate Reference:	Well SRC Pratt 41-29D
Project:	SEC.29-T1N-R68W	TVD Reference:	WELL @ 5229.0ft (Original Well Elev)
Site:	SRC Pratt 41-29D Pad Sec.29-T1N-R68W	MD Reference:	WELL @ 5229.0ft (Original Well Elev)
Well:	SRC Pratt 41-29D	North Reference:	True
Wellbore:	Wellbore #1	Survey Calculation Method:	Minimum Curvature
Design:	Wellbore #1	Database:	Landmark

Survey										
Measured Depth (ft)	Inclination (°)	Azimuth (°)	Vertical Depth (ft)	+N/-S (ft)	+E/-W (ft)	Vertical Section (ft)	Dogleg Rate (°/100ft)	Build Rate (°/100ft)	Turn Rate (°/100ft)	
7,122.0	0.70	287.10	6,989.1	998.0	371.0	1,064.5	0.83	-0.69	-22.82	
7,309.0	2.00	288.90	7,176.0	999.4	366.9	1,064.4	0.70	0.70	0.96	
7,496.0	3.30	296.40	7,362.8	1,002.9	359.0	1,065.1	0.72	0.70	4.01	
7,682.0	4.10	281.50	7,548.4	1,006.6	347.6	1,064.9	0.67	0.43	-8.01	
7,869.0	3.50	285.50	7,735.0	1,009.4	335.6	1,063.7	0.35	-0.32	2.14	
8,057.0	2.60	291.60	7,922.7	1,012.5	326.1	1,063.5	0.51	-0.48	3.24	
8,244.0	1.50	316.50	8,109.6	1,015.9	320.5	1,064.8	0.74	-0.59	13.32	
8,432.0	1.10	313.00	8,297.6	1,018.9	317.5	1,066.7	0.22	-0.21	-1.86	
8,689.0	1.10	322.00	8,554.5	1,022.5	314.1	1,069.0	0.07	0.00	3.50	
8,733.0	1.10	322.00	8,598.5	1,023.2	313.6	1,069.5	0.00	0.00	0.00	

Checked By: _____ Approved By: _____ Date: _____