

T7S, R96W, 6th P.M.

WPX Energy Rocky Mountain, LLC

Well location, WILLIAMS GM 701-4-HN1 (VERT.), located as shown in Lot 1 of Section 4, T7S, R96W, 6th P.M., Garfield County, Colorado.

### BASIS OF ELEVATION

SPOT ELEVATION AT THE NORTHWEST CORNER OF SECTION 30, T5S, R95W, 6th P.M. TAKEN FROM THE FORKED GULCH QUADRANGLE, COLORADO, GARFIELD COUNTY, 7.5 MINUTE SERIES (TOPOGRAPHICAL MAP) PUBLISHED BY THE UNITED STATES DEPARTMENT OF THE INTERIOR, GEOLOGICAL SURVEY. SAID ELEVATION IS MARKED AS BEING 5966 FEET.

### BASIS OF BEARINGS

BASIS OF BEARINGS IS A G.P.S. OBSERVATION.

NOTE:  
SEE CURRENT FOOTAGE PLAT #6 FOR  
EXISTING IMPROVEMENT WITHIN 400'  
OF THE PROPOSED WELL HEAD.

PLAT #1

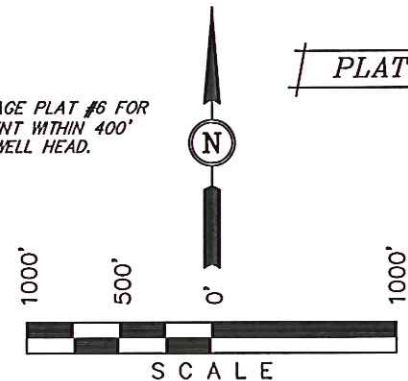

### CERTIFICATE

THIS IS TO CERTIFY THAT THE ABOVE PLAT WAS PREPARED AND LOCATION AS SHOWN WAS STAKED ON THE GROUND FROM FIELD NOTES OF ACTUAL SURVEYS MADE BY ME OR UNDER MY SUPERVISION AND THAT THE SAME ARE TRUE AND CORRECT TO THE BEST OF MY KNOWLEDGE AND BELIEF.

REGISTERED LAND SURVEYOR  
REGISTRATION NO. 17492  
STATE OF COLORADO

UINTAH ENGINEERING & LAND SURVEYING  
85 SOUTH 200 EAST - VERNAL, UTAH 84078  
(435) 789-1017

SCALE 1" = 1000'	DATE SURVEYED: 09-30-11	DATE DRAWN: 01-30-12
PARTY B.J. T.M. D.R.B.	REFERENCES G.L.O. PLAT	
WEATHER COLD	FILE WPX Energy Rocky Mountain, LLC	

1912 Brass Cap  
1.0' High, N-S  
Fenceline, LS 10097  
Lat: 39.473281°  
Long: 108.103789°

S89°52'44"W - 2638.33' (Meas.)

S89°53'55"W - 1300.94' (Meas.)

S89°54'12"W - 1300.91' (Meas.)

T6S  
T7S

1912 Brass Cap  
17" High, Pile of  
Stones  
Lat: 39.473253°  
Long: 108.122347°

Lot 4

1912 Brass Cap  
1.2' High, Stone  
Lat: 39.473269°  
Long: 108.113003°

Lot 3

Private Alum. Cap  
1.0' High, Stone  
PLS 22580  
Lat: 39.473275°  
Long: 108.108397°

Lot 2

WILLIAMS GM 701-4-HN1 (Vert.)

Elev. Ungraded Ground = 5450.0'

Lot 1

N06°01'11"E -  
1314.28' (Meas.)

896'

N05°53'19"E -  
1341.87' (Meas.)

Private Alum. Cap  
0.5' High, N-E Fence  
Corner, PLS 22580  
Lat: 39.469689°  
Long: 108.108883°

N88°52'24"W -  
1301.32' (Meas.)

Private Alum. Cap  
0.5' High, Stones,  
PLS 22580  
Lat: 39.469617°  
Long: 108.104278°

1920 Brass Cap  
1.2' High, Pile of  
Stones LS 10097  
Lat: 39.465997°  
Long: 108.104761°

N05°55'39"E -  
1325.84' (Meas.)

1920 Brass Cap  
1.5' High, Pile of  
Stone  
Lat: 39.466536°  
Long: 108.122344°

Lot 5

2012 Private Alum.  
Cap 1.0' High  
Lat: 39.465950°  
Long: 108.122347°

Lot 6

C.C.  
1920 Brass Cap,  
0.6' High, Stones  
Lat: 39.459025°  
Long: 108.122344°

Lot 7

1920 Brass Cap,  
0.8' High, Pile  
of Stones  
Lat: 39.458669°  
Long: 108.122347°

1920 Brass Cap,  
1.5' High, Pile  
of Stones, RLS  
17492  
Lat: 39.458703°  
Long: 108.115031°

1920 Brass Cap,  
1.5' High, Pile  
of Stones  
Lat: 39.458708°  
Long: 108.105731°

NE Cor Sec 9  
CC 1920 Brass  
Cap, 0.8' High,  
Pile of Stones  
Lat: 39.458719°  
Long: 108.103406°

N05°52'48"E - 2669.92' (Meas.)

S89°40'28"W -  
2066.48' (Meas.)

NW Cor Sec 9  
CC 1920 Brass Cap  
1.0' High, Rebar  
Lat: 39.458669°  
Long: 108.121936°

LINE TABLE		
LINE	BEARING	LENGTH
L1	S89°38'53"W	656.44'
L2	N89°51'16"W	115.68'
L3	N00°02'55"E	129.07'

NE Cor Sec 9  
CC 1920 Brass  
Cap, 0.8' High,  
Pile of Stones  
Lat: 39.458719°  
Long: 108.103406°

PDOP = 1.7

NAD 83 (SURFACE LOCATION)  
LATITUDE = 39°28'16.99" (39.471386)  
LONGITUDE = 108°06'26.03" (108.107231)  
STATE PLANE-(COLO. CENTRAL-NAD 83)  
N = 1607142.192  
E = 2264081.932

### LEGEND:

- └─┘ = 90° SYMBOL
- = PROPOSED WELL HEAD.
- ▲ = SECTION CORNERS LOCATED.