

Drawing: ANDERSON\_GCC2-APD2.DWG Plotted by: DALLAS\_KNOLL Date: 12/21/2011 10:08:49 AM R:\Project Files\BP\BP 80 Acre Infill\Anderson Gas Com C #2 #3\Permitting Drawings\

PROPOSED ANDERSON GAS COM C #2	
OPERATOR	BP
NORTHING	1191852.23
EASTING	2369354.80
LATITUDE	N37° 10' 24"
LONGITUDE	W107° 39' 52"

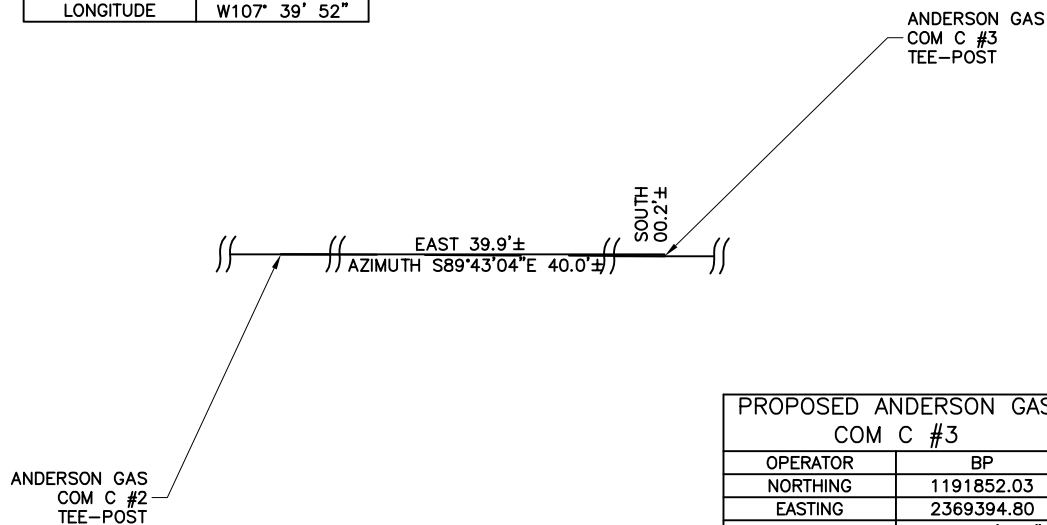

PROPOSED ANDERSON GAS COM C #3	
OPERATOR	BP
NORTHING	1191852.03
EASTING	2369394.80
LATITUDE	N37° 10' 24"
LONGITUDE	W107° 39' 52"

☼ EXISTING WELLHEAD  
||—|| PROPOSED TEE-POST

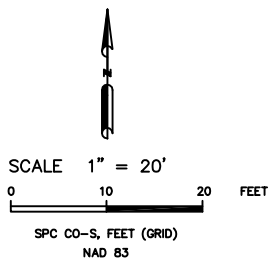

PROJ. NO. 49228572	FILE NO. ANDERSON GAS COM C #2		ANDERSON GAS COM C #2 WELLHEAD DISTANCE PLAT	
			SURFACE LOCATION OF WELL: 1496.0 FEET FROM THE SOUTH LINE, AND 1564.2 FEET FROM THE EAST LINE SECTION 24 T34N, R8W, NMPM	REV A
DRAWN BY DK	DATE 12/19/11	CLIENT PC	BP AMERICA PROD. CO.— LAPLATA COUNTY, CO.	