

# Samson Resources Company

## SE Bayfield 34-7 #12U-3A

Multi Well plan for form 2A (Doc #400223265)

Township 34 North Range 7 West, N.M.P.M.

Section 12: N1/2

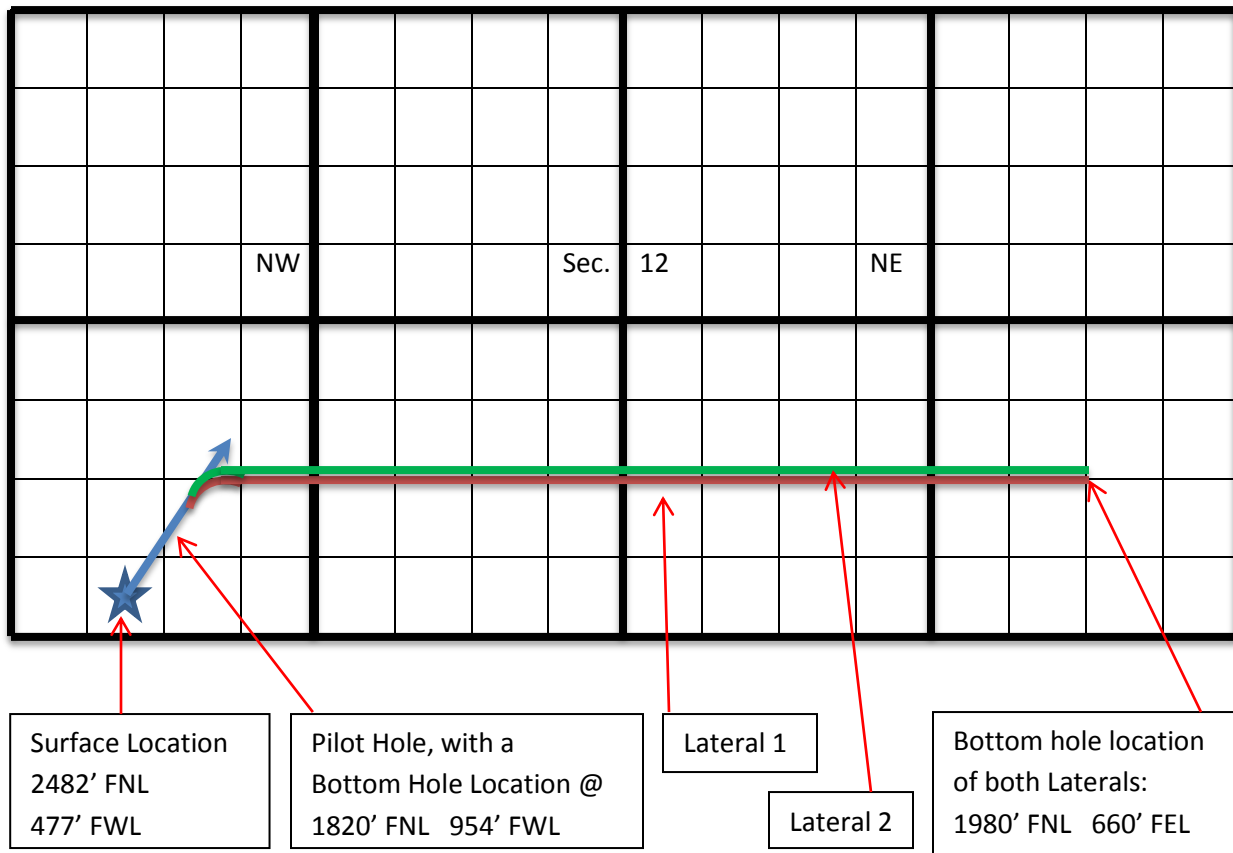

Narrative: The diagram above is to scale with each small square being 330'. It represents an aerial view of the wellbores that will make up the SE Bayfield 34-7 #12U-3A. The well will consist of one Pilot hole that will be a directional well that goes in a Northeasterly direction to a measured depth of 2925'. At a depth of about 2400 feet, the first lateral will leave the Pilot hole and curve to a horizontal well in an easterly direction. About 100 feet below the first lateral, the second lateral will do the same thing. Both laterals will be just shy of  $\frac{3}{4}$ 's of a mile long with lateral number two being lower, but from an aerial perspective, almost directly under lateral number one.