

# WELL LOCATION CERTIFICATE

SECTION 23, TOWNSHIP 7 NORTH, RANGE 66 WEST, 6TH P.M.

NW CRN SEC. 23  
3.25" AC LS 4392

N88°44'16"E

5244.9'

NE CRN SEC. 23  
2.5" AC LS 12374

BH = 500' FNL,  
200' FWL.

## NOTES:

THIS IS A DIRECTIONAL DRILL WELL.  
BOTTOM HOLE AT 500' FNL, 200' FWL.

WELL FALLS IN A CORN FIELD.  
SEE LOCATION DRAWING FOR IMPROVEMENTS

W1/4 CRN SEC. 23  
3.25" AC LS 10855

N88°59'03"E  
2639.3'

GROUND ELEVATION = 4899'  
LAT. & LONG. = N 40.55389'  
W 104.75158'

E1/4 CRN SEC. 23  
2.5" AC LS 12374

BASIS OF BEARINGS

SW CRN SEC. 23  
3.25" AC LS 10855

S88°57'50"W

2656.1'

S1/4 CRN SEC. 23  
3.25" AC LS 4392

S88°57'32"W

2655.8'

SE CRN SEC. 23  
2.5" AC LS 12374

I HEREBY STATE TO PERTOLEUM DEV. CORP. THAT THE SURFACE LOCATION FOR THE  
WELL MAGNUSON 231-221 IS LOCATED 180' FSL & 750' FWL, SEC. 23, T7N, R66W, 6PM.

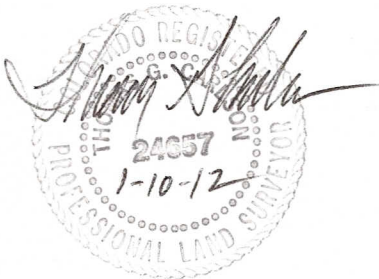

## LEGEND

- FOUND MONUMENT
- PROPOSED WELL
- BOTTOM HOLE

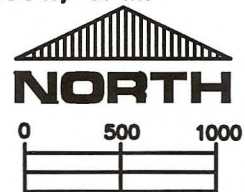

SCALE 1" = 1000'

ELEVATION SOURCE = USGS 7.5' QUAD.MAP CONTOURS  
NGVD 1929 DATUM.

LAT. & LONG. ARE DIFFERENTIALLY CORRECTED (WGS'84)  
USING (DGPS) WITH (PDOP) VALUE OF 1.4.

SHOWN DISTANCES ARE FIELD MEASURED - EXTERIOR SECTION LINES  
ARE DRAWN TO SCALE (BEST APPROX. OR FOUND MONUMENT ).

DISTANCES TO WELL SHOWN PERPENDICULAR  
TO SECTION LINES.

THOMAS G. CARLSON, PLS 24657  
HORSESHOE SURVEYING, LLC

THIS IS NOT A MONUMENTED BOUNDARY SURVEY, IT IS ONLY A  
DRAWING INTENDED TO DEPICT THE WELL LOCATION TO SECTION LINES.

PREPARED BY: HORSESHOE SURVEYING, LLC  
PO BOX 150458  
LAKEWOOD, CO 80215  
(720)872-0196

DRAWING DATE:  
1-10-12

FIELD DATE:  
1-7-12

BY: TGC

CHKD:

WELL NAME:

MAGNUSON 231-221

LOCATION:

WELD COUNTY, CO  
SW1/4, SEC. 23, T7N, R66W, 6TH P.M.

JOB NO.

SHEET NO.

1 OF 1