



KERR MCGEE OIL & GAS ONSHORE LP



Location: COLORADO Slot: SLOT#13 FEHRN 26-32 (1654'FNL & 1091'FEL)
Field: WELD COUNTY (KERR MCGEE) Well: FEHRN 26-32
Facility: SEC.32-T2N-R66W Wellbore: FEHRN 26-32 PWB

Plot reference wellpath is FEHRN 26-32 (REV-C.0) PWP	
True vertical depths are referenced to XTREME 6 (RKB)	Grid System: NAD83 / Lambert Colorado SP, Northern Zone (501), US feet
Measured depths are referenced to XTREME 6 (RKB)	North Reference: True north
XTREME 6 (RKB) to Mean Sea Level: 4932 feet	Scale: True distance
Mean Sea Level to Mud line (At Slot: SLOT#13 FEHRN 26-32 (1654'FNL & 1091'FEL)): 0 feet	Depths are in feet
Coordinates are in feet referenced to Slot	Created by: doddanna on 9/8/2011

Scale 1 inch = 300
Easting (ft)
0 150 300 450 600 750 900 1050 1200

PROJECTION TO BIT : 8042.94ft TVD, 1612.31ft N, 1048.10ft E
LAST BHI MWD SURVEY : 7992.94ft TVD, 1612.05ft N, 1048.14ft E

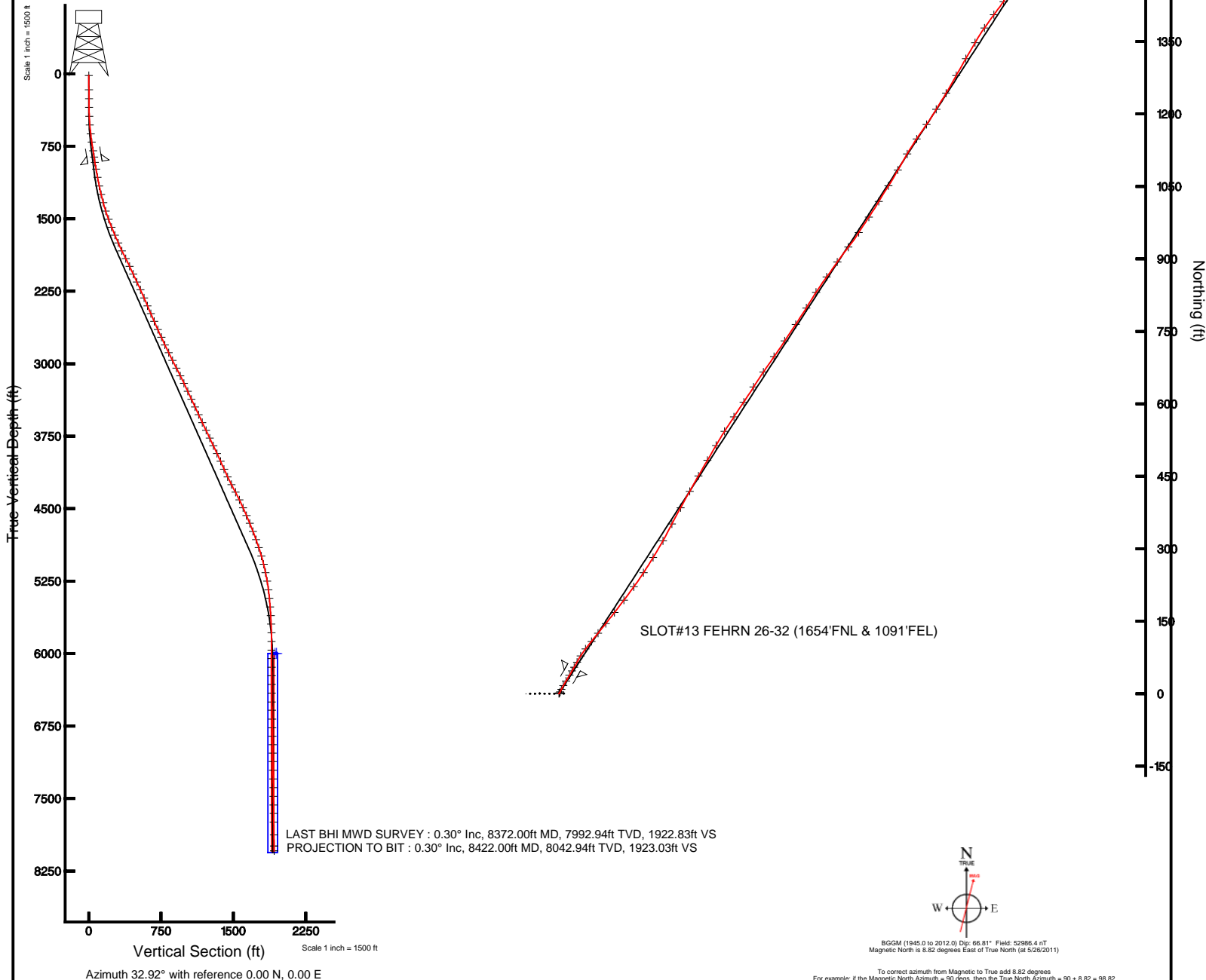



Actual Wellpath Report

FEHRN 26-32 AWP

Page 1 of 4



REFERENCE WELLPATH IDENTIFICATION			
Operator	KERR MCGEE OIL & GAS ONSHORE LP	Slot	SLOT#13 FEHRN 26-32 (1654'FNL & 1091'FEL)
Area	COLORADO	Well	FEHRN 26-32
Field	WELD COUNTY (KERR MCGEE)	Wellbore	FEHRN 26-32 AWB
Facility	SEC.32-T2N-R66W		

REPORT SETUP INFORMATION			
Projection System	NAD83 / Lambert Colorado SP, Northern Zone (501), US feet	Software System	WellArchitect® 3.0.0
North Reference	True	User	Doddanna
Scale	0.99996	Report Generated	9/8/2011 at 12:47:31 PM
Convergence at slot	0.46° East	Database/Source file	WA_Denver/FEHRN_26-32_AWB.xml

WELLPATH LOCATION						
	Local coordinates		Grid coordinates		Geographic coordinates	
	North[ft]	East[ft]	Easting[US ft]	Northing[US ft]	Latitude	Longitude
Slot Location	1311.54	519.46	3197078.58	1279083.91	40°05'50.381"N	104°47'43.876"W
Facility Reference Pt			3196569.55	1277768.35	40°05'37.420"N	104°47'50.560"W
Field Reference Pt			3197771.84	1268891.29	40°04'09.600"N	104°47'36.000"W

WELLPATH DATUM			
Calculation method	Minimum curvature	XTREME 6 (RKB) to Facility Vertical Datum	4932.00ft
Horizontal Reference Pt	Slot	XTREME 6 (RKB) to Mean Sea Level	4932.00ft
Vertical Reference Pt	XTREME 6 (RKB)	XTREME 6 (RKB) to Mud Line at Slot (SLOT#13 FEHRN 26-32 (1654'FNL & 1091'FEL))	4932.00ft
MD Reference Pt	XTREME 6 (RKB)	Section Origin	N 0.00, E 0.00 ft
Field Vertical Reference	Mean Sea Level	Section Azimuth	32.92°



Actual Wellpath Report

FEHRN 26-32 AWP

Page 2 of 4



REFERENCE WELLPATH IDENTIFICATION			
Operator	KERR MCGEE OIL & GAS ONSHORE LP	Slot	SLOT#13 FEHRN 26-32 (1654'FNL & 1091'FEL)
Area	COLORADO	Well	FEHRN 26-32
Field	WELD COUNTY (KERR MCGEE)	Wellbore	FEHRN 26-32 AWB
Facility	SEC.32-T2N-R66W		

WELLPATH DATA (95 stations) † = interpolated/extrapolated station								
MD [ft]	Inclination [°]	Azimuth [°]	TVD [ft]	Vert Sect [ft]	North [ft]	East [ft]	DLS [°/100ft]	Comments
0.00†	0.000	59.800	0.00	0.00	0.00	0.00	0.00	
16.00	0.000	59.800	16.00	0.00	0.00	0.00	0.00	
164.00	0.400	59.800	164.00	0.46	0.26	0.45	0.27	
255.00	0.400	12.000	255.00	1.04	0.73	0.79	0.36	
346.00	0.500	40.100	345.99	1.73	1.34	1.11	0.26	
439.00	2.600	28.500	438.96	4.24	3.51	2.38	2.27	
529.00	4.600	26.400	528.77	9.86	8.54	4.96	2.23	
620.00	6.500	30.300	619.34	18.63	16.25	9.18	2.13	
706.00	8.300	30.600	704.62	29.70	25.80	14.79	2.09	
797.00	9.200	30.600	794.56	43.53	37.71	21.84	0.99	
864.00	8.800	30.300	860.74	54.00	46.75	27.15	0.60	
991.00	10.000	28.900	986.03	74.70	64.79	37.38	0.96	
1077.00	10.300	32.000	1070.68	89.84	77.85	45.07	0.72	
1168.00	12.200	37.700	1159.93	107.56	92.36	55.26	2.42	
1257.00	13.600	38.400	1246.69	127.35	108.00	67.51	1.58	
1345.00	15.100	39.100	1331.94	149.04	125.00	81.17	1.72	
1436.00	17.500	38.400	1419.27	174.45	144.93	97.14	2.65	
1525.00	20.800	38.000	1503.34	203.52	167.87	115.19	3.71	
1614.00	21.500	37.300	1586.34	235.52	193.30	134.80	0.84	
1703.00	24.100	35.900	1668.38	269.94	221.00	155.34	2.98	
1791.00	23.300	33.400	1748.96	305.28	250.08	175.46	1.46	
1881.00	25.700	31.300	1830.85	342.59	281.62	195.40	2.84	
1971.00	27.200	29.200	1911.43	382.63	316.25	215.57	1.96	
2061.00	25.200	27.500	1992.18	422.24	351.21	234.46	2.37	
2150.00	25.500	28.900	2072.61	460.21	384.79	252.46	0.75	
2241.00	24.900	28.900	2154.95	498.86	418.71	271.19	0.66	
2329.00	24.400	30.300	2234.93	535.50	450.62	289.31	0.87	
2420.00	23.900	29.900	2317.97	572.68	482.83	307.99	0.58	
2510.00	22.700	29.900	2400.63	608.23	513.69	325.73	1.33	
2597.00	23.700	32.700	2480.59	642.48	542.96	343.55	1.71	
2686.00	23.600	33.100	2562.12	678.18	572.93	362.94	0.21	
2777.00	24.000	34.100	2645.38	714.90	603.52	383.26	0.62	
2866.00	25.500	32.400	2726.20	752.16	634.68	403.68	1.87	
2953.00	25.100	34.500	2804.86	789.33	665.70	424.16	1.13	
3043.00	25.900	34.800	2886.09	828.06	697.58	446.19	0.90	
3131.00	27.300	33.400	2964.78	867.45	730.21	468.27	1.74	
3221.00	27.000	34.100	3044.86	908.51	764.36	491.09	0.49	
3311.00	26.500	31.300	3125.23	949.01	798.43	512.97	1.51	
3398.00	25.800	33.100	3203.33	987.35	830.88	533.40	1.22	
3488.00	24.600	36.200	3284.76	1025.64	862.40	555.16	1.98	
3579.00	25.300	34.800	3367.27	1063.98	893.66	577.44	1.01	
3668.00	25.600	38.400	3447.64	1102.13	924.34	600.24	1.77	
3756.00	24.400	32.700	3527.41	1139.24	954.54	621.87	3.06	
3846.00	25.800	33.800	3608.90	1177.42	986.46	642.81	1.64	
3935.00	25.400	31.000	3689.17	1215.86	1018.92	663.42	1.43	



Actual Wellpath Report

FEHRN 26-32 AWP

Page 3 of 4



REFERENCE WELLPATH IDENTIFICATION			
Operator	KERR MCGEE OIL & GAS ONSHORE LP	Slot	SLOT#13 FEHRN 26-32 (1654'FNL & 1091'FEL)
Area	COLORADO	Well	FEHRN 26-32
Field	WELD COUNTY (KERR MCGEE)	Wellbore	FEHRN 26-32 AWB
Facility	SEC.32-T2N-R66W		

WELLPATH DATA (95 stations)								
MD [ft]	Inclination [°]	Azimuth [°]	TVD [ft]	Vert Sect [ft]	North [ft]	East [ft]	DLS [°/100ft]	Comments
4024.00	25.300	32.400	3769.60	1253.95	1051.34	683.44	0.68	
4112.00	25.800	29.600	3849.00	1291.88	1083.87	702.98	1.49	
4201.00	25.400	30.300	3929.26	1330.28	1117.19	722.17	0.56	
4290.00	23.600	34.100	4010.25	1367.16	1148.42	741.79	2.69	
4379.00	24.400	34.800	4091.56	1403.35	1178.27	762.27	0.95	
4468.00	25.500	31.300	4172.25	1440.88	1209.74	782.72	2.07	
4556.00	27.600	31.000	4250.97	1480.19	1243.40	803.06	2.39	
4646.00	27.700	29.200	4330.69	1521.90	1279.53	824.01	0.93	
4735.00	26.300	30.300	4409.99	1562.24	1314.62	844.05	1.67	
4825.00	24.100	29.600	4491.42	1600.51	1347.81	863.18	2.47	
4914.00	23.600	35.200	4572.83	1636.45	1378.17	882.43	2.60	
5001.00	22.400	36.200	4652.91	1670.40	1405.78	902.26	1.45	
5092.00	20.800	36.200	4737.52	1703.85	1432.81	922.04	1.76	
5181.00	20.000	38.400	4820.94	1734.78	1457.49	940.83	1.25	
5269.00	18.500	38.400	4904.02	1763.66	1480.23	958.85	1.70	
5360.00	16.600	37.700	4990.78	1790.98	1501.83	975.77	2.10	
5449.00	13.900	34.500	5076.64	1814.34	1520.70	989.60	3.18	
5537.00	11.400	31.300	5162.49	1833.61	1536.85	1000.11	2.95	
5628.00	9.500	28.900	5251.98	1850.09	1551.11	1008.41	2.14	
5719.00	7.600	25.300	5341.97	1863.55	1563.13	1014.61	2.17	
5807.00	6.000	14.800	5429.35	1873.69	1572.83	1018.28	2.30	
5896.00	4.700	8.500	5517.96	1881.43	1580.94	1020.00	1.60	
5986.00	3.700	6.700	5607.72	1887.39	1587.47	1020.89	1.12	
6074.00	3.000	2.500	5695.56	1891.92	1592.59	1021.32	0.84	
6165.00	1.500	12.700	5786.49	1895.09	1596.13	1021.68	1.70	
6255.00	0.500	105.900	5876.48	1896.31	1597.17	1022.32	1.79	
6344.00	0.400	107.300	5965.48	1896.51	1596.97	1022.99	0.11	
6431.00	0.300	84.100	6052.48	1896.74	1596.91	1023.51	0.20	
6521.00	0.200	76.700	6142.48	1897.00	1596.97	1023.90	0.12	
6610.00	0.400	85.500	6231.47	1897.30	1597.03	1024.36	0.23	
6699.00	0.200	65.400	6320.47	1897.62	1597.12	1024.81	0.25	
6788.00	0.400	48.900	6409.47	1898.05	1597.39	1025.18	0.24	
6880.00	0.700	22.500	6501.47	1898.91	1598.12	1025.64	0.42	
6967.00	1.100	28.500	6588.46	1900.26	1599.34	1026.24	0.47	
7058.00	1.300	28.200	6679.44	1902.16	1601.02	1027.15	0.22	
7148.00	1.600	18.700	6769.41	1904.40	1603.11	1028.03	0.43	
7237.00	0.800	64.400	6858.39	1906.13	1604.55	1028.99	1.34	
7324.00	1.500	63.000	6945.37	1907.64	1605.33	1030.55	0.81	
7410.00	0.800	92.800	7031.35	1908.91	1605.81	1032.16	1.04	
7498.00	1.400	91.100	7119.34	1909.79	1605.76	1033.84	0.68	
7589.00	2.400	103.000	7210.29	1911.02	1605.31	1036.81	1.18	
7678.00	3.400	85.500	7299.17	1913.26	1605.10	1041.26	1.49	
7768.00	2.600	96.400	7389.05	1915.79	1605.08	1045.95	1.09	
7857.00	0.600	111.800	7478.01	1916.79	1604.69	1048.39	2.28	
7947.00	0.700	349.500	7568.01	1917.28	1605.05	1048.72	1.27	



Actual Wellpath Report

FEHRN 26-32 AWP

Page 4 of 4



REFERENCE WELLPATH IDENTIFICATION			
Operator	KERR MCGEE OIL & GAS ONSHORE LP	Slot	SLOT#13 FEHRN 26-32 (1654'FNL & 1091'FEL)
Area	COLORADO	Well	FEHRN 26-32
Field	WELD COUNTY (KERR MCGEE)	Wellbore	FEHRN 26-32 AWB
Facility	SEC.32-T2N-R66W		

WELLPATH DATA (95 stations)								
MD [ft]	Inclination [°]	Azimuth [°]	TVD [ft]	Vert Sect [ft]	North [ft]	East [ft]	DLS [°/100ft]	Comments
8036.00	1.100	327.700	7657.00	1918.03	1606.31	1048.17	0.58	
8125.00	1.300	351.900	7745.98	1919.15	1608.03	1047.57	0.61	
8259.00	1.100	20.400	7879.95	1921.55	1610.74	1047.80	0.46	
8372.00	0.300	351.200	7992.94	1922.83	1612.05	1048.14	0.75	LAST BHI MWD SURVEY
8422.00	0.300	351.200	8042.94	1923.03	1612.31	1048.10	0.00	PROJECTION TO BIT

HOLE & CASING SECTIONS - Ref Wellbore: FEHRN 26-32 AWB Ref Wellpath: FEHRN 26-32 AWP									
String/Diameter	Start MD [ft]	End MD [ft]	Interval [ft]	Start TVD [ft]	End TVD [ft]	Start N/S [ft]	Start E/W [ft]	End N/S [ft]	End E/W [ft]
12.25in Open Hole	16.00	919.00	903.00	16.00	915.05	0.00	0.00	54.25	31.48
8.625in Casing Surface	16.00	919.00	903.00	16.00	915.05	0.00	0.00	54.25	31.48
7.875in Open Hole	919.00	8422.00	7503.00	915.05	8042.94	54.25	31.48	1612.31	1048.10

TARGETS									
Name	MD [ft]	TVD [ft]	North [ft]	East [ft]	Grid East [US ft]	Grid North [US ft]	Latitude	Longitude	Shape
FEHRN 26-32 GEO TARGET 50' RADIUS (50'FNL & 50'FEL, REV-1)		6000.00	1601.11	1036.74	3198102.53	1280693.14	40°06'06.203"N	104°47'30.534"W	circle
FEHRN 26-32 HARDLINE 50'E OF GEO TARGET		6000.00	1601.09	1086.74	3198152.52	1280693.52	40°06'06.203"N	104°47'29.891"W	point
FEHRN 26-32 HARDLINE 50'N OF GEO TARGET		6000.00	1651.09	1036.74	3198102.13	1280743.12	40°06'06.697"N	104°47'30.534"W	point

WELLPATH COMPOSITION - Ref Wellbore: FEHRN 26-32 AWB Ref Wellpath: FEHRN 26-32 AWP				
Start MD [ft]	End MD [ft]	Positional Uncertainty Model	Log Name/Comment	Wellbore
16.00	864.00	NaviTrak (Standard)	BHI MWD NAVITRAK 12.25 <164-864>	FEHRN 26-32 AWB
864.00	8372.00	NaviTrak (Standard)	BHI MWD NAVITRAK 7.875 <991-8372>	FEHRN 26-32 AWB
8372.00	8422.00	Blind Drilling (std)	Projection to bit	FEHRN 26-32 AWB