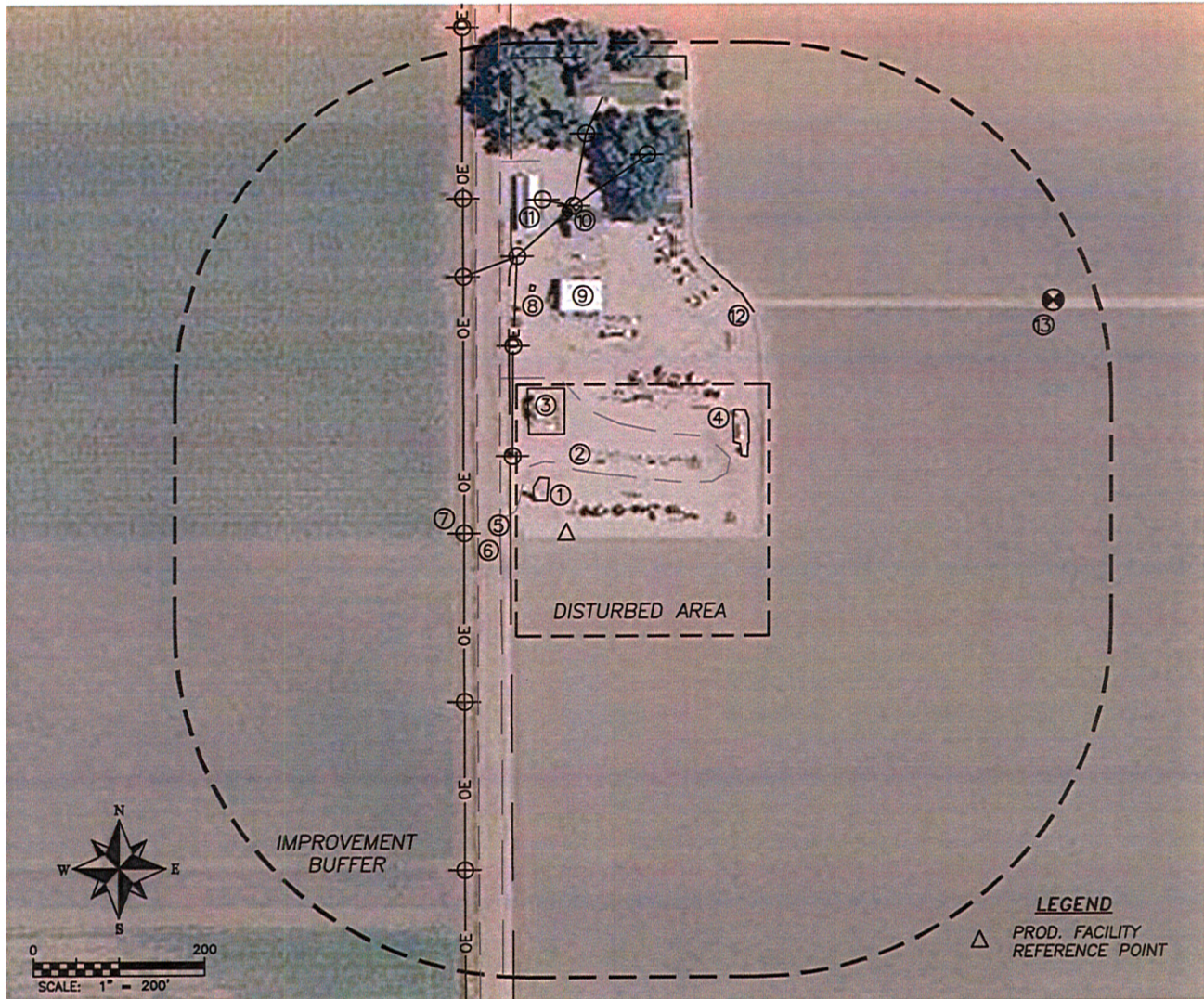

PRODUCTION FACILITY LOCATION DRAWING WAKE E24-77HN

SECTION 24, TOWNSHIP 6 NORTH, RANGE 65 WEST OF THE 6TH PRINCIPAL MERIDIAN

**REFERENCE POINT LOCATION:**

LATITUDE: N40.47618°
 LONGITUDE: W104.62061°
 ELEV.: 4637'
 PDOP.: 1.4
 FOOTAGE: 941' FNL, 82' FWL
 QTR/QTR: NW4/NW4
 DATE: 1/25/2012

ASSOCIATED EXISTING WELLS:

OLE 4-24, OLE 21-24

ASSOCIATED NEW WELLS:

WAKE E24-77HN

DISTANCE TO NEAREST:

BUILDING: 263'± N
 PUBLIC ROAD: 75'± W
 OVERHEAD UTILITY: 120'± W
 RAILROAD: 5280'±
 PROP. LINE: 82'± W

EXISTING FACILITIES:

TANKS: 2
 SEPARATORS: 2
 EMF: 2
 VOC: 1

IMPROVEMENTS

1. PROD. EQUIP:	45'± N
2. FIELD ROAD:	78'± N
3. PROD. TANKS:	118'± N
4. PROD. EQUIP:	234'± NE
5. CONC. DITCH:	64'± W
6. E EDGE WCR 47:	75'± W
7. O.H. UTILITY:	120'± W
8. IRRIG. PUMP:	287'± N
9. BUILDING:	263'± N
10. BUILDING:	350'± N
11. BUILDING:	359'± N
12. CONC. DITCH:	339'± NE
13. GAS WELL:	630'± NE