



Scientific Drilling
Rocky Mountain Operations

Company: OXY USA RMAT
Project: Garfield County, CO NAD27
Site: Cascade Creek 697-06A Pad



Well Details: CC 697-06-08

TVD Reference: GL 8184' & RKB 30' @ 8214.00ft (H&P) Ground Level: 8184.00
+N/-S 0.00 +E/-W 0.00 Northing 639483.07 Easting 1223037.36 Latitude 39° 33' 24.647 N Longitude 108° 15' 21.466 W Slot E



Azimuths to True North
Magnetic North: 10.51°

Magnetic Field
Strength: 52311.9snT
Dip Angle: 65.77°
Date: 2010/12/20
Model: IGRF2005-10

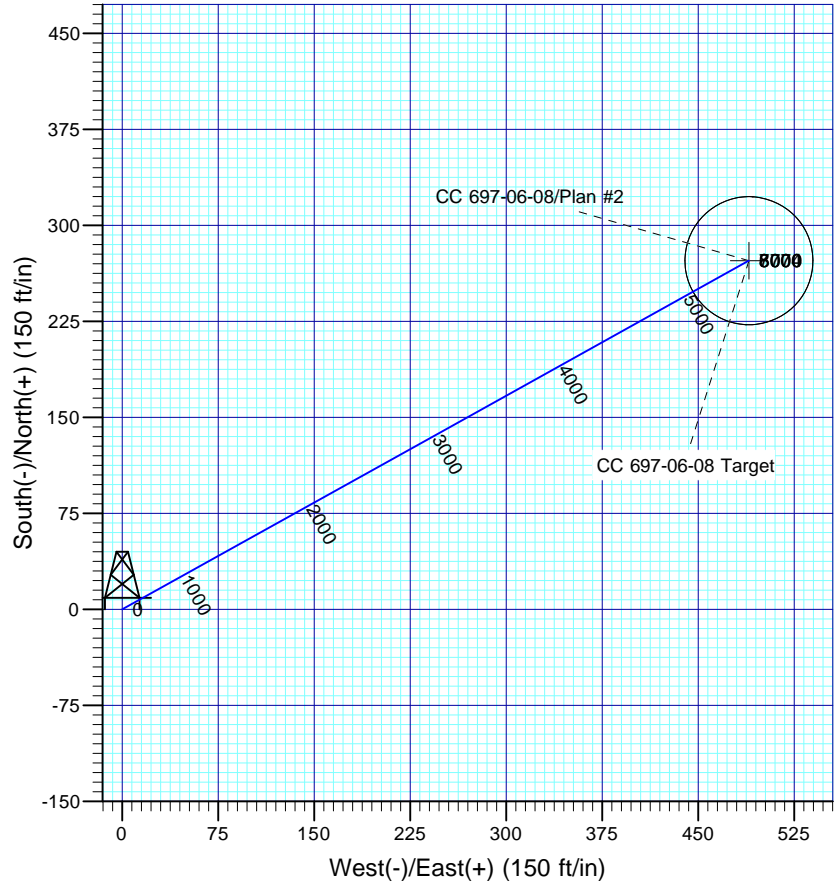
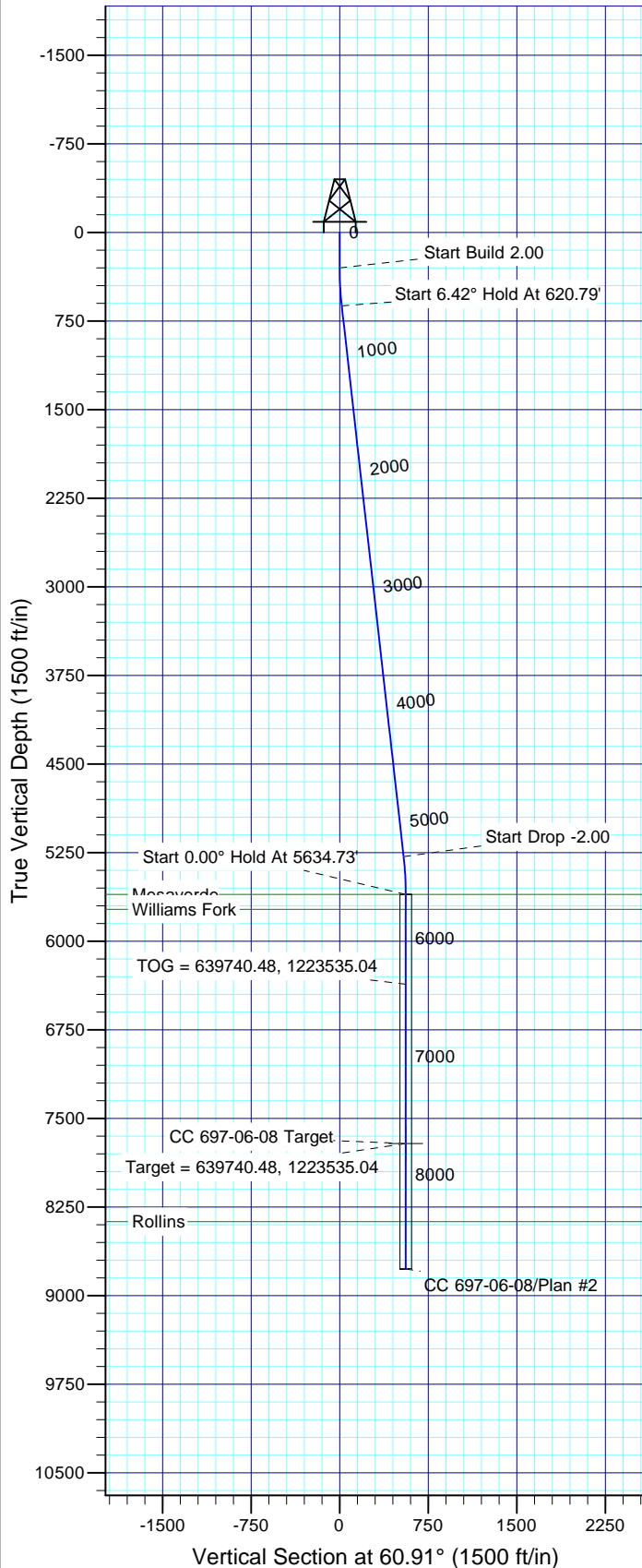

FORMATION TOP DETAILS

TVDPath	MDPath	Formation
5604.00	5634.73	Mesaverde
5729.00	5759.73	Williams Fork
8374.00	8404.73	Rollins

Plan: Plan #2

20:30, February 03 2011
Created By: Rex Hall

PROJECT DETAILS: Garfield County, CO NAD27

Geodetic System: US State Plane 1927 (Exact solution)
Datum: NAD 1927 (NADCON CONUS)
Ellipsoid: Clarke 1866
Zone: Colorado Central 502

System Datum: Mean Sea Level

SECTION DETAILS

Sec	MD	Inc	Azi	TVD	+N/-S	+E/-W	Dleg	TFace	V Sect	Target
1	0.00	0.00	0.00	0.00	0.00	0.00	0.00	0.00	0.00	
2	300.00	0.00	0.00	300.00	0.00	0.00	0.00	0.00	0.00	
3	620.79	6.42	60.91	620.12	8.72	15.68	2.00	60.91	17.94	
4	5313.94	6.42	60.91	5283.88	263.67	473.96	0.00	0.00	542.37	
5	5634.73	0.00	0.00	5604.00	272.39	489.64	2.00	180.00	560.31	
6	7743.73	0.00	0.00	7713.00	272.39	489.64	0.00	0.00	560.31	
7	8804.73	0.00	0.00	8774.00	272.39	489.64	0.00	0.00	560.31	CC 697-06-08 Target

OXY USA RMAT

**Garfield County, CO NAD27
Cascade Creek 697-06A Pad
CC 697-06-08 - Slot E**

OH

Plan: Plan #2

Standard Planning Report

03 February, 2011

Scientific Drilling International

Planning Report

Database:	EDM-RexH-Local	Local Co-ordinate Reference:	Well CC 697-06-08 - Slot E
Company:	OXY USA RMAT	TVD Reference:	GL 8184' & RKB 30' @ 8214.00ft (H&P)
Project:	Garfield County, CO NAD27	MD Reference:	GL 8184' & RKB 30' @ 8214.00ft (H&P)
Site:	Cascade Creek 697-06A Pad	North Reference:	True
Well:	CC 697-06-08	Survey Calculation Method:	Minimum Curvature
Wellbore:	OH		
Design:	Plan #2		

Project	Garfield County, CO NAD27		
Map System:	US State Plane 1927 (Exact solution)	System Datum:	Mean Sea Level
Geo Datum:	NAD 1927 (NADCON CONUS)		
Map Zone:	Colorado Central 502		

Site		Cascade Creek 697-06A Pad, Sec 6 T6S R97W			
Site Position:		Northing:	639,442.25 usft	Latitude:	39° 33' 24.203 N
From:	Map	Easting:	1,222,903.93 usft	Longitude:	108° 15' 23.153 W
Position Uncertainty:	0.00 ft	Slot Radius:	13.200 in	Grid Convergence:	-1.74 °

Well	CC 697-06-08 - Slot E					
Well Position	+N/-S	44.85 ft	Northing:	639,483.07 usft	Latitude:	39° 33' 24.647 N
	+E/-W	132.13 ft	Easting:	1,223,037.36 usft	Longitude:	108° 15' 21.466 W
Position Uncertainty		0.00 ft	Wellhead Elevation:		Ground Level:	8,184.00 ft

Wellbore	OH				
Magnetics	Model Name	Sample Date	Declination (°)	Dip Angle (°)	Field Strength (nT)
	IGRF2005-10	2010/12/20	10.51	65.77	52,312

Design	Plan #2			
Audit Notes:				
Version:	Phase:	PLAN	Tie On Depth:	0.00
Vertical Section:	Depth From (TVD) (ft)	+N/-S (ft)	+E/-W (ft)	Direction (°)
	0.00	0.00	0.00	60.91

Plan Sections										
Measured Depth (ft)	Inclination (°)	Azimuth (°)	Vertical Depth (ft)	+N/-S (ft)	+E/-W (ft)	Dogleg Rate (°/100ft)	Build Rate (°/100ft)	Turn Rate (°/100ft)	TFO (°)	Target
0.00	0.00	0.00	0.00	0.00	0.00	0.00	0.00	0.00	0.00	
300.00	0.00	0.00	300.00	0.00	0.00	0.00	0.00	0.00	0.00	
620.79	6.42	60.91	620.12	8.72	15.68	2.00	2.00	0.00	60.91	
5,313.94	6.42	60.91	5,283.88	263.67	473.96	0.00	0.00	0.00	0.00	
5,634.73	0.00	0.00	5,604.00	272.39	489.64	2.00	-2.00	0.00	180.00	
7,743.73	0.00	0.00	7,713.00	272.39	489.64	0.00	0.00	0.00	0.00	CC 697-06-08 Target
8,804.73	0.00	0.00	8,774.00	272.39	489.64	0.00	0.00	0.00	0.00	

Scientific Drilling International

Planning Report

Database:	EDM-RexH-Local	Local Co-ordinate Reference:	Well CC 697-06-08 - Slot E
Company:	OXY USA RMAT	TVD Reference:	GL 8184' & RKB 30' @ 8214.00ft (H&P)
Project:	Garfield County, CO NAD27	MD Reference:	GL 8184' & RKB 30' @ 8214.00ft (H&P)
Site:	Cascade Creek 697-06A Pad	North Reference:	True
Well:	CC 697-06-08	Survey Calculation Method:	Minimum Curvature
Wellbore:	OH		
Design:	Plan #2		

Planned Survey									
Measured Depth (ft)	Inclination (°)	Azimuth (°)	Vertical Depth (ft)	+N/-S (ft)	+E/-W (ft)	Vertical Section (ft)	Dogleg Rate (°/100ft)	Build Rate (°/100ft)	Turn Rate (°/100ft)
0.00	0.00	0.00	0.00	0.00	0.00	0.00	0.00	0.00	0.00
100.00	0.00	0.00	100.00	0.00	0.00	0.00	0.00	0.00	0.00
200.00	0.00	0.00	200.00	0.00	0.00	0.00	0.00	0.00	0.00
300.00	0.00	0.00	300.00	0.00	0.00	0.00	0.00	0.00	0.00
Start Build 2.00									
400.00	2.00	60.91	399.98	0.85	1.53	1.75	2.00	2.00	0.00
500.00	4.00	60.91	499.84	3.39	6.10	6.98	2.00	2.00	0.00
600.00	6.00	60.91	599.45	7.63	13.71	15.69	2.00	2.00	0.00
620.79	6.42	60.91	620.12	8.72	15.68	17.94	2.00	2.00	0.00
Start 6.42° Hold At 620.79'									
700.00	6.42	60.91	698.83	13.03	23.41	26.79	0.00	0.00	0.00
800.00	6.42	60.91	798.21	18.46	33.18	37.97	0.00	0.00	0.00
900.00	6.42	60.91	897.58	23.89	42.94	49.14	0.00	0.00	0.00
1,000.00	6.42	60.91	996.96	29.32	52.71	60.32	0.00	0.00	0.00
1,100.00	6.42	60.91	1,096.33	34.75	62.47	71.49	0.00	0.00	0.00
1,200.00	6.42	60.91	1,195.70	40.19	72.24	82.66	0.00	0.00	0.00
1,300.00	6.42	60.91	1,295.08	45.62	82.00	93.84	0.00	0.00	0.00
1,400.00	6.42	60.91	1,394.45	51.05	91.77	105.01	0.00	0.00	0.00
1,500.00	6.42	60.91	1,493.82	56.48	101.53	116.19	0.00	0.00	0.00
1,600.00	6.42	60.91	1,593.20	61.92	111.30	127.36	0.00	0.00	0.00
1,700.00	6.42	60.91	1,692.57	67.35	121.06	138.54	0.00	0.00	0.00
1,800.00	6.42	60.91	1,791.94	72.78	130.83	149.71	0.00	0.00	0.00
1,900.00	6.42	60.91	1,891.32	78.21	140.59	160.88	0.00	0.00	0.00
2,000.00	6.42	60.91	1,990.69	83.64	150.36	172.06	0.00	0.00	0.00
2,100.00	6.42	60.91	2,090.07	89.08	160.12	183.23	0.00	0.00	0.00
2,200.00	6.42	60.91	2,189.44	94.51	169.89	194.41	0.00	0.00	0.00
2,300.00	6.42	60.91	2,288.81	99.94	179.65	205.58	0.00	0.00	0.00
2,400.00	6.42	60.91	2,388.19	105.37	189.42	216.76	0.00	0.00	0.00
2,500.00	6.42	60.91	2,487.56	110.81	199.18	227.93	0.00	0.00	0.00
2,600.00	6.42	60.91	2,586.93	116.24	208.95	239.10	0.00	0.00	0.00
2,700.00	6.42	60.91	2,686.31	121.67	218.71	250.28	0.00	0.00	0.00
2,800.00	6.42	60.91	2,785.68	127.10	228.48	261.45	0.00	0.00	0.00
2,900.00	6.42	60.91	2,885.06	132.53	238.24	272.63	0.00	0.00	0.00
3,000.00	6.42	60.91	2,984.43	137.97	248.01	283.80	0.00	0.00	0.00
3,100.00	6.42	60.91	3,083.80	143.40	257.77	294.97	0.00	0.00	0.00
3,200.00	6.42	60.91	3,183.18	148.83	267.54	306.15	0.00	0.00	0.00
3,300.00	6.42	60.91	3,282.55	154.26	277.30	317.32	0.00	0.00	0.00
3,400.00	6.42	60.91	3,381.92	159.70	287.07	328.50	0.00	0.00	0.00
3,500.00	6.42	60.91	3,481.30	165.13	296.83	339.67	0.00	0.00	0.00
3,600.00	6.42	60.91	3,580.67	170.56	306.60	350.85	0.00	0.00	0.00
3,700.00	6.42	60.91	3,680.05	175.99	316.36	362.02	0.00	0.00	0.00
3,800.00	6.42	60.91	3,779.42	181.42	326.13	373.19	0.00	0.00	0.00
3,900.00	6.42	60.91	3,878.79	186.86	335.89	384.37	0.00	0.00	0.00
4,000.00	6.42	60.91	3,978.17	192.29	345.66	395.54	0.00	0.00	0.00
4,100.00	6.42	60.91	4,077.54	197.72	355.42	406.72	0.00	0.00	0.00
4,200.00	6.42	60.91	4,176.91	203.15	365.19	417.89	0.00	0.00	0.00
4,300.00	6.42	60.91	4,276.29	208.59	374.95	429.07	0.00	0.00	0.00
4,400.00	6.42	60.91	4,375.66	214.02	384.72	440.24	0.00	0.00	0.00
4,500.00	6.42	60.91	4,475.04	219.45	394.48	451.41	0.00	0.00	0.00
4,600.00	6.42	60.91	4,574.41	224.88	404.25	462.59	0.00	0.00	0.00
4,700.00	6.42	60.91	4,673.78	230.31	414.01	473.76	0.00	0.00	0.00
4,800.00	6.42	60.91	4,773.16	235.75	423.78	484.94	0.00	0.00	0.00
4,900.00	6.42	60.91	4,872.53	241.18	433.54	496.11	0.00	0.00	0.00
5,000.00	6.42	60.91	4,971.90	246.61	443.31	507.29	0.00	0.00	0.00

Scientific Drilling International

Planning Report

Database:	EDM-RexH-Local	Local Co-ordinate Reference:	Well CC 697-06-08 - Slot E
Company:	OXY USA RMAT	TVD Reference:	GL 8184' & RKB 30' @ 8214.00ft (H&P)
Project:	Garfield County, CO NAD27	MD Reference:	GL 8184' & RKB 30' @ 8214.00ft (H&P)
Site:	Cascade Creek 697-06A Pad	North Reference:	True
Well:	CC 697-06-08	Survey Calculation Method:	Minimum Curvature
Wellbore:	OH		
Design:	Plan #2		

Planned Survey									
Measured Depth (ft)	Inclination (°)	Azimuth (°)	Vertical Depth (ft)	+N/-S (ft)	+E/-W (ft)	Vertical Section (ft)	Dogleg Rate (°/100ft)	Build Rate (°/100ft)	Turn Rate (°/100ft)
5,100.00	6.42	60.91	5,071.28	252.04	453.07	518.46	0.00	0.00	0.00
5,200.00	6.42	60.91	5,170.65	257.48	462.84	529.63	0.00	0.00	0.00
5,300.00	6.42	60.91	5,270.03	262.91	472.60	540.81	0.00	0.00	0.00
5,313.94	6.42	60.91	5,283.88	263.67	473.96	542.37	0.00	0.00	0.00
Start Drop -2.00									
5,400.00	4.69	60.91	5,369.53	267.72	481.24	550.70	2.00	-2.00	0.00
5,500.00	2.69	60.91	5,469.32	270.85	486.87	557.14	2.00	-2.00	0.00
5,600.00	0.69	60.91	5,569.27	272.29	489.46	560.10	2.00	-2.00	0.00
5,634.73	0.00	0.00	5,604.00	272.39	489.64	560.31	2.00	-2.00	0.00
Start 0.00° Hold At 5634.73' - Mesaverde									
5,700.00	0.00	0.00	5,669.27	272.39	489.64	560.31	0.00	0.00	0.00
5,759.73	0.00	0.00	5,729.00	272.39	489.64	560.31	0.00	0.00	0.00
Williams Fork									
5,800.00	0.00	0.00	5,769.27	272.39	489.64	560.31	0.00	0.00	0.00
5,900.00	0.00	0.00	5,869.27	272.39	489.64	560.31	0.00	0.00	0.00
6,000.00	0.00	0.00	5,969.27	272.39	489.64	560.31	0.00	0.00	0.00
6,100.00	0.00	0.00	6,069.27	272.39	489.64	560.31	0.00	0.00	0.00
6,200.00	0.00	0.00	6,169.27	272.39	489.64	560.31	0.00	0.00	0.00
6,300.00	0.00	0.00	6,269.27	272.39	489.64	560.31	0.00	0.00	0.00
6,394.73	0.00	0.00	6,364.00	272.39	489.64	560.31	0.00	0.00	0.00
TOG = 639740.48, 1223535.04									
6,400.00	0.00	0.00	6,369.27	272.39	489.64	560.31	0.00	0.00	0.00
6,500.00	0.00	0.00	6,469.27	272.39	489.64	560.31	0.00	0.00	0.00
6,600.00	0.00	0.00	6,569.27	272.39	489.64	560.31	0.00	0.00	0.00
6,700.00	0.00	0.00	6,669.27	272.39	489.64	560.31	0.00	0.00	0.00
6,800.00	0.00	0.00	6,769.27	272.39	489.64	560.31	0.00	0.00	0.00
6,900.00	0.00	0.00	6,869.27	272.39	489.64	560.31	0.00	0.00	0.00
7,000.00	0.00	0.00	6,969.27	272.39	489.64	560.31	0.00	0.00	0.00
7,100.00	0.00	0.00	7,069.27	272.39	489.64	560.31	0.00	0.00	0.00
7,200.00	0.00	0.00	7,169.27	272.39	489.64	560.31	0.00	0.00	0.00
7,300.00	0.00	0.00	7,269.27	272.39	489.64	560.31	0.00	0.00	0.00
7,400.00	0.00	0.00	7,369.27	272.39	489.64	560.31	0.00	0.00	0.00
7,500.00	0.00	0.00	7,469.27	272.39	489.64	560.31	0.00	0.00	0.00
7,600.00	0.00	0.00	7,569.27	272.39	489.64	560.31	0.00	0.00	0.00
7,700.00	0.00	0.00	7,669.27	272.39	489.64	560.31	0.00	0.00	0.00
7,743.73	0.00	0.00	7,713.00	272.39	489.64	560.31	0.00	0.00	0.00
Target = 639740.48, 1223535.04									
7,800.00	0.00	0.00	7,769.27	272.39	489.64	560.31	0.00	0.00	0.00
7,900.00	0.00	0.00	7,869.27	272.39	489.64	560.31	0.00	0.00	0.00
8,000.00	0.00	0.00	7,969.27	272.39	489.64	560.31	0.00	0.00	0.00
8,100.00	0.00	0.00	8,069.27	272.39	489.64	560.31	0.00	0.00	0.00
8,200.00	0.00	0.00	8,169.27	272.39	489.64	560.31	0.00	0.00	0.00
8,300.00	0.00	0.00	8,269.27	272.39	489.64	560.31	0.00	0.00	0.00
8,400.00	0.00	0.00	8,369.27	272.39	489.64	560.31	0.00	0.00	0.00
8,404.73	0.00	0.00	8,374.00	272.39	489.64	560.31	0.00	0.00	0.00
Rollins									
8,500.00	0.00	0.00	8,469.27	272.39	489.64	560.31	0.00	0.00	0.00
8,600.00	0.00	0.00	8,569.27	272.39	489.64	560.31	0.00	0.00	0.00
8,700.00	0.00	0.00	8,669.27	272.39	489.64	560.31	0.00	0.00	0.00
8,800.00	0.00	0.00	8,769.27	272.39	489.64	560.31	0.00	0.00	0.00
8,804.73	0.00	0.00	8,774.00	272.39	489.64	560.31	0.00	0.00	0.00
PBHL = 639740.48, 1223535.04									

Scientific Drilling International

Planning Report

Database:	EDM-RexH-Local	Local Co-ordinate Reference:	Well CC 697-06-08 - Slot E
Company:	OXY USA RMAT	TVD Reference:	GL 8184' & RKB 30' @ 8214.00ft (H&P)
Project:	Garfield County, CO NAD27	MD Reference:	GL 8184' & RKB 30' @ 8214.00ft (H&P)
Site:	Cascade Creek 697-06A Pad	North Reference:	True
Well:	CC 697-06-08	Survey Calculation Method:	Minimum Curvature
Wellbore:	OH		
Design:	Plan #2		

Design Targets									
Target Name	Dip Angle	Dip Dir.	TVD	+N/-S	+E/-W	Northing	Easting	Latitude	Longitude
- hit/miss target	(°)	(°)	(ft)	(ft)	(ft)	(usft)	(usft)		
- Shape									
CC 697-06-08 Target	0.00	0.00	7,713.00	272.39	489.64	639,740.48	1,223,535.04	39° 33' 27.339 N	108° 15' 15.214 W
- plan hits target center									
- Circle (radius 50.00)									

Formations					
Measured Depth	Vertical Depth	Name	Lithology	Dip	Dip Direction
(ft)	(ft)			(°)	(°)
5,634.73	5,604.00	Mesaverde		0.00	
5,759.73	5,729.00	Williams Fork		0.00	
8,404.73	8,374.00	Rollins		0.00	

Plan Annotations				
Measured Depth	Vertical Depth	Local Coordinates		Comment
(ft)	(ft)	+N/-S (ft)	+E/-W (ft)	
300.00	300.00	0.00	0.00	Start Build 2.00
620.79	620.12	8.72	15.68	Start 6.42° Hold At 620.79'
5,313.94	5,283.88	263.67	473.96	Start Drop -2.00
5,634.73	5,604.00	272.39	489.64	Start 0.00° Hold At 5634.73'
6,394.73	6,364.00	272.39	489.64	TOG = 639740.48, 1223535.04
7,743.73	7,713.00	272.39	489.64	Target = 639740.48, 1223535.04
8,804.73	8,774.00	272.39	489.64	PBHL = 639740.48, 1223535.04