



Scientific Drilling
Rocky Mountain Operations

Company: OXY USA RMAT
Project: Garfield County, CO NAD27
Site: Cascade Creek 697-06A Pad



Well Details: CC 697-05-34B

TVD Reference: GL 8184' & RKB 30' @ 8214.00ft (H&P) Ground Level: 8184.00
+N/-S 0.00 +E/-W 0.00 Northing 639442.01 Easting 1223055.79 Latitude 39° 33' 24.247 N Longitude 108° 15' 21.215 W Slot Q



Azimuths to True North
Magnetic North: 10.51°

Magnetic Field
Strength: 52311.8snT
Dip Angle: 65.77°
Date: 2010/12/20
Model: IGRF2005-10

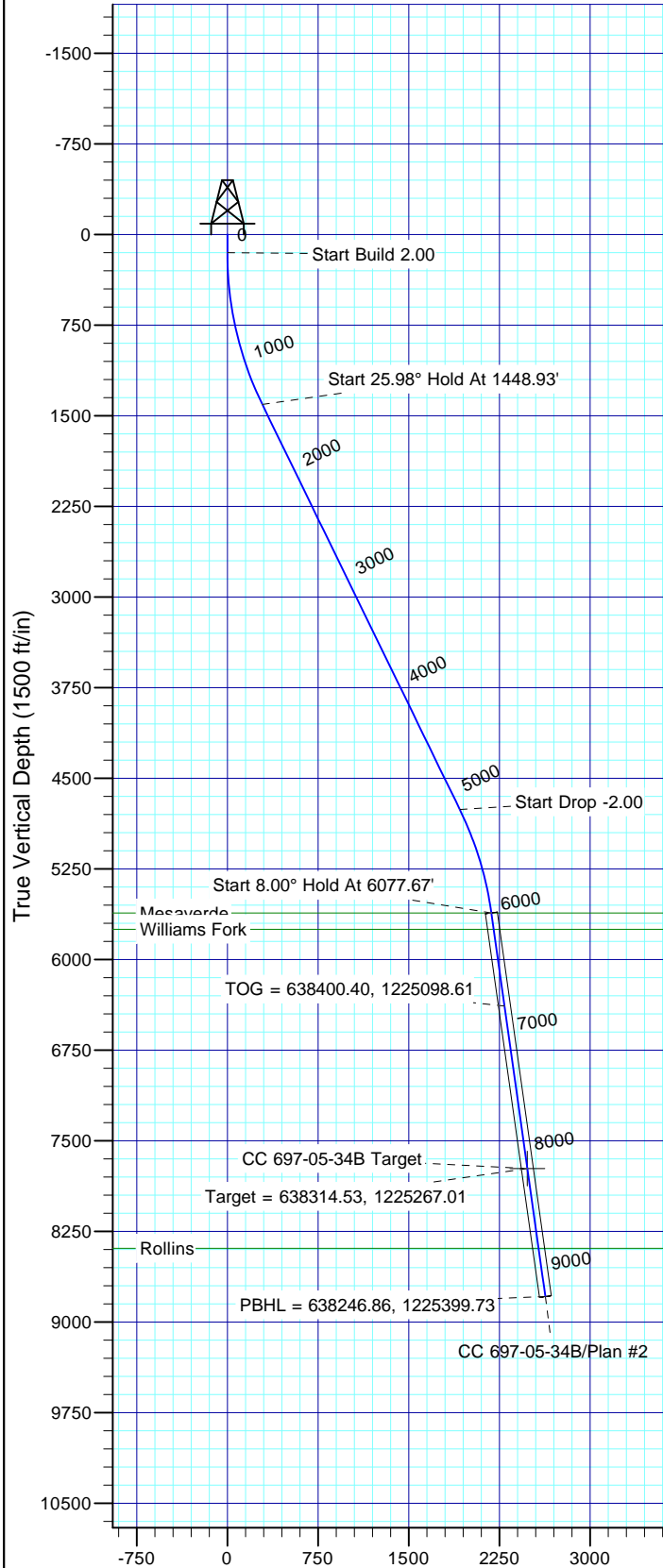

Vertical Section at 115.28° (1500 ft/in)

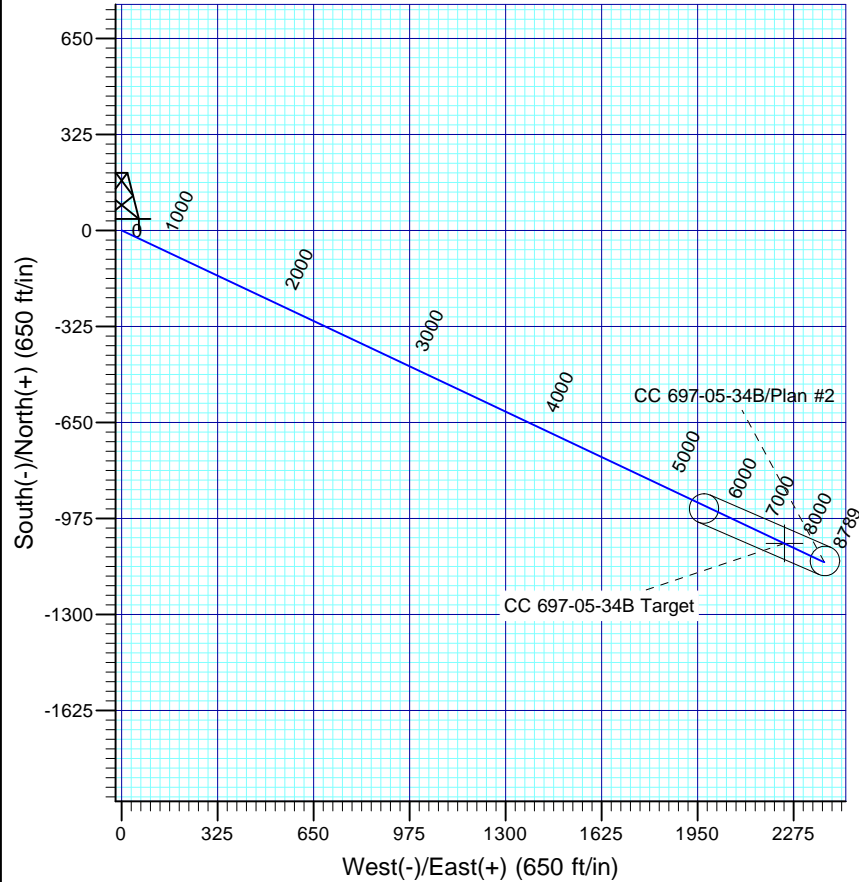

FORMATION TOP DETAILS

| TVDPath | MDPath | Formation |
|---------|---------|---------------|
| 5614.00 | 6077.67 | Mesaverde |
| 5749.00 | 6214.00 | Williams Fork |
| 8389.00 | 8879.94 | Rollins |

Plan: Plan #2

12:16, February 03 2011
Created By: Rex Hall

PROJECT DETAILS: Garfield County, CO NAD27

Geodetic System: US State Plane 1927 (Exact solution)
Datum: NAD 1927 (NADCON CONUS)
Ellipsoid: Clarke 1866
Zone: Colorado Central 502

System Datum: Mean Sea Level

SECTION DETAILS

| Sec | MD | Inc | Azi | TVD | +N/-S | +E/-W | Dleg | TFace | Vsect | Target |
|-----|---------|-------|--------|---------|----------|---------|------|--------|---------|----------------------|
| 1 | 0.00 | 0.00 | 0.00 | 0.00 | 0.00 | 0.00 | 0.00 | 0.00 | 0.00 | |
| 2 | 150.00 | 0.00 | 0.00 | 150.00 | 0.00 | 0.00 | 0.00 | 0.00 | 0.00 | |
| 3 | 1448.93 | 25.98 | 115.28 | 1404.88 | -123.61 | 261.75 | 2.00 | 115.28 | 289.46 | |
| 4 | 5178.74 | 25.98 | 115.28 | 4757.82 | -821.26 | 1739.09 | 0.00 | 0.00 | 1923.25 | |
| 5 | 6077.67 | 8.00 | 115.28 | 5614.00 | -932.96 | 1975.62 | 2.00 | 180.00 | 2184.84 | |
| 6 | 8213.46 | 8.00 | 115.28 | 7729.00 | -1059.89 | 2244.41 | 0.00 | 0.00 | 2482.08 | CC 697-05-34B Target |
| 7 | 9283.87 | 8.00 | 115.28 | 8789.00 | -1123.50 | 2379.11 | 0.00 | 0.00 | 2631.05 | |

OXY USA RMAT

**Garfield County, CO NAD27
Cascade Creek 697-06A Pad
CC 697-05-34B - Slot Q**

OH

Plan: Plan #2

Standard Planning Report

03 February, 2011

Scientific Drilling International

Planning Report

| | | | |
|------------------|---------------------------|-------------------------------------|--------------------------------------|
| Database: | EDM-RexH-Local | Local Co-ordinate Reference: | Well CC 697-05-34B - Slot Q |
| Company: | OXY USA RMAT | TVD Reference: | GL 8184' & RKB 30' @ 8214.00ft (H&P) |
| Project: | Garfield County, CO NAD27 | MD Reference: | GL 8184' & RKB 30' @ 8214.00ft (H&P) |
| Site: | Cascade Creek 697-06A Pad | North Reference: | True |
| Well: | CC 697-05-34B | Survey Calculation Method: | Minimum Curvature |
| Wellbore: | OH | | |
| Design: | Plan #2 | | |

| | | | |
|--------------------|--------------------------------------|----------------------|----------------|
| Project | Garfield County, CO NAD27 | | |
| Map System: | US State Plane 1927 (Exact solution) | System Datum: | Mean Sea Level |
| Geo Datum: | NAD 1927 (NADCON CONUS) | | |
| Map Zone: | Colorado Central 502 | | |

| | | | | | |
|-----------------------|---------|---|-------------------|-------------------|-------------------|
| Site | | Cascade Creek 697-06A Pad, Sec 6 T6S R97W | | | |
| Site Position: | | Northing: | 639,442.25 usft | Latitude: | 39° 33' 24.203 N |
| From: | Map | Easting: | 1,222,903.93 usft | Longitude: | 108° 15' 23.153 W |
| Position Uncertainty: | 0.00 ft | Slot Radius: | 13.200 in | Grid Convergence: | -1.74 ° |

| Well | CC 697-05-34B - Slot Q | | | | | |
|----------------------|------------------------|-----------|---------------------|-------------------|---------------|-------------------|
| Well Position | +N/-S | 4.37 ft | Northing: | 639,442.01 usft | Latitude: | 39° 33' 24.247 N |
| | +E/-W | 151.80 ft | Easting: | 1,223,055.79 usft | Longitude: | 108° 15' 21.215 W |
| Position Uncertainty | | 0.00 ft | Wellhead Elevation: | | Ground Level: | 8,184.00 ft |

| | | | | | |
|------------------|-------------------|--------------------|------------------------|----------------------|----------------------------|
| Wellbore | OH | | | | |
| Magnetics | Model Name | Sample Date | Declination (°) | Dip Angle (°) | Field Strength (nT) |
| | IGRF2005-10 | 2010/12/20 | 10.51 | 65.77 | 52,312 |

| | | | | |
|--------------------------|------------------------------|-------------------|----------------------|----------------------|
| Design | Plan #2 | | | |
| Audit Notes: | | | | |
| Version: | Phase: | PLAN | Tie On Depth: | 0.00 |
| Vertical Section: | Depth From (TVD) (ft) | +N/-S (ft) | +E/-W (ft) | Direction (°) |
| | 0.00 | 0.00 | 0.00 | 115.28 |

| Plan Sections | | | | | | | | | | |
|----------------------|-----------------|-------------|---------------------|------------|------------|-----------------------|----------------------|---------------------|---------|----------------------|
| Measured Depth (ft) | Inclination (°) | Azimuth (°) | Vertical Depth (ft) | +N/-S (ft) | +E/-W (ft) | Dogleg Rate (°/100ft) | Build Rate (°/100ft) | Turn Rate (°/100ft) | TFO (°) | Target |
| 0.00 | 0.00 | 0.00 | 0.00 | 0.00 | 0.00 | 0.00 | 0.00 | 0.00 | 0.00 | |
| 150.00 | 0.00 | 0.00 | 150.00 | 0.00 | 0.00 | 0.00 | 0.00 | 0.00 | 0.00 | |
| 1,448.93 | 25.98 | 115.28 | 1,404.88 | -123.61 | 261.75 | 2.00 | 2.00 | 0.00 | 115.28 | |
| 5,178.74 | 25.98 | 115.28 | 4,757.82 | -821.26 | 1,739.09 | 0.00 | 0.00 | 0.00 | 0.00 | |
| 6,077.67 | 8.00 | 115.28 | 5,614.00 | -932.96 | 1,975.62 | 2.00 | -2.00 | 0.00 | 180.00 | |
| 8,213.46 | 8.00 | 115.28 | 7,729.00 | -1,059.89 | 2,244.41 | 0.00 | 0.00 | 0.00 | 0.00 | CC 697-05-34B Target |
| 9,283.87 | 8.00 | 115.28 | 8,789.00 | -1,123.50 | 2,379.11 | 0.00 | 0.00 | 0.00 | 0.00 | |

Scientific Drilling International

Planning Report

| | | | |
|------------------|---------------------------|-------------------------------------|--------------------------------------|
| Database: | EDM-RexH-Local | Local Co-ordinate Reference: | Well CC 697-05-34B - Slot Q |
| Company: | OXY USA RMAT | TVD Reference: | GL 8184' & RKB 30' @ 8214.00ft (H&P) |
| Project: | Garfield County, CO NAD27 | MD Reference: | GL 8184' & RKB 30' @ 8214.00ft (H&P) |
| Site: | Cascade Creek 697-06A Pad | North Reference: | True |
| Well: | CC 697-05-34B | Survey Calculation Method: | Minimum Curvature |
| Wellbore: | OH | | |
| Design: | Plan #2 | | |

| Planned Survey | | | | | | | | | |
|-------------------------------|-----------------|-------------|---------------------|------------|------------|-----------------------|-----------------------|----------------------|---------------------|
| Measured Depth (ft) | Inclination (°) | Azimuth (°) | Vertical Depth (ft) | +N/-S (ft) | +E/-W (ft) | Vertical Section (ft) | Dogleg Rate (°/100ft) | Build Rate (°/100ft) | Turn Rate (°/100ft) |
| 0.00 | 0.00 | 0.00 | 0.00 | 0.00 | 0.00 | 0.00 | 0.00 | 0.00 | 0.00 |
| 100.00 | 0.00 | 0.00 | 100.00 | 0.00 | 0.00 | 0.00 | 0.00 | 0.00 | 0.00 |
| 150.00 | 0.00 | 0.00 | 150.00 | 0.00 | 0.00 | 0.00 | 0.00 | 0.00 | 0.00 |
| Start Build 2.00 | | | | | | | | | |
| 200.00 | 1.00 | 115.28 | 200.00 | -0.19 | 0.39 | 0.44 | 2.00 | 2.00 | 0.00 |
| 300.00 | 3.00 | 115.28 | 299.93 | -1.68 | 3.55 | 3.93 | 2.00 | 2.00 | 0.00 |
| 400.00 | 5.00 | 115.28 | 399.68 | -4.66 | 9.86 | 10.90 | 2.00 | 2.00 | 0.00 |
| 500.00 | 7.00 | 115.28 | 499.13 | -9.12 | 19.31 | 21.35 | 2.00 | 2.00 | 0.00 |
| 600.00 | 9.00 | 115.28 | 598.15 | -15.06 | 31.89 | 35.27 | 2.00 | 2.00 | 0.00 |
| 700.00 | 11.00 | 115.28 | 696.63 | -22.48 | 47.59 | 52.63 | 2.00 | 2.00 | 0.00 |
| 800.00 | 13.00 | 115.28 | 794.44 | -31.35 | 66.39 | 73.42 | 2.00 | 2.00 | 0.00 |
| 900.00 | 15.00 | 115.28 | 891.46 | -41.68 | 88.27 | 97.62 | 2.00 | 2.00 | 0.00 |
| 1,000.00 | 17.00 | 115.28 | 987.58 | -53.45 | 113.19 | 125.18 | 2.00 | 2.00 | 0.00 |
| 1,100.00 | 19.00 | 115.28 | 1,082.68 | -66.65 | 141.13 | 156.08 | 2.00 | 2.00 | 0.00 |
| 1,200.00 | 21.00 | 115.28 | 1,176.65 | -81.25 | 172.06 | 190.28 | 2.00 | 2.00 | 0.00 |
| 1,300.00 | 23.00 | 115.28 | 1,269.36 | -97.25 | 205.93 | 227.74 | 2.00 | 2.00 | 0.00 |
| 1,400.00 | 25.00 | 115.28 | 1,360.71 | -114.61 | 242.71 | 268.41 | 2.00 | 2.00 | 0.00 |
| 1,448.93 | 25.98 | 115.28 | 1,404.88 | -123.61 | 261.75 | 289.46 | 2.00 | 2.00 | 0.00 |
| Start 25.98° Hold At 1448.93' | | | | | | | | | |
| 1,500.00 | 25.98 | 115.28 | 1,450.79 | -133.16 | 281.98 | 311.84 | 0.00 | 0.00 | 0.00 |
| 1,600.00 | 25.98 | 115.28 | 1,540.68 | -151.86 | 321.58 | 355.64 | 0.00 | 0.00 | 0.00 |
| 1,700.00 | 25.98 | 115.28 | 1,630.58 | -170.57 | 361.19 | 399.44 | 0.00 | 0.00 | 0.00 |
| 1,800.00 | 25.98 | 115.28 | 1,720.48 | -189.27 | 400.80 | 443.25 | 0.00 | 0.00 | 0.00 |
| 1,900.00 | 25.98 | 115.28 | 1,810.37 | -207.98 | 440.41 | 487.05 | 0.00 | 0.00 | 0.00 |
| 2,000.00 | 25.98 | 115.28 | 1,900.27 | -226.68 | 480.02 | 530.85 | 0.00 | 0.00 | 0.00 |
| 2,100.00 | 25.98 | 115.28 | 1,990.16 | -245.39 | 519.63 | 574.66 | 0.00 | 0.00 | 0.00 |
| 2,200.00 | 25.98 | 115.28 | 2,080.06 | -264.09 | 559.24 | 618.46 | 0.00 | 0.00 | 0.00 |
| 2,300.00 | 25.98 | 115.28 | 2,169.96 | -282.80 | 598.85 | 662.26 | 0.00 | 0.00 | 0.00 |
| 2,400.00 | 25.98 | 115.28 | 2,259.85 | -301.50 | 638.46 | 706.07 | 0.00 | 0.00 | 0.00 |
| 2,500.00 | 25.98 | 115.28 | 2,349.75 | -320.21 | 678.07 | 749.87 | 0.00 | 0.00 | 0.00 |
| 2,600.00 | 25.98 | 115.28 | 2,439.64 | -338.91 | 717.67 | 793.67 | 0.00 | 0.00 | 0.00 |
| 2,700.00 | 25.98 | 115.28 | 2,529.54 | -357.62 | 757.28 | 837.48 | 0.00 | 0.00 | 0.00 |
| 2,800.00 | 25.98 | 115.28 | 2,619.43 | -376.32 | 796.89 | 881.28 | 0.00 | 0.00 | 0.00 |
| 2,900.00 | 25.98 | 115.28 | 2,709.33 | -395.03 | 836.50 | 925.08 | 0.00 | 0.00 | 0.00 |
| 3,000.00 | 25.98 | 115.28 | 2,799.23 | -413.73 | 876.11 | 968.89 | 0.00 | 0.00 | 0.00 |
| 3,100.00 | 25.98 | 115.28 | 2,889.12 | -432.44 | 915.72 | 1,012.69 | 0.00 | 0.00 | 0.00 |
| 3,200.00 | 25.98 | 115.28 | 2,979.02 | -451.14 | 955.33 | 1,056.50 | 0.00 | 0.00 | 0.00 |
| 3,300.00 | 25.98 | 115.28 | 3,068.91 | -469.85 | 994.94 | 1,100.30 | 0.00 | 0.00 | 0.00 |
| 3,400.00 | 25.98 | 115.28 | 3,158.81 | -488.55 | 1,034.55 | 1,144.10 | 0.00 | 0.00 | 0.00 |
| 3,500.00 | 25.98 | 115.28 | 3,248.70 | -507.26 | 1,074.16 | 1,187.91 | 0.00 | 0.00 | 0.00 |
| 3,600.00 | 25.98 | 115.28 | 3,338.60 | -525.96 | 1,113.77 | 1,231.71 | 0.00 | 0.00 | 0.00 |
| 3,700.00 | 25.98 | 115.28 | 3,428.50 | -544.67 | 1,153.37 | 1,275.51 | 0.00 | 0.00 | 0.00 |
| 3,800.00 | 25.98 | 115.28 | 3,518.39 | -563.37 | 1,192.98 | 1,319.32 | 0.00 | 0.00 | 0.00 |
| 3,900.00 | 25.98 | 115.28 | 3,608.29 | -582.08 | 1,232.59 | 1,363.12 | 0.00 | 0.00 | 0.00 |
| 4,000.00 | 25.98 | 115.28 | 3,698.18 | -600.78 | 1,272.20 | 1,406.92 | 0.00 | 0.00 | 0.00 |
| 4,100.00 | 25.98 | 115.28 | 3,788.08 | -619.49 | 1,311.81 | 1,450.73 | 0.00 | 0.00 | 0.00 |
| 4,200.00 | 25.98 | 115.28 | 3,877.97 | -638.19 | 1,351.42 | 1,494.53 | 0.00 | 0.00 | 0.00 |
| 4,300.00 | 25.98 | 115.28 | 3,967.87 | -656.89 | 1,391.03 | 1,538.33 | 0.00 | 0.00 | 0.00 |
| 4,400.00 | 25.98 | 115.28 | 4,057.77 | -675.60 | 1,430.64 | 1,582.14 | 0.00 | 0.00 | 0.00 |
| 4,500.00 | 25.98 | 115.28 | 4,147.66 | -694.30 | 1,470.25 | 1,625.94 | 0.00 | 0.00 | 0.00 |
| 4,600.00 | 25.98 | 115.28 | 4,237.56 | -713.01 | 1,509.86 | 1,669.74 | 0.00 | 0.00 | 0.00 |
| 4,700.00 | 25.98 | 115.28 | 4,327.45 | -731.71 | 1,549.47 | 1,713.55 | 0.00 | 0.00 | 0.00 |
| 4,800.00 | 25.98 | 115.28 | 4,417.35 | -750.42 | 1,589.07 | 1,757.35 | 0.00 | 0.00 | 0.00 |
| 4,900.00 | 25.98 | 115.28 | 4,507.25 | -769.12 | 1,628.68 | 1,801.16 | 0.00 | 0.00 | 0.00 |

Scientific Drilling International

Planning Report

| | | | |
|------------------|---------------------------|-------------------------------------|--------------------------------------|
| Database: | EDM-RexH-Local | Local Co-ordinate Reference: | Well CC 697-05-34B - Slot Q |
| Company: | OXY USA RMAT | TVD Reference: | GL 8184' & RKB 30' @ 8214.00ft (H&P) |
| Project: | Garfield County, CO NAD27 | MD Reference: | GL 8184' & RKB 30' @ 8214.00ft (H&P) |
| Site: | Cascade Creek 697-06A Pad | North Reference: | True |
| Well: | CC 697-05-34B | Survey Calculation Method: | Minimum Curvature |
| Wellbore: | OH | | |
| Design: | Plan #2 | | |

| Planned Survey | | | | | | | | | |
|---|-----------------|-------------|---------------------|------------|------------|-----------------------|-----------------------|----------------------|---------------------|
| Measured Depth (ft) | Inclination (°) | Azimuth (°) | Vertical Depth (ft) | +N/-S (ft) | +E/-W (ft) | Vertical Section (ft) | Dogleg Rate (°/100ft) | Build Rate (°/100ft) | Turn Rate (°/100ft) |
| 5,000.00 | 25.98 | 115.28 | 4,597.14 | -787.83 | 1,668.29 | 1,844.96 | 0.00 | 0.00 | 0.00 |
| 5,100.00 | 25.98 | 115.28 | 4,687.04 | -806.53 | 1,707.90 | 1,888.76 | 0.00 | 0.00 | 0.00 |
| 5,178.74 | 25.98 | 115.28 | 4,757.82 | -821.26 | 1,739.09 | 1,923.25 | 0.00 | 0.00 | 0.00 |
| Start Drop -2.00 | | | | | | | | | |
| 5,200.00 | 25.55 | 115.28 | 4,776.97 | -825.21 | 1,747.45 | 1,932.49 | 2.00 | -2.00 | 0.00 |
| 5,300.00 | 23.55 | 115.28 | 4,867.92 | -842.95 | 1,785.02 | 1,974.05 | 2.00 | -2.00 | 0.00 |
| 5,400.00 | 21.55 | 115.28 | 4,960.27 | -859.33 | 1,819.70 | 2,012.40 | 2.00 | -2.00 | 0.00 |
| 5,500.00 | 19.55 | 115.28 | 5,053.90 | -874.32 | 1,851.44 | 2,047.51 | 2.00 | -2.00 | 0.00 |
| 5,600.00 | 17.55 | 115.28 | 5,148.70 | -887.91 | 1,880.21 | 2,079.32 | 2.00 | -2.00 | 0.00 |
| 5,700.00 | 15.55 | 115.28 | 5,244.55 | -900.07 | 1,905.98 | 2,107.81 | 2.00 | -2.00 | 0.00 |
| 5,800.00 | 13.55 | 115.28 | 5,341.33 | -910.80 | 1,928.70 | 2,132.94 | 2.00 | -2.00 | 0.00 |
| 5,900.00 | 11.55 | 115.28 | 5,438.94 | -920.08 | 1,948.35 | 2,154.67 | 2.00 | -2.00 | 0.00 |
| 6,000.00 | 9.55 | 115.28 | 5,537.24 | -927.90 | 1,964.91 | 2,172.99 | 2.00 | -2.00 | 0.00 |
| 6,077.67 | 8.00 | 115.28 | 5,614.00 | -932.96 | 1,975.63 | 2,184.84 | 2.00 | -2.00 | 0.00 |
| Start 8.00° Hold At 6077.67' - Mesaverde | | | | | | | | | |
| 6,100.00 | 8.00 | 115.28 | 5,636.11 | -934.29 | 1,978.44 | 2,187.95 | 0.00 | 0.00 | 0.00 |
| 6,200.00 | 8.00 | 115.28 | 5,735.14 | -940.23 | 1,991.02 | 2,201.86 | 0.00 | 0.00 | 0.00 |
| 6,214.00 | 8.00 | 115.28 | 5,749.00 | -941.06 | 1,992.78 | 2,203.81 | 0.00 | 0.00 | 0.00 |
| Williams Fork | | | | | | | | | |
| 6,300.00 | 8.00 | 115.28 | 5,834.16 | -946.18 | 2,003.60 | 2,215.78 | 0.00 | 0.00 | 0.00 |
| 6,400.00 | 8.00 | 115.28 | 5,933.19 | -952.12 | 2,016.19 | 2,229.70 | 0.00 | 0.00 | 0.00 |
| 6,500.00 | 8.00 | 115.28 | 6,032.22 | -958.06 | 2,028.77 | 2,243.61 | 0.00 | 0.00 | 0.00 |
| 6,600.00 | 8.00 | 115.28 | 6,131.25 | -964.00 | 2,041.36 | 2,257.53 | 0.00 | 0.00 | 0.00 |
| 6,700.00 | 8.00 | 115.28 | 6,230.27 | -969.95 | 2,053.94 | 2,271.45 | 0.00 | 0.00 | 0.00 |
| 6,800.00 | 8.00 | 115.28 | 6,329.30 | -975.89 | 2,066.53 | 2,285.37 | 0.00 | 0.00 | 0.00 |
| 6,855.24 | 8.00 | 115.28 | 6,384.00 | -979.17 | 2,073.48 | 2,293.05 | 0.00 | 0.00 | 0.00 |
| TOG = 638400.40, 1225098.61 | | | | | | | | | |
| 6,900.00 | 8.00 | 115.28 | 6,428.33 | -981.83 | 2,079.11 | 2,299.28 | 0.00 | 0.00 | 0.00 |
| 7,000.00 | 8.00 | 115.28 | 6,527.35 | -987.78 | 2,091.70 | 2,313.20 | 0.00 | 0.00 | 0.00 |
| 7,100.00 | 8.00 | 115.28 | 6,626.38 | -993.72 | 2,104.28 | 2,327.12 | 0.00 | 0.00 | 0.00 |
| 7,200.00 | 8.00 | 115.28 | 6,725.41 | -999.66 | 2,116.87 | 2,341.04 | 0.00 | 0.00 | 0.00 |
| 7,300.00 | 8.00 | 115.28 | 6,824.43 | -1,005.60 | 2,129.45 | 2,354.95 | 0.00 | 0.00 | 0.00 |
| 7,400.00 | 8.00 | 115.28 | 6,923.46 | -1,011.55 | 2,142.04 | 2,368.87 | 0.00 | 0.00 | 0.00 |
| 7,500.00 | 8.00 | 115.28 | 7,022.49 | -1,017.49 | 2,154.62 | 2,382.79 | 0.00 | 0.00 | 0.00 |
| 7,600.00 | 8.00 | 115.28 | 7,121.51 | -1,023.43 | 2,167.21 | 2,396.70 | 0.00 | 0.00 | 0.00 |
| 7,700.00 | 8.00 | 115.28 | 7,220.54 | -1,029.38 | 2,179.79 | 2,410.62 | 0.00 | 0.00 | 0.00 |
| 7,800.00 | 8.00 | 115.28 | 7,319.57 | -1,035.32 | 2,192.37 | 2,424.54 | 0.00 | 0.00 | 0.00 |
| 7,900.00 | 8.00 | 115.28 | 7,418.59 | -1,041.26 | 2,204.96 | 2,438.46 | 0.00 | 0.00 | 0.00 |
| 8,000.00 | 8.00 | 115.28 | 7,517.62 | -1,047.21 | 2,217.54 | 2,452.37 | 0.00 | 0.00 | 0.00 |
| 8,100.00 | 8.00 | 115.28 | 7,616.65 | -1,053.15 | 2,230.13 | 2,466.29 | 0.00 | 0.00 | 0.00 |
| 8,200.00 | 8.00 | 115.28 | 7,715.67 | -1,059.09 | 2,242.71 | 2,480.21 | 0.00 | 0.00 | 0.00 |
| 8,213.46 | 8.00 | 115.28 | 7,729.00 | -1,059.89 | 2,244.41 | 2,482.08 | 0.00 | 0.00 | 0.00 |
| Target = 638314.53, 1225267.01 | | | | | | | | | |
| 8,300.00 | 8.00 | 115.28 | 7,814.70 | -1,065.03 | 2,255.30 | 2,494.13 | 0.00 | 0.00 | 0.00 |
| 8,400.00 | 8.00 | 115.28 | 7,913.73 | -1,070.98 | 2,267.88 | 2,508.04 | 0.00 | 0.00 | 0.00 |
| 8,500.00 | 8.00 | 115.28 | 8,012.75 | -1,076.92 | 2,280.47 | 2,521.96 | 0.00 | 0.00 | 0.00 |
| 8,600.00 | 8.00 | 115.28 | 8,111.78 | -1,082.86 | 2,293.05 | 2,535.88 | 0.00 | 0.00 | 0.00 |
| 8,700.00 | 8.00 | 115.28 | 8,210.81 | -1,088.81 | 2,305.64 | 2,549.80 | 0.00 | 0.00 | 0.00 |
| 8,800.00 | 8.00 | 115.28 | 8,309.84 | -1,094.75 | 2,318.22 | 2,563.71 | 0.00 | 0.00 | 0.00 |
| 8,879.94 | 8.00 | 115.28 | 8,389.00 | -1,099.50 | 2,328.28 | 2,574.84 | 0.00 | 0.00 | 0.00 |
| Rollins | | | | | | | | | |
| 8,900.00 | 8.00 | 115.28 | 8,408.86 | -1,100.69 | 2,330.81 | 2,577.63 | 0.00 | 0.00 | 0.00 |
| 9,000.00 | 8.00 | 115.28 | 8,507.89 | -1,106.63 | 2,343.39 | 2,591.55 | 0.00 | 0.00 | 0.00 |

Scientific Drilling International

Planning Report

| | | | |
|------------------|---------------------------|-------------------------------------|--------------------------------------|
| Database: | EDM-RexH-Local | Local Co-ordinate Reference: | Well CC 697-05-34B - Slot Q |
| Company: | OXY USA RMAT | TVD Reference: | GL 8184' & RKB 30' @ 8214.00ft (H&P) |
| Project: | Garfield County, CO NAD27 | MD Reference: | GL 8184' & RKB 30' @ 8214.00ft (H&P) |
| Site: | Cascade Creek 697-06A Pad | North Reference: | True |
| Well: | CC 697-05-34B | Survey Calculation Method: | Minimum Curvature |
| Wellbore: | OH | | |
| Design: | Plan #2 | | |

| Planned Survey | | | | | | | | | |
|------------------------------|-----------------|-------------|---------------------|------------|------------|-----------------------|-----------------------|----------------------|---------------------|
| Measured Depth (ft) | Inclination (°) | Azimuth (°) | Vertical Depth (ft) | +N/-S (ft) | +E/-W (ft) | Vertical Section (ft) | Dogleg Rate (°/100ft) | Build Rate (°/100ft) | Turn Rate (°/100ft) |
| 9,100.00 | 8.00 | 115.28 | 8,606.92 | -1,112.58 | 2,355.97 | 2,605.46 | 0.00 | 0.00 | 0.00 |
| 9,200.00 | 8.00 | 115.28 | 8,705.94 | -1,118.52 | 2,368.56 | 2,619.38 | 0.00 | 0.00 | 0.00 |
| 9,283.87 | 8.00 | 115.28 | 8,789.00 | -1,123.50 | 2,379.11 | 2,631.05 | 0.00 | 0.00 | 0.00 |
| PBHL = 638246.86, 1225399.73 | | | | | | | | | |

| Design Targets | | | | | | | | | |
|---------------------------|---------------|--------------|----------|------------|------------|-----------------|----------------|------------------|-------------------|
| Target Name | Dip Angle (°) | Dip Dir. (°) | TVD (ft) | +N/-S (ft) | +E/-W (ft) | Northing (usft) | Easting (usft) | Latitude | Longitude |
| - hit/miss target | | | | | | | | | |
| - Shape | | | | | | | | | |
| CC 697-05-34B Target | -8.00 | 113.43 | 7,729.00 | -1,059.89 | 2,244.41 | 638,314.54 | 1,225,267.01 | 39° 33' 13.770 N | 108° 14' 52.560 W |
| - plan hits target center | | | | | | | | | |
| - Circle (radius 50.00) | | | | | | | | | |

| Formations | | | | | |
|---------------------|---------------------|---------------|-----------|---------|-------------------|
| Measured Depth (ft) | Vertical Depth (ft) | Name | Lithology | Dip (°) | Dip Direction (°) |
| 6,077.67 | 5,614.00 | Mesaverde | | 0.00 | |
| 6,214.00 | 5,749.00 | Williams Fork | | 0.00 | |
| 8,879.94 | 8,389.00 | Rollins | | 0.00 | |

| Plan Annotations | | | | |
|---------------------|---------------------|-------------------|------------|--------------------------------|
| Measured Depth (ft) | Vertical Depth (ft) | Local Coordinates | | Comment |
| | | +N/-S (ft) | +E/-W (ft) | |
| 150.00 | 150.00 | 0.00 | 0.00 | Start Build 2.00 |
| 1,448.93 | 1,404.88 | -123.61 | 261.75 | Start 25.98° Hold At 1448.93' |
| 5,178.74 | 4,757.82 | -821.26 | 1,739.09 | Start Drop -2.00 |
| 6,077.67 | 5,614.00 | -932.96 | 1,975.62 | Start 8.00° Hold At 6077.67' |
| 6,855.24 | 6,384.00 | -979.17 | 2,073.48 | TOG = 638400.40, 1225098.61 |
| 8,213.46 | 7,729.00 | -1,059.89 | 2,244.41 | Target = 638314.53, 1225267.01 |
| 9,283.87 | 8,789.00 | -1,123.50 | 2,379.11 | PBHL = 638246.86, 1225399.73 |