

PIONEER NATURAL RESOURCES USA, INC.

PROPOSED PITS EXISTING GROUND WITH PLAN

LOCATED IN
SECTION 12, T7N, R93W, 6th P.M.
MOFFAT COUNTY, COLORADO

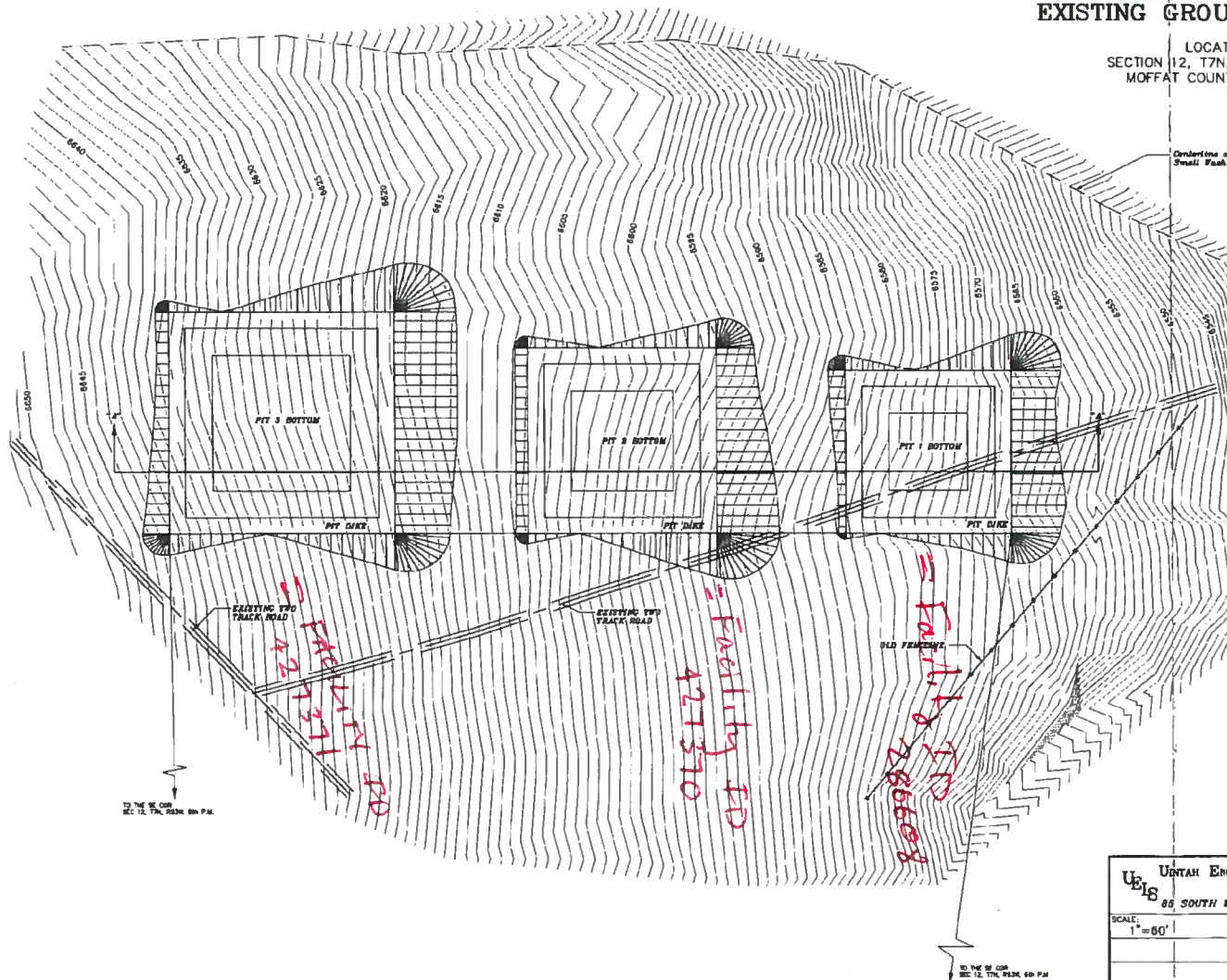

SHEET 2 of 5

U&S UTAH ENGINEERING & LAND SURVEYING PHONE: (435) 788-1017 85 SOUTH 200 EAST - VERNAL, UTAH 84078	
SCALE: 1"=80'	DATE: 6-6-06
	REV:
	DRAWN BY: HNM
	FILE: 3 2 1 8 6

FIT HISTORY 3 CAPACITY	
Requested Storage Capacity	37,540 MB
Storage Capacity Last Freshstart	36,078 MB
Storage Capacity Plus Freshstart	46,347 MB

FIT HISTORY 3 SATURATIONS	
Low Sat (0" Depth) Remnant	1,724 MB
Low Sat Volume	8,511.20 MB
Low Sat Volume	8,511.20 MB
Total Low Sat Volume	17,022.40 MB
Low Fit Volume	7,923.65 MB
Low Fit Volume	7,923.65 MB
Total Low Fit Volume	15,847.30 MB
Depth Point Footprint:	1,000 Acres

PT HAMER 3 04/07/2013

Top (Outside):	705"x305"
Top (Inside):	170"x170"
Bottom:	136"x126"
Top Elevations:	64.82.0'
Bottom Elevations:	64.19.5'

PTI NUMBER 2 CAPACITY	
Requested Storage Capacity	12,308 MB.
Storage Capacity Leds Feedback	12,863 MB.
Storage Capacity Plus Feedback	79,548 MB.

File number: 007210075
 Date (October): 1984

FIT HUBBER : CAPACITY	
Required Storage Capacity	15,000 MB
Storage Capacity Loss Threshold	15,234 MB
Storage Capacity Plus Threshold	20,010 MB

PRT 10-000079 1 Page 10 of 28	
Top {Outgoing}:	1327+1327
Top {vmlbo}:	129+1327
Bottom:	72+72
Top {Dovetile}:	6377+1327
Bottom {Dovetile}:	6004+6377



Trade ID	Acquiring	Issuing	Conversion	Description
10	76-676-30	6861-33	684-76	Net 1)
21	86-626-06	86671-81	8634-06	Net 1-7-83 300

[illegible]

ELEVATIONS SHOWN ON PIT CORNERS ARE DESIGN GRADE
NOT / ALL DISTANCES ARE FROM DESIGN GRADING

KEY-WAY CONSTRUCTION IS
FOR BIKE STABILITY AND UTILITY.

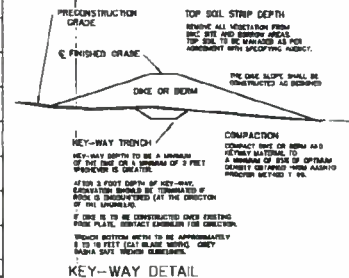

KEY-WAY DETAIL

SHEET 3 of 5

UTAH ENGINEERING & LAND SURVEYING PHONE (435) 788-1017 85 SOUTH 200 EAST - VERNAL, UTAH 84078		
SCALE.	DATE.	REV.
1"=60'	6-5-06	
	DRAWN BY:	
	HNM	
	CHECKED:	
	3 2 1 8 6	