



Company: Carrizo Oil & Gas  
 Site: Nelson Ranches  
 Well: 27-11-10-59  
 Project: Weld County, Colorado (NAD83)  
 Rig Name: Xtreme 19



Planning: 936.442.2510 Fax: 936.442.2515  
 Operations: 936.442.2500 Fax: 936.442.2599

#### PILOT ANNOTATIONS

MD	Inc	Azi	TVD	+N/-S	+E/-W	VSec	Departure	Annotation
7430.00	0.00	0.00	7430.00	0.00	0.00	0.00	0.00	Pilot PBHL - 7430.00' MD

#### ANNOTATIONS

MD	Inc	Azi	TVD	+N/-S	+E/-W	VSec	Departure	Annotation
200.00	0.00	0.00	200.00	0.00	0.00	0.00	0.00	KOP, 2.50°/100' Build
480.29	7.01	245.83	479.59	-7.01	-15.62	8.88	17.12	Begin 7.01° Tangent
5913.33	7.01	245.83	5872.05	-278.37	-620.33	352.65	679.93	Begin 12.00°/100' Build & Turn
6640.70	90.00	178.69	6324.00	-756.35	-660.59	831.95	1178.33	Begin 90.00° Lateral
10497.13	90.00	178.69	6324.00	-4611.77	-572.32	4647.15	5034.76	PBHL



Azimuths to Grid North  
 True North: -0.99°  
 Magnetic North: 7.39°  
 Magnetic Field  
 Strength: 53378.3snT  
 Dip Angle: 67.49°  
 Date: 1/4/2012  
 Model: WMM\_2010

Created By: Marcus Mitcham  
 Date: 15:21, January 05 2012  
 Plan: Design #1

US State Plane 1983  
 Colorado Northern Zone

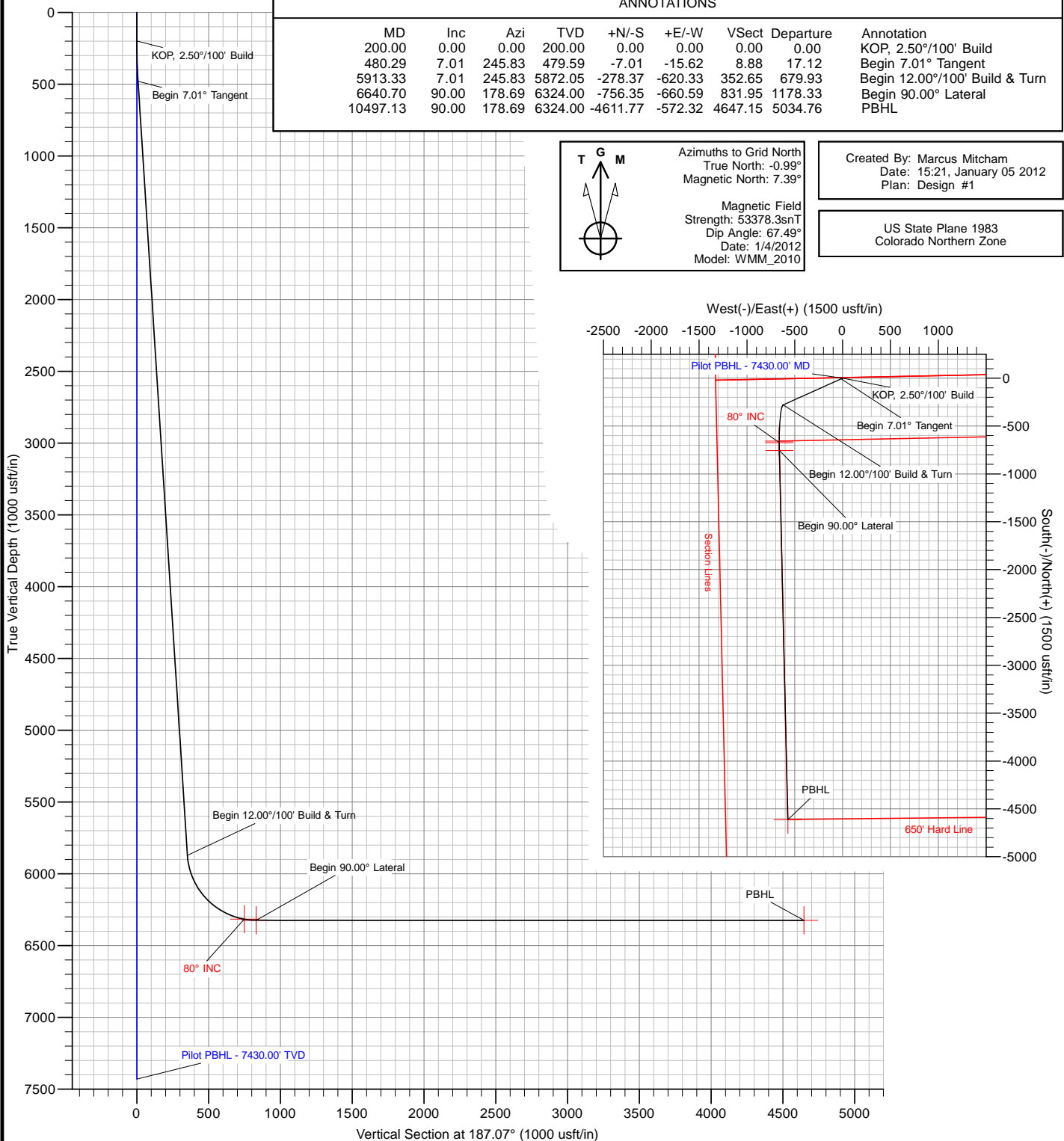

The customer should only rely on this document after independently verifying all paths, targets, coordinates, lease and hard lines represented. Any decisions made or wells drilled utilizing this or any other information supplied by MS Energy are at the sole risk and responsibility of the customer. MS Energy is not responsible for the accuracy of this schematic or the information contained herein.



## **Carrizo Oil & Gas**

**Weld County, Colorado (NAD83)**

**Nelson Ranches**

**27-11-10-59**

**Wellbore #1**

**Plan: Design #1**

## **Standard Planning Report**

**05 January, 2012**

<b>Database:</b>	Southern Region	<b>Local Co-ordinate Reference:</b>	Well 27-11-10-59
<b>Company:</b>	Carrizo Oil & Gas	<b>TVD Reference:</b>	WELL @ 5120.90usft (Xtreme 19)
<b>Project:</b>	Weld County, Colorado (NAD83)	<b>MD Reference:</b>	WELL @ 5120.90usft (Xtreme 19)
<b>Site:</b>	Nelson Ranches	<b>North Reference:</b>	Grid
<b>Well:</b>	27-11-10-59	<b>Survey Calculation Method:</b>	Minimum Curvature
<b>Wellbore:</b>	Wellbore #1		
<b>Design:</b>	Design #1		

<b>Project</b>	Weld County, Colorado (NAD83)		
<b>Map System:</b>	US State Plane 1983	<b>System Datum:</b>	Mean Sea Level
<b>Geo Datum:</b>	North American Datum 1983		
<b>Map Zone:</b>	Colorado Northern Zone		

<b>Well</b>	27-11-10-59			
<b>Well Position</b>	<b>+N/-S</b>	1,543,823.69 usft	<b>Northing:</b>	1,543,823.69 usft
	<b>+E/-W</b>	3,423,426.85 usft	<b>Easting:</b>	3,423,426.85 usft
<b>Position Uncertainty</b>		0.00 usft	<b>Wellhead Elevation:</b>	<b>Latitude:</b> 40° 48' 58.1438 N
				<b>Longitude:</b> 103° 58' 12.742 W
				<b>Ground Level:</b> 5,103.90 usft

<b>Wellbore</b>	Wellbore #1				
<b>Magnetics</b>	<b>Model Name</b>	<b>Sample Date</b>	<b>Declination (°)</b>	<b>Dip Angle (°)</b>	<b>Field Strength (nT)</b>
	WMM_2010	1/4/2012	8.38	67.49	53,378

<b>Design</b>	Design #1			
<b>Audit Notes:</b>				
<b>Version:</b>	<b>Phase:</b>	PROTOTYPE	<b>Tie On Depth:</b>	200.00
<b>Vertical Section:</b>	<b>Depth From (TVD) (usft)</b>	<b>+N/-S (usft)</b>	<b>+E/-W (usft)</b>	<b>Direction (°)</b>
	0.00	0.00	0.00	187.07

<b>Plan Sections</b>										
Measured Depth (usft)	Inclination (°)	Azimuth (°)	Vertical Depth (usft)	+N/-S (usft)	+E/-W (usft)	Dogleg Rate (°/100usft)	Build Rate (°/100usft)	Turn Rate (°/100usft)	TFO (°)	Target
200.00	0.00	0.00	200.00	0.00	0.00	0.00	0.00	0.00	0.00	
480.29	7.01	245.83	479.59	-7.01	-15.62	2.50	2.50	0.00	245.83	
5,913.33	7.01	245.83	5,872.05	-278.37	-620.33	0.00	0.00	0.00	0.00	
6,640.70	90.00	178.69	6,324.00	-756.35	-660.59	12.00	11.41	-9.23	-67.30	90° v1 - Nelson Ranch
10,497.13	90.00	178.69	6,324.00	-4,611.78	-572.32	0.00	0.00	0.00	0.00	PBHL v1 - Nelson Ranch



Database:	Southern Region	Local Co-ordinate Reference:	Well 27-11-10-59
Company:	Carrizo Oil & Gas	TVD Reference:	WELL @ 5120.90usft (Xtreme 19)
Project:	Weld County, Colorado (NAD83)	MD Reference:	WELL @ 5120.90usft (Xtreme 19)
Site:	Nelson Ranches	North Reference:	Grid
Well:	27-11-10-59	Survey Calculation Method:	Minimum Curvature
Wellbore:	Wellbore #1		
Design:	Design #1		

Planned Survey									
Measured Depth (usft)	Inclination (°)	Azimuth (°)	Vertical Depth (usft)	+N/-S (usft)	+E/-W (usft)	Vertical Section (usft)	Dogleg Rate (°/100usft)	Build Rate (°/100usft)	Turn Rate (°/100usft)
0.00	0.00	0.00	0.00	0.00	0.00	0.00	0.00	0.00	0.00
100.00	0.00	0.00	100.00	0.00	0.00	0.00	0.00	0.00	0.00
200.00	0.00	0.00	200.00	0.00	0.00	0.00	0.00	0.00	0.00
KOP, 2.50°/100' Build									
300.00	2.50	245.83	299.97	-0.89	-1.99	1.13	2.50	2.50	0.00
400.00	5.00	245.83	399.75	-3.57	-7.96	4.52	2.50	2.50	0.00
480.29	7.01	245.83	479.59	-7.01	-15.62	8.88	2.50	2.50	0.00
Begin 7.01° Tangent									
500.00	7.01	245.83	499.15	-7.99	-17.81	10.13	0.00	0.00	0.00
600.00	7.01	245.83	598.41	-12.99	-28.94	16.45	0.00	0.00	0.00
700.00	7.01	245.83	697.66	-17.98	-40.07	22.78	0.00	0.00	0.00
800.00	7.01	245.83	796.91	-22.98	-51.20	29.11	0.00	0.00	0.00
900.00	7.01	245.83	896.17	-27.97	-62.33	35.44	0.00	0.00	0.00
1,000.00	7.01	245.83	995.42	-32.97	-73.46	41.76	0.00	0.00	0.00
1,100.00	7.01	245.83	1,094.67	-37.96	-84.59	48.09	0.00	0.00	0.00
1,200.00	7.01	245.83	1,193.93	-42.96	-95.72	54.42	0.00	0.00	0.00
1,300.00	7.01	245.83	1,293.18	-47.95	-106.85	60.75	0.00	0.00	0.00
1,400.00	7.01	245.83	1,392.43	-52.95	-117.98	67.07	0.00	0.00	0.00
1,500.00	7.01	245.83	1,491.69	-57.94	-129.11	73.40	0.00	0.00	0.00
1,600.00	7.01	245.83	1,590.94	-62.93	-140.24	79.73	0.00	0.00	0.00
1,700.00	7.01	245.83	1,690.19	-67.93	-151.37	86.05	0.00	0.00	0.00
1,800.00	7.01	245.83	1,789.44	-72.92	-162.50	92.38	0.00	0.00	0.00
1,900.00	7.01	245.83	1,888.70	-77.92	-173.64	98.71	0.00	0.00	0.00
2,000.00	7.01	245.83	1,987.95	-82.91	-184.77	105.04	0.00	0.00	0.00
2,100.00	7.01	245.83	2,087.20	-87.91	-195.90	111.36	0.00	0.00	0.00
2,200.00	7.01	245.83	2,186.46	-92.90	-207.03	117.69	0.00	0.00	0.00
2,300.00	7.01	245.83	2,285.71	-97.90	-218.16	124.02	0.00	0.00	0.00
2,400.00	7.01	245.83	2,384.96	-102.89	-229.29	130.35	0.00	0.00	0.00
2,500.00	7.01	245.83	2,484.22	-107.89	-240.42	136.67	0.00	0.00	0.00
2,600.00	7.01	245.83	2,583.47	-112.88	-251.55	143.00	0.00	0.00	0.00
2,700.00	7.01	245.83	2,682.72	-117.88	-262.68	149.33	0.00	0.00	0.00
2,800.00	7.01	245.83	2,781.98	-122.87	-273.81	155.66	0.00	0.00	0.00
2,900.00	7.01	245.83	2,881.23	-127.87	-284.94	161.98	0.00	0.00	0.00
3,000.00	7.01	245.83	2,980.48	-132.86	-296.07	168.31	0.00	0.00	0.00
3,100.00	7.01	245.83	3,079.73	-137.86	-307.20	174.64	0.00	0.00	0.00
3,200.00	7.01	245.83	3,178.99	-142.85	-318.33	180.97	0.00	0.00	0.00
3,300.00	7.01	245.83	3,278.24	-147.84	-329.46	187.29	0.00	0.00	0.00
3,400.00	7.01	245.83	3,377.49	-152.84	-340.59	193.62	0.00	0.00	0.00
3,500.00	7.01	245.83	3,476.75	-157.83	-351.72	199.95	0.00	0.00	0.00
3,600.00	7.01	245.83	3,576.00	-162.83	-362.85	206.28	0.00	0.00	0.00
3,700.00	7.01	245.83	3,675.25	-167.82	-373.98	212.60	0.00	0.00	0.00
3,800.00	7.01	245.83	3,774.51	-172.82	-385.11	218.93	0.00	0.00	0.00
3,900.00	7.01	245.83	3,873.76	-177.81	-396.24	225.26	0.00	0.00	0.00
4,000.00	7.01	245.83	3,973.01	-182.81	-407.37	231.59	0.00	0.00	0.00
4,100.00	7.01	245.83	4,072.26	-187.80	-418.50	237.91	0.00	0.00	0.00
4,200.00	7.01	245.83	4,171.52	-192.80	-429.63	244.24	0.00	0.00	0.00
4,300.00	7.01	245.83	4,270.77	-197.79	-440.76	250.57	0.00	0.00	0.00
4,400.00	7.01	245.83	4,370.02	-202.79	-451.89	256.90	0.00	0.00	0.00
4,500.00	7.01	245.83	4,469.28	-207.78	-463.02	263.22	0.00	0.00	0.00
4,600.00	7.01	245.83	4,568.53	-212.78	-474.15	269.55	0.00	0.00	0.00
4,700.00	7.01	245.83	4,667.78	-217.77	-485.28	275.88	0.00	0.00	0.00
4,800.00	7.01	245.83	4,767.04	-222.77	-496.41	282.21	0.00	0.00	0.00
4,900.00	7.01	245.83	4,866.29	-227.76	-507.54	288.53	0.00	0.00	0.00
5,000.00	7.01	245.83	4,965.54	-232.75	-518.67	294.86	0.00	0.00	0.00



Database:	Southern Region	Local Co-ordinate Reference:	Well 27-11-10-59
Company:	Carrizo Oil & Gas	TVD Reference:	WELL @ 5120.90usft (Xtreme 19)
Project:	Weld County, Colorado (NAD83)	MD Reference:	WELL @ 5120.90usft (Xtreme 19)
Site:	Nelson Ranches	North Reference:	Grid
Well:	27-11-10-59	Survey Calculation Method:	Minimum Curvature
Wellbore:	Wellbore #1		
Design:	Design #1		

Planned Survey									
Measured Depth (usft)	Inclination (°)	Azimuth (°)	Vertical Depth (usft)	+N/-S (usft)	+E/-W (usft)	Vertical Section (usft)	Dogleg Rate (°/100usft)	Build Rate (°/100usft)	Turn Rate (°/100usft)
5,100.00	7.01	245.83	5,064.80	-237.75	-529.80	301.19	0.00	0.00	0.00
5,200.00	7.01	245.83	5,164.05	-242.74	-540.93	307.51	0.00	0.00	0.00
5,300.00	7.01	245.83	5,263.30	-247.74	-552.06	313.84	0.00	0.00	0.00
5,400.00	7.01	245.83	5,362.55	-252.73	-563.19	320.17	0.00	0.00	0.00
5,500.00	7.01	245.83	5,461.81	-257.73	-574.32	326.50	0.00	0.00	0.00
5,600.00	7.01	245.83	5,561.06	-262.72	-585.45	332.82	0.00	0.00	0.00
5,700.00	7.01	245.83	5,660.31	-267.72	-596.58	339.15	0.00	0.00	0.00
5,800.00	7.01	245.83	5,759.57	-272.71	-607.71	345.48	0.00	0.00	0.00
5,900.00	7.01	245.83	5,858.82	-277.71	-618.84	351.81	0.00	0.00	0.00
5,913.33	7.01	245.83	5,872.05	-278.37	-620.33	352.65	0.00	0.00	0.00
Begin 12.00°/100' Build & Turn									
5,925.00	7.66	236.09	5,883.63	-279.10	-621.62	353.53	12.00	5.57	-83.48
5,950.00	9.60	220.72	5,908.34	-281.61	-624.37	356.36	12.00	7.78	-61.48
5,975.00	11.99	210.93	5,932.90	-285.42	-627.06	360.47	12.00	9.54	-39.16
6,000.00	14.60	204.47	5,957.23	-290.51	-629.70	365.85	12.00	10.44	-25.85
6,025.00	17.33	199.97	5,981.27	-296.88	-632.28	372.49	12.00	10.94	-18.00
6,050.00	20.14	196.68	6,004.94	-304.50	-634.79	380.36	12.00	11.23	-13.17
6,075.00	23.00	194.17	6,028.19	-313.36	-637.22	389.45	12.00	11.42	-10.04
6,100.00	25.88	192.19	6,050.95	-323.43	-639.56	399.74	12.00	11.55	-7.92
6,125.00	28.79	190.58	6,073.15	-334.69	-641.82	411.18	12.00	11.63	-6.42
6,150.00	31.71	189.25	6,094.75	-347.09	-643.98	423.76	12.00	11.70	-5.33
6,175.00	34.65	188.12	6,115.67	-360.62	-646.05	437.44	12.00	11.74	-4.52
6,200.00	37.59	187.15	6,135.86	-375.22	-648.00	452.17	12.00	11.78	-3.89
6,225.00	40.55	186.30	6,155.27	-390.87	-649.84	467.93	12.00	11.81	-3.40
6,250.00	43.50	185.54	6,173.83	-407.52	-651.56	484.66	12.00	11.83	-3.02
6,275.00	46.47	184.87	6,191.52	-425.12	-653.16	502.32	12.00	11.85	-2.70
6,300.00	49.43	184.25	6,208.26	-443.62	-654.64	520.86	12.00	11.86	-2.45
6,325.00	52.40	183.69	6,224.02	-462.97	-655.98	540.24	12.00	11.87	-2.24
6,350.00	55.37	183.17	6,238.75	-483.13	-657.19	560.39	12.00	11.88	-2.07
6,375.00	58.34	182.69	6,252.42	-504.03	-658.26	581.27	12.00	11.89	-1.93
6,400.00	61.32	182.24	6,264.98	-525.63	-659.18	602.81	12.00	11.90	-1.81
6,425.00	64.29	181.81	6,276.41	-547.85	-659.97	624.95	12.00	11.90	-1.71
6,450.00	67.27	181.41	6,286.66	-570.63	-660.61	647.65	12.00	11.91	-1.62
6,475.00	70.25	181.02	6,295.72	-593.93	-661.10	670.82	12.00	11.91	-1.56
6,500.00	73.23	180.64	6,303.55	-617.66	-661.45	694.42	12.00	11.92	-1.50
6,525.00	76.21	180.28	6,310.14	-641.78	-661.64	718.37	12.00	11.92	-1.45
6,550.00	79.19	179.93	6,315.47	-666.20	-661.69	742.62	12.00	11.92	-1.42
6,575.00	82.17	179.58	6,319.52	-690.86	-661.58	767.08	12.00	11.92	-1.39
6,600.00	85.15	179.24	6,322.28	-715.71	-661.32	791.70	12.00	11.92	-1.37
6,625.00	88.13	178.90	6,323.74	-740.66	-660.92	816.42	12.00	11.92	-1.36
6,640.70	90.00	178.69	6,324.00	-756.35	-660.59	831.95	12.00	11.92	-1.35
Begin 90.00° Lateral									
6,700.00	90.00	178.69	6,324.00	-815.64	-659.23	890.62	0.00	0.00	0.00
6,800.00	90.00	178.69	6,324.00	-915.61	-656.94	989.55	0.00	0.00	0.00
6,900.00	90.00	178.69	6,324.00	-1,015.58	-654.65	1,088.48	0.00	0.00	0.00
7,000.00	90.00	178.69	6,324.00	-1,115.56	-652.36	1,187.41	0.00	0.00	0.00
7,100.00	90.00	178.69	6,324.00	-1,215.53	-650.08	1,286.34	0.00	0.00	0.00
7,200.00	90.00	178.69	6,324.00	-1,315.51	-647.79	1,385.27	0.00	0.00	0.00
7,300.00	90.00	178.69	6,324.00	-1,415.48	-645.50	1,484.20	0.00	0.00	0.00
7,400.00	90.00	178.69	6,324.00	-1,515.45	-643.21	1,583.13	0.00	0.00	0.00
7,500.00	90.00	178.69	6,324.00	-1,615.43	-640.92	1,682.06	0.00	0.00	0.00
7,600.00	90.00	178.69	6,324.00	-1,715.40	-638.63	1,780.99	0.00	0.00	0.00
7,700.00	90.00	178.69	6,324.00	-1,815.37	-636.34	1,879.92	0.00	0.00	0.00
7,800.00	90.00	178.69	6,324.00	-1,915.35	-634.05	1,978.85	0.00	0.00	0.00



<b>Database:</b>	Southern Region	<b>Local Co-ordinate Reference:</b>	Well 27-11-10-59
<b>Company:</b>	Carrizo Oil & Gas	<b>TVD Reference:</b>	WELL @ 5120.90usft (Xtreme 19)
<b>Project:</b>	Weld County, Colorado (NAD83)	<b>MD Reference:</b>	WELL @ 5120.90usft (Xtreme 19)
<b>Site:</b>	Nelson Ranches	<b>North Reference:</b>	Grid
<b>Well:</b>	27-11-10-59	<b>Survey Calculation Method:</b>	Minimum Curvature
<b>Wellbore:</b>	Wellbore #1		
<b>Design:</b>	Design #1		

Planned Survey									
Measured Depth (usft)	Inclination (°)	Azimuth (°)	Vertical Depth (usft)	+N/-S (usft)	+E/-W (usft)	Vertical Section (usft)	Dogleg Rate (°/100usft)	Build Rate (°/100usft)	Turn Rate (°/100usft)
7,900.00	90.00	178.69	6,324.00	-2,015.32	-631.76	2,077.79	0.00	0.00	0.00
8,000.00	90.00	178.69	6,324.00	-2,115.30	-629.48	2,176.72	0.00	0.00	0.00
8,100.00	90.00	178.69	6,324.00	-2,215.27	-627.19	2,275.65	0.00	0.00	0.00
8,200.00	90.00	178.69	6,324.00	-2,315.24	-624.90	2,374.58	0.00	0.00	0.00
8,300.00	90.00	178.69	6,324.00	-2,415.22	-622.61	2,473.51	0.00	0.00	0.00
8,400.00	90.00	178.69	6,324.00	-2,515.19	-620.32	2,572.44	0.00	0.00	0.00
8,500.00	90.00	178.69	6,324.00	-2,615.17	-618.03	2,671.37	0.00	0.00	0.00
8,600.00	90.00	178.69	6,324.00	-2,715.14	-615.74	2,770.30	0.00	0.00	0.00
8,700.00	90.00	178.69	6,324.00	-2,815.11	-613.45	2,869.23	0.00	0.00	0.00
8,800.00	90.00	178.69	6,324.00	-2,915.09	-611.17	2,968.16	0.00	0.00	0.00
8,900.00	90.00	178.69	6,324.00	-3,015.06	-608.88	3,067.09	0.00	0.00	0.00
9,000.00	90.00	178.69	6,324.00	-3,115.03	-606.59	3,166.03	0.00	0.00	0.00
9,100.00	90.00	178.69	6,324.00	-3,215.01	-604.30	3,264.96	0.00	0.00	0.00
9,200.00	90.00	178.69	6,324.00	-3,314.98	-602.01	3,363.89	0.00	0.00	0.00
9,300.00	90.00	178.69	6,324.00	-3,414.96	-599.72	3,462.82	0.00	0.00	0.00
9,400.00	90.00	178.69	6,324.00	-3,514.93	-597.43	3,561.75	0.00	0.00	0.00
9,500.00	90.00	178.69	6,324.00	-3,614.90	-595.14	3,660.68	0.00	0.00	0.00
9,600.00	90.00	178.69	6,324.00	-3,714.88	-592.85	3,759.61	0.00	0.00	0.00
9,700.00	90.00	178.69	6,324.00	-3,814.85	-590.57	3,858.54	0.00	0.00	0.00
9,800.00	90.00	178.69	6,324.00	-3,914.82	-588.28	3,957.47	0.00	0.00	0.00
9,900.00	90.00	178.69	6,324.00	-4,014.80	-585.99	4,056.40	0.00	0.00	0.00
10,000.00	90.00	178.69	6,324.00	-4,114.77	-583.70	4,155.33	0.00	0.00	0.00
10,100.00	90.00	178.69	6,324.00	-4,214.75	-581.41	4,254.26	0.00	0.00	0.00
10,200.00	90.00	178.69	6,324.00	-4,314.72	-579.12	4,353.20	0.00	0.00	0.00
10,300.00	90.00	178.69	6,324.00	-4,414.69	-576.83	4,452.13	0.00	0.00	0.00
10,400.00	90.00	178.69	6,324.00	-4,514.67	-574.54	4,551.06	0.00	0.00	0.00
10,497.13	90.00	178.69	6,324.00	-4,611.78	-572.32	4,647.15	0.00	0.00	0.00
PBHL									

Design Targets										
Target Name	Dip Angle (°)	Dip Dir. (°)	TVD (usft)	+N/-S (usft)	+E/-W (usft)	Northing (usft)	Easting (usft)	Latitude		Longitude
80° INC v1 - Nelson Rar - plan hits target center - Point	0.00	0.00	6,316.70	-672.91	-661.67	1,543,150.78	3,422,765.18	40° 48' 51.6086 N		103° 58' 21.497 W
PBHL v1 - Nelson Ranc - plan hits target center - Point	0.00	0.00	6,324.00	-4,611.78	-572.32	1,539,211.92	3,422,854.53	40° 48' 12.6796 N		103° 58' 21.218 W
90° v1 - Nelson Rancher - plan hits target center - Point	0.00	0.00	6,324.00	-756.35	-660.59	1,543,067.34	3,422,766.26	40° 48' 50.7841 N		103° 58' 21.502 W



Database:	Southern Region	Local Co-ordinate Reference:	Well 27-11-10-59
Company:	Carrizo Oil & Gas	TVD Reference:	WELL @ 5120.90usft (Xtreme 19)
Project:	Weld County, Colorado (NAD83)	MD Reference:	WELL @ 5120.90usft (Xtreme 19)
Site:	Nelson Ranches	North Reference:	Grid
Well:	27-11-10-59	Survey Calculation Method:	Minimum Curvature
Wellbore:	Wellbore #1		
Design:	Design #1		

Plan Annotations				
Measured Depth (usft)	Vertical Depth (usft)	Local Coordinates		Comment
		+N/-S (usft)	+E/-W (usft)	
200.00	200.00	0.00	0.00	KOP, 2.50°/100' Build
480.29	479.59	-7.01	-15.62	Begin 7.01° Tangent
5,913.33	5,872.05	-278.37	-620.33	Begin 12.00°/100' Build & Turn
6,640.70	6,324.00	-756.35	-660.59	Begin 90.00° Lateral
10,497.13	6,324.00	-4,611.78	-572.32	PBHL