



Company: Carrizo Oil & Gas  
 Site: Jones  
 Well: 18-24-10-59  
 Project: Weld County, Colorado (NAD83)  
 Rig Name: Xtreme 19



Planning: 936.442.2510 Fax: 936.442.2515  
 Operations: 936.442.2500 Fax: 936.442.2599

#### PILOT ANNOTATIONS

MD	Inc	Azi	TVD	+N/-S	+E/-W	Vsect	Departure	Annotation
7430.00	0.00	0.00	7430.00	0.00	0.00	0.00	0.00	Pilot PBHL - 7430.00' MD

#### ANNOTATIONS

MD	Inc	Azi	TVD	+N/-S	+E/-W	Vsect	Departure	Annotation
1400.00	0.00	0.00	1400.00	0.00	0.00	0.00	0.00	KOP, 2.00°/100' Build
1734.78	6.70	52.99	1734.02	11.76	15.60	13.81	19.54	Begin 6.70° Tangent
6274.28	6.70	52.99	6242.55	330.37	438.24	387.98	548.82	Begin 12.00°/100' Build & Turn
6989.04	90.00	2.21	6683.00	804.64	496.64	865.75	1029.27	Begin 90.00° Lateral
10775.54	90.00	2.21	6683.00	4588.32	642.73	4633.11	4815.77	PBHL

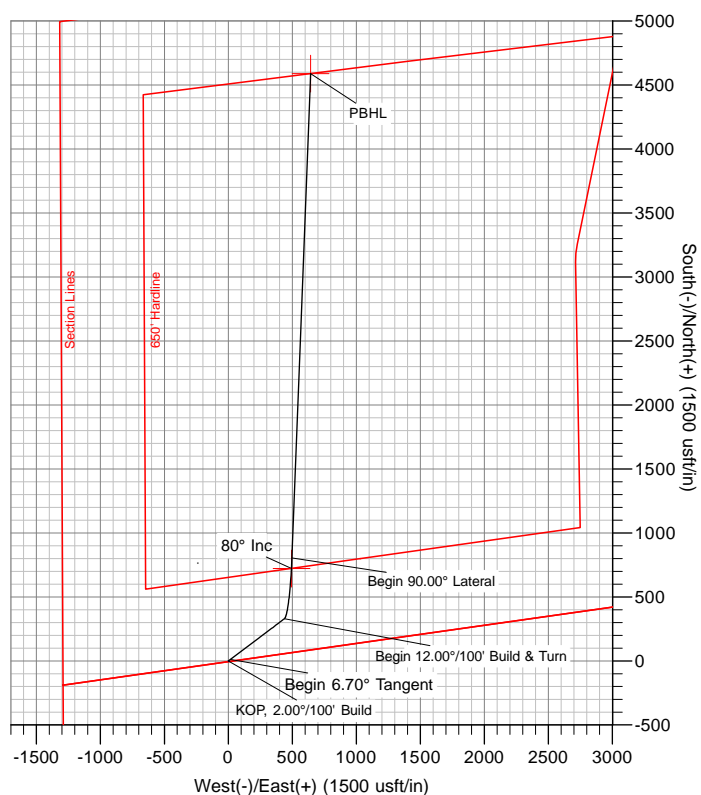
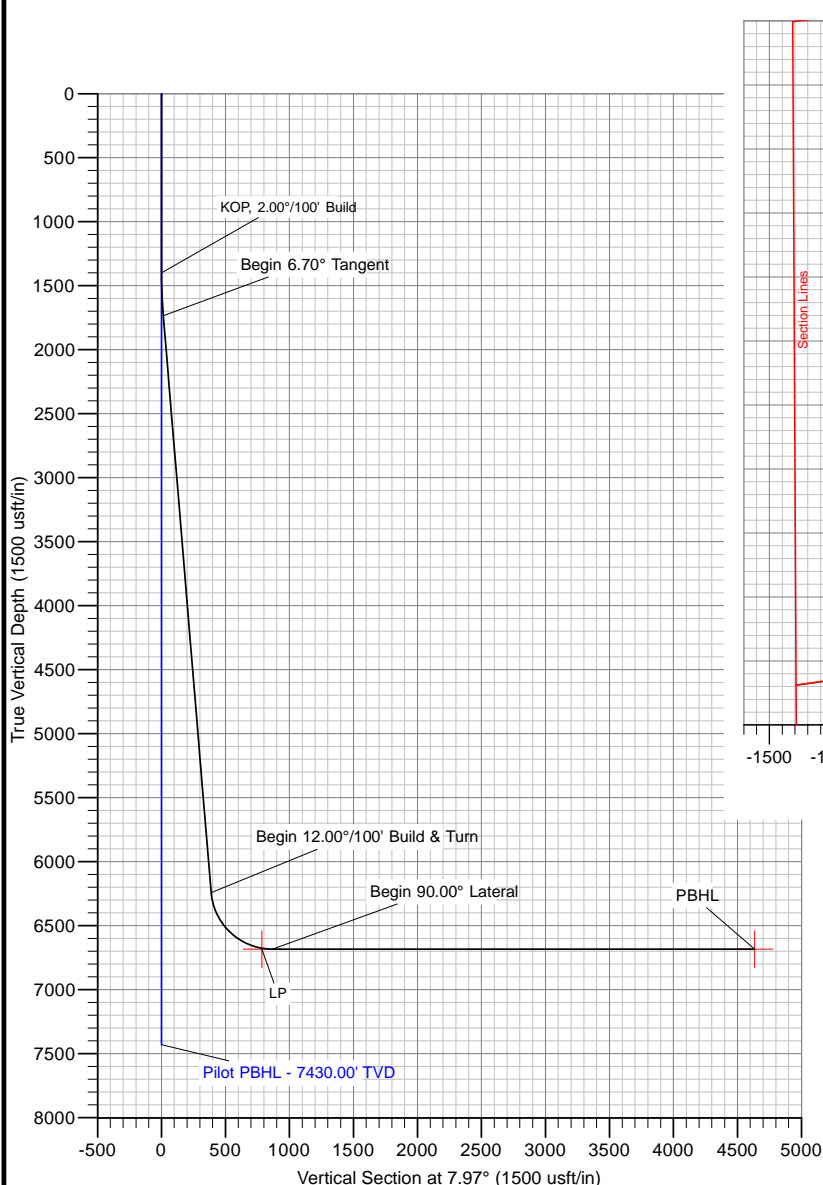

US State Plane 1983  
 Colorado Northern Zone

Created By: Vanessa Scott  
 Date: 9:27, January 05 2012  
 Plan: Design #1



Azimuths to Grid North  
 True North: -0.95°  
 Magnetic North: 7.46°

Magnetic Field  
 Strength: 53377.3snT  
 Dip Angle: 67.50°  
 Date: 1/4/2012  
 Model: WMM\_2010

The customer should only rely on this document after independently verifying all paths, targets, coordinates, lease and hard lines represented. Any decisions made or wells drilled utilizing this or any other information supplied by MS Energy are at the sole risk and responsibility of the customer. MS Energy is not responsible for the accuracy of this schematic or the information contained herein.



## **Carrizo Oil & Gas**

**Weld County, Colorado (NAD83)**

**Jones**

**18-24-10-59**

**Wellbore #1**

**Plan: Design #1**

## **Standard Planning Report**

**05 January, 2012**

<b>Database:</b>	Southern Region	<b>Local Co-ordinate Reference:</b>	Well 18-24-10-59
<b>Company:</b>	Carrizo Oil & Gas	<b>TVD Reference:</b>	WELL @ 5405.00usft (Xtreme 19)
<b>Project:</b>	Weld County, Colorado (NAD83)	<b>MD Reference:</b>	WELL @ 5405.00usft (Xtreme 19)
<b>Site:</b>	Jones	<b>North Reference:</b>	Grid
<b>Well:</b>	18-24-10-59	<b>Survey Calculation Method:</b>	Minimum Curvature
<b>Wellbore:</b>	Wellbore #1		
<b>Design:</b>	Design #1		

<b>Project</b>	Weld County, Colorado (NAD83)		
<b>Map System:</b>	US State Plane 1983	<b>System Datum:</b>	Mean Sea Level
<b>Geo Datum:</b>	North American Datum 1983		
<b>Map Zone:</b>	Colorado Northern Zone		

<b>Well</b>	18-24-10-59			
<b>Well Position</b>	<b>+N/-S</b>	1,548,430.91 usft	<b>Northing:</b>	1,548,430.91 usft
	<b>+E/-W</b>	3,408,016.56 usft	<b>Easting:</b>	3,408,016.56 usft
<b>Position Uncertainty</b>		0.00 usft	<b>Wellhead Elevation:</b>	<b>Latitude:</b> 40° 49' 46.2398 N
				<b>Longitude:</b> 104° 1' 32.141 W
				<b>Ground Level:</b> 5,388.00 usft

<b>Wellbore</b>	Wellbore #1				
<b>Magnetics</b>	<b>Model Name</b>	<b>Sample Date</b>	<b>Declination (°)</b>	<b>Dip Angle (°)</b>	<b>Field Strength (nT)</b>
	WMM_2010	1/4/2012	8.41	67.50	53,377

<b>Design</b>	Design #1			
<b>Audit Notes:</b>				
<b>Version:</b>	<b>Phase:</b>	PROTOTYPE	<b>Tie On Depth:</b>	0.00
<b>Vertical Section:</b>	<b>Depth From (TVD) (usft)</b>	<b>+N/-S (usft)</b>	<b>+E/-W (usft)</b>	<b>Direction (°)</b>
	0.00	0.00	0.00	7.97

<b>Plan Sections</b>										
Measured Depth (usft)	Inclination (°)	Azimuth (°)	Vertical Depth (usft)	+N/-S (usft)	+E/-W (usft)	Dogleg Rate (°/100usft)	Build Rate (°/100usft)	Turn Rate (°/100usft)	TFO (°)	Target
0.00	0.00	0.00	0.00	0.00	0.00	0.00	0.00	0.00	0.00	
1,400.00	0.00	0.00	1,400.00	0.00	0.00	0.00	0.00	0.00	0.00	
1,734.78	6.70	52.99	1,734.02	11.76	15.60	2.00	2.00	0.00	52.99	
6,274.28	6.70	52.99	6,242.55	330.37	438.24	0.00	0.00	0.00	0.00	
6,989.04	90.00	2.21	6,683.00	804.64	496.64	12.00	11.65	-7.10	-50.97	
10,775.54	90.00	2.21	6,683.00	4,588.32	642.73	0.00	0.00	0.00	0.00	PBHL v1 - Jones 18-2

<b>Database:</b>	Southern Region	<b>Local Co-ordinate Reference:</b>	Well 18-24-10-59
<b>Company:</b>	Carrizo Oil & Gas	<b>TVD Reference:</b>	WELL @ 5405.00usft (Xtreme 19)
<b>Project:</b>	Weld County, Colorado (NAD83)	<b>MD Reference:</b>	WELL @ 5405.00usft (Xtreme 19)
<b>Site:</b>	Jones	<b>North Reference:</b>	Grid
<b>Well:</b>	18-24-10-59	<b>Survey Calculation Method:</b>	Minimum Curvature
<b>Wellbore:</b>	Wellbore #1		
<b>Design:</b>	Design #1		

Planned Survey									
Measured Depth (usft)	Inclination (°)	Azimuth (°)	Vertical Depth (usft)	+N/-S (usft)	+E/-W (usft)	Vertical Section (usft)	Dogleg Rate (°/100usft)	Build Rate (°/100usft)	Turn Rate (°/100usft)
0.00	0.00	0.00	0.00	0.00	0.00	0.00	0.00	0.00	0.00
100.00	0.00	0.00	100.00	0.00	0.00	0.00	0.00	0.00	0.00
200.00	0.00	0.00	200.00	0.00	0.00	0.00	0.00	0.00	0.00
300.00	0.00	0.00	300.00	0.00	0.00	0.00	0.00	0.00	0.00
400.00	0.00	0.00	400.00	0.00	0.00	0.00	0.00	0.00	0.00
500.00	0.00	0.00	500.00	0.00	0.00	0.00	0.00	0.00	0.00
600.00	0.00	0.00	600.00	0.00	0.00	0.00	0.00	0.00	0.00
700.00	0.00	0.00	700.00	0.00	0.00	0.00	0.00	0.00	0.00
800.00	0.00	0.00	800.00	0.00	0.00	0.00	0.00	0.00	0.00
900.00	0.00	0.00	900.00	0.00	0.00	0.00	0.00	0.00	0.00
1,000.00	0.00	0.00	1,000.00	0.00	0.00	0.00	0.00	0.00	0.00
1,100.00	0.00	0.00	1,100.00	0.00	0.00	0.00	0.00	0.00	0.00
1,200.00	0.00	0.00	1,200.00	0.00	0.00	0.00	0.00	0.00	0.00
1,300.00	0.00	0.00	1,300.00	0.00	0.00	0.00	0.00	0.00	0.00
1,400.00	0.00	0.00	1,400.00	0.00	0.00	0.00	0.00	0.00	0.00
<b>KOP, 2.00°/100' Build</b>									
1,500.00	2.00	52.99	1,499.98	1.05	1.39	1.23	2.00	2.00	0.00
1,600.00	4.00	52.99	1,599.84	4.20	5.57	4.93	2.00	2.00	0.00
1,700.00	6.00	52.99	1,699.45	9.45	12.53	11.09	2.00	2.00	0.00
1,734.78	6.70	52.99	1,734.02	11.76	15.60	13.81	2.00	2.00	0.00
<b>Begin 6.70° Tangent</b>									
1,800.00	6.70	52.99	1,798.79	16.34	21.67	19.19	0.00	0.00	0.00
1,900.00	6.70	52.99	1,898.11	23.36	30.98	27.43	0.00	0.00	0.00
2,000.00	6.70	52.99	1,997.43	30.38	40.30	35.67	0.00	0.00	0.00
2,100.00	6.70	52.99	2,096.75	37.40	49.61	43.92	0.00	0.00	0.00
2,200.00	6.70	52.99	2,196.07	44.41	58.92	52.16	0.00	0.00	0.00
2,300.00	6.70	52.99	2,295.38	51.43	68.23	60.40	0.00	0.00	0.00
2,400.00	6.70	52.99	2,394.70	58.45	77.54	68.64	0.00	0.00	0.00
2,500.00	6.70	52.99	2,494.02	65.47	86.85	76.89	0.00	0.00	0.00
2,600.00	6.70	52.99	2,593.34	72.49	96.16	85.13	0.00	0.00	0.00
2,700.00	6.70	52.99	2,692.66	79.51	105.47	93.37	0.00	0.00	0.00
2,800.00	6.70	52.99	2,791.97	86.53	114.78	101.61	0.00	0.00	0.00
2,900.00	6.70	52.99	2,891.29	93.54	124.09	109.85	0.00	0.00	0.00
3,000.00	6.70	52.99	2,990.61	100.56	133.40	118.10	0.00	0.00	0.00
3,100.00	6.70	52.99	3,089.93	107.58	142.71	126.34	0.00	0.00	0.00
3,200.00	6.70	52.99	3,189.25	114.60	152.02	134.58	0.00	0.00	0.00
3,300.00	6.70	52.99	3,288.56	121.62	161.33	142.82	0.00	0.00	0.00
3,400.00	6.70	52.99	3,387.88	128.64	170.64	151.07	0.00	0.00	0.00
3,500.00	6.70	52.99	3,487.20	135.66	179.95	159.31	0.00	0.00	0.00
3,600.00	6.70	52.99	3,586.52	142.68	189.26	167.55	0.00	0.00	0.00
3,700.00	6.70	52.99	3,685.83	149.69	198.57	175.79	0.00	0.00	0.00
3,800.00	6.70	52.99	3,785.15	156.71	207.88	184.04	0.00	0.00	0.00
3,900.00	6.70	52.99	3,884.47	163.73	217.19	192.28	0.00	0.00	0.00
4,000.00	6.70	52.99	3,983.79	170.75	226.50	200.52	0.00	0.00	0.00
4,100.00	6.70	52.99	4,083.11	177.77	235.81	208.76	0.00	0.00	0.00
4,200.00	6.70	52.99	4,182.42	184.79	245.12	217.01	0.00	0.00	0.00
4,300.00	6.70	52.99	4,281.74	191.81	254.43	225.25	0.00	0.00	0.00
4,400.00	6.70	52.99	4,381.06	198.83	263.74	233.49	0.00	0.00	0.00
4,500.00	6.70	52.99	4,480.38	205.84	273.05	241.73	0.00	0.00	0.00
4,600.00	6.70	52.99	4,579.70	212.86	282.36	249.98	0.00	0.00	0.00
4,700.00	6.70	52.99	4,679.01	219.88	291.67	258.22	0.00	0.00	0.00
4,800.00	6.70	52.99	4,778.33	226.90	300.98	266.46	0.00	0.00	0.00
4,900.00	6.70	52.99	4,877.65	233.92	310.30	274.70	0.00	0.00	0.00
5,000.00	6.70	52.99	4,976.97	240.94	319.61	282.94	0.00	0.00	0.00

<b>Database:</b>	Southern Region	<b>Local Co-ordinate Reference:</b>	Well 18-24-10-59
<b>Company:</b>	Carrizo Oil & Gas	<b>TVD Reference:</b>	WELL @ 5405.00usft (Xtreme 19)
<b>Project:</b>	Weld County, Colorado (NAD83)	<b>MD Reference:</b>	WELL @ 5405.00usft (Xtreme 19)
<b>Site:</b>	Jones	<b>North Reference:</b>	Grid
<b>Well:</b>	18-24-10-59	<b>Survey Calculation Method:</b>	Minimum Curvature
<b>Wellbore:</b>	Wellbore #1		
<b>Design:</b>	Design #1		

Planned Survey									
Measured Depth (usft)	Inclination (°)	Azimuth (°)	Vertical Depth (usft)	+N/-S (usft)	+E/-W (usft)	Vertical Section (usft)	Dogleg Rate (°/100usft)	Build Rate (°/100usft)	Turn Rate (°/100usft)
5,100.00	6.70	52.99	5,076.29	247.96	328.92	291.19	0.00	0.00	0.00
5,200.00	6.70	52.99	5,175.60	254.97	338.23	299.43	0.00	0.00	0.00
5,300.00	6.70	52.99	5,274.92	261.99	347.54	307.67	0.00	0.00	0.00
5,400.00	6.70	52.99	5,374.24	269.01	356.85	315.91	0.00	0.00	0.00
5,500.00	6.70	52.99	5,473.56	276.03	366.16	324.16	0.00	0.00	0.00
5,600.00	6.70	52.99	5,572.88	283.05	375.47	332.40	0.00	0.00	0.00
5,700.00	6.70	52.99	5,672.19	290.07	384.78	340.64	0.00	0.00	0.00
5,800.00	6.70	52.99	5,771.51	297.09	394.09	348.88	0.00	0.00	0.00
5,900.00	6.70	52.99	5,870.83	304.11	403.40	357.13	0.00	0.00	0.00
6,000.00	6.70	52.99	5,970.15	311.12	412.71	365.37	0.00	0.00	0.00
6,100.00	6.70	52.99	6,069.47	318.14	422.02	373.61	0.00	0.00	0.00
6,200.00	6.70	52.99	6,168.78	325.16	431.33	381.85	0.00	0.00	0.00
6,274.28	6.70	52.99	6,242.55	330.37	438.24	387.98	0.00	0.00	0.00
Begin 12.00°/100' Build & Turn									
6,300.00	8.96	37.42	6,268.04	332.87	440.66	390.78	12.00	8.82	-60.54
6,325.00	11.54	28.67	6,292.64	336.61	443.04	394.82	12.00	10.29	-34.99
6,350.00	14.28	23.15	6,317.01	341.64	445.46	400.13	12.00	10.95	-22.06
6,375.00	17.10	19.41	6,341.07	347.94	447.89	406.71	12.00	11.30	-14.99
6,400.00	19.98	16.70	6,364.77	355.50	450.34	414.54	12.00	11.50	-10.82
6,425.00	22.88	14.66	6,388.04	364.30	452.80	423.59	12.00	11.62	-8.18
6,450.00	25.81	13.05	6,410.82	374.30	455.26	433.84	12.00	11.71	-6.42
6,475.00	28.75	11.75	6,433.04	385.49	457.71	445.26	12.00	11.76	-5.19
6,500.00	31.70	10.68	6,454.63	397.83	460.15	457.82	12.00	11.80	-4.30
6,525.00	34.66	9.77	6,475.56	411.30	462.58	471.49	12.00	11.83	-3.64
6,550.00	37.62	8.99	6,495.74	425.84	464.97	486.23	12.00	11.86	-3.13
6,575.00	40.59	8.30	6,515.14	441.43	467.34	502.00	12.00	11.88	-2.74
6,600.00	43.56	7.70	6,533.70	458.02	469.67	518.75	12.00	11.89	-2.42
6,625.00	46.54	7.16	6,551.35	475.56	471.96	536.44	12.00	11.90	-2.17
6,650.00	49.52	6.66	6,568.07	494.01	474.19	555.02	12.00	11.91	-1.97
6,675.00	52.50	6.21	6,583.80	513.32	476.37	574.44	12.00	11.92	-1.80
6,700.00	55.48	5.80	6,598.50	533.43	478.48	594.65	12.00	11.92	-1.66
6,725.00	58.46	5.41	6,612.12	554.29	480.53	615.59	12.00	11.93	-1.55
6,750.00	61.44	5.05	6,624.64	575.83	482.50	637.20	12.00	11.93	-1.45
6,775.00	64.43	4.71	6,636.02	598.01	484.39	659.43	12.00	11.94	-1.37
6,800.00	67.41	4.38	6,646.21	620.76	486.20	682.21	12.00	11.94	-1.30
6,825.00	70.40	4.07	6,655.21	644.02	487.91	705.48	12.00	11.94	-1.25
6,850.00	73.39	3.77	6,662.98	667.73	489.53	729.18	12.00	11.95	-1.20
6,875.00	76.37	3.47	6,669.50	691.81	491.06	753.24	12.00	11.95	-1.17
6,900.00	79.36	3.19	6,674.76	716.21	492.48	777.60	12.00	11.95	-1.14
6,925.00	82.35	2.91	6,678.73	740.85	493.79	802.19	12.00	11.95	-1.12
6,950.00	85.33	2.64	6,681.41	765.67	494.99	826.94	12.00	11.95	-1.10
6,975.00	88.32	2.36	6,682.79	790.61	496.08	851.78	12.00	11.95	-1.09
6,989.04	90.00	2.21	6,683.00	804.64	496.64	865.75	12.00	11.95	-1.09
Begin 90.00° Lateral									
7,000.00	90.00	2.21	6,683.00	815.59	497.07	876.66	0.00	0.00	0.00
7,100.00	90.00	2.21	6,683.00	915.51	500.92	976.15	0.00	0.00	0.00
7,200.00	90.00	2.21	6,683.00	1,015.44	504.78	1,075.65	0.00	0.00	0.00
7,300.00	90.00	2.21	6,683.00	1,115.36	508.64	1,175.14	0.00	0.00	0.00
7,400.00	90.00	2.21	6,683.00	1,215.29	512.50	1,274.64	0.00	0.00	0.00
7,500.00	90.00	2.21	6,683.00	1,315.22	516.36	1,374.13	0.00	0.00	0.00
7,600.00	90.00	2.21	6,683.00	1,415.14	520.21	1,473.62	0.00	0.00	0.00
7,700.00	90.00	2.21	6,683.00	1,515.07	524.07	1,573.12	0.00	0.00	0.00
7,800.00	90.00	2.21	6,683.00	1,614.99	527.93	1,672.61	0.00	0.00	0.00
7,900.00	90.00	2.21	6,683.00	1,714.92	531.79	1,772.11	0.00	0.00	0.00

<b>Database:</b>	Southern Region	<b>Local Co-ordinate Reference:</b>	Well 18-24-10-59
<b>Company:</b>	Carrizo Oil & Gas	<b>TVD Reference:</b>	WELL @ 5405.00usft (Xtreme 19)
<b>Project:</b>	Weld County, Colorado (NAD83)	<b>MD Reference:</b>	WELL @ 5405.00usft (Xtreme 19)
<b>Site:</b>	Jones	<b>North Reference:</b>	Grid
<b>Well:</b>	18-24-10-59	<b>Survey Calculation Method:</b>	Minimum Curvature
<b>Wellbore:</b>	Wellbore #1		
<b>Design:</b>	Design #1		

Planned Survey										
Measured Depth (usft)	Inclination (°)	Azimuth (°)	Vertical Depth (usft)	+N/-S (usft)	+E/-W (usft)	Vertical Section (usft)	Dogleg Rate (°/100usft)	Build Rate (°/100usft)	Turn Rate (°/100usft)	
8,000.00	90.00	2.21	6,683.00	1,814.84	535.65	1,871.60	0.00	0.00	0.00	
8,100.00	90.00	2.21	6,683.00	1,914.77	539.50	1,971.10	0.00	0.00	0.00	
8,200.00	90.00	2.21	6,683.00	2,014.69	543.36	2,070.59	0.00	0.00	0.00	
8,300.00	90.00	2.21	6,683.00	2,114.62	547.22	2,170.09	0.00	0.00	0.00	
8,400.00	90.00	2.21	6,683.00	2,214.55	551.08	2,269.58	0.00	0.00	0.00	
8,500.00	90.00	2.21	6,683.00	2,314.47	554.94	2,369.08	0.00	0.00	0.00	
8,600.00	90.00	2.21	6,683.00	2,414.40	558.79	2,468.57	0.00	0.00	0.00	
8,700.00	90.00	2.21	6,683.00	2,514.32	562.65	2,568.07	0.00	0.00	0.00	
8,800.00	90.00	2.21	6,683.00	2,614.25	566.51	2,667.56	0.00	0.00	0.00	
8,900.00	90.00	2.21	6,683.00	2,714.17	570.37	2,767.05	0.00	0.00	0.00	
9,000.00	90.00	2.21	6,683.00	2,814.10	574.23	2,866.55	0.00	0.00	0.00	
9,100.00	90.00	2.21	6,683.00	2,914.02	578.09	2,966.04	0.00	0.00	0.00	
9,200.00	90.00	2.21	6,683.00	3,013.95	581.94	3,065.54	0.00	0.00	0.00	
9,300.00	90.00	2.21	6,683.00	3,113.88	585.80	3,165.03	0.00	0.00	0.00	
9,400.00	90.00	2.21	6,683.00	3,213.80	589.66	3,264.53	0.00	0.00	0.00	
9,500.00	90.00	2.21	6,683.00	3,313.73	593.52	3,364.02	0.00	0.00	0.00	
9,600.00	90.00	2.21	6,683.00	3,413.65	597.38	3,463.52	0.00	0.00	0.00	
9,700.00	90.00	2.21	6,683.00	3,513.58	601.23	3,563.01	0.00	0.00	0.00	
9,800.00	90.00	2.21	6,683.00	3,613.50	605.09	3,662.51	0.00	0.00	0.00	
9,900.00	90.00	2.21	6,683.00	3,713.43	608.95	3,762.00	0.00	0.00	0.00	
10,000.00	90.00	2.21	6,683.00	3,813.35	612.81	3,861.49	0.00	0.00	0.00	
10,100.00	90.00	2.21	6,683.00	3,913.28	616.67	3,960.99	0.00	0.00	0.00	
10,200.00	90.00	2.21	6,683.00	4,013.21	620.52	4,060.48	0.00	0.00	0.00	
10,300.00	90.00	2.21	6,683.00	4,113.13	624.38	4,159.98	0.00	0.00	0.00	
10,400.00	90.00	2.21	6,683.00	4,213.06	628.24	4,259.47	0.00	0.00	0.00	
10,500.00	90.00	2.21	6,683.00	4,312.98	632.10	4,358.97	0.00	0.00	0.00	
10,600.00	90.00	2.21	6,683.00	4,412.91	635.96	4,458.46	0.00	0.00	0.00	
10,700.00	90.00	2.21	6,683.00	4,512.83	639.81	4,557.96	0.00	0.00	0.00	
10,775.54	90.00	2.21	6,683.00	4,588.32	642.73	4,633.12	0.00	0.00	0.00	
PBHL										

Design Targets										
Target Name	Dip Angle (°)	Dip Dir. (°)	TVD (usft)	+N/-S (usft)	+E/-W (usft)	Northing (usft)	Easting (usft)	Latitude	Longitude	
- hit/miss target										
- Shape										
PBHL v1 - Jones 18-24- - plan hits target center - Point	0.00	0.00	6,683.00	4,588.32	642.73	1,553,019.23	3,408,659.29	40° 50' 31.4642 N	104° 1' 22.787 W	
LP v1 - Jones 18-24-10- - plan misses target center by 7.17usft at 6906.71usft MD (6675.95 TVD, 722.80 N, 492.84 E) - Point	0.00	0.00	6,683.00	721.63	493.44	1,549,152.54	3,408,510.00	40° 49' 53.2880 N	104° 1' 25.567 W	

<b>Database:</b>	Southern Region	<b>Local Co-ordinate Reference:</b>	Well 18-24-10-59
<b>Company:</b>	Carrizo Oil & Gas	<b>TVD Reference:</b>	WELL @ 5405.00usft (Xtreme 19)
<b>Project:</b>	Weld County, Colorado (NAD83)	<b>MD Reference:</b>	WELL @ 5405.00usft (Xtreme 19)
<b>Site:</b>	Jones	<b>North Reference:</b>	Grid
<b>Well:</b>	18-24-10-59	<b>Survey Calculation Method:</b>	Minimum Curvature
<b>Wellbore:</b>	Wellbore #1		
<b>Design:</b>	Design #1		

Plan Annotations				
Measured Depth (usft)	Vertical Depth (usft)	Local Coordinates		Comment
		+N/-S (usft)	+E/-W (usft)	
1,400.00	1,400.00	0.00	0.00	KOP, 2.00°/100' Build
1,734.78	1,734.02	11.76	15.60	Begin 6.70° Tangent
6,274.28	6,242.55	330.37	438.24	Begin 12.00°/100' Build & Turn
6,989.04	6,683.00	804.64	496.64	Begin 90.00° Lateral
10,775.54	6,683.00	4,588.32	642.73	PBHL