

BONANZA CREEK ENERGY OPERATING

Well Name: **PRONGHORN 41-11-9HZ**

Surface Location: PRONGHORN 41-11-9HZ

North American Datum 1983 , US State Plane 1983 , Colorado Northern Zone

Ground Elevation: 4682.0

+N/-S	+E/-W	Northing	Easting	Latitude	Longitude	Slot
0.0	0.0	1399041.29	3360376.41	40.421550	-104.205600	
Original Well Elev WELL @ 4697.0ft (Original Well Elev)						

WELLBORE TARGET DETAILS (LAT/LONG)

Name	TVD	+N/-S	+E/-W	Latitude	Longitude	Shape
HARDLINES 460'	1.0	61.9	-189.3	40.421720	-104.206280	Polygon
BHL 670'FNL & 460'FWL	6230.0	-112.5	-4574.7	40.421240	-104.222030	Point
Target 1 460'FNL & 460'FEL	6230.0	61.9	-189.3	40.421720	-104.206280	Point

PRONGHORN 41-11-9HZ
PRONGHORN 41-11-9HZ
PLAN 1 (DEC 29,2011)
13:21, December 29 2011

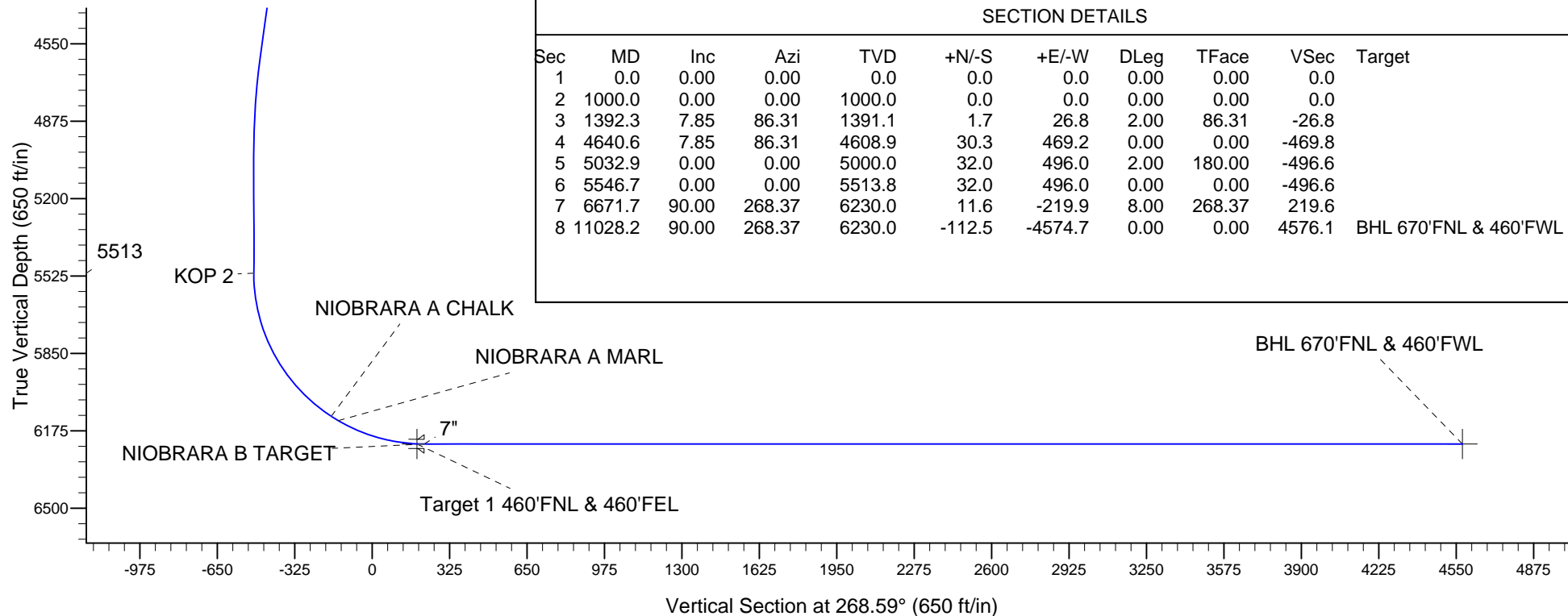
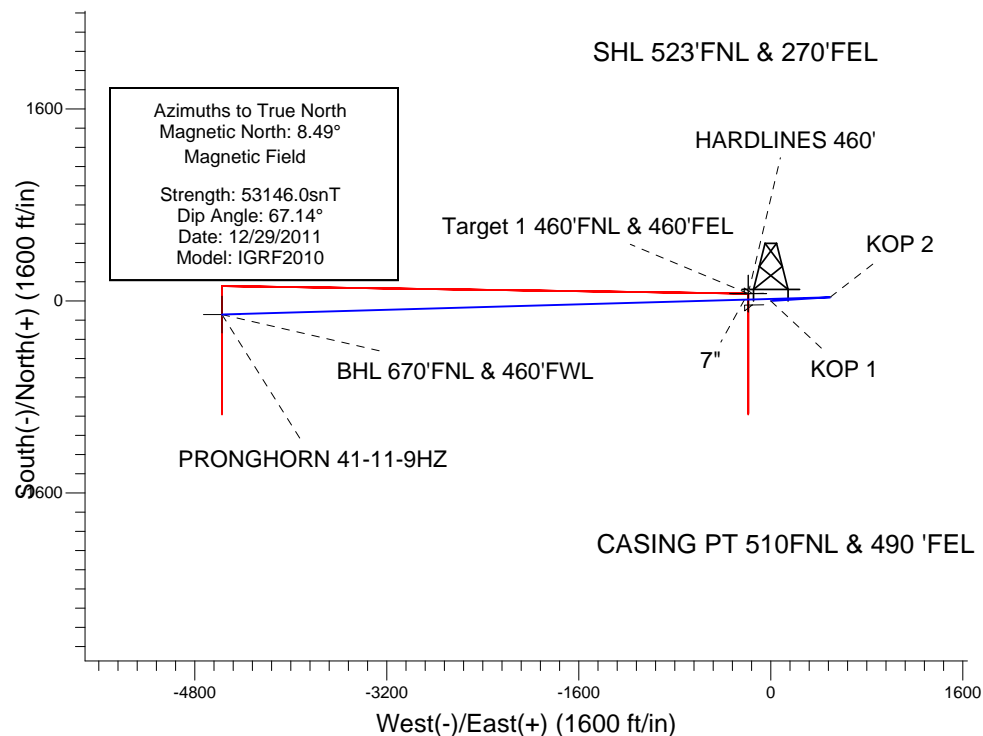



Directional

BONANZA CREEK ENERGY OPERATING

SEC.9-T5N-R61W

PRONGHORN 41-11-9HZ

PRONGHORN 41-11-9HZ

Wellbore #1

Plan: PLAN 1 (DEC 29,2011)

Standard Planning Report

29 December, 2011

Database:	Landmark	Local Co-ordinate Reference:	Well PRONGHORN 41-11-9HZ
Company:	BONANZA CREEK ENERGY OPERATING	TVD Reference:	WELL @ 4697.0ft (Original Well Elev)
Project:	SEC.9-T5N-R61W	MD Reference:	WELL @ 4697.0ft (Original Well Elev)
Site:	PRONGHORN 41-11-9HZ	North Reference:	True
Well:	PRONGHORN 41-11-9HZ	Survey Calculation Method:	Minimum Curvature
Wellbore:	Wellbore #1		
Design:	PLAN 1 (DEC 29,2011)		

Project	SEC.9-T5N-R61W		
Map System:	US State Plane 1983	System Datum:	Mean Sea Level
Geo Datum:	North American Datum 1983		Using Well Reference Point
Map Zone:	Colorado Northern Zone		Using geodetic scale factor

Site PRONGHORN 41-11-9HZ					
Site Position:		Northing:	1,399,041.29 ft	Latitude:	40.421550
From:	Lat/Long	Easting:	3,360,376.41 ft	Longitude:	-104.205600
Position Uncertainty:	0.0 ft	Slot Radius:	"	Grid Convergence:	0.84 °

Well	PRONGHORN 41-11-9HZ					
Well Position	+N/-S	0.0 ft	Northing:	1,399,041.29 ft	Latitude:	40.421550
	+E/-W	0.0 ft	Easting:	3,360,376.41 ft	Longitude:	-104.205600
Position Uncertainty		0.0 ft	Wellhead Elevation:	ft	Ground Level:	4,682.0 ft

Wellbore	Wellbore #1				
Magnetics	Model Name	Sample Date	Declination (°)	Dip Angle (°)	Field Strength (nT)
	IGRF2010	12/29/2011	8.49	67.14	53,146

Design	PLAN 1 (DEC 29,2011)			
Audit Notes:				
Version:	Phase:	PROTOTYPE	Tie On Depth:	0.0
Vertical Section:	Depth From (TVD) (ft)	+N/-S (ft)	+E/-W (ft)	Direction (°)
	0.0	0.0	0.0	268.59

Plan Sections										
Measured Depth (ft)	Inclination (°)	Azimuth (°)	Vertical Depth (ft)	+N/-S (ft)	+E/-W (ft)	Dogleg Rate (°/100ft)	Build Rate (°/100ft)	Turn Rate (°/100ft)	TFO (°)	Target
0.0	0.00	0.00	0.0	0.0	0.0	0.00	0.00	0.00	0.00	
1,000.0	0.00	0.00	1,000.0	0.0	0.0	0.00	0.00	0.00	0.00	
1,392.3	7.85	86.31	1,391.1	1.7	26.8	2.00	2.00	0.00	86.31	
4,640.6	7.85	86.31	4,608.9	30.3	469.2	0.00	0.00	0.00	0.00	
5,032.9	0.00	0.00	5,000.0	32.0	496.0	2.00	-2.00	0.00	180.00	
5,546.7	0.00	0.00	5,513.8	32.0	496.0	0.00	0.00	0.00	0.00	
6,671.7	90.00	268.37	6,230.0	11.6	-219.9	8.00	8.00	0.00	268.37	
11,028.2	90.00	268.37	6,230.0	-112.5	-4,574.7	0.00	0.00	0.00	0.00	BHL 670'FNL & 46C

Database:	Landmark	Local Co-ordinate Reference:	Well PRONGHORN 41-11-9HZ
Company:	BONANZA CREEK ENERGY OPERATING	TVD Reference:	WELL @ 4697.0ft (Original Well Elev)
Project:	SEC.9-T5N-R61W	MD Reference:	WELL @ 4697.0ft (Original Well Elev)
Site:	PRONGHORN 41-11-9HZ	North Reference:	True
Well:	PRONGHORN 41-11-9HZ	Survey Calculation Method:	Minimum Curvature
Wellbore:	Wellbore #1		
Design:	PLAN 1 (DEC 29,2011)		

Planned Survey									
Measured Depth (ft)	Inclination (°)	Azimuth (°)	Vertical Depth (ft)	+N/-S (ft)	+E/-W (ft)	Vertical Section (ft)	Dogleg Rate (°/100ft)	Build Rate (°/100ft)	Turn Rate (°/100ft)
0.0	0.00	0.00	0.0	0.0	0.0	0.0	0.00	0.00	0.00
1.0	0.00	0.00	1.0	0.0	0.0	0.0	0.00	0.00	0.00
HARDLINES 460'									
100.0	0.00	0.00	100.0	0.0	0.0	0.0	0.00	0.00	0.00
200.0	0.00	0.00	200.0	0.0	0.0	0.0	0.00	0.00	0.00
300.0	0.00	0.00	300.0	0.0	0.0	0.0	0.00	0.00	0.00
400.0	0.00	0.00	400.0	0.0	0.0	0.0	0.00	0.00	0.00
500.0	0.00	0.00	500.0	0.0	0.0	0.0	0.00	0.00	0.00
600.0	0.00	0.00	600.0	0.0	0.0	0.0	0.00	0.00	0.00
700.0	0.00	0.00	700.0	0.0	0.0	0.0	0.00	0.00	0.00
800.0	0.00	0.00	800.0	0.0	0.0	0.0	0.00	0.00	0.00
900.0	0.00	0.00	900.0	0.0	0.0	0.0	0.00	0.00	0.00
1,000.0	0.00	0.00	1,000.0	0.0	0.0	0.0	0.00	0.00	0.00
KOP 1									
1,100.0	2.00	86.31	1,100.0	0.1	1.7	-1.7	2.00	2.00	0.00
1,200.0	4.00	86.31	1,199.8	0.4	7.0	-7.0	2.00	2.00	0.00
1,300.0	6.00	86.31	1,299.5	1.0	15.7	-15.7	2.00	2.00	0.00
1,392.3	7.85	86.31	1,391.1	1.7	26.8	-26.8	2.00	2.00	0.00
1,400.0	7.85	86.31	1,398.7	1.8	27.8	-27.8	0.00	0.00	0.00
1,500.0	7.85	86.31	1,497.8	2.7	41.4	-41.5	0.00	0.00	0.00
1,600.0	7.85	86.31	1,596.8	3.6	55.1	-55.1	0.00	0.00	0.00
1,700.0	7.85	86.31	1,695.9	4.4	68.7	-68.8	0.00	0.00	0.00
1,800.0	7.85	86.31	1,795.0	5.3	82.3	-82.4	0.00	0.00	0.00
1,900.0	7.85	86.31	1,894.0	6.2	95.9	-96.0	0.00	0.00	0.00
2,000.0	7.85	86.31	1,993.1	7.1	109.5	-109.7	0.00	0.00	0.00
2,100.0	7.85	86.31	2,092.2	7.9	123.2	-123.3	0.00	0.00	0.00
2,200.0	7.85	86.31	2,191.2	8.8	136.8	-137.0	0.00	0.00	0.00
2,300.0	7.85	86.31	2,290.3	9.7	150.4	-150.6	0.00	0.00	0.00
2,400.0	7.85	86.31	2,389.3	10.6	164.0	-164.2	0.00	0.00	0.00
2,500.0	7.85	86.31	2,488.4	11.5	177.7	-177.9	0.00	0.00	0.00
2,600.0	7.85	86.31	2,587.5	12.3	191.3	-191.5	0.00	0.00	0.00
2,700.0	7.85	86.31	2,686.5	13.2	204.9	-205.2	0.00	0.00	0.00
2,800.0	7.85	86.31	2,785.6	14.1	218.5	-218.8	0.00	0.00	0.00
2,900.0	7.85	86.31	2,884.7	15.0	232.1	-232.4	0.00	0.00	0.00
3,000.0	7.85	86.31	2,983.7	15.9	245.8	-246.1	0.00	0.00	0.00
3,100.0	7.85	86.31	3,082.8	16.7	259.4	-259.7	0.00	0.00	0.00
3,200.0	7.85	86.31	3,181.9	17.6	273.0	-273.4	0.00	0.00	0.00
3,275.9	7.85	86.31	3,257.0	18.3	283.3	-283.7	0.00	0.00	0.00
PARKMAN									
3,300.0	7.85	86.31	3,280.9	18.5	286.6	-287.0	0.00	0.00	0.00
3,400.0	7.85	86.31	3,380.0	19.4	300.2	-300.6	0.00	0.00	0.00
3,500.0	7.85	86.31	3,479.0	20.2	313.9	-314.3	0.00	0.00	0.00
3,600.0	7.85	86.31	3,578.1	21.1	327.5	-327.9	0.00	0.00	0.00
3,700.0	7.85	86.31	3,677.2	22.0	341.1	-341.6	0.00	0.00	0.00
3,800.0	7.85	86.31	3,776.2	22.9	354.7	-355.2	0.00	0.00	0.00
3,900.0	7.85	86.31	3,875.3	23.8	368.4	-368.8	0.00	0.00	0.00
4,000.0	7.85	86.31	3,974.4	24.6	382.0	-382.5	0.00	0.00	0.00
4,100.0	7.85	86.31	4,073.4	25.5	395.6	-396.1	0.00	0.00	0.00
4,200.0	7.85	86.31	4,172.5	26.4	409.2	-409.8	0.00	0.00	0.00
4,248.0	7.85	86.31	4,220.0	26.8	415.8	-416.3	0.00	0.00	0.00
SUSSEX									
4,300.0	7.85	86.31	4,271.6	27.3	422.8	-423.4	0.00	0.00	0.00
4,400.0	7.85	86.31	4,370.6	28.2	436.5	-437.0	0.00	0.00	0.00
4,500.0	7.85	86.31	4,469.7	29.0	450.1	-450.7	0.00	0.00	0.00

Database:	Landmark	Local Co-ordinate Reference:	Well PRONGHORN 41-11-9HZ
Company:	BONANZA CREEK ENERGY OPERATING	TVD Reference:	WELL @ 4697.0ft (Original Well Elev)
Project:	SEC.9-T5N-R61W	MD Reference:	WELL @ 4697.0ft (Original Well Elev)
Site:	PRONGHORN 41-11-9HZ	North Reference:	True
Well:	PRONGHORN 41-11-9HZ	Survey Calculation Method:	Minimum Curvature
Wellbore:	Wellbore #1		
Design:	PLAN 1 (DEC 29,2011)		

Planned Survey									
Measured Depth (ft)	Inclination (°)	Azimuth (°)	Vertical Depth (ft)	+N/-S (ft)	+E/-W (ft)	Vertical Section (ft)	Dogleg Rate (°/100ft)	Build Rate (°/100ft)	Turn Rate (°/100ft)
4,600.0	7.85	86.31	4,568.8	29.9	463.7	-464.3	0.00	0.00	0.00
4,640.6	7.85	86.31	4,608.9	30.3	469.2	-469.8	0.00	0.00	0.00
4,700.0	6.66	86.31	4,667.9	30.8	476.7	-477.3	2.00	-2.00	0.00
4,800.0	4.66	86.31	4,767.4	31.4	486.6	-487.2	2.00	-2.00	0.00
4,900.0	2.66	86.31	4,867.2	31.8	492.9	-493.6	2.00	-2.00	0.00
5,000.0	0.66	86.31	4,967.1	32.0	495.8	-496.4	2.00	-2.00	0.00
5,032.9	0.00	0.00	5,000.0	32.0	496.0	-496.6	2.00	-2.00	0.00
5,100.0	0.00	0.00	5,067.1	32.0	496.0	-496.6	0.00	0.00	0.00
5,200.0	0.00	0.00	5,167.1	32.0	496.0	-496.6	0.00	0.00	0.00
5,300.0	0.00	0.00	5,267.1	32.0	496.0	-496.6	0.00	0.00	0.00
5,400.0	0.00	0.00	5,367.1	32.0	496.0	-496.6	0.00	0.00	0.00
5,500.0	0.00	0.00	5,467.1	32.0	496.0	-496.6	0.00	0.00	0.00
5,546.0	0.00	0.00	5,513.1	32.0	496.0	-496.6	0.00	0.00	0.00
KOP 2									
5,546.7	0.00	0.00	5,513.8	32.0	496.0	-496.6	0.00	0.00	0.00
5,600.0	4.27	268.37	5,567.1	31.9	494.0	-494.7	8.00	8.00	0.00
5,700.0	12.27	268.37	5,666.0	31.5	479.7	-480.3	8.00	8.00	0.00
5,800.0	20.27	268.37	5,761.9	30.7	451.7	-452.3	8.00	8.00	0.00
5,900.0	28.27	268.37	5,853.0	29.6	410.6	-411.2	8.00	8.00	0.00
6,000.0	36.27	268.37	5,937.5	28.0	357.3	-357.9	8.00	8.00	0.00
6,046.4	39.98	268.37	5,974.0	27.2	328.6	-329.2	8.00	8.00	0.00
SHARON SPRINGS									
6,100.0	44.27	268.37	6,013.7	26.2	292.7	-293.3	8.00	8.00	0.00
6,200.0	52.27	268.37	6,080.2	24.1	218.2	-218.7	8.00	8.00	0.00
6,258.3	56.93	268.37	6,114.0	22.7	170.7	-171.2	8.00	8.00	0.00
NIOBRARA A CHALK									
6,292.6	59.67	268.37	6,132.0	21.9	141.6	-142.1	8.00	8.00	0.00
NIOBRARA A MARL									
6,300.0	60.27	268.37	6,135.7	21.7	135.1	-135.6	8.00	8.00	0.00
6,400.0	68.27	268.37	6,179.1	19.2	45.2	-45.6	8.00	8.00	0.00
6,481.9	74.82	268.37	6,205.0	16.9	-32.4	32.0	8.00	8.00	0.00
NIOBRARA B CHALK									
6,500.0	76.27	268.37	6,209.5	16.4	-50.0	49.5	8.00	8.00	0.00
6,600.0	84.27	268.37	6,226.4	13.6	-148.4	148.0	8.00	8.00	0.00
6,639.7	87.44	268.37	6,229.3	12.5	-188.0	187.6	8.00	8.00	0.00
Target 1 460'FNL & 460'FEL									
6,671.0	89.95	268.37	6,230.0	11.6	-219.3	218.9	8.00	8.00	0.00
7"									
6,671.7	90.00	268.37	6,230.0	11.6	-219.9	219.6	8.00	8.00	0.00
NIOBRARA B TARGET									
6,700.0	90.00	268.37	6,230.0	10.8	-248.2	247.9	0.00	0.00	0.00
6,800.0	90.00	268.37	6,230.0	7.9	-348.2	347.9	0.00	0.00	0.00
6,900.0	90.00	268.37	6,230.0	5.1	-448.2	447.9	0.00	0.00	0.00
7,000.0	90.00	268.37	6,230.0	2.2	-548.1	547.9	0.00	0.00	0.00
7,100.0	90.00	268.37	6,230.0	-0.6	-648.1	647.9	0.00	0.00	0.00
7,200.0	90.00	268.37	6,230.0	-3.5	-748.0	747.9	0.00	0.00	0.00
7,300.0	90.00	268.37	6,230.0	-6.3	-848.0	847.9	0.00	0.00	0.00
7,400.0	90.00	268.37	6,230.0	-9.2	-948.0	947.9	0.00	0.00	0.00
7,500.0	90.00	268.37	6,230.0	-12.0	-1,047.9	1,047.9	0.00	0.00	0.00
7,600.0	90.00	268.37	6,230.0	-14.9	-1,147.9	1,147.9	0.00	0.00	0.00
7,700.0	90.00	268.37	6,230.0	-17.7	-1,247.8	1,247.9	0.00	0.00	0.00
7,800.0	90.00	268.37	6,230.0	-20.5	-1,347.8	1,347.9	0.00	0.00	0.00
7,900.0	90.00	268.37	6,230.0	-23.4	-1,447.8	1,447.9	0.00	0.00	0.00

Database:	Landmark	Local Co-ordinate Reference:	Well PRONGHORN 41-11-9HZ
Company:	BONANZA CREEK ENERGY OPERATING	TVD Reference:	WELL @ 4697.0ft (Original Well Elev)
Project:	SEC.9-T5N-R61W	MD Reference:	WELL @ 4697.0ft (Original Well Elev)
Site:	PRONGHORN 41-11-9HZ	North Reference:	True
Well:	PRONGHORN 41-11-9HZ	Survey Calculation Method:	Minimum Curvature
Wellbore:	Wellbore #1		
Design:	PLAN 1 (DEC 29,2011)		

Planned Survey									
Measured Depth (ft)	Inclination (°)	Azimuth (°)	Vertical Depth (ft)	+N/-S (ft)	+E/-W (ft)	Vertical Section (ft)	Dogleg Rate (°/100ft)	Build Rate (°/100ft)	Turn Rate (°/100ft)
8,000.0	90.00	268.37	6,230.0	-26.2	-1,547.7	1,547.9	0.00	0.00	0.00
8,100.0	90.00	268.37	6,230.0	-29.1	-1,647.7	1,647.9	0.00	0.00	0.00
8,200.0	90.00	268.37	6,230.0	-31.9	-1,747.6	1,747.9	0.00	0.00	0.00
8,300.0	90.00	268.37	6,230.0	-34.8	-1,847.6	1,847.9	0.00	0.00	0.00
8,400.0	90.00	268.37	6,230.0	-37.6	-1,947.5	1,947.9	0.00	0.00	0.00
8,500.0	90.00	268.37	6,230.0	-40.5	-2,047.5	2,047.9	0.00	0.00	0.00
8,600.0	90.00	268.37	6,230.0	-43.3	-2,147.5	2,147.9	0.00	0.00	0.00
8,700.0	90.00	268.37	6,230.0	-46.2	-2,247.4	2,247.9	0.00	0.00	0.00
8,800.0	90.00	268.37	6,230.0	-49.0	-2,347.4	2,347.9	0.00	0.00	0.00
8,900.0	90.00	268.37	6,230.0	-51.9	-2,447.3	2,447.9	0.00	0.00	0.00
9,000.0	90.00	268.37	6,230.0	-54.7	-2,547.3	2,547.9	0.00	0.00	0.00
9,100.0	90.00	268.37	6,230.0	-57.6	-2,647.3	2,647.9	0.00	0.00	0.00
9,200.0	90.00	268.37	6,230.0	-60.4	-2,747.2	2,747.9	0.00	0.00	0.00
9,300.0	90.00	268.37	6,230.0	-63.3	-2,847.2	2,847.9	0.00	0.00	0.00
9,400.0	90.00	268.37	6,230.0	-66.1	-2,947.1	2,947.9	0.00	0.00	0.00
9,500.0	90.00	268.37	6,230.0	-69.0	-3,047.1	3,047.9	0.00	0.00	0.00
9,600.0	90.00	268.37	6,230.0	-71.8	-3,147.1	3,147.9	0.00	0.00	0.00
9,700.0	90.00	268.37	6,230.0	-74.7	-3,247.0	3,247.9	0.00	0.00	0.00
9,800.0	90.00	268.37	6,230.0	-77.5	-3,347.0	3,347.9	0.00	0.00	0.00
9,900.0	90.00	268.37	6,230.0	-80.4	-3,446.9	3,447.9	0.00	0.00	0.00
10,000.0	90.00	268.37	6,230.0	-83.2	-3,546.9	3,547.9	0.00	0.00	0.00
10,100.0	90.00	268.37	6,230.0	-86.1	-3,646.9	3,647.9	0.00	0.00	0.00
10,200.0	90.00	268.37	6,230.0	-88.9	-3,746.8	3,747.9	0.00	0.00	0.00
10,300.0	90.00	268.37	6,230.0	-91.8	-3,846.8	3,847.9	0.00	0.00	0.00
10,400.0	90.00	268.37	6,230.0	-94.6	-3,946.7	3,947.9	0.00	0.00	0.00
10,500.0	90.00	268.37	6,230.0	-97.5	-4,046.7	4,047.9	0.00	0.00	0.00
10,600.0	90.00	268.37	6,230.0	-100.3	-4,146.7	4,147.9	0.00	0.00	0.00
10,700.0	90.00	268.37	6,230.0	-103.2	-4,246.6	4,247.9	0.00	0.00	0.00
10,800.0	90.00	268.37	6,230.0	-106.0	-4,346.6	4,347.9	0.00	0.00	0.00
10,900.0	90.00	268.37	6,230.0	-108.9	-4,446.5	4,447.9	0.00	0.00	0.00
11,000.0	90.00	268.37	6,230.0	-111.7	-4,546.5	4,547.9	0.00	0.00	0.00
11,028.2	90.00	268.37	6,230.0	-112.5	-4,574.7	4,576.1	0.00	0.00	0.00
BHL 670'FNL & 460'FWL									

Database:	Landmark	Local Co-ordinate Reference:	Well PRONGHORN 41-11-9HZ
Company:	BONANZA CREEK ENERGY OPERATING	TVD Reference:	WELL @ 4697.0ft (Original Well Elev)
Project:	SEC.9-T5N-R61W	MD Reference:	WELL @ 4697.0ft (Original Well Elev)
Site:	PRONGHORN 41-11-9HZ	North Reference:	True
Well:	PRONGHORN 41-11-9HZ	Survey Calculation Method:	Minimum Curvature
Wellbore:	Wellbore #1		
Design:	PLAN 1 (DEC 29,2011)		

Targets									
Target Name	- hit/miss target	Dip Angle (°)	Dip Dir. (°)	TVD (ft)	+N/-S (ft)	+E/-W (ft)	Northing (ft)	Easting (ft)	Latitude
	- Shape								Longitude
BHL 670'FNL & 460'F	- plan hits target center	0.00	0.00	6,230.0	-112.5	-4,574.7	1,398,862.02	3,355,804.05	40.421240
	- Point								-104.222030
Target 1 460'FNL & 460'F	- plan misses target center by 49.5ft at 6639.7ft MD (6229.3 TVD, 12.5 N, -188.0 E)	0.00	0.00	6,230.0	61.9	-189.3	1,399,100.45	3,360,186.20	40.421720
	- Point								-104.206280
HARDLINES 460'	- plan misses target center by 199.2ft at 1.0ft MD (1.0 TVD, 0.0 N, 0.0 E)	0.00	0.00	1.0	61.9	-189.3	1,399,100.42	3,360,186.23	40.421720
	- Polygon								-104.206280
	Point 1			1.0	0.0	0.0	1,399,100.42	3,360,186.23	
	Point 2			1.0	62.0	-4,386.0	1,399,098.39	3,355,799.98	
	Point 3			1.0	-1,000.0	-4,386.0	1,398,036.55	3,355,815.48	
	Point 4			1.0	62.0	-4,386.0	1,399,098.39	3,355,799.98	
	Point 5			1.0	0.0	0.0	1,399,100.42	3,360,186.23	
	Point 6			1.0	-1,000.0	0.0	1,398,100.56	3,360,200.83	
	Point 7			1.0	0.0	0.0	1,399,100.42	3,360,186.23	

Casing Points				
Measured Depth (ft)	Vertical Depth (ft)	Name	Casing Diameter (")	Hole Diameter (")
6,671.0	6,230.0	7"	7	8-3/4

Formations					
Measured Depth (ft)	Vertical Depth (ft)	Name	Lithology	Dip (°)	Dip Direction (°)
3,275.9	3,257.0	PARKMAN		0.00	
4,248.0	4,220.0	SUSSEX		0.00	
6,046.4	5,974.0	SHARON SPRINGS		0.00	
6,258.3	6,114.0	NIOBRARA A CHALK		0.00	
6,292.6	6,132.0	NIOBRARA A MARL		0.00	
6,481.9	6,205.0	NIOBRARA B CHALK		0.00	
6,671.7	6,230.0	NIOBRARA B TARGET		0.00	
	6,232.0	NIOBRARA B MARL		0.00	
	6,289.0	NIOBRARA C CHALK		0.00	

Plan Annotations				
Measured Depth (ft)	Vertical Depth (ft)	+N/-S (ft)	+E/-W (ft)	Comment
1,000.0	1,000.0	0.0	0.0	KOP 1
5,546.0	5,513.1	32.0	496.0	KOP 2