



KERR MCGEE OIL & GAS ONSHORE LP

Location: COLORADO Slot: SLOT#17 PALYO 3-11 (1058'FNL & 1370'FWL)
Field: WELD COUNTY (KERR MCGEE) Well: PALYO 3-11
Facility: SEC.11-T2N-R65W Wellbore: PALYO 3-11 PWB



Plot reference wellpath is PALYO 3-11 (REV.A.D) PWB	
True vertical depths are referenced to XTREME 12 (RKB)	Grid System: NAD83 / Lambert Colorado SP, Northern Zone (501), US feet
Measured depths are referenced to XTREME 12 (RKB)	North Reference: True north
XTREME 12 (RKB) to Mean Sea Level: 4869 feet	Scale: True distance
Mean Sea Level to Mud line (At Slot: SLOT#17 PALYO 3-11 (1058'FNL & 1370'FWL)): 0 feet	Depths are in feet
Coordinates are in feet referenced to Slot	
Created by: cookdam on 1/14/2011	

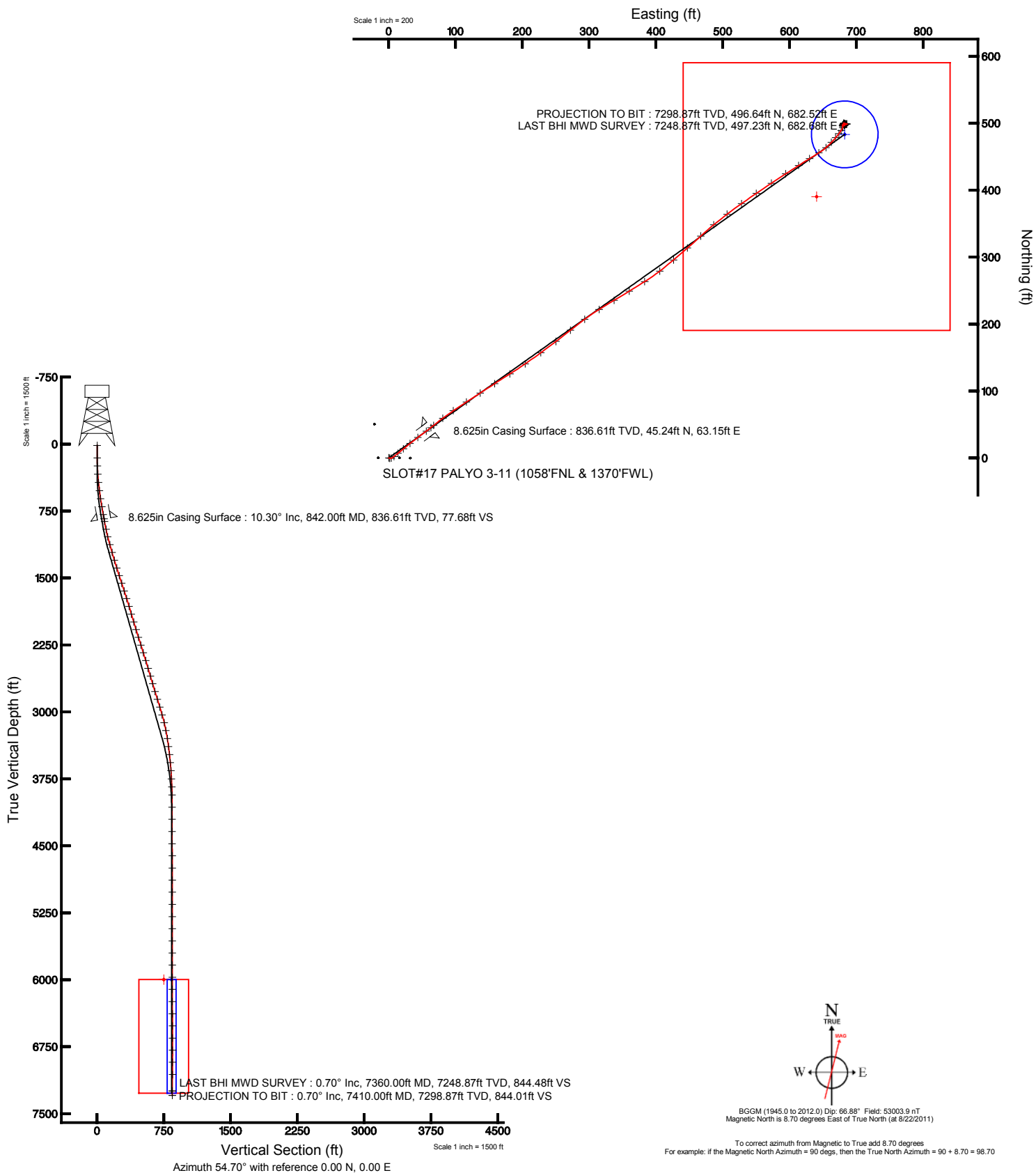



Actual Wellpath Report

PALYO 3-11 AWP

Page 1 of 5



REFERENCE WELLPATH IDENTIFICATION

Operator	KERR MCGEE OIL & GAS ONSHORE LP	Slot	SLOT#17 PALYO 3-11 (1058'FNL & 1370'FWL)
Area	COLORADO	Well	PALYO 3-11
Field	WELD COUNTY (KERR MCGEE)	Wellbore	PALYO 3-11 AWB
Facility	SEC.11-T2N-R65W		

REPORT SETUP INFORMATION

Projection System	NAD83 / Lambert Colorado SP, Northern Zone (501), US feet	Software System	WellArchitect® 3.0.1
North Reference	True	User	Cookdanm
Scale	0.999958	Report Generated	11/4/2011 at 3:46:42 PM
Convergence at slot	0.56° East	Database/Source file	WA_Denver/PALYO_3-11_AWB.xml

WELLPATH LOCATION

	Local coordinates		Grid coordinates		Geographic coordinates	
	North[ft]	East[ft]	Easting[US ft]	Northing[US ft]	Latitude	Longitude
Slot Location	3617.54	-1913.85	3241610.65	1301423.64	40°09'27.252"N	104°38'08.041"W
Facility Reference Pt			3243559.87	1297825.24	40°08'51.504"N	104°37'43.392"W
Field Reference Pt			3197771.84	1268891.29	40°04'09.600"N	104°47'36.000"W

WELLPATH DATUM

Calculation method	Minimum curvature	XTREME 12 (RKB) to Facility Vertical Datum	4869.00ft
Horizontal Reference Pt	Slot	XTREME 12 (RKB) to Mean Sea Level	4869.00ft
Vertical Reference Pt	XTREME 12 (RKB)	XTREME 12 (RKB) to Mud Line at Slot (SLOT#17 PALYO 3-11 (1058'FNL & 1370'FWL))	4869.00ft
MD Reference Pt	XTREME 12 (RKB)	Section Origin	N 0.00, E 0.00 ft
Field Vertical Reference	Mean Sea Level	Section Azimuth	54.70°



Actual Wellpath Report

PALYO 3-11 AWP

Page 2 of 5



REFERENCE WELLPATH IDENTIFICATION

Operator	KERR MCGEE OIL & GAS ONSHORE LP	Slot	SLOT#17 PALYO 3-11 (1058'FNL & 1370'FWL)
Area	COLORADO	Well	PALYO 3-11
Field	WELD COUNTY (KERR MCGEE)	Wellbore	PALYO 3-11 AWB
Facility	SEC.11-T2N-R65W		

WELLPATH DATA (71 stations) † = interpolated/extrapolated station

MD [ft]	Inclination [°]	Azimuth [°]	TVD [ft]	Vert Sect [ft]	North [ft]	East [ft]	DLS [°/100ft]	Comments
0.00†	0.000	113.400	0.00	0.00	0.00	0.00	0.00	
15.00	0.000	113.400	15.00	0.00	0.00	0.00	0.00	
153.00	1.300	113.400	152.99	0.81	-0.62	1.44	0.94	
245.00	1.900	69.400	244.96	2.83	-0.50	3.82	1.44	
337.00	4.000	52.500	336.83	7.51	1.99	7.80	2.45	
429.00	5.700	50.100	428.50	15.27	6.88	13.85	1.86	
521.00	7.300	51.300	519.90	25.66	13.46	21.91	1.75	
612.00	8.700	51.100	610.01	38.30	21.40	31.78	1.54	
703.00	10.000	53.200	699.80	53.07	30.45	43.47	1.48	
793.00	10.300	53.600	788.40	68.93	39.91	56.20	0.34	
871.00	10.300	50.100	865.14	82.85	48.52	67.16	0.80	
962.00	11.900	53.900	954.44	100.34	59.27	80.99	1.93	
1048.00	13.900	55.300	1038.26	119.54	70.37	96.64	2.35	
1139.00	16.100	57.100	1126.15	143.08	83.45	116.23	2.47	
1229.00	15.800	57.100	1212.69	167.79	96.88	136.99	0.33	
1320.00	17.200	57.100	1299.94	193.61	110.92	158.69	1.54	
1411.00	17.300	57.800	1386.85	220.57	125.44	181.44	0.25	
1501.00	18.200	55.400	1472.56	247.98	140.55	204.33	1.29	
1592.00	18.300	53.900	1558.99	276.48	157.04	227.57	0.53	
1683.00	18.000	52.900	1645.46	304.82	173.94	250.33	0.48	
1773.00	17.700	51.800	1731.13	332.38	190.79	272.17	0.50	
1864.00	16.700	53.200	1818.06	359.27	207.18	293.52	1.19	
1955.00	16.400	58.500	1905.29	385.16	221.72	314.94	1.69	
2046.00	17.100	58.900	1992.43	411.32	235.34	337.35	0.78	
2136.00	17.200	58.500	2078.43	437.79	249.13	360.02	0.17	
2227.00	17.800	58.200	2165.22	465.10	263.49	383.32	0.67	
2318.00	17.200	52.200	2252.01	492.43	279.07	405.77	2.09	
2408.00	17.200	49.700	2337.99	518.98	295.83	426.44	0.82	
2499.00	17.800	49.400	2424.77	546.23	313.59	447.26	0.67	
2590.00	16.600	46.900	2511.70	572.96	331.52	467.31	1.55	
2681.00	16.200	51.100	2599.01	598.51	348.37	486.68	1.37	
2771.00	16.800	52.500	2685.30	624.04	364.18	506.77	0.80	
2862.00	17.200	55.000	2772.32	650.63	379.90	528.23	0.92	
2953.00	17.500	55.400	2859.18	677.77	395.39	550.51	0.35	
3044.00	17.100	56.800	2946.07	704.82	410.48	572.97	0.63	
3135.00	15.800	57.100	3033.34	730.57	424.54	594.57	1.43	
3226.00	13.500	57.500	3121.38	753.56	436.98	613.93	2.53	
3316.00	11.300	58.200	3209.27	772.86	447.27	630.29	2.45	
3407.00	9.200	57.800	3298.81	789.02	455.84	644.02	2.31	
3498.00	7.700	48.700	3388.83	802.35	463.74	654.76	2.20	
3589.00	6.600	43.400	3479.12	813.54	471.57	662.93	1.41	
3680.00	5.400	40.900	3569.62	822.83	478.60	669.33	1.35	
3770.00	4.200	35.700	3659.30	830.06	484.48	674.02	1.42	
3861.00	3.400	34.300	3750.10	835.74	489.42	677.49	0.88	
3952.00	2.500	22.000	3840.98	839.94	493.49	679.75	1.20	



Actual Wellpath Report

PALYO 3-11 AWP

Page 3 of 5



REFERENCE WELLPATH IDENTIFICATION

Operator	KERR MCGEE OIL & GAS ONSHORE LP	Slot	SLOT#17 PALYO 3-11 (1058'FNL & 1370'FWL)
Area	COLORADO	Well	PALYO 3-11
Field	WELD COUNTY (KERR MCGEE)	Wellbore	PALYO 3-11 AWB
Facility	SEC.11-T2N-R65W		

WELLPATH DATA (71 stations)

MD [ft]	Inclination [°]	Azimuth [°]	TVD [ft]	Vert Sect [ft]	North [ft]	East [ft]	DLS [°/100ft]	Comments
4043.00	0.500	333.100	3931.95	841.66	495.68	680.32	2.42	
4179.00	0.400	319.400	4067.94	841.71	496.57	679.74	0.11	
4315.00	0.100	50.100	4203.94	841.78	497.01	679.52	0.30	
4451.00	0.400	25.100	4339.94	842.31	497.51	679.81	0.23	
4588.00	0.400	62.000	4476.94	843.20	498.17	680.44	0.18	
4724.00	0.500	64.800	4612.93	844.26	498.65	681.40	0.08	
4860.00	0.400	64.500	4748.93	845.31	499.10	682.36	0.07	
4996.00	0.600	307.400	4884.93	845.57	499.74	682.22	0.63	
5132.00	0.200	269.100	5020.92	845.16	500.17	681.42	0.34	
5268.00	0.100	182.900	5156.92	844.89	500.05	681.18	0.16	
5405.00	0.300	169.200	5293.92	844.67	499.58	681.24	0.15	
5541.00	0.200	162.900	5429.92	844.44	499.00	681.37	0.08	
5677.00	0.200	46.900	5565.92	844.61	498.93	681.62	0.25	
5813.00	0.300	68.000	5701.92	845.19	499.23	682.12	0.10	
5949.00	0.200	72.900	5837.92	845.76	499.43	682.68	0.08	
6085.00	0.200	314.100	5973.92	845.94	499.67	682.73	0.25	
6221.00	0.100	224.800	6109.92	845.78	499.75	682.48	0.16	
6358.00	0.300	137.600	6246.92	845.71	499.40	682.64	0.23	
6494.00	0.600	104.900	6382.91	846.21	498.95	683.57	0.28	
6630.00	0.400	91.500	6518.91	847.04	498.76	684.73	0.17	
6766.00	0.300	97.500	6654.90	847.68	498.70	685.56	0.08	
6902.00	0.400	44.500	6790.90	848.41	498.99	686.24	0.24	
7038.00	0.700	274.000	6926.90	848.24	499.39	685.75	0.74	
7175.00	0.800	239.900	7063.89	846.64	498.97	684.08	0.33	
7360.00	0.700	194.900	7248.87	844.48	497.23	682.68	0.31	LAST BHI MWD SURVEY
7410.00	0.700	194.900	7298.87	844.01	496.64	682.52	0.00	PROJECTION TO BIT

HOLE & CASING SECTIONS - Ref Wellbore: PALYO 3-11 AWB Ref Wellpath: PALYO 3-11 AWP

String/Diameter	Start MD [ft]	End MD [ft]	Interval [ft]	Start TVD [ft]	End TVD [ft]	Start N/S [ft]	Start E/W [ft]	End N/S [ft]	End E/W [ft]
12.25in Open Hole	15.00	848.00	833.00	15.00	842.51	0.00	0.00	45.91	63.98
8.625in Casing Surface	15.00	842.00	827.00	15.00	836.61	0.00	0.00	45.24	63.15
7.875in Open Hole	848.00	7410.00	6562.00	842.51	7298.87	45.91	63.98	496.64	682.52



Actual Wellpath Report

PALYO 3-11 AWP

Page 4 of 5



REFERENCE WELLPATH IDENTIFICATION

Operator	KERR MCGEE OIL & GAS ONSHORE LP	Slot	SLOT#17 PALYO 3-11 (1058'FNL & 1370'FWL)
Area	COLORADO	Well	PALYO 3-11
Field	WELD COUNTY (KERR MCGEE)	Wellbore	PALYO 3-11 AWB
Facility	SEC.11-T2N-R65W		

TARGETS

Name	MD [ft]	TVD [ft]	North [ft]	East [ft]	Grid East [US ft]	Grid North [US ft]	Latitude	Longitude	Shape
PALYO 3-11 GEO TARGET 50' RADIUS (570'FNL & 2050'FWL,REV-1)		6000.00	483.41	682.87	3242288.74	1301913.66	40°09'32.029"N	104°37'59.246"W	circle
PALYO 3-11 LEGAL BOX (107'N,293'S,158'E,242'W OF GEO TARGET)		6000.00	390.43	640.83	3242247.62	1301820.28	40°09'31.110"N	104°37'59.787"W	square

WELLPATH COMPOSITION - Ref Wellbore: PALYO 3-11 AWB Ref Wellpath: PALYO 3-11 AWP

Start MD [ft]	End MD [ft]	Positional Uncertainty Model	Log Name/Comment	Wellbore
15.00	7360.00	NaviTrak (Standard)	BHI MWD SURVEY <153-7360>	PALYO 3-11 AWB
7360.00	7410.00	Blind Drilling (std)	Projection to bit	PALYO 3-11 AWB



Actual Wellpath Report

PALYO 3-11 AWP

Page 5 of 5



REFERENCE WELLPATH IDENTIFICATION

Operator	KERR MCGEE OIL & GAS ONSHORE LP	Slot	SLOT#17 PALYO 3-11 (1058'FNL & 1370'FWL)
Area	COLORADO	Well	PALYO 3-11
Field	WELD COUNTY (KERR MCGEE)	Wellbore	PALYO 3-11 AWB
Facility	SEC.11-T2N-R65W		

WELLPATH COMMENTS

MD [ft]	Inclination [°]	Azimuth [°]	TVD [ft]	Comment
7360.00	0.700	194.900	7248.87	LAST BHI MWD SURVEY
7410.00	0.700	194.900	7298.87	PROJECTION TO BIT