

# MULTI-WELL PLAN

## WELLSITE/PRODUCTION EQUIPMENT LAYOUT

OPERATOR: Pioneer Natural Resources

WELL NAME: Talon 34-25 TR

SWSE of SECTION 25 TOWNSHIP 32 S, RANGE 68 W OF THE 6TH P.M., IN LAS ANIMAS COUNTY

RECEIVED

JUN 01 2011

COGCC

Note: See Well Plat for precise location within section

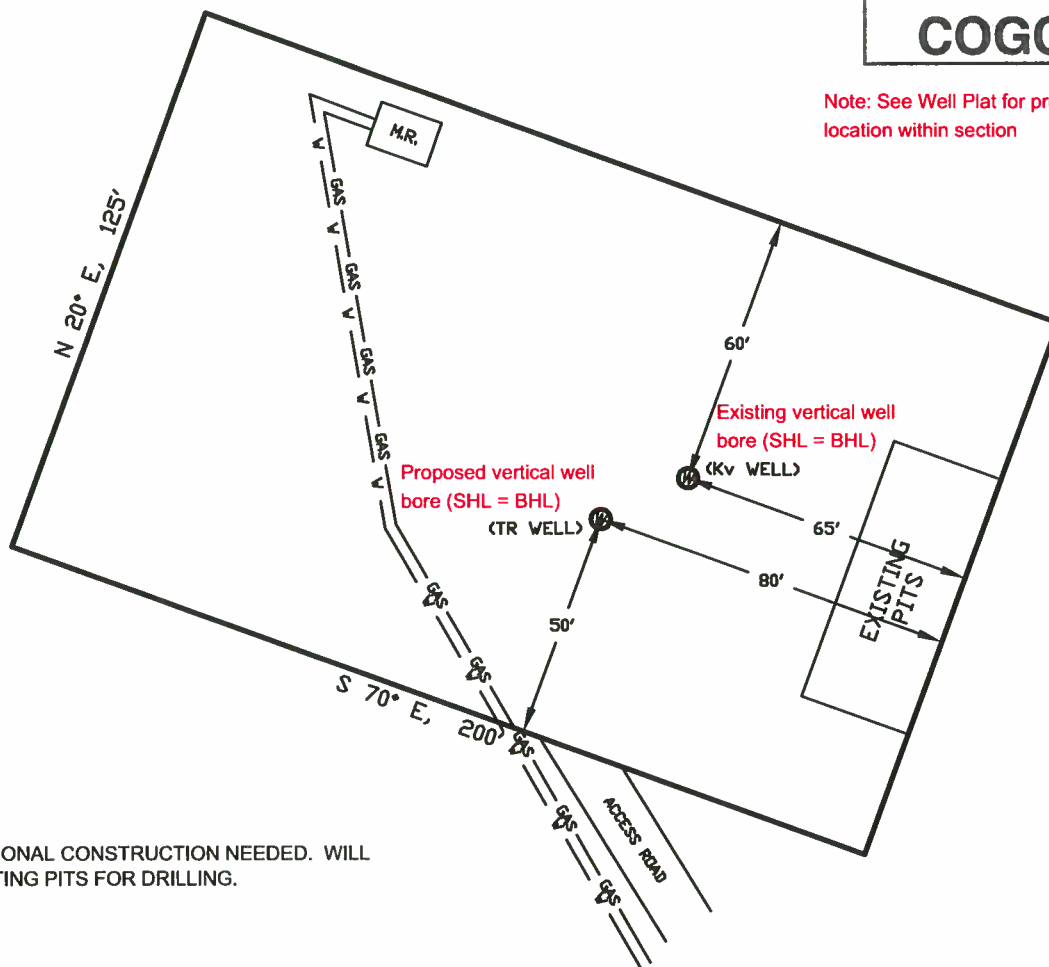

### NOTE:

NO ADDITIONAL CONSTRUCTION NEEDED. WILL USE EXISTING PITS FOR DRILLING.

### NOTE:

MUD AND BLOW PITS WILL BE CONVERTED TO LINED EVAPORATION PITS FOR PRODUCTION.

WELLHEADS ARE TYPICALLY PCP DRIVE HEADS

### LEGEND:

- = WELLHEAD
- = EXISTING WELLPAD
- = FENCE (4 STRAND)
- = 4" GAS GATHERING LINE
- = 2" WATER LINE
- M.R. = COMBO METER RUN AND WATER/GAS SEPARATOR
- G.D.S. = GAS DRIVE SYSTEM

### GRAPHIC SCALE

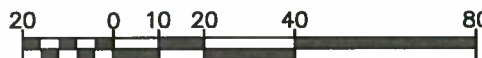

( IN FEET )

1 inch = 40 ft.

September 21, 2010

Date Platted

SHIELDS SURVEY L<sup>td.</sup> C<sup>o.</sup>  
Raton, New Mexico 87740  
(575)445-1232