

US ROCKIES REGION PLANNING

COLORADO NORTHERN ZONE - 83

WELD_WEISS PAD

WEISS 31N-33HZ

WEISS 31N-33HZ

Plan: WEISS 31N-33HZ (wp02)

Standard Planning Report

08 December, 2011

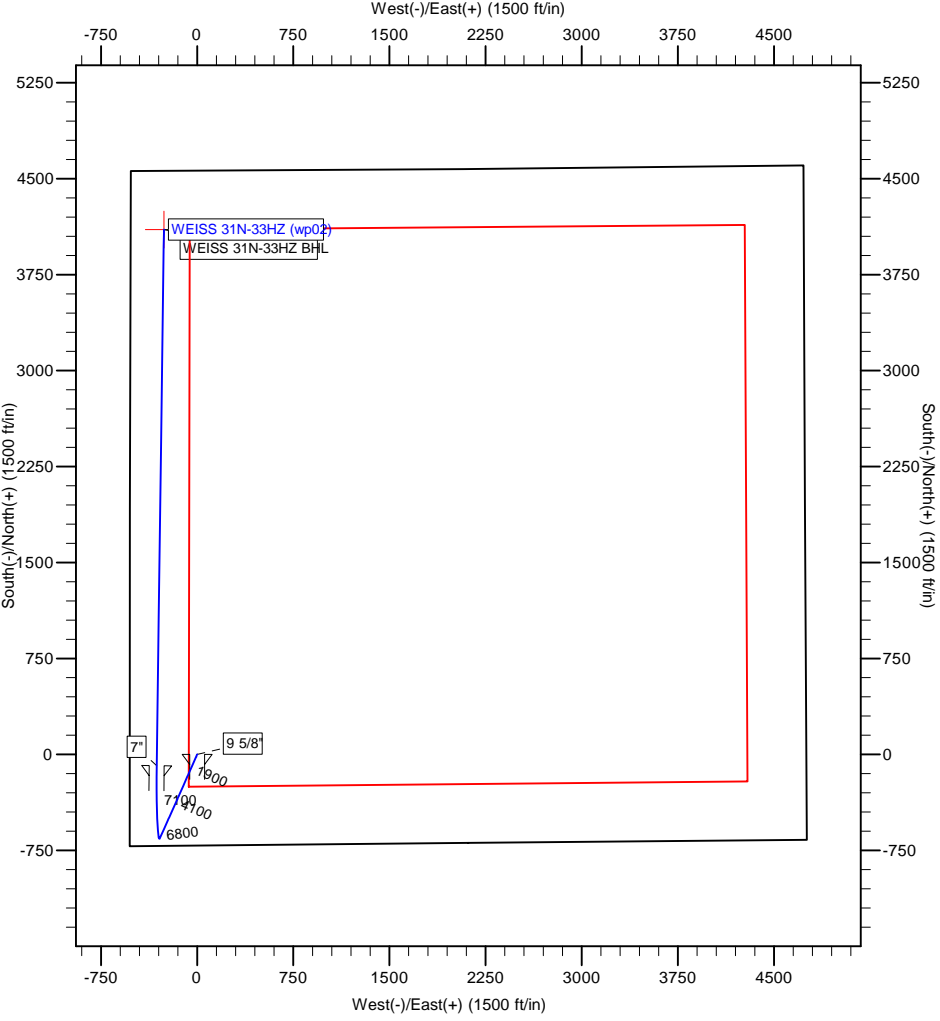

Azimuths to True North
Magnetic North: 8.82°

Magnetic Field
Strength: 52984.3snT
Dip Angle: 66.86°
Date: 9/13/2011
Model: IGRF2010



Project: COLORADO NORTHERN ZONE - 83
Site: WELD WEISS PAD
Well: WEISS 31N-33HZ
Wellbore: WEISS 31N-33HZ
Section: SHL
Design: WEISS 31N-33HZ (wp02)
Latitude: 40.176155
Longitude: -104.789747
GL: 4914.01
KB: 17' RKB + 4914' GL @ 4931.01ft

WELL DETAILS: WEISS 31N-33HZ						
+N/-S	+E/-W	Northing	Ground Level: Easting	4914.01 Latitude	Longitude	Slot
0.00	0.00	1307810.95	3198463.83	40.176155	-104.789747	

SECTION DETAILS								
MD	Inc	Azi	TVD	+N/-S	+E/-W	Dleg	TFace	VSect
0.00	0.00	0.00	0.00	0.00	0.00	0.00	0.00	0.00
850.00	0.00	0.00	850.00	0.00	0.00	0.00	0.00	0.00
1222.31	7.45	203.91	1221.26	-22.09	-9.79	2.00	203.91	-21.42
6572.79	7.45	203.91	6526.63	-655.98	-290.79	0.00	0.00	-636.31
7537.96	89.67	0.76	7167.01	-90.00	-316.00	10.00	156.69	-69.86
7539.12	89.67	0.77	7167.02	-88.84	-315.98	1.00	90.00	-68.70
11729.87	89.67	0.77	7191.01	4101.47	-259.55	0.00	0.00	4109.67

WELLBORE TARGET DETAILS (MAP CO-ORDINATES AND LAT/LONG)							
Name	TVD	+N/-S	+E/-W	Latitude	Longitude	Shape	
WEISS 31N-33HZ BHL	7191.01	4101.47	-259.55	40.187414	-104.790676	Point	

FORMATION TOP DETAILS		
TVDPath	MDPath	Formation
3125.01	3142.24	PARKMAN
4377.01	4404.89	SUSSEX
7041.01	7153.65	SHARON SPRINGS
7113.01	7290.30	NIOBRARA

CASING DETAILS			
TVD	MD	Name	Size
700.00	700.00	9 5/8"	9-5/8
7167.02	7539.12	7"	7

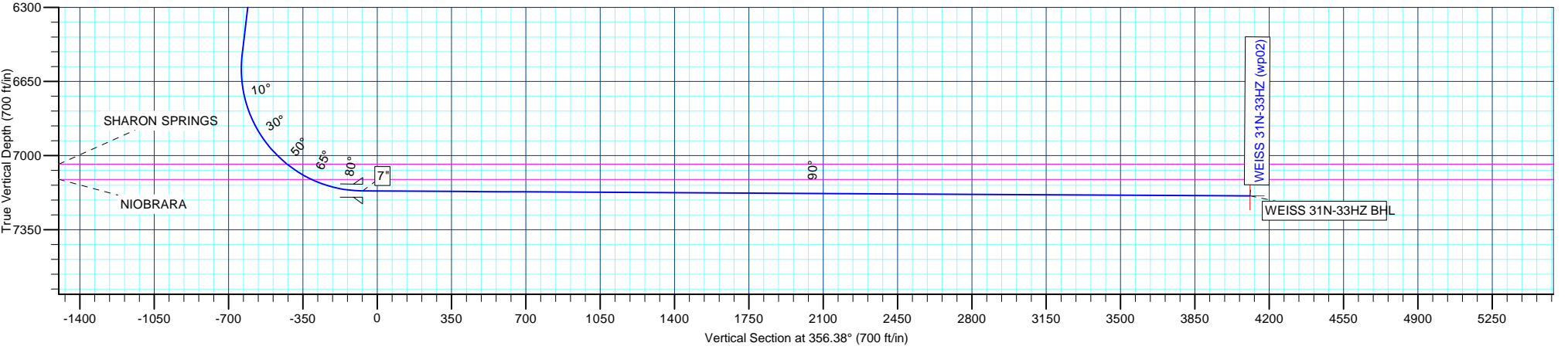

Anadarko Petroleum Corp

Planning Report

Database:	edmp	Local Co-ordinate Reference:	Well WEISS 31N-33HZ
Company:	US ROCKIES REGION PLANNING	TVD Reference:	17' RKB + 4914' GL @ 4931.01ft
Project:	COLORADO NORTHERN ZONE - 83	MD Reference:	17' RKB + 4914' GL @ 4931.01ft
Site:	WELD_WEISS PAD	North Reference:	True
Well:	WEISS 31N-33HZ	Survey Calculation Method:	Minimum Curvature
Wellbore:	WEISS 31N-33HZ		
Design:	WEISS 31N-33HZ (wp02)		

Project	COLORADO NORTHERN ZONE - 83		
Map System:	US State Plane 1983	System Datum:	Mean Sea Level
Geo Datum:	North American Datum 1983		
Map Zone:	Colorado Northern Zone		

Site	WELD_WEISS PAD			
Site Position:		Northing:	1,307,811.68 usft	Latitude: 40.176156
From:	Lat/Long	Easting:	3,198,507.98 usft	Longitude: -104.789589
Position Uncertainty:	0.00 ft	Slot Radius:	0 "	Grid Convergence: 0.46 °

Well	WEISS 31N-33HZ			
Well Position	+N/-S	-0.37 ft	Northing:	1,307,810.95 usft
	+E/-W	-44.15 ft	Easting:	3,198,463.84 usft
Position Uncertainty		0.00 ft	Wellhead Elevation:	Latitude: 40.176155
				Longitude: -104.789747
				Ground Level: 4,914.01 ft

Wellbore	WEISS 31N-33HZ				
Magnetics	Model Name	Sample Date	Declination (°)	Dip Angle (°)	Field Strength (nT)
	IGRF2010	9/13/2011	8.82	66.86	52,984

Design	WEISS 31N-33HZ (wp02)			
Audit Notes:				
Version:	Phase:	PLAN	Tie On Depth:	0.00
Vertical Section:	Depth From (TVD)	+N/-S (ft)	+E/-W (ft)	Direction (°)
	0.00	0.00	0.00	356.38

Plan Sections										
Measured Depth (ft)	Inclination (°)	Azimuth (°)	Vertical Depth (ft)	+N/-S (ft)	+E/-W (ft)	Dogleg Rate (°/100usft)	Build Rate (°/100usft)	Turn Rate (°/100usft)	TFO (°)	Target
0.00	0.00	0.00	0.00	0.00	0.00	0.00	0.00	0.00	0.00	
850.00	0.00	0.00	850.00	0.00	0.00	0.00	0.00	0.00	0.00	
1,222.31	7.45	203.91	1,221.26	-22.09	-9.79	2.00	2.00	0.00	203.91	
6,572.79	7.45	203.91	6,526.63	-655.98	-290.79	0.00	0.00	0.00	0.00	
7,537.96	89.67	0.76	7,167.01	-90.00	-316.00	10.00	8.52	16.25	156.69	
7,539.12	89.67	0.77	7,167.02	-88.84	-315.98	1.00	0.00	1.00	90.00	
11,729.87	89.67	0.77	7,191.01	4,101.47	-259.55	0.00	0.00	0.00	0.00	WEISS 31N-33HZ BH

Anadarko Petroleum Corp

Planning Report

Database:	edmp	Local Co-ordinate Reference:	Well WEISS 31N-33HZ
Company:	US ROCKIES REGION PLANNING	TVD Reference:	17' RKB + 4914' GL @ 4931.01ft
Project:	COLORADO NORTHERN ZONE - 83	MD Reference:	17' RKB + 4914' GL @ 4931.01ft
Site:	WELD_WEISS PAD	North Reference:	True
Well:	WEISS 31N-33HZ	Survey Calculation Method:	Minimum Curvature
Wellbore:	WEISS 31N-33HZ		
Design:	WEISS 31N-33HZ (wp02)		

Planned Survey									
Measured Depth (ft)	Inclination (°)	Azimuth (°)	Vertical Depth (ft)	+N/-S (ft)	+E/-W (ft)	Vertical Section (ft)	Dogleg Rate (°/100usft)	Build Rate (°/100usft)	Turn Rate (°/100usft)
0.00	0.00	0.00	0.00	0.00	0.00	0.00	0.00	0.00	0.00
100.00	0.00	0.00	100.00	0.00	0.00	0.00	0.00	0.00	0.00
200.00	0.00	0.00	200.00	0.00	0.00	0.00	0.00	0.00	0.00
300.00	0.00	0.00	300.00	0.00	0.00	0.00	0.00	0.00	0.00
400.00	0.00	0.00	400.00	0.00	0.00	0.00	0.00	0.00	0.00
500.00	0.00	0.00	500.00	0.00	0.00	0.00	0.00	0.00	0.00
600.00	0.00	0.00	600.00	0.00	0.00	0.00	0.00	0.00	0.00
700.00	0.00	0.00	700.00	0.00	0.00	0.00	0.00	0.00	0.00
9 5/8"									
800.00	0.00	0.00	800.00	0.00	0.00	0.00	0.00	0.00	0.00
850.00	0.00	0.00	850.00	0.00	0.00	0.00	0.00	0.00	0.00
Start Build 2.00									
900.00	1.00	203.91	900.00	-0.40	-0.18	-0.39	2.00	2.00	0.00
1,000.00	3.00	203.91	999.93	-3.59	-1.59	-3.48	2.00	2.00	0.00
1,100.00	5.00	203.91	1,099.68	-9.97	-4.42	-9.67	2.00	2.00	0.00
1,200.00	7.00	203.91	1,199.13	-19.52	-8.65	-18.94	2.00	2.00	0.00
1,222.31	7.45	203.91	1,221.26	-22.09	-9.79	-21.42	2.00	2.00	0.00
Start 5350.48 hold at 1222.31 MD									
1,300.00	7.45	203.91	1,298.30	-31.29	-13.87	-30.35	0.00	0.00	0.00
1,400.00	7.45	203.91	1,397.45	-43.14	-19.12	-41.84	0.00	0.00	0.00
1,500.00	7.45	203.91	1,496.61	-54.99	-24.37	-53.34	0.00	0.00	0.00
1,600.00	7.45	203.91	1,595.77	-66.83	-29.63	-64.83	0.00	0.00	0.00
1,700.00	7.45	203.91	1,694.92	-78.68	-34.88	-76.32	0.00	0.00	0.00
1,800.00	7.45	203.91	1,794.08	-90.53	-40.13	-87.81	0.00	0.00	0.00
1,900.00	7.45	203.91	1,893.24	-102.38	-45.38	-99.30	0.00	0.00	0.00
2,000.00	7.45	203.91	1,992.39	-114.22	-50.63	-110.80	0.00	0.00	0.00
2,100.00	7.45	203.91	2,091.55	-126.07	-55.89	-122.29	0.00	0.00	0.00
2,200.00	7.45	203.91	2,190.71	-137.92	-61.14	-133.78	0.00	0.00	0.00
2,300.00	7.45	203.91	2,289.86	-149.77	-66.39	-145.27	0.00	0.00	0.00
2,400.00	7.45	203.91	2,389.02	-161.61	-71.64	-156.77	0.00	0.00	0.00
2,500.00	7.45	203.91	2,488.18	-173.46	-76.89	-168.26	0.00	0.00	0.00
2,600.00	7.45	203.91	2,587.34	-185.31	-82.15	-179.75	0.00	0.00	0.00
2,700.00	7.45	203.91	2,686.49	-197.16	-87.40	-191.24	0.00	0.00	0.00
2,800.00	7.45	203.91	2,785.65	-209.00	-92.65	-202.73	0.00	0.00	0.00
2,900.00	7.45	203.91	2,884.81	-220.85	-97.90	-214.23	0.00	0.00	0.00
3,000.00	7.45	203.91	2,983.96	-232.70	-103.15	-225.72	0.00	0.00	0.00
3,100.00	7.45	203.91	3,083.12	-244.55	-108.41	-237.21	0.00	0.00	0.00
3,142.24	7.45	203.91	3,125.01	-249.55	-110.62	-242.07	0.00	0.00	0.00
PARKMAN									
3,200.00	7.45	203.91	3,182.28	-256.39	-113.66	-248.70	0.00	0.00	0.00
3,300.00	7.45	203.91	3,281.43	-268.24	-118.91	-260.20	0.00	0.00	0.00
3,400.00	7.45	203.91	3,380.59	-280.09	-124.16	-271.69	0.00	0.00	0.00
3,500.00	7.45	203.91	3,479.75	-291.94	-129.41	-283.18	0.00	0.00	0.00
3,600.00	7.45	203.91	3,578.90	-303.78	-134.66	-294.67	0.00	0.00	0.00
3,700.00	7.45	203.91	3,678.06	-315.63	-139.92	-306.16	0.00	0.00	0.00
3,800.00	7.45	203.91	3,777.22	-327.48	-145.17	-317.66	0.00	0.00	0.00
3,900.00	7.45	203.91	3,876.37	-339.33	-150.42	-329.15	0.00	0.00	0.00
4,000.00	7.45	203.91	3,975.53	-351.17	-155.67	-340.64	0.00	0.00	0.00
4,100.00	7.45	203.91	4,074.69	-363.02	-160.92	-352.13	0.00	0.00	0.00
4,200.00	7.45	203.91	4,173.84	-374.87	-166.18	-363.62	0.00	0.00	0.00
4,300.00	7.45	203.91	4,273.00	-386.72	-171.43	-375.12	0.00	0.00	0.00
4,400.00	7.45	203.91	4,372.16	-398.56	-176.68	-386.61	0.00	0.00	0.00
4,404.89	7.45	203.91	4,377.01	-399.14	-176.94	-387.17	0.00	0.00	0.00
SUSSEX									

Anadarko Petroleum Corp

Planning Report

Database:	edmp	Local Co-ordinate Reference:	Well WEISS 31N-33HZ
Company:	US ROCKIES REGION PLANNING	TVD Reference:	17' RKB + 4914' GL @ 4931.01ft
Project:	COLORADO NORTHERN ZONE - 83	MD Reference:	17' RKB + 4914' GL @ 4931.01ft
Site:	WELD_WEISS PAD	North Reference:	True
Well:	WEISS 31N-33HZ	Survey Calculation Method:	Minimum Curvature
Wellbore:	WEISS 31N-33HZ		
Design:	WEISS 31N-33HZ (wp02)		

Planned Survey									
Measured Depth (ft)	Inclination (°)	Azimuth (°)	Vertical Depth (ft)	+N/-S (ft)	+E/-W (ft)	Vertical Section (ft)	Dogleg Rate (°/100usft)	Build Rate (°/100usft)	Turn Rate (°/100usft)
4,500.00	7.45	203.91	4,471.31	-410.41	-181.93	-398.10	0.00	0.00	0.00
4,600.00	7.45	203.91	4,570.47	-422.26	-187.18	-409.59	0.00	0.00	0.00
4,700.00	7.45	203.91	4,669.63	-434.11	-192.44	-421.09	0.00	0.00	0.00
4,800.00	7.45	203.91	4,768.78	-445.95	-197.69	-432.58	0.00	0.00	0.00
4,900.00	7.45	203.91	4,867.94	-457.80	-202.94	-444.07	0.00	0.00	0.00
5,000.00	7.45	203.91	4,967.10	-469.65	-208.19	-455.56	0.00	0.00	0.00
5,100.00	7.45	203.91	5,066.25	-481.50	-213.44	-467.05	0.00	0.00	0.00
5,200.00	7.45	203.91	5,165.41	-493.34	-218.70	-478.55	0.00	0.00	0.00
5,300.00	7.45	203.91	5,264.57	-505.19	-223.95	-490.04	0.00	0.00	0.00
5,400.00	7.45	203.91	5,363.72	-517.04	-229.20	-501.53	0.00	0.00	0.00
5,500.00	7.45	203.91	5,462.88	-528.89	-234.45	-513.02	0.00	0.00	0.00
5,600.00	7.45	203.91	5,562.04	-540.73	-239.70	-524.52	0.00	0.00	0.00
5,700.00	7.45	203.91	5,661.19	-552.58	-244.95	-536.01	0.00	0.00	0.00
5,800.00	7.45	203.91	5,760.35	-564.43	-250.21	-547.50	0.00	0.00	0.00
5,900.00	7.45	203.91	5,859.51	-576.28	-255.46	-558.99	0.00	0.00	0.00
6,000.00	7.45	203.91	5,958.66	-588.12	-260.71	-570.48	0.00	0.00	0.00
6,100.00	7.45	203.91	6,057.82	-599.97	-265.96	-581.98	0.00	0.00	0.00
6,200.00	7.45	203.91	6,156.98	-611.82	-271.21	-593.47	0.00	0.00	0.00
6,300.00	7.45	203.91	6,256.13	-623.67	-276.47	-604.96	0.00	0.00	0.00
6,400.00	7.45	203.91	6,355.29	-635.51	-281.72	-616.45	0.00	0.00	0.00
6,500.00	7.45	203.91	6,454.45	-647.36	-286.97	-627.94	0.00	0.00	0.00
6,572.79	7.45	203.91	6,526.63	-655.98	-290.79	-636.31	0.00	0.00	0.00
Start DLS 10.00 TFO 156.69									
6,600.00	5.06	216.20	6,553.67	-658.57	-292.22	-638.80	10.00	-8.76	45.17
6,700.00	6.57	334.29	6,653.40	-656.97	-297.32	-636.88	10.00	1.51	118.10
6,800.00	16.14	350.56	6,751.35	-638.06	-302.09	-617.71	10.00	9.57	16.26
6,900.00	26.03	354.74	6,844.54	-602.41	-306.39	-581.85	10.00	9.89	4.19
7,000.00	35.98	356.72	6,930.15	-551.10	-310.09	-530.41	10.00	9.95	1.98
7,100.00	45.95	357.93	7,005.57	-485.69	-313.08	-464.95	10.00	9.97	1.21
7,153.65	51.30	358.42	7,041.01	-445.47	-314.35	-424.73	10.00	9.98	0.91
SHARON SPRINGS									
7,200.00	55.93	358.79	7,068.51	-408.18	-315.26	-387.45	10.00	9.98	0.79
7,290.30	64.94	359.40	7,113.01	-329.73	-316.48	-309.08	10.00	9.98	0.68
NIOBRARA									
7,300.00	65.91	359.46	7,117.05	-320.90	-316.57	-300.27	10.00	9.98	0.62
7,400.00	75.90	0.04	7,149.73	-226.53	-316.96	-206.06	10.00	9.99	0.58
7,500.00	85.88	0.57	7,165.54	-127.92	-316.44	-107.68	10.00	9.99	0.53
7,537.96	89.67	0.76	7,167.01	-90.00	-316.00	-69.86	10.00	9.99	0.51
Start DLS 1.00 TFO 90.00									
7,539.12	89.67	0.77	7,167.02	-88.84	-315.98	-68.70	1.00	0.00	1.00
Start 4190.76 hold at 7539.12 MD - 7"									
7,600.00	89.67	0.77	7,167.37	-27.96	-315.16	-8.00	0.00	0.00	0.00
7,700.00	89.67	0.77	7,167.94	72.03	-313.82	91.70	0.00	0.00	0.00
7,800.00	89.67	0.77	7,168.51	172.02	-312.47	191.41	0.00	0.00	0.00
7,900.00	89.67	0.77	7,169.09	272.01	-311.12	291.11	0.00	0.00	0.00
8,000.00	89.67	0.77	7,169.66	372.00	-309.78	390.82	0.00	0.00	0.00
8,100.00	89.67	0.77	7,170.23	471.98	-308.43	490.52	0.00	0.00	0.00
8,200.00	89.67	0.77	7,170.80	571.97	-307.08	590.23	0.00	0.00	0.00
8,300.00	89.67	0.77	7,171.38	671.96	-305.74	689.93	0.00	0.00	0.00
8,400.00	89.67	0.77	7,171.95	771.95	-304.39	789.64	0.00	0.00	0.00
8,500.00	89.67	0.77	7,172.52	871.94	-303.04	889.34	0.00	0.00	0.00
8,600.00	89.67	0.77	7,173.10	971.93	-301.70	989.04	0.00	0.00	0.00
8,700.00	89.67	0.77	7,173.67	1,071.92	-300.35	1,088.75	0.00	0.00	0.00

Anadarko Petroleum Corp

Planning Report

Database:	edmp	Local Co-ordinate Reference:	Well WEISS 31N-33HZ
Company:	US ROCKIES REGION PLANNING	TVD Reference:	17' RKB + 4914' GL @ 4931.01ft
Project:	COLORADO NORTHERN ZONE - 83	MD Reference:	17' RKB + 4914' GL @ 4931.01ft
Site:	WELD_WEISS PAD	North Reference:	True
Well:	WEISS 31N-33HZ	Survey Calculation Method:	Minimum Curvature
Wellbore:	WEISS 31N-33HZ		
Design:	WEISS 31N-33HZ (wp02)		

Planned Survey										
Measured Depth (ft)	Inclination (°)	Azimuth (°)	Vertical Depth (ft)	+N/-S (ft)	+E/-W (ft)	Vertical Section (ft)	Dogleg Rate (°/100usft)	Build Rate (°/100usft)	Turn Rate (°/100usft)	
8,800.00	89.67	0.77	7,174.24	1,171.91	-299.00	1,188.45	0.00	0.00	0.00	
8,900.00	89.67	0.77	7,174.81	1,271.90	-297.66	1,288.16	0.00	0.00	0.00	
9,000.00	89.67	0.77	7,175.39	1,371.89	-296.31	1,387.86	0.00	0.00	0.00	
9,100.00	89.67	0.77	7,175.96	1,471.88	-294.96	1,487.57	0.00	0.00	0.00	
9,200.00	89.67	0.77	7,176.53	1,571.87	-293.62	1,587.27	0.00	0.00	0.00	
9,300.00	89.67	0.77	7,177.10	1,671.86	-292.27	1,686.98	0.00	0.00	0.00	
9,400.00	89.67	0.77	7,177.68	1,771.85	-290.92	1,786.68	0.00	0.00	0.00	
9,500.00	89.67	0.77	7,178.25	1,871.83	-289.58	1,886.39	0.00	0.00	0.00	
9,600.00	89.67	0.77	7,178.82	1,971.82	-288.23	1,986.09	0.00	0.00	0.00	
9,700.00	89.67	0.77	7,179.39	2,071.81	-286.88	2,085.80	0.00	0.00	0.00	
9,800.00	89.67	0.77	7,179.97	2,171.80	-285.54	2,185.50	0.00	0.00	0.00	
9,900.00	89.67	0.77	7,180.54	2,271.79	-284.19	2,285.21	0.00	0.00	0.00	
10,000.00	89.67	0.77	7,181.11	2,371.78	-282.84	2,384.91	0.00	0.00	0.00	
10,100.00	89.67	0.77	7,181.68	2,471.77	-281.50	2,484.61	0.00	0.00	0.00	
10,200.00	89.67	0.77	7,182.26	2,571.76	-280.15	2,584.32	0.00	0.00	0.00	
10,300.00	89.67	0.77	7,182.83	2,671.75	-278.80	2,684.02	0.00	0.00	0.00	
10,400.00	89.67	0.77	7,183.40	2,771.74	-277.46	2,783.73	0.00	0.00	0.00	
10,500.00	89.67	0.77	7,183.97	2,871.73	-276.11	2,883.43	0.00	0.00	0.00	
10,600.00	89.67	0.77	7,184.55	2,971.72	-274.76	2,983.14	0.00	0.00	0.00	
10,700.00	89.67	0.77	7,185.12	3,071.71	-273.42	3,082.84	0.00	0.00	0.00	
10,800.00	89.67	0.77	7,185.69	3,171.70	-272.07	3,182.55	0.00	0.00	0.00	
10,900.00	89.67	0.77	7,186.26	3,271.68	-270.72	3,282.25	0.00	0.00	0.00	
11,000.00	89.67	0.77	7,186.84	3,371.67	-269.38	3,381.96	0.00	0.00	0.00	
11,100.00	89.67	0.77	7,187.41	3,471.66	-268.03	3,481.66	0.00	0.00	0.00	
11,200.00	89.67	0.77	7,187.98	3,571.65	-266.68	3,581.37	0.00	0.00	0.00	
11,300.00	89.67	0.77	7,188.55	3,671.64	-265.34	3,681.07	0.00	0.00	0.00	
11,400.00	89.67	0.77	7,189.13	3,771.63	-263.99	3,780.77	0.00	0.00	0.00	
11,500.00	89.67	0.77	7,189.70	3,871.62	-262.64	3,880.48	0.00	0.00	0.00	
11,600.00	89.67	0.77	7,190.27	3,971.61	-261.30	3,980.18	0.00	0.00	0.00	
11,700.00	89.67	0.77	7,190.84	4,071.60	-259.95	4,079.89	0.00	0.00	0.00	
11,729.87	89.67	0.77	7,191.01	4,101.47	-259.55	4,109.67	0.00	0.00	0.00	
TD at 11729.87 - WEISS 31N-33HZ BHL										

Design Targets									
Target Name	Dip Angle (°)	Dip Dir. (°)	TVD (ft)	+N/-S (ft)	+E/-W (ft)	Northing (usft)	Easting (usft)	Latitude	Longitude
- hit/miss target									
- Shape									
WEISS 31N-33HZ BHL	0.00	0.00	7,191.01	4,101.47	-259.55	1,311,910.20	3,198,171.45	40.187414	-104.790676
- plan hits target center									
- Point									

Casing Points					
Measured Depth (ft)	Vertical Depth (ft)	Name	Casing Diameter (")	Hole Diameter (")	
700.00	700.00	9 5/8"	9-5/8	12-1/4	
7,539.12	7,167.02	7"	7	8-3/4	

Anadarko Petroleum Corp

Planning Report

Database:	edmp	Local Co-ordinate Reference:	Well WEISS 31N-33HZ
Company:	US ROCKIES REGION PLANNING	TVD Reference:	17' RKB + 4914' GL @ 4931.01ft
Project:	COLORADO NORTHERN ZONE - 83	MD Reference:	17' RKB + 4914' GL @ 4931.01ft
Site:	WELD_WEISS PAD	North Reference:	True
Well:	WEISS 31N-33HZ	Survey Calculation Method:	Minimum Curvature
Wellbore:	WEISS 31N-33HZ		
Design:	WEISS 31N-33HZ (wp02)		

Formations					
Measured Depth (ft)	Vertical Depth (ft)	Name	Lithology	Dip (°)	Dip Direction (°)
3,142.24	3,125.01	PARKMAN		0.00	
4,404.89	4,377.01	SUSSEX		0.00	
7,153.65	7,041.01	SHARON SPRINGS		0.00	
7,290.30	7,113.01	NIOBRARA		0.00	

Plan Annotations				
Measured Depth (ft)	Vertical Depth (ft)	Local Coordinates		Comment
		+N/-S (ft)	+E/-W (ft)	
850.00	850.00	0.00	0.00	Start Build 2.00
1,222.31	1,221.26	-22.09	-9.79	Start 5350.48 hold at 1222.31 MD
6,572.79	6,526.63	-655.98	-290.79	Start DLS 10.00 TFO 156.69
7,537.96	7,167.01	-90.00	-316.00	Start DLS 1.00 TFO 90.00
7,539.12	7,167.02	-88.84	-315.98	Start 4190.76 hold at 7539.12 MD
11,729.87	7,191.01	4,101.47	-259.55	TD at 11729.87