



KERR MCGEE OIL & GAS ONSHORE LP

Location: COLORADO Slot: SLOT#02 BRYANT 37-30 (284'FSL & 1296'FEL)
Field: WELD COUNTY (KERR MCGEE) Well: BRYANT 37-30
Facility: SEC.30-T2N-R68W Wellbore: BRYANT 37-30 PWB



Plot reference wellpath is BRYANT 37-30 (REV-A.0) PWB	Grid System: NAD83 / Lambert Colorado SP, Northern Zone (501), US feet
True vertical depths are referenced to XTREME 12 (RKB)	North Reference: True north
Measured depths are referenced to XTREME 12 (RKB)	Scale: True distance
XTREME 12 (RKB) to Mean Sea Level: 4943 feet	Depths are in feet
Mean Sea Level to Mud line (At Slot: SLOT#02 BRYANT 37-30 (284'FSL & 1296'FEL)): 0 feet	Coordinates are in feet referenced to Slot
Created by: cookdorm on 10/14/2011	

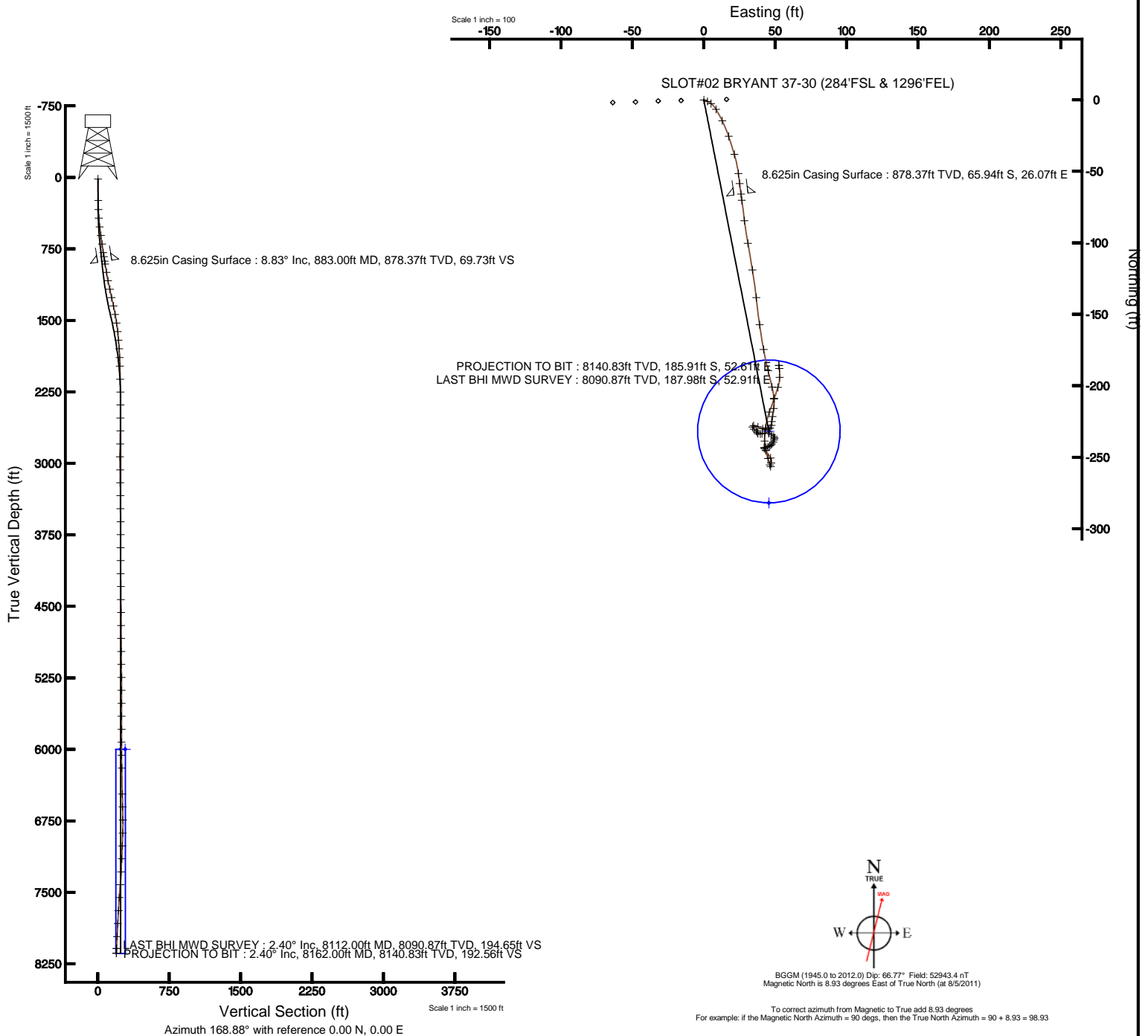



Actual Wellpath Report

BRYANT 37-30 AWP

Page 1 of 5



REFERENCE WELLPATH IDENTIFICATION

Operator	KERR MCGEE OIL & GAS ONSHORE LP	Slot	SLOT#02 BRYANT 37-30 (284'FSL & 1296'FEL)
Area	COLORADO	Well	BRYANT 37-30
Field	WELD COUNTY (KERR MCGEE)	Wellbore	BRYANT 37-30 AWB
Facility	SEC.30-T2N-R68W		

REPORT SETUP INFORMATION

Projection System	NAD83 / Lambert Colorado SP, Northern Zone (501), US feet	Software System	WellArchitect® 3.0.1
North Reference	True	User	Cookdanm
Scale	0.99996	Report Generated	10/14/2011 at 4:28:52 PM
Convergence at slot	0.30° East	Database/Source file	WA_Denver/BRYANT_37-30_AWB.xml

WELLPATH LOCATION

	Local coordinates		Grid coordinates		Geographic coordinates	
	North[ft]	East[ft]	Easting[US ft]	Northing[US ft]	Latitude	Longitude
Slot Location	-0.40	-15.93	3128259.39	1280720.70	40°06'11.016"N	105°02'29.353"W
Facility Reference Pt			3128275.31	1280721.19	40°06'11.020"N	105°02'29.148"W
Field Reference Pt			3197771.84	1268891.29	40°04'09.600"N	104°47'36.000"W

WELLPATH DATUM

Calculation method	Minimum curvature	XTREME 12 (RKB) to Facility Vertical Datum	4943.00ft
Horizontal Reference Pt	Slot	XTREME 12 (RKB) to Mean Sea Level	4943.00ft
Vertical Reference Pt	XTREME 12 (RKB)	XTREME 12 (RKB) to Mud Line at Slot (SLOT#02 BRYANT 37-30 (284'FSL & 1296'FEL))	4943.00ft
MD Reference Pt	XTREME 12 (RKB)	Section Origin	N 0.00, E 0.00 ft
Field Vertical Reference	Mean Sea Level	Section Azimuth	168.88°



Actual Wellpath Report

BRYANT 37-30 AWP

Page 2 of 5



REFERENCE WELLPATH IDENTIFICATION

Operator	KERR MCGEE OIL & GAS ONSHORE LP	Slot	SLOT#02 BRYANT 37-30 (284'FSL & 1296'FEL)
Area	COLORADO	Well	BRYANT 37-30
Field	WELD COUNTY (KERR MCGEE)	Wellbore	BRYANT 37-30 AWB
Facility	SEC.30-T2N-R68W		

WELLPATH DATA (68 stations) † = interpolated/extrapolated station

MD [ft]	Inclination [°]	Azimuth [°]	TVD [ft]	Vert Sect [ft]	North [ft]	East [ft]	DLS [°/100ft]	Comments
0.00†	0.000	112.700	0.00	0.00	0.00	0.00	0.00	
15.00	0.000	112.700	15.00	0.00	0.00	0.00	0.00	
242.00	1.400	112.700	241.98	1.54	-1.07	2.56	0.62	
335.00	2.200	123.900	334.93	3.44	-2.50	5.09	0.94	
427.00	4.600	147.500	426.77	8.12	-6.60	8.54	2.97	
518.00	6.800	153.900	517.31	16.73	-14.52	12.87	2.51	
609.00	8.200	160.800	607.53	28.36	-25.49	17.37	1.83	
700.00	8.500	163.600	697.57	41.48	-38.07	21.41	0.56	
791.00	9.000	172.400	787.51	55.28	-51.57	24.25	1.57	
835.00	9.200	173.100	830.96	62.22	-58.48	25.12	0.52	
912.00	8.600	172.100	907.03	74.11	-70.29	26.65	0.80	
1002.00	9.700	173.100	995.89	88.39	-84.48	28.49	1.23	
1090.00	11.300	170.000	1082.41	104.41	-100.33	30.88	1.93	
1182.00	12.400	170.700	1172.45	123.29	-118.96	34.04	1.21	
1272.00	12.800	173.500	1260.28	142.89	-138.40	36.73	0.81	
1362.00	11.700	172.100	1348.23	161.94	-157.35	39.11	1.27	
1453.00	10.500	169.500	1437.53	179.44	-174.64	41.89	1.43	
1544.00	8.800	166.100	1527.24	194.69	-189.55	45.08	1.97	
1634.00	6.200	166.800	1616.46	206.42	-200.97	47.84	2.89	
1725.00	4.600	176.300	1707.05	214.95	-209.39	49.20	2.01	
1816.00	3.800	187.500	1797.81	221.43	-216.02	49.04	1.26	
1907.00	3.400	191.800	1888.63	226.77	-221.66	48.09	0.53	
1997.00	1.100	174.500	1978.56	230.09	-225.13	47.63	2.64	
2134.00	1.100	191.400	2115.53	232.61	-227.73	47.50	0.24	
2270.00	0.800	228.300	2251.51	234.30	-229.64	46.53	0.49	
2406.00	0.500	242.700	2387.51	234.95	-230.54	45.29	0.25	
2542.00	0.900	272.300	2523.50	234.87	-230.77	43.70	0.39	
2678.00	1.200	290.900	2659.47	233.86	-230.22	41.30	0.33	
2814.00	1.900	294.800	2795.42	231.79	-228.77	37.92	0.52	
2950.00	0.800	262.400	2931.38	230.40	-227.95	34.94	0.95	
3086.00	0.700	174.900	3067.38	231.17	-228.90	34.07	0.76	
3222.00	1.100	124.300	3203.36	232.93	-230.46	35.22	0.62	
3358.00	0.700	136.600	3339.34	234.56	-231.80	36.87	0.32	
3495.00	0.300	185.100	3476.34	235.61	-232.77	37.41	0.40	
3631.00	0.700	129.500	3612.33	236.60	-233.65	38.02	0.43	
3767.00	0.800	69.100	3748.32	237.08	-233.84	39.55	0.56	
3903.00	0.300	110.200	3884.32	237.10	-233.62	40.77	0.45	
4039.00	1.400	74.700	4020.30	237.17	-233.31	42.71	0.86	
4176.00	1.000	115.100	4157.27	237.75	-233.37	45.41	0.66	
4312.00	1.000	115.100	4293.25	239.15	-234.38	47.56	0.00	
4448.00	0.600	145.700	4429.24	240.51	-235.47	49.03	0.42	
4584.00	0.300	177.700	4565.24	241.51	-236.42	49.45	0.28	
4720.00	0.300	177.700	4701.23	242.22	-237.13	49.48	0.00	
4856.00	0.600	203.700	4837.23	243.15	-238.14	49.20	0.26	
4993.00	0.600	203.700	4974.22	244.33	-239.45	48.63	0.00	



Actual Wellpath Report

BRYANT 37-30 AWP

Page 3 of 5



REFERENCE WELLPATH IDENTIFICATION

Operator	KERR MCGEE OIL & GAS ONSHORE LP	Slot	SLOT#02 BRYANT 37-30 (284'FSL & 1296'FEL)
Area	COLORADO	Well	BRYANT 37-30
Field	WELD COUNTY (KERR MCGEE)	Wellbore	BRYANT 37-30 AWB
Facility	SEC.30-T2N-R68W		

WELLPATH DATA (68 stations)

MD [ft]	Inclination [°]	Azimuth [°]	TVD [ft]	Vert Sect [ft]	North [ft]	East [ft]	DLS [°/100ft]	Comments
5129.00	0.700	215.700	5110.21	245.49	-240.78	47.86	0.12	
5265.00	0.400	240.800	5246.21	246.20	-241.68	46.96	0.28	
5401.00	0.500	230.400	5382.20	246.63	-242.29	46.09	0.09	
5537.00	0.600	258.600	5518.20	246.92	-242.81	44.93	0.21	
5673.00	0.600	256.800	5654.19	246.95	-243.11	43.54	0.01	
5809.00	0.300	272.600	5790.19	246.89	-243.26	42.49	0.24	
5945.00	0.200	145.000	5926.18	247.02	-243.44	42.27	0.33	
6081.00	0.400	159.100	6062.18	247.71	-244.08	42.58	0.16	
6217.00	1.000	143.600	6198.17	249.25	-245.48	43.45	0.46	
6490.00	1.600	149.600	6471.10	255.00	-250.68	46.79	0.23	
6625.00	1.600	196.000	6606.05	258.46	-254.12	47.23	0.93	
6762.00	0.600	165.700	6743.03	260.87	-256.65	46.88	0.82	
6898.00	1.700	339.800	6879.01	259.59	-255.45	46.36	1.69	
7034.00	2.300	344.700	7014.93	254.88	-250.92	44.94	0.46	
7170.00	2.700	345.700	7150.80	248.96	-245.19	43.43	0.30	
7306.00	2.800	359.800	7286.64	242.50	-238.76	42.62	0.50	
7442.00	5.100	7.200	7422.31	233.50	-229.44	43.37	1.73	
7578.00	4.500	19.800	7557.84	223.18	-218.42	45.94	0.89	
7715.00	4.000	19.500	7694.46	214.46	-208.86	49.35	0.37	
7851.00	2.800	18.100	7830.22	207.48	-201.23	51.97	0.88	
7987.00	3.300	2.200	7966.03	200.77	-194.16	53.15	0.72	
8112.00	2.400	351.700	8090.87	194.65	-187.98	52.91	0.83	LAST BHI MWD SURVEY
8162.00	2.400	351.700	8140.83	192.56	-185.91	52.61	0.00	PROJECTION TO BIT

HOLE & CASING SECTIONS - Ref Wellbore: BRYANT 37-30 AWB Ref Wellpath: BRYANT 37-30 AWP

String/Diameter	Start MD [ft]	End MD [ft]	Interval [ft]	Start TVD [ft]	End TVD [ft]	Start N/S [ft]	Start E/W [ft]	End N/S [ft]	End E/W [ft]
12.25in Open Hole	15.00	883.00	868.00	15.00	878.37	0.00	0.00	-65.94	26.07
8.625in Casing Surface	15.00	883.00	868.00	15.00	878.37	0.00	0.00	-65.94	26.07
7.875in Open Hole	883.00	8162.00	7279.00	878.37	8140.83	-65.94	26.07	-185.91	52.61



Actual Wellpath Report

BRYANT 37-30 AWP

Page 4 of 5



REFERENCE WELLPATH IDENTIFICATION

Operator	KERR MCGEE OIL & GAS ONSHORE LP	Slot	SLOT#02 BRYANT 37-30 (284'FSL & 1296'FEL)
Area	COLORADO	Well	BRYANT 37-30
Field	WELD COUNTY (KERR MCGEE)	Wellbore	BRYANT 37-30 AWB
Facility	SEC.30-T2N-R68W		

TARGETS

Name	MD [ft]	TVD [ft]	North [ft]	East [ft]	Grid East [US ft]	Grid North [US ft]	Latitude	Longitude	Shape
BRYANT 37-30 GEO TARGET 50' RADIUS (50'FSL & 1250'FEL, REV-1)		6000.00	-232.03	45.61	3128306.20	1280488.91	40°06'08.723"N	105°02'28.766"W	circle
BRYANT 37-30 HARDLINE 50' OF GEO TARGET		6000.00	-282.05	45.58	3128306.42	1280438.90	40°06'08.229"N	105°02'28.766"W	point

WELLPATH COMPOSITION - Ref Wellbore: BRYANT 37-30 AWB Ref Wellpath: BRYANT 37-30 AWP

Start MD [ft]	End MD [ft]	Positional Uncertainty Model	Log Name/Comment	Wellbore
15.00	8112.00	NaviTrak (Standard)	BHI MWD SURVEYS <242-8112>	BRYANT 37-30 AWB
8112.00	8162.00	Blind Drilling (std)	Projection to bit	BRYANT 37-30 AWB



Actual Wellpath Report

BRYANT 37-30 AWP

Page 5 of 5

**REFERENCE WELLPATH IDENTIFICATION**

Operator	KERR MCGEE OIL & GAS ONSHORE LP	Slot	SLOT#02 BRYANT 37-30 (284'FSL & 1296'FEL)
Area	COLORADO	Well	BRYANT 37-30
Field	WELD COUNTY (KERR MCGEE)	Wellbore	BRYANT 37-30 AWB
Facility	SEC.30-T2N-R68W		

WELLPATH COMMENTS

MD [ft]	Inclination [°]	Azimuth [°]	TVD [ft]	Comment
8112.00	2.400	351.700	8090.87	LAST BHI MWD SURVEY
8162.00	2.400	351.700	8140.83	PROJECTION TO BIT