



KERR MCGEE OIL & GAS ONSHORE LP

Location: COLORADO Slot: SLOT#03 BRYANT 33-29 (284°FSL & 1312°FEL)
Field: WELD COUNTY (KERR MCGEE) Well: BRYANT 33-29
Facility: SEC.30-T2N-R68W Wellbore: BRYANT 33-29 PWB



Plot reference wellbore is BRYANT 33-29 (REV-A-D) PWB	
True vertical depths are referenced to XTREME 12 (RKB)	Grid System: NAD83 / Lambert Colorado SP, Northern Zone (501), US feet
Measured depths are referenced to XTREME 12 (RKB)	North Reference: True north
XTREME 12 (RKB) to Mean Sea Level: 4943 feet	Scale: True distance
Mean Sea Level to Mud line (At Slot SLOT#03 BRYANT 33-29 (284°FSL & 1312°FEL)): 0 feet	Depths are in feet
Coordinates are in feet referenced to Slot	Created by: cookdam on 10/14/2011

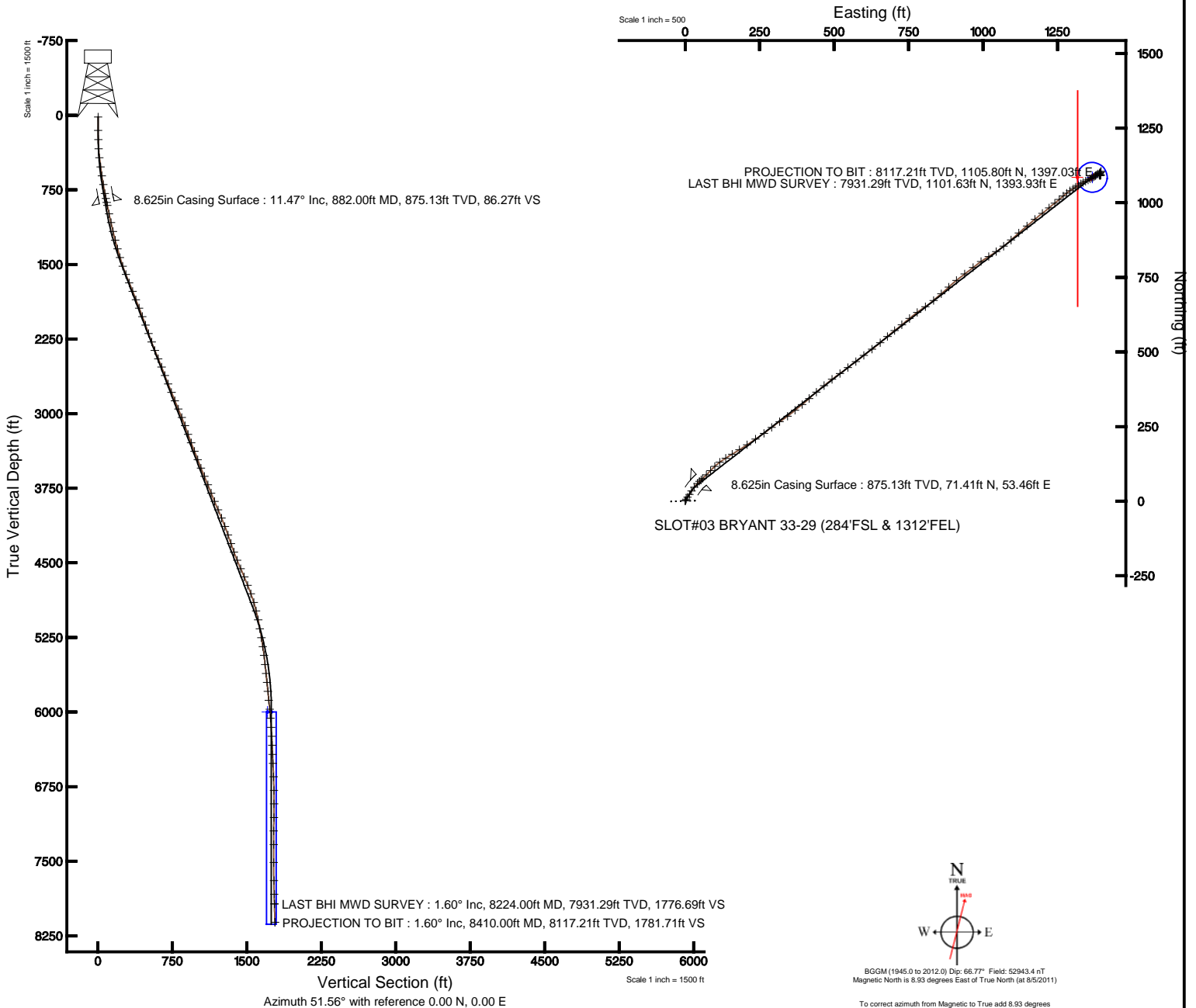



Actual Wellpath Report

BRYANT 33-29 AWP

Page 1 of 5



REFERENCE WELLPATH IDENTIFICATION

Operator	KERR MCGEE OIL & GAS ONSHORE LP	Slot	SLOT#03 BRYANT 33-29 (284'FSL & 1312'FEL)
Area	COLORADO	Well	BRYANT 33-29
Field	WELD COUNTY (KERR MCGEE)	Wellbore	BRYANT 33-29 AWB
Facility	SEC.30-T2N-R68W		

REPORT SETUP INFORMATION

Projection System	NAD83 / Lambert Colorado SP, Northern Zone (501), US feet	Software System	WellArchitect® 3.0.1
North Reference	True	User	Cookdanm
Scale	0.99996	Report Generated	10/14/2011 at 4:49:33 PM
Convergence at slot	0.30° East	Database/Source file	WA_Denver/BRYANT_33-29_AWB.xml

WELLPATH LOCATION

	Local coordinates		Grid coordinates		Geographic coordinates	
	North[ft]	East[ft]	Easting[US ft]	Northing[US ft]	Latitude	Longitude
Slot Location	-0.81	-31.86	3128243.46	1280720.21	40°06'11.012"N	105°02'29.558"W
Facility Reference Pt			3128275.31	1280721.19	40°06'11.020"N	105°02'29.148"W
Field Reference Pt			3197771.84	1268891.29	40°04'09.600"N	104°47'36.000"W

WELLPATH DATUM

Calculation method	Minimum curvature	XTREME 12 (RKB) to Facility Vertical Datum	4943.00ft
Horizontal Reference Pt	Slot	XTREME 12 (RKB) to Mean Sea Level	4943.00ft
Vertical Reference Pt	XTREME 12 (RKB)	XTREME 12 (RKB) to Mud Line at Slot (SLOT#03 BRYANT 33-29 (284'FSL & 1312'FEL))	4943.00ft
MD Reference Pt	XTREME 12 (RKB)	Section Origin	N 0.00, E 0.00 ft
Field Vertical Reference	Mean Sea Level	Section Azimuth	51.56°



Actual Wellpath Report

BRYANT 33-29 AWP

Page 2 of 5



REFERENCE WELLPATH IDENTIFICATION

Operator	KERR MCGEE OIL & GAS ONSHORE LP	Slot	SLOT#03 BRYANT 33-29 (284'FSL & 1312'FEL)
Area	COLORADO	Well	BRYANT 33-29
Field	WELD COUNTY (KERR MCGEE)	Wellbore	BRYANT 33-29 AWB
Facility	SEC.30-T2N-R68W		

WELLPATH DATA (88 stations) † = interpolated/extrapolated station

MD [ft]	Inclination [°]	Azimuth [°]	TVD [ft]	Vert Sect [ft]	North [ft]	East [ft]	DLS [°/100ft]	Comments
0.00†	0.000	350.700	0.00	0.00	0.00	0.00	0.00	
15.00	0.000	350.700	15.00	0.00	0.00	0.00	0.00	
150.00	0.500	350.700	150.00	0.29	0.58	-0.10	0.37	
242.00	1.700	29.300	241.98	1.75	2.17	0.51	1.46	
335.00	3.800	33.200	334.87	5.95	5.95	2.87	2.27	
427.00	6.200	33.900	426.51	13.58	12.63	7.31	2.61	
518.00	8.300	33.200	516.78	24.49	22.20	13.65	2.31	
609.00	9.000	32.100	606.74	37.44	33.73	21.03	0.79	
700.00	10.500	37.800	696.43	52.21	46.31	29.89	1.96	
790.00	10.800	42.700	784.88	68.50	58.99	40.64	1.06	
842.00	11.300	46.900	835.92	78.39	66.05	47.66	1.82	
912.00	11.600	48.000	904.52	92.25	75.44	57.90	0.53	
999.00	12.200	45.500	989.65	110.13	87.74	70.96	0.91	
1090.00	12.700	43.400	1078.51	129.59	101.75	84.69	0.74	
1181.00	13.500	46.900	1167.15	150.08	116.27	99.32	1.24	
1271.00	14.500	53.900	1254.48	171.81	130.09	116.09	2.18	
1362.00	16.000	56.800	1342.27	195.68	143.67	135.79	1.85	
1453.00	16.700	59.600	1429.59	221.12	157.15	157.57	1.16	
1544.00	19.100	58.500	1516.18	248.85	171.55	181.54	2.66	
1634.00	21.300	56.400	1600.64	279.76	188.29	207.71	2.57	
1725.00	22.700	55.700	1685.01	313.74	207.34	235.99	1.57	
1816.00	21.500	54.300	1769.33	347.91	226.96	264.04	1.44	
1907.00	21.200	51.800	1854.08	381.02	246.87	290.51	1.05	
1997.00	21.300	56.800	1937.97	413.58	265.89	316.98	2.02	
2088.00	20.400	53.200	2023.02	445.89	284.44	343.51	1.72	
2179.00	20.300	50.400	2108.34	477.53	304.00	368.37	1.08	
2270.00	19.600	51.500	2193.88	508.57	323.56	392.48	0.87	
2361.00	20.300	46.900	2279.42	539.57	343.85	415.95	1.89	
2451.00	22.100	50.100	2363.33	572.06	365.38	440.34	2.38	
2542.00	21.900	50.400	2447.70	606.14	387.18	466.55	0.25	
2633.00	21.500	52.900	2532.26	639.78	408.06	492.93	1.11	
2724.00	21.200	54.600	2617.01	672.88	427.65	519.64	0.76	
2815.00	21.800	52.500	2701.68	706.21	447.47	546.46	1.07	
2906.00	21.500	52.900	2786.26	739.78	467.81	573.17	0.37	
2996.00	22.300	52.200	2869.77	773.34	488.23	599.81	0.94	
3087.00	22.900	53.600	2953.78	808.30	509.32	627.71	0.89	
3178.00	22.000	49.400	3037.89	843.03	530.92	654.90	2.02	
3268.00	20.200	49.400	3121.85	875.40	552.00	679.50	2.00	
3359.00	19.600	52.500	3207.42	906.36	571.52	703.54	1.33	
3450.00	20.700	49.700	3292.85	937.70	591.21	727.92	1.61	
3541.00	21.600	51.100	3377.72	970.53	612.13	753.22	1.13	
3632.00	21.100	52.900	3462.47	1003.65	632.53	779.32	0.91	
3723.00	21.900	56.400	3547.14	1036.94	651.81	806.52	1.66	
3814.00	23.100	49.700	3631.23	1071.70	672.75	834.28	3.11	
3904.00	21.600	49.700	3714.47	1105.90	694.88	860.38	1.67	



Actual Wellpath Report

BRYANT 33-29 AWP

Page 3 of 5



REFERENCE WELLPATH IDENTIFICATION			
Operator	KERR MCGEE OIL & GAS ONSHORE LP	Slot	SLOT#03 BRYANT 33-29 (284'FSL & 1312'FEL)
Area	COLORADO	Well	BRYANT 33-29
Field	WELD COUNTY (KERR MCGEE)	Wellbore	BRYANT 33-29 AWB
Facility	SEC.30-T2N-R68W		

WELLPATH DATA (88 stations)

MD [ft]	Inclination [°]	Azimuth [°]	TVD [ft]	Vert Sect [ft]	North [ft]	East [ft]	DLS [°/100ft]	Comments
3995.00	21.700	46.200	3799.05	1139.40	717.36	885.29	1.42	
4086.00	22.400	51.500	3883.40	1173.49	739.80	911.01	2.32	
4177.00	23.200	53.200	3967.29	1208.75	761.33	938.93	1.14	
4267.00	23.000	51.800	4050.08	1244.05	782.83	966.94	0.65	
4358.00	20.700	54.300	4134.54	1277.90	803.21	993.98	2.73	
4449.00	19.000	59.600	4220.13	1308.63	820.09	1019.82	2.72	
4540.00	19.500	55.000	4306.05	1338.46	836.30	1045.04	1.75	
4631.00	20.000	52.500	4391.70	1369.18	854.49	1069.83	1.08	
4721.00	22.100	47.300	4475.69	1401.46	875.34	1094.49	3.12	
4812.00	23.800	49.000	4559.49	1436.88	899.00	1120.93	2.00	
4903.00	23.100	49.400	4642.97	1473.06	922.66	1148.34	0.79	
4994.00	21.800	50.400	4727.07	1507.80	945.05	1174.91	1.49	
5085.00	19.400	52.500	4812.25	1539.81	965.02	1199.93	2.76	
5176.00	17.400	49.700	4898.60	1568.52	983.03	1222.30	2.40	
5266.00	14.300	52.200	4985.16	1593.09	998.55	1241.35	3.53	
5357.00	11.600	48.700	5073.84	1613.47	1011.48	1257.11	3.09	
5448.00	10.100	48.700	5163.21	1630.58	1022.78	1269.97	1.65	
5539.00	9.200	51.800	5252.93	1645.82	1032.55	1281.69	1.14	
5630.00	8.400	57.100	5342.86	1659.71	1040.66	1292.98	1.25	
5720.00	7.500	58.500	5431.99	1672.09	1047.30	1303.51	1.02	
5811.00	5.500	55.700	5522.40	1682.33	1052.86	1312.18	2.22	
5902.00	7.100	58.900	5612.85	1692.26	1058.22	1320.60	1.80	
5993.00	5.600	54.600	5703.29	1702.27	1063.70	1329.03	1.73	
6083.00	5.800	61.700	5792.84	1711.14	1068.40	1336.62	0.81	
6174.00	6.400	64.800	5883.33	1720.60	1072.74	1345.25	0.75	
6265.00	5.400	63.100	5973.85	1729.73	1076.83	1353.66	1.12	
6355.00	4.400	60.300	6063.52	1737.29	1080.46	1360.44	1.14	
6446.00	3.800	60.300	6154.28	1743.72	1083.68	1366.09	0.66	
6537.00	3.200	63.100	6245.11	1749.19	1086.33	1370.97	0.69	
6628.00	2.900	57.100	6335.98	1753.97	1088.73	1375.17	0.48	
6719.00	2.700	54.900	6426.87	1758.40	1091.21	1378.86	0.25	
6809.00	2.500	53.900	6516.78	1762.48	1093.59	1382.18	0.23	
6946.00	2.500	52.200	6653.65	1768.45	1097.18	1386.95	0.05	
7082.00	2.700	120.700	6789.54	1772.56	1097.36	1392.05	2.15	
7218.00	1.700	143.200	6925.44	1773.64	1094.11	1396.02	0.96	
7354.00	1.000	246.600	7061.42	1772.44	1092.02	1396.13	1.59	
7490.00	1.100	272.600	7197.40	1770.31	1091.61	1393.74	0.35	
7627.00	0.500	315.500	7334.38	1769.25	1092.10	1392.01	0.59	
7808.00	0.800	351.000	7515.37	1769.79	1093.91	1391.26	0.27	
7990.00	1.200	16.300	7697.34	1771.97	1096.99	1391.59	0.32	
8126.00	1.200	27.200	7833.31	1774.43	1099.62	1392.64	0.17	
8224.00	1.600	36.700	7931.29	1776.69	1101.63	1393.93	0.47	LAST BHI MWD SURVEY
8410.00	1.600	36.700	8117.21	1781.71	1105.80	1397.03	0.00	PROJECTION TO BIT



Actual Wellpath Report

BRYANT 33-29 AWP

Page 4 of 5



REFERENCE WELLPATH IDENTIFICATION

Operator	KERR MCGEE OIL & GAS ONSHORE LP	Slot	SLOT#03 BRYANT 33-29 (284'FSL & 1312'FEL)
Area	COLORADO	Well	BRYANT 33-29
Field	WELD COUNTY (KERR MCGEE)	Wellbore	BRYANT 33-29 AWB
Facility	SEC.30-T2N-R68W		

HOLE & CASING SECTIONS - Ref Wellbore: BRYANT 33-29 AWB Ref Wellpath: BRYANT 33-29 AWP

String/Diameter	Start MD [ft]	End MD [ft]	Interval [ft]	Start TVD [ft]	End TVD [ft]	Start N/S [ft]	Start E/W [ft]	End N/S [ft]	End E/W [ft]
12.25in Open Hole	15.00	897.00	882.00	15.00	889.83	0.00	0.00	73.43	55.67
8.625in Casing Surface	15.00	882.00	867.00	15.00	875.13	0.00	0.00	71.41	53.46
7.875in Open Hole	882.00	8410.00	7528.00	875.13	8117.21	71.41	53.46	1105.80	1397.03

TARGETS

Name	MD [ft]	TVD [ft]	North [ft]	East [ft]	Grid East [US ft]	Grid North [US ft]	Latitude	Longitude	Shape
BRYANT 33-29 GEO TARGET 50' RADIUS (1330'FSL & 50'FWL, REV-1)		6000.00	1085.63	1367.57	3129605.34	1281812.86	40°06'21.740"N	105°02'11.958"W	circle
BRYANT 33-29 HARDLINE 50'W OF GEO TARGET		6000.00	1085.67	1317.57	3129555.34	1281812.64	40°06'21.740"N	105°02'12.601"W	point

WELLPATH COMPOSITION - Ref Wellbore: BRYANT 33-29 AWB Ref Wellpath: BRYANT 33-29 AWP

Start MD [ft]	End MD [ft]	Positional Uncertainty Model	Log Name/Comment	Wellbore
15.00	8224.00	NaviTrak (Standard)	BHI MWD SURVEYS <150-8224>	BRYANT 33-29 AWB
8224.00	8410.00	Blind Drilling (std)	Projection to bit	BRYANT 33-29 AWB



Actual Wellpath Report

BRYANT 33-29 AWP

Page 5 of 5

**REFERENCE WELLPATH IDENTIFICATION**

Operator	KERR MCGEE OIL & GAS ONSHORE LP	Slot	SLOT#03 BRYANT 33-29 (284'FSL & 1312'FEL)
Area	COLORADO	Well	BRYANT 33-29
Field	WELD COUNTY (KERR MCGEE)	Wellbore	BRYANT 33-29 AWB
Facility	SEC.30-T2N-R68W		

WELLPATH COMMENTS

MD [ft]	Inclination [°]	Azimuth [°]	TVD [ft]	Comment
8224.00	1.600	36.700	7931.29	LAST BHI MWD SURVEY
8410.00	1.600	36.700	8117.21	PROJECTION TO BIT