

RC LAND INC
14-8-67 1H
UNGRADED ELEVATION:
5296.7'

BASIS OF ELEVATION: USGS SPOT
 ELEVATION LOCATED AT THE NE
 CORNER SECTION 14, T8N, R67W,
 ELEVATION: 5281'

14

BHL
LATITUDE (NAD 83)
 NORTH 40.656047 DEG.
LONGITUDE (NAD 83)
 WEST 104.856524 DEG.
LATITUDE (NAD 27)
 NORTH 40.656066 DEG.
LONGITUDE (NAD 27)
 WEST 104.855997 DEG.

NORTHING
 482488
EASTING
 2178687

N 89°04'48" E 2555.37'
 N 89°02'24" E 2555.60'
 S 89°31'34" W 2576.10'
 S 89°30'52" W 2576.10'
 N 00°30'41" E 5281.63'
 S 00°03'44" W 2666.9'
 S 00°03'15" W 2660.94'
 (1277.80')
 (1277.80')
 (1288.05')
 (1288.05')
 1980'
 1980'
 600'
 250'

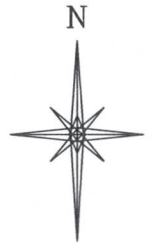

SCALE 1" = 1000'

T. 8 N.

RC LAND INC

14-8-67 1H

UNGRADED ELEVATION:

5296.7'

BASIS OF ELEVATION: USGS SPOT
ELEVATION LOCATED AT THE NE
CORNER SECTION 14, T8N, R67W,
ELEVATION: 5281'

LATITUDE (NAD 83)
NORTH 40.668276 DEG.
LONGITUDE (NAD 83)
WEST 104.856389 DEG.

LATITUDE (NAD 27)
NORTH 40.668295 DEG.
LONGITUDE (NAD 27)
WEST 104.855863 DEG.

NORTHING
486942.92

EASTING
2178692.07

BASIS OF
BEARING/DATUM
SPCS CO NORTH NAD 27
BASED ON
NGS TRIANGULATION
POINT "CP NW 12-8-67"

BHL
LATITUDE (NAD 83)
NORTH 40.656047 DEG.
LONGITUDE (NAD 83)
WEST 104.856524 DEG.

LATITUDE (NAD 27)
NORTH 40.656066 DEG.
LONGITUDE (NAD 27)
WEST 104.855997 DEG.

NORTHING
482488
EASTING
2178687

NOTES

PRIARIE LANDS
NO EXISTING FEATURES WITHIN
400' RADIUS OF WELL SITE.

GPS OPERATOR PAUL ORME
OBSERVED A PDOP OF 2.5.
ALL GPS OBSERVATIONS ARE IN
COMPLIANCE WITH COGCC RULE No.215.

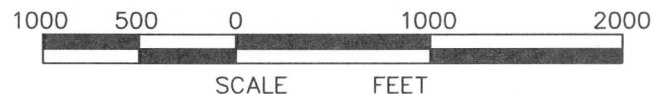



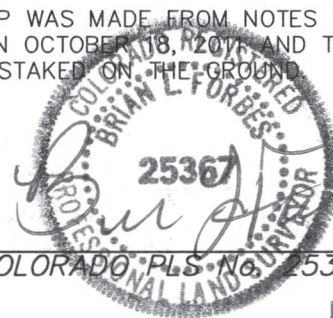

SURVEYOR'S STATEMENT

I, BRIAN L. FORBES, OF ROCK SPRINGS, WYOMING, HEREBY STATE: THIS MAP WAS MADE FROM NOTES TAKEN DURING AN ACTUAL FIELD SURVEY DONE UNDER MY DIRECT SUPERVISION ON OCTOBER 18, 2017, AND THAT THIS PLAT CORRECTLY SHOWS THE LOCATION OF RC LAND INC 14-8-67 1H AS STAKED ON THE GROUND.



LEGEND

-  WELL LOCATION
 BOTTOM HOLE LOC. (APPROX)
 FOUND MONUMENT
 PREVIOUSLY FOUND MONUMENT



RIFFIN & ASSOCIATES, INC.

(307) 362-5028

1414 ELK ST., ROCK SPRINGS, WY 82901

DRAWN: 10/31/11 - JMB

SCALE: 1" = 1000'

REVISED: NA

DRG JOB No. 18843

EXHIBIT 1

**PLAT OF DRILLING LOCATION
FOR
CHESAPEAKE ENERGY LLC.**

**250' F/NL & 1980' F/EL, NWNE, SECTION 14,
T. 8 N., R. 67 W., 6th P.M.
WELD COUNTY, COLORADO**