

State of Colorado
Oil and Gas Conservation Commission

1120 Lincoln Street, Suite 801, Denver, Colorado 80203 Phone: (303)894-2100 Fax: (303)894-2109



02221345

SUNDRY NOTICE

Submit original plus one copy. This form is to be used for general, technical and environmental sundry information. For proposed or completed operations, describe in full on Technical Information Page (Page 2 of this form.) Identify well or other facility by API Number or by OGCC Facility ID. Operator shall send an informational copy of all sundry notices for wells located in High Density Areas to the Local Government Designee (Rule 603b.)

Received
11/30/11

1. OGCC Operator Number: 2800	4. Contact Name: David H. Stephens	Complete the Attachment Checklist OP OGCC
2. Name of Operator: Anadarko E&P Company LP	Phone: 720-929-6363	
3. Address: 1099 18th Street, Suite 1800 City: Denver State: CO Zip: 80202	Fax: 720-929-7363	
5. API Number 05-123-33866	OGCC Facility ID Number	Survey Plat
6. Well/Facility Name: Christner	7. Well/Facility Number 8-66-5-3H	Directional Survey
8. Location (Qtr/Qtr, Sec, Twp, Rng, Meridian): SENW-5-8N-66W-6PM		Surface Eqpm Diagram
9. County: Weld	10. Field Name: Wildcat	Technical Info Page
11. Federal, Indian or State Lease Number: N/A		Other

General Notice

<input type="checkbox"/> CHANGE OF LOCATION: Attach New Survey Plat (a change of surface qtr/qtr is substantive and requires a new permit)	
Change of Surface Footage from Exterior Section Lines:	<input type="checkbox"/> FNU/FSL <input type="checkbox"/> FEL/FWL
Change of Surface Footage to Exterior Section Lines:	<input type="checkbox"/> <input type="checkbox"/>
Change of Bottomhole Footage from Exterior Section Lines:	<input type="checkbox"/> <input type="checkbox"/>
Change of Bottomhole Footage to Exterior Section Lines:	<input type="checkbox"/> attach directional survey
Bottomhole location Qtr/Qtr, Sec, Twp, Rng, Mer	
Latitude	Distance to nearest property line Distance to nearest bldg, public rd, utility or RR
Longitude	Distance to nearest lease line Is location in a High Density Area (rule 603b)? Yes/No
Ground Elevation	Distance to nearest well same formation Surface owner consultation date:
GPS DATA: Date of Measurement PDOP Reading Instrument Operator's Name	
<input type="checkbox"/> CHANGE SPACING UNIT Formation Formation Code Spacing order number Unit Acreage Unit configuration	<input type="checkbox"/> Remove from surface bond Signed surface use agreement attached
<input type="checkbox"/> CHANGE OF OPERATOR (prior to drilling): Effective Date: Plugging Bond: <input type="checkbox"/> Blanket <input type="checkbox"/> Individual	<input type="checkbox"/> CHANGE WELL NAME NUMBER From: To: Effective Date:
<input type="checkbox"/> ABANDONED LOCATION: Was location ever built? <input type="checkbox"/> Yes <input type="checkbox"/> No Is site ready for inspection? <input type="checkbox"/> Yes <input type="checkbox"/> No Date Ready for Inspection:	<input type="checkbox"/> NOTICE OF CONTINUED SHUT IN STATUS Date well shut in or temporarily abandoned: Has Production Equipment been removed from site? <input type="checkbox"/> Yes <input type="checkbox"/> No MIT required if shut in longer than two years. Date of last MIT
<input type="checkbox"/> SPUD DATE:	<input type="checkbox"/> REQUEST FOR CONFIDENTIAL STATUS (6 mos from date casing set)
<input type="checkbox"/> SUBSEQUENT REPORT OF STAGE, SQUEEZE OR REMEDIAL CEMENT WORK Method used Cementing tool setting/perf depth Cement volume Cement top Cement bottom Date *submit cbi and cement job summaries	
<input type="checkbox"/> RECLAMATION: Attach technical page describing final reclamation procedures per Rule 1004. Final reclamation will commence on approximately <input type="checkbox"/> Final reclamation is completed and site is ready for inspection.	

Technical Engineering/Environmental Notice

<input type="checkbox"/> Notice of Intent Approximate Start Date:	<input type="checkbox"/> Report of Work Done Date Work Completed:	
Details of work must be described in full on Technical Information Page (Page 2 must be submitted.)		
<input type="checkbox"/> Intent to Recomplete (submit form 2)	<input type="checkbox"/> Request to Vent or Flare	<input type="checkbox"/> E&P Waste Disposal
<input type="checkbox"/> Change Drilling Plans	<input type="checkbox"/> Repair Well	<input type="checkbox"/> Beneficial Reuse of E&P Waste
<input type="checkbox"/> Gross Interval Changed?	<input type="checkbox"/> Rule 502 variance requested	<input type="checkbox"/> Status Update/Change of Remediation Plans
<input type="checkbox"/> Casing/Cementing Program Change	<input checked="" type="checkbox"/> Other: Reserve pit closure	for Spills and Releases

I hereby certify that the statements made in this form are, to the best of my knowledge, true, correct and complete.

Signed: [Signature] Date: 11/22/11 Email: Dave.Stephens@anadarko.com
Print Name: David H. Stephens, P.G. Title: Environmental Manager/Rockies

COGCC Approved: [Signature] Title: 12/1/11 Date: CPSTV

CONDITIONS OF APPROVAL, IF ANY:

TECHNICAL INFORMATION PAGE



FOR OGCC USE ONLY

1. OGCC Operator Number: 2800 API Number: 05-123-33866
2. Name of Operator: Anadarko E&P Company LP OGCC Facility ID #
3. Well/Facility Name: Christner Well/Facility Number: 8-66-5-3H
4. Location (QtrQtr, Sec, Twp, Rng, Meridian): SENW-5-8N-66W-6PM

This form is to be completed whenever a Sundry Notice is submitted requiring detailed report of work to be performed or completed. This form shall be transmitted within 30 days of work completed as a "subsequent" report and must accompany Form 4, page 1.

5. DESCRIBE PROPOSED OR COMPLETED OPERATIONS

Anadarko E&P Company LP (Anadarko) has closed the reserve pits used to drill the surface hole for the Christner 8-66-5-3H well. The reserve pits were located on the Christner 8-66-5-3H pad site. Two background soil samples were collected (PitBG_Christner_C039_North and PitBG_Christner_C039_South) from the base of the reserve pits prior to the start of drilling activities and prior to introduction of drilling mud into the reserve pit. Background samples were analyzed for total arsenic and barium. Upon completion of the drilling activities, the drill mud was removed from the reserve pits and land applied at an approved facility. Two confirmatory soil samples (PitPost_Christner_C039_North and PitPost_Christner_C039_South) were collected from the base of the emptied reserve pit and submitted for laboratory analysis of total petroleum hydrocarbon (TPH), benzene, toluene, ethylbenzene, xylene (BTX), total arsenic and barium, and TCLP arsenic. Laboratory results confirm that all analyte levels were within COGCC allowable levels and/or below the background levels detected in PitBG_Christner_C039_North and PitBG_Christner_C039_South. Based on the laboratory results, Anadarko is requesting a no further action (NFA) status for the reserve pit. The laboratory reports and a table presenting the analytical results are included as attachments to this Form 4.

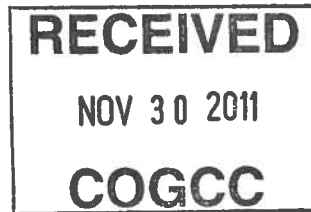

November 21, 2011

Mr. Steven Lindblom
East Environmental Supervisor
Colorado Oil and Gas Conservation Commission
1120 Lincoln Street, Suite 801
Denver, CO 80203

RE: No Further Action Closure Request for Surface Hole Drilling Mud Reserve Pits – Bellmore 9-66-15-5H, Christner 8-66-5-3H, Eichheim 9-66-19-14H, and Turner 8-66-17-4H, Weld County, CO

Dear Mr. Lindblom

Anadarko E&P Company, LP (Anadarko) requests no further action (NFA) status from the Colorado Oil and Gas Conservation Commission (COGCC) for four geographically related well sites in Weld County, Colorado: Bellmore 9-66-15-5H, Christner 8-66-5-3H, Eichheim 9-66-19-14H, and Turner 8-66-17-4H. The attached Form 4 Sundry notifications compare the background soil quality collected from the base of the reserve pits to the soil quality of the same pits collected after the drilling mud and associated cuttings were removed and properly disposed. For reference a map and table of the four locations with applicable analytical results are included.

Should you have any questions or require additional information please feel free to contact me at (720) 929-6363.

Sincerely,
Anadarko E&P Company LP

A handwritten signature in blue ink, appearing to read "David H. Stephens". The signature is stylized with a large, sweeping initial "D" and a long horizontal stroke at the end.

David H. Stephens, P.G.
EHS Manager

Attachments

ATTACHMENT 1



02221344

Page 1

Rev 12/05

State of Colorado

Oil and Gas Conservation Commission

1120 Lincoln Street, Suite 801, Denver, Colorado 80203 Phone: (303)894-2100 Fax: (303)894-2109



SUNDRY NOTICE

Submit original plus one copy. This form is to be used for general, technical and environmental sundry information. For proposed or completed operations, describe in full on Technical Information Page (Page 2 of this form.) Identify well or other facility by API Number or by OGCC Facility ID. Operator shall send an informational copy of all sundry notices for wells located in High Density Areas to the Local Government Designee (Rule 603b.)

AP
Revised
11/30/11

1. OGCC Operator Number: 2800	4. Contact Name: David H. Stephens	Complete the Attachment Checklist OP OGCC
2. Name of Operator: Anadarko E&P Company LP	Phone: 720-929-6363	
3. Address: 1099 18th Street, Suite 1800 City: Denver State: CO Zip: 80202	Fax: 720-929-7363	
5. API Number 05-123-33865	OGCC Facility ID Number	Survey Plat
6. Well/Facility Name: Bellmore	7. Well/Facility Number: 9-66-15-5H	Directional Survey
8. Location (Qtr/Sec, Twp, Rng, Meridian): SWNW-15-9N-66W		Surface Eqpm Diagram
9. County: Weld	10. Field Name: Wildcat	Technical Info Page
11. Federal, Indian or State Lease Number: N/A		Other

General Notice

<input type="checkbox"/> CHANGE OF LOCATION: Attach New Survey Plat (a change of surface qtr/qtr is substantive and requires a new permit)	
Change of Surface Footage from Exterior Section Lines:	<input type="checkbox"/> FNU/FSL <input type="checkbox"/> FEL/FWL
Change of Surface Footage to Exterior Section Lines:	<input type="checkbox"/> <input type="checkbox"/>
Change of Bottomhole Footage from Exterior Section Lines:	<input type="checkbox"/> <input type="checkbox"/>
Change of Bottomhole Footage to Exterior Section Lines:	<input type="checkbox"/> attach directional survey
Bottomhole location Qtr/Sec, Twp, Rng, Mer	
Latitude	Distance to nearest property line
Longitude	Distance to nearest bldg, public rd, utility or RR
Ground Elevation	Distance to nearest lease line
	Is location in a High Density Area (rule 603b)? Yes/No
	Distance to nearest well same formation
	Surface owner consultation date:
GPS DATA:	
Date of Measurement	PDOP Reading
	Instrument Operator's Name
<input type="checkbox"/> CHANGE SPACING UNIT	
Formation	Formation Code
Spacing order number	Unit Acreage
Unit configuration	
<input type="checkbox"/> Remove from surface bond	
Signed surface use agreement attached	
<input type="checkbox"/> CHANGE OF OPERATOR (prior to drilling):	
Effective Date:	
Plugging Bond: <input type="checkbox"/> Blanket <input type="checkbox"/> Individual	
<input type="checkbox"/> CHANGE WELL NAME	
From:	NUMBER
To:	
Effective Date:	
<input type="checkbox"/> ABANDONED LOCATION:	
Was location ever built? <input type="checkbox"/> Yes <input type="checkbox"/> No	
Is site ready for inspection? <input type="checkbox"/> Yes <input type="checkbox"/> No	
Date Ready for Inspection:	
<input type="checkbox"/> NOTICE OF CONTINUED SHUT IN STATUS	
Date well shut in or temporarily abandoned:	
Has Production Equipment been removed from site? <input type="checkbox"/> Yes <input type="checkbox"/> No	
MIT required if shut in longer than two years. Date of last MIT	
<input type="checkbox"/> SPUD DATE:	
<input type="checkbox"/> REQUEST FOR CONFIDENTIAL STATUS (6 mos from date casing set)	
<input type="checkbox"/> SUBSEQUENT REPORT OF STAGE, SQUEEZE OR REMEDIAL CEMENT WORK	
*submit cbl and cement job summaries	
Method used	Cementing tool setting/perf depth
Cement volume	Cement top
Cement bottom	Date
<input type="checkbox"/> RECLAMATION: Attach technical page describing final reclamation procedures per Rule 1004.	
Final reclamation will commence on approximately	
<input type="checkbox"/> Final reclamation is completed and site is ready for inspection.	

Technical Engineering/Environmental Notice

<input type="checkbox"/> Notice of Intent		<input type="checkbox"/> Report of Work Done
Approximate Start Date:		Date Work Completed:
Details of work must be described in full on Technical Information Page (Page 2 must be submitted.)		
<input type="checkbox"/> Intent to Recomplete (submit form 2)	<input type="checkbox"/> Request to Vent or Flare	<input type="checkbox"/> E&P Waste Disposal
<input type="checkbox"/> Change Drilling Plans	<input type="checkbox"/> Repair Well	<input type="checkbox"/> Beneficial Reuse of E&P Waste
<input type="checkbox"/> Gross Interval Changed?	<input type="checkbox"/> Rule 502 variance requested	<input type="checkbox"/> Status Update/Change of Remediation Plans
<input type="checkbox"/> Casing/Cementing Program Change	<input checked="" type="checkbox"/> Other: Reserve pit closure	for Spills and Releases

I hereby certify that the statements made in this form are, to the best of my knowledge, true, correct and complete.

Signed: [Signature] Date: 11/22/11 Email: Dave.Stephens@anadarko.com
Print Name: David H. Stephens, P.G. Title: Environmental Manager/Rockies

COGCC Approved: [Signature] Title: COGCC IV Date: 11/30/11

CONDITIONS OF APPROVAL, IF ANY:

TECHNICAL INFORMATION PAGE



FOR OGCC USE ONLY

1. OGCC Operator Number: 2800 API Number: 05-123-33865
2. Name of Operator: Anadarko E&P Company LP OGCC Facility ID #
3. Well/Facility Name: Bellmore Well/Facility Number: 9-66-15-5H
4. Location (QtrQtr, Sec, Twp, Rng, Meridian): SWNW-15-9N-66W-6PM

This form is to be completed whenever a Sundry Notice is submitted requiring detailed report of work to be performed or completed. This form shall be transmitted within 30 days of work completed as a "subsequent" report and must accompany Form 4, page 1.

5. DESCRIBE PROPOSED OR COMPLETED OPERATIONS

Anadarko E&P Company LP (Anadarko) has closed the reserve pits used to drill the surface hole for the Bellmore 9-66-15-5H well. The reserve pits were located on the Bellmore 9-66-15-5H pad site. Two background soil samples were collected (PitBG_Bellmore_C035_East and PitBG_Bellmore_C035_West) from the base of the reserve pits prior to the start of drilling activities and prior to introduction of drilling mud into the reserve pit. Background samples were analyzed for total arsenic and barium. Upon completion of the drilling activities, the drill mud was removed from the reserve pits and land applied at an approved facility. Two confirmatory soil samples (PitPost_Bellmore_C035_East and PitPost_Bellmore_C035_West) were collected from the base of the emptied reserve pit and submitted for laboratory analysis of total petroleum hydrocarbon (TPH), benzene, toluene, ethylbenzene, xylene (BTEX), total arsenic and barium, and TCLP arsenic. Laboratory results confirm that all analyte levels were within COGCC allowable levels and/or below the background levels detected in PitBG_Bellmore_C035_East and PitBG_Bellmore_C035_West except for arsenic. The attached map and table identify four site locations in the area and the associated analytical results. Figure 1 demonstrates the area specific background arsenic ranges. The reserve pit arsenic concentrations are below the upper range of background arsenic concentrations detected in background reserve pit samples collected at other sites in the area. Additionally, the reserve pit arsenic concentrations are below the CDPHE allowable level of 11.0 mg/kg in "Risk Management Guidance for Evaluating Arsenic Concentrations". Based on these results, Anadarko is requesting a no further action (NFA) status for the reserve pit. The laboratory reports are included as an attachment to this Form 4.

State of Colorado
Oil and Gas Conservation Commission

1120 Lincoln Street, Suite 801, Denver, Colorado 80203 Phone: (303)894-2100 Fax: (303)894-2109



02221346

SUNDRY NOTICE

Submit original plus one copy. This form is to be used for general, technical and environmental sundry information. For proposed or completed operations, describe in full on Technical Information Page (Page 2 of this form.) Identify well or other facility by API Number or by OGCC Facility ID. Operator shall send an informational copy of all sundry notices for wells located in High Density Areas to the Local Government Designee (Rule 603b.)

Received
11/30/11

1. OGCC Operator Number: 2800		4. Contact Name David H. Stephens		Complete the Attachment Checklist	
2. Name of Operator: Anadarko E&P Company LP		Phone: 720-929-6363		OP OGCC	
3. Address: 1099 18th Street, Suite 1800 City: Denver State: CO Zip: 80202		Fax: 720-929-7363			
5. API Number 05- 123-33867		OGCC Facility ID Number		Survey Plat	
6. Well/Facility Name: Eichheim		7. Well/Facility Number 9-66-19-14H		Directional Survey	
8. Location (Qtr/Qtr, Sec, Twp, Rng, Meridian): SESW-19-9N-66W-6PM				Surface Equipmt Diagram	
9. County: Weld		10. Field Name: Wildcat		Technical Info Page	
11. Federal, Indian or State Lease Number: N/A				Other	

General Notice

<input type="checkbox"/> CHANGE OF LOCATION: Attach New Survey Plat (a change of surface qtr/qtr is substantive and requires a new permit)	
Change of Surface Footage from Exterior Section Lines:	<input type="checkbox"/> FNU/FSL <input type="checkbox"/> FEL/FWL
Change of Surface Footage to Exterior Section Lines:	<input type="checkbox"/> <input type="checkbox"/>
Change of Bottomhole Footage from Exterior Section Lines:	<input type="checkbox"/> <input type="checkbox"/>
Change of Bottomhole Footage to Exterior Section Lines:	<input type="checkbox"/> attach directional survey
Bottomhole location Qtr/Qtr, Sec, Twp, Rng, Mer	
Latitude	Distance to nearest property line
Longitude	Distance to nearest lease line
Ground Elevation	Distance to nearest well same formation
	Distance to nearest bldg, public rd, utility or RR
	Is location in a High Density Area (rule 603b)? Yes/No
Surface owner consultation date:	
GPS DATA:	
Date of Measurement PDOP Reading Instrument Operator's Name	
<input type="checkbox"/> CHANGE SPACING UNIT	<input type="checkbox"/> Remove from surface bond
Formation Formation Code Spacing order number Unit Acreage Unit configuration	Signed surface use agreement attached
<input type="checkbox"/> CHANGE OF OPERATOR (prior to drilling):	<input type="checkbox"/> CHANGE WELL NAME
Effective Date:	From:
Plugging Bond: <input type="checkbox"/> Blanket <input type="checkbox"/> Individual	To:
	Effective Date:
<input type="checkbox"/> ABANDONED LOCATION:	<input type="checkbox"/> NOTICE OF CONTINUED SHUT IN STATUS
Was location ever built? <input type="checkbox"/> Yes <input type="checkbox"/> No	Date well shut in or temporarily abandoned:
Is site ready for inspection? <input type="checkbox"/> Yes <input type="checkbox"/> No	Has Production Equipment been removed from site? <input type="checkbox"/> Yes <input type="checkbox"/> No
Date Ready for Inspection:	MIT required if shut in longer than two years. Date of last MIT
<input type="checkbox"/> SPUD DATE:	<input type="checkbox"/> REQUEST FOR CONFIDENTIAL STATUS (6 mos from date casing set)
<input type="checkbox"/> SUBSEQUENT REPORT OF STAGE, SQUEEZE OR REMEDIAL CEMENT WORK	
*submit cbl and cement job summaries	
Method used	Cementing tool setting/perf depth
Cement volume	Cement top
Cement bottom	Date
<input type="checkbox"/> RECLAMATION: Attach technical page describing final reclamation procedures per Rule 1004.	
Final reclamation will commence on approximately	
<input type="checkbox"/> Final reclamation is completed and site is ready for inspection.	

Technical Engineering/Environmental Notice

<input type="checkbox"/> Notice of Intent	<input type="checkbox"/> Report of Work Done
Approximate Start Date:	Date Work Completed:
Details of work must be described in full on Technical Information Page (Page 2 must be submitted.)	
<input type="checkbox"/> Intent to Recomplete (submit form 2)	<input type="checkbox"/> Request to Vent or Flare
<input type="checkbox"/> Change Drilling Plans	<input type="checkbox"/> Repair Well
<input type="checkbox"/> Gross Interval Changed?	<input type="checkbox"/> Rule 502 variance requested
<input type="checkbox"/> Casing/Cementing Program Change	<input checked="" type="checkbox"/> Other: Reserve pit closure
	<input type="checkbox"/> E&P Waste Disposal
	<input type="checkbox"/> Beneficial Reuse of E&P Waste
	<input type="checkbox"/> Status Update/Change of Remediation Plans for Spills and Releases

I hereby certify that the statements made in this form are, to the best of my knowledge, true, correct and complete.

Signed: [Signature] Date: 11/22/11 Email: Dave.Stephens@anadarko.com
Print Name: David H. Stephens, P.G. Title: Environmental Manager/Rockies

COGCC Approved: [Signature] Title: COGCC Date: 12/1/11

CONDITIONS OF APPROVAL, IF ANY:

TECHNICAL INFORMATION PAGE



FOR OGCC USE ONLY

1. OGCC Operator Number: 2800	API Number: 05-123-33867
2. Name of Operator: Anadarko E&P Company LP	OGCC Facility ID #
3. Well/Facility Name: Eichheim	Well/Facility Number: 9-66-19-14H
4. Location (QtrQtr, Sec, Twp, Rng, Meridian): SESW-19-9N-66W-6PM	

This form is to be completed whenever a Sundry Notice is submitted requiring detailed report of work to be performed or completed. This form shall be transmitted within 30 days of work completed as a "subsequent" report and must accompany Form 4, page 1.

5. DESCRIBE PROPOSED OR COMPLETED OPERATIONS

Anadarko E&P Company LP (Anadarko) has closed the reserve pits used to drill the surface hole for the Eichheim 9-66-19-14H well. The reserve pits were located on the Eichheim 9-66-19-14H pad site. Two background soil samples were collected (PitBG_Eichheim_C037_North and PitBG_Eichheim_C037_South) from the base of the reserve pits prior to the start of drilling activities and prior to introduction of drilling mud into the reserve pit. Background samples were analyzed for total arsenic and barium. Upon completion of the drilling activities, the drill mud was removed from the reserve pit and land applied at an approved facility. Two confirmatory soil samples (PitPost_Eichheim_C037_North and PitPost_Eichheim_C037_South) were collected from the base of the emptied reserve pits and submitted for laboratory analysis of total petroleum hydrocarbon (TPH), benzene, toluene, ethylbenzene, xylene (BTEX), total arsenic and barium, and TCLP arsenic.

Laboratory results confirm that all analyte levels were within COGCC allowable levels and/or below background levels in both pits except for arsenic in PitBG_Eichheim_C037_North. The PitPost_Eichheim_C037_North had an arsenic level greater than the background sample; however, once a +/- 25% laboratory accuracy was applied (analytical method 2D0.8/6020), the post closure reserve pit arsenic concentration is below the background arsenic concentration detected in PitBG_Eichheim_C037_North. Based on the laboratory results, Anadarko is requesting a no further action (NFA) status for the reserve pit. The laboratory reports and a table presenting the analytical results are included as attachments to this Form 4.

State of Colorado
Oil and Gas Conservation Commission

1120 Lincoln Street, Suite 801, Denver, Colorado 80203 Phone: (303)894-2100 Fax: (303)894-2109



02221347

SUNDRY NOTICE

Submit original plus one copy. This form is to be used for general, technical and environmental sundry information. For proposed or completed operations, describe in full on Technical Information Page (Page 2 of this form). Identify well or other facility by API Number or by OGCC Facility ID. Operator shall send an informational copy of all sundry notices for wells located in High Density Areas to the Local Government Designee (Rule 603b).

Received
11/30/11

1. OGCC Operator Number: 2800	4. Contact Name: David H. Stephens	Complete the Attachment Checklist OP OGCC
2. Name of Operator: Anadarko E&P Company LP	Phone: 720-929-6363	
3. Address: 1099 18th Street, Suite 1800 City: Denver State: CO Zip: 80202	Fax: 720-929-7363	
5. API Number 05-123-33580	OGCC Facility ID Number	Survey Plat
6. Well/Facility Name: Turner	7. Well/Facility Number: 8-66-17-4H	Directional Survey
8. Location (Qtr/Sec, Twp, Rng, Meridian): NWNW-17-8N-66W-6PM		Surface Equipmt Diagram
9. County: Weld	10. Field Name: Wildcat	Technical Info Page
11. Federal, Indian or State Lease Number: N/A		Other

General Notice

<input type="checkbox"/> CHANGE OF LOCATION: Attach New Survey Plat (a change of surface qtr/qtr is substantive and requires a new permit)	
Change of Surface Footage from Exterior Section Lines:	<input type="checkbox"/> FNU/FSL <input type="checkbox"/> FEL/FWL
Change of Surface Footage to Exterior Section Lines:	<input type="checkbox"/>
Change of Bottomhole Footage from Exterior Section Lines:	<input type="checkbox"/>
Change of Bottomhole Footage to Exterior Section Lines:	<input type="checkbox"/> attach directional survey
Bottomhole location Qtr/Sec, Twp, Rng, Mer	
Latitude	Distance to nearest property line
Longitude	Distance to nearest lease line
Ground Elevation	Distance to nearest well same formation
	Distance to nearest bldg, public rd, utility or RR
	Is location in a High Density Area (rule 603b)? Yes/No
Surface owner consultation date:	
GPS DATA:	
Date of Measurement	PDOP Reading
Instrument Operator's Name	
<input type="checkbox"/> CHANGE SPACING UNIT	
Formation	Formation Code
Spacing order number	Unit Acreage
Unit configuration	
<input type="checkbox"/> Remove from surface bond	
Signed surface use agreement attached	
<input type="checkbox"/> CHANGE OF OPERATOR (prior to drilling):	
Effective Date:	
Plugging Bond: <input type="checkbox"/> Blanket <input type="checkbox"/> Individual	
<input type="checkbox"/> CHANGE WELL NAME	
From:	NUMBER
To:	
Effective Date:	
<input type="checkbox"/> ABANDONED LOCATION:	
Was location ever built? <input type="checkbox"/> Yes <input type="checkbox"/> No	
Is site ready for inspection? <input type="checkbox"/> Yes <input type="checkbox"/> No	
Date Ready for Inspection:	
<input type="checkbox"/> NOTICE OF CONTINUED SHUT IN STATUS	
Date well shut in or temporarily abandoned:	
Has Production Equipment been removed from site? <input type="checkbox"/> Yes <input type="checkbox"/> No	
MIT required if shut in longer than two years. Date of last MIT	
<input type="checkbox"/> SPUD DATE:	
<input type="checkbox"/> REQUEST FOR CONFIDENTIAL STATUS (6 mos from date casing set)	
<input type="checkbox"/> SUBSEQUENT REPORT OF STAGE, SQUEEZE OR REMEDIAL CEMENT WORK	
*submit cbi and cement job summaries	
Method used	Cementing tool setting/perf depth
Cement volume	Cement top
Cement bottom	Date
<input type="checkbox"/> RECLAMATION: Attach technical page describing final reclamation procedures per Rule 1004.	
Final reclamation will commence on approximately	
<input type="checkbox"/> Final reclamation is completed and site is ready for inspection.	

Technical Engineering/Environmental Notice

<input type="checkbox"/> Notice of Intent		<input type="checkbox"/> Report of Work Done
Approximate Start Date:		Date Work Completed:
Details of work must be described in full on Technical Information Page (Page 2 must be submitted.)		
<input type="checkbox"/> Intent to Recomplete (submit form 2)	<input type="checkbox"/> Request to Vent or Flare	<input type="checkbox"/> E&P Waste Disposal
<input type="checkbox"/> Change Drilling Plans	<input type="checkbox"/> Repair Well	<input type="checkbox"/> Beneficial Reuse of E&P Waste
<input type="checkbox"/> Gross Interval Changed?	<input type="checkbox"/> Rule 502 variance requested	<input type="checkbox"/> Status Update/Change of Remediation Plans
<input type="checkbox"/> Casing/Cementing Program Change	<input checked="" type="checkbox"/> Other: Reserve pit closure	for Spills and Releases

I hereby certify that the statements made in this form are, to the best of my knowledge, true, correct and complete.

Signed: [Signature] Date: 11/22/11 Email: Dave.Stephens@anadarko.com
Print Name: David H. Stephens, P.G. Title: Environmental Manager/Rockies

COGCC Approved: [Signature] Title: COGCC Date: 12/1/11

CONDITIONS OF APPROVAL, IF ANY:

TECHNICAL INFORMATION PAGE



FOR OGCC USE ONLY

1. OGCC Operator Number: 2800 API Number: 05-123-33580
2. Name of Operator: Anadrako E&P Company LP OGCC Facility ID # _____
3. Well/Facility Name: Turner Well/Facility Number: 8-66-17-4H
4. Location (QtrQtr, Sec, Twp, Rng, Meridian): NWNW-17-8N-66W-6PM

This form is to be completed whenever a Sundry Notice is submitted requiring detailed report of work to be performed or completed. This form shall be transmitted within 30 days of work completed as a "subsequent" report and must accompany Form 4, page 1.

5. **DESCRIBE PROPOSED OR COMPLETED OPERATIONS**

Anadarko E&P Company LP (Anadarko) has closed the reserve pits used to drill the surface hole for the Turner 8-66-17-4H well. The reserve pits were located on the Turner 8-66-17-4H pad site. Two background soil samples were collected (PitBG_Turner_C041_North and PitBG_Turner_C041_South) from the base of the reserve pits prior to the start of drilling activities and prior to introduction of drilling mud into the reserve pit. Background samples were analyzed for total arsenic and barium. Upon completion of the drilling activities, the drill mud was removed from the reserve pit and land applied at an approved facility. Two confirmatory soil samples (PitPost_Turner_C041_North and PitPost_Turner_C041_South) were collected from the base of the emptied reserve pits and submitted for laboratory analysis of total petroleum hydrocarbon (TPH), benzene, toluene, ethylbenzene, xylene (BTEX), total arsenic and barium, and TCLP arsenic. Laboratory results confirm that all analyte levels were within COGCC allowable levels and/or below the background levels detected in PitBG_Turner_C041_North and PitBG_Turner_C041_South. Based on the laboratory results, Anadarko is requesting a no further action (NFA) status for the reserve pit. The laboratory reports and a table presenting the analytical results are included as attachments to this Form 4.

ATTACHMENT 2

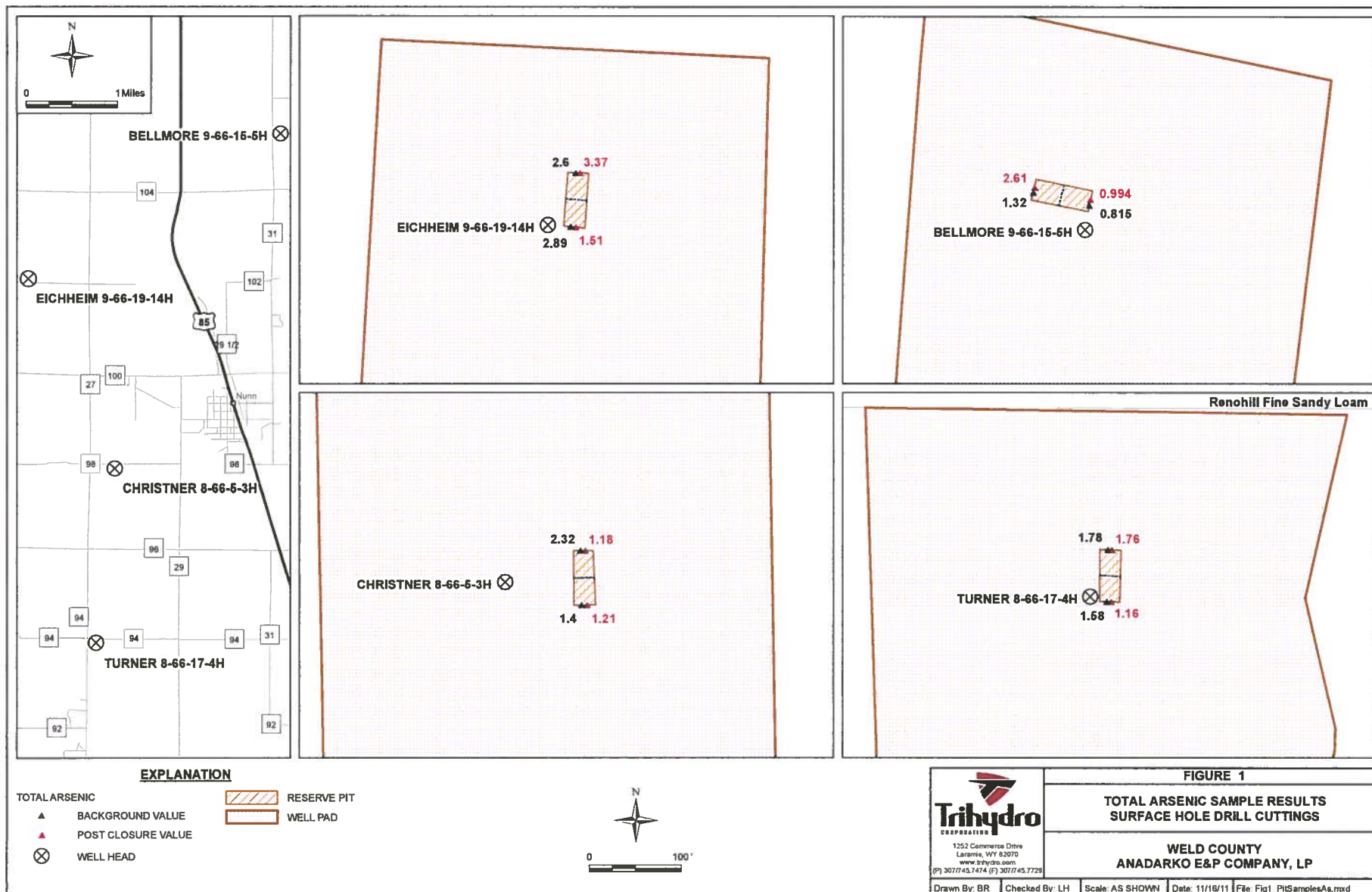

ATTACHMENT 3

**TABLE 1. RESERVE PIT DRILLING MUD ANALYSIS
WELD COUNTY
ANADARKO E&P COMPANY LP**

Anadarko Well Name	API Number	Sample ID	Sample Status	Date Sampled	TPH-DRO	TPH-GRO	TPH-ORO	Total TPH*	Benzene	Ethylbenzene	Toluene	Xylene	Total As	Total Ba	TCLP As
					mg/kg	mg/kg	mg/kg	mg/kg	mg/L	mg/L	mg/L	mg/L	mg/kg	mg/kg	mg/L
Christner 8-66-5-3H	49-021-20664	PitBG_Christner_C039_North	Background	8/30/2011	—	—	—	—	—	—	—	—	2.32	22.7	—
Christner 8-66-5-3H	49-021-20664	PitBG_Christner_C039_South	Background	8/30/2011	—	—	—	—	—	—	—	—	1.4	21.3	—
Christner 8-66-5-3H	49-021-20664	PitPost_Christner_C039_North	Post-closure	8/30/2011	ND (50)	ND (0.5)	ND (50)	ND (100.5)	ND (.0050)	ND (.0050)	ND (.0050)	ND (.0050)	1.18	14.2	ND (0.100)
Christner 8-66-5-3H	49-021-20664	PitPost_Christner_C039_South	Post-closure	8/30/2011	ND (50)	ND (0.5)	ND (50)	ND (100.5)	ND (.0050)	ND (.0050)	ND (.0050)	ND (.0050)	1.21	24.6	ND (0.100)
Turner 8-66-17-4H	49-021-20663	PitBG_Turner_C041_North	Background	8/30/2011	—	—	—	—	—	—	—	—	1.78	22.8	—
Turner 8-66-17-4H	49-021-20663	PitBG_Turner_C041_South	Background	8/30/2011	—	—	—	—	—	—	—	—	1.58	20.5	—
Turner 8-66-17-4H	49-021-20663	PitPost_Turner_C041_North	Post-closure	9/2/2011	ND (50)	ND (0.5)	ND (50)	ND (100.5)	ND (.0050)	ND (.0050)	ND (.0050)	ND (.0050)	1.76	28.5	ND (0.100)
Turner 8-66-17-4H	49-021-20663	PitPost_Turner_C041_South	Post-closure	9/2/2011	ND (50)	ND (0.5)	ND (50)	ND (100.5)	ND (.0050)	ND (.0050)	ND (.0050)	ND (.0050)	1.16	20.1	ND (0.100)
Eichheim 9-66-19-14H	49-021-20673	PitBG_Eichheim_C037_North	Background	8/30/2011	—	—	—	—	—	—	—	—	2.6	71.7	—
Eichheim 9-66-19-14H	49-021-20665	PitBG_Eichheim_C037_South	Background	8/30/2011	—	—	—	—	—	—	—	—	2.89	94	—
Eichheim 9-66-19-14H	49-021-20673	PitPost_Eichheim_C037_North	Post-closure	9/9/2011	ND (50)	ND (0.5)	ND (50)	ND (100.5)	ND (.0050)	ND (.0050)	ND (.0050)	ND (.0050)	3.37	ND	ND (0.100)
Eichheim 9-66-19-14H	49-021-20665	PitPost_Eichheim_C037_South	Post-closure	9/9/2011	ND (50)	ND (0.5)	ND (50)	ND (100.5)	ND (.0050)	ND (.0050)	ND (.0050)	ND (.0050)	1.51	ND	ND (0.100)
Bellmore 9-66-15-5H	49-021-20665	PitBG_Bellmore_C035_East	Background	8/30/2011	—	—	—	—	—	—	—	—	0.815	24.3	—
Bellmore 9-66-15-5H	49-021-20741	PitBG_Bellmore_C035_West	Background	8/30/2011	—	—	—	—	—	—	—	—	1.32	37.3	—
Bellmore 9-66-15-5H	49-021-20665	PitPost_Bellmore_C035_East	Post-closure	9/9/2011	ND (50)	ND (0.5)	ND (50)	ND (100.5)	ND (.0050)	ND (.0050)	ND (.0050)	ND (.0050)	0.994	ND	ND (0.100)
Bellmore 9-66-15-5H	49-021-20741	PitPost_Bellmore_C035_West	Post-closure	9/9/2011	ND (50)	ND (0.5)	ND (50)	ND (100.5)	ND (.0050)	ND (.0050)	ND (.0050)	ND (.0050)	2.61	ND	ND (0.100)
COGCC Limits (mg/kg)					NA	NA	NA	500	0.17	100	85	175	0.39	15,000	NA
RCRA TCLP Limits (mg/L)									0.5					100	5

Notes:
 * - Calculated sum of DRO, GRO, and ORO
 — denotes the analyte was not sampled
Bold denotes exceedance of relevant regulatory limit
 ND (RL) - Not detected at the reporting limit listed parenthetically
 B - Compound was detected in the blank and the sample
 J - Result is less than the reporting limit but greater than or equal to the method detection limit and concentration is an approximate value

ATTACHMENT 4

Summit Scientific

741 Corporate Circle – Suite I ♦ Golden, Colorado 80401

303.277.9310 - laboratory ♦ 303.277.9531 - fax

September 08, 2011

Laurie Heath
Trihydro Corporation
1252 Commerce Dr.
Laramie, WY 82070
RE: Greater DJ Basin

Enclosed are the results of analyses for samples received by Summit Scientific on 08/31/11 09:30. If you have any questions concerning this report, please feel free to contact me.

Sincerely,

A handwritten signature in black ink, appearing to read 'P. Shrewsbury', written in a cursive style.

Paul Shrewsbury For Ben Shrewsbury
President / Laboratory Director

S₂

Trihydro Corporation
1252 Commerce Dr.
Laramie WY, 82070

Project: Greater DJ Basin
Project Number: 11X-006-001
Project Manager: Laurie Heath

Reported:
09/08/11 09:27

ANALYTICAL REPORT FOR SAMPLES

Sample ID	Laboratory ID	Matrix	Date Sampled	Date Received
PitBG_Christner_C039_South	R108195-01	Soil	08/30/11 17:45	08/31/11 09:30
PitBG_Turner_C041_South	R108195-02	Soil	08/30/11 17:25	08/31/11 09:30
PitBG_Bellmore_C035_East	R108195-03	Soil	08/30/11 16:15	08/31/11 09:30
PitBG_Eichheim_C037_South	R108195-04	Soil	08/30/11 16:50	08/31/11 09:30
PitBG_Christner_C039_North	R108195-05	Soil	08/30/11 17:45	08/31/11 09:30
PitBG_Turner_C041_North	R108195-06	Soil	08/30/11 17:25	08/31/11 09:30
PitBG_Bellmore_C035_West	R108195-07	Soil	08/30/11 16:15	08/31/11 09:30
PitBG_Eichheim_C037_North	R108195-08	Soil	08/30/11 16:50	08/31/11 09:30
PitPost_Christner_C039_North	R108195-09	Soil	08/30/11 18:20	08/31/11 09:30
PitPost_Christner_C039_South	R108195-10	Soil	08/30/11 17:55	08/31/11 09:30

Summit Scientific

The results in this report apply to the samples analyzed in accordance with the chain of custody document. This analytical report must be reproduced in its entirety.



S₂

Trihydro Corporation
1252 Commerce Dr.
Laramie WY, 82070

Project: Greater DJ Basin
Project Number: 11X-006-001
Project Manager: Laurie Heath

Reported:
09/08/11 09:27

CASE NARRATIVE

Ten soil samples were received at Summit Scientific's Laboratory on August 31, 2011 at 09:30 via courier. The samples arrived on ice in good condition at a temperature of 5.8 C.

Method 8260B

Two of the samples were analyzed for gasoline range organics in accordance with EPA SW846 Method 8260B.

Method 8015M

Two of the soil samples were analyzed for diesel and residual range organics in accordance with EPA SW846 Method 8015M..

Method 6020/7471

All the samples were analyzed for Total As and Ba and two were analyzed for TCLP As metals in accordance with EPA SW846 Method 6020/7471

QA/QC

The following qualifiers were used for these samples.

QM-07 was used for *As MSI*, *As MSDI*. The spike recovery was outside acceptance limits for the MS and/or MSD. The batch was accepted based on acceptable LCS/LCSD recovery.

Summit Scientific

The results in this report apply to the samples analyzed in accordance with the chain of custody document. This analytical report must be reproduced in its entirety.



S₂

Trihydro Corporation
1252 Commerce Dr.
Laramie WY, 82070

Project: Greater DJ Basin

Project Number: 11X-006-001
Project Manager: Laurie Heath

Reported:
09/08/11 09:27

Summit Scientific R108195 Page 1 of 1

741 Corporate Circle - Suite 1
Golden, Colorado 80401
303-277-4310 - 303-374-9933 Fax

Client: Trihydro Corporation
Project: Greater DJ Basin - Drill Mud Sampling
Project Manager: Mike Ogden
Project Number: 11X-006-001
303-745-7479
303-374-1915 (C)

Number	Sample Identification	Matrix	Type	Sample Date	Sample Time	Sampled By	Container	Qty	Analytes
01-001	PRBGC_Christner_C039_South	Soil	Field Sample	8/30/2011	1745	LH	2 oz. jar	1	6020 As-Rush 6020 Ba-Sid
02-001	PRBGC_Tanner_C041-South	Soil	Field Sample		1725		2 oz. jar	1	6020 As 6020 Ba
03-001	PRBGC_Bellmore_C035_East	Soil	Field Sample		1615		2 oz. jar	1	6020 As 6020 Ba
04-001	PRBGC_Eckheim_C037_South	Soil	Field Sample		1650		2 oz. jar	1	6020 As 6020 Ba
05-001	PRBGC_Schwartz_C037 P1185_Christner_C039_North	Soil	Field Sample		1745		2 oz. jar	1	6020 As-Rush 6020 Ba-Sid
06-001	PRBGC_Schwartz_C039 P1185_Turner_C041-North	Soil	Field Sample		1725		2 oz. jar	1	6020 As 6020 Ba
07-001	PRBGC_Schwartz_C035 P1185_Bellmore_C035_West	Soil	Field Sample		1615		2 oz. jar	1	6020 As 6020 Ba
08-001	PRBGC_Schwartz_C037 P1185_Eckheim_C037_North	Soil	Field Sample		1650		2 oz. jar	1	6020 As 6020 Ba
09-001	PRBGC_Schwartz_C037 P1185_Christner_C039_North	Soil	Field Sample		1820		2 oz. jar	2	6020 As-Rush 6020 Ba Copper TPH pH Sulfate Total Solids Total Phosphorus

010-001 P1185_Christner_C039_South Soil Field 8/30/2011 1755 LH 2oz 2 (As-Rush, Ba-Sid, TPH, pH, Sulfate, Total Solids, Total Phosphorus, Copper)

Turn Around Time (Check)

Same Day ☐ 24 Hours ☒ 72 Hours ☐ Standard ☐ 48 Hours ☐

Sample Integrity: 5.8

Temperature Range: 5.8

Relinquished By: [Signature] Date/Time: 8-31-11 4:30
Received By: [Signature] Date/Time: 8-31-11 4:30

Relinquished By: [Signature] Date/Time: 8/31/2011 07:20
Received By: [Signature] Date/Time: 8/31/2011 07:20

Summit Scientific

The results in this report apply to the samples analyzed in accordance with the chain of custody document. This analytical report must be reproduced in its entirety.

S₂

Trihydro Corporation
1252 Commerce Dr.
Laramie WY, 82070

Project: Greater DJ Basin
Project Number: 11X-006-001
Project Manager: Laurie Heath

Reported:
09/08/11 09:27

PitBG_Christner_C039_South
R108195-01 (Soil)

Summit Scientific

Total Metals by EPA SW846 Method 6020 - Dry Weight Basis

Date Sampled: 08/30/11 17:45

Analyte	Result	Reporting Limit	Units	Dilution	Batch	Prepared	Analyzed	Method	Notes
Arsenic	1.40	0.0783	mg/kg	1	1083103	08/31/11	08/31/11	EPA 6020	

Date Sampled: 08/30/11 17:45

Analyte	Result	Reporting Limit	Units	Dilution	Batch	Prepared	Analyzed	Method	Notes
Barium	21.3	3.92	"	"	"	"	"	"	

Summit Scientific

The results in this report apply to the samples analyzed in accordance with the chain of custody document. This analytical report must be reproduced in its entirety.



S₂

Trihydro Corporation
1252 Commerce Dr.
Laramie WY, 82070

Project: Greater DJ Basin
Project Number: 11X-006-001
Project Manager: Laurie Heath

Reported:
09/08/11 09:27

PitBG_Turner_C041_South
R108195-02 (Soil)

Summit Scientific

Total Metals by EPA SW846 Method 6020 - Dry Weight Basis

Date Sampled: 08/30/11 17:25

Analyte	Result	Reporting Limit	Units	Dilution	Batch	Prepared	Analyzed	Method	Notes
Arsenic	1.58	0.0874	mg/kg	1	1083103	08/31/11	08/31/11	EPA 6020	

Date Sampled: 08/30/11 17:25

Analyte	Result	Reporting Limit	Units	Dilution	Batch	Prepared	Analyzed	Method	Notes
Barium	20.5	4.37	"	"	"	"	"	"	

Summit Scientific

The results in this report apply to the samples analyzed in accordance with the chain of custody document. This analytical report must be reproduced in its entirety.



S₂

Trihydro Corporation
1252 Commerce Dr.
Laramie WY, 82070

Project: Greater DJ Basin
Project Number: 11X-006-001
Project Manager: Laurie Heath

Reported:
09/08/11 09:27

PitBG_Bellmore_C035_East
R108195-03 (Soil)

Summit Scientific

Total Metals by EPA SW846 Method 6020 - Dry Weight Basis

Date Sampled: 08/30/11 16:15

Analyte	Result	Reporting Limit	Units	Dilution	Batch	Prepared	Analyzed	Method	Notes
Arsenic	0.815	0.100	mg/kg	1	1083103	08/31/11	08/31/11	EPA 6020	

Date Sampled: 08/30/11 16:15

Analyte	Result	Reporting Limit	Units	Dilution	Batch	Prepared	Analyzed	Method	Notes
Barium	24.3	5.00	"	"	"	"	"	"	

Summit Scientific

The results in this report apply to the samples analyzed in accordance with the chain of custody document. This analytical report must be reproduced in its entirety.



S₂

Trihydro Corporation
1252 Commerce Dr.
Laramie WY, 82070

Project: Greater DJ Basin
Project Number: 11X-006-001
Project Manager: Laurie Heath

Reported:
09/08/11 09:27

PitBG_Eichheim_C037_South
R108195-04 (Soil)

Summit Scientific

Total Metals by EPA SW846 Method 6020 - Dry Weight Basis

Date Sampled: 08/30/11 16:50

Analyte	Result	Reporting Limit	Units	Dilution	Batch	Prepared	Analyzed	Method	Notes
Arsenic	2.89	0.100	mg/kg	1	1083103	08/31/11	08/31/11	EPA 6020	

Date Sampled: 08/30/11 16:50

Analyte	Result	Reporting Limit	Units	Dilution	Batch	Prepared	Analyzed	Method	Notes
Barium	94.0	5.00	"	"	"	"	"	"	

Summit Scientific

The results in this report apply to the samples analyzed in accordance with the chain of custody document. This analytical report must be reproduced in its entirety.



S₂

Trihydro Corporation
1252 Commerce Dr.
Laramie WY, 82070

Project: Greater DJ Basin
Project Number: 11X-006-001
Project Manager: Laurie Heath

Reported:
09/08/11 09:27

PitBG_Christner_C039_North
R108195-05 (Soil)

Summit Scientific

Total Metals by EPA SW846 Method 6020 - Dry Weight Basis

Date Sampled: 08/30/11 17:45

Analyte	Result	Reporting Limit	Units	Dilution	Batch	Prepared	Analyzed	Method	Notes
Arsenic	2.32	0.0716	mg/kg	1	1083103	08/31/11	08/31/11	EPA 6020	

Date Sampled: 08/30/11 17:45

Analyte	Result	Reporting Limit	Units	Dilution	Batch	Prepared	Analyzed	Method	Notes
Barium	22.7	3.58	"	"	"	"	"	"	

Summit Scientific

The results in this report apply to the samples analyzed in accordance with the chain of custody document. This analytical report must be reproduced in its entirety.



S₂

Trihydro Corporation
1252 Commerce Dr.
Laramie WY, 82070

Project: Greater DJ Basin
Project Number: 11X-006-001
Project Manager: Laurie Heath

Reported:
09/08/11 09:27

PitBG_Turner_C041_North
R108195-06 (Soil)

Summit Scientific

Total Metals by EPA SW846 Method 6020 - Dry Weight Basis

Date Sampled: 08/30/11 17:25

Analyte	Result	Reporting Limit	Units	Dilution	Batch	Prepared	Analyzed	Method	Notes
Arsenic	1.78	0.0844	mg/kg	1	1083103	08/31/11	08/31/11	EPA 6020	

Date Sampled: 08/30/11 17:25

Analyte	Result	Reporting Limit	Units	Dilution	Batch	Prepared	Analyzed	Method	Notes
Barium	22.8	4.22	"	"	"	"	"	"	

Summit Scientific

The results in this report apply to the samples analyzed in accordance with the chain of custody document. This analytical report must be reproduced in its entirety.



S₂

Trihydro Corporation
1252 Commerce Dr.
Laramie WY, 82070

Project: Greater DJ Basin
Project Number: 11X-006-001
Project Manager: Laurie Heath

Reported:
09/08/11 09:27

PitBG_Bellmore_C035_West
R108195-07 (Soil)

Summit Scientific

Total Metals by EPA SW846 Method 6020 - Dry Weight Basis

Date Sampled: 08/30/11 16:15

Analyte	Result	Reporting Limit	Units	Dilution	Batch	Prepared	Analyzed	Method	Notes
Arsenic	1.32	0.0799	mg/kg	1	1083103	08/31/11	08/31/11	EPA 6020	

Date Sampled: 08/30/11 16:15

Analyte	Result	Reporting Limit	Units	Dilution	Batch	Prepared	Analyzed	Method	Notes
Barium	37.3	4.00	"	"	"	"	"	"	

Summit Scientific

The results in this report apply to the samples analyzed in accordance with the chain of custody document. This analytical report must be reproduced in its entirety.



S₂

Trihydro Corporation
1252 Commerce Dr.
Laramie WY, 82070

Project: Greater DJ Basin
Project Number: 11X-006-001
Project Manager: Laurie Heath

Reported:
09/08/11 09:27

PitBG_Eichheim_C037_North
R108195-08 (Soil)

Summit Scientific

Total Metals by EPA SW846 Method 6020 - Dry Weight Basis

Date Sampled: 08/30/11 16:50

Analyte	Result	Reporting Limit	Units	Dilution	Batch	Prepared	Analyzed	Method	Notes
Arsenic	2.60	0.0715	mg/kg	1	1083103	08/31/11	08/31/11	EPA 6020	

Date Sampled: 08/30/11 16:50

Analyte	Result	Reporting Limit	Units	Dilution	Batch	Prepared	Analyzed	Method	Notes
Barium	71.7	3.58	"	"	"	"	"	"	

Summit Scientific

The results in this report apply to the samples analyzed in accordance with the chain of custody document. This analytical report must be reproduced in its entirety.



S₂

Trihydro Corporation
1252 Commerce Dr.
Laramie WY, 82070

Project: Greater DJ Basin
Project Number: 11X-006-001
Project Manager: Laurie Heath

Reported:
09/08/11 09:27

PitPost_Christner_C039_North
R108195-09 (Soil)

Summit Scientific

Extractable Petroleum Hydrocarbons by 8015

Date Sampled: 08/30/11 18:20

Analyte	Result	Reporting Limit	Units	Dilution	Batch	Prepared	Analyzed	Method	Notes
C10-C28 (TEPH-DRO)	ND	50	mg/kg	1	1083105	08/31/11	08/31/11	8015 Full Carbon Chain	
C28-C36 (TEPH-ORO)	ND	50	"	"	"	"	"	"	

Date Sampled: 08/30/11 18:20

Analyte	Result	Reporting Limit	Units	Dilution	Batch	Prepared	Analyzed	Method	Notes
Surrogate: o-Terphenyl		109 %	88.8-124		"	"	"	"	

Volatile Organic Compounds by EPA Method 8260B

Date Sampled: 08/30/11 18:20

Analyte	Result	Reporting Limit	Units	Dilution	Batch	Prepared	Analyzed	Method	Notes
Benzene	ND	0.0050	mg/kg	1	1083104	08/31/11	08/31/11	EPA 8260B	
Toluene	ND	0.0050	"	"	"	"	"	"	
Ethylbenzene	ND	0.0050	"	"	"	"	"	"	
Xylenes (total)	ND	0.0050	"	"	"	"	"	"	
Gasoline Range Hydrocarbons	ND	0.50	"	"	"	"	"	"	

Date Sampled: 08/30/11 18:20

Analyte	Result	Reporting Limit	Units	Dilution	Batch	Prepared	Analyzed	Method	Notes
Surrogate: 1,2-Dichloroethane-d4		111 %	67.4-143		"	"	"	"	
Surrogate: Toluene-d8		98.2 %	77.3-114		"	"	"	"	
Surrogate: 4-Bromofluorobenzene		91.1 %	78.4-125		"	"	"	"	

TCLP Metals by EPA SW846 7471

Date Sampled: 08/30/11 18:20

Analyte	Result	Reporting Limit	Units	Dilution	Batch	Prepared	Analyzed	Method	Notes
---------	--------	-----------------	-------	----------	-------	----------	----------	--------	-------

Summit Scientific

The results in this report apply to the samples analyzed in accordance with the chain of custody document. This analytical report must be reproduced in its entirety.



S₂

Trihydro Corporation
1252 Commerce Dr.
Laramie WY, 82070

Project: Greater DJ Basin
Project Number: 11X-006-001
Project Manager: Laurie Heath

Reported:
09/08/11 09:27

PitPost_Christner_C039_North
R108195-09 (Soil)

Summit Scientific

TCLP Metals by EPA SW846 7471

Arsenic	ND	0.100	mg/L in Extract	1	1090108	09/04/11	09/07/11	EPA 6020
---------	----	-------	-----------------	---	---------	----------	----------	----------

Total Metals by EPA SW846 Method 6020 - Dry Weight Basis

Date Sampled: 08/30/11 18:20

Analyte	Result	Reporting Limit	Units	Dilution	Batch	Prepared	Analyzed	Method	Notes
Arsenic	1.18	0.0592	mg/kg	1	1083103	08/31/11	08/31/11	EPA 6020	

Date Sampled: 08/30/11 18:20

Analyte	Result	Reporting Limit	Units	Dilution	Batch	Prepared	Analyzed	Method	Notes
Barium	14.2	2.96	"	"	"	"	"	"	

Summit Scientific

The results in this report apply to the samples analyzed in accordance with the chain of custody document. This analytical report must be reproduced in its entirety.



S₂

Trihydro Corporation
1252 Commerce Dr.
Laramie WY, 82070

Project: Greater DJ Basin
Project Number: 11X-006-001
Project Manager: Laurie Heath

Reported:
09/08/11 09:27

PitPost_Christner_C039_South
R108195-10 (Soil)

Summit Scientific

Extractable Petroleum Hydrocarbons by 8015

Date Sampled: 08/30/11 17:55

Analyte	Result	Reporting Limit	Units	Dilution	Batch	Prepared	Analyzed	Method	Notes
C10-C28 (TEPH-DRO)	ND	50	mg/kg	1	1083105	08/31/11	08/31/11	8015 Full Carbon Chain	
C28-C36 (TEPH-ORO)	ND	50	"	"	"	"	"	"	

Date Sampled: 08/30/11 17:55

Analyte	Result	Reporting Limit	Units	Dilution	Batch	Prepared	Analyzed	Method	Notes
Surrogate: o-Terphenyl		106 %	88.8-124		"	"	"	"	

Volatile Organic Compounds by EPA Method 8260B

Date Sampled: 08/30/11 17:55

Analyte	Result	Reporting Limit	Units	Dilution	Batch	Prepared	Analyzed	Method	Notes
Benzene	ND	0.0050	mg/kg	1	1083104	08/31/11	08/31/11	EPA 8260B	
Toluene	ND	0.0050	"	"	"	"	"	"	
Ethylbenzene	ND	0.0050	"	"	"	"	"	"	
Xylenes (total)	ND	0.0050	"	"	"	"	"	"	
Gasoline Range Hydrocarbons	ND	0.50	"	"	"	"	"	"	

Date Sampled: 08/30/11 17:55

Analyte	Result	Reporting Limit	Units	Dilution	Batch	Prepared	Analyzed	Method	Notes
Surrogate: 1,2-Dichloroethane-d4		109 %	67.4-143		"	"	"	"	
Surrogate: Toluene-d8		99.5 %	77.3-114		"	"	"	"	
Surrogate: 4-Bromofluorobenzene		93.7 %	78.4-125		"	"	"	"	

TCLP Metals by EPA SW846 7471

Date Sampled: 08/30/11 17:55

Analyte	Result	Reporting Limit	Units	Dilution	Batch	Prepared	Analyzed	Method	Notes
---------	--------	-----------------	-------	----------	-------	----------	----------	--------	-------

Summit Scientific

The results in this report apply to the samples analyzed in accordance with the chain of custody document. This analytical report must be reproduced in its entirety.

S₂

Trihydro Corporation
1252 Commerce Dr.
Laramie WY, 82070

Project: Greater DJ Basin
Project Number: 11X-006-001
Project Manager: Laurie Heath

Reported:
09/08/11 09:27

PitPost_Christner_C039_South
R108195-10 (Soil)

Summit Scientific

TCLP Metals by EPA SW846 7471

Arsenic	ND	0.100	mg/L in Extract	1	1090108	09/04/11	09/07/11	EPA 6020
---------	----	-------	--------------------	---	---------	----------	----------	----------

Total Metals by EPA SW846 Method 6020 - Dry Weight Basis

Date Sampled: 08/30/11 17:55

Analyte	Result	Reporting Limit	Units	Dilution	Batch	Prepared	Analyzed	Method	Notes
Arsenic	1.21	0.0679	mg/kg	1	1083103	08/31/11	08/31/11	EPA 6020	

Date Sampled: 08/30/11 17:55

Analyte	Result	Reporting Limit	Units	Dilution	Batch	Prepared	Analyzed	Method	Notes
Barium	24.6	3.39	"	"	"	"	"	"	

Summit Scientific

The results in this report apply to the samples analyzed in accordance with the chain of custody document. This analytical report must be reproduced in its entirety.



S₂

Trihydro Corporation
1252 Commerce Dr.
Laramie WY, 82070

Project: Greater DJ Basin
Project Number: 11X-006-001
Project Manager: Laurie Heath

Reported:
09/08/11 09:27

Extractable Petroleum Hydrocarbons by 8015 - Quality Control
Summit Scientific

Analyte	Reporting			Spike	Source		%REC		RPD	
	Result	Limit	Units	Level	Result	%REC	Limits	RPD	Limit	Notes

Batch 1083105 - EPA 3550A

Blank (1083105-BLK1)				Prepared & Analyzed: 08/31/11						
C10-C28 (TEPH-DRO)	ND	50	mg/kg							
C28-C36 (TEPH-ORO)	ND	50	"							
Surrogate: o-Terphenyl	13.3		"	12.5		107	88.8-124			
LCS (1083105-BS1)				Prepared & Analyzed: 08/31/11						
C10-C28 (TEPH-DRO)	481	50	mg/kg	501		96.1	85-129		11.8	
LCS Dup (1083105-BSD1)				Prepared & Analyzed: 08/31/11						
C10-C28 (TEPH-DRO)	481	50	mg/kg	501		96.1	85-129	0.0227	11.8	
Matrix Spike (1083105-MS1)				Source: R108195-09		Prepared & Analyzed: 08/31/11				
C10-C28 (TEPH-DRO)	487	50	mg/kg	501	25.6	92.0	77.3-134		8.39	
Matrix Spike Dup (1083105-MSD1)				Source: R108195-09		Prepared & Analyzed: 08/31/11				
C10-C28 (TEPH-DRO)	507	50	mg/kg	501	25.6	96.0	77.3-134	4.00	8.39	

Summit Scientific

The results in this report apply to the samples analyzed in accordance with the chain of custody document. This analytical report must be reproduced in its entirety.



S₂

Trihydro Corporation
1252 Commerce Dr.
Laramie WY, 82070

Project: Greater DJ Basin
Project Number: 11X-006-001
Project Manager: Laurie Heath

Reported:
09/08/11 09:27

Volatile Organic Compounds by EPA Method 8260B - Quality Control
Summit Scientific

Analyte	Reporting			Spike Level	Source		%REC		RPD	
	Result	Limit	Units		Result	%REC	Limits	RPD	Limit	Notes

Batch 1083104 - EPA 5030 Soil MS

Blank (1083104-BLK1)

Prepared & Analyzed: 08/31/11

Benzene	ND	0.0050	mg/kg							
Toluene	ND	0.0050	"							
Ethylbenzene	ND	0.0050	"							
Xylenes (total)	ND	0.0050	"							
Gasoline Range Hydrocarbons	ND	0.50	"							
Surrogate: 1,2-Dichloroethane-d4	0.0379		"	0.0400		94.6	67.4-143			
Surrogate: Toluene-d8	0.0387		"	0.0400		96.8	77.3-114			
Surrogate: 4-Bromofluorobenzene	0.0377		"	0.0400		94.4	78.4-125			

LCS (1083104-BS1)

Prepared & Analyzed: 08/31/11

Benzene	0.0965	0.0050	mg/kg	0.100		96.5	61-139		11.1	
Toluene	0.103	0.0050	"	0.100		103	64-132		10.9	
Ethylbenzene	0.110	0.0050	"	0.100		110	68.7-135		20	
m,p-Xylene	0.221	0.010	"	0.200		110	70.4-129		20	
o-Xylene	0.104	0.0050	"	0.100		104	66.9-126		20	
Surrogate: 1,2-Dichloroethane-d4	0.0383		"	0.0400		95.8	67.4-143			
Surrogate: Toluene-d8	0.0382		"	0.0400		95.4	77.3-114			
Surrogate: 4-Bromofluorobenzene	0.0366		"	0.0400		91.4	78.4-125			

LCS Dup (1083104-BSD1)

Prepared & Analyzed: 08/31/11

Benzene	0.0948	0.0050	mg/kg	0.100		94.8	61-139	1.72	11.1	
Toluene	0.101	0.0050	"	0.100		101	64-132	2.09	10.9	
Ethylbenzene	0.108	0.0050	"	0.100		108	68.7-135	1.62	20	
m,p-Xylene	0.216	0.010	"	0.200		108	70.4-129	2.39	20	
o-Xylene	0.103	0.0050	"	0.100		103	66.9-126	0.838	20	
Surrogate: 1,2-Dichloroethane-d4	0.0395		"	0.0400		98.8	67.4-143			
Surrogate: Toluene-d8	0.0393		"	0.0400		98.2	77.3-114			
Surrogate: 4-Bromofluorobenzene	0.0377		"	0.0400		94.4	78.4-125			

Summit Scientific

The results in this report apply to the samples analyzed in accordance with the chain of custody document. This analytical report must be reproduced in its entirety.



S₂

Trihydro Corporation
1252 Commerce Dr.
Laramie WY, 82070

Project: Greater DJ Basin
Project Number: 11X-006-001
Project Manager: Laurie Heath

Reported:
09/08/11 09:27

Volatile Organic Compounds by EPA Method 8260B - Quality Control
Summit Scientific

Analyte	Reporting			Spike	Source		%REC		RPD	
	Result	Limit	Units	Level	Result	%REC	Limits	RPD	Limit	Notes

Batch 1083104 - EPA 5030 Soil MS

Matrix Spike (1083104-MS1)			Source: R108195-09		Prepared & Analyzed: 08/31/11					
Benzene	0.0963	0.0050	mg/kg	0.100	ND	96.3	42.9-137		17.9	
Toluene	0.102	0.0050	"	0.100	ND	102	42.6-130		11.9	
Ethylbenzene	0.109	0.0050	"	0.100	ND	109	39-133		20	
m,p-Xylene	0.220	0.010	"	0.200	ND	110	34.7-134		20	
o-Xylene	0.107	0.0050	"	0.100	ND	107	41.3-126		20	
Surrogate: 1,2-Dichloroethane-d4	0.0429		"	0.0400		107	67.4-143			
Surrogate: Toluene-d8	0.0396		"	0.0400		99.1	77.3-114			
Surrogate: 4-Bromofluorobenzene	0.0386		"	0.0400		96.4	78.4-125			
Matrix Spike Dup (1083104-MSD1)			Source: R108195-09		Prepared & Analyzed: 08/31/11					
Benzene	0.0962	0.0050	mg/kg	0.100	ND	96.2	42.9-137	0.0935	17.9	
Toluene	0.101	0.0050	"	0.100	ND	101	42.6-130	0.325	11.9	
Ethylbenzene	0.109	0.0050	"	0.100	ND	109	39-133	0.220	20	
m,p-Xylene	0.218	0.010	"	0.200	ND	109	34.7-134	0.933	20	
o-Xylene	0.104	0.0050	"	0.100	ND	104	41.3-126	2.13	20	
Surrogate: 1,2-Dichloroethane-d4	0.0436		"	0.0400		109	67.4-143			
Surrogate: Toluene-d8	0.0394		"	0.0400		98.5	77.3-114			
Surrogate: 4-Bromofluorobenzene	0.0401		"	0.0400		100	78.4-125			

Summit Scientific

The results in this report apply to the samples analyzed in accordance with the chain of custody document. This analytical report must be reproduced in its entirety.



S₂

Trihydro Corporation
1252 Commerce Dr.
Laramie WY, 82070

Project: Greater DJ Basin
Project Number: 11X-006-001
Project Manager: Laurie Heath

Reported:
09/08/11 09:27

TCLP Metals by EPA SW846 7471 - Quality Control
Summit Scientific

Analyte	Reporting			Spike	Source		%REC		RPD	
	Result	Limit	Units	Level	Result	%REC	Limits	RPD	Limit	Notes

Batch 1090108 - EPA 1311

Blank (1090108-BLK1)

Prepared: 09/04/11 Analyzed: 09/07/11

Arsenic ND 0.100 mg/L in Extract

LCS (1090108-BS1)

Prepared: 09/04/11 Analyzed: 09/07/11

Arsenic 0.399 0.100 mg/L in Extract 0.400 99.7 80-120 20

Matrix Spike (1090108-MS1)

Source: R108195-09

Prepared: 09/04/11 Analyzed: 09/07/11

Arsenic 0.400 0.100 mg/L in Extract 0.400 0.00241 99.3 75-125 25

Matrix Spike Dup (1090108-MSD1)

Source: R108195-09

Prepared: 09/04/11 Analyzed: 09/07/11

Arsenic 0.398 0.100 mg/L in Extract 0.400 0.00241 98.9 75-125 0.363 25

Summit Scientific

The results in this report apply to the samples analyzed in accordance with the chain of custody document. This analytical report must be reproduced in its entirety.



S₂

Trihydro Corporation
1252 Commerce Dr.
Laramie WY, 82070

Project: Greater DJ Basin
Project Number: 11X-006-001
Project Manager: Laurie Heath

Reported:
09/08/11 09:27

Total Metals by EPA SW846 Method 6020 - Dry Weight Basis - Quality Control
Summit Scientific

Analyte	Reporting			Spike Level	Source		%REC		RPD	
	Result	Limit	Units		Result	%REC	Limits	RPD	Limit	Notes

Batch 1083103 - EPA 3050B

Blank (1083103-BLK1)

Prepared & Analyzed: 08/31/11

Arsenic	ND	0.100	mg/kg
Barium	ND	5.00	"

LCS (1083103-BS1)

Prepared & Analyzed: 08/31/11

Arsenic	2.20	0.100	mg/kg	2.50	87.9	80-120	20
Barium	225	5.00	"	224	100	80-120	20

LCS Dup (1083103-BSD1)

Prepared & Analyzed: 08/31/11

Arsenic	2.24	0.100	mg/kg	2.50	89.5	80-120	1.76	20
Barium	229	5.00	"	224	102	80-120	1.90	20

Matrix Spike (1083103-MS1)

Source: R108195-01

Prepared & Analyzed: 08/31/11

Arsenic	2.64	0.0821	mg/kg	2.06	1.40	60.3	75-125	20	QM-07
Barium	185	4.11	"	184	21.3	89.0	75-125	20	

Matrix Spike Dup (1083103-MSD1)

Source: R108195-01

Prepared & Analyzed: 08/31/11

Arsenic	2.88	0.0849	mg/kg	2.13	1.40	69.4	75-125	8.55	20	QM-07
Barium	186	4.25	"	191	21.3	86.3	75-125	0.289	20	

Summit Scientific

The results in this report apply to the samples analyzed in accordance with the chain of custody document. This analytical report must be reproduced in its entirety.



S₂

Trihydro Corporation
1252 Commerce Dr.
Laramie WY, 82070

Project: Greater DJ Basin
Project Number: 11X-006-001
Project Manager: Laurie Heath

Reported:
09/08/11 09:27

Notes and Definitions

QM-07 The spike recovery was outside acceptance limits for the MS and/or MSD. The batch was accepted based on acceptable LCS/LCSD recovery.

DET Analyte DETECTED

ND Analyte NOT DETECTED at or above the reporting limit

NR Not Reported

dry Sample results reported on a dry weight basis

RPD Relative Percent Difference

Summit Scientific

The results in this report apply to the samples analyzed in accordance with the chain of custody document. This analytical report must be reproduced in its entirety.



Summit Scientific

741 Corporate Circle – Suite I ♦ Golden, Colorado 80401

303.277.9310 - laboratory ♦ 303.277.9531 - fax

October 17, 2011

Mike Ogden
Trihydro Corporation
1252 Commerce Dr.
Laramie, WY 82070
RE: Greater DJ Basin

Enclosed are the results of analyses for samples received by Summit Scientific on 09/10/11 13:00. If you have any questions concerning this report, please feel free to contact me.

Sincerely,



Paul Shrewsbury For Ben Shrewsbury
President / Laboratory Director

S₂

Trihydro Corporation
1252 Commerce Dr.
Laramie WY, 82070

Project: Greater DJ Basin
Project Number: 11X-006-001 Task C035+C037
Project Manager: Mike Ogden

Reported:
10/17/11 08:11

ANALYTICAL REPORT FOR SAMPLES

Sample ID	Laboratory ID	Matrix	Date Sampled	Date Received
PitPost_Bellmore_C035_East	R109065-01	Soil	09/09/11 08:50	09/10/11 13:00
PitPost_Bellmore_C035_West	R109065-02	Soil	09/09/11 08:50	09/10/11 13:00
PitPost_Eichhem_C037_N	R109065-03	Soil	09/09/11 08:20	09/10/11 13:00
PitPost_Eichhem_C037_S	R109065-04	Soil	09/09/11 08:10	09/10/11 13:00

Summit Scientific

The results in this report apply to the samples analyzed in accordance with the chain of custody document. This analytical report must be reproduced in its entirety.



S₂

Trihydro Corporation
1252 Commerce Dr.
Laramie WY, 82070

Project: Greater DJ Basin
Project Number: 11X-006-001 Task C035+C037
Project Manager: Mike Ogden

Reported:
10/17/11 08:11

CASE NARRATIVE

Four soil samples were received at Summit Scientific's Laboratory on September 10, 2011 at 13:00 via courier. The samples arrived on ice in good condition at a temperature of 5.1 C.

Method 8260B

All of the samples were analyzed for gasoline range organics in accordance with EPA SW846 Method 8260B.

Method 8015M

All of the soil samples were analyzed for diesel and residual range organics in accordance with EPA SW846 Method 8015M..

Method 6020/7471

All the samples were analyzed for Total As and for TCLP As metals in accordance with EPA SW846 Method 6020/7471. Sample PitPost_Eichhem_C037_N was reanalyzed and the new data was included in this report.

QA/QC

The following qualifiers were used for these samples.

QM-07 was used for *As MS1*. The spike recovery was outside acceptance limits for the MS and/or MSD. The batch was accepted based on acceptable LCS/LCSD recovery.

Summit Scientific

The results in this report apply to the samples analyzed in accordance with the chain of custody document. This analytical report must be reproduced in its entirety.



Trihydro Corporation
1252 Commerce Dr.
Laramie WY, 82070

Project: Greater DJ Basin

Project Number: 11X-006-001 Task C035+C037

Project Manager: Mike Ogden

Reported:

10/17/11 08:11

Summit Scientific 2/19/05

741 Corporate Circle Suite I • Golden, Colorado 80401
303-277-9310 • 303-277-9531 Fax

Page of

Client: Trihydro Corporation

Address: 1252 Commerce Dr.

City/State/Zip: Laramie, WY 82070

Phone: 307-745-7474

1771-CH1-10C.WM

Sampler Name: W/10 CBL

Project Number: 11X-006-001 ~~000~~ Task CO35 + CO37

[illegible]

www.s2scientific.com

Summit Scientific

The results in this report apply to the samples analyzed in accordance with the chain of custody document. This analytical report must be reproduced in its entirety.

S₂

Trihydro Corporation
1252 Commerce Dr.
Laramie WY, 82070

Project: Greater DJ Basin
Project Number: 11X-006-001 Task C035+C037
Project Manager: Mike Ogden

Reported:
10/17/11 08:11

PitPost_Bellmore_C035_East
R109065-01 (Soil)

Summit Scientific

Extractable Petroleum Hydrocarbons by 8015

Date Sampled: 09/09/11 08:50

Analyte	Result	Reporting Limit	Units	Dilution	Batch	Prepared	Analyzed	Method	Notes
C10-C28 (TEPH-DRO)	ND	50	mg/kg	1	1091303	09/13/11	09/13/11	8015 Full Carbon Chain	
C28-C36 (TEPH-ORO)	ND	50	"	"	"	"	"	"	

Date Sampled: 09/09/11 08:50

Analyte	Result	Reporting Limit	Units	Dilution	Batch	Prepared	Analyzed	Method	Notes
Surrogate: o-Terphenyl		95.5 %	88.8-124		"	"	"	"	

Volatile Organic Compounds by EPA Method 8260B

Date Sampled: 09/09/11 08:50

Analyte	Result	Reporting Limit	Units	Dilution	Batch	Prepared	Analyzed	Method	Notes
Benzene	ND	0.0050	mg/kg	1	1091302	09/13/11	09/13/11	EPA 8260B	
Toluene	ND	0.0050	"	"	"	"	"	"	
Ethylbenzene	ND	0.0050	"	"	"	"	"	"	
Xylenes (total)	ND	0.0050	"	"	"	"	"	"	
Gasoline Range Hydrocarbons	ND	0.50	"	"	"	"	"	"	

Date Sampled: 09/09/11 08:50

Analyte	Result	Reporting Limit	Units	Dilution	Batch	Prepared	Analyzed	Method	Notes
Surrogate: 1,2-Dichloroethane-d4		112 %	67.4-143		"	"	"	"	
Surrogate: Toluene-d8		98.8 %	77.3-114		"	"	"	"	
Surrogate: 4-Bromofluorobenzene		98.8 %	78.4-125		"	"	"	"	

TCLP Metals by EPA SW846 6020/7471

Date Sampled: 09/09/11 08:50

Analyte	Result	Reporting Limit	Units	Dilution	Batch	Prepared	Analyzed	Method	Notes
---------	--------	-----------------	-------	----------	-------	----------	----------	--------	-------

Summit Scientific

The results in this report apply to the samples analyzed in accordance with the chain of custody document. This analytical report must be reproduced in its entirety.



S₂

Trihydro Corporation
1252 Commerce Dr.
Laramie WY, 82070

Project: Greater DJ Basin
Project Number: 11X-006-001 Task C035+C037
Project Manager: Mike Ogden

Reported:
10/17/11 08:11

PitPost_Bellmore_C035_East
R109065-01 (Soil)

Summit Scientific

TCLP Metals by EPA SW846 6020/7471

Arsenic	ND	0.100	mg/L in Extract	1	1091204	09/12/11	09/12/11	EPA 6020
---------	----	-------	--------------------	---	---------	----------	----------	----------

Total Metals by EPA SW846 Method 6020 - Dry Weight Basis

Date Sampled: 09/09/11 08:50

Analyte	Result	Reporting Limit	Units	Dilution	Batch	Prepared	Analyzed	Method	Notes
Arsenic	0.994	0.0784	mg/kg	1	1091205	09/12/11	09/13/11	EPA 6020	

Summit Scientific

The results in this report apply to the samples analyzed in accordance with the chain of custody document. This analytical report must be reproduced in its entirety.



S₂

Trihydro Corporation
1252 Commerce Dr.
Laramie WY, 82070

Project: Greater DJ Basin
Project Number: 11X-006-001 Task C035+C037
Project Manager: Mike Ogden

Reported:
10/17/11 08:11

PitPost_Bellmore_C035_West
R109065-02 (Soil)

Summit Scientific

Extractable Petroleum Hydrocarbons by 8015

Date Sampled: 09/09/11 08:50

Analyte	Result	Reporting Limit	Units	Dilution	Batch	Prepared	Analyzed	Method	Notes
C10-C28 (TEPH-DRO)	ND	50	mg/kg	1	1091303	09/13/11	09/13/11	8015 Full Carbon Chain	
C28-C36 (TEPH-ORO)	ND	50	"	"	"	"	"	"	

Date Sampled: 09/09/11 08:50

Analyte	Result	Reporting Limit	Units	Dilution	Batch	Prepared	Analyzed	Method	Notes
Surrogate: o-Terphenyl		97.5 %	88.8-124		"	"	"	"	

Volatile Organic Compounds by EPA Method 8260B

Date Sampled: 09/09/11 08:50

Analyte	Result	Reporting Limit	Units	Dilution	Batch	Prepared	Analyzed	Method	Notes
Benzene	ND	0.0050	mg/kg	1	1091302	09/13/11	09/13/11	EPA 8260B	
Toluene	ND	0.0050	"	"	"	"	"	"	
Ethylbenzene	ND	0.0050	"	"	"	"	"	"	
Xylenes (total)	ND	0.0050	"	"	"	"	"	"	
Gasoline Range Hydrocarbons	ND	0.50	"	"	"	"	"	"	

Date Sampled: 09/09/11 08:50

Analyte	Result	Reporting Limit	Units	Dilution	Batch	Prepared	Analyzed	Method	Notes
Surrogate: 1,2-Dichloroethane-d4		112 %	67.4-143		"	"	"	"	
Surrogate: Toluene-d8		98.1 %	77.3-114		"	"	"	"	
Surrogate: 4-Bromofluorobenzene		97.3 %	78.4-125		"	"	"	"	

TCLP Metals by EPA SW846 6020/7471

Date Sampled: 09/09/11 08:50

Analyte	Result	Reporting Limit	Units	Dilution	Batch	Prepared	Analyzed	Method	Notes
---------	--------	-----------------	-------	----------	-------	----------	----------	--------	-------

Summit Scientific

The results in this report apply to the samples analyzed in accordance with the chain of custody document. This analytical report must be reproduced in its entirety.



S₂

Trihydro Corporation
1252 Commerce Dr.
Laramie WY, 82070

Project: Greater DJ Basin
Project Number: 11X-006-001 Task C035+C037
Project Manager: Mike Ogden

Reported:
10/17/11 08:11

PitPost_Bellmore_C035_West
R109065-02 (Soil)

Summit Scientific

TCLP Metals by EPA SW846 6020/7471

Arsenic	ND	0.100	mg/L in Extract	1	1091204	09/12/11	09/12/11	EPA 6020
---------	----	-------	--------------------	---	---------	----------	----------	----------

Total Metals by EPA SW846 Method 6020 - Dry Weight Basis

Date Sampled: 09/09/11 08:50

Analyte	Result	Reporting Limit	Units	Dilution	Batch	Prepared	Analyzed	Method	Notes
Arsenic	2.61	0.0798	mg/kg	1	1091205	09/12/11	09/13/11	EPA 6020	

Summit Scientific

The results in this report apply to the samples analyzed in accordance with the chain of custody document. This analytical report must be reproduced in its entirety.



S₂

Trihydro Corporation
1252 Commerce Dr.
Laramie WY, 82070

Project: Greater DJ Basin
Project Number: 11X-006-001 Task C035+C037
Project Manager: Mike Ogden

Reported:
10/17/11 08:11

PitPost_Eichhem_C037_N
R109065-03 (Soil)

Summit Scientific

Extractable Petroleum Hydrocarbons by 8015

Date Sampled: 09/09/11 08:20

Analyte	Result	Reporting Limit	Units	Dilution	Batch	Prepared	Analyzed	Method	Notes
C10-C28 (TEPH-DRO)	ND	50	mg/kg	1	1091303	09/13/11	09/13/11	8015 Full Carbon Chain	
C28-C36 (TEPH-ORO)	ND	50	"	"	"	"	"	"	

Date Sampled: 09/09/11 08:20

Analyte	Result	Reporting Limit	Units	Dilution	Batch	Prepared	Analyzed	Method	Notes
Surrogate: o-Terphenyl		97.4 %	88.8-124		"	"	"	"	

Volatile Organic Compounds by EPA Method 8260B

Date Sampled: 09/09/11 08:20

Analyte	Result	Reporting Limit	Units	Dilution	Batch	Prepared	Analyzed	Method	Notes
Benzene	ND	0.0050	mg/kg	1	1091302	09/13/11	09/13/11	EPA 8260B	
Toluene	ND	0.0050	"	"	"	"	"	"	
Ethylbenzene	ND	0.0050	"	"	"	"	"	"	
Xylenes (total)	ND	0.0050	"	"	"	"	"	"	
Gasoline Range Hydrocarbons	ND	0.50	"	"	"	"	"	"	

Date Sampled: 09/09/11 08:20

Analyte	Result	Reporting Limit	Units	Dilution	Batch	Prepared	Analyzed	Method	Notes
Surrogate: 1,2-Dichloroethane-d4		111 %	67.4-143		"	"	"	"	
Surrogate: Toluene-d8		98.0 %	77.3-114		"	"	"	"	
Surrogate: 4-Bromofluorobenzene		97.6 %	78.4-125		"	"	"	"	

TCLP Metals by EPA SW846 6020/7471

Date Sampled: 09/09/11 08:20

Analyte	Result	Reporting Limit	Units	Dilution	Batch	Prepared	Analyzed	Method	Notes
---------	--------	-----------------	-------	----------	-------	----------	----------	--------	-------

Summit Scientific

The results in this report apply to the samples analyzed in accordance with the chain of custody document. This analytical report must be reproduced in its entirety.



S₂

Trihydro Corporation
1252 Commerce Dr.
Laramie WY, 82070

Project: Greater DJ Basin
Project Number: 11X-006-001 Task C035+C037
Project Manager: Mike Ogden

Reported:
10/17/11 08:11

PitPost_Eichhem_C037_N
R109065-03 (Soil)

Summit Scientific

TCLP Metals by EPA SW846 6020/7471

Arsenic	ND	0.100	mg/L in Extract	1	1091204	09/12/11	09/12/11	EPA 6020
---------	----	-------	--------------------	---	---------	----------	----------	----------

Total Metals by EPA SW846 Method 6020 - Dry Weight Basis

Date Sampled: 09/09/11 08:20

Analyte	Result	Reporting Limit	Units	Dilution	Batch	Prepared	Analyzed	Method	Notes
Arsenic	3.37	0.0738	mg/kg	1	1091205	09/12/11	09/13/11	EPA 6020	

Summit Scientific

The results in this report apply to the samples analyzed in accordance with the chain of custody document. This analytical report must be reproduced in its entirety.



S₂

Trihydro Corporation
1252 Commerce Dr.
Laramie WY, 82070

Project: Greater DJ Basin
Project Number: 11X-006-001 Task C035+C037
Project Manager: Mike Ogden

Reported:
10/17/11 08:11

PitPost_Eichhem_C037_S
R109065-04 (Soil)

Summit Scientific

Extractable Petroleum Hydrocarbons by 8015

Date Sampled: 09/09/11 08:10

Analyte	Result	Reporting Limit	Units	Dilution	Batch	Prepared	Analyzed	Method	Notes
C10-C28 (TEPH-DRO)	ND	50	mg/kg	1	1091303	09/13/11	09/13/11	8015 Full Carbon Chain	
C28-C36 (TEPH-ORO)	ND	50	"	"	"	"	"	"	

Date Sampled: 09/09/11 08:10

Analyte	Result	Reporting Limit	Units	Dilution	Batch	Prepared	Analyzed	Method	Notes
Surrogate: o-Terphenyl		97.8 %	88.8-124		"	"	"	"	

Volatile Organic Compounds by EPA Method 8260B

Date Sampled: 09/09/11 08:10

Analyte	Result	Reporting Limit	Units	Dilution	Batch	Prepared	Analyzed	Method	Notes
Benzene	ND	0.0050	mg/kg	1	1091302	09/13/11	09/13/11	EPA 8260B	
Toluene	ND	0.0050	"	"	"	"	"	"	
Ethylbenzene	ND	0.0050	"	"	"	"	"	"	
Xylenes (total)	ND	0.0050	"	"	"	"	"	"	
Gasoline Range Hydrocarbons	ND	0.50	"	"	"	"	"	"	

Date Sampled: 09/09/11 08:10

Analyte	Result	Reporting Limit	Units	Dilution	Batch	Prepared	Analyzed	Method	Notes
Surrogate: 1,2-Dichloroethane-d4		115 %	67.4-143		"	"	"	"	
Surrogate: Toluene-d8		97.1 %	77.3-114		"	"	"	"	
Surrogate: 4-Bromofluorobenzene		96.8 %	78.4-125		"	"	"	"	

TCLP Metals by EPA SW846 6020/7471

Date Sampled: 09/09/11 08:10

Analyte	Result	Reporting Limit	Units	Dilution	Batch	Prepared	Analyzed	Method	Notes
---------	--------	-----------------	-------	----------	-------	----------	----------	--------	-------

Summit Scientific

The results in this report apply to the samples analyzed in accordance with the chain of custody document. This analytical report must be reproduced in its entirety.



S₂

Trihydro Corporation
1252 Commerce Dr.
Laramie WY, 82070

Project: Greater DJ Basin
Project Number: 11X-006-001 Task C035+C037
Project Manager: Mike Ogden

Reported:
10/17/11 08:11

PitPost_Eichhem_C037_S
R109065-04 (Soil)

Summit Scientific

TCLP Metals by EPA SW846 6020/7471

Arsenic	ND	0.100	mg/L in Extract	1	1091204	09/12/11	09/12/11	EPA 6020
---------	----	-------	--------------------	---	---------	----------	----------	----------

Total Metals by EPA SW846 Method 6020 - Dry Weight Basis

Date Sampled: 09/09/11 08:10

Analyte	Result	Reporting Limit	Units	Dilution	Batch	Prepared	Analyzed	Method	Notes
Arsenic	1.51	0.0844	mg/kg	1	1091205	09/12/11	09/13/11	EPA 6020	

Summit Scientific

The results in this report apply to the samples analyzed in accordance with the chain of custody document. This analytical report must be reproduced in its entirety.



S₂

Trihydro Corporation
1252 Commerce Dr.
Laramie WY, 82070

Project: Greater DJ Basin
Project Number: 11X-006-001 Task C035+C037
Project Manager: Mike Ogden

Reported:
10/17/11 08:11

Extractable Petroleum Hydrocarbons by 8015 - Quality Control
Summit Scientific

Analyte	Reporting			Spike	Source		%REC		RPD	
	Result	Limit	Units	Level	Result	%REC	Limits	RPD	Limit	Notes

Batch 1091303 - EPA 3550A

Blank (1091303-BLK1)

Prepared & Analyzed: 09/13/11

C10-C28 (TEPH-DRO) ND 50 mg/kg

C28-C36 (TEPH-ORO) ND 50 "

Surrogate: o-Terphenyl 11.9 " 12.5 95.1 88.8-124

LCS (1091303-BS1)

Prepared & Analyzed: 09/13/11

C10-C28 (TEPH-DRO) 463 50 mg/kg 501 92.4 85-129 11.8

LCS Dup (1091303-BSD1)

Prepared & Analyzed: 09/13/11

C10-C28 (TEPH-DRO) 458 50 mg/kg 501 91.5 85-129 1.06 11.8

Matrix Spike (1091303-MS1)

Source: R109065-01

Prepared & Analyzed: 09/13/11

C10-C28 (TEPH-DRO) 486 50 mg/kg 501 24.8 92.1 77.3-134 8.39

Summit Scientific

The results in this report apply to the samples analyzed in accordance with the chain of custody document. This analytical report must be reproduced in its entirety.



S₂

Trihydro Corporation
1252 Commerce Dr.
Laramie WY, 82070

Project: Greater DJ Basin
Project Number: 11X-006-001 Task C035+C037
Project Manager: Mike Ogden

Reported:
10/17/11 08:11

Volatile Organic Compounds by EPA Method 8260B - Quality Control
Summit Scientific

Analyte	Reporting			Spike Level	Source		%REC		RPD	
	Result	Limit	Units		Result	%REC	Limits	RPD	Limit	Notes

Batch 1091302 - EPA 5030 Soil MS

Blank (1091302-BLK1)

Prepared & Analyzed: 09/13/11

Benzene	ND	0.0050	mg/kg							
Toluene	ND	0.0050	"							
Ethylbenzene	ND	0.0050	"							
Xylenes (total)	ND	0.0050	"							
Gasoline Range Hydrocarbons	ND	0.50	"							
Surrogate: 1,2-Dichloroethane-d4	0.0413		"	0.0400	103	67.4-143				
Surrogate: Toluene-d8	0.0386		"	0.0400	96.5	77.3-114				
Surrogate: 4-Bromofluorobenzene	0.0389		"	0.0400	97.2	78.4-125				

LCS (1091302-BS1)

Prepared & Analyzed: 09/13/11

Benzene	0.0893	0.0050	mg/kg	0.100	89.3	61-139		11.1		
Toluene	0.0982	0.0050	"	0.100	98.2	64-132		10.9		
Ethylbenzene	0.103	0.0050	"	0.100	103	68.7-135		20		
m,p-Xylene	0.218	0.010	"	0.200	109	70.4-129		20		
o-Xylene	0.0969	0.0050	"	0.100	96.9	66.9-126		20		
Surrogate: 1,2-Dichloroethane-d4	0.0419		"	0.0400	105	67.4-143				
Surrogate: Toluene-d8	0.0396		"	0.0400	99.0	77.3-114				
Surrogate: 4-Bromofluorobenzene	0.0388		"	0.0400	96.9	78.4-125				

LCS Dup (1091302-BSD1)

Prepared & Analyzed: 09/13/11

Benzene	0.0935	0.0050	mg/kg	0.100	93.5	61-139	4.63	11.1		
Toluene	0.100	0.0050	"	0.100	100	64-132	2.00	10.9		
Ethylbenzene	0.105	0.0050	"	0.100	105	68.7-135	1.85	20		
m,p-Xylene	0.221	0.010	"	0.200	110	70.4-129	1.16	20		
o-Xylene	0.0991	0.0050	"	0.100	99.1	66.9-126	2.27	20		
Surrogate: 1,2-Dichloroethane-d4	0.0422		"	0.0400	106	67.4-143				
Surrogate: Toluene-d8	0.0389		"	0.0400	97.3	77.3-114				
Surrogate: 4-Bromofluorobenzene	0.0388		"	0.0400	97.0	78.4-125				

Summit Scientific

The results in this report apply to the samples analyzed in accordance with the chain of custody document. This analytical report must be reproduced in its entirety.



S₂

Trihydro Corporation
1252 Commerce Dr.
Laramie WY, 82070

Project: Greater DJ Basin
Project Number: 11X-006-001 Task C035+C037
Project Manager: Mike Ogden

Reported:
10/17/11 08:11

Volatile Organic Compounds by EPA Method 8260B - Quality Control
Summit Scientific

Analyte	Reporting			Spike	Source	%REC		RPD	
	Result	Limit	Units	Level	Result	%REC	Limits	RPD	Limit

Batch 1091302 - EPA 5030 Soil MS

Matrix Spike (1091302-MS1)		Source: R109065-01			Prepared & Analyzed: 09/13/11				
Benzene	0.0936	0.0050	mg/kg	0.100	ND	93.6	42.9-137		17.9
Toluene	0.101	0.0050	"	0.100	ND	101	42.6-130		11.9
Ethylbenzene	0.103	0.0050	"	0.100	ND	103	39-133		20
m,p-Xylene	0.217	0.010	"	0.200	ND	109	34.7-134		20
o-Xylene	0.0972	0.0050	"	0.100	ND	97.2	41.3-126		20
Surrogate: 1,2-Dichloroethane-d4	0.0367		"	0.0400		91.7	67.4-143		
Surrogate: Toluene-d8	0.0397		"	0.0400		99.2	77.3-114		
Surrogate: 4-Bromofluorobenzene	0.0376		"	0.0400		94.0	78.4-125		
Matrix Spike Dup (1091302-MSD1)		Source: R109065-01			Prepared & Analyzed: 09/13/11				
Benzene	0.0938	0.0050	mg/kg	0.100	ND	93.8	42.9-137	0.192	17.9
Toluene	0.101	0.0050	"	0.100	ND	101	42.6-130	0.802	11.9
Ethylbenzene	0.102	0.0050	"	0.100	ND	102	39-133	0.526	20
m,p-Xylene	0.215	0.010	"	0.200	ND	108	34.7-134	0.956	20
o-Xylene	0.0973	0.0050	"	0.100	ND	97.3	41.3-126	0.0308	20
Surrogate: 1,2-Dichloroethane-d4	0.0462		"	0.0400		116	67.4-143		
Surrogate: Toluene-d8	0.0400		"	0.0400		100	77.3-114		
Surrogate: 4-Bromofluorobenzene	0.0399		"	0.0400		99.8	78.4-125		

Summit Scientific

The results in this report apply to the samples analyzed in accordance with the chain of custody document. This analytical report must be reproduced in its entirety.



S₂

Trihydro Corporation
1252 Commerce Dr.
Laramie WY, 82070

Project: Greater DJ Basin
Project Number: 11X-006-001 Task C035+C037
Project Manager: Mike Ogden

Reported:
10/17/11 08:11

TCLP Metals by EPA SW846 6020/7471 - Quality Control
Summit Scientific

Analyte	Reporting			Spike	Source		%REC		RPD	
	Result	Limit	Units	Level	Result	%REC	Limits	RPD	Limit	Notes

Batch 1091204 - EPA 1311

Blank (1091204-BLK1)

Prepared & Analyzed: 09/12/11

Arsenic ND 0.0250 mg/L in Extract

LCS (1091204-BS1)

Prepared & Analyzed: 09/12/11

Arsenic 0.0106 0.0250 mg/L in Extract 0.0101 104 80-120 20

LCS Dup (1091204-BSD1)

Prepared: 09/12/11 Analyzed: 09/14/11

Arsenic 0.0107 0.0250 mg/L in Extract 0.0101 106 80-120 1.10 20

Matrix Spike (1091204-MS1)

Source: R109065-04

Prepared & Analyzed: 09/12/11

Arsenic 0.0160 0.0250 mg/L in Extract 0.0101 0.00417 117 75-125 25

Matrix Spike Dup (1091204-MSD1)

Source: R109065-04

Prepared & Analyzed: 09/12/11

Arsenic 0.0149 0.0250 mg/L in Extract 0.0101 0.00417 107 75-125 6.78 25

Summit Scientific

The results in this report apply to the samples analyzed in accordance with the chain of custody document. This analytical report must be reproduced in its entirety.



S₂

Trihydro Corporation
1252 Commerce Dr.
Laramie WY, 82070

Project: Greater DJ Basin
Project Number: 11X-006-001 Task C035+C037
Project Manager: Mike Ogden

Reported:
10/17/11 08:11

Total Metals by EPA SW846 Method 6020 - Dry Weight Basis - Quality Control
Summit Scientific

Analyte	Reporting			Spike	Source		%REC		RPD	
	Result	Limit	Units	Level	Result	%REC	Limits	RPD	Limit	Notes

Batch 1091205 - EPA 3050B

Blank (1091205-BLK1)				Prepared: 09/12/11 Analyzed: 09/13/11						
Arsenic	ND	0.100	mg/kg							
LCS (1091205-BS1)				Prepared: 09/12/11 Analyzed: 09/13/11						
Arsenic	2.22	0.100	mg/kg	2.54		87.3	80-120		20	
LCS Dup (1091205-BSD1)				Prepared: 09/12/11 Analyzed: 09/13/11						
Arsenic	2.38	0.100	mg/kg	2.54		93.7	80-120	7.12	20	
Matrix Spike (1091205-MS1)				Source: R109061-08 Prepared: 09/12/11 Analyzed: 09/13/11						
Arsenic	11.4	0.0815	mg/kg	2.07	8.29	152	75-125		20	QM-07
Matrix Spike Dup (1091205-MSD1)				Source: R109061-08 Prepared: 09/12/11 Analyzed: 09/13/11						
Arsenic	10.4	0.0825	mg/kg	2.10	8.29	103	75-125	9.08	20	

Summit Scientific

The results in this report apply to the samples analyzed in accordance with the chain of custody document. This analytical report must be reproduced in its entirety.



S₂

Trihydro Corporation
1252 Commerce Dr.
Laramie WY, 82070

Project: Greater DJ Basin
Project Number: 11X-006-001 Task C035+C037
Project Manager: Mike Ogden

Reported:
10/17/11 08:11

Notes and Definitions

QM-07 The spike recovery was outside acceptance limits for the MS and/or MSD. The batch was accepted based on acceptable LCS/LCSD recovery.

DET Analyte DETECTED

ND Analyte NOT DETECTED at or above the reporting limit

NR Not Reported

dry Sample results reported on a dry weight basis

RPD Relative Percent Difference

Summit Scientific

The results in this report apply to the samples analyzed in accordance with the chain of custody document. This analytical report must be reproduced in its entirety.



Summit Scientific

741 Corporate Circle – Suite I ♦ Golden, Colorado 80401

303.277.9310 - laboratory ♦ 303.277.9531 - fax

September 08, 2011

Mike Ogden
Trihydro Corporation
1252 Commerce Dr.
Laramie, WY 82070
RE: Greater DJ Basin

Enclosed are the results of analyses for samples received by Summit Scientific on 09/02/11 20:28. If you have any questions concerning this report, please feel free to contact me.

Sincerely,



Paul Shrewsbury For Ben Shrewsbury
President / Laboratory Director

S₂

Trihydro Corporation
1252 Commerce Dr.
Laramie WY, 82070

Project: Greater DJ Basin
Project Number: 11X-006-001
Project Manager: Mike Ogden

Reported:
09/08/11 15:35

ANALYTICAL REPORT FOR SAMPLES

Sample ID	Laboratory ID	Matrix	Date Sampled	Date Received
PitPost_Turner_C041_North	R109021-01	Soil	09/02/11 18:15	09/02/11 20:28
PitPost_Turner_C041_South	R109021-02	Soil	09/02/11 18:15	09/02/11 20:28

Summit Scientific

The results in this report apply to the samples analyzed in accordance with the chain of custody document. This analytical report must be reproduced in its entirety.



S₂

Trihydro Corporation
1252 Commerce Dr.
Laramie WY, 82070

Project: Greater DJ Basin
Project Number: 11X-006-001
Project Manager: Mike Ogden

Reported:
09/08/11 15:35

CASE NARRATIVE

Two soil samples were received at Summit Scientific's Laboratory on September 2, 2011 at 20:28 via courier. The samples arrived on ice in good condition at a temperature of 5.1 C.

Method 8260B

All of the samples were analyzed for gasoline range organics in accordance with EPA SW846 Method 8260B.

Method 8015M

All of the soil samples were analyzed for diesel and residual range organics in accordance with EPA SW846 Method 8015M..

Method 6020/7471

All the samples were analyzed for Total As and Ba and TCLP As metals in accordance with EPA SW846 Method 6020/7471

QA/QC

The following qualifiers were used for these samples.

QM-07 was used for *As MSI*, *As*, *Ba MSDI*. The spike recovery was outside acceptance limits for the MS and/or MSD. The batch was accepted based on acceptable LCS/LCSD recovery.

Summit Scientific

The results in this report apply to the samples analyzed in accordance with the chain of custody document. This analytical report must be reproduced in its entirety.



Trihydro Corporation
1252 Commerce Dr.
Laramie WY, 82070

Project: Greater DJ Basin

Project Number: 11X-006-001
Project Manager: Mike Ogden

Reported:
09/08/11 15:35

Summit Scientific 2-109021

774 Corporate Circle Suite 1 • Golden, Colorado 80401
303-277-9310 • 303-277-9531 Fax

Page of

Client: Trihydro Corporation

Address: 1252 Commerce Dr.

City/State/Zip: Laramie, WY 82070

Phone: 307-745-7474 Fax: 307-745-7229

Sampler Name: Lung Health

Client: Trihydro Corporation
Address: 1751 Commerce Dr
Project Manager Luise Hahn

City/State/Zip: Laramie, WY 82070
E-Mail: lhealth@trj.hugob.com
Phone/fax/telex: 2001 1724 COUNTESS DT.

Phone: 307-745-7174 Fax: 307-745-7729 Project Name: ~~XXXXXXXXXX~~ Greater DJ

Project Number: 11X-000-001

[illegible]

www.s2scientific.com

Summit Scientific

The results in this report apply to the samples analyzed in accordance with the chain of custody document. This analytical report must be reproduced in its entirety.

S₂

Trihydro Corporation
1252 Commerce Dr.
Laramie WY, 82070

Project: Greater DJ Basin
Project Number: 11X-006-001
Project Manager: Mike Ogden

Reported:
09/08/11 15:35

PitPost_Turner_C041_North
R109021-01 (Soil)

Summit Scientific

Extractable Petroleum Hydrocarbons by 8015

Date Sampled: 09/02/11 18:15

Analyte	Result	Reporting Limit	Units	Dilution	Batch	Prepared	Analyzed	Method	Notes
C10-C28 (TEPH-DRO)	ND	50	mg/kg	1	1090302	09/03/11	09/04/11	8015 Full Carbon Chain	
C28-C36 (TEPH-ORO)	ND	50	"	"	"	"	"	"	

Date Sampled: 09/02/11 18:15

Analyte	Result	Reporting Limit	Units	Dilution	Batch	Prepared	Analyzed	Method	Notes
Surrogate: o-Terphenyl		103 %	88.8-124		"	"	"	"	

Volatile Organic Compounds by EPA Method 8260B

Date Sampled: 09/02/11 18:15

Analyte	Result	Reporting Limit	Units	Dilution	Batch	Prepared	Analyzed	Method	Notes
Benzene	ND	0.0050	mg/kg	1	1090301	09/03/11	09/04/11	EPA 8260B	
Toluene	ND	0.0050	"	"	"	"	"	"	
Ethylbenzene	ND	0.0050	"	"	"	"	"	"	
Xylenes (total)	ND	0.0050	"	"	"	"	"	"	
Gasoline Range Hydrocarbons	ND	0.50	"	"	"	"	"	"	

Date Sampled: 09/02/11 18:15

Analyte	Result	Reporting Limit	Units	Dilution	Batch	Prepared	Analyzed	Method	Notes
Surrogate: 1,2-Dichloroethane-d4		107 %	67.4-143		"	"	"	"	
Surrogate: Toluene-d8		98.2 %	77.3-114		"	"	"	"	
Surrogate: 4-Bromofluorobenzene		94.4 %	78.4-125		"	"	"	"	

TCLP Metals by EPA SW846 6020/7471

Date Sampled: 09/02/11 18:15

Analyte	Result	Reporting Limit	Units	Dilution	Batch	Prepared	Analyzed	Method	Notes
---------	--------	-----------------	-------	----------	-------	----------	----------	--------	-------

Summit Scientific

The results in this report apply to the samples analyzed in accordance with the chain of custody document. This analytical report must be reproduced in its entirety.



S₂

Trihydro Corporation
1252 Commerce Dr.
Laramie WY, 82070

Project: Greater DJ Basin
Project Number: 11X-006-001
Project Manager: Mike Ogden

Reported:
09/08/11 15:35

PitPost_Turner_C041_North
R109021-01 (Soil)

Summit Scientific

TCLP Metals by EPA SW846 6020/7471

Arsenic	ND	0.100	mg/L in Extract	1	1090108	09/04/11	09/07/11	EPA 6020
---------	----	-------	-----------------	---	---------	----------	----------	----------

Total Metals by EPA SW846 Method 6020 - Dry Weight Basis

Date Sampled: 09/02/11 18:15

Analyte	Result	Reporting Limit	Units	Dilution	Batch	Prepared	Analyzed	Method	Notes
Arsenic	1.76	0.100	mg/kg	1	1090401	09/04/11	09/07/11	EPA 6020	

Date Sampled: 09/02/11 18:15

Analyte	Result	Reporting Limit	Units	Dilution	Batch	Prepared	Analyzed	Method	Notes
Barium	28.5	5.00	"	"	"	"	"	"	

Summit Scientific

The results in this report apply to the samples analyzed in accordance with the chain of custody document. This analytical report must be reproduced in its entirety.



S₂

Trihydro Corporation
1252 Commerce Dr.
Laramie WY, 82070

Project: Greater DJ Basin
Project Number: 11X-006-001
Project Manager: Mike Ogden

Reported:
09/08/11 15:35

PitPost_Turner_C041_South
R109021-02 (Soil)

Summit Scientific

Extractable Petroleum Hydrocarbons by 8015

Date Sampled: 09/02/11 18:15

Analyte	Result	Reporting Limit	Units	Dilution	Batch	Prepared	Analyzed	Method	Notes
C10-C28 (TEPH-DRO)	ND	50	mg/kg	1	1090302	09/03/11	09/04/11	8015 Full Carbon Chain	
C28-C36 (TEPH-ORO)	ND	50	"	"	"	"	"	"	

Date Sampled: 09/02/11 18:15

Analyte	Result	Reporting Limit	Units	Dilution	Batch	Prepared	Analyzed	Method	Notes
Surrogate: <i>o</i> -Terphenyl		105 %	88.8-124		"	"	"	"	

Volatile Organic Compounds by EPA Method 8260B

Date Sampled: 09/02/11 18:15

Analyte	Result	Reporting Limit	Units	Dilution	Batch	Prepared	Analyzed	Method	Notes
Benzene	ND	0.0050	mg/kg	1	1090301	09/03/11	09/04/11	EPA 8260B	
Toluene	ND	0.0050	"	"	"	"	"	"	
Ethylbenzene	ND	0.0050	"	"	"	"	"	"	
Xylenes (total)	ND	0.0050	"	"	"	"	"	"	
Gasoline Range Hydrocarbons	ND	0.50	"	"	"	"	"	"	

Date Sampled: 09/02/11 18:15

Analyte	Result	Reporting Limit	Units	Dilution	Batch	Prepared	Analyzed	Method	Notes
Surrogate: 1,2-Dichloroethane-d4		111 %	67.4-143		"	"	"	"	
Surrogate: Toluene-d8		98.7 %	77.3-114		"	"	"	"	
Surrogate: 4-Bromofluorobenzene		92.1 %	78.4-125		"	"	"	"	

TCLP Metals by EPA SW846 6020/7471

Date Sampled: 09/02/11 18:15

Analyte	Result	Reporting Limit	Units	Dilution	Batch	Prepared	Analyzed	Method	Notes
---------	--------	-----------------	-------	----------	-------	----------	----------	--------	-------

Summit Scientific

The results in this report apply to the samples analyzed in accordance with the chain of custody document. This analytical report must be reproduced in its entirety.



S₂

Trihydro Corporation
1252 Commerce Dr.
Laramie WY, 82070

Project: Greater DJ Basin
Project Number: 11X-006-001
Project Manager: Mike Ogden

Reported:
09/08/11 15:35

PitPost_Turner_C041_South
R109021-02 (Soil)

Summit Scientific

TCLP Metals by EPA SW846 6020/7471

Arsenic	ND	0.100	mg/L in Extract	1	1090108	09/04/11	09/07/11	EPA 6020
---------	----	-------	-----------------	---	---------	----------	----------	----------

Total Metals by EPA SW846 Method 6020 - Dry Weight Basis

Date Sampled: 09/02/11 18:15

Analyte	Result	Reporting Limit	Units	Dilution	Batch	Prepared	Analyzed	Method	Notes
Arsenic	1.16	0.0795	mg/kg	1	1090401	09/04/11	09/07/11	EPA 6020	

Date Sampled: 09/02/11 18:15

Analyte	Result	Reporting Limit	Units	Dilution	Batch	Prepared	Analyzed	Method	Notes
Barium	20.1	3.97	"	"	"	"	"	"	

Summit Scientific

The results in this report apply to the samples analyzed in accordance with the chain of custody document. This analytical report must be reproduced in its entirety.



S₂

Trihydro Corporation
1252 Commerce Dr.
Laramie WY, 82070

Project: Greater DJ Basin
Project Number: 11X-006-001
Project Manager: Mike Ogden

Reported:
09/08/11 15:35

Extractable Petroleum Hydrocarbons by 8015 - Quality Control
Summit Scientific

Analyte	Reporting			Spike	Source		%REC		RPD	
	Result	Limit	Units	Level	Result	%REC	Limits	RPD	Limit	Notes

Batch 1090302 - EPA 3550A

Blank (1090302-BLK1)

Prepared & Analyzed: 09/03/11

C10-C28 (TEPH-DRO) ND 50 mg/kg
C28-C36 (TEPH-ORO) ND 50 "

Surrogate: o-Terphenyl 11.6 " 12.5 92.9 88.8-124

LCS (1090302-BS1)

Prepared & Analyzed: 09/03/11

C10-C28 (TEPH-DRO) 517 50 mg/kg 501 103 85-129 11.8

LCS Dup (1090302-BSD1)

Prepared & Analyzed: 09/03/11

C10-C28 (TEPH-DRO) 520 50 mg/kg 501 104 85-129 0.618 11.8

Matrix Spike (1090302-MS1)

Source: R109004-02

Prepared & Analyzed: 09/03/11

C10-C28 (TEPH-DRO) 504 50 mg/kg 501 30.8 94.5 77.3-134 8.39

Matrix Spike Dup (1090302-MSD1)

Source: R109004-02

Prepared & Analyzed: 09/03/11

C10-C28 (TEPH-DRO) 496 50 mg/kg 501 30.8 92.9 77.3-134 1.65 8.39

Summit Scientific

The results in this report apply to the samples analyzed in accordance with the chain of custody document. This analytical report must be reproduced in its entirety.



S₂

Trihydro Corporation
1252 Commerce Dr.
Laramie WY, 82070

Project: Greater DJ Basin
Project Number: 11X-006-001
Project Manager: Mike Ogden

Reported:
09/08/11 15:35

Volatile Organic Compounds by EPA Method 8260B - Quality Control
Summit Scientific

Analyte	Reporting			Spike	Source		%REC		RPD	Notes
	Result	Limit	Units	Level	Result	%REC	Limits	RPD	Limit	

Batch 1090301 - EPA 5030 Soil MS

Blank (1090301-BLK1)

Prepared: 09/03/11 Analyzed: 09/04/11

Benzene	ND	0.0050	mg/kg
Toluene	ND	0.0050	"
Ethylbenzene	ND	0.0050	"
Xylenes (total)	ND	0.0050	"
Gasoline Range Hydrocarbons	ND	0.50	"

Surrogate: 1,2-Dichloroethane-d4	0.0383		"	0.0400	95.8	67.4-143
Surrogate: Toluene-d8	0.0394		"	0.0400	98.5	77.3-114
Surrogate: 4-Bromofluorobenzene	0.0375		"	0.0400	93.7	78.4-125

LCS (1090301-BS1)

Prepared: 09/03/11 Analyzed: 09/04/11

Benzene	0.0878	0.0050	mg/kg	0.100	87.8	61-139	11.1
Toluene	0.0928	0.0050	"	0.100	92.8	64-132	10.9
Ethylbenzene	0.101	0.0050	"	0.100	101	68.7-135	20
m,p-Xylene	0.192	0.010	"	0.200	96.2	70.4-129	20
o-Xylene	0.0964	0.0050	"	0.100	96.4	66.9-126	20

Surrogate: 1,2-Dichloroethane-d4	0.0391		"	0.0400	97.7	67.4-143
Surrogate: Toluene-d8	0.0399		"	0.0400	99.8	77.3-114
Surrogate: 4-Bromofluorobenzene	0.0392		"	0.0400	98.0	78.4-125

LCS Dup (1090301-BSD1)

Prepared: 09/03/11 Analyzed: 09/04/11

Benzene	0.0880	0.0050	mg/kg	0.100	88.0	61-139	0.239	11.1
Toluene	0.0932	0.0050	"	0.100	93.2	64-132	0.484	10.9
Ethylbenzene	0.100	0.0050	"	0.100	100	68.7-135	1.01	20
m,p-Xylene	0.191	0.010	"	0.200	95.4	70.4-129	0.908	20
o-Xylene	0.0955	0.0050	"	0.100	95.5	66.9-126	0.938	20

Surrogate: 1,2-Dichloroethane-d4	0.0394		"	0.0400	98.6	67.4-143
Surrogate: Toluene-d8	0.0398		"	0.0400	99.6	77.3-114
Surrogate: 4-Bromofluorobenzene	0.0385		"	0.0400	96.2	78.4-125

Summit Scientific

The results in this report apply to the samples analyzed in accordance with the chain of custody document. This analytical report must be reproduced in its entirety.



S₂

Trihydro Corporation
1252 Commerce Dr.
Laramie WY, 82070

Project: Greater DJ Basin
Project Number: 11X-006-001
Project Manager: Mike Ogden

Reported:
09/08/11 15:35

Volatile Organic Compounds by EPA Method 8260B - Quality Control
Summit Scientific

Analyte	Reporting			Spike	Source	%REC		RPD	
	Result	Limit	Units	Level	Result	%REC	Limits	RPD	Limit

Batch 1090301 - EPA 5030 Soil MS

Matrix Spike (1090301-MS1)		Source: R109018-02		Prepared: 09/03/11		Analyzed: 09/04/11	
Benzene	0.0878	0.0050	mg/kg	0.100	ND	87.8	42.9-137
Toluene	0.0923	0.0050	"	0.100	ND	92.3	42.6-130
Ethylbenzene	0.0982	0.0050	"	0.100	ND	98.2	39-133
m,p-Xylene	0.188	0.010	"	0.200	ND	94.2	34.7-134
o-Xylene	0.0950	0.0050	"	0.100	ND	95.0	41.3-126
Surrogate: 1,2-Dichloroethane-d4	0.0417		"	0.0400		104	67.4-143
Surrogate: Toluene-d8	0.0403		"	0.0400		101	77.3-114
Surrogate: 4-Bromofluorobenzene	0.0385		"	0.0400		96.2	78.4-125
Matrix Spike Dup (1090301-MSD1)		Source: R109018-02		Prepared: 09/03/11		Analyzed: 09/04/11	
Benzene	0.0888	0.0050	mg/kg	0.100	ND	88.8	42.9-137
Toluene	0.0928	0.0050	"	0.100	ND	92.8	42.6-130
Ethylbenzene	0.100	0.0050	"	0.100	ND	100	39-133
m,p-Xylene	0.194	0.010	"	0.200	ND	96.8	34.7-134
o-Xylene	0.0968	0.0050	"	0.100	ND	96.8	41.3-126
Surrogate: 1,2-Dichloroethane-d4	0.0427		"	0.0400		107	67.4-143
Surrogate: Toluene-d8	0.0397		"	0.0400		99.3	77.3-114
Surrogate: 4-Bromofluorobenzene	0.0387		"	0.0400		96.8	78.4-125

Summit Scientific

The results in this report apply to the samples analyzed in accordance with the chain of custody document. This analytical report must be reproduced in its entirety.



S₂

Trihydro Corporation
1252 Commerce Dr.
Laramie WY, 82070

Project: Greater DJ Basin
Project Number: 11X-006-001
Project Manager: Mike Ogden

Reported:
09/08/11 15:35

TCLP Metals by EPA SW846 6020/7471 - Quality Control
Summit Scientific

Analyte	Reporting			Spike	Source		%REC		RPD	
	Result	Limit	Units	Level	Result	%REC	Limits	RPD	Limit	Notes

Batch 1090108 - EPA 1311

Blank (1090108-BLK1)

Prepared: 09/04/11 Analyzed: 09/07/11

Arsenic ND 0.100 mg/L in Extract

LCS (1090108-BS1)

Prepared: 09/04/11 Analyzed: 09/07/11

Arsenic 0.399 0.100 mg/L in Extract 0.400 99.7 80-120 20

Matrix Spike (1090108-MS1)

Source: R108195-09

Prepared: 09/04/11 Analyzed: 09/07/11

Arsenic 0.400 0.100 mg/L in Extract 0.400 0.00241 99.3 75-125 25

Matrix Spike Dup (1090108-MSD1)

Source: R108195-09

Prepared: 09/04/11 Analyzed: 09/07/11

Arsenic 0.398 0.100 mg/L in Extract 0.400 0.00241 98.9 75-125 0.363 25

Summit Scientific

The results in this report apply to the samples analyzed in accordance with the chain of custody document. This analytical report must be reproduced in its entirety.



S₂

Trihydro Corporation
1252 Commerce Dr.
Laramie WY, 82070

Project: Greater DJ Basin
Project Number: 11X-006-001
Project Manager: Mike Ogden

Reported:
09/08/11 15:35

Total Metals by EPA SW846 Method 6020 - Dry Weight Basis - Quality Control
Summit Scientific

Analyte	Reporting			Spike	Source		%REC		RPD	
	Result	Limit	Units	Level	Result	%REC	Limits	RPD	Limit	Notes

Batch 1090401 - EPA 3050B

Blank (1090401-BLK1)

Prepared: 09/04/11 Analyzed: 09/07/11

Arsenic	ND	0.100	mg/kg
Barium	ND	5.00	"

LCS (1090401-BS1)

Prepared: 09/04/11 Analyzed: 09/07/11

Arsenic	2.16	0.100	mg/kg	2.56	84.4	80-120	20
Barium	209	5.00	"	224	93.1	80-120	20

LCS Dup (1090401-BSD1)

Prepared: 09/04/11 Analyzed: 09/07/11

Arsenic	2.31	0.100	mg/kg	2.56	90.4	80-120	6.85	20
Barium	224	5.00	"	224	99.8	80-120	6.95	20

Matrix Spike (1090401-MS1)

Source: R108196-03

Prepared: 09/04/11 Analyzed: 09/07/11

Arsenic	5.60	0.100	mg/kg	2.50	3.83	70.8	75-125	20	QM-07
Barium	301	5.00	"	219	83.3	99.2	75-125	20	

Matrix Spike Dup (1090401-MSD1)

Source: R108196-03

Prepared: 09/04/11 Analyzed: 09/07/11

Arsenic	5.22	0.100	mg/kg	2.49	3.83	55.8	75-125	7.00	20	QM-07
Barium	112	5.00	"	219	83.3	13.1	75-125	91.5	20	QM-07

Summit Scientific

The results in this report apply to the samples analyzed in accordance with the chain of custody document. This analytical report must be reproduced in its entirety.

S₂

Trihydro Corporation
1252 Commerce Dr.
Laramie WY, 82070

Project: Greater DJ Basin
Project Number: 11X-006-001
Project Manager: Mike Ogden

Reported:
09/08/11 15:35

Notes and Definitions

QM-07 The spike recovery was outside acceptance limits for the MS and/or MSD. The batch was accepted based on acceptable LCS/LCSD recovery.

DET Analyte DETECTED

ND Analyte NOT DETECTED at or above the reporting limit

NR Not Reported

dry Sample results reported on a dry weight basis

RPD Relative Percent Difference

