

Witt 34-23 #2 Lease Map

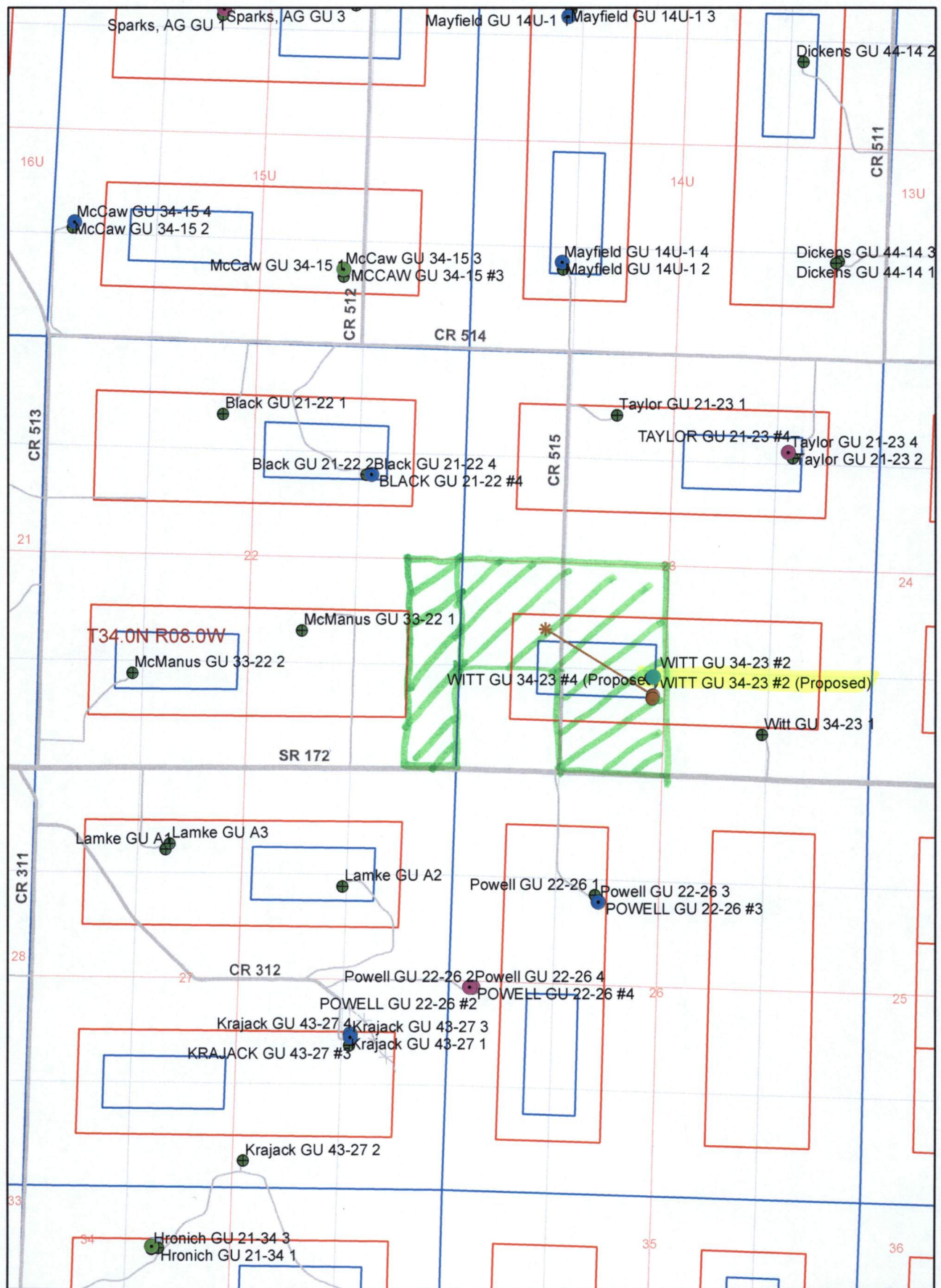

FD. 2" ALUM. CAP
LS #9185 (1977)

FD. 1/2" IRON BAR
LS #6728 (1990)

FD. REBAR

FD. 2"
ALUM. CAP
LS#9185 (1977)



23

FD. 2" ALUM. CAP
LS #5836

NO MONUMENT
FOUND OR SET

NO MONUMENT
FOUND OR SET

DRILLING
WINDOW

WITT GU 34-23 #2
BOTTOM HOLE LOCATION
2503.3' FWL
1224.3' FSL

LAT. 37.17276 N
LONG. 107.68708 W
ELEV. UNGRADED
GROUND = 6678.617'
N = 1191739.843
E = 2362797.566

2503.3'± FWL (MEAS.)

90°

660'

660'

1224.3'± FSL (MEAS.)

90°

660'

660'

FD. 2" ALUM. CAP
LS #9185 (1977)

BASIS OF BEARING
N88°22'40"W 2649.5± (MEAS.)

FD. 3/4" ALUM. CAP
LS #9187

N88°21'20"W 2656.3± (MEAS.)

FD. 3/4" ALUM. CAP
LS #9187 (1992)

OPERATOR: BP AMERICA PRODUCTION COMPANY

LEASE: WITT GU 34-23 #2

SECTION 23 TOWNSHIP 34 NORTH RANGE 8 WEST N.M.P.M.

COUNTY: LA PLATA COUNTY, COLORADO

SURFACE LOCATION OF WELL: 1224.3 FEET FROM THE SOUTH LINE, AND
2503.3 FEET FROM THE WEST LINE

BOTTOM HOLE LOCATION: 1224.3 FEET FROM THE SOUTH LINE, AND
2503.3 FEET FROM THE WEST LINE

GROUND LEVEL ELEVATION: 6678.617'

SURVEYOR'S STATEMENT:

I, GARY D. GABLE, A LICENSED PROFESSIONAL LAND SURVEYOR IN THE STATE OF COLORADO, DO HEREBY STATE THAT THE WELL LOCATION SHOWN ON THIS PLAT WAS PLOTTED FROM FIELD NOTES OF ACTUAL SURVEYS MADE BY ME OR UNDER MY RESPONSIBLE CHARGE, AND THAT THIS PLAT IS NOT A LAND SURVEY PLAT OR AN IMPROVEMENT SURVEY PLAT, AND THAT IT IS NOT TO BE RELIED UPON FOR THE ESTABLISHMENT OF FENCE, BUILDING, OR OTHER FUTURE IMPROVEMENT LINES. SAID SURVEY IS ACCURATE TO THE BEST OF MY KNOWLEDGE AND BELIEF.

Gary D. Gable

GARY D. GABLE
P.L.S. #24662

NOTE: THIS EXHIBIT IS INTENDED ONLY TO DEPICT
THE PROPOSED WELL LOCATION AND DOES NOT
REPRESENT A MONUMENTED BOUNDARY SURVEY.

LEGEND:

- = PROPOSED WELL HEAD
- = BOTTOM HOLE LOCATION
- △ = SECTION CORNERS LOCATED
- △ = SECTION CORNERS NOT FOUND OR SET
THIS SURVEY (CALCULATED LOCATION).
- S.U.I.T. = SOUTHERN UTE INDIAN TRIBE
- BLM = BUREAU OF LAND MANAGEMENT

SCALE 1" = 1000'
0 500 1000

- 1) ALL MEASUREMENTS SHOWN HEREON ARE GROUND MEASUREMENTS
- 2) BASIS OF BEARING: SPC, C-SO, NAD83 ALONG SOUTH LINE OF THE SW1/4 OF SAID SECTION 23 BEARS: N88°22'40"W
- 3) DATE FIELD SURVEY: 4/27/11
- 4) ELEVATION DETERMINED FROM NAVD 1988 DATUM, AND DETERMINED USING GPS OBSERVATIONS.
- 5) THERE ARE NO IMPROVEMENTS WITHIN 200 FEET OF THE LOCATION.
- 6) AGRICULTURAL SURFACE USE.
- 7) BOTTOM HOLE LOCATION PROVIDED BY BP
- 8) INSTRUMENT OPERATOR: BILL MITCHELL
- 9) PDOP VALUE: 2.2

URS

211 Rock Point Dr. Suite # 101
Durango, CO 81301 (970) 375-7717

PROJ. NO
8572

FILE NO
WITT_GU34-23_2-APD

DRAWN BY
DK

DATE
8/17/11

CLIENT
PC

WITT GU 34-23 #2
WELL LOCATION PLAT

REV
E

BP AMERICA PROD. CO. - DURANGO, CO

2649.5 - 2503.3 = 146.2' from Lease line

11/28/11