

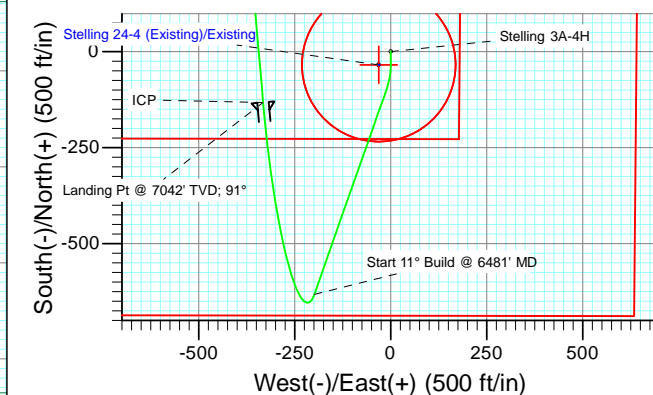

Project: DJ Wattenberg
Site: SESW S4-T1N-R65W (Stelling)
Well: Stelling 3A-4H
Wellbore: HZ
Design: Plan #1

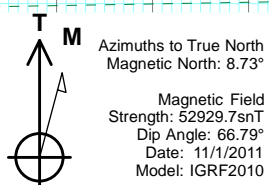
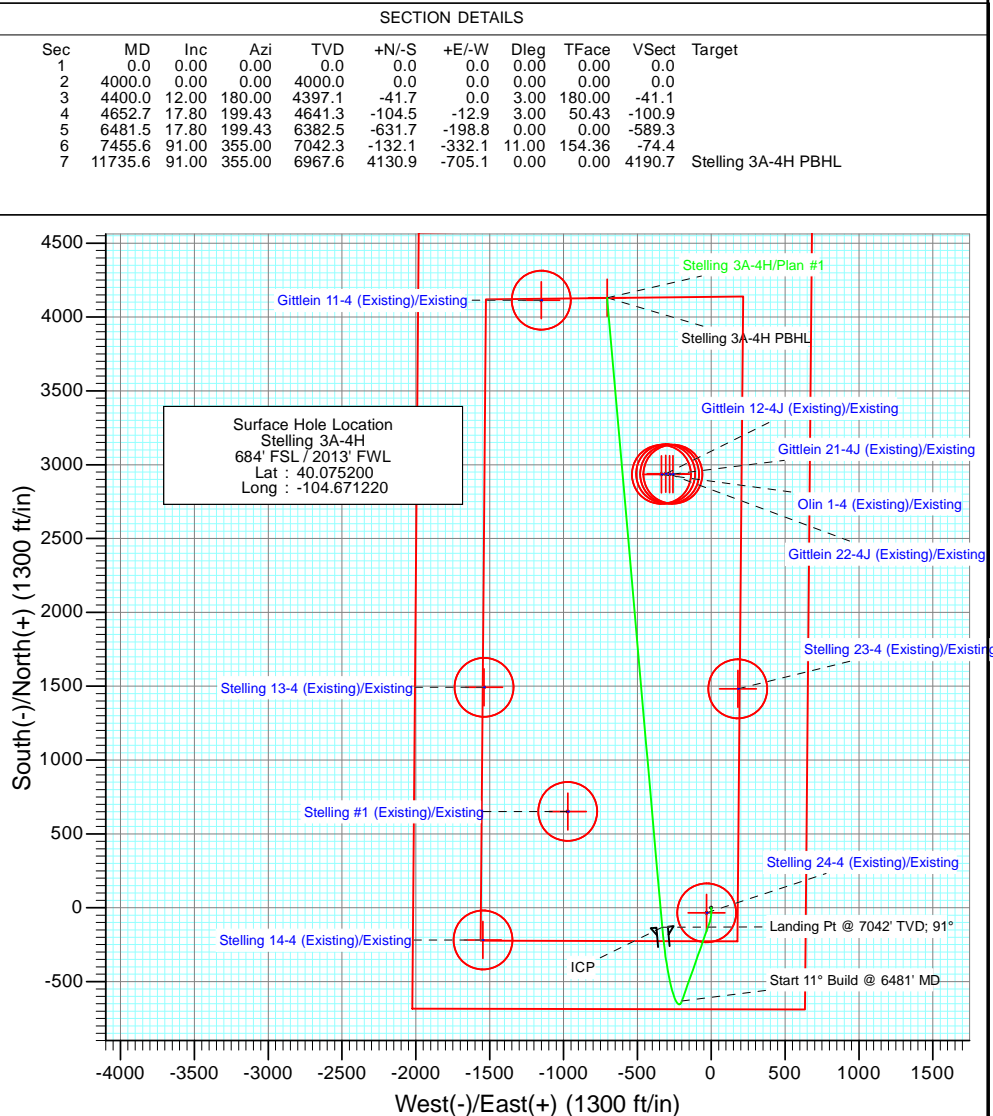
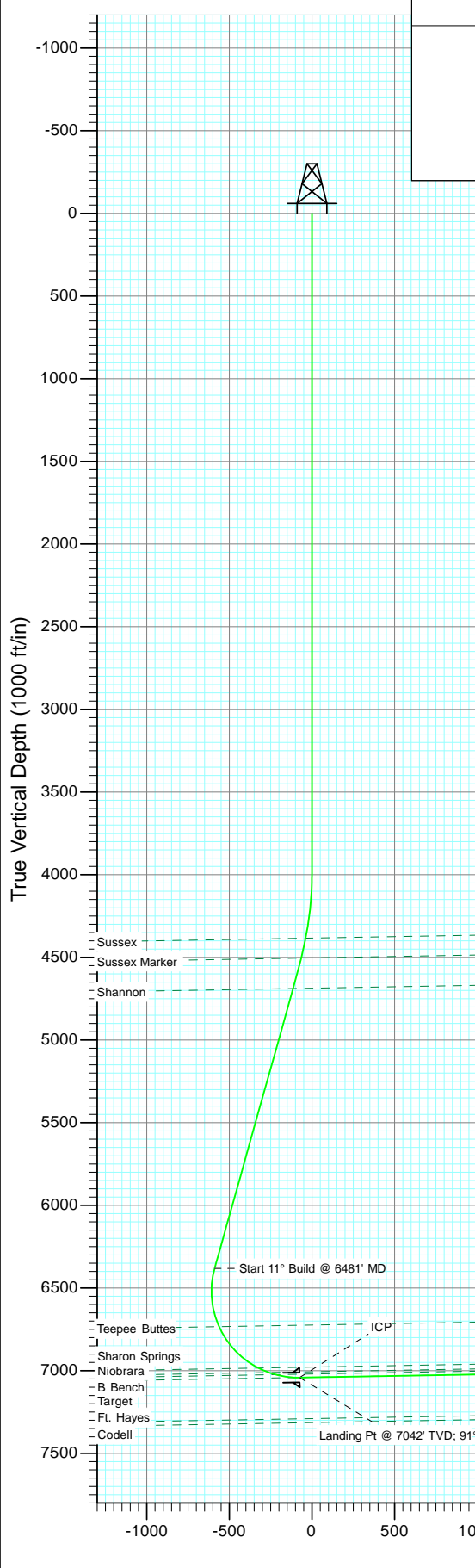

Plan #1 Stelling 3A-4H 115xxx; LR KBE @ 4929.0ft (Original Well Elev) GL @ 4916.0 North American Datum 1983 Well Stelling 3A-4H, True North									
Type	Target	Azimuth	Origin	N/S	E/W	From	TVD	+N/-S	+E/-W
TD	No Target (Freehand)	350.31	Slot	0.0	0.0	0.0	6967.6	4130.9	-705.1
Stelling 3A-4H PBHL				Latitude		Longitude			
				40.086540		-104.673740			

Planning Report

Database:	USA EDM 5000 Multi Users DB	Local Co-ordinate Reference:	Well Stelling 3A-4H
Company:	EnCana Oil & Gas (USA) Inc	TVD Reference:	KBE @ 4929.0ft (Original Well Elev)
Project:	DJ Wattenberg	MD Reference:	KBE @ 4929.0ft (Original Well Elev)
Site:	SESW S4-T1N-R65W (Stelling)	North Reference:	True
Well:	Stelling 3A-4H	Survey Calculation Method:	Minimum Curvature
Wellbore:	HZ		
Design:	Plan #1		

Project	DJ Wattenberg		
Map System:	US State Plane 1983	System Datum:	Mean Sea Level
Geo Datum:	North American Datum 1983		
Map Zone:	Colorado Northern Zone		

Site		SESW S4-T1N-R65W (Stelling)			
Site Position:		Northing:	1,271,326.71 ft	Latitude:	40.075200
From:	Lat/Long	Easting:	3,231,932.75 ft	Longitude:	-104.671220
Position Uncertainty:	0.0 ft	Slot Radius:	13.200 in	Grid Convergence:	0.54 °

Well	Stelling 3A-4H					
Well Position	+N/-S	0.0 ft	Northing:	1,271,326.70 ft	Latitude:	40.075200
	+E/-W	0.0 ft	Easting:	3,231,932.75 ft	Longitude:	-104.671220
Position Uncertainty		0.0 ft	Wellhead Elevation:	ft	Ground Level:	4,916.0 ft

Wellbore	HZ				
Magnetics	Model Name	Sample Date	Declination (°)	Dip Angle (°)	Field Strength (nT)
	IGRF2010	11/1/2011	8.73	66.79	52,930

Design	Plan #1			
Audit Notes:				
Version:	Phase:	PLAN	Tie On Depth:	0.0
Vertical Section:	Depth From (TVD) (ft)	+N/-S (ft)	+E/-W (ft)	Direction (°)
	0.0	0.0	0.0	350.31

Plan Sections										
Measured Depth (ft)	Inclination (°)	Azimuth (°)	Vertical Depth (ft)	+N/-S (ft)	+E/-W (ft)	Dogleg Rate (°/100ft)	Build Rate (°/100ft)	Turn Rate (°/100ft)	TFO (°)	Target
0.0	0.00	0.00	0.0	0.0	0.0	0.00	0.00	0.00	0.00	
4,000.0	0.00	0.00	4,000.0	0.0	0.0	0.00	0.00	0.00	0.00	
4,400.0	12.00	180.00	4,397.1	-41.7	0.0	3.00	3.00	0.00	180.00	
4,652.7	17.80	199.43	4,641.3	-104.5	-12.9	3.00	2.30	7.69	50.43	
6,481.5	17.80	199.43	6,382.5	-631.7	-198.8	0.00	0.00	0.00	0.00	
7,455.6	91.00	355.00	7,042.3	-132.1	-332.1	11.00	7.51	15.97	154.36	
11,735.6	91.00	355.00	6,967.6	4,130.9	-705.1	0.00	0.00	0.00	0.00	Stelling 3A-4H PBHL

Planning Report

Database:	USA EDM 5000 Multi Users DB	Local Co-ordinate Reference:	Well Stelling 3A-4H
Company:	EnCana Oil & Gas (USA) Inc	TVD Reference:	KBE @ 4929.0ft (Original Well Elev)
Project:	DJ Wattenberg	MD Reference:	KBE @ 4929.0ft (Original Well Elev)
Site:	SESW S4-T1N-R65W (Stelling)	North Reference:	True
Well:	Stelling 3A-4H	Survey Calculation Method:	Minimum Curvature
Wellbore:	HZ		
Design:	Plan #1		

Planned Survey									
Measured Depth (ft)	Inclination (°)	Azimuth (°)	Vertical Depth (ft)	+N/-S (ft)	+E/-W (ft)	Vertical Section (ft)	Dogleg Rate (°/100ft)	Build Rate (°/100ft)	Comments / Formations
0.0	0.00	0.00	0.0	0.0	0.0	0.0	0.00	0.00	Stelling 3A-4H South Section Line
100.0	0.00	0.00	100.0	0.0	0.0	0.0	0.00	0.00	
200.0	0.00	0.00	200.0	0.0	0.0	0.0	0.00	0.00	
300.0	0.00	0.00	300.0	0.0	0.0	0.0	0.00	0.00	
400.0	0.00	0.00	400.0	0.0	0.0	0.0	0.00	0.00	
500.0	0.00	0.00	500.0	0.0	0.0	0.0	0.00	0.00	
600.0	0.00	0.00	600.0	0.0	0.0	0.0	0.00	0.00	
700.0	0.00	0.00	700.0	0.0	0.0	0.0	0.00	0.00	
800.0	0.00	0.00	800.0	0.0	0.0	0.0	0.00	0.00	
900.0	0.00	0.00	900.0	0.0	0.0	0.0	0.00	0.00	
1,000.0	0.00	0.00	1,000.0	0.0	0.0	0.0	0.00	0.00	
1,100.0	0.00	0.00	1,100.0	0.0	0.0	0.0	0.00	0.00	
1,200.0	0.00	0.00	1,200.0	0.0	0.0	0.0	0.00	0.00	
1,300.0	0.00	0.00	1,300.0	0.0	0.0	0.0	0.00	0.00	
1,400.0	0.00	0.00	1,400.0	0.0	0.0	0.0	0.00	0.00	
1,500.0	0.00	0.00	1,500.0	0.0	0.0	0.0	0.00	0.00	
1,600.0	0.00	0.00	1,600.0	0.0	0.0	0.0	0.00	0.00	
1,700.0	0.00	0.00	1,700.0	0.0	0.0	0.0	0.00	0.00	
1,800.0	0.00	0.00	1,800.0	0.0	0.0	0.0	0.00	0.00	
1,900.0	0.00	0.00	1,900.0	0.0	0.0	0.0	0.00	0.00	
2,000.0	0.00	0.00	2,000.0	0.0	0.0	0.0	0.00	0.00	
2,100.0	0.00	0.00	2,100.0	0.0	0.0	0.0	0.00	0.00	
2,200.0	0.00	0.00	2,200.0	0.0	0.0	0.0	0.00	0.00	
2,300.0	0.00	0.00	2,300.0	0.0	0.0	0.0	0.00	0.00	
2,400.0	0.00	0.00	2,400.0	0.0	0.0	0.0	0.00	0.00	
2,500.0	0.00	0.00	2,500.0	0.0	0.0	0.0	0.00	0.00	
2,600.0	0.00	0.00	2,600.0	0.0	0.0	0.0	0.00	0.00	
2,700.0	0.00	0.00	2,700.0	0.0	0.0	0.0	0.00	0.00	
2,800.0	0.00	0.00	2,800.0	0.0	0.0	0.0	0.00	0.00	
2,900.0	0.00	0.00	2,900.0	0.0	0.0	0.0	0.00	0.00	
3,000.0	0.00	0.00	3,000.0	0.0	0.0	0.0	0.00	0.00	
3,100.0	0.00	0.00	3,100.0	0.0	0.0	0.0	0.00	0.00	
3,200.0	0.00	0.00	3,200.0	0.0	0.0	0.0	0.00	0.00	
3,300.0	0.00	0.00	3,300.0	0.0	0.0	0.0	0.00	0.00	
3,400.0	0.00	0.00	3,400.0	0.0	0.0	0.0	0.00	0.00	
3,500.0	0.00	0.00	3,500.0	0.0	0.0	0.0	0.00	0.00	
3,600.0	0.00	0.00	3,600.0	0.0	0.0	0.0	0.00	0.00	KOP @ 4000'
3,700.0	0.00	0.00	3,700.0	0.0	0.0	0.0	0.00	0.00	
3,800.0	0.00	0.00	3,800.0	0.0	0.0	0.0	0.00	0.00	
3,900.0	0.00	0.00	3,900.0	0.0	0.0	0.0	0.00	0.00	
4,000.0	0.00	0.00	4,000.0	0.0	0.0	0.0	0.00	0.00	
4,100.0	3.00	180.00	4,100.0	-2.6	0.0	-2.6	3.00	3.00	
4,200.0	6.00	180.00	4,199.6	-10.5	0.0	-10.3	3.00	3.00	
4,300.0	9.00	180.00	4,298.8	-23.5	0.0	-23.2	3.00	3.00	
4,387.3	11.62	180.00	4,384.7	-39.1	0.0	-38.6	3.00	3.00	
4,400.0	12.00	180.00	4,397.1	-41.7	0.0	-41.1	3.00	3.00	Sussex
4,500.0	14.10	189.53	4,494.5	-64.1	-2.0	-62.9	3.00	2.10	
4,511.0	14.35	190.41	4,505.2	-66.8	-2.5	-65.4	3.00	2.27	
4,600.0	16.47	196.51	4,591.0	-89.8	-8.1	-87.1	3.00	2.39	
4,652.7	17.80	199.43	4,641.3	-104.5	-12.9	-100.9	3.00	2.52	
4,700.0	17.80	199.43	4,686.4	-118.2	-17.7	-113.5	0.00	0.00	
4,702.8	17.80	199.43	4,689.0	-119.0	-18.0	-114.2	0.00	0.00	

Planning Report

Database:	USA EDM 5000 Multi Users DB	Local Co-ordinate Reference:	Well Stelling 3A-4H
Company:	EnCana Oil & Gas (USA) Inc	TVD Reference:	KBE @ 4929.0ft (Original Well Elev)
Project:	DJ Wattenberg	MD Reference:	KBE @ 4929.0ft (Original Well Elev)
Site:	SESW S4-T1N-R65W (Stelling)	North Reference:	True
Well:	Stelling 3A-4H	Survey Calculation Method:	Minimum Curvature
Wellbore:	HZ		
Design:	Plan #1		

Planned Survey									
Measured Depth (ft)	Inclination (°)	Azimuth (°)	Vertical Depth (ft)	+N/-S (ft)	+E/-W (ft)	Vertical Section (ft)	Dogleg Rate (°/100ft)	Build Rate (°/100ft)	Comments / Formations
4,800.0	17.80	199.43	4,781.6	-147.0	-27.8	-140.2	0.00	0.00	
4,900.0	17.80	199.43	4,876.8	-175.8	-38.0	-166.9	0.00	0.00	
5,000.0	17.80	199.43	4,972.0	-204.6	-48.2	-193.6	0.00	0.00	
5,100.0	17.80	199.43	5,067.2	-233.5	-58.4	-220.3	0.00	0.00	
5,200.0	17.80	199.43	5,162.4	-262.3	-68.5	-247.0	0.00	0.00	
5,300.0	17.80	199.43	5,257.6	-291.1	-78.7	-273.7	0.00	0.00	
5,400.0	17.80	199.43	5,352.9	-320.0	-88.9	-300.4	0.00	0.00	
5,500.0	17.80	199.43	5,448.1	-348.8	-99.0	-327.2	0.00	0.00	
5,600.0	17.80	199.43	5,543.3	-377.6	-109.2	-353.9	0.00	0.00	
5,700.0	17.80	199.43	5,638.5	-406.4	-119.4	-380.6	0.00	0.00	
5,800.0	17.80	199.43	5,733.7	-435.3	-129.5	-407.3	0.00	0.00	
5,900.0	17.80	199.43	5,828.9	-464.1	-139.7	-434.0	0.00	0.00	
6,000.0	17.80	199.43	5,924.1	-492.9	-149.9	-460.7	0.00	0.00	
6,100.0	17.80	199.43	6,019.3	-521.8	-160.0	-487.4	0.00	0.00	
6,200.0	17.80	199.43	6,114.6	-550.6	-170.2	-514.1	0.00	0.00	
6,300.0	17.80	199.43	6,209.8	-579.4	-180.4	-540.8	0.00	0.00	
6,400.0	17.80	199.43	6,305.0	-608.2	-190.6	-567.5	0.00	0.00	
6,481.5	17.80	199.43	6,382.5	-631.7	-198.8	-589.3	0.00	0.00	Start 11° Build @ 6481' MD
6,500.0	15.98	202.64	6,400.3	-636.8	-200.8	-593.9	11.00	-9.79	
6,600.0	8.21	242.59	6,498.1	-652.8	-212.4	-607.7	11.00	-7.78	
6,700.0	10.95	311.22	6,597.0	-649.8	-225.9	-602.5	11.00	2.74	
6,800.0	20.32	333.74	6,693.3	-627.9	-240.8	-578.5	11.00	9.37	
6,845.5	25.01	338.25	6,735.3	-611.9	-247.9	-561.5	11.00	10.32	Teepee Buttes
6,900.0	30.76	341.91	6,783.4	-587.9	-256.5	-536.4	11.00	10.55	
7,000.0	41.48	346.18	6,864.1	-531.3	-272.4	-477.9	11.00	10.71	
7,100.0	52.29	348.94	6,932.4	-460.1	-287.9	-405.1	11.00	10.82	
7,198.7	63.02	350.97	6,985.1	-378.1	-302.4	-321.8	11.00	10.86	Sharon Springs
7,200.0	63.15	350.99	6,985.7	-376.9	-302.5	-320.7	11.00	10.88	
7,266.9	70.44	352.15	7,012.0	-316.2	-311.5	-259.2	11.00	10.89	Niobrara
7,300.0	74.04	352.68	7,022.1	-284.9	-315.7	-227.7	11.00	10.89	
7,311.9	75.34	352.87	7,025.3	-273.5	-317.1	-216.2	11.00	10.90	B Bench
7,400.0	84.94	354.19	7,040.3	-187.4	-326.9	-129.7	11.00	10.90	
7,455.6	91.00	355.00	7,042.3	-132.1	-332.1	-74.3	10.99	10.89	Landing Pt @ 7042' TVD; 91° - ICP
7,500.0	91.00	355.00	7,041.5	-87.9	-336.0	-30.1	0.00	0.00	
7,600.0	91.00	355.00	7,039.8	11.7	-344.7	69.6	0.00	0.00	
7,700.0	91.00	355.00	7,038.0	111.3	-353.4	169.2	0.00	0.00	
7,800.0	91.00	355.00	7,036.3	210.9	-362.1	268.9	0.00	0.00	
7,900.0	91.00	355.00	7,034.5	310.5	-370.9	368.5	0.00	0.00	
8,000.0	91.00	355.00	7,032.8	410.1	-379.6	468.2	0.00	0.00	
8,100.0	91.00	355.00	7,031.0	509.8	-388.3	567.8	0.00	0.00	
8,200.0	91.00	355.00	7,029.3	609.4	-397.0	667.5	0.00	0.00	
8,300.0	91.00	355.00	7,027.6	709.0	-405.7	767.1	0.00	0.00	
8,400.0	91.00	355.00	7,025.8	808.6	-414.4	866.8	0.00	0.00	
8,500.0	91.00	355.00	7,024.1	908.2	-423.1	966.4	0.00	0.00	
8,600.0	91.00	355.00	7,022.3	1,007.8	-431.9	1,066.1	0.00	0.00	
8,700.0	91.00	355.00	7,020.6	1,107.4	-440.6	1,165.7	0.00	0.00	
8,800.0	91.00	355.00	7,018.8	1,207.0	-449.3	1,265.4	0.00	0.00	
8,900.0	91.00	355.00	7,017.1	1,306.6	-458.0	1,365.0	0.00	0.00	
9,000.0	91.00	355.00	7,015.3	1,406.2	-466.7	1,464.7	0.00	0.00	
9,100.0	91.00	355.00	7,013.6	1,505.8	-475.4	1,564.3	0.00	0.00	
9,200.0	91.00	355.00	7,011.9	1,605.4	-484.1	1,664.0	0.00	0.00	
9,300.0	91.00	355.00	7,010.1	1,705.0	-492.9	1,763.6	0.00	0.00	

Planning Report

Database:	USA EDM 5000 Multi Users DB	Local Co-ordinate Reference:	Well Stelling 3A-4H
Company:	EnCana Oil & Gas (USA) Inc	TVD Reference:	KBE @ 4929.0ft (Original Well Elev)
Project:	DJ Wattenberg	MD Reference:	KBE @ 4929.0ft (Original Well Elev)
Site:	SESW S4-T1N-R65W (Stelling)	North Reference:	True
Well:	Stelling 3A-4H	Survey Calculation Method:	Minimum Curvature
Wellbore:	HZ		
Design:	Plan #1		

Planned Survey

Measured Depth (ft)	Inclination (°)	Azimuth (°)	Vertical Depth (ft)	+N/-S (ft)	+E/-W (ft)	Vertical Section (ft)	Dogleg Rate (°/100ft)	Build Rate (°/100ft)	Comments / Formations
9,400.0	91.00	355.00	7,008.4	1,804.6	-501.6	1,863.3	0.00	0.00	
9,500.0	91.00	355.00	7,006.6	1,904.2	-510.3	1,962.9	0.00	0.00	
9,600.0	91.00	355.00	7,004.9	2,003.8	-519.0	2,062.6	0.00	0.00	
9,700.0	91.00	355.00	7,003.1	2,103.4	-527.7	2,162.2	0.00	0.00	
9,800.0	91.00	355.00	7,001.4	2,203.0	-536.4	2,261.9	0.00	0.00	
9,900.0	91.00	355.00	6,999.6	2,302.6	-545.1	2,361.5	0.00	0.00	
10,000.0	91.00	355.00	6,997.9	2,402.2	-553.9	2,461.2	0.00	0.00	
10,100.0	91.00	355.00	6,996.1	2,501.8	-562.6	2,560.8	0.00	0.00	
10,200.0	91.00	355.00	6,994.4	2,601.4	-571.3	2,660.5	0.00	0.00	
10,300.0	91.00	355.00	6,992.7	2,701.0	-580.0	2,760.1	0.00	0.00	
10,400.0	91.00	355.00	6,990.9	2,800.7	-588.7	2,859.8	0.00	0.00	
10,500.0	91.00	355.00	6,989.2	2,900.3	-597.4	2,959.4	0.00	0.00	
10,600.0	91.00	355.00	6,987.4	2,999.9	-606.1	3,059.1	0.00	0.00	
10,700.0	91.00	355.00	6,985.7	3,099.5	-614.9	3,158.7	0.00	0.00	
10,800.0	91.00	355.00	6,983.9	3,199.1	-623.6	3,258.4	0.00	0.00	
10,900.0	91.00	355.00	6,982.2	3,298.7	-632.3	3,358.0	0.00	0.00	
11,000.0	91.00	355.00	6,980.4	3,398.3	-641.0	3,457.7	0.00	0.00	
11,100.0	91.00	355.00	6,978.7	3,497.9	-649.7	3,557.3	0.00	0.00	
11,200.0	91.00	355.00	6,976.9	3,597.5	-658.4	3,657.0	0.00	0.00	
11,300.0	91.00	355.00	6,975.2	3,697.1	-667.1	3,756.6	0.00	0.00	
11,400.0	91.00	355.00	6,973.5	3,796.7	-675.9	3,856.3	0.00	0.00	
11,500.0	91.00	355.00	6,971.7	3,896.3	-684.6	3,955.9	0.00	0.00	
11,600.0	91.00	355.00	6,970.0	3,995.9	-693.3	4,055.6	0.00	0.00	
11,700.0	91.00	355.00	6,968.2	4,095.5	-702.0	4,155.2	0.00	0.00	
11,735.6	91.00	355.00	6,967.6	4,130.9	-705.1	4,190.7	0.00	0.00	TD at 11735.6 - Stelling 3A-4H PBHL

Targets

Target Name - hit/miss target - Shape	Dip Angle (°)	Dip Dir. (°)	TVD (ft)	+N/-S (ft)	+E/-W (ft)	Northing (ft)	Easting (ft)	Latitude	Longitude
Stelling 3A-4H South Se - plan misses target center by 7000.0ft at 0.0ft MD (0.0 TVD, 0.0 N, 0.0 E) - Polygon Point 1 Point 2	0.00	0.00	-7,000.0	0.0	0.0	1,271,326.70	3,231,932.75	40.075200	-104.671220
			-7,000.0	-684.0	200.0	1,270,644.60	3,232,139.14		
			-7,000.0	-684.0	-200.0	1,270,640.87	3,231,739.15		
Stelling 3A-4H PBHL - plan hits target center - Point	0.00	0.00	6,967.6	4,130.9	-705.1	1,275,450.86	3,231,189.08	40.086540	-104.673740

Casing Points

Measured Depth (ft)	Vertical Depth (ft)	Name	Casing Diameter (in)	Hole Diameter (in)
7,455.6	7,042.3	ICP	0.000	0.000

Planning Report

Database:	USA EDM 5000 Multi Users DB	Local Co-ordinate Reference:	Well Stelling 3A-4H
Company:	EnCana Oil & Gas (USA) Inc	TVD Reference:	KBE @ 4929.0ft (Original Well Elev)
Project:	DJ Wattenberg	MD Reference:	KBE @ 4929.0ft (Original Well Elev)
Site:	SESW S4-T1N-R65W (Stelling)	North Reference:	True
Well:	Stelling 3A-4H	Survey Calculation Method:	Minimum Curvature
Wellbore:	HZ		
Design:	Plan #1		

Formations						
Measured Depth (ft)	Vertical Depth (ft)	Name	Lithology	Dip (°)	Dip Direction (°)	
4,387.3	4,384.0	Sussex		-1.00	355.00	
4,511.0	4,504.0	Sussex Marker		-1.00	355.00	
4,702.8	4,687.0	Shannon		-1.00	355.00	
6,845.5	6,725.0	Teepee Buttes		-1.00	355.00	
7,198.7	6,979.0	Sharon Springs		-1.00	355.00	
7,266.9	7,007.0	Niobrara		-1.00	355.00	
7,311.9	7,021.0	B Bench		-1.00	355.00	

Plan Annotations					
Measured Depth (ft)	Vertical Depth (ft)	Local Coordinates			
		+N/-S (ft)	+E/-W (ft)	Comment	
4,000.0	4,000.0	0.0	0.0	KOP @ 4000'	
4,400.0	4,397.1	-41.7	0.0	Start build/turn @ 4400' MD	
4,652.7	4,641.3	-104.5	-12.9	EOB; Inc=17.8°	
6,481.5	6,382.5	-631.7	-198.8	Start 11° Build @ 6481' MD	
7,455.6	7,042.3	-132.1	-332.1	Landing Pt @ 7042' TVD; 91°	
11,735.6	6,967.6	4,130.9	-705.1	TD at 11735.6	

EnCana Oil & Gas (USA) Inc

DJ Wattenberg

SESW S4-T1N-R65W (Stelling)

Stelling 3A-4H

HZ

Plan #1

Anticollision Report

01 November, 2011

Anticollision Report

Company:	EnCana Oil & Gas (USA) Inc	Local Co-ordinate Reference:	Well Stelling 3A-4H
Project:	DJ Wattenberg	TVD Reference:	KBE @ 4929.0ft (Original Well Elev)
Reference Site:	SESW S4-T1N-R65W (Stelling)	MD Reference:	KBE @ 4929.0ft (Original Well Elev)
Site Error:	0.0ft	North Reference:	True
Reference Well:	Stelling 3A-4H	Survey Calculation Method:	Minimum Curvature
Well Error:	0.0ft	Output errors are at	2.00 sigma
Reference Wellbore	HZ	Database:	USA EDM 5000 Multi Users DB
Reference Design:	Plan #1	Offset TVD Reference:	Offset Datum

Reference	Plan #1		
Filter type:	NO GLOBAL FILTER: Using user defined selection & filtering criteria		
Interpolation Method:	MD Interval 100.0ft	Error Model:	Systematic Ellipse
Depth Range:	Unlimited	Scan Method:	Closest Approach 3D
Results Limited by:	Maximum center-center distance of 1,377.6ft	Error Surface:	Elliptical Conic
Warning Levels Evaluated at:	2.00 Sigma		

Survey Tool Program	Date	11/1/2011		
From (ft)	To (ft)	Survey (Wellbore)	Tool Name	Description
0.0	11,735.0	Plan #1 (HZ)	MWD	Geolink MWD

Summary						
Site Name	Reference Measured Depth (ft)	Offset Measured Depth (ft)	Distance Between Centres (ft)	Distance Between Ellipses (ft)	Separation Factor	Warning
Offset Well - Wellbore - Design						
SESW S4-T1N-R65W (Stelling)						
Gittlein 11-4 (Existing) - Existing - Existing	11,735.6	6,970.6	446.3	357.9	5.046	CC, ES, SF
Gittlein 12-4J (Existing) - Existing - Existing	10,512.7	6,983.9	291.0	223.6	4.318	CC, ES, SF
Gittlein 21-4J (Existing) - Existing - Existing	10,505.9	6,983.1	339.6	272.3	5.048	CC, ES, SF
Gittlein 22-4J (Existing) - Existing - Existing	10,508.2	6,983.0	317.3	250.0	4.714	CC, ES, SF
Olin 1-4 (Existing) - Existing - Existing	10,510.8	6,987.0	262.2	194.8	3.892	CC, ES, SF
Stelling #1 (Existing) - Existing - Existing	8,292.7	7,029.7	569.0	537.1	17.878	CC
Stelling #1 (Existing) - Existing - Existing	8,300.0	7,029.6	569.0	537.1	17.827	ES
Stelling #1 (Existing) - Existing - Existing	8,400.0	7,027.8	579.0	545.7	17.406	SF
Stelling 13-4 (Existing) - Existing - Existing	9,179.0	7,014.2	1,060.2	1,015.1	23.505	CC
Stelling 13-4 (Existing) - Existing - Existing	9,200.0	7,013.9	1,060.4	1,015.0	23.335	ES
Stelling 13-4 (Existing) - Existing - Existing	9,600.0	7,006.9	1,140.7	1,088.7	21.936	SF
Stelling 14-4 (Existing) - Existing - Existing	7,479.2	7,050.0	1,216.1	1,190.7	47.924	CC, ES
Stelling 14-4 (Existing) - Existing - Existing	8,100.0	7,037.0	1,367.2	1,337.7	46.405	SF
Stelling 23-4 (Existing) - Existing - Existing	9,019.4	7,016.0	650.5	608.0	15.288	CC, ES
Stelling 23-4 (Existing) - Existing - Existing	9,200.0	7,012.9	675.1	629.7	14.857	SF
Stelling 24-4 (Existing) - Existing - Existing	4,362.2	4,357.0	31.1	15.8	2.042	CC, ES, SF

Anticollision Report

Company:	EnCana Oil & Gas (USA) Inc	Local Co-ordinate Reference:	Well Stelling 3A-4H
Project:	DJ Wattenberg	TVD Reference:	KBE @ 4929.0ft (Original Well Elev)
Reference Site:	SESW S4-T1N-R65W (Stelling)	MD Reference:	KBE @ 4929.0ft (Original Well Elev)
Site Error:	0.0ft	North Reference:	True
Reference Well:	Stelling 3A-4H	Survey Calculation Method:	Minimum Curvature
Well Error:	0.0ft	Output errors are at	2.00 sigma
Reference Wellbore	HZ	Database:	USA EDM 5000 Multi Users DB
Reference Design:	Plan #1	Offset TVD Reference:	Offset Datum

Offset Design													Offset Site Error:		0.0 ft
Survey Program: 0-MWD													Offset Well Error:		0.0 ft
Reference		Offset		Semi Major Axis			Distance							Warning	
Measured Depth (ft)	Vertical Depth (ft)	Measured Depth (ft)	Vertical Depth (ft)	Reference (ft)	Offset (ft)	Highside Toolface (°)	Offset Wellbore Centre +N/-S (ft)	+E/-W (ft)	Between Centres (ft)	Between Ellipses (ft)	Total Uncertainty Axis	Separation Factor			
10,500.0	6,989.2	6,992.2	6,992.2	55.3	12.2	-92.82	4,113.8	-1,151.1	1,333.9	1,266.8	67.11	19.877			
10,600.0	6,987.4	6,990.4	6,990.4	57.0	12.2	-92.59	4,113.8	-1,151.1	1,240.1	1,171.3	68.82	18.018			
10,700.0	6,985.7	6,988.7	6,988.7	58.7	12.2	-92.37	4,113.8	-1,151.1	1,147.4	1,076.8	70.54	16.264			
10,800.0	6,983.9	6,986.9	6,986.9	60.5	12.2	-92.15	4,113.8	-1,151.1	1,055.9	983.7	72.27	14.612			
10,900.0	6,982.2	6,985.2	6,985.2	62.2	12.2	-91.92	4,113.8	-1,151.1	966.2	892.2	73.99	13.058			
11,000.0	6,980.4	6,983.4	6,983.4	63.9	12.2	-91.70	4,113.8	-1,151.1	878.7	803.0	75.72	11.605			
11,100.0	6,978.7	6,981.7	6,981.7	65.6	12.2	-91.47	4,113.8	-1,151.1	794.2	716.7	77.45	10.255			
11,200.0	6,976.9	6,979.9	6,979.9	67.3	12.2	-91.25	4,113.8	-1,151.1	713.7	634.5	79.18	9.013			
11,300.0	6,975.2	6,978.2	6,978.2	69.0	12.2	-91.03	4,113.8	-1,151.1	638.6	557.7	80.91	7.893			
11,400.0	6,973.5	6,976.5	6,976.5	70.8	12.2	-90.80	4,113.8	-1,151.1	571.3	488.7	82.64	6.913			
11,500.0	6,971.7	6,974.7	6,974.7	72.5	12.2	-90.58	4,113.8	-1,151.1	514.7	430.4	84.37	6.101			
11,600.0	6,970.0	6,973.0	6,973.0	74.2	12.1	-90.35	4,113.8	-1,151.1	472.8	386.6	86.10	5.491			
11,700.0	6,968.2	6,971.2	6,971.2	75.9	12.1	-90.13	4,113.8	-1,151.1	449.5	361.6	87.84	5.117			
11,735.6	6,967.6	6,970.6	6,970.6	76.5	12.1	-90.05	4,113.8	-1,151.1	446.3	357.9	88.45	5,046 CC, ES, SF			

Anticollision Report

Company:	EnCana Oil & Gas (USA) Inc	Local Co-ordinate Reference:	Well Stelling 3A-4H
Project:	DJ Wattenberg	TVD Reference:	KBE @ 4929.0ft (Original Well Elev)
Reference Site:	SESW S4-T1N-R65W (Stelling)	MD Reference:	KBE @ 4929.0ft (Original Well Elev)
Site Error:	0.0ft	North Reference:	True
Reference Well:	Stelling 3A-4H	Survey Calculation Method:	Minimum Curvature
Well Error:	0.0ft	Output errors are at	2.00 sigma
Reference Wellbore	HZ	Database:	USA EDM 5000 Multi Users DB
Reference Design:	Plan #1	Offset TVD Reference:	Offset Datum

Offset Design SESW S4-T1N-R65W (Stelling) - Gittlein 12-4J (Existing) - Existing - Existing													Offset Site Error:	0.0 ft
Survey Program: 0-MWD													Offset Well Error:	0.0 ft
Reference		Offset		Semi Major Axis			Distance				Total Uncertainty Axis	Separation Factor	Warning	
Measured Depth (ft)	Vertical Depth (ft)	Measured Depth (ft)	Vertical Depth (ft)	Reference (ft)	Offset (ft)	Highside Toolface (°)	Offset Wellbore Centre +N/-S (ft)	+E/-W (ft)	Between Centres (ft)	Between Ellipses (ft)				
9,200.0	7,011.9	7,006.9	7,006.9	33.8	12.2	94.50	2,938.3	-308.6	1,344.4	1,299.0	45.34	29.652		
9,300.0	7,010.1	7,005.1	7,005.1	35.4	12.2	94.16	2,938.3	-308.6	1,246.9	1,200.0	46.97	26.547		
9,400.0	7,008.4	7,003.4	7,003.4	37.0	12.2	93.82	2,938.3	-308.6	1,149.9	1,101.3	48.62	23.654		
9,500.0	7,006.6	7,001.6	7,001.6	38.6	12.2	93.48	2,938.3	-308.6	1,053.5	1,003.3	50.27	20.956		
9,600.0	7,004.9	6,999.9	6,999.9	40.3	12.2	93.13	2,938.3	-308.6	957.8	905.9	51.94	18.442		
9,700.0	7,003.1	6,998.1	6,998.1	41.9	12.2	92.79	2,938.3	-308.6	863.1	809.5	53.61	16.099		
9,800.0	7,001.4	6,996.4	6,996.4	43.6	12.2	92.45	2,938.3	-308.6	769.7	714.4	55.29	13.921		
9,900.0	6,999.6	6,994.6	6,994.6	45.2	12.2	92.10	2,938.3	-308.6	678.2	621.2	56.98	11.903		
10,000.0	6,997.9	6,992.9	6,992.9	46.9	12.2	91.76	2,938.3	-308.6	589.5	530.8	58.67	10.047		
10,100.0	6,996.1	6,991.1	6,991.1	48.6	12.2	91.42	2,938.3	-308.6	504.9	444.6	60.36	8.365		
10,200.0	6,994.4	6,989.4	6,989.4	50.3	12.2	91.07	2,938.3	-308.6	427.1	365.1	62.06	6.882		
10,300.0	6,992.7	6,987.7	6,987.7	51.9	12.2	90.73	2,938.3	-308.6	360.4	296.7	63.76	5.652		
10,400.0	6,990.9	6,985.9	6,985.9	53.6	12.2	90.39	2,938.3	-308.6	312.1	246.6	65.47	4.767		
10,500.0	6,989.2	6,984.2	6,984.2	55.3	12.2	90.04	2,938.3	-308.6	291.3	224.1	67.17	4.336		
10,512.7	6,988.9	6,983.9	6,983.9	55.6	12.2	90.00	2,938.3	-308.6	291.0	223.6	67.39	4.318	CC, ES, SF	
10,600.0	6,987.4	6,982.4	6,982.4	57.0	12.2	89.70	2,938.3	-308.6	303.8	234.9	68.88	4.411		
10,700.0	6,985.7	6,980.7	6,980.7	58.7	12.2	89.36	2,938.3	-308.6	346.1	275.5	70.59	4.903		
10,800.0	6,983.9	6,978.9	6,978.9	60.5	12.2	89.01	2,938.3	-308.6	408.9	336.6	72.29	5.656		
10,900.0	6,982.2	6,977.2	6,977.2	62.2	12.2	88.67	2,938.3	-308.6	484.4	410.4	74.00	6.546		
11,000.0	6,980.4	6,975.4	6,975.4	63.9	12.2	88.33	2,938.3	-308.6	567.5	491.8	75.71	7.496		
11,100.0	6,978.7	6,973.7	6,973.7	65.6	12.1	87.98	2,938.3	-308.6	655.4	578.0	77.41	8.466		
11,200.0	6,976.9	6,971.9	6,971.9	67.3	12.1	87.64	2,938.3	-308.6	746.3	667.2	79.12	9.433		
11,300.0	6,975.2	6,970.2	6,970.2	69.0	12.1	87.30	2,938.3	-308.6	839.3	758.4	80.82	10.384		
11,400.0	6,973.5	6,968.5	6,968.5	70.8	12.1	86.95	2,938.3	-308.6	933.7	851.2	82.52	11.315		
11,500.0	6,971.7	6,966.7	6,966.7	72.5	12.1	86.61	2,938.3	-308.6	1,029.2	944.9	84.22	12.220		
11,600.0	6,970.0	6,965.0	6,965.0	74.2	12.1	86.27	2,938.3	-308.6	1,125.4	1,039.5	85.92	13.099		
11,700.0	6,968.2	6,963.2	6,963.2	75.9	12.1	85.93	2,938.3	-308.6	1,222.3	1,134.7	87.61	13.952		
11,735.6	6,967.6	6,962.6	6,962.6	76.5	12.1	85.81	2,938.3	-308.6	1,256.8	1,168.6	88.21	14.248		

Anticollision Report

Company:	EnCana Oil & Gas (USA) Inc	Local Co-ordinate Reference:	Well Stelling 3A-4H
Project:	DJ Wattenberg	TVD Reference:	KBE @ 4929.0ft (Original Well Elev)
Reference Site:	SESW S4-T1N-R65W (Stelling)	MD Reference:	KBE @ 4929.0ft (Original Well Elev)
Site Error:	0.0ft	North Reference:	True
Reference Well:	Stelling 3A-4H	Survey Calculation Method:	Minimum Curvature
Well Error:	0.0ft	Output errors are at	2.00 sigma
Reference Wellbore	HZ	Database:	USA EDM 5000 Multi Users DB
Reference Design:	Plan #1	Offset TVD Reference:	Offset Datum

Offset Design SESW S4-T1N-R65W (Stelling) - Gittlein 21-4J (Existing) - Existing - Existing													Offset Site Error:	0.0 ft
Survey Program: 0-MWD													Offset Well Error:	0.0 ft
Reference		Offset		Semi Major Axis			Distance				Total Uncertainty Axis	Separation Factor	Warning	
Measured Depth (ft)	Vertical Depth (ft)	Measured Depth (ft)	Vertical Depth (ft)	Reference (ft)	Offset (ft)	Highside Toolface (°)	Offset Wellbore Centre +N/-S (ft)	+E/-W (ft)	Between Centres (ft)	Between Ellipses (ft)				
9,200.0	7,011.9	7,005.9	7,005.9	33.8	12.2	93.84	2,935.7	-259.7	1,349.1	1,303.7	45.36	29.739		
9,300.0	7,010.1	7,004.1	7,004.1	35.4	12.2	93.55	2,935.7	-259.7	1,252.6	1,205.6	46.99	26.654		
9,400.0	7,008.4	7,002.4	7,002.4	37.0	12.2	93.25	2,935.7	-259.7	1,156.7	1,108.0	48.64	23.782		
9,500.0	7,006.6	7,000.6	7,000.6	38.6	12.2	92.96	2,935.7	-259.7	1,061.5	1,011.2	50.29	21.108		
9,600.0	7,004.9	6,998.9	6,998.9	40.3	12.2	92.67	2,935.7	-259.7	967.3	915.3	51.95	18.619		
9,700.0	7,003.1	6,997.1	6,997.1	41.9	12.2	92.37	2,935.7	-259.7	874.4	820.8	53.62	16.306		
9,800.0	7,001.4	6,995.4	6,995.4	43.6	12.2	92.08	2,935.7	-259.7	783.2	727.9	55.30	14.163		
9,900.0	6,999.6	6,993.6	6,993.6	45.2	12.2	91.78	2,935.7	-259.7	694.5	637.5	56.98	12.187		
10,000.0	6,997.9	6,991.9	6,991.9	46.9	12.2	91.49	2,935.7	-259.7	609.2	550.5	58.67	10.383		
10,100.0	6,996.1	6,990.1	6,990.1	48.6	12.2	91.19	2,935.7	-259.7	529.1	468.8	60.37	8.766		
10,200.0	6,994.4	6,988.4	6,988.4	50.3	12.2	90.90	2,935.7	-259.7	457.0	394.9	62.06	7.363		
10,300.0	6,992.7	6,986.7	6,986.7	51.9	12.2	90.61	2,935.7	-259.7	397.1	333.3	63.76	6.227		
10,400.0	6,990.9	6,984.9	6,984.9	53.6	12.2	90.31	2,935.7	-259.7	355.7	290.2	65.47	5.433		
10,500.0	6,989.2	6,983.2	6,983.2	55.3	12.2	90.02	2,935.7	-259.7	339.6	272.4	67.17	5.056		
10,505.9	6,989.1	6,983.1	6,983.1	55.4	12.2	90.00	2,935.7	-259.7	339.6	272.3	67.27	5.048 CC, ES, SF		
10,600.0	6,987.4	6,981.4	6,981.4	57.0	12.2	89.72	2,935.7	-259.7	352.4	283.5	68.88	5.116		
10,700.0	6,985.7	6,979.7	6,979.7	58.7	12.2	89.43	2,935.7	-259.7	391.1	320.5	70.59	5.541		
10,800.0	6,983.9	6,977.9	6,977.9	60.5	12.2	89.13	2,935.7	-259.7	449.2	376.9	72.29	6.214		
10,900.0	6,982.2	6,976.2	6,976.2	62.2	12.2	88.84	2,935.7	-259.7	520.2	446.2	74.00	7.029		
11,000.0	6,980.4	6,974.4	6,974.4	63.9	12.2	88.55	2,935.7	-259.7	599.5	523.8	75.71	7.918		
11,100.0	6,978.7	6,972.7	6,972.7	65.6	12.1	88.25	2,935.7	-259.7	684.2	606.8	77.42	8.838		
11,200.0	6,976.9	6,970.9	6,970.9	67.3	12.1	87.96	2,935.7	-259.7	772.6	693.5	79.13	9.764		
11,300.0	6,975.2	6,969.2	6,969.2	69.0	12.1	87.66	2,935.7	-259.7	863.6	782.7	80.84	10.682		
11,400.0	6,973.5	6,967.5	6,967.5	70.8	12.1	87.37	2,935.7	-259.7	956.3	873.8	82.55	11.585		
11,500.0	6,971.7	6,965.7	6,965.7	72.5	12.1	87.08	2,935.7	-259.7	1,050.4	966.1	84.25	12.467		
11,600.0	6,970.0	6,964.0	6,964.0	74.2	12.1	86.78	2,935.7	-259.7	1,145.4	1,059.5	85.96	13.326		
11,700.0	6,968.2	6,962.2	6,962.2	75.9	12.1	86.49	2,935.7	-259.7	1,241.3	1,153.6	87.66	14.160		
11,735.6	6,967.6	6,961.6	6,961.6	76.5	12.1	86.38	2,935.7	-259.7	1,275.5	1,187.3	88.26	14.451		

Anticollision Report

Company:	EnCana Oil & Gas (USA) Inc	Local Co-ordinate Reference:	Well Stelling 3A-4H
Project:	DJ Wattenberg	TVD Reference:	KBE @ 4929.0ft (Original Well Elev)
Reference Site:	SESW S4-T1N-R65W (Stelling)	MD Reference:	KBE @ 4929.0ft (Original Well Elev)
Site Error:	0.0ft	North Reference:	True
Reference Well:	Stelling 3A-4H	Survey Calculation Method:	Minimum Curvature
Well Error:	0.0ft	Output errors are at	2.00 sigma
Reference Wellbore	HZ	Database:	USA EDM 5000 Multi Users DB
Reference Design:	Plan #1	Offset TVD Reference:	Offset Datum

Offset Design SESW S4-T1N-R65W (Stelling) - Gittlein 22-4J (Existing) - Existing - Existing													Offset Site Error: 0.0 ft	
Survey Program: 0-MWD													Offset Well Error: 0.0 ft	
Reference		Offset		Semi Major Axis			Distance						Warning	
Measured Depth (ft)	Vertical Depth (ft)	Measured Depth (ft)	Vertical Depth (ft)	Reference (ft)	Offset (ft)	Highside Toolface (°)	Offset Wellbore Centre +N/-S (ft)	+E/-W (ft)	Between Centres (ft)	Between Ellipses (ft)	Total Uncertainty Axis	Separation Factor		
9,200.0	7,011.9	7,005.9	7,005.9	33.8	12.2	94.12	2,936.1	-282.1	1,345.9	1,300.6	45.35	29.676		
9,300.0	7,010.1	7,004.1	7,004.1	35.4	12.2	93.80	2,936.1	-282.1	1,249.0	1,202.0	46.98	26.583		
9,400.0	7,008.4	7,002.4	7,002.4	37.0	12.2	93.49	2,936.1	-282.1	1,152.6	1,103.9	48.63	23.702		
9,500.0	7,006.6	7,000.6	7,000.6	38.6	12.2	93.17	2,936.1	-282.1	1,056.8	1,006.5	50.28	21.018		
9,600.0	7,004.9	6,998.9	6,998.9	40.3	12.2	92.86	2,936.1	-282.1	961.9	909.9	51.95	18.517		
9,700.0	7,003.1	6,997.1	6,997.1	41.9	12.2	92.54	2,936.1	-282.1	868.1	814.5	53.62	16.191		
9,800.0	7,001.4	6,995.4	6,995.4	43.6	12.2	92.23	2,936.1	-282.1	775.9	720.6	55.30	14.032		
9,900.0	6,999.6	6,993.6	6,993.6	45.2	12.2	91.92	2,936.1	-282.1	685.9	628.9	56.98	12.038		
10,000.0	6,997.9	6,991.9	6,991.9	46.9	12.2	91.60	2,936.1	-282.1	599.0	540.4	58.67	10.210		
10,100.0	6,996.1	6,990.1	6,990.1	48.6	12.2	91.29	2,936.1	-282.1	517.0	456.6	60.36	8.564		
10,200.0	6,994.4	6,988.4	6,988.4	50.3	12.2	90.97	2,936.1	-282.1	442.3	380.2	62.06	7.127		
10,300.0	6,992.7	6,986.7	6,986.7	51.9	12.2	90.66	2,936.1	-282.1	379.5	315.7	63.76	5.951		
10,400.0	6,990.9	6,984.9	6,984.9	53.6	12.2	90.34	2,936.1	-282.1	335.2	269.8	65.47	5.121		
10,500.0	6,989.2	6,983.2	6,983.2	55.3	12.2	90.03	2,936.1	-282.1	317.4	250.2	67.17	4.725		
10,508.2	6,989.0	6,983.0	6,983.0	55.5	12.2	90.00	2,936.1	-282.1	317.3	250.0	67.31	4.714 CC, ES, SF		
10,600.0	6,987.4	6,981.4	6,981.4	57.0	12.2	89.71	2,936.1	-282.1	330.3	261.4	68.88	4.796		
10,700.0	6,985.7	6,979.7	6,979.7	58.7	12.2	89.40	2,936.1	-282.1	370.7	300.2	70.59	5.252		
10,800.0	6,983.9	6,977.9	6,977.9	60.5	12.2	89.08	2,936.1	-282.1	431.0	358.8	72.29	5.962		
10,900.0	6,982.2	6,976.2	6,976.2	62.2	12.2	88.77	2,936.1	-282.1	504.1	430.1	74.00	6.812		
11,000.0	6,980.4	6,974.4	6,974.4	63.9	12.2	88.45	2,936.1	-282.1	585.2	509.5	75.71	7.730		
11,100.0	6,978.7	6,972.7	6,972.7	65.6	12.1	88.14	2,936.1	-282.1	671.4	594.0	77.42	8.673		
11,200.0	6,976.9	6,970.9	6,970.9	67.3	12.1	87.82	2,936.1	-282.1	761.0	681.9	79.12	9.618		
11,300.0	6,975.2	6,969.2	6,969.2	69.0	12.1	87.51	2,936.1	-282.1	852.9	772.1	80.83	10.552		
11,400.0	6,973.5	6,967.5	6,967.5	70.8	12.1	87.19	2,936.1	-282.1	946.4	863.9	82.54	11.467		
11,500.0	6,971.7	6,965.7	6,965.7	72.5	12.1	86.88	2,936.1	-282.1	1,041.2	956.9	84.24	12.360		
11,600.0	6,970.0	6,964.0	6,964.0	74.2	12.1	86.56	2,936.1	-282.1	1,136.8	1,050.9	85.94	13.228		
11,700.0	6,968.2	6,962.2	6,962.2	75.9	12.1	86.25	2,936.1	-282.1	1,233.1	1,145.5	87.64	14.071		
11,735.6	6,967.6	6,961.6	6,961.6	76.5	12.1	86.14	2,936.1	-282.1	1,267.5	1,179.3	88.24	14.364		

Anticollision Report

Company:	EnCana Oil & Gas (USA) Inc	Local Co-ordinate Reference:	Well Stelling 3A-4H
Project:	DJ Wattenberg	TVD Reference:	KBE @ 4929.0ft (Original Well Elev)
Reference Site:	SESW S4-T1N-R65W (Stelling)	MD Reference:	KBE @ 4929.0ft (Original Well Elev)
Site Error:	0.0ft	North Reference:	True
Reference Well:	Stelling 3A-4H	Survey Calculation Method:	Minimum Curvature
Well Error:	0.0ft	Output errors are at	2.00 sigma
Reference Wellbore	HZ	Database:	USA EDM 5000 Multi Users DB
Reference Design:	Plan #1	Offset TVD Reference:	Offset Datum

Offset Design SESW S4-T1N-R65W (Stelling) - Olin 1-4 (Existing) - Existing - Existing													Offset Site Error:	0.0 ft
Survey Program: 0-MWD													Offset Well Error:	0.0 ft
Reference		Offset		Semi Major Axis		Distance		Total		Separation		Warning		
Measured Depth (ft)	Vertical Depth (ft)	Measured Depth (ft)	Vertical Depth (ft)	Reference (ft)	Offset (ft)	Highside Toolface (°)	Offset Wellbore Centre +N/-S (ft)	+E/-W (ft)	Between Centres (ft)	Between Ellipses (ft)	Uncertainty Axis			
9,200.0	7,011.9	7,009.9	7,009.9	33.8	12.2	94.99	2,933.9	-337.2	1,336.6	1,291.3	45.32	29.492		
9,300.0	7,010.1	7,008.1	7,008.1	35.4	12.2	94.61	2,933.9	-337.2	1,238.7	1,191.7	46.96	26.381		
9,400.0	7,008.4	7,006.4	7,006.4	37.0	12.2	94.23	2,933.9	-337.2	1,141.2	1,092.6	48.60	23.480		
9,500.0	7,006.6	7,004.6	7,004.6	38.6	12.2	93.85	2,933.9	-337.2	1,044.1	993.9	50.26	20.774		
9,600.0	7,004.9	7,002.9	7,002.9	40.3	12.2	93.47	2,933.9	-337.2	947.7	895.7	51.93	18.249		
9,700.0	7,003.1	7,001.1	7,001.1	41.9	12.2	93.09	2,933.9	-337.2	852.0	798.4	53.61	15.895		
9,800.0	7,001.4	6,999.4	6,999.4	43.6	12.2	92.71	2,933.9	-337.2	757.5	702.2	55.29	13.702		
9,900.0	6,999.6	6,997.6	6,997.6	45.2	12.2	92.33	2,933.9	-337.2	664.6	607.7	56.98	11.665		
10,000.0	6,997.9	6,995.9	6,995.9	46.9	12.2	91.95	2,933.9	-337.2	574.1	515.4	58.67	9.786		
10,100.0	6,996.1	6,994.1	6,994.1	48.6	12.2	91.57	2,933.9	-337.2	487.3	426.9	60.37	8.073		
10,200.0	6,994.4	6,992.4	6,992.4	50.3	12.2	91.19	2,933.9	-337.2	406.6	344.5	62.07	6.551		
10,300.0	6,992.7	6,990.7	6,990.7	51.9	12.2	90.80	2,933.9	-337.2	336.4	272.6	63.77	5.276		
10,400.0	6,990.9	6,988.9	6,988.9	53.6	12.2	90.42	2,933.9	-337.2	284.6	219.2	65.47	4.348		
10,500.0	6,989.2	6,987.2	6,987.2	55.3	12.2	90.04	2,933.9	-337.2	262.4	195.2	67.18	3.906		
10,510.8	6,989.0	6,987.0	6,987.0	55.5	12.2	90.00	2,933.9	-337.2	262.2	194.8	67.36	3.892 CC, ES, SF		
10,600.0	6,987.4	6,985.4	6,985.4	57.0	12.2	89.66	2,933.9	-337.2	276.9	208.1	68.88	4.020		
10,700.0	6,985.7	6,983.7	6,983.7	58.7	12.2	89.28	2,933.9	-337.2	323.3	252.7	70.59	4.580		
10,800.0	6,983.9	6,981.9	6,981.9	60.5	12.2	88.90	2,933.9	-337.2	390.3	318.0	72.30	5.399		
10,900.0	6,982.2	6,980.2	6,980.2	62.2	12.2	88.52	2,933.9	-337.2	469.2	395.2	74.00	6.341		
11,000.0	6,980.4	6,978.4	6,978.4	63.9	12.2	88.14	2,933.9	-337.2	554.9	479.2	75.70	7.330		
11,100.0	6,978.7	6,976.7	6,976.7	65.6	12.2	87.75	2,933.9	-337.2	644.8	567.4	77.41	8.330		
11,200.0	6,976.9	6,974.9	6,974.9	67.3	12.2	87.37	2,933.9	-337.2	737.3	658.2	79.11	9.320		
11,300.0	6,975.2	6,973.2	6,973.2	69.0	12.1	86.99	2,933.9	-337.2	831.5	750.7	80.80	10.290		
11,400.0	6,973.5	6,971.5	6,971.5	70.8	12.1	86.61	2,933.9	-337.2	926.9	844.4	82.50	11.235		
11,500.0	6,971.7	6,969.7	6,969.7	72.5	12.1	86.23	2,933.9	-337.2	1,023.2	939.0	84.19	12.153		
11,600.0	6,970.0	6,968.0	6,968.0	74.2	12.1	85.85	2,933.9	-337.2	1,120.1	1,034.2	85.88	13.043		
11,700.0	6,968.2	6,966.2	6,966.2	75.9	12.1	85.47	2,933.9	-337.2	1,217.6	1,130.0	87.57	13.905		
11,735.6	6,967.6	6,965.6	6,965.6	76.5	12.1	85.34	2,933.9	-337.2	1,252.3	1,164.1	88.16	14.204		

Anticollision Report

Company:	EnCana Oil & Gas (USA) Inc	Local Co-ordinate Reference:	Well Stelling 3A-4H
Project:	DJ Wattenberg	TVD Reference:	KBE @ 4929.0ft (Original Well Elev)
Reference Site:	SESW S4-T1N-R65W (Stelling)	MD Reference:	KBE @ 4929.0ft (Original Well Elev)
Site Error:	0.0ft	North Reference:	True
Reference Well:	Stelling 3A-4H	Survey Calculation Method:	Minimum Curvature
Well Error:	0.0ft	Output errors are at	2.00 sigma
Reference Wellbore	HZ	Database:	USA EDM 5000 Multi Users DB
Reference Design:	Plan #1	Offset TVD Reference:	Offset Datum

Offset Design SESW S4-T1N-R65W (Stelling) - Stelling #1 (Existing) - Existing - Existing													Offset Site Error:	0.0 ft
Survey Program: O-MWD													Offset Well Error:	0.0 ft
Reference		Offset		Semi Major Axis			Distance				Total Uncertainty Axis	Separation Factor	Warning	
Measured Depth (ft)	Vertical Depth (ft)	Measured Depth (ft)	Vertical Depth (ft)	Reference (ft)	Offset (ft)	Highside Toolface (°)	Offset Wellbore Centre +N/-S (ft)	+E/-W (ft)	Between Centres (ft)	Between Ellipses (ft)				
0.0	0.0	2.0	2.0	0.0	0.0	-56.14	652.1	-971.9	1,170.4					
100.0	100.0	102.0	102.0	0.2	0.2	-56.14	652.1	-971.9	1,170.4	1,170.1	0.31	3,810.027		
200.0	200.0	202.0	202.0	0.3	0.3	-56.14	652.1	-971.9	1,170.4	1,169.7	0.66	1,783.418		
300.0	300.0	302.0	302.0	0.5	0.5	-56.14	652.1	-971.9	1,170.4	1,169.4	1.01	1,164.176		
400.0	400.0	402.0	402.0	0.7	0.7	-56.14	652.1	-971.9	1,170.4	1,169.0	1.35	864.131		
500.0	500.0	502.0	502.0	0.8	0.9	-56.14	652.1	-971.9	1,170.4	1,168.7	1.70	687.055		
600.0	600.0	602.0	602.0	1.0	1.0	-56.14	652.1	-971.9	1,170.4	1,168.3	2.05	570.209		
700.0	700.0	702.0	702.0	1.2	1.2	-56.14	652.1	-971.9	1,170.4	1,168.0	2.40	487.330		
800.0	800.0	802.0	802.0	1.4	1.4	-56.14	652.1	-971.9	1,170.4	1,167.6	2.75	425.486		
900.0	900.0	902.0	902.0	1.5	1.6	-56.14	652.1	-971.9	1,170.4	1,167.3	3.10	377.571		
1,000.0	1,000.0	1,002.0	1,002.0	1.7	1.7	-56.14	652.1	-971.9	1,170.4	1,166.9	3.45	339.355		
1,100.0	1,100.0	1,102.0	1,102.0	1.9	1.9	-56.14	652.1	-971.9	1,170.4	1,166.6	3.80	308.164		
1,200.0	1,200.0	1,202.0	1,202.0	2.1	2.1	-56.14	652.1	-971.9	1,170.4	1,166.2	4.15	282.225		
1,300.0	1,300.0	1,302.0	1,302.0	2.2	2.2	-56.14	652.1	-971.9	1,170.4	1,165.9	4.50	260.313		
1,400.0	1,400.0	1,402.0	1,402.0	2.4	2.4	-56.14	652.1	-971.9	1,170.4	1,165.5	4.85	241.558		
1,500.0	1,500.0	1,502.0	1,502.0	2.6	2.6	-56.14	652.1	-971.9	1,170.4	1,165.2	5.19	225.324		
1,600.0	1,600.0	1,602.0	1,602.0	2.8	2.8	-56.14	652.1	-971.9	1,170.4	1,164.8	5.54	211.135		
1,700.0	1,700.0	1,702.0	1,702.0	2.9	2.9	-56.14	652.1	-971.9	1,170.4	1,164.5	5.89	198.627		
1,800.0	1,800.0	1,802.0	1,802.0	3.1	3.1	-56.14	652.1	-971.9	1,170.4	1,164.1	6.24	187.518		
1,900.0	1,900.0	1,902.0	1,902.0	3.3	3.3	-56.14	652.1	-971.9	1,170.4	1,163.8	6.59	177.586		
2,000.0	2,000.0	2,002.0	2,002.0	3.5	3.5	-56.14	652.1	-971.9	1,170.4	1,163.4	6.94	168.653		
2,100.0	2,100.0	2,102.0	2,102.0	3.6	3.6	-56.14	652.1	-971.9	1,170.4	1,163.1	7.29	160.576		
2,200.0	2,200.0	2,202.0	2,202.0	3.8	3.8	-56.14	652.1	-971.9	1,170.4	1,162.7	7.64	153.237		
2,300.0	2,300.0	2,302.0	2,302.0	4.0	4.0	-56.14	652.1	-971.9	1,170.4	1,162.4	7.99	146.540		
2,400.0	2,400.0	2,402.0	2,402.0	4.2	4.2	-56.14	652.1	-971.9	1,170.4	1,162.0	8.34	140.403		
2,500.0	2,500.0	2,502.0	2,502.0	4.3	4.3	-56.14	652.1	-971.9	1,170.4	1,161.7	8.68	134.760		
2,600.0	2,600.0	2,602.0	2,602.0	4.5	4.5	-56.14	652.1	-971.9	1,170.4	1,161.3	9.03	129.553		
2,700.0	2,700.0	2,702.0	2,702.0	4.7	4.7	-56.14	652.1	-971.9	1,170.4	1,161.0	9.38	124.733		
2,800.0	2,800.0	2,802.0	2,802.0	4.9	4.9	-56.14	652.1	-971.9	1,170.4	1,160.6	9.73	120.259		
2,900.0	2,900.0	2,902.0	2,902.0	5.0	5.0	-56.14	652.1	-971.9	1,170.4	1,160.3	10.08	116.095		
3,000.0	3,000.0	3,002.0	3,002.0	5.2	5.2	-56.14	652.1	-971.9	1,170.4	1,159.9	10.43	112.210		
3,100.0	3,100.0	3,102.0	3,102.0	5.4	5.4	-56.14	652.1	-971.9	1,170.4	1,159.6	10.78	108.576		
3,200.0	3,200.0	3,202.0	3,202.0	5.6	5.6	-56.14	652.1	-971.9	1,170.4	1,159.2	11.13	105.170		
3,300.0	3,300.0	3,302.0	3,302.0	5.7	5.7	-56.14	652.1	-971.9	1,170.4	1,158.9	11.48	101.972		
3,400.0	3,400.0	3,402.0	3,402.0	5.9	5.9	-56.14	652.1	-971.9	1,170.4	1,158.5	11.83	98.962		
3,500.0	3,500.0	3,502.0	3,502.0	6.1	6.1	-56.14	652.1	-971.9	1,170.4	1,158.2	12.18	96.125		
3,600.0	3,600.0	3,602.0	3,602.0	6.3	6.3	-56.14	652.1	-971.9	1,170.4	1,157.8	12.52	93.446		
3,700.0	3,700.0	3,702.0	3,702.0	6.4	6.4	-56.14	652.1	-971.9	1,170.4	1,157.5	12.87	90.912		
3,800.0	3,800.0	3,802.0	3,802.0	6.6	6.6	-56.14	652.1	-971.9	1,170.4	1,157.1	13.22	88.512		
3,900.0	3,900.0	3,902.0	3,902.0	6.8	6.8	-56.14	652.1	-971.9	1,170.4	1,156.8	13.57	86.235		
4,000.0	4,000.0	4,002.0	4,002.0	7.0	7.0	-56.14	652.1	-971.9	1,170.4	1,156.4	13.92	84.073		
4,100.0	4,100.0	4,102.0	4,102.0	7.1	7.1	123.93	652.1	-971.9	1,171.8	1,157.6	14.27	82.140		
4,200.0	4,199.6	4,201.6	4,201.6	7.3	7.3	124.14	652.1	-971.9	1,176.2	1,161.6	14.61	80.534		
4,300.0	4,298.8	4,300.8	4,300.8	7.5	7.5	124.47	652.1	-971.9	1,183.6	1,168.7	14.94	79.219		
4,400.0	4,397.1	4,399.1	4,399.1	7.7	7.7	124.93	652.1	-971.9	1,194.1	1,178.8	15.28	78.158		
4,500.0	4,494.5	4,496.5	4,496.5	7.9	7.8	116.21	652.1	-971.9	1,205.6	1,190.0	15.68	76.892		
4,600.0	4,591.0	4,593.0	4,593.0	8.2	8.0	110.28	652.1	-971.9	1,216.2	1,200.1	16.11	75.513		
4,700.0	4,686.4	4,688.4	4,688.4	8.5	8.2	108.61	652.1	-971.9	1,226.3	1,209.7	16.55	74.088		
4,800.0	4,781.6	4,783.6	4,783.6	8.8	8.3	109.90	652.1	-971.9	1,236.8	1,219.8	17.01	72.719		
4,900.0	4,876.8	4,878.8	4,878.8	9.2	8.5	111.16	652.1	-971.9	1,248.0	1,230.5	17.48	71.394		
5,000.0	4,972.0	4,974.0	4,974.0	9.6	8.7	112.41	652.1	-971.9	1,259.8	1,241.9	17.97	70.125		
5,100.0	5,067.2	5,069.2	5,069.2	9.9	8.8	113.63	652.1	-971.9	1,272.3	1,253.8	18.46	68.919		

CC - Min centre to center distance or convergent point, SF - min separation factor, ES - min ellipse separation

Anticollision Report

Company:	EnCana Oil & Gas (USA) Inc	Local Co-ordinate Reference:	Well Stelling 3A-4H
Project:	DJ Wattenberg	TVD Reference:	KBE @ 4929.0ft (Original Well Elev)
Reference Site:	SESW S4-T1N-R65W (Stelling)	MD Reference:	KBE @ 4929.0ft (Original Well Elev)
Site Error:	0.0ft	North Reference:	True
Reference Well:	Stelling 3A-4H	Survey Calculation Method:	Minimum Curvature
Well Error:	0.0ft	Output errors are at	2.00 sigma
Reference Wellbore	HZ	Database:	USA EDM 5000 Multi Users DB
Reference Design:	Plan #1	Offset TVD Reference:	Offset Datum

Offset Design SESW S4-T1N-R65W (Stelling) - Stelling #1 (Existing) - Existing - Existing													Offset Site Error:	0.0 ft
Survey Program: 0-MWD													Offset Well Error:	0.0 ft
Reference		Offset		Semi Major Axis		Distance		Total		Separation		Warning		
Measured Depth (ft)	Vertical Depth (ft)	Measured Depth (ft)	Vertical Depth (ft)	Reference (ft)	Offset (ft)	Highside Toolface (°)	Offset Wellbore Centre +N/-S (ft)	+E/-W (ft)	Between Centres (ft)	Between Ellipses (ft)	Uncertainty Axis			
5,200.0	5,162.4	5,164.4	5,164.4	10.3	9.0	114.83	652.1	-971.9	1,285.3	1,266.4	18.96	67.781		
5,300.0	5,257.6	5,259.6	5,259.6	10.8	9.2	116.01	652.1	-971.9	1,299.0	1,279.5	19.47	66.713		
5,400.0	5,352.9	5,354.9	5,354.9	11.2	9.3	117.16	652.1	-971.9	1,313.2	1,293.2	19.98	65.716		
5,500.0	5,448.1	5,450.1	5,450.1	11.6	9.5	118.29	652.1	-971.9	1,328.0	1,307.5	20.50	64.789		
5,600.0	5,543.3	5,545.3	5,545.3	12.1	9.7	119.40	652.1	-971.9	1,343.3	1,322.3	21.01	63.931		
5,700.0	5,638.5	5,640.5	5,640.5	12.5	9.8	120.48	652.1	-971.9	1,359.1	1,337.6	21.53	63.140		
5,800.0	5,733.7	5,735.7	5,735.7	13.0	10.0	121.54	652.1	-971.9	1,375.4	1,353.4	22.04	62.412		
7,000.0	6,864.1	6,866.1	6,866.1	16.0	12.0	-21.91	652.1	-971.9	1,374.6	1,351.3	23.32	58.952		
7,100.0	6,932.4	6,934.4	6,934.4	15.5	12.1	-31.48	652.1	-971.9	1,305.6	1,283.1	22.55	57.891		
7,200.0	6,985.7	6,987.7	6,987.7	15.1	12.2	-44.64	652.1	-971.9	1,227.5	1,204.7	22.80	53.842		
7,300.0	7,022.1	7,024.1	7,024.1	14.7	12.2	-62.35	652.1	-971.9	1,143.9	1,119.7	24.18	47.317		
7,400.0	7,040.3	7,042.3	7,042.3	14.5	12.3	-81.88	652.1	-971.9	1,058.6	1,033.3	25.28	41.879		
7,500.0	7,041.5	7,043.5	7,043.5	14.4	12.3	-91.39	652.1	-971.9	975.6	950.3	25.34	38.499		
7,600.0	7,039.8	7,041.8	7,041.8	14.6	12.3	-91.22	652.1	-971.9	896.3	870.8	25.54	35.093		
7,700.0	7,038.0	7,040.0	7,040.0	15.0	12.3	-91.04	652.1	-971.9	821.5	795.5	25.97	31.639		
7,800.0	7,036.3	7,038.3	7,038.3	15.6	12.3	-90.87	652.1	-971.9	752.6	726.0	26.59	28.299		
7,900.0	7,034.5	7,036.5	7,036.5	16.3	12.3	-90.69	652.1	-971.9	691.3	663.9	27.40	25.227		
8,000.0	7,032.8	7,034.8	7,034.8	17.2	12.3	-90.51	652.1	-971.9	639.8	611.4	28.36	22.558		
8,100.0	7,031.0	7,033.0	7,033.0	18.2	12.3	-90.34	652.1	-971.9	600.7	571.2	29.45	20.397		
8,200.0	7,029.3	7,031.3	7,031.3	19.4	12.2	-90.16	652.1	-971.9	576.5	545.8	30.64	18.813		
8,292.7	7,027.7	7,029.7	7,029.7	20.5	12.2	-90.00	652.1	-971.9	569.0	537.1	31.82	17.878 CC		
8,300.0	7,027.6	7,029.6	7,029.6	20.6	12.2	-89.99	652.1	-971.9	569.0	537.1	31.92	17.827 ES		
8,400.0	7,025.8	7,027.8	7,027.8	21.9	12.2	-89.81	652.1	-971.9	579.0	545.7	33.26	17.406 SF		
8,500.0	7,024.1	7,026.1	7,026.1	23.2	12.2	-89.64	652.1	-971.9	605.6	570.9	34.67	17.468		
8,600.0	7,022.3	7,024.3	7,024.3	24.6	12.2	-89.46	652.1	-971.9	646.6	610.5	36.12	17.904		
8,700.0	7,020.6	7,022.6	7,022.6	26.1	12.2	-89.28	652.1	-971.9	699.7	662.1	37.61	18.607		
8,800.0	7,018.8	7,020.8	7,020.8	27.6	12.2	-89.11	652.1	-971.9	762.3	723.1	39.13	19.482		
8,900.0	7,017.1	7,019.1	7,019.1	29.1	12.2	-88.93	652.1	-971.9	832.1	791.5	40.67	20.460		
9,000.0	7,015.3	7,017.3	7,017.3	30.6	12.2	-88.76	652.1	-971.9	907.7	865.4	42.24	21.487		
9,100.0	7,013.6	7,015.6	7,015.6	32.2	12.2	-88.58	652.1	-971.9	987.6	943.8	43.83	22.531		
9,200.0	7,011.9	7,013.9	7,013.9	33.8	12.2	-88.41	652.1	-971.9	1,070.9	1,025.4	45.44	23.568		
9,300.0	7,010.1	7,012.1	7,012.1	35.4	12.2	-88.23	652.1	-971.9	1,156.8	1,109.7	47.06	24.584		
9,400.0	7,008.4	7,010.4	7,010.4	37.0	12.2	-88.05	652.1	-971.9	1,244.8	1,196.1	48.69	25.568		
9,500.0	7,006.6	7,008.6	7,008.6	38.6	12.2	-87.88	652.1	-971.9	1,334.5	1,284.2	50.33	26.517		

Anticollision Report

Company:	EnCana Oil & Gas (USA) Inc	Local Co-ordinate Reference:	Well Stelling 3A-4H
Project:	DJ Wattenberg	TVD Reference:	KBE @ 4929.0ft (Original Well Elev)
Reference Site:	SESW S4-T1N-R65W (Stelling)	MD Reference:	KBE @ 4929.0ft (Original Well Elev)
Site Error:	0.0ft	North Reference:	True
Reference Well:	Stelling 3A-4H	Survey Calculation Method:	Minimum Curvature
Well Error:	0.0ft	Output errors are at	2.00 sigma
Reference Wellbore	HZ	Database:	USA EDM 5000 Multi Users DB
Reference Design:	Plan #1	Offset TVD Reference:	Offset Datum

Offset Design SESW S4-T1N-R65W (Stelling) - Stelling 13-4 (Existing) - Existing - Existing													Offset Site Error:	0.0 ft
Survey Program: 0-MWD													Offset Well Error:	0.0 ft
Reference		Offset		Semi Major Axis			Distance				Total Uncertainty Axis	Separation Factor	Warning	
Measured Depth (ft)	Vertical Depth (ft)	Measured Depth (ft)	Vertical Depth (ft)	Reference (ft)	Offset (ft)	Highside Toolface (°)	Offset Wellbore Centre +N/-S (ft)	+E/-W (ft)	Between Centres (ft)	Between Ellipses (ft)				
8,300.0	7,027.6	7,029.6	7,029.6	20.6	12.2	-90.83	1,492.1	-1,538.5	1,377.2	1,345.2	31.91	43.156		
8,400.0	7,025.8	7,027.8	7,027.8	21.9	12.2	-90.73	1,492.1	-1,538.5	1,315.6	1,282.3	33.26	39.558		
8,500.0	7,024.1	7,026.1	7,026.1	23.2	12.2	-90.64	1,492.1	-1,538.5	1,259.0	1,224.3	34.66	36.323		
8,600.0	7,022.3	7,024.3	7,024.3	24.6	12.2	-90.55	1,492.1	-1,538.5	1,208.0	1,171.9	36.11	33.452		
8,700.0	7,020.6	7,022.6	7,022.6	26.1	12.2	-90.45	1,492.1	-1,538.5	1,163.4	1,125.8	37.60	30.941		
8,800.0	7,018.8	7,020.8	7,020.8	27.6	12.2	-90.36	1,492.1	-1,538.5	1,125.9	1,086.8	39.12	28.779		
8,900.0	7,017.1	7,019.1	7,019.1	29.1	12.2	-90.26	1,492.1	-1,538.5	1,096.3	1,055.6	40.67	26.955		
9,000.0	7,015.3	7,017.3	7,017.3	30.6	12.2	-90.17	1,492.1	-1,538.5	1,075.2	1,033.0	42.24	25.453		
9,100.0	7,013.6	7,015.6	7,015.6	32.2	12.2	-90.07	1,492.1	-1,538.5	1,063.2	1,019.3	43.84	24.254		
9,179.0	7,012.2	7,014.2	7,014.2	33.4	12.2	-90.00	1,492.1	-1,538.5	1,060.2	1,015.1	45.11	23.505 CC		
9,200.0	7,011.9	7,013.9	7,013.9	33.8	12.2	-89.98	1,492.1	-1,538.5	1,060.4	1,015.0	45.44	23.335 ES		
9,300.0	7,010.1	7,012.1	7,012.1	35.4	12.2	-89.89	1,492.1	-1,538.5	1,067.1	1,020.0	47.07	22.672		
9,400.0	7,008.4	7,010.4	7,010.4	37.0	12.2	-89.79	1,492.1	-1,538.5	1,083.0	1,034.3	48.70	22.238		
9,500.0	7,006.6	7,008.6	7,008.6	38.6	12.2	-89.70	1,492.1	-1,538.5	1,107.7	1,057.4	50.35	22.002		
9,600.0	7,004.9	7,006.9	7,006.9	40.3	12.2	-89.60	1,492.1	-1,538.5	1,140.7	1,088.7	52.00	21.936 SF		
9,700.0	7,003.1	7,005.1	7,005.1	41.9	12.2	-89.51	1,492.1	-1,538.5	1,181.3	1,127.6	53.67	22.012		
9,800.0	7,001.4	7,003.4	7,003.4	43.6	12.2	-89.41	1,492.1	-1,538.5	1,228.6	1,173.3	55.34	22.203		
9,900.0	6,999.6	7,001.6	7,001.6	45.2	12.2	-89.32	1,492.1	-1,538.5	1,282.1	1,225.1	57.01	22.487		
10,000.0	6,997.9	6,999.9	6,999.9	46.9	12.2	-89.23	1,492.1	-1,538.5	1,340.8	1,282.1	58.70	22.844		

Anticollision Report

Company:	EnCana Oil & Gas (USA) Inc	Local Co-ordinate Reference:	Well Stelling 3A-4H
Project:	DJ Wattenberg	TVD Reference:	KBE @ 4929.0ft (Original Well Elev)
Reference Site:	SESW S4-T1N-R65W (Stelling)	MD Reference:	KBE @ 4929.0ft (Original Well Elev)
Site Error:	0.0ft	North Reference:	True
Reference Well:	Stelling 3A-4H	Survey Calculation Method:	Minimum Curvature
Well Error:	0.0ft	Output errors are at	2.00 sigma
Reference Wellbore	HZ	Database:	USA EDM 5000 Multi Users DB
Reference Design:	Plan #1	Offset TVD Reference:	Offset Datum

Offset Design SESW S4-T1N-R65W (Stelling) - Stelling 14-4 (Existing) - Existing - Existing													Offset Site Error:	0.0 ft
Survey Program: 0-MWD													Offset Well Error:	0.0 ft
Reference		Offset		Semi Major Axis			Distance						Warning	
Measured Depth Depth (ft)	Vertical Depth (ft)	Measured Depth Depth (ft)	Vertical Depth (ft)	Reference (ft)	Offset (ft)	Highside Toolface (°)	Offset Wellbore Centre +N/-S (ft)	+E/-W (ft)	Between Centres (ft)	Between Ellipses (ft)	Total Uncertainty Axis	Separation Factor		
6,800.0	6,693.3	6,699.3	6,699.3	16.7	11.7	-48.14	-218.2	-1,545.6	1,367.6	1,339.9	27.76	49.273		
6,900.0	6,783.4	6,789.4	6,789.4	16.4	11.8	-59.81	-218.2	-1,545.6	1,341.1	1,313.8	27.31	49.114		
7,000.0	6,864.1	6,870.1	6,870.1	16.0	12.0	-68.58	-218.2	-1,545.6	1,311.1	1,284.4	26.80	48.926		
7,100.0	6,932.4	6,938.4	6,938.4	15.5	12.1	-76.16	-218.2	-1,545.6	1,280.7	1,254.4	26.32	48.660		
7,200.0	6,985.7	6,991.7	6,991.7	15.1	12.2	-82.48	-218.2	-1,545.6	1,253.2	1,227.3	25.90	48.378		
7,300.0	7,022.1	7,028.1	7,028.1	14.7	12.2	-87.10	-218.2	-1,545.6	1,231.7	1,206.1	25.58	48.160		
7,400.0	7,040.3	7,046.3	7,046.3	14.5	12.3	-89.61	-218.2	-1,545.6	1,219.1	1,193.7	25.38	48.028		
7,479.2	7,044.0	7,050.0	7,050.0	14.4	12.3	-90.00	-218.2	-1,545.6	1,216.1	1,190.7	25.38	47.924	CC, ES	
7,500.0	7,041.5	7,047.5	7,047.5	14.4	12.3	-89.98	-218.2	-1,545.6	1,216.6	1,191.2	25.36	47.968		
7,600.0	7,039.8	7,045.8	7,045.8	14.6	12.3	-89.90	-218.2	-1,545.6	1,222.7	1,197.1	25.56	47.835		
7,700.0	7,038.0	7,044.0	7,044.0	15.0	12.3	-89.82	-218.2	-1,545.6	1,236.9	1,210.9	25.98	47.603		
7,800.0	7,036.3	7,042.3	7,042.3	15.6	12.3	-89.73	-218.2	-1,545.6	1,258.9	1,232.2	26.61	47.306		
7,900.0	7,034.5	7,040.5	7,040.5	16.3	12.3	-89.65	-218.2	-1,545.6	1,288.2	1,260.8	27.42	46.986		
8,000.0	7,032.8	7,038.8	7,038.8	17.2	12.3	-89.57	-218.2	-1,545.6	1,324.5	1,296.2	28.38	46.677		
8,100.0	7,031.0	7,037.0	7,037.0	18.2	12.3	-89.49	-218.2	-1,545.6	1,367.2	1,337.7	29.46	46.405	SF	

Anticollision Report

Company:	EnCana Oil & Gas (USA) Inc	Local Co-ordinate Reference:	Well Stelling 3A-4H
Project:	DJ Wattenberg	TVD Reference:	KBE @ 4929.0ft (Original Well Elev)
Reference Site:	SESW S4-T1N-R65W (Stelling)	MD Reference:	KBE @ 4929.0ft (Original Well Elev)
Site Error:	0.0ft	North Reference:	True
Reference Well:	Stelling 3A-4H	Survey Calculation Method:	Minimum Curvature
Well Error:	0.0ft	Output errors are at	2.00 sigma
Reference Wellbore	HZ	Database:	USA EDM 5000 Multi Users DB
Reference Design:	Plan #1	Offset TVD Reference:	Offset Datum

Offset Design SESW S4-T1N-R65W (Stelling) - Stelling 23-4 (Existing) - Existing - Existing													Offset Site Error:	0.0 ft
Survey Program: 0-MWD													Offset Well Error:	0.0 ft
Reference		Offset		Semi Major Axis		Distance		Total		Separation		Warning		
Measured Depth (ft)	Vertical Depth (ft)	Measured Depth (ft)	Vertical Depth (ft)	Reference (ft)	Offset (ft)	Highside Toolface (°)	Offset Wellbore Centre +N/-S (ft)	+E/-W (ft)	Between Centres (ft)	Between Ellipses (ft)	Uncertainty Axis			
7,900.0	7,034.5	7,035.5	7,035.5	16.3	12.3	91.72	1,482.2	179.6	1,294.6	1,267.2	27.41	47.229		
8,000.0	7,032.8	7,033.8	7,033.8	17.2	12.3	91.57	1,482.2	179.6	1,209.2	1,180.8	28.37	42.623		
8,100.0	7,031.0	7,032.0	7,032.0	18.2	12.3	91.41	1,482.2	179.6	1,126.2	1,096.7	29.45	38.235		
8,200.0	7,029.3	7,030.3	7,030.3	19.4	12.2	91.26	1,482.2	179.6	1,046.2	1,015.5	30.64	34.139		
8,300.0	7,027.6	7,028.6	7,028.6	20.6	12.2	91.11	1,482.2	179.6	969.8	937.9	31.92	30.384		
8,400.0	7,025.8	7,026.8	7,026.8	21.9	12.2	90.95	1,482.2	179.6	898.2	864.9	33.26	27.002		
8,500.0	7,024.1	7,025.1	7,025.1	23.2	12.2	90.80	1,482.2	179.6	832.4	797.7	34.67	24.012		
8,600.0	7,022.3	7,023.3	7,023.3	24.6	12.2	90.64	1,482.2	179.6	774.0	737.9	36.12	21.431		
8,700.0	7,020.6	7,021.6	7,021.6	26.1	12.2	90.49	1,482.2	179.6	724.7	687.1	37.60	19.272		
8,800.0	7,018.8	7,019.8	7,019.8	27.6	12.2	90.34	1,482.2	179.6	686.5	647.4	39.12	17.547		
8,900.0	7,017.1	7,018.1	7,018.1	29.1	12.2	90.18	1,482.2	179.6	661.4	620.7	40.67	16.262		
9,000.0	7,015.3	7,016.3	7,016.3	30.6	12.2	90.03	1,482.2	179.6	650.8	608.6	42.24	15.407		
9,019.4	7,015.0	7,016.0	7,016.0	30.9	12.2	90.00	1,482.2	179.6	650.5	608.0	42.55	15.288 CC, ES		
9,100.0	7,013.6	7,014.6	7,014.6	32.2	12.2	89.88	1,482.2	179.6	655.5	611.7	43.83	14.954		
9,200.0	7,011.9	7,012.9	7,012.9	33.8	12.2	89.72	1,482.2	179.6	675.1	629.7	45.44	14.857 SF		
9,300.0	7,010.1	7,011.1	7,011.1	35.4	12.2	89.57	1,482.2	179.6	708.4	661.4	47.06	15.054		
9,400.0	7,008.4	7,009.4	7,009.4	37.0	12.2	89.42	1,482.2	179.6	753.6	704.9	48.69	15.477		
9,500.0	7,006.6	7,007.6	7,007.6	38.6	12.2	89.26	1,482.2	179.6	808.7	758.4	50.34	16.066		
9,600.0	7,004.9	7,005.9	7,005.9	40.3	12.2	89.11	1,482.2	179.6	871.9	819.9	51.99	16.770		
9,700.0	7,003.1	7,004.1	7,004.1	41.9	12.2	88.95	1,482.2	179.6	941.4	887.7	53.65	17.546		
9,800.0	7,001.4	7,002.4	7,002.4	43.6	12.2	88.80	1,482.2	179.6	1,016.0	960.7	55.32	18.366		
9,900.0	6,999.6	7,000.6	7,000.6	45.2	12.2	88.65	1,482.2	179.6	1,094.7	1,037.7	56.99	19.207		
10,000.0	6,997.9	6,998.9	6,998.9	46.9	12.2	88.49	1,482.2	179.6	1,176.6	1,117.9	58.67	20.054		
10,100.0	6,996.1	6,997.1	6,997.1	48.6	12.2	88.34	1,482.2	179.6	1,261.1	1,200.8	60.36	20.895		
10,200.0	6,994.4	6,995.4	6,995.4	50.3	12.2	88.19	1,482.2	179.6	1,347.8	1,285.7	62.04	21.723		

Anticollision Report

Company:	EnCana Oil & Gas (USA) Inc	Local Co-ordinate Reference:	Well Stelling 3A-4H
Project:	DJ Wattenberg	TVD Reference:	KBE @ 4929.0ft (Original Well Elev)
Reference Site:	SESW S4-T1N-R65W (Stelling)	MD Reference:	KBE @ 4929.0ft (Original Well Elev)
Site Error:	0.0ft	North Reference:	True
Reference Well:	Stelling 3A-4H	Survey Calculation Method:	Minimum Curvature
Well Error:	0.0ft	Output errors are at	2.00 sigma
Reference Wellbore	HZ	Database:	USA EDM 5000 Multi Users DB
Reference Design:	Plan #1	Offset TVD Reference:	Offset Datum

Offset Design SESW S4-T1N-R65W (Stelling) - Stelling 24-4 (Existing) - Existing - Existing													Offset Site Error:	0.0 ft
Survey Program: 0-MWD													Offset Well Error:	0.0 ft
Reference		Offset		Semi Major Axis			Distance				Total Uncertainty Axis	Separation Factor	Warning	
Measured Depth (ft)	Vertical Depth (ft)	Measured Depth (ft)	Vertical Depth (ft)	Reference (ft)	Offset (ft)	Highside Toolface (°)	Offset Wellbore Centre +N/-S (ft)	+E/-W (ft)	Between Centres (ft)	Between Ellipses (ft)				
0.0	0.0	0.0	0.0	0.0	0.0	-137.79	-34.3	-31.1	46.3					
100.0	100.0	97.0	97.0	0.2	0.1	-137.79	-34.3	-31.1	46.2	45.9	0.30	154.575		
200.0	200.0	197.0	197.0	0.3	0.3	-137.79	-34.3	-31.1	46.2	45.6	0.65	71.409		
300.0	300.0	297.0	297.0	0.5	0.5	-137.79	-34.3	-31.1	46.2	45.2	1.00	46.397		
400.0	400.0	397.0	397.0	0.7	0.7	-137.79	-34.3	-31.1	46.2	44.9	1.35	34.361		
500.0	500.0	497.0	497.0	0.8	0.8	-137.79	-34.3	-31.1	46.2	44.5	1.69	27.284		
600.0	600.0	597.0	597.0	1.0	1.0	-137.79	-34.3	-31.1	46.2	44.2	2.04	22.624		
700.0	700.0	697.0	697.0	1.2	1.2	-137.79	-34.3	-31.1	46.2	43.8	2.39	19.324		
800.0	800.0	797.0	797.0	1.4	1.4	-137.79	-34.3	-31.1	46.2	43.5	2.74	16.864		
900.0	900.0	897.0	897.0	1.5	1.5	-137.79	-34.3	-31.1	46.2	43.1	3.09	14.959		
1,000.0	1,000.0	997.0	997.0	1.7	1.7	-137.79	-34.3	-31.1	46.2	42.8	3.44	13.441		
1,100.0	1,100.0	1,097.0	1,097.0	1.9	1.9	-137.79	-34.3	-31.1	46.2	42.4	3.79	12.203		
1,200.0	1,200.0	1,197.0	1,197.0	2.1	2.1	-137.79	-34.3	-31.1	46.2	42.1	4.14	11.174		
1,300.0	1,300.0	1,297.0	1,297.0	2.2	2.2	-137.79	-34.3	-31.1	46.2	41.8	4.49	10.304		
1,400.0	1,400.0	1,397.0	1,397.0	2.4	2.4	-137.79	-34.3	-31.1	46.2	41.4	4.84	9.561		
1,500.0	1,500.0	1,497.0	1,497.0	2.6	2.6	-137.79	-34.3	-31.1	46.2	41.1	5.19	8.917		
1,600.0	1,600.0	1,597.0	1,597.0	2.8	2.8	-137.79	-34.3	-31.1	46.2	40.7	5.53	8.355		
1,700.0	1,700.0	1,697.0	1,697.0	2.9	2.9	-137.79	-34.3	-31.1	46.2	40.4	5.88	7.859		
1,800.0	1,800.0	1,797.0	1,797.0	3.1	3.1	-137.79	-34.3	-31.1	46.2	40.0	6.23	7.419		
1,900.0	1,900.0	1,897.0	1,897.0	3.3	3.3	-137.79	-34.3	-31.1	46.2	39.7	6.58	7.025		
2,000.0	2,000.0	1,997.0	1,997.0	3.5	3.5	-137.79	-34.3	-31.1	46.2	39.3	6.93	6.672		
2,100.0	2,100.0	2,097.0	2,097.0	3.6	3.6	-137.79	-34.3	-31.1	46.2	39.0	7.28	6.352		
2,200.0	2,200.0	2,197.0	2,197.0	3.8	3.8	-137.79	-34.3	-31.1	46.2	38.6	7.63	6.061		
2,300.0	2,300.0	2,297.0	2,297.0	4.0	4.0	-137.79	-34.3	-31.1	46.2	38.3	7.98	5.796		
2,400.0	2,400.0	2,397.0	2,397.0	4.2	4.2	-137.79	-34.3	-31.1	46.2	37.9	8.33	5.553		
2,500.0	2,500.0	2,497.0	2,497.0	4.3	4.3	-137.79	-34.3	-31.1	46.2	37.6	8.68	5.329		
2,600.0	2,600.0	2,597.0	2,597.0	4.5	4.5	-137.79	-34.3	-31.1	46.2	37.2	9.03	5.123		
2,700.0	2,700.0	2,697.0	2,697.0	4.7	4.7	-137.79	-34.3	-31.1	46.2	36.9	9.37	4.933		
2,800.0	2,800.0	2,797.0	2,797.0	4.9	4.9	-137.79	-34.3	-31.1	46.2	36.5	9.72	4.755		
2,900.0	2,900.0	2,897.0	2,897.0	5.0	5.0	-137.79	-34.3	-31.1	46.2	36.2	10.07	4.591		
3,000.0	3,000.0	2,997.0	2,997.0	5.2	5.2	-137.79	-34.3	-31.1	46.2	35.8	10.42	4.437		
3,100.0	3,100.0	3,097.0	3,097.0	5.4	5.4	-137.79	-34.3	-31.1	46.2	35.5	10.77	4.293		
3,200.0	3,200.0	3,197.0	3,197.0	5.6	5.6	-137.79	-34.3	-31.1	46.2	35.1	11.12	4.158		
3,300.0	3,300.0	3,297.0	3,297.0	5.7	5.7	-137.79	-34.3	-31.1	46.2	34.8	11.47	4.032		
3,400.0	3,400.0	3,397.0	3,397.0	5.9	5.9	-137.79	-34.3	-31.1	46.2	34.4	11.82	3.913		
3,500.0	3,500.0	3,497.0	3,497.0	6.1	6.1	-137.79	-34.3	-31.1	46.2	34.1	12.17	3.800		
3,600.0	3,600.0	3,597.0	3,597.0	6.3	6.3	-137.79	-34.3	-31.1	46.2	33.7	12.52	3.694		
3,700.0	3,700.0	3,697.0	3,697.0	6.4	6.4	-137.79	-34.3	-31.1	46.2	33.4	12.86	3.594		
3,800.0	3,800.0	3,797.0	3,797.0	6.6	6.6	-137.79	-34.3	-31.1	46.2	33.0	13.21	3.499		
3,900.0	3,900.0	3,897.0	3,897.0	6.8	6.8	-137.79	-34.3	-31.1	46.2	32.7	13.56	3.409		
4,000.0	4,000.0	3,997.0	3,997.0	7.0	7.0	-137.79	-34.3	-31.1	46.2	32.3	13.91	3.324		
4,100.0	4,100.0	4,097.0	4,097.0	7.1	7.1	44.52	-34.3	-31.1	44.3	30.1	14.25	3.110		
4,200.0	4,199.6	4,196.6	4,196.6	7.3	7.3	52.71	-34.3	-31.1	39.1	24.5	14.59	2.681		
4,300.0	4,298.8	4,295.8	4,295.8	7.5	7.5	71.15	-34.3	-31.1	32.9	17.9	14.96	2.197		
4,362.2	4,360.0	4,357.0	4,357.0	7.6	7.6	89.99	-34.3	-31.1	31.1	15.8	15.21	2.042 CC, ES, SF		
4,400.0	4,397.1	4,394.1	4,394.1	7.7	7.6	103.26	-34.3	-31.1	32.0	16.6	15.34	2.082		
4,500.0	4,494.5	4,491.5	4,491.5	7.9	7.8	125.46	-34.3	-31.1	41.7	26.1	15.61	2.670		
4,600.0	4,591.0	4,588.0	4,588.0	8.2	8.0	139.81	-34.3	-31.1	60.1	44.3	15.81	3.801		
4,700.0	4,686.4	4,683.4	4,683.4	8.5	8.2	150.31	-34.3	-31.1	85.0	69.0	16.01	5.306		
4,800.0	4,781.6	4,778.6	4,778.6	8.8	8.3	157.98	-34.3	-31.1	112.8	96.5	16.29	6.922		
4,900.0	4,876.8	4,873.8	4,873.8	9.2	8.5	162.60	-34.3	-31.1	141.7	125.1	16.60	8.537		
5,000.0	4,972.0	4,969.0	4,969.0	9.6	8.6	165.65	-34.3	-31.1	171.3	154.3	16.92	10.118		

CC - Min centre to center distance or convergent point, SF - min separation factor, ES - min ellipse separation

Anticollision Report

Company:	EnCana Oil & Gas (USA) Inc	Local Co-ordinate Reference:	Well Stelling 3A-4H
Project:	DJ Wattenberg	TVD Reference:	KBE @ 4929.0ft (Original Well Elev)
Reference Site:	SESW S4-T1N-R65W (Stelling)	MD Reference:	KBE @ 4929.0ft (Original Well Elev)
Site Error:	0.0ft	North Reference:	True
Reference Well:	Stelling 3A-4H	Survey Calculation Method:	Minimum Curvature
Well Error:	0.0ft	Output errors are at	2.00 sigma
Reference Wellbore	HZ	Database:	USA EDM 5000 Multi Users DB
Reference Design:	Plan #1	Offset TVD Reference:	Offset Datum

Offset Design SESW S4-T1N-R65W (Stelling) - Stelling 24-4 (Existing) - Existing - Existing												Offset Site Error:	0.0 ft
Survey Program: 0-MWD												Offset Well Error:	0.0 ft
Reference		Offset		Semi Major Axis		Distance							
Measured Depth (ft)	Vertical Depth (ft)	Measured Depth (ft)	Vertical Depth (ft)	Reference (ft)	Offset (ft)	Highside Toolface (°)	Offset Wellbore Centre +N/-S (ft)	+E/-W (ft)	Between Centres (ft)	Between Ellipses (ft)	Total Uncertainty Axis	Separation Factor	Warning
5,100.0	5,067.2	5,064.2	5,064.2	9.9	8.8	167.80	-34.3	-31.1	201.1	183.8	17.25	11.654	
5,200.0	5,162.4	5,159.4	5,159.4	10.3	9.0	169.40	-34.3	-31.1	231.1	213.5	17.59	13.141	
5,300.0	5,257.6	5,254.6	5,254.6	10.8	9.1	170.63	-34.3	-31.1	261.3	243.3	17.92	14.578	
5,400.0	5,352.9	5,349.9	5,349.9	11.2	9.3	171.61	-34.3	-31.1	291.5	273.2	18.26	15.966	
5,500.0	5,448.1	5,445.1	5,445.1	11.6	9.5	172.40	-34.3	-31.1	321.8	303.2	18.59	17.306	
5,600.0	5,543.3	5,540.3	5,540.3	12.1	9.6	173.06	-34.3	-31.1	352.1	333.2	18.93	18.601	
5,700.0	5,638.5	5,635.5	5,635.5	12.5	9.8	173.61	-34.3	-31.1	382.5	363.3	19.27	19.851	
5,800.0	5,733.7	5,730.7	5,730.7	13.0	10.0	174.09	-34.3	-31.1	412.9	393.3	19.61	21.060	
5,900.0	5,828.9	5,825.9	5,825.9	13.5	10.1	174.49	-34.3	-31.1	443.4	423.4	19.95	22.229	
6,000.0	5,924.1	5,921.1	5,921.1	14.0	10.3	174.85	-34.3	-31.1	473.8	453.5	20.28	23.359	
6,100.0	6,019.3	6,016.3	6,016.3	14.5	10.5	175.16	-34.3	-31.1	504.3	483.7	20.62	24.453	
6,200.0	6,114.6	6,111.6	6,111.6	15.0	10.6	175.44	-34.3	-31.1	534.8	513.8	20.96	25.512	
6,300.0	6,209.8	6,206.8	6,206.8	15.5	10.8	175.68	-34.3	-31.1	565.2	543.9	21.30	26.538	
6,400.0	6,305.0	6,302.0	6,302.0	16.0	11.0	175.90	-34.3	-31.1	595.7	574.1	21.64	27.532	
6,500.0	6,400.3	6,397.3	6,397.3	16.5	11.1	172.82	-34.3	-31.1	625.9	603.8	22.10	28.329	
6,600.0	6,498.1	6,495.1	6,495.1	16.8	11.3	133.46	-34.3	-31.1	644.6	621.8	22.80	28.271	
6,700.0	6,597.0	6,594.0	6,594.0	16.9	11.5	66.73	-34.3	-31.1	645.7	622.7	23.03	28.037	
6,800.0	6,693.3	6,690.3	6,690.3	16.7	11.7	47.56	-34.3	-31.1	629.6	606.8	22.87	27.536	
6,900.0	6,783.4	6,780.4	6,780.4	16.4	11.8	44.57	-34.3	-31.1	597.8	575.3	22.54	26.525	
7,000.0	6,864.1	6,861.1	6,861.1	16.0	12.0	47.95	-34.3	-31.1	552.5	530.1	22.45	24.614	
7,100.0	6,932.4	6,929.4	6,929.4	15.5	12.1	55.96	-34.3	-31.1	497.3	474.3	23.03	21.595	
7,200.0	6,985.7	6,982.7	6,982.7	15.1	12.2	67.44	-34.3	-31.1	437.2	413.0	24.20	18.066	
7,300.0	7,022.1	7,019.1	7,019.1	14.7	12.2	79.48	-34.3	-31.1	379.3	354.2	25.11	15.102	
7,400.0	7,040.3	7,037.3	7,037.3	14.5	12.3	88.01	-34.3	-31.1	333.1	307.8	25.34	13.147	
7,500.0	7,041.5	7,038.5	7,038.5	14.4	12.3	90.09	-34.3	-31.1	309.6	284.3	25.35	12.215	
7,526.8	7,041.1	7,038.1	7,038.1	14.4	12.3	90.00	-34.3	-31.1	308.4	283.0	25.41	12.137	
7,600.0	7,039.8	7,036.8	7,036.8	14.6	12.3	89.76	-34.3	-31.1	317.0	291.5	25.54	12.411	
7,700.0	7,038.0	7,035.0	7,035.0	15.0	12.3	89.44	-34.3	-31.1	353.7	327.8	25.96	13.624	
7,800.0	7,036.3	7,033.3	7,033.3	15.6	12.3	89.11	-34.3	-31.1	412.0	385.4	26.59	15.497	
7,900.0	7,034.5	7,031.5	7,031.5	16.3	12.2	88.79	-34.3	-31.1	484.1	456.7	27.39	17.675	
8,000.0	7,032.8	7,029.8	7,029.8	17.2	12.2	88.47	-34.3	-31.1	564.8	536.4	28.34	19.926	
8,100.0	7,031.0	7,028.0	7,028.0	18.2	12.2	88.14	-34.3	-31.1	650.8	621.4	29.42	22.119	
8,200.0	7,029.3	7,026.3	7,026.3	19.4	12.2	87.82	-34.3	-31.1	740.4	709.8	30.61	24.190	
8,300.0	7,027.6	7,024.6	7,024.6	20.6	12.2	87.50	-34.3	-31.1	832.3	800.4	31.87	26.113	
8,400.0	7,025.8	7,022.8	7,022.8	21.9	12.2	87.17	-34.3	-31.1	925.9	892.7	33.21	27.881	
8,500.0	7,024.1	7,021.1	7,021.1	23.2	12.2	86.85	-34.3	-31.1	1,020.7	986.1	34.60	29.499	
8,600.0	7,022.3	7,019.3	7,019.3	24.6	12.2	86.53	-34.3	-31.1	1,116.4	1,080.4	36.04	30.979	
8,700.0	7,020.6	7,017.6	7,017.6	26.1	12.2	86.20	-34.3	-31.1	1,212.9	1,175.3	37.51	32.331	
8,800.0	7,018.8	7,015.8	7,015.8	27.6	12.2	85.88	-34.3	-31.1	1,309.8	1,270.8	39.02	33.569	

Anticollision Report

Company:	EnCana Oil & Gas (USA) Inc	Local Co-ordinate Reference:	Well Stelling 3A-4H
Project:	DJ Wattenberg	TVD Reference:	KBE @ 4929.0ft (Original Well Elev)
Reference Site:	SESW S4-T1N-R65W (Stelling)	MD Reference:	KBE @ 4929.0ft (Original Well Elev)
Site Error:	0.0ft	North Reference:	True
Reference Well:	Stelling 3A-4H	Survey Calculation Method:	Minimum Curvature
Well Error:	0.0ft	Output errors are at	2.00 sigma
Reference Wellbore	HZ	Database:	USA EDM 5000 Multi Users DB
Reference Design:	Plan #1	Offset TVD Reference:	Offset Datum

Reference Depths are relative to KBE @ 4929.0ft (Original Well Elev)

Offset Depths are relative to Offset Datum

Central Meridian is -105.500000 °

Coordinates are relative to: Stelling 3A-4H

Coordinate System is US State Plane 1983, Colorado Northern Zone

Grid Convergence at Surface is: 0.54 °

