

PETROLEUM DEVELOPMENT CORP Weld County CO

Well Name: **Carmichael 41-26H**

Surface Location: Carmichael 41-26H Pad Sec.26-T7N-R63W
North American Datum 1983 , US State Plane 1983 , Colorado Northern Zone

Ground Elevation: 4769.0

+N/-S	+E/-W	Northing	Easting	Latitude	Longitude	Slot
0.0	0.0	1445815.89	3306258.77	40.551940	-104.397870	

Original Well Elev WELL @ 4784.0ft (Original Well Elev)

WELLBORE TARGET DETAILS

Name	TVD	+N/-S	+E/-W	Shape
HARDLINE BHL 460'FSL	1.0	-4863.6	-433.4	Polygon
HARDLINE SHL 460'FNL	1.0	-360.0	-400.0	Polygon
TARGET BHL 500'FSL & 1120'FEL	6644.0	-4823.6	-33.4	Point

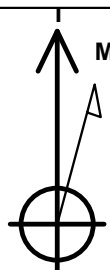

Azimuths to True North
Magnetic North: 8.65°

Magnetic Field
Strength: 53224.1snT
Dip Angle: 67.23°
Date: 9/14/2011
Model: IGRF2010

ANNOTATIONS

TVD	MD	Annotation
5910.5	5910.5	KOP
6674.4	7116.2	End of Build

Carmichael 41-26H Pad Sec.26-T7N-R63W
Carmichael 41-26H
Plan #1 (9-14-11)
7:28, September 15 2011

South(-)/North(+) (1700 ft/in)

SHL 100'FNL, 1120'FEL

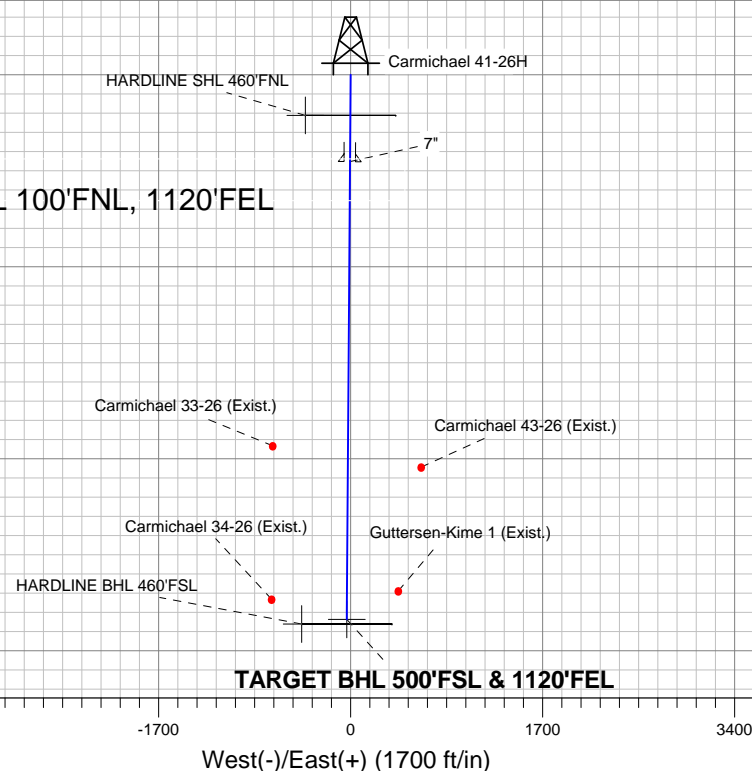

ENSIGN
Directional

SECTION DETAILS

Sec	MD	Inc	Azi	TVD	+N/-S	+E/-W	DLeg	TFace	VSec	Target
1	0.0	0.00	0.00	0.0	0.0	0.0	0.00	0.00	0.0	
2	5910.5	0.00	0.00	5910.5	0.0	0.0	0.00	0.00	0.0	
3	7116.2	90.43	180.40	6674.4	-769.7	-5.3	7.50	180.40	769.7	
4	11170.4	90.43	180.40	6644.0	-4823.6	-33.4	0.00	0.00	4823.7	TARGET BHL 500'FSL & 1120'FEL

