



# KERR MCGEE OIL & GAS ONSHORE LP



Location: COLORADO Slot: SLOT#11 CANNON 36-3 (518'FSL & 2143'FEL)  
Field: WELD COUNTY (KERR MCGEE) Well: CANNON 36-3  
Facility: SEC.03-T2N-R65W Wellbore: CANNON 36-3 PWB

Plot reference wellpath is CANNON 36-3 (REV-A.0) PWP

True vertical depths are referenced to XTREME 12 (RKB)

Grid System: NAD83 / Lambert Colorado SP, Northern Zone (501), US feet

Measured depths are referenced to XTREME 12 (RKB)

North Reference: True north

XTREME 12 (RKB) to Mean Sea Level: 4868 feet

Scale: True distance

Mean Sea Level to Mud line (At Slot: SLOT#11 CANNON 36-3 (518'FSL & 2143'FEL)): 0 feet

Depths are in feet

Coordinates are in feet referenced to Slot

Created by: doddanna on 9/12/2011

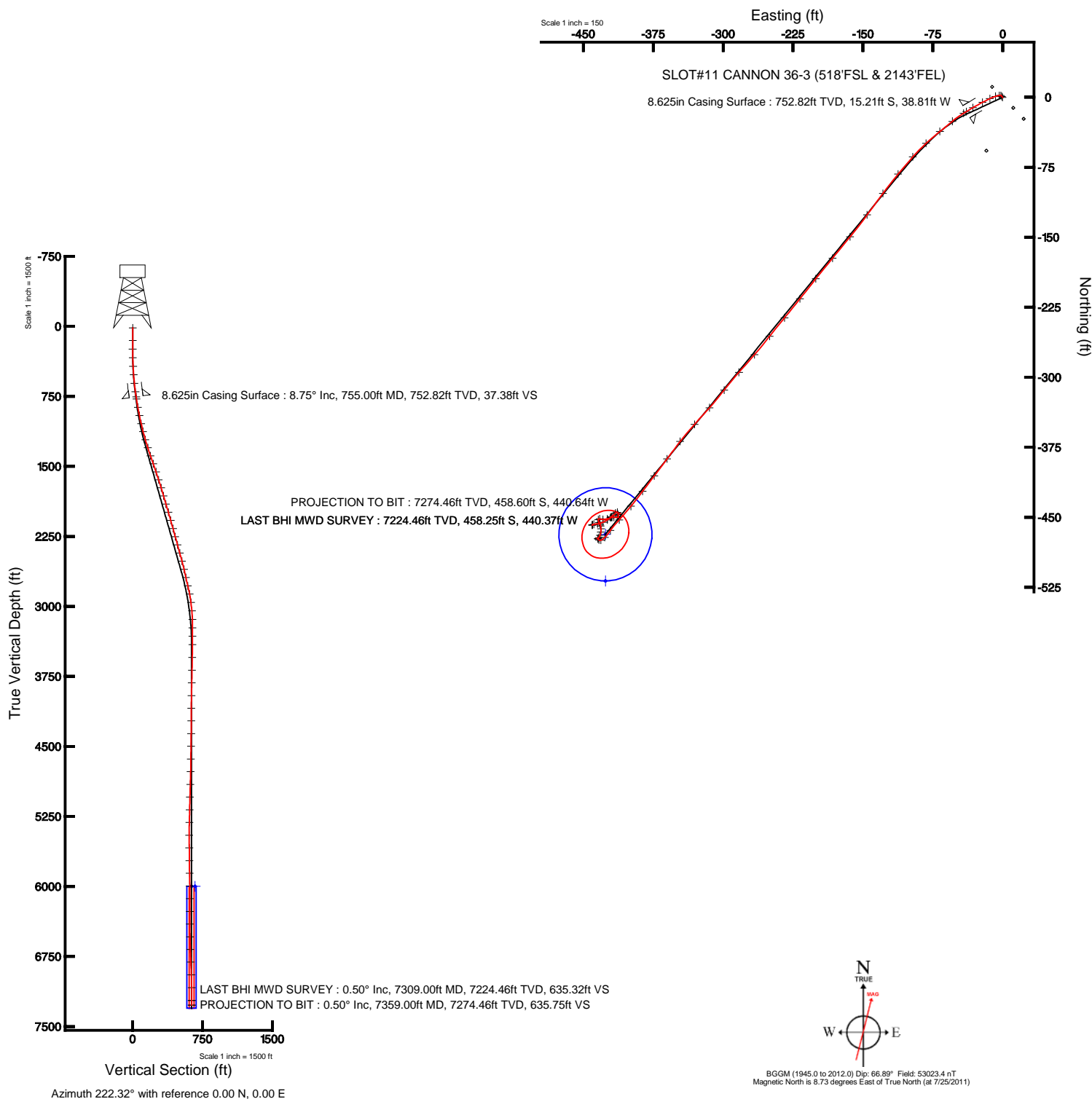



# Actual Wellpath Report

CANNON 36-3 AWP

Page 1 of 4



REFERENCE WELLPATH IDENTIFICATION			
Operator	KERR MCGEE OIL & GAS ONSHORE LP	Slot	SLOT#11 CANNON 36-3 (518'FSL & 2143'FEL)
Area	COLORADO	Well	CANNON 36-3
Field	WELD COUNTY (KERR MCGEE)	Wellbore	CANNON 36-3 AWB
Facility	SEC.03-T2N-R65W		

REPORT SETUP INFORMATION			
Projection System	NAD83 / Lambert Colorado SP, Northern Zone (501), US feet	Software System	WellArchitect® 3.0.0
North Reference	True	User	Doddanna
Scale	0.999958	Report Generated	9/12/2011 at 9:48:43 AM
Convergence at slot	0.55° East	Database/Source file	WA_Denver/CANNON_36-3_AWB.xml

WELLPATH LOCATION						
	Local coordinates		Grid coordinates		Geographic coordinates	
	North[ft]	East[ft]	Easting[US ft]	Northing[US ft]	Latitude	Longitude
Slot Location	-3042.59	-546.42	3238093.08	1302973.18	40°09'42.901"N	104°38'53.153"W
Facility Reference Pt			3238610.16	1306020.75	40°10'12.968"N	104°38'46.115"W
Field Reference Pt			3197771.84	1268891.29	40°04'09.600"N	104°47'36.000"W

WELLPATH DATUM			
Calculation method	Minimum curvature	XTREME 12 (RKB) to Facility Vertical Datum	4868.00ft
Horizontal Reference Pt	Slot	XTREME 12 (RKB) to Mean Sea Level	4868.00ft
Vertical Reference Pt	XTREME 12 (RKB)	XTREME 12 (RKB) to Mud Line at Slot (SLOT#11 CANNON 36-3 (518'FSL & 2143'FEL))	4868.00ft
MD Reference Pt	XTREME 12 (RKB)	Section Origin	N 0.00, E 0.00 ft
Field Vertical Reference	Mean Sea Level	Section Azimuth	222.32°



# Actual Wellpath Report

CANNON 36-3 AWP

Page 2 of 4



REFERENCE WELLPATH IDENTIFICATION			
Operator	KERR MCGEE OIL & GAS ONSHORE LP	Slot	SLOT#11 CANNON 36-3 (518'FSL & 2143'FEL)
Area	COLORADO	Well	CANNON 36-3
Field	WELD COUNTY (KERR MCGEE)	Wellbore	CANNON 36-3 AWP
Facility	SEC.03-T2N-R65W		

WELLPATH DATA (69 stations) † = interpolated/extrapolated station								
MD [ft]	Inclination [°]	Azimuth [°]	TVD [ft]	Vert Sect [ft]	North [ft]	East [ft]	DLS [°/100ft]	Comments
0.00†	0.000	325.500	0.00	0.00	0.00	0.00	0.00	
15.00	0.000	325.500	15.00	0.00	0.00	0.00	0.00	
150.00	1.100	325.500	149.99	-0.30	1.07	-0.73	0.81	
242.00	0.700	299.500	241.98	-0.37	2.07	-1.72	0.61	
334.00	1.800	258.700	333.96	0.92	2.07	-3.63	1.47	
426.00	3.300	254.800	425.86	4.31	1.09	-7.60	1.64	
518.00	4.900	243.600	517.63	10.21	-1.35	-13.68	1.94	
609.00	6.300	243.200	608.19	18.49	-5.33	-21.62	1.54	
700.00	8.400	239.000	698.44	29.53	-11.01	-31.77	2.38	
778.00	8.900	239.400	775.55	40.75	-17.01	-41.85	0.65	
869.00	9.900	229.900	865.33	55.24	-25.64	-53.89	2.02	
960.00	12.000	231.300	954.67	72.34	-36.59	-67.26	2.33	
1050.00	13.000	227.800	1042.54	91.66	-49.24	-82.06	1.39	
1135.00	14.800	221.400	1125.05	112.03	-63.81	-96.32	2.78	
1226.00	16.200	220.000	1212.74	136.34	-82.25	-112.17	1.59	
1316.00	17.800	216.500	1298.81	162.57	-102.93	-128.43	2.11	
1407.00	18.900	216.200	1385.18	191.06	-126.00	-145.40	1.21	
1498.00	19.300	219.700	1471.17	220.74	-149.47	-163.72	1.33	
1589.00	18.800	219.300	1557.19	250.41	-172.39	-182.61	0.57	
1679.00	18.000	218.600	1642.59	278.76	-194.48	-200.47	0.92	
1770.00	17.100	218.600	1729.35	306.15	-215.92	-217.59	0.99	
1861.00	16.400	219.700	1816.49	332.33	-236.26	-234.14	0.84	
1951.00	16.400	217.900	1902.83	357.69	-256.06	-250.06	0.56	
2042.00	16.400	221.100	1990.13	383.34	-275.88	-266.40	0.99	
2133.00	15.700	221.800	2077.58	408.50	-294.74	-283.05	0.80	
2224.00	16.000	217.900	2165.12	433.32	-313.82	-298.96	1.22	
2315.00	15.400	221.800	2252.73	457.90	-332.72	-314.72	1.33	
2405.00	15.500	222.500	2339.48	481.88	-350.50	-330.81	0.24	
2496.00	15.100	217.200	2427.26	505.85	-368.90	-346.19	1.60	
2587.00	14.800	216.900	2515.17	529.22	-387.64	-360.34	0.34	
2678.00	14.200	217.200	2603.28	551.91	-405.82	-374.06	0.66	
2768.00	12.400	216.900	2690.86	572.53	-422.34	-386.54	2.00	
2859.00	13.500	219.300	2779.54	592.86	-438.38	-399.13	1.35	
2950.00	10.900	222.500	2868.48	612.08	-452.94	-411.68	2.95	
3041.00	7.700	215.500	2958.28	626.74	-464.25	-421.03	3.72	
3131.00	4.700	225.700	3047.74	636.41	-471.74	-427.17	3.54	
3222.00	1.900	255.500	3138.59	641.39	-474.72	-431.30	3.51	
3313.00	1.000	313.500	3229.56	642.64	-474.55	-433.34	1.77	
3404.00	0.900	312.800	3320.55	642.62	-473.52	-434.44	0.11	
3494.00	0.400	80.100	3410.55	642.36	-472.99	-434.65	1.32	
3631.00	1.000	32.700	3547.54	640.81	-471.90	-433.53	0.57	
3767.00	1.300	23.600	3683.51	638.17	-469.49	-432.28	0.26	
3903.00	1.700	9.400	3819.46	635.02	-466.08	-431.33	0.40	
4039.00	1.400	352.900	3955.41	632.24	-462.44	-431.20	0.39	
4175.00	1.100	351.200	4091.38	630.34	-459.50	-431.61	0.22	



# Actual Wellpath Report

CANNON 36-3 AWP

Page 3 of 4



REFERENCE WELLPATH IDENTIFICATION			
Operator	KERR MCGEE OIL & GAS ONSHORE LP	Slot	SLOT#11 CANNON 36-3 (518'FSL & 2143'FEL)
Area	COLORADO	Well	CANNON 36-3
Field	WELD COUNTY (KERR MCGEE)	Wellbore	CANNON 36-3 AWB
Facility	SEC.03-T2N-R65W		

WELLPATH DATA (69 stations)								
MD [ft]	Inclination [°]	Azimuth [°]	TVD [ft]	Vert Sect [ft]	North [ft]	East [ft]	DLS [°/100ft]	Comments
4311.00	0.600	320.200	4227.37	629.43	-457.67	-432.26	0.49	
4447.00	1.200	338.200	4363.35	628.71	-455.80	-433.25	0.48	
4583.00	1.400	350.800	4499.31	627.05	-452.84	-434.04	0.26	
4719.00	1.600	109.600	4635.29	625.29	-451.83	-432.52	1.90	
4855.00	1.400	88.500	4771.24	623.40	-452.43	-429.07	0.43	
4992.00	2.500	80.500	4908.16	619.89	-451.89	-424.45	0.83	
5128.00	1.600	40.300	5044.08	615.67	-449.95	-420.30	1.21	
5264.00	1.100	63.900	5180.04	612.55	-447.93	-417.90	0.54	
5400.00	1.700	32.700	5316.00	609.35	-445.66	-415.63	0.70	
5536.00	1.200	131.800	5451.98	607.35	-444.91	-413.48	1.64	
5672.00	1.300	193.300	5587.95	608.68	-447.36	-412.78	0.94	
5808.00	0.800	135.000	5723.93	610.08	-449.53	-412.46	0.82	
5945.00	1.700	268.500	5860.91	611.53	-450.26	-413.81	1.70	
6081.00	1.200	277.300	5996.87	613.74	-450.13	-417.24	0.40	
6217.00	0.600	253.800	6132.85	615.17	-450.15	-419.34	0.51	
6353.00	0.200	293.500	6268.85	615.85	-450.25	-420.24	0.34	
6489.00	0.400	50.200	6404.85	615.46	-449.86	-420.09	0.38	
6625.00	1.400	230.900	6540.84	616.63	-450.60	-421.02	1.32	
6761.00	2.000	236.900	6676.78	620.57	-452.94	-424.30	0.46	
6897.00	2.600	246.000	6812.67	625.69	-455.49	-429.10	0.52	
7034.00	2.500	262.600	6949.53	630.82	-457.14	-434.90	0.54	
7170.00	0.900	263.300	7085.47	633.89	-457.65	-438.91	1.18	
7309.00	0.500	218.300	7224.46	635.32	-458.25	-440.37	0.47	LAST BHI MWD SURVEY
7359.00	0.500	218.300	7274.46	635.75	-458.60	-440.64	0.00	PROJECTION TO BIT

HOLE & CASING SECTIONS - Ref Wellbore: CANNON 36-3 AWB Ref Wellpath: CANNON 36-3 AWP									
String/Diameter	Start MD [ft]	End MD [ft]	Interval [ft]	Start TVD [ft]	End TVD [ft]	Start N/S [ft]	Start E/W [ft]	End N/S [ft]	End E/W [ft]
12.25in Open Hole	15.00	755.00	740.00	15.00	752.82	0.00	0.00	-15.21	-38.81
8.625in Casing Surface	15.00	755.00	740.00	15.00	752.82	0.00	0.00	-15.21	-38.81
7.875in Open Hole	755.00	7359.00	6604.00	752.82	7274.46	-15.21	-38.81	-458.60	-440.64



# Actual Wellpath Report

CANNON 36-3 AWP

Page 4 of 4



REFERENCE WELLPATH IDENTIFICATION			
Operator	KERR MCGEE OIL & GAS ONSHORE LP	Slot	SLOT#11 CANNON 36-3 (518'FSL & 2143'FEL)
Area	COLORADO	Well	CANNON 36-3
Field	WELD COUNTY (KERR MCGEE)	Wellbore	CANNON 36-3 AWB
Facility	SEC.03-T2N-R65W		

TARGETS									
Name	MD [ft]	TVD [ft]	North [ft]	East [ft]	Grid East [US ft]	Grid North [US ft]	Latitude	Longitude	Shape
CANNON 36-3 GEO TARGET 50' RADIUS (50'FSL & 2565'FEL, REV-1)		6000.00	-468.42	-426.48	3237671.14	1302500.70	40°09'38.272"N	104°38'58.646"W	circle
CANNON 36-3 HARDLINE 50'S OF GEO TARGET		6000.00	-518.46	-426.48	3237671.62	1302450.67	40°09'37.778"N	104°38'58.646"W	point

WELLPATH COMPOSITION - Ref Wellbore: CANNON 36-3 AWB					Ref Wellpath: CANNON 36-3 AWP	
Start MD [ft]	End MD [ft]	Positional Uncertainty Model	Log Name/Comment		Wellbore	
15.00	700.00	NaviTrak (Standard)	BHI MWD NAVITRAK 12.25 <150-700>		CANNON 36-3 AWB	
700.00	7309.00	NaviTrak (Standard)	BHI MWD NAVITRAK 7.875 <778-7309>		CANNON 36-3 AWB	
7309.00	7359.00	Blind Drilling (std)	Projection to bit		CANNON 36-3 AWB	