

QUICKSILVER RESOURCES, INC.

CONSTRUCTION LAYOUT FOR
K-DIAMOND RANCH #44-17
SECTION 17, T6N, R92W, 6th. P.M.
824' FSL 843' FEL

FIGURE #1

SCALE: 1" = 50'
DATE: 05-04-11
DRAWN BY: J.I.

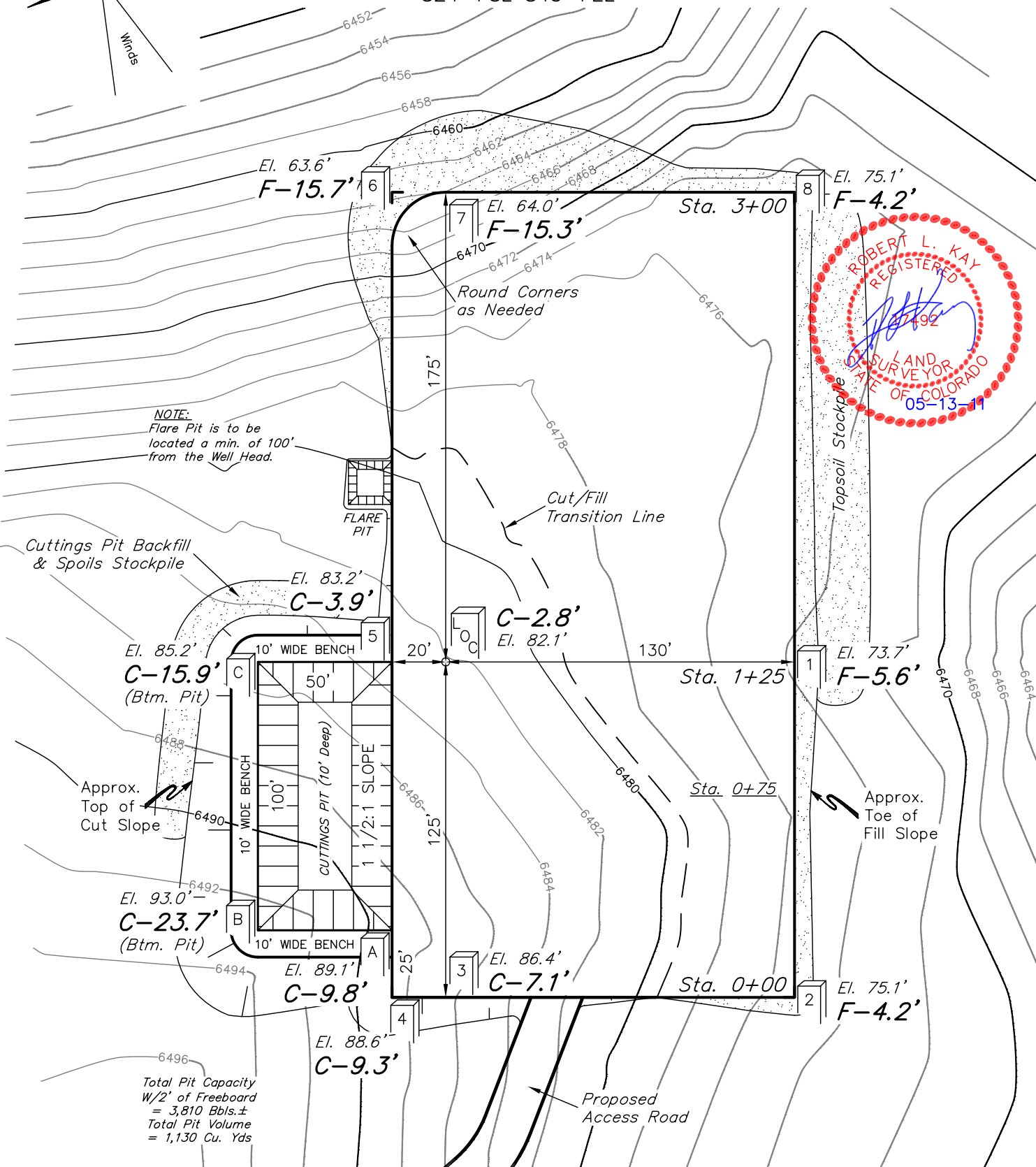
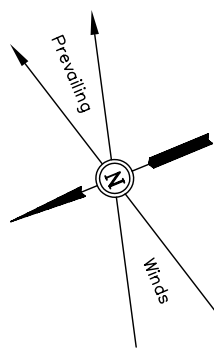

Elev. Ungraded Ground At Loc. Stake = 6482.1'
FINISHED GRADE ELEV. AT LOC. STAKE = 6479.3'

UINTAH ENGINEERING & LAND SURVEYING
85 So. 200 East * Vernal, Utah 84078 * (435) 789-1017

QUICKSILVER RESOURCES, INC.

FIGURE #2

CONSTRUCTION LAYOUT CROSS SECTIONS FOR

K-DIAMOND RANCH #44-17

SECTION 17, T6N, R92W, 6th. P.M.

824' FSL 843' FEL

1" = 20'
X-Section
Scale
1" = 50'

DATE: 05-04-11

DRAWN BY: J.I.

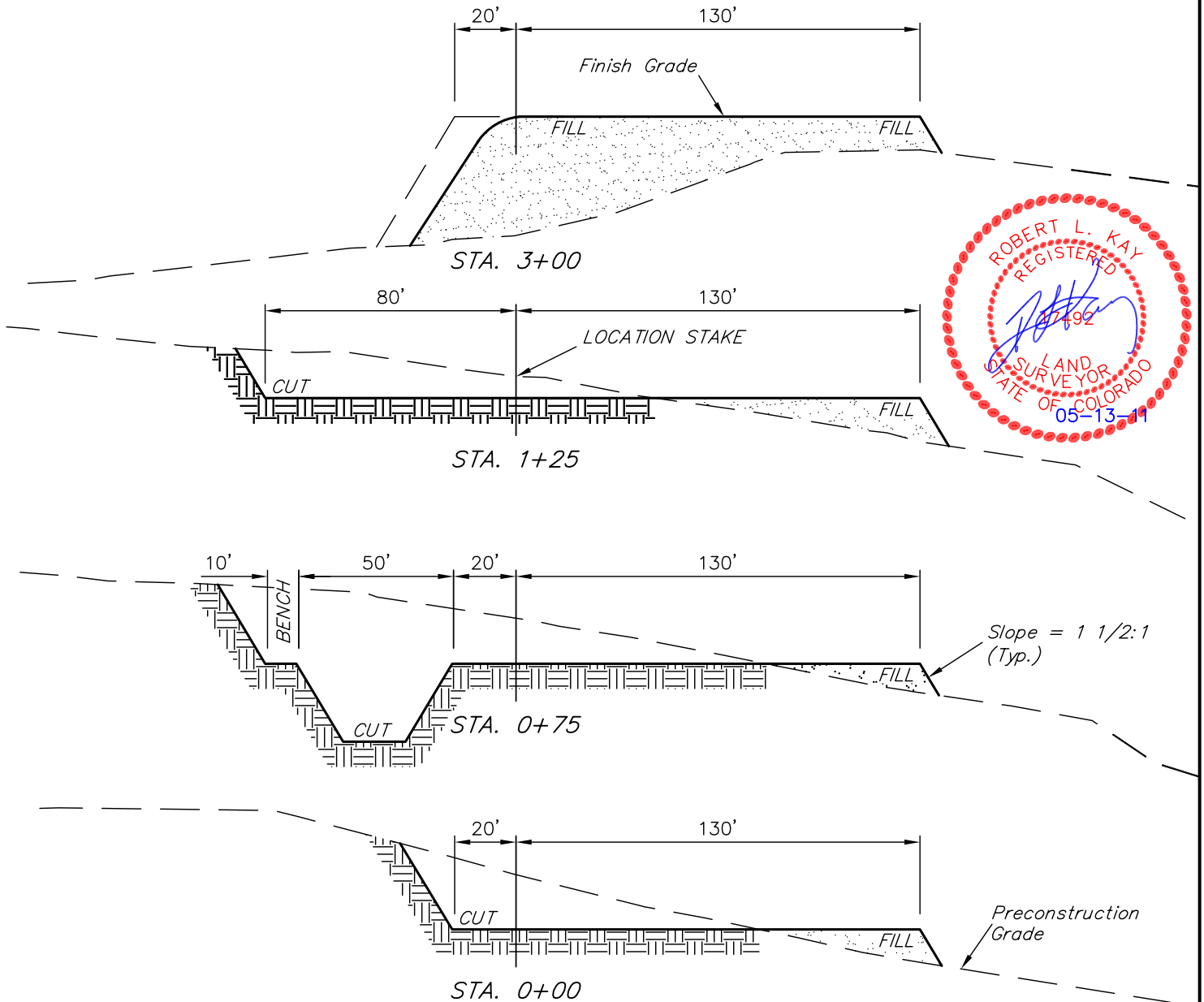

NOTE:

Topsoil should not be Stripped Below Finished Grade on Substructure Area.

APPROXIMATE ACREAGES

WELL SITE DISTURBANCE = ± 1.590 ACRES
ACCESS ROAD DISTURBANCE = ± 0.918 ACRES
TOTAL = ± 2.508 ACRES

* NOTE:
FILL QUANTITY INCLUDES 5% FOR COMPACTION

APPROXIMATE YARDAGES

(6") Topsoil Stripping = 1,230 Cu. Yds.
Remaining Location = 5,750 Cu. Yds.
TOTAL CUT = 6,980 CU.YDS.
FILL = 5,180 CU.YDS.

EXCESS MATERIAL = 1,800 Cu. Yds.
Topsoil & Pit Backfill = 1,800 Cu. Yds.
(1/2 Pit Vol.)
EXCESS UNBALANCE = 0 Cu. Yds.
(After Interim Rehabilitation)

UINTAH ENGINEERING & LAND SURVEYING
85 So. 200 East * Vernal, Utah 84078 * (435) 789-1017

QUICKSILVER RESOURCES, INC.

TYPICAL RIG LAYOUT FOR

K-DIAMOND RANCH #44-17
SECTION 17, T6N, R92W, 6th. P.M.
824' FSL 843' FEL

FIGURE #3

SCALE: 1" = 50'

DATE: 05-04-11

DRAWN BY: J.I.

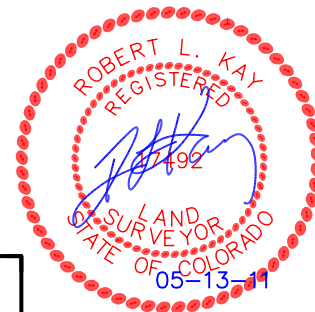
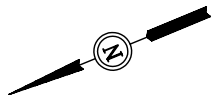

NOTE:
Flare Pit is to be
located a min. of 100'
from the Well Head.

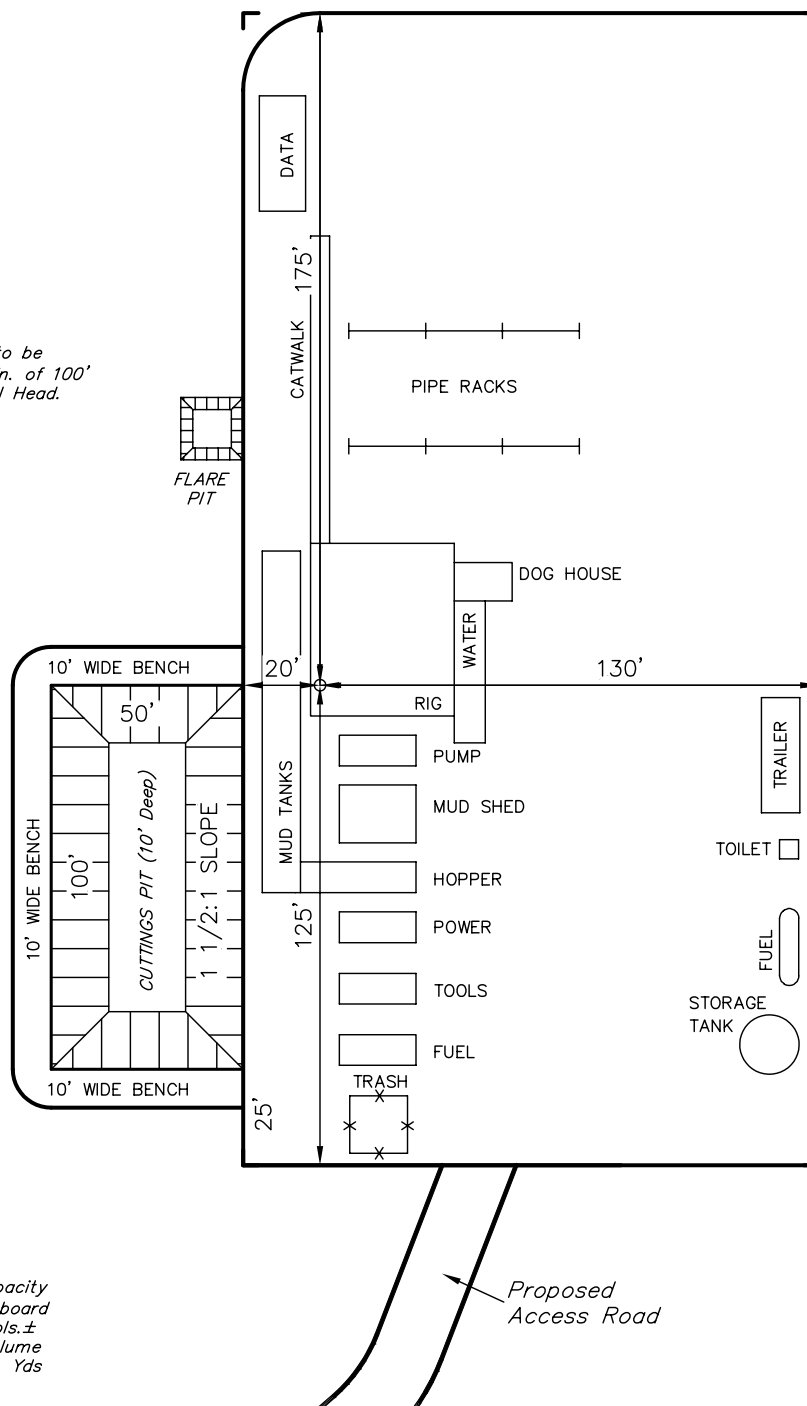

Total Pit Capacity
W/2' of Freeboard
= 3,810 Bbls.±
Total Pit Volume
= 1,130 Cu. Yds

UINTAH ENGINEERING & LAND SURVEYING

85 So. 200 East * Vernal, Utah 84078 * (435) 789-1017