

Encana OIL & GAS (USA) INC.
WELL PAD P08 798
LOCATED IN GARFIELD COUNTY, COLORADO
SECTION 8, T7S, R98W, 6th P.M.

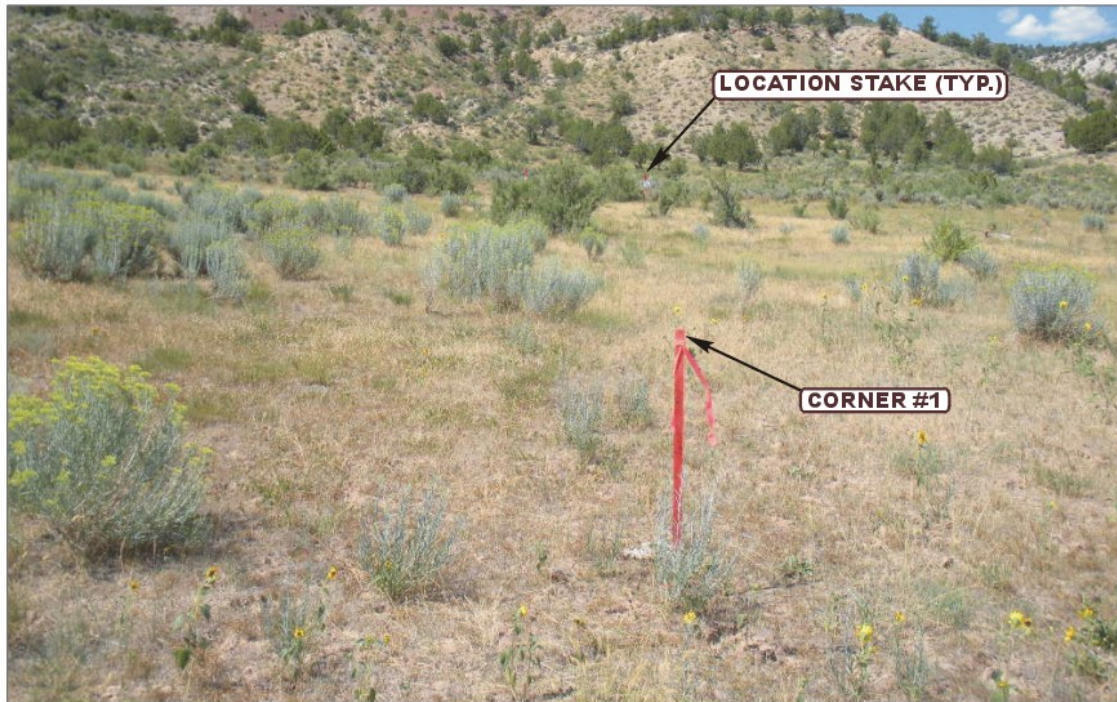

PHOTO: VIEW FROM CORNER #1 TO LOCATION STAKE

CAMERA ANGLE: NORTHERLY



PHOTO: VIEW FROM BEGINNING OF PROPOSED ACCESS

CAMERA ANGLE: NORTHERLY



UELS Uintah Engineering & Land Surveying
85 South 200 East Vernal, Utah 84078
(435) 789-1017 * FAX (435) 789-1813

LOCATION PHOTOS

08 **19** **11**
MONTH DAY YEAR

TAKEN BY: B.J.

DRAWN BY: J.L.G.

REVISED: 00-00-00

PHOTO
P1

Encana OIL & GAS (USA) INC.
WELL PAD P08 798
LOCATED IN GARFIELD COUNTY, COLORADO
SECTION 8, T7S, R98W, 6th P.M.



PHOTO: VIEW OF LOCATION STAKE

CAMERA ANGLE: NORTHERLY



PHOTO: VIEW OF LOCATION STAKE

CAMERA ANGLE: SOUTHERLY



U **E** **L** **S** Uintah Engineering & Land Surveying
85 South 200 East Vernal, Utah 84078
(435) 789-1017 * FAX (435) 789-1813

LOCATION PHOTOS

08 **19** **11**
MONTH DAY YEAR

TAKEN BY: B.J.

DRAWN BY: J.L.G.

REVISED: 00-00-00

PHOTO
P2

Encana OIL & GAS (USA) INC.
WELL PAD P08 798
LOCATED IN GARFIELD COUNTY, COLORADO
SECTION 8, T7S, R98W, 6th P.M.



PHOTO: VIEW OF LOCATION STAKE

CAMERAANGLE: EASTERLY



PHOTO: VIEW OF LOCATION STAKE

CAMERAANGLE: WESTERLY



U **E** **L** **S** Uintah Engineering & Land Surveying
85 South 200 East Vernal, Utah 84078
(435) 789-1017 * FAX (435) 789-1813

- Since 1964 -

LOCATION PHOTOS

08 **19** **11**
MONTH DAY YEAR

TAKEN BY: B.J.

DRAWN BY: J.L.G.

REVISED: 00-00-00

PHOTO
P3