



DE	ET	OE	ES
Received			
8/30/2011			
COGCC Rifle			
Spill #2215365			

Submit original plus one copy. This form is to be used for general, technical and environmental sundry Information. For proposed or completed operations, describe in full on Technical Information Page (Page 2 of this form.) Identify well or other facility by API Number or by OGCC Facility ID. Operator shall send an informational copy of all sundry notices for wells located in High Density Areas to the Local Government Designee (Rule 603b.)

1. OGCC Operator Number: 96850	4. Contact Name Karolina Blaney
2. Name of Operator: Williams Production RMT Company	Phone: 970-683-2285
3. Address: 1058 County Road 215	Fax:
City: Parachute State: CO Zip: 81635	
5. API Number 05- 045- 20627	OGCC Facility ID Number 335529
6. Well/Facility Name: Federal	7. Well/Facility Number KP 34-18
8. Location (QtrQtr, Sec, Twp, Rng, Meridian): SWSE Sec 18 T6S R91W	
9. County: Garfield	10. Field Name: Kokopelli
11. Federal, Indian or State Lease Number: COC 51146	

Complete the Attachment Checklist

OP OGCC

Survey Plat		
Directional Survey		
Surface Eqpmt Diagram		
Technical Info Page	X	
Other	X	

General Notice

☐ **CHANGE OF LOCATION:** Attach New Survey Plat (a change of surface qtr/qtr is substantive and requires a new permit)

Change of <b>Surface</b> Footage <b>from</b> Exterior Section Lines:	<input type="checkbox"/>	<input type="checkbox"/>	<input type="checkbox"/>	<input type="checkbox"/>
Change of <b>Surface</b> Footage <b>to</b> Exterior Section Lines:	<input type="checkbox"/>	<input type="checkbox"/>	<input type="checkbox"/>	<input type="checkbox"/>
Change of <b>Bottomhole</b> Footage <b>from</b> Exterior Section Lines:	<input type="checkbox"/>	<input type="checkbox"/>	<input type="checkbox"/>	<input type="checkbox"/>
Change of <b>Bottomhole</b> Footage <b>to</b> Exterior Section Lines:	<input type="checkbox"/>	<input type="checkbox"/>	<input type="checkbox"/>	<input type="checkbox"/>

Bottomhole location Qtr/Qtr, Sec, Twp, Rng, Mer \_\_\_\_\_

Latitude \_\_\_\_\_ Distance to nearest property line \_\_\_\_\_ Distance to nearest bldg, public rd, utility or RR \_\_\_\_\_

Longitude \_\_\_\_\_ Distance to nearest lease line \_\_\_\_\_ Is location in a High Density Area (rule 603b)? Yes/No ☐

Ground Elevation \_\_\_\_\_ Distance to nearest well same formation \_\_\_\_\_ Surface owner consultation date: \_\_\_\_\_

**GPS DATA:**

Date of Measurement \_\_\_\_\_ PDOP Reading \_\_\_\_\_ Instrument Operator's Name \_\_\_\_\_

☐ **CHANGE SPACING UNIT**

Formation	Formation Code	Spacing order number	Unit Acreage	Unit configuration
<input type="checkbox"/>	<input type="checkbox"/>	<input type="checkbox"/>	<input type="checkbox"/>	<input type="checkbox"/>

☐ **Remove from surface bond**  
Signed surface use agreement attached

☐ **CHANGE OF OPERATOR (prior to drilling):**  
Effective Date: \_\_\_\_\_  
Plugging Bond: ☐ Blanket ☐ Individual

☐ **CHANGE WELL NAME** **NUMBER**  
From: \_\_\_\_\_  
To: \_\_\_\_\_  
Effective Date: \_\_\_\_\_

☐ **ABANDONED LOCATION:**  
Was location ever built? ☐ Yes ☐ No  
Is site ready for Inspection? ☐ Yes ☐ No  
Date Ready for Inspection: \_\_\_\_\_

☐ **NOTICE OF CONTINUED SHUT IN STATUS**  
Date well shut in or temporarily abandoned: \_\_\_\_\_  
Has Production Equipment been removed from site? ☐ Yes ☐ No  
MIT required if shut in longer than two years. Date of last MIT \_\_\_\_\_

☐ **SPUD DATE:** \_\_\_\_\_

☐ **REQUEST FOR CONFIDENTIAL STATUS** (6 mos from date casing set)

☐ **SUBSEQUENT REPORT OF STAGE, SQUEEZE OR REMEDIAL CEMENT WORK** \*submit cbl and cement job summaries

Method used	Cementing tool setting/perf depth	Cement volume	Cement top	Cement bottom	Date
<input type="checkbox"/>	<input type="checkbox"/>	<input type="checkbox"/>	<input type="checkbox"/>	<input type="checkbox"/>	<input type="checkbox"/>

☐ **RECLAMATION:** Attach technical page describing final reclamation procedures per Rule 1004.  
Final reclamation will commence on approximately \_\_\_\_\_

☐ Final reclamation is completed and site is ready for inspection.

Technical Engineering/Environmental Notice

☐ Notice of Intent  
Approximate Start Date: \_\_\_\_\_

☒ Report of Work Done  
Date Work Completed: August 24, 2011

Details of work must be described in full on Technical Information Page (Page 2 must be submitted.)

<input type="checkbox"/> Intent to Recomplete (submit form 2)	<input type="checkbox"/> Request to Vent or Flare	<input type="checkbox"/> E&P Waste Disposal
<input type="checkbox"/> Change Drilling Plans	<input type="checkbox"/> Repair Well	<input type="checkbox"/> Beneficial Reuse of E&P Waste
<input type="checkbox"/> Gross Interval Changed?	<input type="checkbox"/> Rule 502 variance requested	<input checked="" type="checkbox"/> Status Update/Change of Remediation Plans
<input type="checkbox"/> Casing/Cementing Program Change	<input type="checkbox"/> Other: _____	for Spills and Releases

I hereby certify that the statements made in this form are, to the best of my knowledge, true, correct and complete.

Signed: Karolina Blaney Date: 8/25/2011 Email: karolina.blaney@williams.com  
Print Name: Karolina Blaney Title: Environmental Specialist.

COGCC Approved: \_\_\_\_\_ Title \_\_\_\_\_ Date: 9/15/2011

CONDITIONS OF APPROVAL, IF ANY: Location is in 317B External Buffer Zone.  
See Conditions of Approval at bottom of Page #2 of this Sundry Form.



TECHNICAL INFORMATION PAGE



FOR OGCC USE ONLY

1. OGCC Operator Number:	96850	API Number:	05-045-20627
2. Name of Operator:	Williams Production RMT Company OGCC Facility ID # 335529		
3. Well/Facility Name:	Federal	Well/Facility Number:	KP 34-18
4. Location (QtrQtr, Sec, Twp, Rng, Meridian):	SWSE Sec 18 T6S R91W 6th pm		

This form is to be completed whenever a Sundry Notice is submitted requiring detailed report of work to be performed or completed. This form shall be transmitted within 30 days of work completed as a "subsequent" report and must accompany Form 4, page 1.

5. DESCRIBE PROPOSED OR COMPLETED OPERATIONS

Williams Production is submitting the analytical data for the KP 34-18 pad as requested by the COGCC on August 17, 2011. The release occurred on August 2, 2011. The incident tracking number for the release is 2215365. A soil sample was collected on the pad at the point of origin of the release. A second soil sample was collected, off the location, in the sediment trap that was impacted by the release. Both samples were analyzed for Table 910-1. Refer to the attached map (Attachment A) for the sampling locations. Analytical results were below Table 910-1 with the exception of Arsenic and SAR values, which were expected to be somewhat higher, especially on the pad, due to the fact the release was frac water. It is anticipated that the SAR values, most notably off site, will drop to below Table 910-1 standards following one or two natural precipitation events. Background samples were collected for arsenic and SAR from undisturbed areas off the location. These sampling locations are also depicted on the attached map. Williams would like to close this incident out if approved by the COGCC. A copy of the analytical results is included with the Form 4 for reference.

Below are the SAR analytical results for the pad, access road and adjacent field.

KP 34-18 Well Pad	SAR on 8/3/2011	448.7
KP 34-18 Sediment Trap	SAR on 8/3/2011	19.4
Background Location	SAR on 8/18/2011	4.9

Below are the analytical results for arsenic on the pad, access road and background locations.

KP 34-18 Well Pad (Point of Origin)	Depth Collected 0-12 inches	3.5 mg/Kg
KP 34-18 Sediment Trap (Off Location)	Depth Collected 0-12 inches	4.9 mg/Kg
Background Location 1	Depth Collected 0-12 inches	4.4 mg/Kg
Background Location 2	Depth Collected 0-12 inches	4.6 mg/Kg
Background Location 3	Depth Collected 0-12 inches	3.8 mg/Kg

COGCC Conditions of Approval:

Arsenic concentrations reported from the spill path are within arsenic levels identified by background arsenic study plus standard deviation. No further investigation into arsenic concentrations is required for this spill.

SAR concentrations, both on and off the pad, are elevated above table 910-1 levels. SAR-impacted material must be removed from the area where the spill went off the pad, and a minimum of two confirmation sample results, with site map showing sample locations, must be submitted via a Sundry Form 4 referencing the spill number.

SAR-impacted material located near the spill origin on the pad must either be removed and confirmation samples collected and reported as above, or a monitoring schedule must be submitted within 2 weeks which includes precipitation measurement techniques and a minimum of three proposed sample locations. Samples from the proposed locations shall be collected after two precipitation events and the results submitted on a Form 4 referencing the spill number.

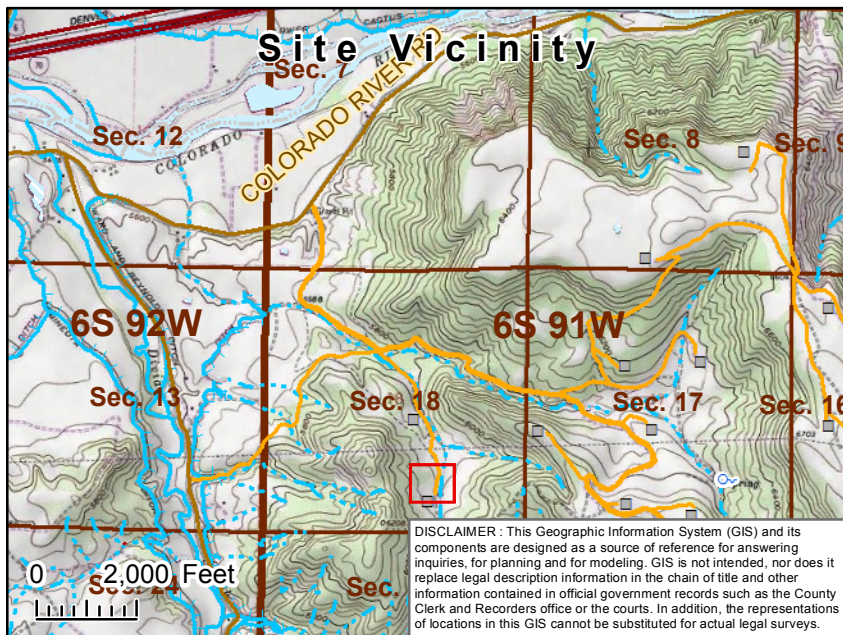

## Attachment A--Sample Location Map

Location: KP 34-18

Williams Production RMT

### Legend

#### PLSS

- Township
- Section

#### Transportation Features

- Highways
- Public Roads
- Williams Access Roads

#### Hydrographic Features

- Perennial Stream
- Intermittent Stream
- Ditch/Canal
- River

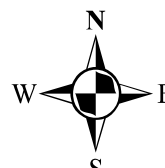

0 37.5 75 150 Feet



09-Aug-2011

Mark Mumby  
HRL Compliance Solutions  
744 Horizon Ct. Suite 140  
Grand Junction, CO 81506

Re: **KP 34-18 8/3/11**

Work Order: **1108137**

Dear Mark,

ALS Environmental received 2 samples on 04-Aug-2011 09:45 AM for the analyses presented in the following report.

The analytical data provided relates directly to the results received by ALS Environmental and for only the analyses requested. The report from the subcontract laboratory is included in its entirety

QC sample results for this data met laboratory specifications. Any exceptions are noted in the Case Narrative, or noted with qualifiers in the report or QC batch information. Should this laboratory report need to be reproduced, it should be reproduced in full unless written approval has been obtained from ALS Environmental. Samples will be disposed in 30 days unless storage arrangements are made.

The total number of pages in this report is 28.

If you have any questions regarding this report, please feel free to contact me.

Sincerely,

A handwritten signature in cursive script that reads "Ann Preston".

Electronically approved by: Joseph Ribar

Ann Preston  
Project Manager



Certificate No: IL100452

ADDRESS 3352 128th Avenue Holland, Michigan 49424-9263 | PHONE (616) 399-6070 | FAX (616) 399-6185

ALS GROUP USA, CORP Part of the ALS Laboratory Group A Campbell Brothers Limited Company

Environmental The ALS logo, a stylized blue triangle with a yellow flame inside.

[www.alsglobal.com](http://www.alsglobal.com)

RIGHT SOLUTIONS RIGHT PARTNER

**ALS Group USA, Corp**

Date: 09-Aug-11

---

**Client:** HRL Compliance Solutions  
**Project:** KP 34-18 8/3/11  
**Work Order:** 1108137**Work Order Sample Summary**

---

<u>Lab Samp ID</u>	<u>Client Sample ID</u>	<u>Matrix</u>	<u>Tag Number</u>	<u>Collection Date</u>	<u>Date Received</u>	<u>Hold</u>
1108137-01	Pt of origin KP 34-18	Soil		8/3/2011 11:05	8/4/2011 09:45	<input type="checkbox"/>
1108137-02	Sed. Trap KP 34-18	Soil		8/3/2011 11:00	8/4/2011 09:45	<input type="checkbox"/>

## ALS Group USA, Corp

Date: 09-Aug-11

---

**Client:** HRL Compliance Solutions

**Project:** KP 34-18 8/3/11

**Work Order:** 1108137

## Case Narrative

---

### QC Summary

#### Metals by ICP-MS

Batch 34734, Method 6020A, Sample 1108113-22B MS/MSD: The MS and MSD recoveries are out of control for several compounds; however, the result in the parent sample is greater than 4x the spike amount. No qualification is required.

**ALS Group USA, Corp**

Date: 09-Aug-11

**Client:** HRL Compliance Solutions  
**Project:** KP 34-18 8/3/11  
**WorkOrder:** 1108137

---



---

**QUALIFIERS,  
ACRONYMS, UNITS**

---

<b><u>Qualifier</u></b>	<b><u>Description</u></b>
*	Value exceeds Regulatory Limit
a	Not accredited
B	Analyte detected in the associated Method Blank above the Reporting Limit
E	Value above quantitation range
H	Analyzed outside of Holding Time
J	Analyte detected below quantitation limit
n	Not offered for accreditation
ND	Not Detected at the Reporting Limit
O	Sample amount is > 4 times amount spiked
P	Dual Column results percent difference > 40%
R	RPD above laboratory control limit
S	Spike Recovery outside laboratory control limits
U	Analyzed but not detected above the MDL

<b><u>Acronym</u></b>	<b><u>Description</u></b>
DUP	Method Duplicate
LCS	Laboratory Control Sample
LCSD	Laboratory Control Sample Duplicate
MBLK	Method Blank
MDL	Method Detection Limit
MQL	Method Quantitation Limit
MS	Matrix Spike
MSD	Matrix Spike Duplicate
PDS	Post Digestion Spike
PQL	Practical Quantitation Limit
SD	Serial Dilution
TDL	Target Detection Limit

<b><u>Units Reported</u></b>	<b><u>Description</u></b>
% of sample	Percent of Sample
µg/Kg-dry as noted	Micrograms per Kilogram Dry Weight
mg/Kg-dry	Milligrams per Kilogram Dry Weight
s.u.	Standard Units

---



**ALS Group USA, Corp**

Date: 09-Aug-11

Client: HRL Compliance Solutions

Project: KP 34-18 8/3/11

Work Order: 1108137

Sample ID: Pt of origin KP 34-18

Lab ID: 1108137-01

Collection Date: 8/3/2011 11:05 AM

Matrix: SOIL

Analyses	Result	Qual	Report Limit	Units	Dilution Factor	Date Analyzed
<b>DIESEL RANGE ORGANICS BY GC-FID</b>						
<b>DRO (C10-C28)</b>	<b>28</b>		<b>SW8015M</b>		Prep Date: <b>8/4/2011</b>	Analyst: <b>RM</b>
			<b>5.2</b>	<b>mg/Kg-dry</b>	1	8/5/2011 11:58 AM
Surr: 4-Terphenyl-d14	108		39-115	%REC	1	8/5/2011 11:58 AM
<b>GASOLINE RANGE ORGANICS BY GC-FID</b>						
<b>GRO (C6-C10)</b>	<b>23</b>		<b>SW8015</b>			Analyst: <b>RM</b>
			<b>6.3</b>	<b>mg/Kg-dry</b>	100	8/4/2011 08:42 PM
Surr: Toluene-d8	110		50-150	%REC	100	8/4/2011 08:42 PM
<b>MERCURY BY CVAA</b>						
Mercury	ND		<b>SW7471</b>		Prep Date: <b>8/5/2011</b>	Analyst: <b>LR</b>
			0.024	mg/Kg-dry	1	8/5/2011 02:41 PM
<b>METALS BY ICP-MS</b>						
<b>Arsenic</b>	<b>3.5</b>		<b>SW6020A</b>		Prep Date: <b>8/4/2011</b>	Analyst: <b>CES</b>
			<b>0.96</b>	<b>mg/Kg-dry</b>	2	8/5/2011 07:14 AM
<b>Barium</b>	<b>700</b>		<b>9.6</b>	<b>mg/Kg-dry</b>	20	8/5/2011 02:30 PM
Cadmium	ND		0.38	mg/Kg-dry	2	8/5/2011 07:14 AM
<b>Chromium</b>	<b>12</b>		<b>0.96</b>	<b>mg/Kg-dry</b>	2	8/5/2011 07:14 AM
<b>Copper</b>	<b>12</b>		<b>0.96</b>	<b>mg/Kg-dry</b>	2	8/5/2011 07:14 AM
<b>Lead</b>	<b>10</b>		<b>0.96</b>	<b>mg/Kg-dry</b>	2	8/5/2011 07:14 AM
<b>Nickel</b>	<b>11</b>		<b>0.96</b>	<b>mg/Kg-dry</b>	2	8/5/2011 07:14 AM
Selenium	ND		0.96	mg/Kg-dry	2	8/5/2011 07:14 AM
Silver	ND		0.96	mg/Kg-dry	2	8/5/2011 07:14 AM
<b>Zinc</b>	<b>77</b>		<b>1.9</b>	<b>mg/Kg-dry</b>	2	8/5/2011 07:14 AM
<b>SUBCONTRACTED ANALYSES</b>						
Subcontracted Analyses	Recvd 8/8/11		<b>SUBCONTRACT</b>			Analyst: <b>A&amp;LGL</b>
			as noted		1	8/8/2011
<b>SEMI-VOLATILE ORGANIC COMPOUNDS</b>						
<b>Acenaphthene</b>	<b>ND</b>		<b>SW8270</b>		Prep Date: <b>8/4/2011</b>	Analyst: <b>CW</b>
			37	µg/Kg-dry	1	8/4/2011 11:35 PM
<b>Anthracene</b>	<b>ND</b>		37	µg/Kg-dry	1	8/4/2011 11:35 PM
<b>Benzo(a)anthracene</b>	<b>ND</b>		37	µg/Kg-dry	1	8/4/2011 11:35 PM
<b>Benzo(a)pyrene</b>	<b>ND</b>		37	µg/Kg-dry	1	8/4/2011 11:35 PM
<b>Benzo(b)fluoranthene</b>	<b>ND</b>		37	µg/Kg-dry	1	8/4/2011 11:35 PM
<b>Benzo(g,h,i)perylene</b>	<b>ND</b>		37	µg/Kg-dry	1	8/4/2011 11:35 PM
<b>Benzo(k)fluoranthene</b>	<b>ND</b>		37	µg/Kg-dry	1	8/4/2011 11:35 PM
<b>Chrysene</b>	<b>ND</b>		37	µg/Kg-dry	1	8/4/2011 11:35 PM
<b>Dibenzo(a,h)anthracene</b>	<b>ND</b>		37	µg/Kg-dry	1	8/4/2011 11:35 PM
<b>Fluoranthene</b>	<b>ND</b>		37	µg/Kg-dry	1	8/4/2011 11:35 PM
<b>Fluorene</b>	<b>ND</b>		37	µg/Kg-dry	1	8/4/2011 11:35 PM
<b>Indeno(1,2,3-cd)pyrene</b>	<b>ND</b>		37	µg/Kg-dry	1	8/4/2011 11:35 PM
<b>Naphthalene</b>	<b>ND</b>		37	µg/Kg-dry	1	8/4/2011 11:35 PM
<b>Pyrene</b>	<b>ND</b>		37	µg/Kg-dry	1	8/4/2011 11:35 PM
Surr: 2,4,6-Tribromophenol	78.9		34-140	%REC	1	8/4/2011 11:35 PM

**Note:** See Qualifiers page for a list of qualifiers and their definitions.



**ALS Group USA, Corp**

Date: 09-Aug-11

**Client:** HRL Compliance Solutions  
**Project:** KP 34-18 8/3/11  
**Sample ID:** Pt of origin KP 34-18  
**Collection Date:** 8/3/2011 11:05 AM

**Work Order:** 1108137  
**Lab ID:** 1108137-01  
**Matrix:** SOIL

Analyses	Result	Qual	Report Limit	Units	Dilution Factor	Date Analyzed
<i>Surr: 2-Fluorobiphenyl</i>	50.9		12-100	%REC	1	8/4/2011 11:35 PM
<i>Surr: 2-Fluorophenol</i>	82.0		33-117	%REC	1	8/4/2011 11:35 PM
<i>Surr: 4-Terphenyl-d14</i>	53.1		25-137	%REC	1	8/4/2011 11:35 PM
<i>Surr: Nitrobenzene-d5</i>	67.5		37-107	%REC	1	8/4/2011 11:35 PM
<i>Surr: Phenol-d6</i>	79.0		40-106	%REC	1	8/4/2011 11:35 PM
<b>VOLATILE ORGANIC COMPOUNDS</b>			<b>SW8260</b>			Analyst: <b>MK</b>
Benzene	ND		130	µg/Kg-dry	100	8/4/2011 09:12 PM
Ethylbenzene	ND		130	µg/Kg-dry	100	8/4/2011 09:12 PM
<b>m,p-Xylene</b>	<b>420</b>		<b>130</b>	<b>µg/Kg-dry</b>	100	8/4/2011 09:12 PM
o-Xylene	ND		130	µg/Kg-dry	100	8/4/2011 09:12 PM
Toluene	ND		130	µg/Kg-dry	100	8/4/2011 09:12 PM
<b>Xylenes, Total</b>	<b>500</b>		<b>380</b>	<b>µg/Kg-dry</b>	100	8/4/2011 09:12 PM
<i>Surr: 1,2-Dichloroethane-d4</i>	96.5		70-120	%REC	100	8/4/2011 09:12 PM
<i>Surr: 4-Bromofluorobenzene</i>	98.1		75-120	%REC	100	8/4/2011 09:12 PM
<i>Surr: Dibromofluoromethane</i>	93.9		85-115	%REC	100	8/4/2011 09:12 PM
<i>Surr: Toluene-d8</i>	99.7		85-115	%REC	100	8/4/2011 09:12 PM
<b>CHROMIUM, TRIVALENT</b>			<b>CALCULATION</b>			Analyst: <b>JJG</b>
<b>Chromium, Trivalent</b>	<b>12</b>			<b>mg/L-dry</b>	1	8/9/2011 08:20 AM
<b>CHROMIUM, HEXAVALENT</b>			<b>SW7196A</b>		Prep Date: <b>8/5/2011</b>	Analyst: <b>MB</b>
Chromium, Hexavalent	ND		0.60	mg/Kg-dry	1	8/8/2011 04:30 PM
<b>MOISTURE</b>			<b>A2540 G</b>			Analyst: <b>CG</b>
<b>Moisture</b>	<b>21</b>		<b>0.050</b>	<b>% of sample</b>	1	8/4/2011 01:52 PM
<b>PH</b>			<b>SW9045D</b>			Analyst: <b>RD</b>
<b>pH</b>	<b>8.88</b>			<b>s.u.</b>	1	8/4/2011 10:05 AM

**Note:** See Qualifiers page for a list of qualifiers and their definitions.

**ALS Group USA, Corp**

Date: 09-Aug-11

Client: HRL Compliance Solutions

Project: KP 34-18 8/3/11

Work Order: 1108137

Sample ID: Sed. Trap KP 34-18

Lab ID: 1108137-02

Collection Date: 8/3/2011 11:00 AM

Matrix: SOIL

Analyses	Result	Qual	Report Limit	Units	Dilution Factor	Date Analyzed
<b>DIESEL RANGE ORGANICS BY GC-FID</b>						
<b>DRO (C10-C28)</b>	<b>25</b>		<b>SW8015M</b>		Prep Date: <b>8/4/2011</b>	Analyst: <b>RM</b>
			<b>5.5</b>	<b>mg/Kg-dry</b>	<b>1</b>	8/5/2011 11:58 AM
Surr: 4-Terphenyl-d14	83.1		39-115	%REC	1	8/5/2011 11:58 AM
<b>GASOLINE RANGE ORGANICS BY GC-FID</b>						
<b>GRO (C6-C10)</b>	<b>ND</b>		<b>SW8015</b>			Analyst: <b>RM</b>
			<b>6.6</b>	<b>mg/Kg-dry</b>	<b>100</b>	8/4/2011 09:08 PM
Surr: Toluene-d8	104		50-150	%REC	100	8/4/2011 09:08 PM
<b>MERCURY BY CVAA</b>						
<b>Mercury</b>	<b>0.029</b>		<b>SW7471</b>		Prep Date: <b>8/5/2011</b>	Analyst: <b>LR</b>
			<b>0.023</b>	<b>mg/Kg-dry</b>	<b>1</b>	8/5/2011 02:43 PM
<b>METALS BY ICP-MS</b>						
<b>Arsenic</b>	<b>4.9</b>		<b>SW6020A</b>		Prep Date: <b>8/4/2011</b>	Analyst: <b>CES</b>
			<b>0.87</b>	<b>mg/Kg-dry</b>	<b>2</b>	8/5/2011 07:20 AM
<b>Barium</b>	<b>700</b>		<b>8.7</b>	<b>mg/Kg-dry</b>	<b>20</b>	8/5/2011 03:00 PM
Cadmium	ND		0.35	mg/Kg-dry	2	8/5/2011 07:20 AM
<b>Chromium</b>	<b>16</b>		<b>0.87</b>	<b>mg/Kg-dry</b>	<b>2</b>	8/5/2011 07:20 AM
<b>Copper</b>	<b>16</b>		<b>0.87</b>	<b>mg/Kg-dry</b>	<b>2</b>	8/5/2011 07:20 AM
<b>Lead</b>	<b>14</b>		<b>0.87</b>	<b>mg/Kg-dry</b>	<b>2</b>	8/5/2011 07:20 AM
<b>Nickel</b>	<b>17</b>		<b>0.87</b>	<b>mg/Kg-dry</b>	<b>2</b>	8/5/2011 07:20 AM
<b>Selenium</b>	<b>1.3</b>		<b>0.87</b>	<b>mg/Kg-dry</b>	<b>2</b>	8/5/2011 07:20 AM
Silver	ND		0.87	mg/Kg-dry	2	8/5/2011 07:20 AM
<b>Zinc</b>	<b>74</b>		<b>1.7</b>	<b>mg/Kg-dry</b>	<b>2</b>	8/5/2011 07:20 AM
<b>SUBCONTRACTED ANALYSES</b>						
<b>Subcontracted Analyses</b>		<b>Recvd 8/8/11</b>	<b>SUBCONTRACT</b>			Analyst: <b>A&amp;LGL</b>
			<b>as noted</b>		<b>1</b>	8/8/2011
<b>SEMI-VOLATILE ORGANIC COMPOUNDS</b>						
<b>Acenaphthene</b>	<b>ND</b>		<b>SW8270</b>		Prep Date: <b>8/4/2011</b>	Analyst: <b>CW</b>
			<b>40</b>	<b>µg/Kg-dry</b>	<b>1</b>	8/5/2011 12:02 PM
<b>Anthracene</b>	<b>ND</b>		<b>40</b>	<b>µg/Kg-dry</b>	<b>1</b>	8/5/2011 12:02 PM
<b>Benzo(a)anthracene</b>	<b>ND</b>		<b>40</b>	<b>µg/Kg-dry</b>	<b>1</b>	8/5/2011 12:02 PM
<b>Benzo(a)pyrene</b>	<b>ND</b>		<b>40</b>	<b>µg/Kg-dry</b>	<b>1</b>	8/5/2011 12:02 PM
<b>Benzo(b)fluoranthene</b>	<b>ND</b>		<b>40</b>	<b>µg/Kg-dry</b>	<b>1</b>	8/5/2011 12:02 PM
<b>Benzo(g,h,i)perylene</b>	<b>ND</b>		<b>40</b>	<b>µg/Kg-dry</b>	<b>1</b>	8/5/2011 12:02 PM
<b>Benzo(k)fluoranthene</b>	<b>ND</b>		<b>40</b>	<b>µg/Kg-dry</b>	<b>1</b>	8/5/2011 12:02 PM
<b>Chrysene</b>	<b>ND</b>		<b>40</b>	<b>µg/Kg-dry</b>	<b>1</b>	8/5/2011 12:02 PM
<b>Dibenzo(a,h)anthracene</b>	<b>ND</b>		<b>40</b>	<b>µg/Kg-dry</b>	<b>1</b>	8/5/2011 12:02 PM
<b>Fluoranthene</b>	<b>ND</b>		<b>40</b>	<b>µg/Kg-dry</b>	<b>1</b>	8/5/2011 12:02 PM
<b>Fluorene</b>	<b>ND</b>		<b>40</b>	<b>µg/Kg-dry</b>	<b>1</b>	8/5/2011 12:02 PM
<b>Indeno(1,2,3-cd)pyrene</b>	<b>ND</b>		<b>40</b>	<b>µg/Kg-dry</b>	<b>1</b>	8/5/2011 12:02 PM
<b>Naphthalene</b>	<b>ND</b>		<b>40</b>	<b>µg/Kg-dry</b>	<b>1</b>	8/5/2011 12:02 PM
<b>Pyrene</b>	<b>ND</b>		<b>40</b>	<b>µg/Kg-dry</b>	<b>1</b>	8/5/2011 12:02 PM
Surr: 2,4,6-Tribromophenol	74.7		34-140	%REC	1	8/5/2011 12:02 PM

**Note:** See Qualifiers page for a list of qualifiers and their definitions.

**ALS Group USA, Corp****Date:** 09-Aug-11

**Client:** HRL Compliance Solutions  
**Project:** KP 34-18 8/3/11  
**Sample ID:** Sed. Trap KP 34-18  
**Collection Date:** 8/3/2011 11:00 AM

**Work Order:** 1108137  
**Lab ID:** 1108137-02  
**Matrix:** SOIL

Analyses	Result	Qual	Report Limit	Units	Dilution Factor	Date Analyzed
<i>Surr: 2-Fluorobiphenyl</i>	55.5		12-100	%REC	1	8/5/2011 12:02 PM
<i>Surr: 2-Fluorophenol</i>	70.4		33-117	%REC	1	8/5/2011 12:02 PM
<i>Surr: 4-Terphenyl-d14</i>	64.5		25-137	%REC	1	8/5/2011 12:02 PM
<i>Surr: Nitrobenzene-d5</i>	58.7		37-107	%REC	1	8/5/2011 12:02 PM
<i>Surr: Phenol-d6</i>	67.9		40-106	%REC	1	8/5/2011 12:02 PM
<b>VOLATILE ORGANIC COMPOUNDS</b>			<b>SW8260</b>			Analyst: <b>MK</b>
Benzene	ND		130	µg/Kg-dry	100	8/4/2011 09:37 PM
Ethylbenzene	ND		130	µg/Kg-dry	100	8/4/2011 09:37 PM
m,p-Xylene	ND		130	µg/Kg-dry	100	8/4/2011 09:37 PM
o-Xylene	ND		130	µg/Kg-dry	100	8/4/2011 09:37 PM
Toluene	ND		130	µg/Kg-dry	100	8/4/2011 09:37 PM
Xylenes, Total	ND		400	µg/Kg-dry	100	8/4/2011 09:37 PM
<i>Surr: 1,2-Dichloroethane-d4</i>	97.3		70-120	%REC	100	8/4/2011 09:37 PM
<i>Surr: 4-Bromofluorobenzene</i>	98.3		75-120	%REC	100	8/4/2011 09:37 PM
<i>Surr: Dibromofluoromethane</i>	95.6		85-115	%REC	100	8/4/2011 09:37 PM
<i>Surr: Toluene-d8</i>	98.8		85-115	%REC	100	8/4/2011 09:37 PM
<b>CHROMIUM, TRIVALENT</b>			<b>CALCULATION</b>			Analyst: <b>JJG</b>
Chromium, Trivalent	16			mg/L-dry	1	8/9/2011 08:20 AM
<b>CHROMIUM, HEXAVALENT</b>			<b>SW7196A</b>		Prep Date: <b>8/5/2011</b>	Analyst: <b>MB</b>
Chromium, Hexavalent	ND		0.66	mg/Kg-dry	1	8/8/2011 04:30 PM
<b>MOISTURE</b>			<b>A2540 G</b>			Analyst: <b>CG</b>
Moisture	25		0.050	% of sample	1	8/4/2011 01:52 PM
<b>PH</b>			<b>SW9045D</b>			Analyst: <b>RD</b>
pH	8.56			s.u.	1	8/4/2011 10:05 AM

**Note:** See Qualifiers page for a list of qualifiers and their definitions.

Report Number: F11217-0210

Account Number: 91000

Received 8/30/2011 Rifle COGCC

# A & L GREAT LAKES LABORATORIES, INC.

3505 Conestoga Drive • Fort Wayne, Indiana 46808-4413 • Phone 260-483-4759 • Fax 260-483-5274

www.algreatlakes.com • lab@algreatlakes.com



**QUALITY ANALYSES FOR INFORMED DECISIONS**

TO: ALS LABORATORY GROUP  
3352 128TH AVE  
HOLLAND, MI 49424-9263

RE: 1108137

DATE RECEIVED: 08/05/2011

DATE REPORTED: 08/08/2011

PAGE: 1

ATTN: ANN PRESTON

## REPORT OF ANALYSIS

LAB NO.	SAMPLE ID	ANALYSIS	RESULT	UNIT	METHOD
52192	01C	Sat'd Paste Extraction with DIW			USDA Handbook 60
		Conductivity (ECe)	35.80	mmho/cm	USDA Handbook 60
		Calcium (Sat'd Paste)	211	ppm	USDA Handbook 60
		Magnesium (Sat'd Paste)	73	ppm	USDA Handbook 60
		Sodium (Sat'd Paste)	29760	ppm	USDA Handbook 60
		Sodium Adsorption Ratio	448.7	-	USDA Handbook 60
52193	02C	Sat'd Paste Extraction with DIW			USDA Handbook 60
		Conductivity (ECe)	0.90	mmho/cm	USDA Handbook 60
		Calcium (Sat'd Paste)	44	ppm	USDA Handbook 60
		Magnesium (Sat'd Paste)	18	ppm	USDA Handbook 60
		Sodium (Sat'd Paste)	607	ppm	USDA Handbook 60
		Sodium Adsorption Ratio	19.4	-	USDA Handbook 60

## ALS Group USA, Corp

Client: HRL Compliance Solutions  
 Work Order: 1108137  
 Project: KP 34-18 8/3/11

## QC BATCH REPORT

Batch ID: **34732** Instrument ID **GC8** Method: **SW8015M**

<b>MBLK</b>	Sample ID: <b>DBLKS1-34732-34732</b>				Units: <b>mg/Kg</b>		Analysis Date: <b>8/5/2011 11:12 AM</b>			
Client ID:	Run ID: <b>GC8_110805A</b>				SeqNo: <b>1697452</b>		Prep Date: <b>8/4/2011</b>		DF: <b>1</b>	
Analyte	Result	PQL	SPK Val	SPK Ref Value	%REC	Control Limit	RPD Ref Value	%RPD	RPD Limit	Qual
DRO (C10-C28)	ND	4.2								
<i>Surr: 4-Terphenyl-d14</i>	1.524	0	1.667	0	91.4	39-115	0			

<b>LCS</b>	Sample ID: <b>DLCSS1-34732-34732</b>				Units: <b>mg/Kg</b>		Analysis Date: <b>8/5/2011 09:17 AM</b>			
Client ID:	Run ID: <b>GC8_110805A</b>				SeqNo: <b>1698910</b>		Prep Date: <b>8/4/2011</b>		DF: <b>1</b>	
Analyte	Result	PQL	SPK Val	SPK Ref Value	%REC	Control Limit	RPD Ref Value	%RPD	RPD Limit	Qual
DRO (C10-C28)	147.4	4.2	166.7	0	88.5	60-130	0			
<i>Surr: 4-Terphenyl-d14</i>	1.253	0	1.667	0	75.2	39-115	0			

<b>LCSD</b>	Sample ID: <b>DLCSDS1-34732-34732</b>				Units: <b>mg/Kg</b>		Analysis Date: <b>8/5/2011 09:17 AM</b>			
Client ID:	Run ID: <b>GC8_110805A</b>				SeqNo: <b>1698936</b>		Prep Date: <b>8/4/2011</b>		DF: <b>1</b>	
Analyte	Result	PQL	SPK Val	SPK Ref Value	%REC	Control Limit	RPD Ref Value	%RPD	RPD Limit	Qual
DRO (C10-C28)	143.1	4.2	166.7	0	85.9	60-130	147.4	2.95	30	
<i>Surr: 4-Terphenyl-d14</i>	1.284	0	1.667	0	77	39-115	1.253	2.44	30	

<b>MS</b>	Sample ID: <b>1108079-03A MS</b>				Units: <b>mg/Kg</b>		Analysis Date: <b>8/5/2011 09:40 AM</b>			
Client ID:	Run ID: <b>GC8_110805A</b>				SeqNo: <b>1698911</b>		Prep Date: <b>8/4/2011</b>		DF: <b>1</b>	
Analyte	Result	PQL	SPK Val	SPK Ref Value	%REC	Control Limit	RPD Ref Value	%RPD	RPD Limit	Qual
DRO (C10-C28)	212.6	8.1	324.2	0	65.6	60-130	0			
<i>Surr: 4-Terphenyl-d14</i>	2.316	0	3.242	0	71.4	39-115	0			

<b>MSD</b>	Sample ID: <b>1108079-03A MSD</b>				Units: <b>mg/Kg</b>		Analysis Date: <b>8/5/2011 09:40 AM</b>			
Client ID:	Run ID: <b>GC8_110805A</b>				SeqNo: <b>1698937</b>		Prep Date: <b>8/4/2011</b>		DF: <b>1</b>	
Analyte	Result	PQL	SPK Val	SPK Ref Value	%REC	Control Limit	RPD Ref Value	%RPD	RPD Limit	Qual
DRO (C10-C28)	262	7.9	317.2	0	82.6	60-130	212.6	20.8	30	
<i>Surr: 4-Terphenyl-d14</i>	3.03	0	3.172	0	95.5	39-115	2.316	26.7	30	

The following samples were analyzed in this batch:

1108137-01B 1108137-02B

Note: See Qualifiers Page for a list of Qualifiers and their explanation.

**Client:** HRL Compliance Solutions  
**Work Order:** 1108137  
**Project:** KP 34-18 8/3/11

**QC BATCH REPORT**

Batch ID: **R93089** Instrument ID **GC9** Method: **SW8015**

<b>MBLK</b>	Sample ID: <b>MBLK-R93089-R93089</b>				Units: <b>µg/L</b>		Analysis Date: <b>8/4/2011 07:23 PM</b>			
Client ID:	Run ID: <b>GC9_110804B</b>				SeqNo: <b>1697305</b>		Prep Date:		DF: <b>1</b>	
Analyte	Result	PQL	SPK Val	SPK Ref Value	%REC	Control Limit	RPD Ref Value	%RPD	RPD Limit	Qual
GRO (C6-C10)	ND	200								
<i>Surr: Toluene-d8</i>	<i>106.3</i>	<i>0</i>	<i>100</i>	<i>0</i>	<i>106</i>	<i>70-130</i>	<i>0</i>			

<b>LCS</b>	Sample ID: <b>LCS-R93089-R93089</b>				Units: <b>µg/L</b>		Analysis Date: <b>8/4/2011 06:04 PM</b>			
Client ID:	Run ID: <b>GC9_110804B</b>				SeqNo: <b>1697303</b>		Prep Date:		DF: <b>1</b>	
Analyte	Result	PQL	SPK Val	SPK Ref Value	%REC	Control Limit	RPD Ref Value	%RPD	RPD Limit	Qual
GRO (C6-C10)	26680	200	25000	0	107	70-130	0			
<i>Surr: Toluene-d8</i>	<i>113.4</i>	<i>0</i>	<i>100</i>	<i>0</i>	<i>113</i>	<i>70-130</i>	<i>0</i>			

<b>LCSD</b>	Sample ID: <b>LCSD-R93089-R93089</b>				Units: <b>µg/L</b>		Analysis Date: <b>8/4/2011 06:30 PM</b>			
Client ID:	Run ID: <b>GC9_110804B</b>				SeqNo: <b>1697304</b>		Prep Date:		DF: <b>1</b>	
Analyte	Result	PQL	SPK Val	SPK Ref Value	%REC	Control Limit	RPD Ref Value	%RPD	RPD Limit	Qual
GRO (C6-C10)	25590	200	25000	0	102	70-130	26680	4.16	30	
<i>Surr: Toluene-d8</i>	<i>111.5</i>	<i>0</i>	<i>100</i>	<i>0</i>	<i>111</i>	<i>70-130</i>	<i>113.4</i>	<i>1.75</i>	<i>30</i>	

<b>MS</b>	Sample ID: <b>1108113-01A MS</b>				Units: <b>µg/Kg</b>		Analysis Date: <b>8/5/2011 04:30 AM</b>			
Client ID:	Run ID: <b>GC9_110804B</b>				SeqNo: <b>1697338</b>		Prep Date:		DF: <b>50</b>	
Analyte	Result	PQL	SPK Val	SPK Ref Value	%REC	Control Limit	RPD Ref Value	%RPD	RPD Limit	Qual
GRO (C6-C10)	1308000	2,500	1250000	0	105	70-130	0			
<i>Surr: Toluene-d8</i>	<i>5096</i>	<i>0</i>	<i>5000</i>	<i>0</i>	<i>102</i>	<i>50-150</i>	<i>0</i>			

<b>MSD</b>	Sample ID: <b>1108113-01A MSD</b>				Units: <b>µg/Kg</b>		Analysis Date: <b>8/5/2011 04:56 AM</b>			
Client ID:	Run ID: <b>GC9_110804B</b>				SeqNo: <b>1697339</b>		Prep Date:		DF: <b>50</b>	
Analyte	Result	PQL	SPK Val	SPK Ref Value	%REC	Control Limit	RPD Ref Value	%RPD	RPD Limit	Qual
GRO (C6-C10)	1257000	2,500	1250000	0	101	70-130	1308000	3.98	30	
<i>Surr: Toluene-d8</i>	<i>5112</i>	<i>0</i>	<i>5000</i>	<i>0</i>	<i>102</i>	<i>50-150</i>	<i>5096</i>	<i>0.323</i>	<i>30</i>	

The following samples were analyzed in this batch: | 1108137-01A | 1108137-02A |

**Note:** See Qualifiers Page for a list of Qualifiers and their explanation.

**Client:** HRL Compliance Solutions  
**Work Order:** 1108137  
**Project:** KP 34-18 8/3/11

**QC BATCH REPORT**

Batch ID: **34751** Instrument ID **HG1** Method: **SW7471**

<b>MBLK</b>	Sample ID: <b>MBLK-34751-34751</b>				Units: <b>mg/Kg</b>		Analysis Date: <b>8/5/2011 02:32 PM</b>			
Client ID:	Run ID: <b>HG1_110805A</b>				SeqNo: <b>1697107</b>		Prep Date: <b>8/5/2011</b>		DF: <b>1</b>	
Analyte	Result	PQL	SPK Val	SPK Ref Value	%REC	Control Limit	RPD Ref Value	%RPD	RPD Limit	Qual
Mercury	ND	0.020								

<b>LCS</b>	Sample ID: <b>LCS-34751-34751</b>				Units: <b>mg/Kg</b>		Analysis Date: <b>8/5/2011 02:34 PM</b>			
Client ID:	Run ID: <b>HG1_110805A</b>				SeqNo: <b>1697108</b>		Prep Date: <b>8/5/2011</b>		DF: <b>1</b>	
Analyte	Result	PQL	SPK Val	SPK Ref Value	%REC	Control Limit	RPD Ref Value	%RPD	RPD Limit	Qual
Mercury	0.175	0.020	0.1665		0	105	80-120	0		

<b>LCSD</b>	Sample ID: <b>LCSD-34751-34751</b>				Units: <b>mg/Kg</b>		Analysis Date: <b>8/5/2011 02:36 PM</b>			
Client ID:	Run ID: <b>HG1_110805A</b>				SeqNo: <b>1697109</b>		Prep Date: <b>8/5/2011</b>		DF: <b>1</b>	
Analyte	Result	PQL	SPK Val	SPK Ref Value	%REC	Control Limit	RPD Ref Value	%RPD	RPD Limit	Qual
Mercury	0.1749	0.020	0.1665		0	105	80-120	0.175	0.0476	20

<b>MS</b>	Sample ID: <b>1108172-04AMS</b>				Units: <b>mg/Kg</b>		Analysis Date: <b>8/5/2011 03:09 PM</b>			
Client ID:	Run ID: <b>HG1_110805A</b>				SeqNo: <b>1697166</b>		Prep Date: <b>8/5/2011</b>		DF: <b>1</b>	
Analyte	Result	PQL	SPK Val	SPK Ref Value	%REC	Control Limit	RPD Ref Value	%RPD	RPD Limit	Qual
Mercury	0.1646	0.018	0.1471	0.01626	101	75-125	0			

<b>MSD</b>	Sample ID: <b>1108172-04AMSD</b>				Units: <b>mg/Kg</b>		Analysis Date: <b>8/5/2011 03:11 PM</b>			
Client ID:	Run ID: <b>HG1_110805A</b>				SeqNo: <b>1697170</b>		Prep Date: <b>8/5/2011</b>		DF: <b>1</b>	
Analyte	Result	PQL	SPK Val	SPK Ref Value	%REC	Control Limit	RPD Ref Value	%RPD	RPD Limit	Qual
Mercury	0.163	0.018	0.1482	0.01626	99	75-125	0.1646	0.976	35	

The following samples were analyzed in this batch:

1108137-01B	1108137-02B
-------------	-------------

**Note:** See Qualifiers Page for a list of Qualifiers and their explanation.



**Client:** HRL Compliance Solutions  
**Work Order:** 1108137  
**Project:** KP 34-18 8/3/11

**QC BATCH REPORT**

Batch ID: **34734** Instrument ID **ICPMS1** Method: **SW6020A**

<b>MBLK</b>		Sample ID: <b>MBLK-34734-34734</b>				Units: <b>mg/Kg</b>		Analysis Date: <b>8/5/2011 04:40 AM</b>		
Client ID:		Run ID: <b>ICPMS1_110804A</b>				SeqNo: <b>1696499</b>		Prep Date: <b>8/4/2011</b>		DF: <b>1</b>
Analyte	Result	PQL	SPK Val	SPK Ref Value	%REC	Control Limit	RPD Ref Value	%RPD	RPD Limit	Qual
Arsenic	ND	0.25								
Barium	ND	0.25								
Cadmium	ND	0.10								
Chromium	0.00438	0.25								J
Copper	ND	0.25								
Lead	ND	0.25								
Nickel	ND	0.25								
Selenium	ND	0.25								
Silver	ND	0.25								
Zinc	ND	0.50								

<b>LCS</b>		Sample ID: <b>LCS-34734-34734</b>				Units: <b>mg/Kg</b>		Analysis Date: <b>8/5/2011 04:46 AM</b>		
Client ID:		Run ID: <b>ICPMS1_110804A</b>				SeqNo: <b>1696500</b>		Prep Date: <b>8/4/2011</b>		DF: <b>1</b>
Analyte	Result	PQL	SPK Val	SPK Ref Value	%REC	Control Limit	RPD Ref Value	%RPD	RPD Limit	Qual
Arsenic	5.045	0.25	5	0	101	80-120	0			
Barium	5.24	0.25	5	0	105	80-120	0			
Cadmium	4.95	0.10	5	0	99	80-120	0			
Chromium	5.48	0.25	5	0	110	80-120	0			
Copper	5.41	0.25	5	0	108	80-120	0			
Lead	5.205	0.25	5	0	104	80-120	0			
Nickel	5.46	0.25	5	0	109	80-120	0			
Selenium	4.779	0.25	5	0	95.6	80-120	0			
Silver	5.225	0.25	5	0	104	80-120	0			
Zinc	4.972	0.50	5	0	99.4	80-120	0			

<b>LCSD</b>		Sample ID: <b>LCSD-34734-34734</b>				Units: <b>mg/Kg</b>		Analysis Date: <b>8/5/2011 04:52 AM</b>		
Client ID:		Run ID: <b>ICPMS1_110804A</b>				SeqNo: <b>1696502</b>		Prep Date: <b>8/4/2011</b>		DF: <b>1</b>
Analyte	Result	PQL	SPK Val	SPK Ref Value	%REC	Control Limit	RPD Ref Value	%RPD	RPD Limit	Qual
Arsenic	4.958	0.25	5	0	99.2	80-120	5.045	1.75	20	
Barium	5.075	0.25	5	0	102	80-120	5.24	3.2	20	
Cadmium	4.805	0.10	5	0	96.1	80-120	4.95	2.98	20	
Chromium	5.375	0.25	5	0	108	80-120	5.48	1.93	20	
Copper	5.325	0.25	5	0	106	80-120	5.41	1.58	20	
Lead	5.09	0.25	5	0	102	80-120	5.205	2.23	20	
Nickel	5.375	0.25	5	0	108	80-120	5.46	1.57	20	
Selenium	4.683	0.25	5	0	93.7	80-120	4.779	2.03	20	
Silver	5.12	0.25	5	0	102	80-120	5.225	2.03	20	
Zinc	4.75	0.50	5	0	95	80-120	4.972	4.57	20	

**Note:** See Qualifiers Page for a list of Qualifiers and their explanation.

**Client:** HRL Compliance Solutions  
**Work Order:** 1108137  
**Project:** KP 34-18 8/3/11

**QC BATCH REPORT**

Batch ID: **34734** Instrument ID **ICPMS1** Method: **SW6020A**

<b>MS</b>		Sample ID: <b>1108113-22BMS</b>				Units: <b>mg/Kg</b>		Analysis Date: <b>8/5/2011 06:21 AM</b>		
Client ID:		Run ID: <b>ICPMS1_110804A</b>				SeqNo: <b>1696522</b>		Prep Date: <b>8/4/2011</b>		DF: <b>4</b>
Analyte	Result	PQL	SPK Val	SPK Ref Value	%REC	Control Limit	RPD Ref Value	%RPD	RPD Limit	Qual
Arsenic	13.98	1.5	7.289	7.263	92.2	80-120	0			
Barium	66.73	1.5	7.289	61.36	73.8	80-120	0			SO
Cadmium	12.56	0.58	7.289	5.23	101	80-120	0			
Chromium	24.04	1.5	7.289	25.64	-22	80-120	0			S
Copper	18.72	1.5	7.289	12.68	82.8	80-120	0			
Lead	28.52	1.5	7.289	23.01	75.5	80-120	0			S
Nickel	19.21	1.5	7.289	12.93	86.2	80-120	0			
Selenium	7.638	1.5	7.289	0.8792	92.7	80-120	0			
Silver	7.525	1.5	7.289	0.4977	96.4	80-120	0			
Zinc	96.71	2.9	7.289	100.4	-50.7	80-120	0			SO

<b>MSD</b>		Sample ID: <b>1108113-22BMSD</b>				Units: <b>mg/Kg</b>		Analysis Date: <b>8/5/2011 06:27 AM</b>		
Client ID:		Run ID: <b>ICPMS1_110804A</b>				SeqNo: <b>1696524</b>		Prep Date: <b>8/4/2011</b>		DF: <b>4</b>
Analyte	Result	PQL	SPK Val	SPK Ref Value	%REC	Control Limit	RPD Ref Value	%RPD	RPD Limit	Qual
Arsenic	14.51	1.5	7.364	7.263	98.4	80-120	13.98	3.68	25	
Barium	71.31	1.5	7.364	61.36	135	80-120	66.73	6.63	25	SO
Cadmium	13.72	0.59	7.364	5.23	115	80-120	12.56	8.85	25	
Chromium	23.35	1.5	7.364	25.64	-31.1	80-120	24.04	2.89	25	S
Copper	20.18	1.5	7.364	12.68	102	80-120	18.72	7.51	25	
Lead	30.13	1.5	7.364	23.01	96.7	80-120	28.52	5.51	25	
Nickel	19.31	1.5	7.364	12.93	86.7	80-120	19.21	0.524	25	
Selenium	7.959	1.5	7.364	0.8792	96.1	80-120	7.638	4.11	25	
Silver	7.629	1.5	7.364	0.4977	96.8	80-120	7.525	1.37	25	
Zinc	102.7	2.9	7.364	100.4	31.4	80-120	96.71	6.02	25	SO

The following samples were analyzed in this batch:

1108137-01B	1108137-02B
-------------	-------------

**Note:** See Qualifiers Page for a list of Qualifiers and their explanation.

**Client:** HRL Compliance Solutions  
**Work Order:** 1108137  
**Project:** KP 34-18 8/3/11

**QC BATCH REPORT**

Batch ID: **34731** Instrument ID **SVMS6** Method: **SW8270**

**MBLK** Sample ID: **SBLKS1-34731-34731** Units: **µg/Kg** Analysis Date: **8/4/2011 08:55 PM**

Client ID: Run ID: **SVMS6\_110804A** SeqNo: **1696562** Prep Date: **8/4/2011** DF: **1**

Analyte	Result	PQL	SPK Val	SPK Ref Value	%REC	Control Limit	RPD Ref Value	%RPD	RPD Limit	Qual
Acenaphthene	ND	30								
Anthracene	ND	30								
Benzo(a)anthracene	ND	30								
Benzo(a)pyrene	ND	30								
Benzo(b)fluoranthene	ND	30								
Benzo(g,h,i)perylene	ND	30								
Benzo(k)fluoranthene	ND	30								
Chrysene	ND	30								
Dibenzo(a,h)anthracene	ND	30								
Fluoranthene	ND	30								
Fluorene	ND	30								
Indeno(1,2,3-cd)pyrene	ND	30								
Naphthalene	ND	30								
Pyrene	ND	30								
<i>Surr: 2,4,6-Tribromophenol</i>	<i>1258</i>	<i>0</i>	<i>1667</i>	<i>0</i>	<i>75.5</i>	<i>34-140</i>	<i>0</i>			
<i>Surr: 2-Fluorobiphenyl</i>	<i>1065</i>	<i>0</i>	<i>1667</i>	<i>0</i>	<i>63.9</i>	<i>12-100</i>	<i>0</i>			
<i>Surr: 2-Fluorophenol</i>	<i>1259</i>	<i>0</i>	<i>1667</i>	<i>0</i>	<i>75.6</i>	<i>33-117</i>	<i>0</i>			
<i>Surr: 4-Terphenyl-d14</i>	<i>1141</i>	<i>0</i>	<i>1667</i>	<i>0</i>	<i>68.5</i>	<i>25-137</i>	<i>0</i>			
<i>Surr: Nitrobenzene-d5</i>	<i>1057</i>	<i>0</i>	<i>1667</i>	<i>0</i>	<i>63.4</i>	<i>37-107</i>	<i>0</i>			
<i>Surr: Phenol-d6</i>	<i>1195</i>	<i>0</i>	<i>1667</i>	<i>0</i>	<i>71.7</i>	<i>40-106</i>	<i>0</i>			

**Note:** See Qualifiers Page for a list of Qualifiers and their explanation.

**Client:** HRL Compliance Solutions  
**Work Order:** 1108137  
**Project:** KP 34-18 8/3/11

**QC BATCH REPORT**

Batch ID: **34731** Instrument ID **SVMS6** Method: **SW8270**

LCS		Sample ID: <b>SLCSS1-34731-34731</b>				Units: <b>µg/Kg</b>		Analysis Date: <b>8/4/2011 09:21 PM</b>		
Client ID:		Run ID: <b>SVMS6_110804A</b>				SeqNo: <b>1696563</b>		Prep Date: <b>8/4/2011</b>		DF: <b>1</b>
Analyte	Result	PQL	SPK Val	SPK Ref Value	%REC	Control Limit	RPD Ref Value	%RPD	RPD Limit	Qual
Acenaphthene	1029	30	1333	0	77.2	45-110	0			
Anthracene	1157	30	1333	0	86.8	55-105	0			
Benzo(a)anthracene	1191	30	1333	0	89.4	50-110	0			
Benzo(a)pyrene	1245	30	1333	0	93.4	50-110	0			
Benzo(b)fluoranthene	1361	30	1333	0	102	45-115	0			
Benzo(g,h,i)perylene	903.7	30	1333	0	67.8	40-125	0			
Benzo(k)fluoranthene	1249	30	1333	0	93.7	45-115	0			
Chrysene	1150	30	1333	0	86.3	55-110	0			
Dibenzo(a,h)anthracene	1069	30	1333	0	80.2	40-125	0			
Fluoranthene	1218	30	1333	0	91.3	55-115	0			
Fluorene	1080	30	1333	0	81	50-110	0			
Indeno(1,2,3-cd)pyrene	992.7	30	1333	0	74.5	40-120	0			
Naphthalene	953.7	30	1333	0	71.5	40-105	0			
Pyrene	1201	30	1333	0	90.1	45-125	0			
<i>Surr: 2,4,6-Tribromophenol</i>	<i>1343</i>	<i>0</i>	<i>1667</i>	<i>0</i>	<i>80.6</i>	<i>34-140</i>	<i>0</i>			
<i>Surr: 2-Fluorobiphenyl</i>	<i>963</i>	<i>0</i>	<i>1667</i>	<i>0</i>	<i>57.8</i>	<i>12-100</i>	<i>0</i>			
<i>Surr: 2-Fluorophenol</i>	<i>1052</i>	<i>0</i>	<i>1667</i>	<i>0</i>	<i>63.1</i>	<i>33-117</i>	<i>0</i>			
<i>Surr: 4-Terphenyl-d14</i>	<i>1254</i>	<i>0</i>	<i>1667</i>	<i>0</i>	<i>75.3</i>	<i>25-137</i>	<i>0</i>			
<i>Surr: Nitrobenzene-d5</i>	<i>976.3</i>	<i>0</i>	<i>1667</i>	<i>0</i>	<i>58.6</i>	<i>37-107</i>	<i>0</i>			
<i>Surr: Phenol-d6</i>	<i>993.3</i>	<i>0</i>	<i>1667</i>	<i>0</i>	<i>59.6</i>	<i>40-106</i>	<i>0</i>			

**Note:** See Qualifiers Page for a list of Qualifiers and their explanation.

**Client:** HRL Compliance Solutions  
**Work Order:** 1108137  
**Project:** KP 34-18 8/3/11

**QC BATCH REPORT**

Batch ID: **34731** Instrument ID **SVMS6** Method: **SW8270**

LCSD		Sample ID: <b>SLCSDS1-34731-34731</b>				Units: <b>µg/Kg</b>		Analysis Date: <b>8/4/2011 09:48 PM</b>		
Client ID:		Run ID: <b>SVMS6_110804A</b>				SeqNo: <b>1696564</b>		Prep Date: <b>8/4/2011</b>		DF: <b>1</b>
Analyte	Result	PQL	SPK Val	SPK Ref Value	%REC	Control Limit	RPD Ref Value	%RPD	RPD Limit	Qual
Acenaphthene	1147	30	1333	0	86.1	45-110	1029	10.9	25	
Anthracene	1203	30	1333	0	90.2	55-105	1157	3.87	25	
Benzo(a)anthracene	1218	30	1333	0	91.3	50-110	1191	2.19	25	
Benzo(a)pyrene	1292	30	1333	0	96.9	50-110	1245	3.7	25	
Benzo(b)fluoranthene	1413	30	1333	0	106	45-115	1361	3.7	25	
Benzo(g,h,i)perylene	1006	30	1333	0	75.4	40-125	903.7	10.7	25	
Benzo(k)fluoranthene	1268	30	1333	0	95.1	45-115	1249	1.54	25	
Chrysene	1178	30	1333	0	88.4	55-110	1150	2.43	25	
Dibenzo(a,h)anthracene	1146	30	1333	0	86	40-125	1069	6.98	25	
Fluoranthene	1238	30	1333	0	92.9	55-115	1218	1.68	25	
Fluorene	1143	30	1333	0	85.7	50-110	1080	5.64	25	
Indeno(1,2,3-cd)pyrene	1085	30	1333	0	81.4	40-120	992.7	8.86	25	
Naphthalene	1120	30	1333	0	84	40-105	953.7	16	25	
Pyrene	1233	30	1333	0	92.5	45-125	1201	2.57	25	
<i>Surr: 2,4,6-Tribromophenol</i>	<i>1404</i>	<i>0</i>	<i>1667</i>	<i>0</i>	<i>84.2</i>	<i>34-140</i>	<i>1343</i>	<i>4.42</i>	<i>40</i>	
<i>Surr: 2-Fluorobiphenyl</i>	<i>1099</i>	<i>0</i>	<i>1667</i>	<i>0</i>	<i>65.9</i>	<i>12-100</i>	<i>963</i>	<i>13.2</i>	<i>40</i>	
<i>Surr: 2-Fluorophenol</i>	<i>1256</i>	<i>0</i>	<i>1667</i>	<i>0</i>	<i>75.4</i>	<i>33-117</i>	<i>1052</i>	<i>17.7</i>	<i>40</i>	
<i>Surr: 4-Terphenyl-d14</i>	<i>1285</i>	<i>0</i>	<i>1667</i>	<i>0</i>	<i>77.1</i>	<i>25-137</i>	<i>1254</i>	<i>2.39</i>	<i>40</i>	
<i>Surr: Nitrobenzene-d5</i>	<i>1172</i>	<i>0</i>	<i>1667</i>	<i>0</i>	<i>70.3</i>	<i>37-107</i>	<i>976.3</i>	<i>18.2</i>	<i>40</i>	
<i>Surr: Phenol-d6</i>	<i>1187</i>	<i>0</i>	<i>1667</i>	<i>0</i>	<i>71.2</i>	<i>40-106</i>	<i>993.3</i>	<i>17.7</i>	<i>40</i>	

**Note:** See Qualifiers Page for a list of Qualifiers and their explanation.

**Client:** HRL Compliance Solutions  
**Work Order:** 1108137  
**Project:** KP 34-18 8/3/11

**QC BATCH REPORT**

Batch ID: **34731** Instrument ID **SVMS6** Method: **SW8270**

MS Sample ID: <b>1108079-03A MS</b>				Units: <b>µg/Kg</b>			Analysis Date: <b>8/4/2011 10:15 PM</b>			
Client ID:		Run ID: <b>SVMS6_110804A</b>		SeqNo: <b>1696580</b>		Prep Date: <b>8/4/2011</b>		DF: <b>1</b>		
Analyte	Result	PQL	SPK Val	SPK Ref Value	%REC	Control Limit	RPD Ref Value	%RPD	RPD Limit	Qual
Acenaphthene	1647	59	2626	0	62.7	45-110	0			
Anthracene	1857	59	2626	0	70.7	55-105	0			
Benzo(a)anthracene	1922	59	2626	18.18	72.5	50-110	0			
Benzo(a)pyrene	1996	59	2626	19.15	75.3	50-110	0			
Benzo(b)fluoranthene	2015	59	2626	19.47	76	45-115	0			
Benzo(g,h,i)perylene	1509	59	2626	0	57.5	40-125	0			
Benzo(k)fluoranthene	2113	59	2626	0	80.5	45-115	0			
Chrysene	1787	59	2626	16.23	67.4	55-110	0			
Dibenzo(a,h)anthracene	1773	59	2626	0	67.5	40-125	0			
Fluoranthene	1936	59	2626	23.69	72.8	55-115	0			
Fluorene	1745	59	2626	0	66.5	50-110	0			
Indeno(1,2,3-cd)pyrene	1652	59	2626	0	62.9	40-120	0			
Naphthalene	1482	59	2626	0	56.4	40-105	0			
Pyrene	1877	59	2626	22.07	70.6	45-125	0			
Surr: 2,4,6-Tribromophenol	2150	0	3283	0	65.5	34-140	0			
Surr: 2-Fluorobiphenyl	948.7	0	3283	0	28.9	12-100	0			
Surr: 2-Fluorophenol	1827	0	3283	0	55.6	33-117	0			
Surr: 4-Terphenyl-d14	1174	0	3283	0	35.8	25-137	0			
Surr: Nitrobenzene-d5	1525	0	3283	0	46.5	37-107	0			
Surr: Phenol-d6	1733	0	3283	0	52.8	40-106	0			

**Note:** See Qualifiers Page for a list of Qualifiers and their explanation.

**Client:** HRL Compliance Solutions  
**Work Order:** 1108137  
**Project:** KP 34-18 8/3/11

**QC BATCH REPORT**

Batch ID: **34731** Instrument ID **SVMS6** Method: **SW8270**

<b>MSD</b>		Sample ID: <b>1108079-03A MSD</b>				Units: <b>µg/Kg</b>		Analysis Date: <b>8/4/2011 10:42 PM</b>		
Client ID:		Run ID: <b>SVMS6_110804A</b>				SeqNo: <b>1696581</b>		Prep Date: <b>8/4/2011</b>		DF: <b>1</b>
Analyte	Result	PQL	SPK Val	SPK Ref Value	%REC	Control Limit	RPD Ref Value	%RPD	RPD Limit	Qual
Acenaphthene	1557	57	2538	0	61.4	45-110	1647	5.58	30	
Anthracene	1762	57	2538	0	69.4	55-105	1857	5.29	30	
Benzo(a)anthracene	1846	57	2538	18.18	72	50-110	1922	4.05	30	
Benzo(a)pyrene	1904	57	2538	19.15	74.2	50-110	1996	4.73	30	
Benzo(b)fluoranthene	2168	57	2538	19.47	84.7	45-115	2015	7.34	30	
Benzo(g,h,i)perylene	1434	57	2538	0	56.5	40-125	1509	5.11	30	
Benzo(k)fluoranthene	1617	57	2538	0	63.7	45-115	2113	26.6	30	
Chrysene	1755	57	2538	16.23	68.5	55-110	1787	1.8	30	
Dibenzo(a,h)anthracene	1708	57	2538	0	67.3	40-125	1773	3.73	30	
Fluoranthene	1849	57	2538	23.69	71.9	55-115	1936	4.56	30	
Fluorene	1645	57	2538	0	64.8	50-110	1745	5.91	30	
Indeno(1,2,3-cd)pyrene	1563	57	2538	0	61.6	40-120	1652	5.53	30	
Naphthalene	1486	57	2538	0	58.5	40-105	1482	0.253	30	
Pyrene	1804	57	2538	22.07	70.2	45-125	1877	4	30	
<i>Surr: 2,4,6-Tribromophenol</i>	2164	0	3173	0	68.2	34-140	2150	0.638	40	
<i>Surr: 2-Fluorobiphenyl</i>	1022	0	3173	0	32.2	12-100	948.7	7.47	40	
<i>Surr: 2-Fluorophenol</i>	1927	0	3173	0	60.7	33-117	1827	5.37	40	
<i>Surr: 4-Terphenyl-d14</i>	1282	0	3173	0	40.4	25-137	1174	8.79	40	
<i>Surr: Nitrobenzene-d5</i>	1507	0	3173	0	47.5	37-107	1525	1.23	40	
<i>Surr: Phenol-d6</i>	1824	0	3173	0	57.5	40-106	1733	5.09	40	

The following samples were analyzed in this batch:

1108137-01B

1108137-02B

**Note:** See Qualifiers Page for a list of Qualifiers and their explanation.



**Client:** HRL Compliance Solutions  
**Work Order:** 1108137  
**Project:** KP 34-18 8/3/11

**QC BATCH REPORT**

Batch ID: **R93002** Instrument ID **VMS7** Method: **SW8260**

MBLK		Sample ID: <b>VBLKW1-110804-R93002</b>				Units: <b>µg/L</b>		Analysis Date: <b>8/4/2011 01:34 PM</b>		
Client ID:		Run ID: <b>VMS7_110804A</b>				SeqNo: <b>1695979</b>		Prep Date:		DF: <b>1</b>
Analyte	Result	PQL	SPK Val	SPK Ref Value	%REC	Control Limit	RPD Ref Value	%RPD	RPD Limit	Qual
Benzene	ND	1.0								
Ethylbenzene	ND	1.0								
m,p-Xylene	ND	2.0								
o-Xylene	ND	1.0								
Toluene	ND	1.0								
Xylenes, Total	ND	2.0								
Surr: 1,2-Dichloroethane-d4	98.25	0	100	0	98.2	70-120	0			
Surr: 4-Bromofluorobenzene	97.88	0	100	0	97.9	75-120	0			
Surr: Dibromofluoromethane	98.68	0	100	0	98.7	85-115	0			
Surr: Toluene-d8	99.77	0	100	0	99.8	85-120	0			

LCS		Sample ID: <b>VLCSW1-110804-R93002</b>				Units: <b>µg/L</b>		Analysis Date: <b>8/4/2011 12:18 PM</b>		
Client ID:		Run ID: <b>VMS7_110804A</b>				SeqNo: <b>1695343</b>		Prep Date:		DF: <b>1</b>
Analyte	Result	PQL	SPK Val	SPK Ref Value	%REC	Control Limit	RPD Ref Value	%RPD	RPD Limit	Qual
Benzene	20.04	1.0	20	0	100	80-120	0			
Ethylbenzene	20.3	1.0	20	0	102	75-125	0			
m,p-Xylene	40.97	2.0	40	0	102	75-130	0			
o-Xylene	20.34	1.0	20	0	102	80-120	0			
Toluene	20.24	1.0	20	0	101	75-120	0			
Xylenes, Total	61.31	2.0	60	0	102	75-130	0			
Surr: 1,2-Dichloroethane-d4	95.85	0	100	0	95.8	70-120	0			
Surr: 4-Bromofluorobenzene	99.19	0	100	0	99.2	75-120	0			
Surr: Dibromofluoromethane	99.34	0	100	0	99.3	85-115	0			
Surr: Toluene-d8	100.5	0	100	0	100	85-120	0			

LCSD		Sample ID: <b>VLCSWDW1-110804-R93002</b>				Units: <b>µg/L</b>		Analysis Date: <b>8/4/2011 12:44 PM</b>		
Client ID:		Run ID: <b>VMS7_110804A</b>				SeqNo: <b>1695350</b>		Prep Date:		DF: <b>1</b>
Analyte	Result	PQL	SPK Val	SPK Ref Value	%REC	Control Limit	RPD Ref Value	%RPD	RPD Limit	Qual
Benzene	19.1	1.0	20	0	95.5	80-120	20.04	4.8	30	
Ethylbenzene	19.42	1.0	20	0	97.1	75-125	20.3	4.43	30	
m,p-Xylene	38.85	2.0	40	0	97.1	75-130	40.97	5.31	30	
o-Xylene	19.48	1.0	20	0	97.4	80-120	20.34	4.32	30	
Toluene	19.38	1.0	20	0	96.9	75-120	20.24	4.34	30	
Xylenes, Total	58.33	2.0	60	0	97.2	75-130	61.31	4.98	30	
Surr: 1,2-Dichloroethane-d4	95.93	0	100	0	95.9	70-120	95.85	0.0834	30	
Surr: 4-Bromofluorobenzene	100.2	0	100	0	100	75-120	99.19	1	30	
Surr: Dibromofluoromethane	99.62	0	100	0	99.6	85-115	99.34	0.281	30	
Surr: Toluene-d8	101.1	0	100	0	101	85-120	100.5	0.635	30	

**Note:** See Qualifiers Page for a list of Qualifiers and their explanation.

**Client:** HRL Compliance Solutions  
**Work Order:** 1108137  
**Project:** KP 34-18 8/3/11

## QC BATCH REPORT

---

Batch ID: **R93002** Instrument ID **VMS7** Method: **SW8260**

---

The following samples were analyzed in this batch:

1108137-01A	1108137-02A
-------------	-------------

---

**Note:** See Qualifiers Page for a list of Qualifiers and their explanation.

**Client:** HRL Compliance Solutions  
**Work Order:** 1108137  
**Project:** KP 34-18 8/3/11

**QC BATCH REPORT**

Batch ID: **34802** Instrument ID **WETCHEM** Method: **SW7196A**

<b>MBLK</b>	Sample ID: <b>MBLK-34802-34802</b>				Units: <b>mg/Kg</b>		Analysis Date: <b>8/8/2011 04:30 PM</b>			
Client ID:	Run ID: <b>WETCHEM_110808I</b>				SeqNo: <b>1699086</b>		Prep Date: <b>8/5/2011</b>		DF: <b>1</b>	
Analyte	Result	PQL	SPK Val	SPK Ref Value	%REC	Control Limit	RPD Ref Value	%RPD	RPD Limit	Qual
Chromium, Hexavalent	ND	0.48								

<b>LCS</b>	Sample ID: <b>LCS-34802-34802</b>				Units: <b>mg/Kg</b>		Analysis Date: <b>8/8/2011 04:30 PM</b>			
Client ID:	Run ID: <b>WETCHEM_110808I</b>				SeqNo: <b>1699087</b>		Prep Date: <b>8/5/2011</b>		DF: <b>1</b>	
Analyte	Result	PQL	SPK Val	SPK Ref Value	%REC	Control Limit	RPD Ref Value	%RPD	RPD Limit	Qual
Chromium, Hexavalent	1.894	0.49	1.969	0	96.2	75-110	0			

<b>LCSD</b>	Sample ID: <b>LCSD-34802-34802</b>				Units: <b>mg/Kg</b>		Analysis Date: <b>8/8/2011 04:30 PM</b>			
Client ID:	Run ID: <b>WETCHEM_110808I</b>				SeqNo: <b>1699095</b>		Prep Date: <b>8/5/2011</b>		DF: <b>1</b>	
Analyte	Result	PQL	SPK Val	SPK Ref Value	%REC	Control Limit	RPD Ref Value	%RPD	RPD Limit	Qual
Chromium, Hexavalent	1.909	0.50	1.984	0	96.2	75-110	1.739	9.3	20	

<b>MS</b>	Sample ID: <b>1108138-01A MS</b>				Units: <b>mg/Kg</b>		Analysis Date: <b>8/8/2011 04:30 PM</b>			
Client ID:	Run ID: <b>WETCHEM_110808I</b>				SeqNo: <b>1699092</b>		Prep Date: <b>8/5/2011</b>		DF: <b>1</b>	
Analyte	Result	PQL	SPK Val	SPK Ref Value	%REC	Control Limit	RPD Ref Value	%RPD	RPD Limit	Qual
Chromium, Hexavalent	1.7	0.49	1.976	0.1865	76.6	60-130	0			

<b>MSD</b>	Sample ID: <b>1108138-01A MSD</b>				Units: <b>mg/Kg</b>		Analysis Date: <b>8/8/2011 04:30 PM</b>			
Client ID:	Run ID: <b>WETCHEM_110808I</b>				SeqNo: <b>1699093</b>		Prep Date: <b>8/5/2011</b>		DF: <b>1</b>	
Analyte	Result	PQL	SPK Val	SPK Ref Value	%REC	Control Limit	RPD Ref Value	%RPD	RPD Limit	Qual
Chromium, Hexavalent	1.761	0.50	1.992	0.1865	79	60-130	1.7	3.55	30	

<b>DUP</b>	Sample ID: <b>1108137-01B DUP</b>				Units: <b>mg/Kg</b>		Analysis Date: <b>8/8/2011 04:30 PM</b>			
Client ID: <b>Pt of origin KP 34-18</b>	Run ID: <b>WETCHEM_110808I</b>				SeqNo: <b>1699089</b>		Prep Date: <b>8/5/2011</b>		DF: <b>1</b>	
Analyte	Result	PQL	SPK Val	SPK Ref Value	%REC	Control Limit	RPD Ref Value	%RPD	RPD Limit	Qual
Chromium, Hexavalent	ND	0.49	0	0	0	0-0	0.1303	0	30	

The following samples were analyzed in this batch:

1108137-01B	1108137-02B
-------------	-------------

**Note:** See Qualifiers Page for a list of Qualifiers and their explanation.

**Client:** HRL Compliance Solutions  
**Work Order:** 1108137  
**Project:** KP 34-18 8/3/11

## QC BATCH REPORT

Batch ID: **R93034** Instrument ID **WETCHEM** Method: **SW9045D**

**DUP** Sample ID: **1108138-01A DUP** Units: **s.u.** Analysis Date: **8/4/2011 10:05 AM**

Client ID: Run ID: **WETCHEM\_110804E** SeqNo: **1695827** Prep Date: DF: **1**

Analyte	Result	PQL	SPK Val	SPK Ref Value	%REC	Control Limit	RPD Ref Value	%RPD	RPD Limit	Qual
pH	9.13	0	0	0	0	0-0	9.13	0	20	

The following samples were analyzed in this batch:

1108137-01B	1108137-02B
-------------	-------------

**Note:** See Qualifiers Page for a list of Qualifiers and their explanation.

**Client:** HRL Compliance Solutions  
**Work Order:** 1108137  
**Project:** KP 34-18 8/3/11

**QC BATCH REPORT**

Batch ID: **R93064** Instrument ID **MOIST** Method: **A2540 G**

<b>MBLK</b>	Sample ID: <b>WBLKS1-R93064</b>			Units: <b>% of sample</b>			Analysis Date: <b>8/4/2011 01:52 PM</b>			
Client ID:	Run ID: <b>MOIST_110804D</b>			SeqNo: <b>1696802</b>			Prep Date:		DF: <b>1</b>	
Analyte	Result	PQL	SPK Val	SPK Ref Value	%REC	Control Limit	RPD Ref Value	%RPD	RPD Limit	Qual
Moisture	ND	0.050								

<b>LCS</b>	Sample ID: <b>LCS-R93064</b>			Units: <b>% of sample</b>			Analysis Date: <b>8/4/2011 01:52 PM</b>			
Client ID:	Run ID: <b>MOIST_110804D</b>			SeqNo: <b>1696801</b>			Prep Date:		DF: <b>1</b>	
Analyte	Result	PQL	SPK Val	SPK Ref Value	%REC	Control Limit	RPD Ref Value	%RPD	RPD Limit	Qual
Moisture	100	0.050	100	0	100	99.5-100.5	0			E

<b>DUP</b>	Sample ID: <b>1108113-22BDUP1</b>			Units: <b>% of sample</b>			Analysis Date: <b>8/4/2011 01:52 PM</b>			
Client ID:	Run ID: <b>MOIST_110804D</b>			SeqNo: <b>1696784</b>			Prep Date:		DF: <b>1</b>	
Analyte	Result	PQL	SPK Val	SPK Ref Value	%REC	Control Limit	RPD Ref Value	%RPD	RPD Limit	Qual
Moisture	66.88	0.050	0	0	0	0-0	66.06	1.23	20	

<b>DUP</b>	Sample ID: <b>1108113-22BDUP2</b>			Units: <b>% of sample</b>			Analysis Date: <b>8/4/2011 01:52 PM</b>			
Client ID:	Run ID: <b>MOIST_110804D</b>			SeqNo: <b>1696785</b>			Prep Date:		DF: <b>1</b>	
Analyte	Result	PQL	SPK Val	SPK Ref Value	%REC	Control Limit	RPD Ref Value	%RPD	RPD Limit	Qual
Moisture	67.05	0.050	0	0	0	0-0	66.06	1.49	20	

<b>DUP</b>	Sample ID: <b>1108116-05ADUP</b>			Units: <b>% of sample</b>			Analysis Date: <b>8/4/2011 01:52 PM</b>			
Client ID:	Run ID: <b>MOIST_110804D</b>			SeqNo: <b>1696791</b>			Prep Date:		DF: <b>1</b>	
Analyte	Result	PQL	SPK Val	SPK Ref Value	%REC	Control Limit	RPD Ref Value	%RPD	RPD Limit	Qual
Moisture	55.23	0.050	0	0	0	0-0	53.86	2.51	20	

The following samples were analyzed in this batch:

1108137-01B	1108137-02B
-------------	-------------

**Note:** See Qualifiers Page for a list of Qualifiers and their explanation.



# ALS Laboratory Group

225 Commerce Drive, Fort Collins, Colorado 80524  
TF: (800) 443-1511 PH: (970) 490-1511 FX: (970) 490-1522

Received 8/3/2011 Chain of Custody

Form 202r8

WORKORDER  
#

1108137

PROJECT NAME		KP 34-18		SAMPLER		Reed Wold		DATE		8/3/2011		PAGE		1 of 1	
PROJECT No.				SITE ID		KP 34-18		TURNAROUND		See Below		DISPOSAL		By Lab or Return to Client	
COMPANY NAME		HRL COMPLIANCE SOLUTIONS Inc.		BILL TO COMPANY		HCSI		BTEX/ GRO DRO/ PAH/ Metals (table 910-1) SAR/ EC/ PH							
SEND REPORT TO		Mark Mumby		INVOICE ATTN TO		Mark Mumby									
ADDRESS		744 HORIZON CT SUITE 140		ADDRESS											
CITY / STATE / ZIP		GRAND JUNCTION CO 81506		CITY / STATE / ZIP											
PHONE		970-243-3271		PHONE											
FAX		970-243-3280		FAX											
E-MAIL		Mmumby@hrlcomp.com		E-MAIL											
Lab ID	Field ID	Matrix	Sample Date	Sample Time	# Bottles	Pres.	QC								
	Pt of origin KP 34-18	SO	8/3/2011	11:05	3	8		X	X	X					
	Sed. Trap KP 34-18	SO	8/3/2011	11:00	3	8		X	X	X					

\*Time Zone (Circle): EST CST MST PST Matrix: O = oil S = soil NS = non-soil solid W = water L = liquid E = extract F = filter

For metals or anions, please detail analytes below.

Comments:	QC PACKAGE (check below)	
	X	LEVEL II (Standard QC)
		LEVEL III (Std QC + forms)
		LEVEL IV (Std QC + forms + raw data)
BTEX, GRO, DOR 24 HR the rest as soon as possible.		
3.0c		
Preservative Key: 1-HCl 2-HNO3 3-H2SO4 4-NaOH 5-NaHSO4 7-Other 8-4 degrees C 9-5035		

	SIGNATURE	PRINTED NAME	DATE	TIME
RELINQUISHED BY	<i>Reed Wold</i>	<i>Reed Wold</i>	8/3/11	5pm
RECEIVED BY	<i>Diane F Shaw</i>	<i>Diane F Shaw</i>	8/4/11	0945
RELINQUISHED BY				
RECEIVED BY				
RELINQUISHED BY				
RECEIVED BY				

**FedEx** Express **NEW Package**  
**US Airbill**

FedEx  
Tracking  
Number

8758 3475 8884

Received 8/30/2011 Rifle COGCC

0200 Form  
ID No.

**FedEx Retrieval Copy**

**1 From**  
Date 8/31/11 Sender's FedEx  
Account Number

Sender's Name Beed Wold Phone 970 243-3271

Company HLSE

Address 744 Halzer Ct Suite 140 Dept/Floor/Suite/Room

City Grand Junction State CO ZIP 81506

**2 Your Internal Billing Reference**

**3 To**  
Recipient's Name Samir Redding Phone 616 399-6670

Company ALS Group

Address 3352 128th Ave Dept/Floor/Suite/Room

Address Holland State MI ZIP 49124

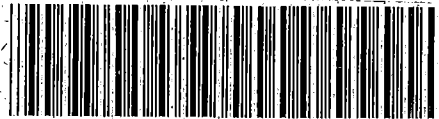

8758 3475 8884

**CUSTODY SEAL**

DATE 8/31/11

SIGNATURE [Signature]

**CUSTODY SEAL**

DATE 8/31/11

SIGNATURE [Signature]

**4 Express Package Service** \*To most locations.

NOTE: Service order has changed. Please select carefully.

**Packages up to 150 lbs.**  
For packages over 150 lbs., use the new  
FedEx Express Freight US Airbill.

**Next Business Day**

☐ **FedEx First Overnight**  
Earliest next business morning delivery to select  
locations. Friday shipments will be delivered on  
Monday unless SATURDAY Delivery is selected.

☒ **FedEx Priority Overnight**  
Next business morning.\* Friday shipments will be  
delivered on Monday unless SATURDAY Delivery  
is selected.

☐ **FedEx Standard Overnight**  
Next business afternoon.\*  
Saturday Delivery NOT available.

**2 or 3 Business Days**

☐ **NEW FedEx 2Day A.M.**  
Second business morning.\*  
Saturday Delivery NOT available.

☐ **FedEx 2Day**  
Second business afternoon.\* Thursday shipments  
will be delivered on Monday unless SATURDAY  
Delivery is selected.

☐ **FedEx Express Saver**  
Third business day.\*  
Saturday Delivery NOT available.

**5 Packaging** \*Declared value limit \$500.

☐ **FedEx Envelope\*** ☐ **FedEx Pak\*** ☐ **FedEx Box** ☐ **FedEx Tube** ☒ **Other**

**6 Special Handling and Delivery Signature Options**

☒ **SATURDAY DELIVERY**

☒ **No Signature Required**  
Package may be left without  
obtaining a signature for delivery.

☐ **Direct Signature**  
Someone at recipient's address  
may sign for delivery. *Fee applies.*

☐ **Indirect Signature**  
If no one is available at recipient's  
address, someone at a neighboring  
address may sign for delivery. For  
residential deliveries only. *Fee applies.*

Does this shipment contain dangerous goods?

☒ **No** ☐ **Yes**  
One box must be checked.

☒ **No** ☐ **Yes**  
As per attached  
Shipper's Declaration. ☐ **Yes**  
Shipper's Declaration  
not required.

☐ **Dry Ice**  
Dry Ice, 9, UH 1845 x kg

Dangerous goods (including dry ice) cannot be shipped in FedEx packaging  
or placed in a FedEx Express Drop Box.

☐ **Cargo Aircraft Only**

**7 Payment Bill to:**

Sender's Acct. No. in Section 1 will be billed. ☐ **Obtain recip. Acct. No.**

☒ **Recipient** ☐ **Third Party** ☐ **Credit Card** ☐ **Cash/Check**

Total Packages 1 Total Weight 39 lbs. Credit Card Auth. 612

\*Our liability is limited to \$100 unless you declare a higher value. See the current FedEx Service Guide for details.

Rev. Rate 11/10 - Doc 4103126 - 07/04 - 2010 FedEx - PRINTED IN U.S.A. SRY

**QEC**

Quality Environmental Containers  
800-255-3950 • 304-255-3900

**QEC**

Quality Environmental Containers  
800-255-3950 • 304-255-3900

fedex.com 1.800.GoFedEx 1.800.463.3339

fedex.com 1.800.GoFedEx 1.800.463.3339





## Subcontractor:

A &amp; L Great Lakes Agricultural La

3505 Conestoga Dr

Ft. Wayne, IN 46808

TEL: (260) 483-4759

FAX: (260) 483-5274

Acct #: 91000

## CHAIN-OF-CUSTODY RECORD

Page 1 of 1

Date: 04-Aug-11COC ID: 3027Due Date 08-Aug-11

Customer Information		Project Information		Parameter/Method Request for Analysis										
Purchase Order		Project Name	1108137	A Subcontracted Analyses (SUBCONTRACT)										
Work Order		Project Number		B										
Company Name	ALS Group USA, Corp	Bill To Company	ALS Group USA, Corp	C										
Send Report To	Ann Preston	Inv Attn	Accounts Payable	D										
Address	3352 128th Avenue	Address	3352 128th Avenue	E										
				F										
City/State/Zip	Holland, Michigan 49424-9263	City/State/Zip	Holland, Michigan 49424-9263	G										
Phone	(616) 399-6070	Phone	(616) 399-6070	H										
Fax	(616) 399-6185	Fax	(616) 399-6185	I										
eMail Address	ann.preston@alsglobal.com	eMail CC		J										
Sample ID	Matrix	Collection Date 24hr	Bottle	A	B	C	D	E	F	G	H	I	J	
1108137-01C (Pt of origin KP 34-18)	Soil	3/Aug/2011 11:05	(1) 8OZGNEAT	X										
1108137-02C (Sed. Trap KP 34-18)	Soil	3/Aug/2011 11:00	(1) 8OZGNEAT	X										

## Comments:

Please analyze the following samples for SAR/ED/pH

*\*RUSH\* Results needed 8/8/11, if possible.*

Relinquished by:

8/4/11 1445

Date/Time

Received by:

Date/Time

Cooler IDs

Report/QC Level

Std

Relinquished by:

Date/Time

Received by:

Date/Time

ALS Group USA, Corp

## Sample Receipt Checklist

Client Name: HRLDate/Time Received: 04-Aug-11 09:45Work Order: 1108137Received by: DSChecklist completed by Diane Shaw 04-Aug-11  
eSignature DateReviewed by: Joseph Ribar 04-Aug-11  
eSignature DateMatrices: SoilCarrier name: FedEx

Shipping container/cooler in good condition? Yes ☒ No ☐ Not Present ☐

Custody seals intact on shipping container/cooler? Yes ☒ No ☐ Not Present ☐

Custody seals intact on sample bottles? Yes ☐ No ☐ Not Present ☒

Chain of custody present? Yes ☒ No ☐

Chain of custody signed when relinquished and received? Yes ☒ No ☐

Chain of custody agrees with sample labels? Yes ☒ No ☐

Samples in proper container/bottle? Yes ☒ No ☐

Sample containers intact? Yes ☒ No ☐

Sufficient sample volume for indicated test? Yes ☒ No ☐

All samples received within holding time? Yes ☒ No ☐

Container/Temp Blank temperature in compliance? Yes ☒ No ☐

Temperature(s)/Thermometer(s): 3.0 c

Cooler(s)/Kit(s):

Water - VOA vials have zero headspace? Yes ☐ No ☐ No VOA vials submitted ☒

Water - pH acceptable upon receipt? Yes ☐ No ☐ N/A ☒

pH adjusted? Yes ☐ No ☐ N/A ☒

pH adjusted by: -

Login Notes:

-----

Client Contacted:

Date Contacted:

Person Contacted:

Contacted By:

Regarding:

Comments:

CorrectiveAction:



23-Aug-2011

Mark Mumby  
HRL Compliance Solutions  
744 Horizon Ct. Suite 140  
Grand Junction, CO 81506

Re: **KP 34-18 8/17/11**

Work Order: **1108572**

Dear Mark,

ALS Environmental received 3 samples on 18-Aug-2011 10:45 AM for the analyses presented in the following report.

The analytical data provided relates directly to the samples received by ALS Environmental and for only the analyses requested.

QC sample results for this data met laboratory specifications. Any exceptions are noted in the Case Narrative, or noted with qualifiers in the report or QC batch information. Should this laboratory report need to be reproduced, it should be reproduced in full unless written approval has been obtained from ALS Environmental. Samples will be disposed in 30 days unless storage arrangements are made.

The total number of pages in this report is 14.

If you have any questions regarding this report, please feel free to contact me.

Sincerely,

A handwritten signature in cursive script that reads "Ann Preston".

Electronically approved by: Ann Preston

Ann Preston  
Project Manager



Certificate No: IL100452

ADDRESS 3352 128th Avenue Holland, Michigan 49424-9263 | PHONE (616) 399-6070 | FAX (616) 399-6185

ALS GROUP USA, CORP Part of the ALS Laboratory Group A Campbell Brothers Limited Company

Environmental The ALS logo, a stylized blue triangle with a yellow flame inside.

[www.alsglobal.com](http://www.alsglobal.com)

RIGHT SOLUTIONS RIGHT PARTNER

**ALS Group USA, Corp**

Date: 23-Aug-11

---

**Client:** HRL Compliance Solutions  
**Project:** KP 34-18 8/17/11  
**Work Order:** 1108572**Work Order Sample Summary**

---

<u>Lab Samp ID</u>	<u>Client Sample ID</u>	<u>Matrix</u>	<u>Tag Number</u>	<u>Collection Date</u>	<u>Date Received</u>	<u>Hold</u>
1108572-01	KP 34-18-BG1	Soil		8/17/2011 10:45	8/18/2011 10:45	<input type="checkbox"/>
1108572-02	KP 34-18-BG 2	Soil		8/17/2011 10:50	8/18/2011 10:45	<input type="checkbox"/>
1108572-03	KP 34-18-BG 3	Soil		8/17/2011 10:55	8/18/2011 10:45	<input type="checkbox"/>

---

**ALS Group USA, Corp**

Date: 23-Aug-11

**Client:** HRL Compliance Solutions**Project:** KP 34-18 8/17/11**WorkOrder:** 1108572**QUALIFIERS,  
ACRONYMS, UNITS**

<b><u>Qualifier</u></b>	<b><u>Description</u></b>
*	Value exceeds Regulatory Limit
a	Not accredited
B	Analyte detected in the associated Method Blank above the Reporting Limit
E	Value above quantitation range
H	Analyzed outside of Holding Time
J	Analyte detected below quantitation limit
n	Not offered for accreditation
ND	Not Detected at the Reporting Limit
O	Sample amount is > 4 times amount spiked
P	Dual Column results percent difference > 40%
R	RPD above laboratory control limit
S	Spike Recovery outside laboratory control limits
U	Analyzed but not detected above the MDL

<b><u>Acronym</u></b>	<b><u>Description</u></b>
DUP	Method Duplicate
LCS	Laboratory Control Sample
LCSD	Laboratory Control Sample Duplicate
MBLK	Method Blank
MDL	Method Detection Limit
MQL	Method Quantitation Limit
MS	Matrix Spike
MSD	Matrix Spike Duplicate
PDS	Post Digestion Spike
PQL	Practical Quantitation Limit
SD	Serial Dilution
TDL	Target Detection Limit

<b><u>Units Reported</u></b>	<b><u>Description</u></b>
% of sample as noted	Percent of Sample
mg/Kg-dry	Milligrams per Kilogram Dry Weight
s.u.	Standard Units

**ALS Group USA, Corp****Date:** 23-Aug-11**Client:** HRL Compliance Solutions**Project:** KP 34-18 8/17/11**Work Order:** 1108572**Sample ID:** KP 34-18-BG1**Lab ID:** 1108572-01**Collection Date:** 8/17/2011 10:45 AM**Matrix:** SOIL

Analyses	Result	Qual	Report Limit	Units	Dilution Factor	Date Analyzed
<b>METALS BY ICP-MS</b>						
Arsenic	4.4		SW6020A 0.74	mg/Kg-dry	Prep Date: 8/18/2011 2	Analyst: CES 8/18/2011 07:03 PM
<b>SUBCONTRACTED ANALYSES</b>						
Subcontracted Analyses	Rcvd 8/23/11		SUBCONTRACT as noted		1	Analyst: A&LGL 8/23/2011
<b>MOISTURE</b>						
Moisture	4.4		A2540 G 0.050	% of sample	1	Analyst: CG 8/18/2011 01:39 PM
<b>PH</b>						
pH	8.49		SW9045D	s.u.	1	Analyst: KV 8/18/2011 08:50 AM

**Note:** See Qualifiers page for a list of qualifiers and their definitions.

Report Number: F11231-0301

Account Number: 91000

Received 8/30/2011 Rifle COGCC

# A & L GREAT LAKES LABORATORIES, INC.

3505 Conestoga Drive • Fort Wayne, Indiana 46808-4413 • Phone 260-483-4759 • Fax 260-483-5274

www.algreatlakes.com • lab@algreatlakes.com



**QUALITY ANALYSES FOR INFORMED DECISIONS**

TO: ALS LABORATORY GROUP  
3352 128TH AVE  
HOLLAND, MI 49424-9263

RE: 1108572

DATE RECEIVED: 08/19/2011

DATE REPORTED: 08/23/2011

PAGE: 1

P.O. NUMBER: 20-122010590

ATTN: ANN PRESTON

## REPORT OF ANALYSIS

LAB NO.	SAMPLE ID	ANALYSIS	RESULT	UNIT	METHOD
70895	01A	Sat'd Paste Extraction with DIW	1		USDA Handbook 60
		Conductivity (ECe)	0.30	mmho/cm	USDA Handbook 60
		Calcium (Sat'd Paste)	32	ppm	USDA Handbook 60
		Magnesium (Sat'd Paste)	6	ppm	USDA Handbook 60
		Sodium (Sat'd Paste)	115	ppm	USDA Handbook 60
		Sodium Adsorption Ratio	4.9	-	USDA Handbook 60



**ALS Group USA, Corp****Date:** 23-Aug-11**Client:** HRL Compliance Solutions**Project:** KP 34-18 8/17/11**Work Order:** 1108572**Sample ID:** KP 34-18-BG 2**Lab ID:** 1108572-02**Collection Date:** 8/17/2011 10:50 AM**Matrix:** SOIL

Analyses	Result	Qual	Report Limit	Units	Dilution Factor	Date Analyzed
<b>METALS BY ICP-MS</b>			<b>SW6020A</b>		Prep Date: <b>8/18/2011</b>	Analyst: <b>CES</b>
Arsenic	4.6		0.75	mg/Kg-dry	2	8/18/2011 07:09 PM
<b>MOISTURE</b>			<b>A2540 G</b>			Analyst: <b>CG</b>
Moisture	3.2		0.050	% of sample	1	8/18/2011 01:39 PM

**Note:** See Qualifiers page for a list of qualifiers and their definitions.

**ALS Group USA, Corp****Date:** 23-Aug-11**Client:** HRL Compliance Solutions**Project:** KP 34-18 8/17/11**Work Order:** 1108572**Sample ID:** KP 34-18-BG 3**Lab ID:** 1108572-03**Collection Date:** 8/17/2011 10:55 AM**Matrix:** SOIL

Analyses	Result	Qual	Report Limit	Units	Dilution Factor	Date Analyzed
<b>METALS BY ICP-MS</b>			<b>SW6020A</b>		Prep Date: <b>8/18/2011</b>	Analyst: <b>CES</b>
Arsenic	3.8		0.67	mg/Kg-dry	2	8/18/2011 07:14 PM
<b>MOISTURE</b>			<b>A2540 G</b>			Analyst: <b>CG</b>
Moisture	3.5		0.050	% of sample	1	8/18/2011 01:39 PM

**Note:** See Qualifiers page for a list of qualifiers and their definitions.

## ALS Group USA, Corp

Date: 23-Aug-11

Client: HRL Compliance Solutions

## QC BATCH REPORT

Work Order: 1108572

Project: KP 34-18 8/17/11

Batch ID: 34984

Instrument ID ICPMS1

Method: SW6020A

<b>MBLK</b>	Sample ID: <b>MBLK-34984-34984</b>				Units: <b>mg/Kg</b>		Analysis Date: <b>8/18/2011 03:48 PM</b>			
Client ID:	Run ID: <b>ICPMS1_110817A</b>				SeqNo: <b>1710042</b>		Prep Date: <b>8/18/2011</b>		DF: <b>1</b>	
Analyte	Result	PQL	SPK Val	SPK Ref Value	%REC	Control Limit	RPD Ref Value	%RPD	RPD Limit	Qual
Arsenic	ND	0.25								

<b>LCS</b>	Sample ID: <b>LCS-34984-34984</b>				Units: <b>mg/Kg</b>		Analysis Date: <b>8/18/2011 03:53 PM</b>			
Client ID:	Run ID: <b>ICPMS1_110817A</b>				SeqNo: <b>1710043</b>		Prep Date: <b>8/18/2011</b>		DF: <b>2</b>	
Analyte	Result	PQL	SPK Val	SPK Ref Value	%REC	Control Limit	RPD Ref Value	%RPD	RPD Limit	Qual
Arsenic	4.53	0.50	5	0	90.6	80-120	0			

<b>LCSD</b>	Sample ID: <b>LCSD-34984-34984</b>				Units: <b>mg/Kg</b>		Analysis Date: <b>8/18/2011 03:59 PM</b>			
Client ID:	Run ID: <b>ICPMS1_110817A</b>				SeqNo: <b>1710044</b>		Prep Date: <b>8/18/2011</b>		DF: <b>2</b>	
Analyte	Result	PQL	SPK Val	SPK Ref Value	%REC	Control Limit	RPD Ref Value	%RPD	RPD Limit	Qual
Arsenic	4.59	0.50	5	0	91.8	80-120	4.53	1.32	20	

<b>MS</b>	Sample ID: <b>1108570-03AMS</b>				Units: <b>mg/Kg</b>		Analysis Date: <b>8/18/2011 05:01 PM</b>			
Client ID:	Run ID: <b>ICPMS1_110817A</b>				SeqNo: <b>1710059</b>		Prep Date: <b>8/18/2011</b>		DF: <b>2</b>	
Analyte	Result	PQL	SPK Val	SPK Ref Value	%REC	Control Limit	RPD Ref Value	%RPD	RPD Limit	Qual
Arsenic	11.01	0.75	7.463	4.532	86.8	80-120	0			

<b>MSD</b>	Sample ID: <b>1108570-03AMSD</b>				Units: <b>mg/Kg</b>		Analysis Date: <b>8/18/2011 05:06 PM</b>			
Client ID:	Run ID: <b>ICPMS1_110817A</b>				SeqNo: <b>1710061</b>		Prep Date: <b>8/18/2011</b>		DF: <b>2</b>	
Analyte	Result	PQL	SPK Val	SPK Ref Value	%REC	Control Limit	RPD Ref Value	%RPD	RPD Limit	Qual
Arsenic	10.38	0.67	6.702	4.532	87.2	80-120	11.01	5.9	25	

The following samples were analyzed in this batch:

1108572-01B	1108572-02A	1108572-03A
-------------	-------------	-------------

Note: See Qualifiers Page for a list of Qualifiers and their explanation.

**Client:** HRL Compliance Solutions  
**Work Order:** 1108572  
**Project:** KP 34-18 8/17/11

## QC BATCH REPORT

Batch ID: **R93573** Instrument ID **WETCHEM** Method: **SW9045D**

**DUP** Sample ID: **1108570-01B DUP** Units: **s.u.** Analysis Date: **8/18/2011 08:50 AM**

Client ID: Run ID: **WETCHEM\_1108181** SeqNo: **1709711** Prep Date: DF: **1**

Analyte	Result	PQL	SPK Val	SPK Ref Value	%REC	Control Limit	RPD Ref Value	%RPD	RPD Limit	Qual
pH	7.64	0	0	0	0	0-0	7.64	0	20	

The following samples were analyzed in this batch:

1108572-01B

**Note:** See Qualifiers Page for a list of Qualifiers and their explanation.

Client: HRL Compliance Solutions

Work Order: 1108572

Project: KP 34-18 8/17/11

**QC BATCH REPORT**Batch ID: **R93596**Instrument ID **MOIST**Method: **A2540 G****MBLK** Sample ID: **WBLKS1-R93596** Units: **% of sample** Analysis Date: **8/18/2011 01:39 PM**Client ID: Run ID: **MOIST\_110818A** SeqNo: **1710194** Prep Date: DF: **1**

Analyte	Result	PQL	SPK Val	SPK Ref Value	%REC	Control Limit	RPD Ref Value	%RPD	RPD Limit	Qual
Moisture	ND	0.050								

**LCS** Sample ID: **LCS-R93596** Units: **% of sample** Analysis Date: **8/18/2011 01:39 PM**Client ID: Run ID: **MOIST\_110818A** SeqNo: **1710193** Prep Date: DF: **1**

Analyte	Result	PQL	SPK Val	SPK Ref Value	%REC	Control Limit	RPD Ref Value	%RPD	RPD Limit	Qual
Moisture	100	0.050	100	0	100	99.5-100.5	0			

**DUP** Sample ID: **1108553-17ADUP** Units: **% of sample** Analysis Date: **8/18/2011 01:39 PM**Client ID: Run ID: **MOIST\_110818A** SeqNo: **1710183** Prep Date: DF: **1**

Analyte	Result	PQL	SPK Val	SPK Ref Value	%REC	Control Limit	RPD Ref Value	%RPD	RPD Limit	Qual
Moisture	19.94	0.050	0	0	0	0-0	19.55	1.98	20	

**DUP** Sample ID: **1108573-01ADUP** Units: **% of sample** Analysis Date: **8/18/2011 01:39 PM**Client ID: Run ID: **MOIST\_110818A** SeqNo: **1710192** Prep Date: DF: **1**

Analyte	Result	PQL	SPK Val	SPK Ref Value	%REC	Control Limit	RPD Ref Value	%RPD	RPD Limit	Qual
Moisture	3.14	0.050	0	0	0	0-0	3.49	10.6	20	

The following samples were analyzed in this batch:

1108572-01B	1108572-02A	1108572-03A
-------------	-------------	-------------

Note: See Qualifiers Page for a list of Qualifiers and their explanation.

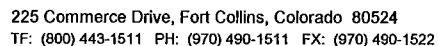



## Received 8/30/2011 Rifle COGCC

1108572

Form 202r8

\*Time Zone (Circle): EST CST MST PST Matrix: O = oil S = soil NS = non-soil solid W = water L = liquid E = extract F = filter

**For metals or anions, please detail analytes below.**

	SIGNATURE	PRINTED NAME	DATE	TIME
RELINQUISHED BY		Recd Wad	8/17/11	5pm
RECEIVED BY		KEITH WIERENGA	8/18/11	1045
RELINQUISHED BY				
RECEIVED BY				
RELINQUISHED BY				
RECEIVED BY				

**Subcontractor:**

A &amp; L Great Lakes Agricultural La

3505 Conestoga Dr

TEL: (260) 483-4759

FAX: (260) 483-5274

Ft. Wayne, IN 46808

Acct #: 91000

**CHAIN-OF-CUSTODY RECORD**Date: **18-Aug-11**COC ID: **3050**Due Date **19-Aug-11**

Page 1 of 1

Customer Information		Project Information		Parameter/Method Request for Analysis										
Purchase Order		Project Name	1108572	A Subcontracted Analyses (SUBCONTRACT)										
Work Order		Project Number		B										
Company Name	ALS Group USA, Corp	Bill To Company	ALS Group USA, Corp	C										
Send Report To	Ann Preston	Inv Attn	Accounts Payable	D										
Address	3352 128th Avenue	Address	3352 128th Avenue	E										
				F										
City/State/Zip	Holland, Michigan 49424-9263	City/State/Zip	Holland, Michigan 49424-9263	G										
Phone	(616) 399-6070	Phone	(616) 399-6070	H										
Fax	(616) 399-6185	Fax	(616) 399-6185	I										
eMail Address	ann.preston@alsglobal.com	eMail CC		J										
<b>Sample ID</b>	<b>Matrix</b>	<b>Collection Date 24hr</b>	<b>Bottle</b>	<b>A</b>	<b>B</b>	<b>C</b>	<b>D</b>	<b>E</b>	<b>F</b>	<b>G</b>	<b>H</b>	<b>I</b>	<b>J</b>	
1108572-01A (KP 34-18-BG1)	Soil	17/Aug/2011 10:45	(1) MISC	X										

**Comments:**Please analyze for SAR-EC. Email results to Ann Preston.

Relinquished by:	Date/Time	Received by:	Date/Time	Cooler IDs	Report/QC Level
					<b>Std</b>
Relinquished by:	Date/Time	Received by:	Date/Time		

ALS Group USA, Corp

## Sample Receipt Checklist

Client Name: HRLDate/Time Received: 18-Aug-11 10:45Work Order: 1108572Received by: KRWChecklist completed by Keith Wurenga 18-Aug-11  
eSignature DateReviewed by: Ann Preston 18-Aug-11  
eSignature DateMatrices: SoilCarrier name: FedEx

Shipping container/cooler in good condition? Yes ☒ No ☐ Not Present ☐

Custody seals intact on shipping container/cooler? Yes ☒ No ☐ Not Present ☐

Custody seals intact on sample bottles? Yes ☐ No ☐ Not Present ☒

Chain of custody present? Yes ☒ No ☐

Chain of custody signed when relinquished and received? Yes ☒ No ☐

Chain of custody agrees with sample labels? Yes ☒ No ☐

Samples in proper container/bottle? Yes ☒ No ☐

Sample containers intact? Yes ☒ No ☐

Sufficient sample volume for indicated test? Yes ☒ No ☐

All samples received within holding time? Yes ☒ No ☐

Container/Temp Blank temperature in compliance? Yes ☒ No ☐

Temperature(s)/Thermometer(s): 5.8 C

Cooler(s)/Kit(s):

Water - VOA vials have zero headspace? Yes ☐ No ☐ No VOA vials submitted ☒

Water - pH acceptable upon receipt? Yes ☐ No ☐ N/A ☒

pH adjusted? Yes ☐ No ☐ N/A ☒

pH adjusted by:

Login Notes:

-----

Client Contacted:

Date Contacted:

Person Contacted:

Contacted By:

Regarding:

Comments:

CorrectiveAction:



CUSTODY SEAL

DATE

SIGNATURE

QEC

Quality Environmental Containers  
800-255-3950 • 304-255-3900FedEx Express NEW Package  
US AirbillFedEx  
Tracking  
Number

8758 3471 4006

0200

Form  
ID No.

FedEx Retrieval Copy

## 1 From

Date 8/17/11

Sender's FedEx  
Account NumberSender's  
Name

Reed Wolf

Phone 970 243-3271

Company

HRH Compliance

Address

744 Horizon Ct Suite 140

Dept./Floor/Suite/Room

City

Grand Junction

State

CO

ZIP

81506

## 2 Your Internal Billing Reference

## 3 To

Recipient's  
Name

Sample Believing

Phone 616 399-6070

Company

ALS Group

Address

3252 128th Ave

We cannot deliver to P.O. boxes or P.O. ZIP codes.

Dept./Floor/Suite/Room

Address

Use this line for the HOLD location address or for continuation of your shipping address.

City

Holland

State

MT

ZIP

49424

01

HOLD Weekday  
FedEx location address  
REQUIRED. NOT available for  
FedEx First Overnight.

31

HOLD Saturday  
FedEx location address  
REQUIRED. Available ONLY for  
FedEx Priority Overnight and  
FedEx 2Day to select locations.

## 4 Express Package Service

\* To most locations.

NOTE: Service order has changed. Please select carefully.

## Next Business Day

06

FedEx First Overnight  
Earliest next business morning delivery to select  
locations. Friday shipments will be delivered on  
Monday unless SATURDAY Delivery is selected.

01

FedEx Priority Overnight  
Next business morning.\* Friday shipments will be  
delivered on Monday unless SATURDAY Delivery  
is selected.

05

FedEx Standard Overnight  
Next business afternoon.\*  
Saturday Delivery NOT available.

## 2 or 3 Business Days

49

NEW FedEx 2Day A.M.  
Second business morning.\*  
Saturday Delivery NOT available.

03

FedEx 2Day  
Second business afternoon.\* Thursday shipments  
will be delivered on Monday unless SATURDAY  
Delivery is selected.

20

FedEx Express Saver  
Third business day.\*  
Saturday Delivery NOT available.

## 5 Packaging

\* Declared value limit \$500.

06

FedEx Envelope\*

02

FedEx Pak\*

03

FedEx  
Box

04

FedEx  
Tube

01

Other

## 6 Special Handling and Delivery Signature Options

## SATURDAY DELIVERY

04

No Signature Required  
Package may be left without  
obtaining a signature for delivery.

10

Direct Signature  
Someone at recipient's address  
may sign for delivery. Fee applies.

34

Indirect Signature  
If no one is available at recipient's  
address, someone at a neighboring  
address may sign for delivery. For  
residential deliveries only. Fee applies.

## Does this shipment contain dangerous goods?

One box must be checked.

04

Yes  
As per attached  
Shipper's Declaration

Yes

Shipper's Declaration  
not required.

06

Dry Ice  
Dry Ice, 9 UN 1845

x

kg

Dangerous goods (including dry ice) cannot be shipped in FedEx packaging  
or placed in a FedEx Express Drop Box.

Cargo Aircraft Only

## 7 Payment Bill to:

Enter FedEx Acct. No. or Credit Card No. below.

Obtain recip.  
Acct. No.

1

Sender  
Acct. No. in Section  
1 will be billed.

2

Recipient

3

Third Party

4

Credit Card

5

Cash/Check

Total Packages

Total Weight

Credit Card Auth.

\*Our liability is limited to \$100 unless you declare a higher value. See the current FedEx Service Guide for details.



8758 3471 4006

612