

Loc ID # 335699

DOCUMENT
#2216271

FORM
15
Rev 6/99

State of Colorado
Oil and Gas Conservation Commission

1120 Lincoln Street, Suite 801, Denver, Colorado 80203 (303)894-2100 Fax: (303)894-2109



FOR OGCC USE ONLY
RECEIVED
9/14/2011

EARTHEN PIT REPORT/PERMIT

This form is to be used for both reporting and permitting pits. Rule 903 describes when a Permit with prior approval, or a Report within 30 days, is required for pits. Submit required attachments and forms.

FORM SUBMITTED FOR:

☒ **Pit Report** ☐ **Pit Permit**

Complete the Attachment Checklist

Oper OGCC

Detailed Site Plan	
Topo Map w/ Pit Location	/
Water Analysis (Form 25)	
Source Wells (Form 26)	
Pit Design/Plan & Cross Sect	
Design Calculations	
Sensitive Area Determ.	
Mud Program	
Form 2A	

OGCC Operator Number: 100185
Name of Operator: Encana Oil & Gas (USA) Inc.
Address: 370 17th Street, Suite 1700
City: Denver State: CO Zip: 80202

Contact Name and Telephone:
Chris Hines
No: 970-285-2653
Fax: _____

API Number (of associated well): 335699 (Location ID) G09 596 OGCC Facility ID (of other associated facility): _____
Pit Location (QtrQtr, Sec, Twp, Rng, Meridian): SWNE Sec. 9 T5S R96W
Latitude: 39.631945 Longitude: 108.173530 County: Garfield
Pit Use: ☒ Production ☐ Drilling (Attach mud program) ☐ Special Purpose (Describe Use): Multi-well Pit
Pit Type: ☒ Lined ☐ Unlined Surface Discharge Permit: ☐ Yes ☐ No
Offsite disposal of pit contents: ☐ Injection ☐ Commercial Pit/Facility Name: N/A 609 WEST Pit/Facility No: N/A 596
Attach Form 26 to identify Source Wells and Form 25 to provide Produced Water Analysis results.

Existing Site Conditions

WEST PIT - all

Is the location in a "Sensitive Area?" ☐ Yes ☒ No **Attach data used for determination.**
Distance (in feet) to nearest surface water: ~541 ground water: ~40' water wells: ~1.2 miles
LAND USE (or attach copy of Form 2A if previously submitted for associated well) Select one which best describes land use:
Crop Land: ☐ Irrigated ☐ Dry Land ☐ Improved Pasture ☐ Hay Meadow ☐ CRP
Non-Crop Land: ☒ Rangeland ☐ Timber ☐ Recreational ☐ Other (describe): _____
Subdivided: ☐ Industrial ☐ Commercial ☐ Residential
SOILS (or attach copy of Form 2A if previously submitted for associated well)
Soil map units from USNRCS survey: Sheet No: _____ Soil Complex/Series No: 56
Soils Series Name: Parachute trigul Rhone Horizon thickness (in inches): A: _____ ; B: _____ ; C: _____
Soils Series Name: _____ Horizon thickness (in inches): A: _____ ; B: _____ ; C: _____
Attach detailed site plan and topo map with pit location.

Pit Design and Construction

Size of pit (feet): Length: 200 Width: 39 Depth: 19
Calculated pit volume (bbls): 23603 Daily inflow rate (bbls/day): _____
Daily disposal rates (attach calculations): Evaporation: _____ bbls/day Percolation: _____ bbls/day
Type of liner material: HDPE Thickness: 30 mil
Attach description of proposed design and construction (Include sketches and calculations).
Method of treatment of produced water prior to discharge into pit (separator, heater treater, other): Mechanical settling/separating
Is pit fenced? ☒ Yes ☐ No Is pit netted? ☒ Yes ☐ No

I hereby certify that the statements made in this form are, to the best of my knowledge, true, correct, and complete.

Print Name: Heather Mitchell Signed: Heather Mitchell
Title: Regulatory Analyst Date: 09/01/2011

OGCC Approved: Carly Hines Title: FOR Greg Desautels Date: 09/14/2011

CONDITIONS OF APPROVAL, IF ANY:

FACILITY NUMBER: 425566

O&G Supervisor

Pit report submitted retroactively to establish pit facility ID # for pit closure purposes.

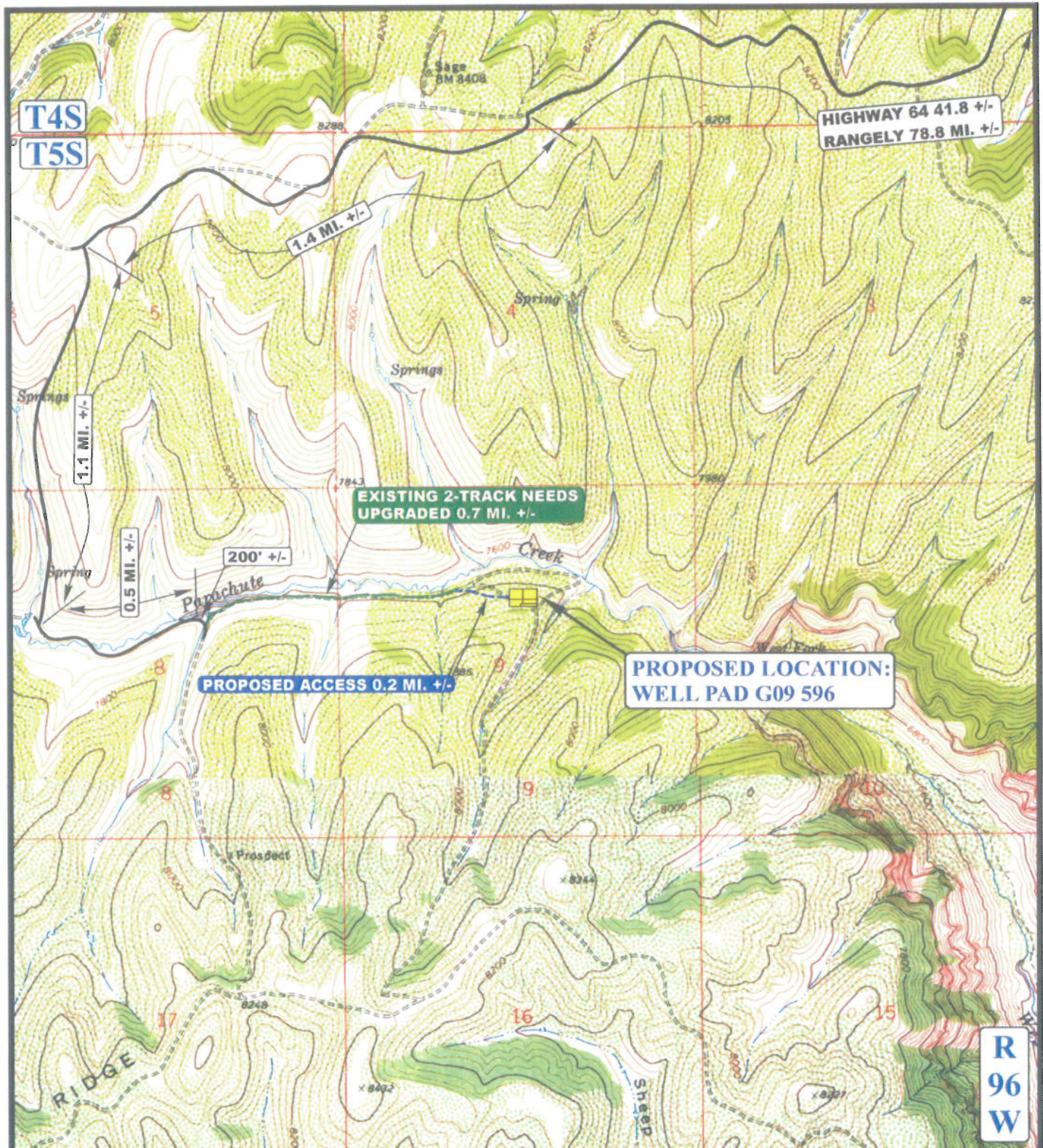

LEGEND:

— EXISTING ROAD
- - - PROPOSED ACCESS ROAD

EnCana OIL & GAS (USA) INC.

WELL PAD G09 596
SECTION 9, T5S, R96W, 6th P.M.
SW 1/4 NE 1/4



Uintah Engineering & Land Surveying
85 South 200 East Vernal, Utah 84078
(435) 789-1017 * FAX (435) 789-1813



TOPOGRAPHIC
MAP

07 **20** **06**
MONTH DAY YEAR

SCALE: 1" = 2000' DRAWN BY: J.L.G. REVISED: 00-00-00

B
TOPO



0 75 150
1 inch = 125 feet



G09 Well Pad
Wildcat Field
North Parachute Mountain
Garfield County, Colorado
Revised: September 5, 2011

Access Road

Edge of Working Surface

Storage Pits

Edge of Disturbance and Perimeter Controls

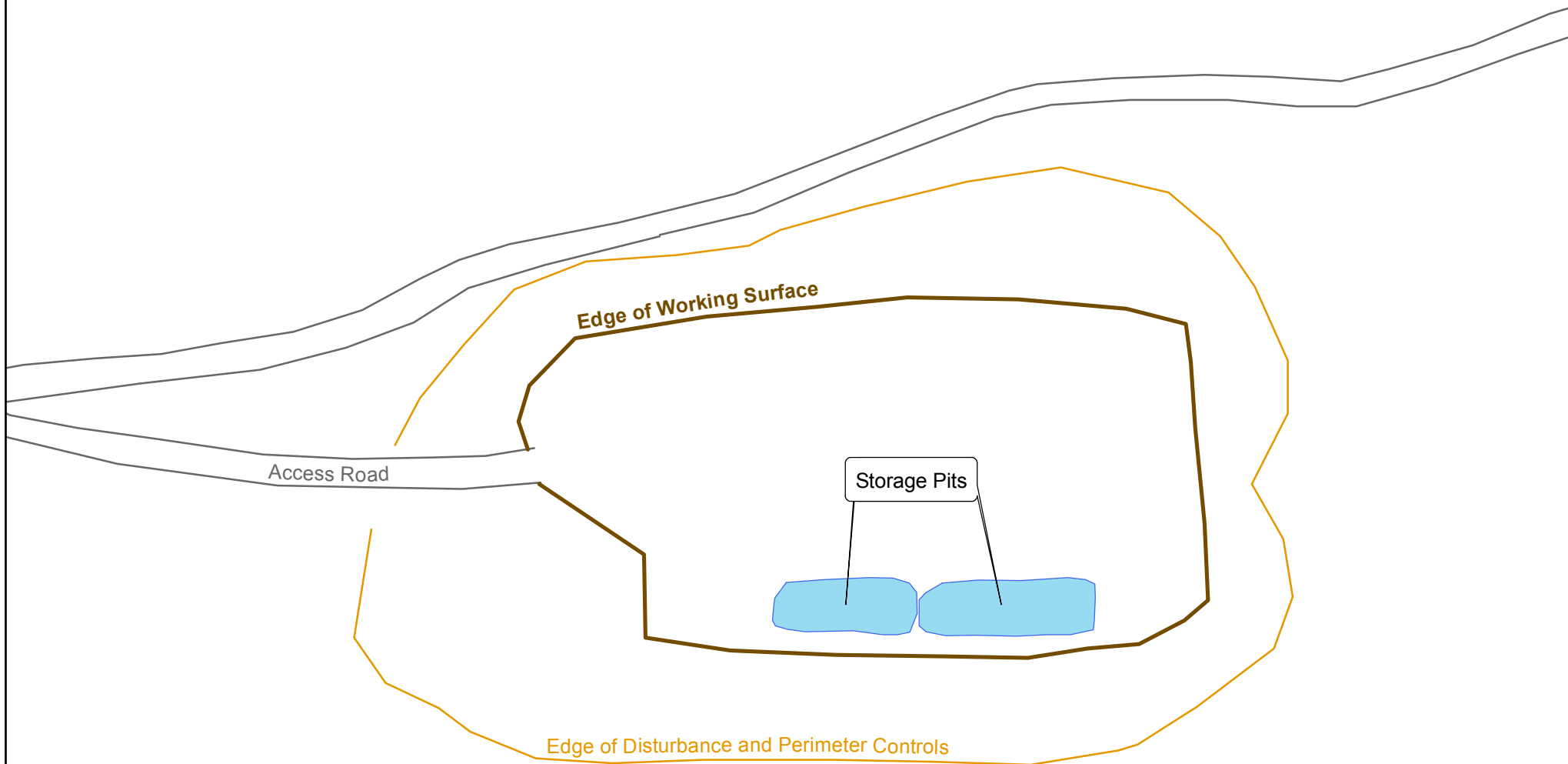

FORM 15 (Earthen Pit Report/Permit) Narrative Attachment

NPM G09 596 Pad – 335699(Location ID)

Document Date – 09/01/2011

This pit report was prepared in support of closure activities an historic and unpermitted pit on the G09 596 pad. This pit was transferred to Encana by Conoco Phillips effective 3/08/2010. Encana has limited internal documentation on the original use and construction of the pit. The intent of this submittal is not to justify continued operation of the pits, but to provide a facility ID number to reference during all correspondence associated with pit closure site investigation and remediation activities.

Is the location in a “Sensitive Area?”

No, based on the distance to surface water and the depth to ground water, this location is not found in a sensitive area.

Description of pit use:

The pit on G09 596 well pad provided storage for produced water.