

FORM

15

Rev 6/99

State of Colorado

Oil and Gas Conservation Commission

1120 Lincoln Street, Suite 801, Denver, Colorado 80203 (303)894-2100 Fax: (303)894-2109



DOCUMENT
#2216262

FOR OGCC USE ONLY

RECEIVED
9/14/2011

EARTHEN PIT REPORT/PERMIT

This form is to be used for both reporting and permitting pits. Rule 903 describes when a Permit with prior approval, or a Report within 30 days, is required for pits. Submit required attachments and forms.

FORM SUBMITTED FOR:

☒ Pit Report

☐ Pit Permit

OGCC Operator Number: 100185

Name of Operator: Encana Oil & Gas (USA) Inc.

Address: 370 17th Street, Suite 1700

City: Denver State: CO Zip: 80202

Contact Name and Telephone:

Chris Hines

No: 970-285-2653

Fax:

Complete the Attachment Checklist

Oper OGCC

Detailed Site Plan	<input checked="" type="checkbox"/>	<input type="checkbox"/>
Topo Map w/ Pit Location	<input checked="" type="checkbox"/>	<input type="checkbox"/>
Water Analysis (Form 25)	<input type="checkbox"/>	<input type="checkbox"/>
Source Wells (Form 26)	<input type="checkbox"/>	<input type="checkbox"/>
Pit Design/Plan & Cross Sect	<input type="checkbox"/>	<input type="checkbox"/>
Design Calculations	<input type="checkbox"/>	<input type="checkbox"/>
Sensitive Area Determ.	<input type="checkbox"/>	<input type="checkbox"/>
Mud Program	<input type="checkbox"/>	<input type="checkbox"/>
Form 2A	<input type="checkbox"/>	<input type="checkbox"/>

API Number (of associated well): 335573 (Location ID)

OGCC Facility ID (of other associated facility):

Pit Location (QtrQtr, Sec, Twp, Rng, Meridian): SWNE Sec. 29 T5S R95W - EF G29 595 pad

Latitude: 39.585625

Longitude: 108.073752

County: Garfield

Pit Use: ☒ Production ☐ Drilling (Attach mud program) ☐ Special Purpose (Describe Use): Multi-well Pit

Pit Type: ☒ Lined ☐ Unlined Surface Discharge Permit: ☐ Yes ☐ No

Offsite disposal of pit contents: ☐ Injection ☐ Commercial Pit/Facility Name: N/A G29 WEST Pit/Facility No: N/A 595

Attach Form 26 to identify Source Wells and Form 25 to provide Produced Water Analysis results.

WEST PIT

Existing Site Conditions

Is the location in a "Sensitive Area?" ☒ Yes ☐ No Attach data used for determination.

Distance (in feet) to nearest surface water: ~100 ground water: ~30' water wells: ~2945

LAND USE (or attach copy of Form 2A if previously submitted for associated well) Select one which best describes land use:

Crop Land: ☐ Irrigated ☐ Dry Land ☐ Improved Pasture ☐ Hay Meadow ☐ CRP

Non-Crop Land: ☒ Rangeland ☐ Timber ☐ Recreational ☐ Other (describe):

Subdivided: ☐ Industrial ☐ Commercial ☐ Residential

SOILS (or attach copy of Form 2A if previously submitted for associated well)

Soil map units from USNRCS survey: Sheet No: Soil Complex/Series No: 47

Soils Series Name: Nihill Channery Loam

Horizon thickness (in inches): A: ; B: ; C:

Soils Series Name: Horizon thickness (in inches): A: ; B: ; C:

Attach detailed site plan and topo map with pit location.

Pit Design and Construction

Size of pit (feet): Length: 281' Width: 64' 60' Depth: 16'

Calculated pit volume (bbls): 44816 Daily inflow rate (bbls/day):

Daily disposal rates (attach calculations): Evaporation: bbls/day Percolation: bbls/day

Type of liner material: HDPE Thickness: 30 mil

Attach description of proposed design and construction (include sketches and calculations).

Method of treatment of produced water prior to discharge into pit (separator, heater treater, other): Mechanical settling/separating

Is pit fenced? ☒ Yes ☐ No Is pit netted? ☒ Yes ☐ No

I hereby certify that the statements made in this form are, to the best of my knowledge, true, correct and complete.

Print Name: Heather Mitchell

Signed:

Title: Regulatory Analyst

Date: 09/06/2011

OGCC Approved: Title: For Greg Derambeau Date: 09/19/2011

CONDITIONS OF APPROVAL, IF ANY:

FACILITY NUMBER: 425550

OGCC supervisor

Pit report submitted retroactively to establish pit facility ID # for pit closure purposes. Form 27 pit closure workplan to be submitted shortly.

ENCANA OIL & GAS (USA) INC.
 NORTH PARACHUTE RANCH RECYCLING WATER PROGRAM
 G29 WELL PAD
 S29 T5S R95W

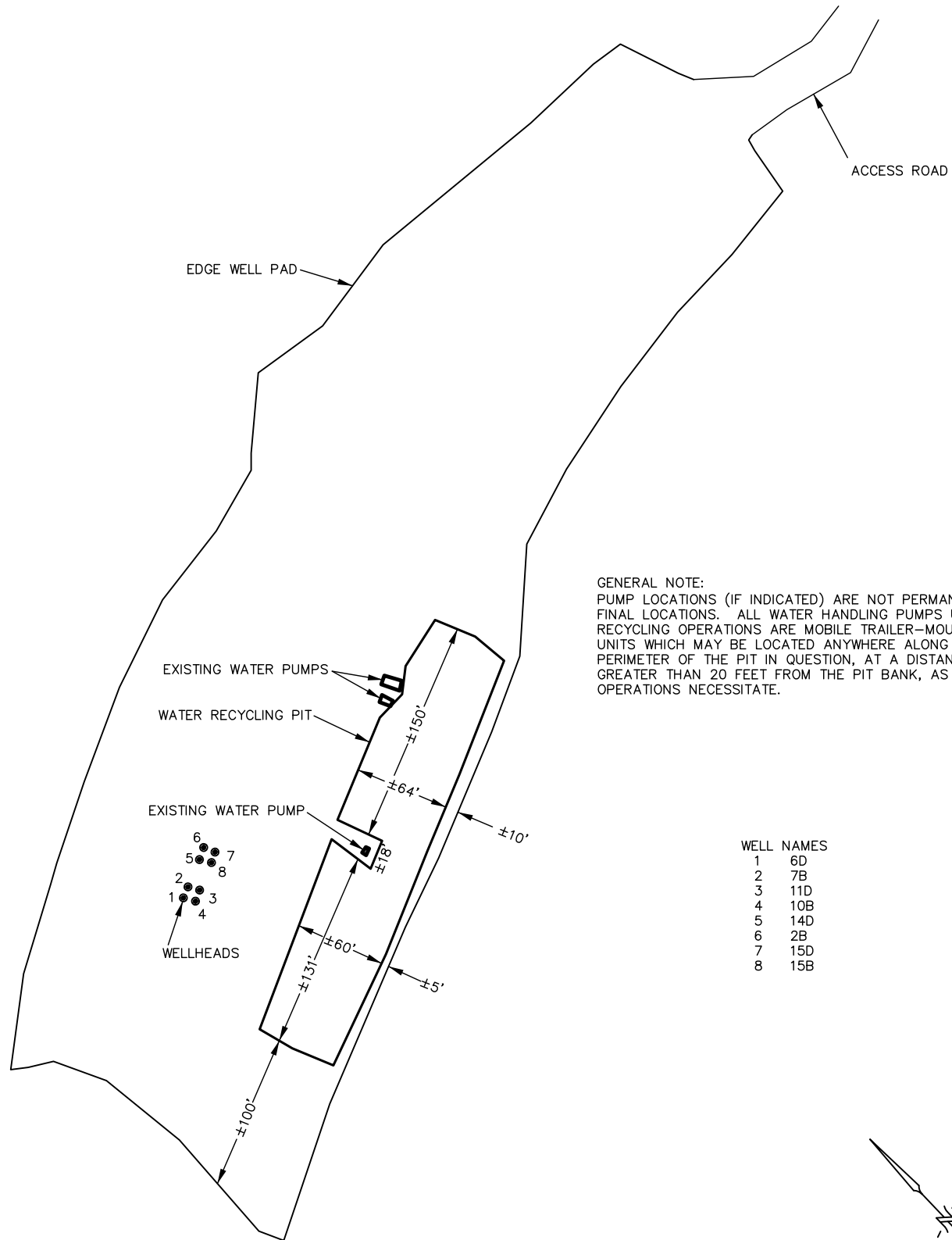

GENERAL NOTE:
 PUMP LOCATIONS (IF INDICATED) ARE NOT PERMANENT OR FINAL LOCATIONS. ALL WATER HANDLING PUMPS USED IN RECYCLING OPERATIONS ARE MOBILE TRAILER-MOUNTED UNITS WHICH MAY BE LOCATED ANYWHERE ALONG THE PERIMETER OF THE PIT IN QUESTION, AT A DISTANCE NO GREATER THAN 20 FEET FROM THE PIT BANK, AS OPERATIONS NECESSITATE.

WELL NAMES

1	6D
2	7B
3	11D
4	10B
5	14D
6	2B
7	15D
8	15B

Rev.: 7-31-08
 Date: 7-15-08
 Drawn By: JEV

UINTAH ENGINEERING & LAND SURVEYING
 832 North Crest Drive, Unit B Grand Junction, Colorado

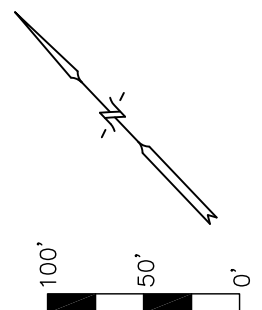

FORM 15 (Earthen Pit Report/Permit) Narrative Attachment

EF G29 595 Pad – 335573 (Location ID)

Document Date – 09/06/2011

This pit report was prepared in support of closure activities on historic and unpermitted pit on the EF G29 595 pad. Encana has limited internal documentation on the original use and construction of the pit. The intent of this submittal is not to justify continued operation of the pit, but to provide a facility ID number to reference during all correspondence associated with pit closure site investigation and remediation activities.

Is the location in a “Sensitive Area?”

Yes, based on the distance to surface water and the depth to ground water, this location is found in a sensitive area.

Description of pit use:

The pits on this well pad provided storage for treated water used in support of hydraulic fracturing operations in Encana’s North Parachute Ranch. The pits were constructed on the cut-slope and were supplied filtered produced water via pipeline from the Middle Fork Treatment Facility, located in the SWSW of Section 30, T5S, R95W in Garfield County or transferred from a flowback tank after mechanical settling.

The North Parachute Properties use a centralized 3-phase gathering system for the collection of produced natural gas and associated fluids. With this centralization of the fluid separation and processing, these pits are likely to contain filter produced water from every well in the North Parachute Properties.