



KERR MCGEE OIL & GAS ONSHORE LP



Location: COLORADO Slot: SLOT#02 CANNON 26-3 (1565'FNL & 1645'FEL)
Field: WELD COUNTY (KERR MCGEE) Well: CANNON 26-3
Facility: SEC.03-T2N-R65W Wellbore: CANNON 26-3 PWB

| | |
|---|--|
| Plot reference wellpath is CANNON 26-3 (REV-8.0) PWP | |
| True vertical depths are referenced to XTREME 12 (RKB) | Grid System: NAD83 / Lambert Colorado SP, Northern Zone (501), US feet |
| Measured depths are referenced to XTREME 12 (RKB) | North Reference: True north |
| XTREME 12 (RKB) to Mean Sea Level: 4860 feet | Scale: True distance |
| Mean Sea Level to Mud line (At Slot: SLOT#02 CANNON 26-3 (1565'FNL & 1645'FEL)): 0 feet | Depths are in feet |
| Coordinates are in feet referenced to Slot | Created by: doddanna on 9/9/2011 |

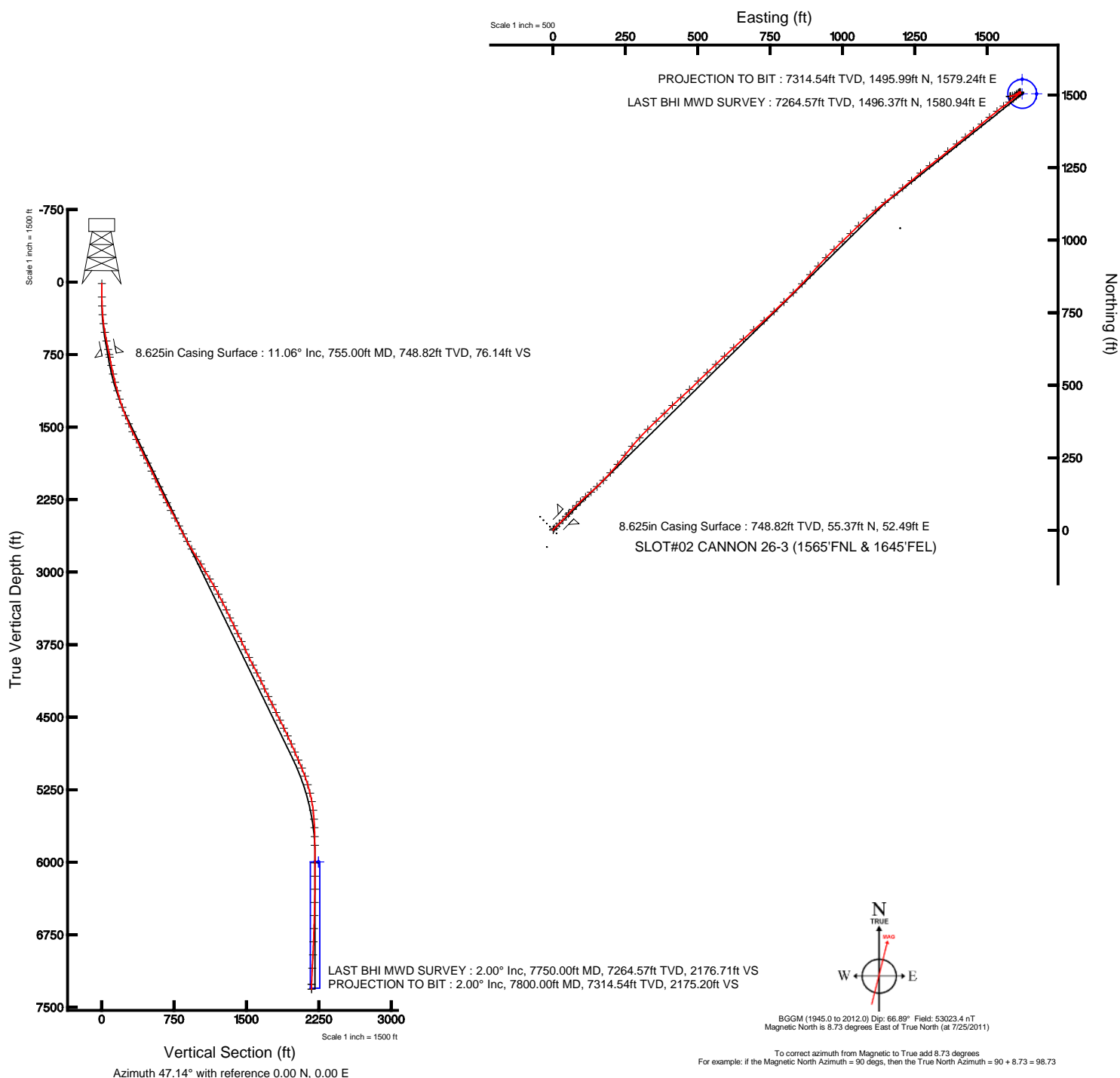



Actual Wellpath Report

CANNON 26-3 AWP

Page 1 of 4



| REFERENCE WELLPATH IDENTIFICATION | | | |
|-----------------------------------|---------------------------------|----------|---|
| Operator | KERR MCGEE OIL & GAS ONSHORE LP | Slot | SLOT#02 CANNON 26-3 (1565'FNL & 1645'FEL) |
| Area | COLORADO | Well | CANNON 26-3 |
| Field | WELD COUNTY (KERR MCGEE) | Wellbore | CANNON 26-3 AWB |
| Facility | SEC.03-T2N-R65W | | |

| REPORT SETUP INFORMATION | | | |
|--------------------------|---|----------------------|-------------------------------|
| Projection System | NAD83 / Lambert Colorado SP, Northern Zone (501), US feet | Software System | WellArchitect@ 3.0.0 |
| North Reference | True | User | Doddanna |
| Scale | 0.999958 | Report Generated | 9/9/2011 at 12:40:09 PM |
| Convergence at slot | 0.55° East | Database/Source file | WA_Denver/CANNON_26-3_AWB.xml |

| WELLPATH LOCATION | | | | | | |
|-----------------------|-------------------|----------|------------------|-----------------|------------------------|-----------------|
| | Local coordinates | | Grid coordinates | | Geographic coordinates | |
| | North[ft] | East[ft] | Easting[US ft] | Northing[US ft] | Latitude | Longitude |
| Slot Location | 11.70 | -11.16 | 3238598.88 | 1306032.34 | 40°10'13.084"N | 104°38'46.259"W |
| Facility Reference Pt | | | 3238610.16 | 1306020.75 | 40°10'12.968"N | 104°38'46.115"W |
| Field Reference Pt | | | 3197771.84 | 1268891.29 | 40°04'09.600"N | 104°47'36.000"W |

| WELLPATH DATUM | | | |
|--------------------------|-------------------|---|-------------------|
| Calculation method | Minimum curvature | XTREME 12 (RKB) to Facility Vertical Datum | 4860.00ft |
| Horizontal Reference Pt | Slot | XTREME 12 (RKB) to Mean Sea Level | 4860.00ft |
| Vertical Reference Pt | XTREME 12 (RKB) | XTREME 12 (RKB) to Mud Line at Slot (SLOT#02 CANNON 26-3 (1565'FNL & 1645'FEL)) | 4860.00ft |
| MD Reference Pt | XTREME 12 (RKB) | Section Origin | N 0.00, E 0.00 ft |
| Field Vertical Reference | Mean Sea Level | Section Azimuth | 47.14° |



Actual Wellpath Report

CANNON 26-3 AWP

Page 2 of 4



| REFERENCE WELLPATH IDENTIFICATION | | | |
|-----------------------------------|---------------------------------|----------|---|
| Operator | KERR MCGEE OIL & GAS ONSHORE LP | Slot | SLOT#02 CANNON 26-3 (1565'FNL & 1645'FEL) |
| Area | COLORADO | Well | CANNON 26-3 |
| Field | WELD COUNTY (KERR MCGEE) | Wellbore | CANNON 26-3 AWB |
| Facility | SEC.03-T2N-R65W | | |

| WELLPATH DATA (82 stations) † = interpolated/extrapolated station | | | | | | | | |
|---|--------------------|----------------|-------------|-------------------|---------------|--------------|------------------|----------|
| MD [ft] | Inclination [°] | Azimuth [°] | TVD [ft] | Vert Sect [ft] | North [ft] | East [ft] | DLS [°/100ft] | Comments |
| 0.00† | 0.000 | 9.400 | 0.00 | 0.00 | 0.00 | 0.00 | 0.00 | |
| 15.00 | 0.000 | 9.400 | 15.00 | 0.00 | 0.00 | 0.00 | 0.00 | |
| 153.00 | 0.400 | 9.400 | 153.00 | 0.38 | 0.48 | 0.08 | 0.29 | |
| 245.00 | 2.000 | 35.800 | 244.98 | 2.21 | 2.09 | 1.07 | 1.79 | |
| 337.00 | 4.700 | 45.700 | 336.81 | 7.55 | 6.03 | 4.71 | 2.99 | |
| 429.00 | 7.300 | 45.700 | 428.30 | 17.16 | 12.75 | 11.59 | 2.83 | |
| 521.00 | 10.100 | 44.300 | 519.23 | 31.07 | 22.60 | 21.41 | 3.05 | |
| 612.00 | 11.300 | 44.600 | 608.65 | 47.94 | 34.66 | 33.24 | 1.32 | |
| 700.00 | 11.600 | 42.100 | 694.90 | 65.37 | 47.37 | 45.23 | 0.66 | |
| 782.00 | 10.800 | 42.500 | 775.33 | 81.24 | 59.15 | 55.95 | 0.98 | |
| 870.00 | 11.100 | 44.300 | 861.73 | 97.92 | 71.29 | 67.43 | 0.52 | |
| 960.00 | 12.400 | 46.000 | 949.85 | 116.23 | 84.20 | 80.43 | 1.49 | |
| 1047.00 | 14.400 | 45.000 | 1034.47 | 136.39 | 98.34 | 94.80 | 2.31 | |
| 1138.00 | 15.400 | 47.400 | 1122.41 | 159.78 | 114.52 | 111.70 | 1.29 | |
| 1229.00 | 16.800 | 50.900 | 1209.84 | 184.98 | 131.00 | 130.80 | 1.87 | |
| 1320.00 | 19.000 | 45.700 | 1296.44 | 212.92 | 149.64 | 151.61 | 2.99 | |
| 1410.00 | 22.000 | 43.900 | 1380.73 | 244.40 | 172.02 | 173.79 | 3.41 | |
| 1501.00 | 23.500 | 42.500 | 1464.65 | 279.51 | 197.68 | 197.87 | 1.75 | |
| 1592.00 | 26.500 | 39.700 | 1547.12 | 317.73 | 226.69 | 223.10 | 3.54 | |
| 1683.00 | 26.300 | 37.900 | 1628.63 | 357.76 | 258.22 | 248.45 | 0.91 | |
| 1773.00 | 25.300 | 39.700 | 1709.66 | 396.51 | 288.75 | 272.99 | 1.41 | |
| 1864.00 | 25.800 | 42.800 | 1791.76 | 435.54 | 318.24 | 298.86 | 1.57 | |
| 1955.00 | 27.300 | 45.300 | 1873.16 | 476.15 | 347.45 | 327.16 | 2.06 | |
| 2046.00 | 26.000 | 46.700 | 1954.50 | 516.96 | 375.81 | 356.51 | 1.59 | |
| 2136.00 | 25.100 | 45.700 | 2035.69 | 555.77 | 402.67 | 384.53 | 1.11 | |
| 2227.00 | 25.800 | 46.400 | 2117.86 | 594.86 | 429.81 | 412.68 | 0.84 | |
| 2318.00 | 26.000 | 47.800 | 2199.72 | 634.61 | 456.86 | 441.80 | 0.71 | |
| 2409.00 | 27.200 | 46.700 | 2281.09 | 675.35 | 484.53 | 471.71 | 1.43 | |
| 2499.00 | 28.300 | 45.300 | 2360.74 | 717.25 | 513.64 | 501.85 | 1.42 | |
| 2590.00 | 27.100 | 47.100 | 2441.31 | 759.54 | 542.92 | 532.36 | 1.61 | |
| 2681.00 | 26.800 | 46.400 | 2522.43 | 800.78 | 571.18 | 562.40 | 0.48 | |
| 2772.00 | 28.000 | 47.100 | 2603.22 | 842.65 | 599.87 | 592.91 | 1.37 | |
| 2862.00 | 29.000 | 47.100 | 2682.31 | 885.60 | 629.10 | 624.37 | 1.11 | |
| 2953.00 | 30.500 | 49.200 | 2761.32 | 930.74 | 659.21 | 658.01 | 2.01 | |
| 3044.00 | 32.500 | 48.500 | 2838.90 | 978.26 | 690.50 | 693.81 | 2.23 | |
| 3135.00 | 30.900 | 47.800 | 2916.32 | 1026.07 | 722.40 | 729.43 | 1.80 | |
| 3225.00 | 31.400 | 46.400 | 2993.35 | 1072.62 | 754.09 | 763.53 | 0.98 | |
| 3316.00 | 31.000 | 46.000 | 3071.19 | 1119.76 | 786.72 | 797.55 | 0.50 | |
| 3407.00 | 29.100 | 45.300 | 3149.95 | 1165.31 | 818.57 | 830.14 | 2.12 | |
| 3498.00 | 28.000 | 43.200 | 3229.89 | 1208.74 | 849.70 | 860.49 | 1.64 | |
| 3589.00 | 27.500 | 41.800 | 3310.42 | 1250.97 | 880.94 | 889.12 | 0.90 | |
| 3679.00 | 25.800 | 42.500 | 3390.86 | 1291.18 | 910.87 | 916.20 | 1.92 | |
| 3770.00 | 25.600 | 43.900 | 3472.86 | 1330.55 | 939.64 | 943.21 | 0.70 | |
| 3861.00 | 25.900 | 45.300 | 3554.82 | 1370.04 | 967.78 | 970.97 | 0.75 | |
| 3952.00 | 26.300 | 46.400 | 3636.54 | 1410.06 | 995.67 | 999.70 | 0.69 | |



Actual Wellpath Report

CANNON 26-3 AWP

Page 3 of 4



| REFERENCE WELLPATH IDENTIFICATION | | | |
|-----------------------------------|---------------------------------|----------|---|
| Operator | KERR MCGEE OIL & GAS ONSHORE LP | Slot | SLOT#02 CANNON 26-3 (1565'FNL & 1645'FEL) |
| Area | COLORADO | Well | CANNON 26-3 |
| Field | WELD COUNTY (KERR MCGEE) | Wellbore | CANNON 26-3 AWB |
| Facility | SEC.03-T2N-R65W | | |

| WELLPATH DATA (82 stations) | | | | | | | | |
|-----------------------------|--------------------|----------------|-------------|-------------------|---------------|--------------|------------------|---------------------|
| MD [ft] | Inclination [°] | Azimuth [°] | TVD [ft] | Vert Sect [ft] | North [ft] | East [ft] | DLS [°/100ft] | Comments |
| 4043.00 | 25.200 | 45.700 | 3718.50 | 1449.59 | 1023.10 | 1028.16 | 1.25 | |
| 4133.00 | 25.200 | 45.300 | 3799.94 | 1487.89 | 1049.96 | 1055.50 | 0.19 | |
| 4224.00 | 25.700 | 48.800 | 3882.11 | 1526.98 | 1076.58 | 1084.12 | 1.74 | |
| 4315.00 | 27.700 | 49.900 | 3963.41 | 1567.83 | 1103.21 | 1115.14 | 2.26 | |
| 4406.00 | 27.300 | 50.900 | 4044.12 | 1609.78 | 1129.99 | 1147.52 | 0.67 | |
| 4496.00 | 25.700 | 51.300 | 4124.67 | 1649.84 | 1155.21 | 1178.77 | 1.79 | |
| 4587.00 | 24.800 | 49.200 | 4206.97 | 1688.60 | 1180.02 | 1208.61 | 1.40 | |
| 4678.00 | 26.900 | 50.600 | 4288.86 | 1728.22 | 1205.56 | 1238.97 | 2.40 | |
| 4769.00 | 26.500 | 49.900 | 4370.16 | 1769.05 | 1231.70 | 1270.41 | 0.56 | |
| 4860.00 | 25.700 | 52.300 | 4451.88 | 1808.98 | 1256.85 | 1301.55 | 1.46 | |
| 4950.00 | 26.300 | 51.600 | 4532.77 | 1848.30 | 1281.17 | 1332.62 | 0.75 | |
| 5041.00 | 27.100 | 50.900 | 4614.07 | 1889.08 | 1306.76 | 1364.50 | 0.94 | |
| 5132.00 | 24.900 | 51.600 | 4695.85 | 1928.86 | 1331.74 | 1395.60 | 2.44 | |
| 5222.00 | 24.200 | 51.600 | 4777.72 | 1966.14 | 1354.96 | 1424.91 | 0.78 | |
| 5313.00 | 22.900 | 49.900 | 4861.14 | 2002.43 | 1377.95 | 1453.07 | 1.61 | |
| 5404.00 | 24.400 | 50.900 | 4944.49 | 2038.87 | 1401.21 | 1481.20 | 1.71 | |
| 5495.00 | 22.200 | 50.600 | 5028.07 | 2074.79 | 1423.98 | 1509.08 | 2.42 | |
| 5586.00 | 20.000 | 50.600 | 5112.96 | 2107.49 | 1444.78 | 1534.39 | 2.42 | |
| 5677.00 | 17.100 | 54.100 | 5199.23 | 2136.31 | 1462.50 | 1557.26 | 3.41 | |
| 5767.00 | 13.500 | 53.700 | 5286.02 | 2159.89 | 1476.49 | 1576.45 | 4.00 | |
| 5858.00 | 10.600 | 50.200 | 5375.01 | 2178.80 | 1488.13 | 1591.44 | 3.28 | |
| 5949.00 | 6.500 | 46.700 | 5464.98 | 2192.31 | 1497.03 | 1601.63 | 4.54 | |
| 6040.00 | 4.500 | 55.200 | 5555.56 | 2201.00 | 1502.60 | 1608.31 | 2.37 | |
| 6130.00 | 2.400 | 56.200 | 5645.39 | 2206.36 | 1505.66 | 1612.77 | 2.33 | |
| 6221.00 | 1.000 | 11.900 | 5736.35 | 2208.89 | 1507.50 | 1614.52 | 2.00 | |
| 6312.00 | 0.600 | 25.600 | 5827.34 | 2209.98 | 1508.71 | 1614.89 | 0.48 | |
| 6494.00 | 0.400 | 343.800 | 6009.33 | 2211.15 | 1510.18 | 1615.13 | 0.22 | |
| 6630.00 | 0.400 | 329.700 | 6145.33 | 2211.47 | 1511.04 | 1614.75 | 0.07 | |
| 6766.00 | 0.800 | 253.000 | 6281.32 | 2210.72 | 1511.17 | 1613.61 | 0.59 | |
| 6902.00 | 1.200 | 237.600 | 6417.30 | 2208.46 | 1510.13 | 1611.50 | 0.35 | |
| 7038.00 | 1.700 | 236.600 | 6553.26 | 2205.07 | 1508.26 | 1608.61 | 0.37 | |
| 7174.00 | 1.700 | 236.600 | 6689.20 | 2201.09 | 1506.04 | 1605.24 | 0.00 | |
| 7310.00 | 2.200 | 235.500 | 6825.12 | 2196.52 | 1503.45 | 1601.41 | 0.37 | |
| 7446.00 | 3.300 | 246.000 | 6960.96 | 2190.23 | 1500.38 | 1595.68 | 0.89 | |
| 7582.00 | 3.200 | 258.000 | 7096.75 | 2183.27 | 1498.00 | 1588.39 | 0.50 | |
| 7750.00 | 2.000 | 257.200 | 7264.57 | 2176.71 | 1496.37 | 1580.94 | 0.71 | LAST BHI MWD SURVEY |
| 7800.00 | 2.000 | 257.200 | 7314.54 | 2175.20 | 1495.99 | 1579.24 | 0.00 | PROJECTION TO BIT |



Actual Wellpath Report

CANNON 26-3 AWP

Page 4 of 4



| REFERENCE WELLPATH IDENTIFICATION | | | |
|-----------------------------------|---------------------------------|----------|---|
| Operator | KERR MCGEE OIL & GAS ONSHORE LP | Slot | SLOT#02 CANNON 26-3 (1565'FNL & 1645'FEL) |
| Area | COLORADO | Well | CANNON 26-3 |
| Field | WELD COUNTY (KERR MCGEE) | Wellbore | CANNON 26-3 AWB |
| Facility | SEC.03-T2N-R65W | | |

| HOLE & CASING SECTIONS - Ref Wellbore: CANNON 26-3 AWB Ref Wellpath: CANNON 26-3 AWP | | | | | | | | | |
|--|---------------|-------------|---------------|----------------|--------------|----------------|----------------|--------------|--------------|
| String/Diameter | Start MD [ft] | End MD [ft] | Interval [ft] | Start TVD [ft] | End TVD [ft] | Start N/S [ft] | Start E/W [ft] | End N/S [ft] | End E/W [ft] |
| 12.25in Open Hole | 15.00 | 755.00 | 740.00 | 15.00 | 748.82 | 0.00 | 0.00 | 55.37 | 52.49 |
| 8.625in Casing Surface | 15.00 | 755.00 | 740.00 | 15.00 | 748.82 | 0.00 | 0.00 | 55.37 | 52.49 |
| 7.875in Open Hole | 755.00 | 7800.00 | 7045.00 | 748.82 | 7314.54 | 55.37 | 52.49 | 1495.99 | 1579.24 |

| TARGETS | | | | | | | | | |
|---|---------|----------|------------|-----------|-------------------|--------------------|----------------|-----------------|--------|
| Name | MD [ft] | TVD [ft] | North [ft] | East [ft] | Grid East [US ft] | Grid North [US ft] | Latitude | Longitude | Shape |
| CANNON 26-3 GEO TARGET 50' RADIUS (50'FNL & 50'FEL REV-1) | | 6000.00 | 1504.95 | 1621.64 | 3240205.89 | 1307552.76 | 40°10'27.955"N | 104°38'25.368"W | circle |
| CANNON 26-3 HARDLINE 50'N OF GEO TARGET | | 6000.00 | 1554.97 | 1621.64 | 3240205.40 | 1307602.78 | 40°10'28.449"N | 104°38'25.368"W | point |
| CANNON 26-3 HARDLINE 50'E OF GEO TARGET | | 6000.00 | 1504.97 | 1671.64 | 3240255.88 | 1307553.27 | 40°10'27.955"N | 104°38'24.724"W | point |

| WELLPATH COMPOSITION - Ref Wellbore: CANNON 26-3 AWB Ref Wellpath: CANNON 26-3 AWP | | | | |
|--|-------------|------------------------------|-----------------------------------|-----------------|
| Start MD [ft] | End MD [ft] | Positional Uncertainty Model | Log Name/Comment | Wellbore |
| 15.00 | 700.00 | NaviTrak (Standard) | BHI MWD NAVITRAK 12.25 <153-700> | CANNON 26-3 AWB |
| 700.00 | 7750.00 | Unknown Tool (Standard) | BHI MWD NAVITRAK 7.875 <782-7750> | CANNON 26-3 AWB |
| 7750.00 | 7800.00 | Blind Drilling (std) | Projection to bit | CANNON 26-3 AWB |