



# KERR MCGEE OIL & GAS ONSHORE LP



Location: COLORADO Slot: SLOT#03 CANNON 7-3 (1554'FNL & 1657'FEL)  
Field: WELD COUNTY (KERR MCGEE) Well: CANNON 7-3  
Facility: SEC.03-T2N-R65W Wellbore: CANNON 7-3 PWB

Plot reference wellpath is CANNON 7-3 (REV-A.1) PWP	
True vertical depths are referenced to XTREME 12 (RKB)	Grid System: NAD83 / Lambert Colorado SP, Northern Zone (501), US feet
Measured depths are referenced to XTREME 12 (RKB)	North Reference: True north
XTREME 12 (RKB) to Mean Sea Level: 4860 feet	Scale: True distance
Mean Sea Level to Mud line (At Slot: SLOT#03 CANNON 7-3 (1554'FNL & 1657'FEL)): 0 feet	Depths are in feet
Coordinates are in feet referenced to Slot	Created by: doddanna on 9/9/2011

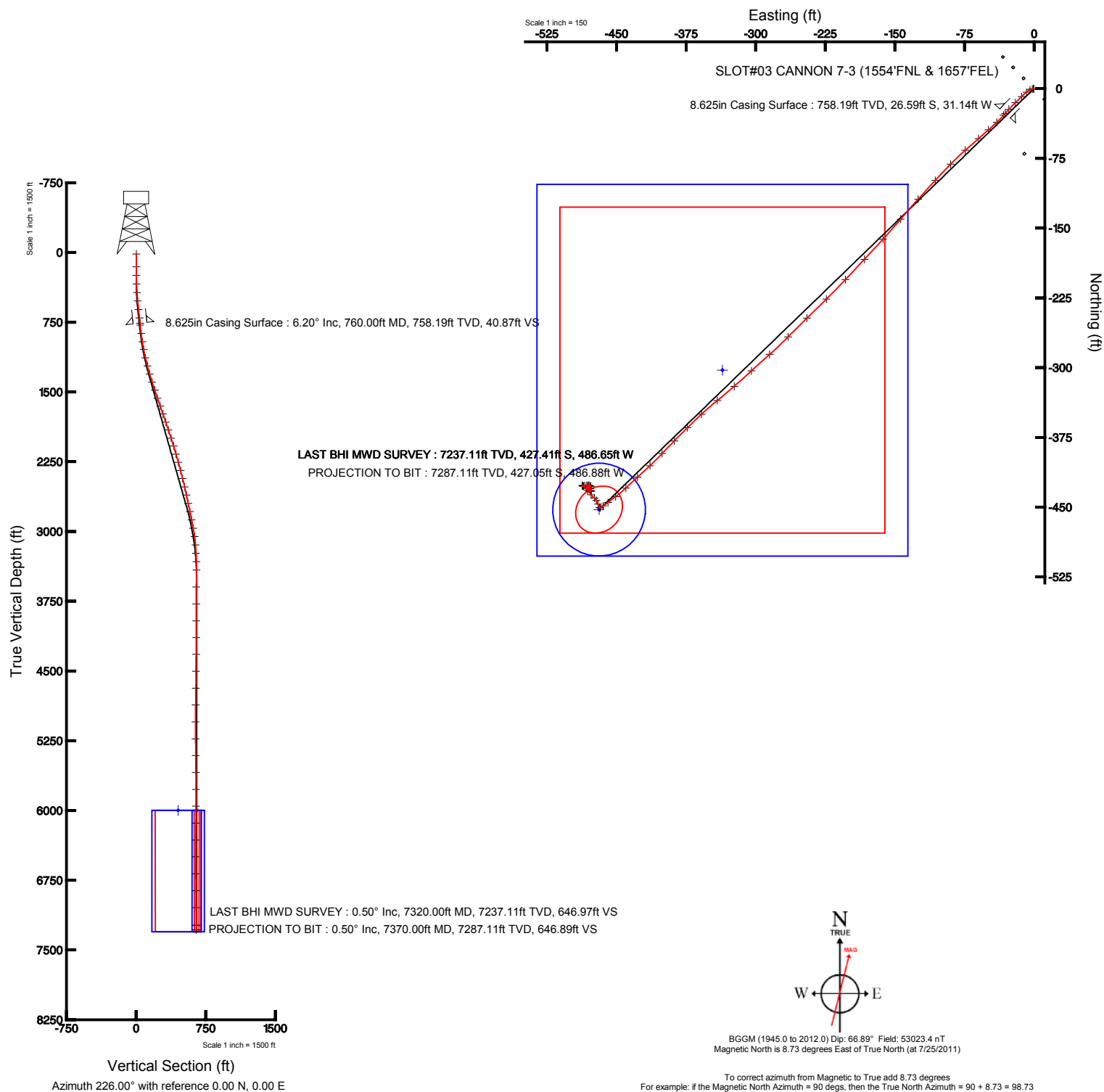



# Actual Wellpath Report

CANNON 7-3 AWP

Page 1 of 4



REFERENCE WELLPATH IDENTIFICATION			
Operator	KERR MCGEE OIL & GAS ONSHORE LP	Slot	SLOT#03 CANNON 7-3 (1554'FNL & 1657'FEL)
Area	COLORADO	Well	CANNON 7-3
Field	WELD COUNTY (KERR MCGEE)	Wellbore	CANNON 7-3 AWB
Facility	SEC.03-T2N-R65W		

REPORT SETUP INFORMATION			
Projection System	NAD83 / Lambert Colorado SP, Northern Zone (501), US feet	Software System	WellArchitect® 3.0.0
North Reference	True	User	Doddanna
Scale	0.999958	Report Generated	9/9/2011 at 9:36:01 AM
Convergence at slot	0.55° East	Database/Source file	WA_Denver/CANNON_7-3_AWB.xml

WELLPATH LOCATION						
	Local coordinates		Grid coordinates		Geographic coordinates	
	North[ft]	East[ft]	Easting[US ft]	Northing[US ft]	Latitude	Longitude
Slot Location	22.99	-22.34	3238587.60	1306043.52	40°10'13.195"N	104°38'46.403"W
Facility Reference Pt			3238610.16	1306020.75	40°10'12.968"N	104°38'46.115"W
Field Reference Pt			3197771.84	1268891.29	40°04'09.600"N	104°47'36.000"W

WELLPATH DATUM			
Calculation method	Minimum curvature	XTREME 12 (RKB) to Facility Vertical Datum	4860.00ft
Horizontal Reference Pt	Slot	XTREME 12 (RKB) to Mean Sea Level	4860.00ft
Vertical Reference Pt	XTREME 12 (RKB)	XTREME 12 (RKB) to Mud Line at Slot (SLOT#03 CANNON 7-3 (1554'FNL & 1657'FEL))	4860.00ft
MD Reference Pt	XTREME 12 (RKB)	Section Origin	N 0.00, E 0.00 ft
Field Vertical Reference	Mean Sea Level	Section Azimuth	226.00°



# Actual Wellpath Report

CANNON 7-3 AWP

Page 2 of 4



REFERENCE WELLPATH IDENTIFICATION			
Operator	KERR MCGEE OIL & GAS ONSHORE LP	Slot	SLOT#03 CANNON 7-3 (1554'FNL & 1657'FEL)
Area	COLORADO	Well	CANNON 7-3
Field	WELD COUNTY (KERR MCGEE)	Wellbore	CANNON 7-3 AWB
Facility	SEC.03-T2N-R65W		

WELLPATH DATA (62 stations) † = interpolated/extrapolated station								
MD [ft]	Inclination [°]	Azimuth [°]	TVD [ft]	Vert Sect [ft]	North [ft]	East [ft]	DLS [°/100ft]	Comments
0.00†	0.000	263.600	0.00	0.00	0.00	0.00	0.00	
15.00	0.000	263.600	15.00	0.00	0.00	0.00	0.00	
153.00	0.500	263.600	153.00	0.48	-0.07	-0.60	0.36	
245.00	1.100	258.400	244.99	1.54	-0.29	-1.86	0.66	
337.00	2.000	244.600	336.95	3.81	-1.16	-4.18	1.05	
429.00	3.600	232.700	428.84	8.20	-3.59	-7.93	1.84	
521.00	5.300	225.300	520.56	15.32	-8.33	-13.24	1.95	
612.00	6.500	225.700	611.08	24.67	-14.89	-19.92	1.32	
703.00	6.200	223.500	701.52	34.73	-22.05	-26.99	0.42	
782.00	6.200	220.700	780.06	43.24	-28.38	-32.71	0.38	
873.00	7.200	226.400	870.44	53.84	-36.04	-40.04	1.32	
963.00	8.300	228.800	959.61	65.96	-44.21	-49.01	1.27	
1047.00	11.300	228.500	1042.38	80.25	-53.65	-59.74	3.57	
1138.00	13.000	229.200	1131.34	99.37	-66.25	-74.17	1.88	
1229.00	14.500	224.300	1219.73	120.98	-81.09	-89.87	2.09	
1319.00	16.700	222.500	1306.41	145.15	-98.69	-106.48	2.50	
1410.00	18.200	222.500	1393.22	172.39	-118.81	-124.92	1.65	
1501.00	18.300	220.000	1479.64	200.78	-140.23	-143.70	0.87	
1592.00	18.700	222.500	1565.94	229.55	-161.93	-162.74	0.98	
1682.00	19.400	223.200	1651.01	258.88	-183.47	-182.72	0.82	
1773.00	19.100	223.200	1736.92	288.85	-205.34	-203.26	0.33	
1864.00	18.600	225.700	1823.04	318.23	-226.33	-223.83	1.04	
1955.00	18.800	225.700	1909.24	347.41	-246.70	-244.72	0.22	
2046.00	18.200	224.600	1995.54	376.28	-267.06	-265.19	0.76	
2136.00	17.200	228.500	2081.28	403.63	-285.89	-285.03	1.72	
2227.00	16.400	227.400	2168.40	429.91	-303.50	-304.56	0.95	
2318.00	15.500	229.200	2255.89	454.89	-320.14	-323.22	1.13	
2409.00	14.900	230.900	2343.71	478.69	-335.47	-341.50	0.82	
2499.00	13.900	227.100	2430.88	501.03	-350.12	-358.40	1.53	
2590.00	13.000	225.700	2519.39	522.19	-364.71	-373.74	1.05	
2681.00	12.300	223.900	2608.18	542.12	-378.85	-387.78	0.88	
2772.00	11.800	223.900	2697.17	561.10	-392.53	-400.96	0.55	
2862.00	12.000	226.700	2785.24	579.65	-405.58	-414.15	0.68	
2953.00	11.300	227.800	2874.36	598.02	-418.06	-427.64	0.81	
3044.00	10.200	226.700	2963.76	614.99	-429.57	-440.10	1.23	
3135.00	8.100	233.400	3053.60	629.41	-438.92	-451.12	2.58	
3226.00	5.000	232.300	3144.00	639.71	-445.17	-459.40	3.41	
3316.00	3.300	235.900	3233.76	646.16	-449.02	-464.65	1.91	
3407.00	1.100	240.400	3324.69	649.59	-450.92	-467.58	2.42	
3498.00	0.800	346.200	3415.68	650.11	-450.74	-468.49	1.68	
3680.00	1.800	330.800	3597.63	648.74	-447.01	-470.19	0.58	
3861.00	1.000	349.400	3778.58	647.15	-442.98	-471.87	0.50	
4043.00	1.300	300.200	3960.54	646.84	-440.38	-473.94	0.55	
4224.00	2.000	322.000	4141.47	647.07	-436.85	-477.66	0.51	
4405.00	1.800	320.200	4322.37	646.53	-432.18	-481.43	0.12	



# Actual Wellpath Report

CANNON 7-3 AWP

Page 3 of 4



REFERENCE WELLPATH IDENTIFICATION			
Operator	KERR MCGEE OIL & GAS ONSHORE LP	Slot	SLOT#03 CANNON 7-3 (1554'FNL & 1657'FEL)
Area	COLORADO	Well	CANNON 7-3
Field	WELD COUNTY (KERR MCGEE)	Wellbore	CANNON 7-3 AWB
Facility	SEC.03-T2N-R65W		

WELLPATH DATA (62 stations)								
MD [ft]	Inclination [°]	Azimuth [°]	TVD [ft]	Vert Sect [ft]	North [ft]	East [ft]	DLS [°/100ft]	Comments
4587.00	0.300	50.900	4504.34	645.84	-429.68	-482.89	1.00	
4768.00	1.300	17.900	4685.32	643.56	-427.43	-481.89	0.59	
4949.00	1.100	126.500	4866.30	641.46	-426.51	-479.86	1.08	
5131.00	0.300	100.150	5048.28	640.90	-427.63	-477.99	0.46	
5313.00	0.600	282.300	5230.28	641.15	-427.52	-478.45	0.49	
5494.00	0.800	269.600	5411.27	642.59	-427.32	-480.64	0.14	
5675.00	1.500	150.400	5592.24	644.09	-429.39	-480.73	1.11	
5857.00	0.700	133.200	5774.21	644.63	-432.22	-478.74	0.47	
6038.00	0.200	139.500	5955.20	644.59	-433.22	-477.73	0.28	
6220.00	0.400	2.400	6137.20	644.15	-432.83	-477.50	0.31	
6402.00	1.200	330.800	6319.18	643.21	-430.53	-478.40	0.49	
6583.00	0.800	330.800	6500.16	642.40	-427.77	-479.94	0.22	
6765.00	1.000	269.600	6682.14	643.23	-426.67	-482.15	0.51	
6946.00	0.500	248.500	6863.12	645.10	-426.97	-484.47	0.31	
7128.00	0.400	229.200	7045.12	646.47	-427.68	-485.69	0.10	
7320.00	0.500	327.300	7237.11	646.97	-427.41	-486.65	0.36	LAST BHI MWD SURVEY
7370.00	0.500	327.300	7287.11	646.89	-427.05	-486.88	0.00	PROJECTION TO BIT

HOLE & CASING SECTIONS - Ref Wellbore: CANNON 7-3 AWB    Ref Wellpath: CANNON 7-3 AWP									
String/Diameter	Start MD [ft]	End MD [ft]	Interval [ft]	Start TVD [ft]	End TVD [ft]	Start N/S [ft]	Start E/W [ft]	End N/S [ft]	End E/W [ft]
12.25in Open Hole	15.00	760.00	745.00	15.00	758.19	0.00	0.00	-26.59	-31.14
8.625in Casing Surface	15.00	760.00	745.00	15.00	758.19	0.00	0.00	-26.59	-31.14
7.875in Open Hole	760.00	7370.00	6610.00	758.19	7287.11	-26.59	-31.14	-427.05	-486.88



# Actual Wellpath Report

CANNON 7-3 AWP

Page 4 of 4



REFERENCE WELLPATH IDENTIFICATION			
Operator	KERR MCGEE OIL & GAS ONSHORE LP	Slot	SLOT#03 CANNON 7-3 (1554'FNL & 1657'FEL)
Area	COLORADO	Well	CANNON 7-3
Field	WELD COUNTY (KERR MCGEE)	Wellbore	CANNON 7-3 AWB
Facility	SEC.03-T2N-R65W		

TARGETS									
Name	MD [ft]	TVD [ft]	North [ft]	East [ft]	Grid East [US ft]	Grid North [US ft]	Latitude	Longitude	Shape
CANNON 7-3 GEO TARGET 50' RADIUS (2010'FNL & 2118'FEL REV-1)		6000.00	-452.86	-468.98	3238123.01	1305586.19	40°10'08.720"N	104°38'52.444"W	circle
CANNON 7-3 LEGAL BOX (350'N, 50'S, 333'E, 67'W OF GEO TARGET)		6000.00	-302.82	-335.95	3238254.59	1305737.49	40°10'10.203"N	104°38'50.730"W	square

WELLPATH COMPOSITION - Ref Wellbore: CANNON 7-3 AWB					Ref Wellpath: CANNON 7-3 AWP	
Start MD [ft]	End MD [ft]	Positional Uncertainty Model	Log Name/Comment		Wellbore	
15.00	703.00	NaviTrak (Standard)	BHI MWD NAVITRAK 12.25 <153-703>		CANNON 7-3 AWB	
703.00	7320.00	NaviTrak (Standard)	BHI MWD NAVITRAK <782-7320>		CANNON 7-3 AWB	
7320.00	7370.00	Blind Drilling (std)	Projection to bit		CANNON 7-3 AWB	