



KERR MCGEE OIL & GAS ONSHORE LP



Location: COLORADO Slot: SLOT#05 CANNON 25-3 (1531'FNL & 1680'FEL)
Field: WELD COUNTY (KERR MCGEE) Well: CANNON 25-3
Facility: SEC.03-T2N-R65W Wellbore: CANNON 25-3 PWB

Plot reference wellpath is CANNON 25-3 (REV-A.0) PWP	
True vertical depths are referenced to XTREME 12 (RKB)	Grid System: NAD83 / Lambert Colorado SP, Northern Zone (501), US feet
Measured depths are referenced to XTREME 12 (RKB)	North Reference: True north
XTREME 12 (RKB) to Mean Sea Level: 4859 feet	Scale: True distance
Mean Sea Level to Mud line (At Slot: SLOT#05 CANNON 25-3 (1531'FNL & 1680'FEL)): 0 feet	Depths are in feet
Coordinates are in feet referenced to Slot	Created by: doddanna on 9/9/2011

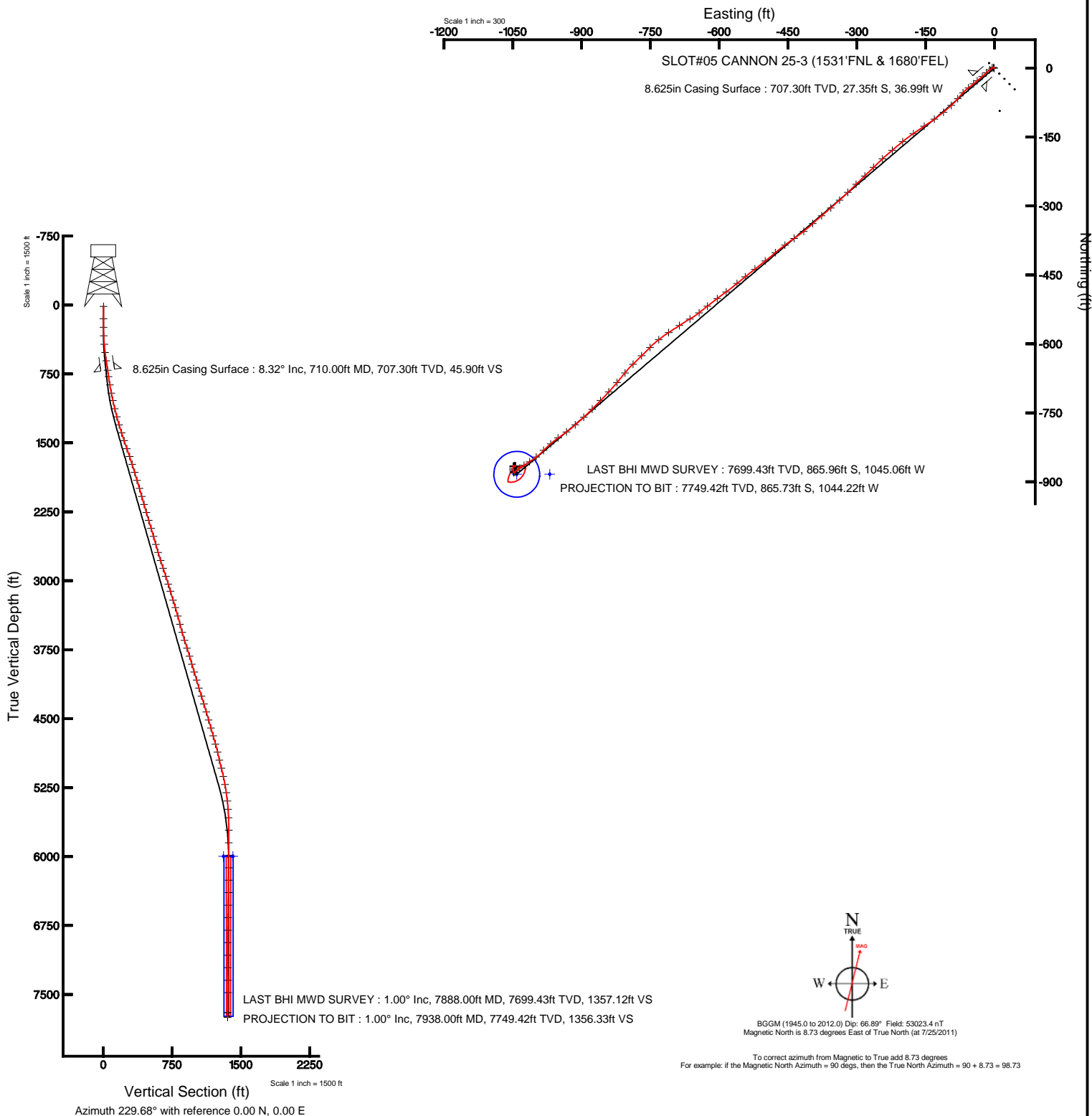



Actual Wellpath Report

CANNON 25-3 AWP

Page 1 of 4



REFERENCE WELLPATH IDENTIFICATION			
Operator	KERR MCGEE OIL & GAS ONSHORE LP	Slot	SLOT#05 CANNON 25-3 (1531'FNL & 1680'FEL)
Area	COLORADO	Well	CANNON 25-3
Field	WELD COUNTY (KERR MCGEE)	Wellbore	CANNON 25-3 AWB
Facility	SEC.03-T2N-R65W		

REPORT SETUP INFORMATION			
Projection System	NAD83 / Lambert Colorado SP, Northern Zone (501), US feet	Software System	WellArchitect@ 3.0.0
North Reference	True	User	Doddanna
Scale	0.999958	Report Generated	9/9/2011 at 2:03:09 PM
Convergence at slot	0.55° East	Database/Source file	WA_Denver/CANNON_25-3_AWB.xml

WELLPATH LOCATION						
	Local coordinates		Grid coordinates		Geographic coordinates	
	North[ft]	East[ft]	Easting[US ft]	Northing[US ft]	Latitude	Longitude
Slot Location	45.94	-44.70	3238565.02	1306066.26	40°10'13.422"N	104°38'46.691"W
Facility Reference Pt			3238610.16	1306020.75	40°10'12.968"N	104°38'46.115"W
Field Reference Pt			3197771.84	1268891.29	40°04'09.600"N	104°47'36.000"W

WELLPATH DATUM			
Calculation method	Minimum curvature	XTREME 12 (RKB) to Facility Vertical Datum	4859.00ft
Horizontal Reference Pt	Slot	XTREME 12 (RKB) to Mean Sea Level	4859.00ft
Vertical Reference Pt	XTREME 12 (RKB)	XTREME 12 (RKB) to Mud Line at Slot (SLOT#05 CANNON 25-3 (1531'FNL & 1680'FEL))	4859.00ft
MD Reference Pt	XTREME 12 (RKB)	Section Origin	N 0.00, E 0.00 ft
Field Vertical Reference	Mean Sea Level	Section Azimuth	229.68°



Actual Wellpath Report

CANNON 25-3 AWP

Page 2 of 4



REFERENCE WELLPATH IDENTIFICATION			
Operator	KERR MCGEE OIL & GAS ONSHORE LP	Slot	SLOT#05 CANNON 25-3 (1531'FNL & 1680'FEL)
Area	COLORADO	Well	CANNON 25-3
Field	WELD COUNTY (KERR MCGEE)	Wellbore	CANNON 25-3 AWB
Facility	SEC.03-T2N-R65W		

WELLPATH DATA (80 stations) † = interpolated/extrapolated station								
MD [ft]	Inclination [°]	Azimuth [°]	TVD [ft]	Vert Sect [ft]	North [ft]	East [ft]	DLS [°/100ft]	Comments
0.00†	0.000	331.900	0.00	0.00	0.00	0.00	0.00	
15.00	0.000	331.900	15.00	0.00	0.00	0.00	0.00	
149.00	1.200	331.900	148.99	-0.30	1.24	-0.66	0.90	
242.00	1.000	256.600	241.98	0.22	1.91	-1.91	1.45	
334.00	2.600	232.000	333.93	3.02	0.44	-4.33	1.89	
426.00	5.200	232.700	425.71	9.27	-3.37	-9.30	2.83	
518.00	7.200	228.100	517.17	19.20	-9.75	-16.90	2.24	
608.00	8.200	228.600	606.35	31.25	-17.76	-25.92	1.11	
781.00	8.400	230.300	777.54	56.22	-33.99	-44.89	0.18	
872.00	9.400	234.800	867.45	70.27	-42.52	-56.08	1.34	
963.00	11.000	222.000	957.02	86.28	-53.26	-67.96	3.04	
1047.00	12.700	221.100	1039.22	103.36	-66.17	-79.40	2.04	
1138.00	13.500	226.700	1127.86	123.86	-81.00	-93.70	1.65	
1229.00	15.000	231.000	1216.06	146.24	-95.70	-110.59	2.02	
1319.00	17.100	233.800	1302.55	171.08	-110.84	-130.32	2.49	
1410.00	17.800	236.900	1389.36	198.23	-126.34	-152.77	1.28	
1501.00	18.500	235.200	1475.83	226.40	-142.18	-176.28	0.96	
1592.00	19.200	230.600	1561.96	255.73	-159.91	-199.70	1.80	
1683.00	18.500	230.300	1648.08	285.13	-178.63	-222.37	0.78	
1773.00	17.900	227.100	1733.57	313.22	-197.17	-243.49	1.30	
1864.00	16.800	225.700	1820.43	340.31	-215.88	-263.14	1.29	
1955.00	17.400	226.000	1907.41	367.01	-234.51	-282.34	0.67	
2046.00	16.200	225.700	1994.52	393.26	-252.83	-301.22	1.32	
2136.00	15.900	226.000	2081.02	418.08	-270.16	-319.07	0.35	
2227.00	16.000	228.200	2168.51	443.06	-287.18	-337.39	0.67	
2318.00	16.500	228.500	2255.88	468.52	-304.10	-356.41	0.56	
2409.00	16.900	230.200	2343.04	494.66	-321.13	-376.25	0.69	
2500.00	16.400	227.400	2430.23	520.73	-338.30	-395.87	1.04	
2590.00	17.100	231.700	2516.41	546.65	-355.10	-415.61	1.58	
2681.00	15.700	235.200	2603.71	572.27	-370.42	-436.22	1.88	
2772.00	16.200	233.100	2691.21	597.20	-385.07	-456.48	0.84	
2863.00	18.000	230.600	2778.18	623.93	-401.61	-477.50	2.14	
2954.00	18.400	230.600	2864.63	652.35	-419.65	-499.46	0.44	
3045.00	18.200	232.700	2951.03	680.90	-437.38	-521.87	0.76	
3135.00	16.900	231.300	3036.84	708.02	-454.08	-543.26	1.52	
3216.00	16.400	229.900	3114.44	731.22	-468.81	-561.19	0.79	
3317.00	17.700	234.100	3211.00	760.79	-487.00	-584.54	1.77	
3400.00	16.600	233.000	3290.31	785.21	-501.53	-604.23	1.38	
3498.00	15.200	231.700	3384.56	812.02	-517.92	-625.49	1.47	
3589.00	14.600	231.900	3472.50	835.41	-532.39	-643.88	0.66	
3680.00	16.300	239.400	3560.22	859.46	-545.97	-663.90	2.88	
3771.00	18.100	236.600	3647.14	886.08	-560.25	-686.70	2.18	
3861.00	18.000	237.000	3732.72	913.75	-575.52	-710.03	0.18	
3952.00	16.000	232.400	3819.74	940.23	-590.83	-731.76	2.65	
4043.00	16.600	224.100	3907.09	965.69	-607.82	-750.75	2.64	



Actual Wellpath Report

CANNON 25-3 AWP

Page 3 of 4



REFERENCE WELLPATH IDENTIFICATION			
Operator	KERR MCGEE OIL & GAS ONSHORE LP	Slot	SLOT#05 CANNON 25-3 (1531'FNL & 1680'FEL)
Area	COLORADO	Well	CANNON 25-3
Field	WELD COUNTY (KERR MCGEE)	Wellbore	CANNON 25-3 AWB
Facility	SEC.03-T2N-R65W		

WELLPATH DATA (80 stations)								
MD [ft]	Inclination [°]	Azimuth [°]	TVD [ft]	Vert Sect [ft]	North [ft]	East [ft]	DLS [°/100ft]	Comments
4133.00	16.900	225.700	3993.27	991.54	-626.19	-769.06	0.61	
4224.00	16.600	226.400	4080.41	1017.71	-644.39	-787.94	0.40	
4315.00	16.700	218.600	4167.61	1043.53	-663.58	-805.51	2.46	
4406.00	17.800	220.800	4254.52	1070.10	-684.33	-822.76	1.41	
4496.00	17.100	222.700	4340.37	1096.83	-704.46	-840.72	1.00	
4587.00	16.600	223.600	4427.47	1123.03	-723.71	-858.76	0.62	
4678.00	16.500	225.300	4514.70	1148.84	-742.21	-876.90	0.54	
4769.00	16.000	227.400	4602.06	1174.26	-759.79	-895.32	0.85	
4859.00	16.300	228.900	4688.51	1199.28	-776.49	-913.97	0.57	
4950.00	14.900	233.700	4776.16	1223.73	-791.81	-933.02	2.09	
5041.00	13.800	234.500	4864.32	1246.21	-805.04	-951.29	1.23	
5132.00	12.600	229.200	4952.92	1266.95	-817.83	-967.64	1.87	
5222.00	14.300	224.600	5040.45	1287.84	-832.16	-982.88	2.23	
5313.00	13.100	232.700	5128.87	1309.34	-846.42	-998.97	2.48	
5404.00	9.800	236.900	5218.04	1327.32	-856.90	-1013.67	3.74	
5494.00	8.300	238.300	5306.92	1341.35	-864.49	-1025.61	1.68	
5585.00	6.000	231.700	5397.21	1352.60	-870.89	-1034.94	2.68	
5676.00	4.800	233.400	5487.80	1361.15	-876.11	-1041.72	1.33	
5767.00	1.500	226.700	5578.65	1366.14	-879.20	-1045.65	3.64	
5903.00	0.500	265.800	5714.63	1368.40	-880.46	-1047.54	0.85	
6039.00	0.100	300.200	5850.63	1368.91	-880.45	-1048.23	0.31	
6175.00	0.300	326.900	5986.63	1368.91	-880.09	-1048.53	0.16	
6311.00	0.700	356.100	6122.62	1368.37	-878.96	-1048.78	0.34	
6447.00	1.100	354.000	6258.61	1367.14	-876.84	-1048.97	0.30	
6583.00	1.200	348.400	6394.58	1365.72	-874.14	-1049.39	0.11	
6719.00	1.400	360.000	6530.54	1363.96	-871.09	-1049.68	0.24	
6855.00	1.500	357.500	6666.50	1361.79	-867.65	-1049.76	0.09	
6991.00	0.800	85.400	6802.48	1359.93	-865.79	-1048.89	1.23	
7127.00	0.500	109.300	6938.47	1358.86	-865.91	-1047.38	0.29	
7264.00	0.200	103.700	7075.47	1358.42	-866.17	-1046.59	0.22	
7400.00	0.700	238.000	7211.47	1359.10	-866.66	-1047.06	0.63	
7536.00	0.600	260.100	7347.46	1360.54	-867.22	-1048.47	0.20	
7672.00	0.800	68.900	7483.45	1360.25	-867.01	-1048.28	1.02	
7888.00	1.000	74.500	7699.43	1357.12	-865.96	-1045.06	0.10	LAST BHI MWD SURVEY
7938.00	1.000	74.500	7749.42	1356.33	-865.73	-1044.22	0.00	PROJECTION TO BIT



Actual Wellpath Report

CANNON 25-3 AWP

Page 4 of 4



REFERENCE WELLPATH IDENTIFICATION			
Operator	KERR MCGEE OIL & GAS ONSHORE LP	Slot	SLOT#05 CANNON 25-3 (1531'FNL & 1680'FEL)
Area	COLORADO	Well	CANNON 25-3
Field	WELD COUNTY (KERR MCGEE)	Wellbore	CANNON 25-3 AWB
Facility	SEC.03-T2N-R65W		

HOLE & CASING SECTIONS - Ref Wellbore: CANNON 25-3 AWB Ref Wellpath: CANNON 25-3 AWP									
String/Diameter	Start MD [ft]	End MD [ft]	Interval [ft]	Start TVD [ft]	End TVD [ft]	Start N/S [ft]	Start E/W [ft]	End N/S [ft]	End E/W [ft]
12.25in Open Hole	15.00	710.00	695.00	15.00	707.30	0.00	0.00	-27.35	-36.99
8.625in Casing Surface	15.00	710.00	695.00	15.00	707.30	0.00	0.00	-27.35	-36.99
7.875in Open Hole	710.00	7938.00	7228.00	707.30	7749.42	-27.35	-36.99	-865.73	-1044.22

TARGETS									
Name	MD [ft]	TVD [ft]	North [ft]	East [ft]	Grid East [US ft]	Grid North [US ft]	Latitude	Longitude	Shape
CANNON 25-3 GEO TARGET 50' RADIUS (2422'FNL & 2570'FWL REV-1)		6000.00	-884.11	-1041.61	3237532.02	1305172.20	40°10'04.685"N	104°39'00.108"W	circle
CANNON 25-3 HARDLINE 72'E OF GEO TARGET		6000.00	-884.13	-969.61	3237604.01	1305172.87	40°10'04.685"N	104°38'59.181"W	point
CANNON 25-3 HARDLINE 72'S OF GEO TARGET		6000.00	-956.13	-1041.61	3237532.71	1305100.18	40°10'03.973"N	104°39'00.108"W	point

WELLPATH COMPOSITION - Ref Wellbore: CANNON 25-3 AWB Ref Wellpath: CANNON 25-3 AWP					
Start MD [ft]	End MD [ft]	Positional Uncertainty Model	Log Name/Comment	Wellbore	
15.00	608.00	NaviTrak (Standard)	BHI MWD NAVITRAK 12.25 <149-608>	CANNON 25-3 AWB	
608.00	7888.00	NaviTrak (Standard)	BHI MWD NAVITRAK 7.875 <781-7888>	CANNON 25-3 AWB	
7888.00	7938.00	Blind Drilling (std)	Projection to bit	CANNON 25-3 AWB	