



KERR MCGEE OIL & GAS ONSHORE LP

Location: COLORADO Slot: SLOT#05 SWEETGRASS 25-14 (1840'FSL & 864'FEL)
Field: WELD COUNTY (KERR MCGEE) Well: SWEETGRASS 25-14
Facility: SEC.14-T1N-R68W Wellbore: SWEETGRASS 25-14 PWB



Plot reference wellpath is: SWEETGRASS 25-14 (REV-A.1) PWB	
True vertical depths are referenced to XTREME 12 (RKB)	Grid System: NAD83 / Lambert Colorado SP, Northern Zone (501), US feet
Measured depths are referenced to XTREME 12 (RKB)	North Reference: True north
XTREME 12 (RKB) to Mean Sea Level: 5151 feet	Scale: True distance
Mean Sea Level to Mudline (at Slot: SWEETGRASS 25-14 (1840'FSL & 864'FEL)): 0 feet	Depths are in feet
Coordinates are in feet referenced to Slot	
Created by: cookdenn on 7/21/2011	

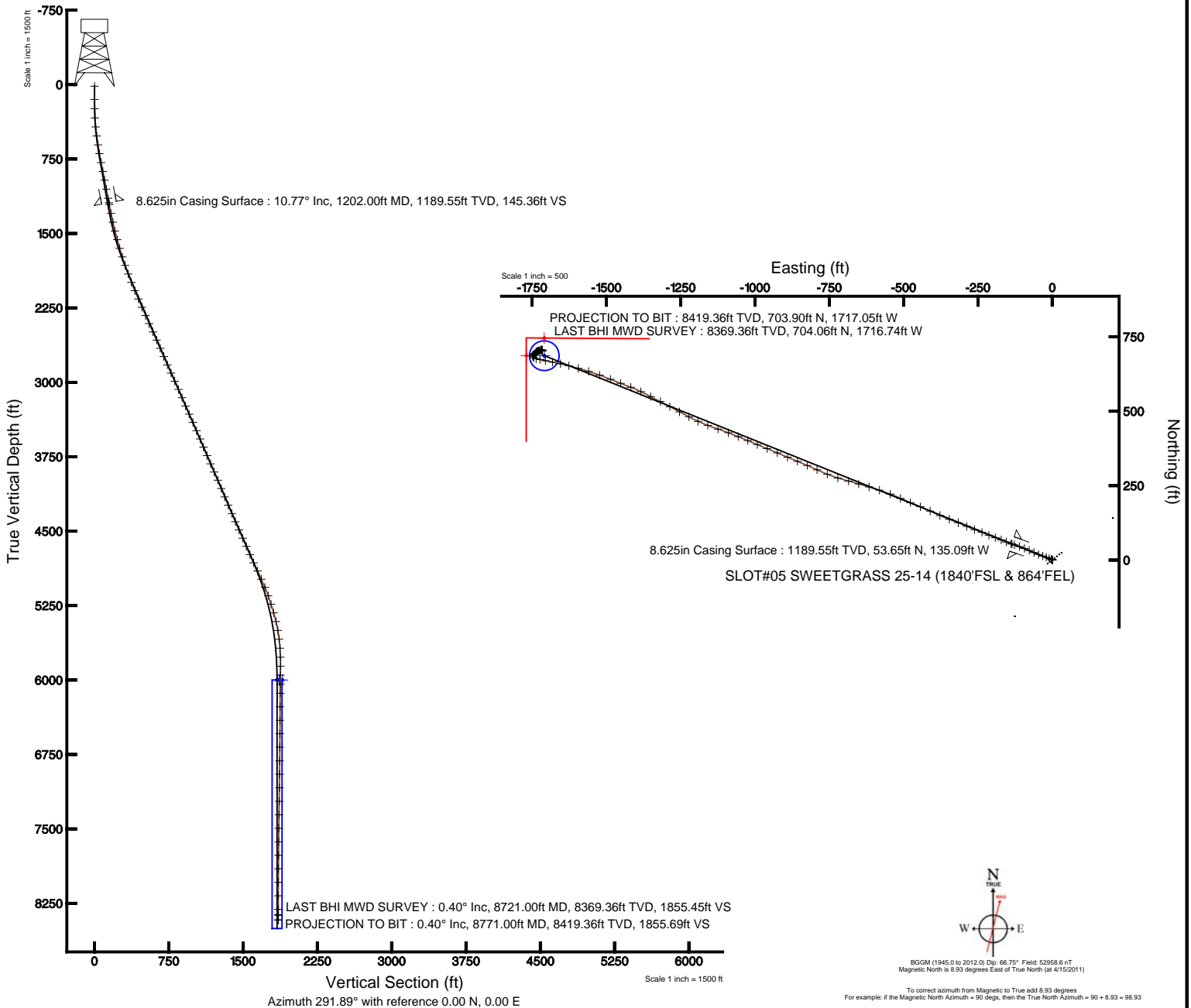



Actual Wellpath Report

SWEETGRASS 25-14 AWP

Page 1 of 5



REFERENCE WELLPATH IDENTIFICATION			
Operator	KERR MCGEE OIL & GAS ONSHORE LP	Slot	SLOT#05 SWEETGRASS 25-14 (1840'FSL & 864'FEL)
Area	COLORADO	Well	SWEETGRASS 25-14
Field	WELD COUNTY (KERR MCGEE)	Wellbore	SWEETGRASS 25-14 AWB
Facility	SEC.14-T1N-R68W		

REPORT SETUP INFORMATION			
Projection System	NAD83 / Lambert Colorado SP, Northern Zone (501), US feet	Software System	WellArchitect® 3.0.0
North Reference	True	User	Cookdanm
Scale	0.999963	Report Generated	7/21/2011 at 10:04:55 AM
Convergence at slot	0.35° East	Database/Source file	WA_DENVER/_SWEETGRASS_25-14_AWB.xml

WELLPATH LOCATION						
	Local coordinates		Grid coordinates		Geographic coordinates	
	North[ft]	East[ft]	Easting[US ft]	Northing[US ft]	Latitude	Longitude
Slot Location	-24.77	-31.36	3149972.93	1261235.65	40°02'57.253"N	104°57'51.430"W
Facility Reference Pt			3150004.14	1261260.61	40°02'57.498"N	104°57'51.026"W
Field Reference Pt			3197771.84	1268891.29	40°04'09.600"N	104°47'36.000"W

WELLPATH DATUM			
Calculation method	Minimum curvature	XTREME 12 (RKB) to Facility Vertical Datum	5151.00ft
Horizontal Reference Pt	Slot	XTREME 12 (RKB) to Mean Sea Level	5151.00ft
Vertical Reference Pt	XTREME 12 (RKB)	XTREME 12 (RKB) to Mud Line at Slot (SLOT#05 SWEETGRASS 25-14 (1840'FSL & 864'FEL))	5151.00ft
MD Reference Pt	XTREME 12 (RKB)	Section Origin	N 0.00, E 0.00 ft
Field Vertical Reference	Mean Sea Level	Section Azimuth	291.89°



Actual Wellpath Report

SWEETGRASS 25-14 AWP

Page 2 of 5



REFERENCE WELLPATH IDENTIFICATION			
Operator	KERR MCGEE OIL & GAS ONSHORE LP	Slot	SLOT#05 SWEETGRASS 25-14 (1840'FSL & 864'FEL)
Area	COLORADO	Well	SWEETGRASS 25-14
Field	WELD COUNTY (KERR MCGEE)	Wellbore	SWEETGRASS 25-14 AWP
Facility	SEC.14-T1N-R68W		

WELLPATH DATA (91 stations) † = interpolated/extrapolated station								
MD [ft]	Inclination [°]	Azimuth [°]	TVD [ft]	Vert Sect [ft]	North [ft]	East [ft]	DLS [°/100ft]	Comments
0.00†	0.000	81.500	0.00	0.00	0.00	0.00	0.00	
15.00	0.000	81.500	15.00	0.00	0.00	0.00	0.00	
149.00	0.900	81.500	148.99	-0.91	0.16	1.04	0.67	
242.00	1.200	310.100	241.99	-0.61	0.89	1.02	2.06	
334.00	3.900	291.800	333.89	3.43	2.67	-2.62	3.03	
426.00	5.900	290.400	425.55	11.29	5.48	-9.96	2.18	
518.00	7.300	289.700	516.94	21.86	9.10	-19.90	1.52	
608.00	8.700	290.000	606.06	34.37	13.36	-31.68	1.56	
699.00	10.400	291.800	695.79	49.47	18.76	-45.77	1.90	
790.00	10.700	293.500	785.26	66.13	25.18	-61.15	0.48	
881.00	11.300	294.200	874.58	83.48	32.21	-77.02	0.68	
971.00	11.300	290.700	962.84	101.10	38.94	-93.32	0.76	
1062.00	10.900	289.700	1052.14	118.62	44.99	-109.76	0.49	
1157.00	11.200	289.000	1145.38	136.81	51.02	-126.94	0.35	
1220.00	10.600	285.800	1207.24	148.68	54.59	-138.30	1.35	
1312.00	11.400	293.500	1297.55	166.18	60.52	-154.78	1.82	
1402.00	12.300	292.100	1385.63	184.66	67.67	-171.82	1.05	
1493.00	14.000	289.700	1474.25	205.35	75.03	-191.16	1.96	
1584.00	15.600	291.800	1562.22	228.59	83.29	-212.89	1.85	
1675.00	16.800	292.100	1649.61	253.98	92.78	-236.43	1.32	
1765.00	17.500	289.700	1735.61	280.51	102.23	-261.23	1.11	
1856.00	19.300	294.600	1821.96	309.21	113.11	-287.78	2.61	
1947.00	20.200	291.800	1907.61	339.94	125.20	-316.05	1.43	
2038.00	21.100	290.400	1992.76	372.03	136.75	-345.99	1.13	
2128.00	23.500	293.900	2076.03	406.16	149.67	-377.58	3.05	
2219.00	23.400	294.600	2159.51	442.34	164.54	-410.60	0.33	
2310.00	23.000	292.500	2243.15	478.17	178.86	-443.46	1.01	
2401.00	24.400	292.500	2326.48	514.74	192.86	-477.25	1.54	
2491.00	23.000	293.900	2408.88	550.91	207.10	-510.50	1.68	
2582.00	25.600	291.800	2491.82	588.34	221.61	-545.01	3.01	
2673.00	24.400	287.900	2574.29	626.75	234.69	-581.16	2.24	
2763.00	23.900	286.200	2656.42	663.44	245.49	-616.36	0.95	
2854.00	22.900	286.200	2739.93	699.40	255.57	-651.06	1.10	
2945.00	23.600	285.500	2823.54	735.13	265.38	-685.62	0.83	
3036.00	24.400	287.200	2906.68	771.96	275.80	-721.13	1.16	
3126.00	25.300	291.100	2988.35	809.72	288.22	-756.83	2.08	
3217.00	23.600	295.600	3071.19	847.35	303.10	-791.41	2.77	
3308.00	22.700	292.500	3154.87	883.09	317.69	-824.06	1.66	
3399.00	23.500	292.500	3238.57	918.79	331.35	-857.04	0.88	
3489.00	24.100	293.200	3320.91	955.10	345.46	-890.51	0.74	
3580.00	24.700	292.800	3403.79	992.69	360.14	-925.11	0.68	
3671.00	23.600	291.800	3486.82	1029.91	374.28	-959.55	1.29	
3762.00	22.600	293.200	3570.52	1065.61	387.93	-992.54	1.25	
3852.00	22.600	293.200	3653.61	1100.19	401.56	-1024.33	0.00	
3943.00	22.600	291.400	3737.63	1135.15	414.82	-1056.68	0.76	
4034.00	23.600	290.700	3821.33	1170.85	427.64	-1090.00	1.14	
4125.00	24.200	289.300	3904.53	1207.70	440.25	-1124.65	0.91	
4215.00	24.200	290.400	3986.62	1244.57	452.77	-1159.35	0.50	
4306.00	21.600	294.200	4070.44	1279.95	466.15	-1192.11	3.29	
4397.00	22.200	298.800	4154.88	1313.76	481.29	-1222.46	2.00	
4488.00	24.200	296.400	4238.52	1349.43	497.87	-1254.23	2.43	
4579.00	23.500	299.900	4321.75	1385.99	515.21	-1286.67	1.73	
4670.00	23.400	296.700	4405.24	1421.96	532.37	-1318.54	1.40	
4760.00	24.300	297.800	4487.56	1458.19	549.04	-1350.89	1.12	
4851.00	24.300	296.000	4570.49	1495.49	565.98	-1384.28	0.81	
4942.00	23.700	290.000	4653.64	1532.45	580.45	-1418.30	2.76	
5033.00	23.600	292.500	4737.00	1568.95	593.67	-1452.32	1.11	
5123.00	24.800	291.400	4819.09	1605.84	607.46	-1486.54	1.42	
5214.00	26.000	290.100	4901.29	1644.86	621.28	-1523.04	1.45	

5305.00	24.700	286.900	4983.53	1683.74	633.66	-1559.97	2.08
---------	--------	---------	---------	---------	--------	----------	------



Actual Wellpath Report

SWEETGRASS 25-14 AWP

Page 3 of 5



REFERENCE WELLPATH IDENTIFICATION			
Operator	KERR MCGEE OIL & GAS ONSHORE LP	Slot	SLOT#05 SWEETGRASS 25-14 (1840'FSL & 864'FEL)
Area	COLORADO	Well	SWEETGRASS 25-14
Field	WELD COUNTY (KERR MCGEE)	Wellbore	SWEETGRASS 25-14 AWB
Facility	SEC.14-T1N-R68W		

WELLPATH DATA (91 stations)								
MD [ft]	Inclination [°]	Azimuth [°]	TVD [ft]	Vert Sect [ft]	North [ft]	East [ft]	DLS [°/100ft]	Comments
5396.00	22.500	286.200	5066.91	1720.01	644.04	-1594.88	2.44	
5487.00	20.000	284.800	5151.72	1752.79	652.88	-1626.66	2.80	
5577.00	18.000	282.300	5236.82	1781.77	659.77	-1655.13	2.40	
5668.00	16.400	279.800	5323.74	1808.20	664.96	-1681.53	1.94	
5759.00	14.600	284.000	5411.43	1832.13	669.92	-1705.32	2.33	
5850.00	9.300	278.100	5500.43	1850.64	673.73	-1723.74	5.97	
5940.00	7.500	286.900	5589.47	1863.56	676.46	-1736.56	2.45	
6031.00	3.500	301.300	5680.03	1872.22	679.63	-1744.62	4.62	
6122.00	3.000	344.500	5770.90	1876.41	683.37	-1747.63	2.68	
6213.00	2.500	28.800	5861.81	1877.61	687.41	-1747.31	2.33	
6303.00	2.200	53.800	5951.73	1876.46	690.15	-1744.97	1.18	
6394.00	1.900	50.600	6042.67	1874.82	692.14	-1742.39	0.35	
6485.00	1.600	44.600	6133.63	1873.60	694.00	-1740.34	0.39	
6621.00	1.100	45.300	6269.59	1872.35	696.27	-1738.07	0.37	
6757.00	0.800	31.600	6405.57	1871.67	698.00	-1736.65	0.28	
6893.00	0.700	53.400	6541.56	1871.08	699.30	-1735.48	0.22	
7029.00	0.900	53.800	6677.55	1870.08	700.43	-1733.96	0.15	
7166.00	1.000	56.900	6814.53	1868.82	701.71	-1732.09	0.08	
7302.00	0.500	72.800	6950.52	1867.68	702.54	-1730.53	0.39	
7438.00	0.800	75.700	7086.51	1866.45	702.95	-1729.04	0.22	
7574.00	0.800	83.700	7222.50	1864.85	703.29	-1727.17	0.08	
7710.00	1.900	71.700	7358.46	1862.29	704.10	-1724.09	0.83	
7846.00	1.200	59.400	7494.41	1859.70	705.53	-1720.72	0.57	
7983.00	0.700	53.400	7631.39	1858.39	706.76	-1718.82	0.37	
8119.00	1.100	168.400	7767.38	1857.24	705.98	-1717.89	1.13	
8255.00	0.300	133.900	7903.37	1856.19	704.45	-1717.37	0.64	
8391.00	0.500	77.700	8039.36	1855.36	704.33	-1716.53	0.31	
8527.00	0.000	164.900	8175.36	1854.87	704.46	-1715.95	0.37	
8663.00	0.400	243.200	8311.36	1855.19	704.24	-1716.38	0.29	
8721.00	0.400	243.200	8369.36	1855.45	704.06	-1716.74	0.00	LAST BHI MWD SURVEY
8771.00	0.400	243.200	8419.36	1855.69	703.90	-1717.05	0.00	PROJECTION TO BIT

HOLE & CASING SECTIONS - Ref Wellbore: SWEETGRASS 25-14 AWB Ref Wellpath: SWEETGRASS 25-14 AWP									
String/Diameter	Start MD [ft]	End MD [ft]	Interval [ft]	Start TVD [ft]	End TVD [ft]	Start N/S [ft]	Start E/W [ft]	End N/S [ft]	End E/W [ft]
12.25in Open Hole	15.00	1212.00	1197.00	15.00	1199.38	0.00	0.00	54.18	-136.88
8.625in Casing Surface	15.00	1202.00	1187.00	15.00	1189.55	0.00	0.00	53.65	-135.09
7.875in Open Hole	1212.00	8771.00	7559.00	1199.38	8419.36	54.18	-136.88	703.90	-1717.05



Actual Wellpath Report

SWEETGRASS 25-14 AWP

Page 4 of 5



REFERENCE WELLPATH IDENTIFICATION			
Operator	KERR MCGEE OIL & GAS ONSHORE LP	Slot	SLOT#05 SWEETGRASS 25-14 (1840'FSL & 864'FEL)
Area	COLORADO	Well	SWEETGRASS 25-14
Field	WELD COUNTY (KERR MCGEE)	Wellbore	SWEETGRASS 25-14 AWB
Facility	SEC.14-T1N-R68W		

TARGETS									
Name	MD [ft]	TVD [ft]	North [ft]	East [ft]	Grid East [US ft]	Grid North [US ft]	Latitude	Longitude	Shape
SWEETGRASS 25-14 GEO TARGET 50' RADIUS (2560'FSL & 2570'FEL, REV-1)		6000.00	686.73	-1709.39	3148259.50	1261912.01	40°03'04.039"N	104°58'13.411"W	circle
SWEETGRASS 25-14 HARDLINE 59'N OF GEO TARGET		6000.00	745.75	-1709.40	3148259.13	1261971.03	40°03'04.622"N	104°58'13.411"W	point
SWEETGRASS 25-14 HARDLINE 60'W OF GEO TARGET		6000.00	686.75	-1769.40	3148199.49	1261911.67	40°03'04.039"N	104°58'14.183"W	point

WELLPATH COMPOSITION - Ref Wellbore: SWEETGRASS 25-14 AWB					Ref Wellpath: SWEETGRASS 25-14 AWP	
Start MD [ft]	End MD [ft]	Positional Uncertainty Model	Log Name/Comment		Wellbore	
15.00	8721.00	NaviTrak (Standard)	BHI MWD SURVEYS <149-8721>		SWEETGRASS 25-14 AWB	
8721.00	8771.00	Blind Drilling (std)	Projection to bit		SWEETGRASS 25-14 AWB	



Actual Wellpath Report

SWEETGRASS 25-14 AWP

Page 5 of 5



REFERENCE WELLPATH IDENTIFICATION			
Operator	KERR MCGEE OIL & GAS ONSHORE LP	Slot	SLOT#05 SWEETGRASS 25-14 (1840'FSL & 864'FEL)
Area	COLORADO	Well	SWEETGRASS 25-14
Field	WELD COUNTY (KERR MCGEE)	Wellbore	SWEETGRASS 25-14 AWB
Facility	SEC.14-T1N-R68W		

WELLPATH COMMENTS				
MD [ft]	Inclination [°]	Azimuth [°]	TVD [ft]	Comment
8721.00	0.400	243.200	8369.36	LAST BHI MWD SURVEY
8771.00	0.400	243.200	8419.36	PROJECTION TO BIT